



Rear I/O

DC-Jack type or Terminal block type by optional



Features

- Fanless system with IBASE IB822 3.5" Single Board Computer
- Intel® Pentium® Silver Processor J5040
- DC-Jack type or Terminal block type (by option)
- Supports 1x 2.5" SATA HDD or SSD (removable)
- Wall mount kit included

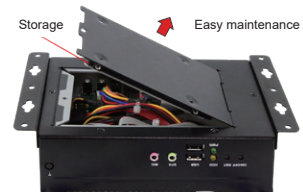
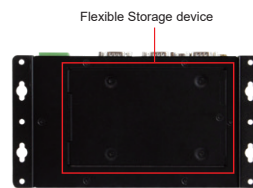

Specifications

System Mainboard	IB822
CPU Type	Intel® Pentium® Silver Processor J5040
System Speed	Up to 2.8GHz
Memory	1x 4GB DDR4 SO-DIMM, Max. 8GB
Front Panel External I/O	1x Power LED 1x HDD LED 1x Power button 1x Reset button 2x USB 2.0 ports 1x Line-out 1x Mic-in 1x Antenna reserved
Rear Panel External I/O	4x USB 3.0 port 1x RS232/422/485 for COM#1 3x RS232 for COM#2~4 1x HDMI 1x DisplayPort 2x RJ-45 Gigabit Ethernet port 2x Antenna reserved 1x DC jack with lock or Terminal block 12V(±10%) DC-in
Expansion Slots	1x M.2 (B-key, type: 2242) 1x M.2 (E-key, type: 2230)
Storage	1x 2.5" SATA HDD or SSD (removable)
Construction	Aluminum & Steel
Chassis Color	Black
Mounting Type	Desktop or wall mount (Wall mount kit included)
Dimensions	172mm (W) x 111.6mm (D) x 53mm (H) 6.77" (W) x 4.37" (D) x 2.08" (H)
Weight	1.1kgs
Operating Temperature	0°C~45°C (32°F~113°F) (HDD) *With air flow 0°C~50°C (32°F~122°F) (SSD) *With air flow
Storage Temperature	-40°C~85°C (-40°F~185°F)
Relative Humidity	5%~90%@45°C (non-condensing)
Vibration	Operating: 1.0 grms / 5~500Hz / random operation (with IEC 60068-2-64) Non-Operating: 2.0 grms / 5~500Hz / random operation (with IEC 60068-2-64)
Shock	Operating : 20G / 11ms Non-operating : 40G / 11ms
Certification	CE/ FCC Class-B / LVD

Ordering Information

CSB200-822-5040S	Fanless system with IB822-J5040 w/ Intel® Pentium® J5040, 4x COM, 1x 4GB DDR4 memory, 1x 2.5" 500GB HDD, desktop stand & mounting brackets, w/o 60W power adaptor, Terminal block power input
CSB200-822-5040S-DC	Fanless system with IB822-J5040 w/ Intel® Pentium® J5040, 4x COM, 1x 4GB DDR4 memory, 1x 2.5" 500GB HDD, desktop stand & mounting brackets, w/o 60W power adaptor, DC-Jack power input
60W power adaptor (optional)	60W (12V@5A) power adaptor, DC-jack or bare wire type, Compatible with IEC62368-1/EN62368-1

Dimensions and Drawing

