

Original BMW Accessories. Installation Instructions.



Retrofit Performance Package for BMW Z8 (E52)

Retrofit kit No.: 51 71 0 420 758 Performance Package

Installation time

The installation time is approx. 8.5 hours, but may vary depending on the condition of the car and the equipment in it.

The vehicle must be updated to the latest I-level status by flashing before installing the retrofit. Different programming times are necessary depending on the production age of the vehicle and the work already performed on the vehicle so that no time requirements can be specified here. The installation time does not include the time required for programming/encoding which depends on the vehicle's age and equipment.

Important information

These installation instructions are primarily designed for use within the BMW dealership organisation and by authorised BMW service companies.

In any event, the target group for these installation instructions is specialist personnel trained on BMW cars with the appropriate specialist knowledge.

All work must be completed using the latest BMW repair manuals, circuit diagrams, servicing manuals and work instructions, in a rational order, using the prescribed tools (special tools) and observing current health and safety regulations.

To avoid unnecessary extra work and/or costs, if any installation or function problem occurs, after a brief troubleshooting session (approx. 0.5 hours), please contact the following:

- 1. Either your national subsidiary or your regional office, or**
- 2 . The Support team via the Aftersales Assistance Portal (ASAP), using the optional technical parts support application.**

Specify the chassis number and the part number of the installed retrofit kit and give a precise description of the problem.

Do not archive the hard copy of these installation instructions since daily updates are made by ASAP!

All illustrations show LHD vehicles; proceed accordingly on RHD vehicles.

Pictograms:

 Denotes instructions that draw your attention to special features.

◀ Denotes the end of an instruction text.

Installation information

- Installation of the Performance Package includes fitting a suspension brace and new spring strut support bearings, including reinforcement rings.
- Before fitting the suspension brace, visually check the gap dimensions between the bonnet and the side trim for symmetry and for any anomalies. The suspension brace cannot be retrofitted if the gap is clearly unsymmetrical.
- In addition, wheel alignment with DIN load as per TIS no. 32 00 150 must be performed. It must be possible to adjust the suspension as per TIS no. 32 00 610 to within the specified tolerances or else it will not be possible to retrofit the suspension brace.
- After fitting the Performance Package, repeat wheel alignment with DIN load as per TIS no. 32 00 150. Adjust the suspension as necessary.

Special tools required

To fit the suspension brace:

81 43 9 429 204, riveting tongs

To fit the spring strut support bearing:

31 2 210, socket insert, WAF21

31 3 341, spring tensioner

31 3 352, spring holder

31 3 354, spring holder ring

31 3 367, protective inlay

Contents

Section	Page
1. Parts Overview	4
2. Preparatory work	5
3. Installing suspension brace	6
4. Installing spring strut support bearing	7
5. Concluding work and coding	8

1. Parts Overview

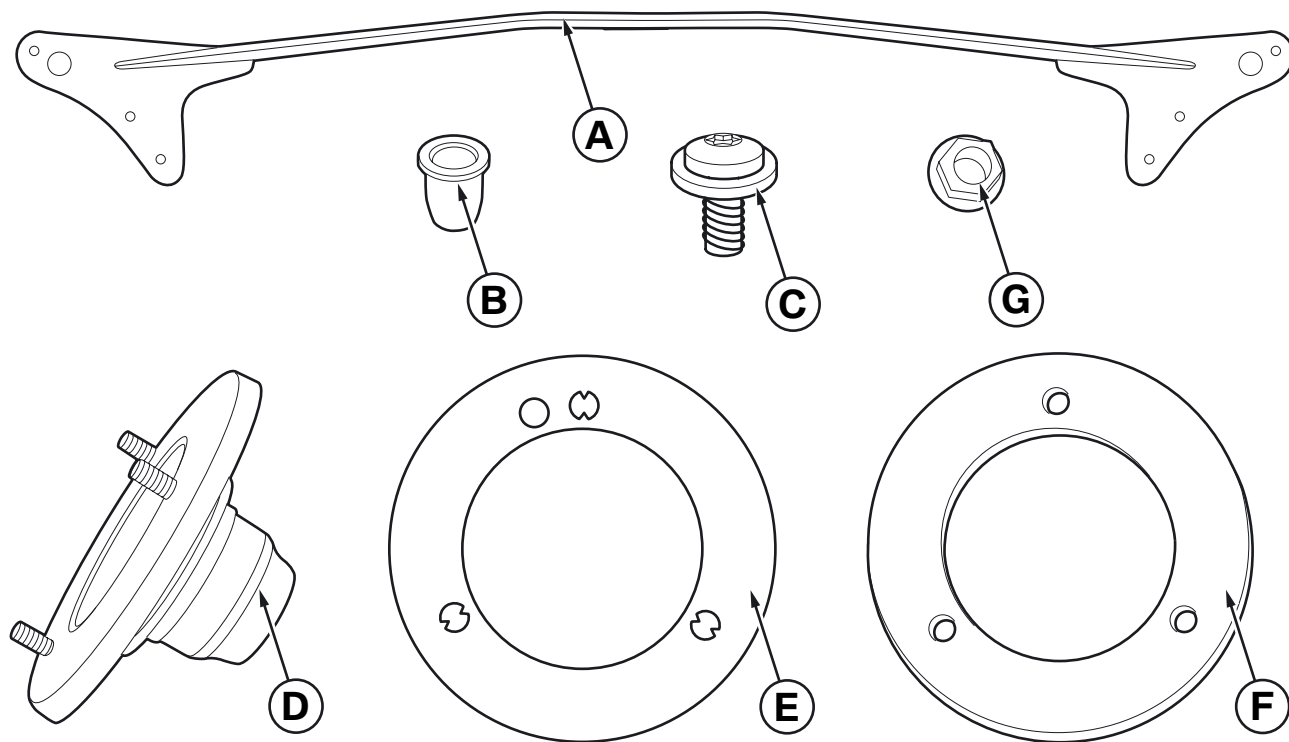

052 0001 V

Legend

A Suspension brace

B Blind rivet nut (6x)

C Torx screw M8 x 18 (6x)

D Spring strut support bearing (2x)

E Sealing ring (2x)

F Reinforcement ring (2x)

G Collar nut M8 (6x)

2. Preparatory work

	TIS No.
Perform quick test	---
Disconnect negative terminal of battery	12 00 ...
Standard wheel alignment with DIN load	32 00 150
 Remove the following components	
 To fit the suspension brace:	
Front wheels	36 10 300
Wheel arch cover, front left and right	51 71 040
Bulb holder for side lights, left	63 99 132
Remove left headlight	63 12 005
Bulb holder for side lights, right	63 99 133
Remove right headlight	63 12 006
Remove intake filter housing, left	13 71 010
Remove intake filter housing, right	13 71 020
 To fit the spring strut support bearing:	
Remove front left and right spring struts	31 31 031

3. Installing suspension brace

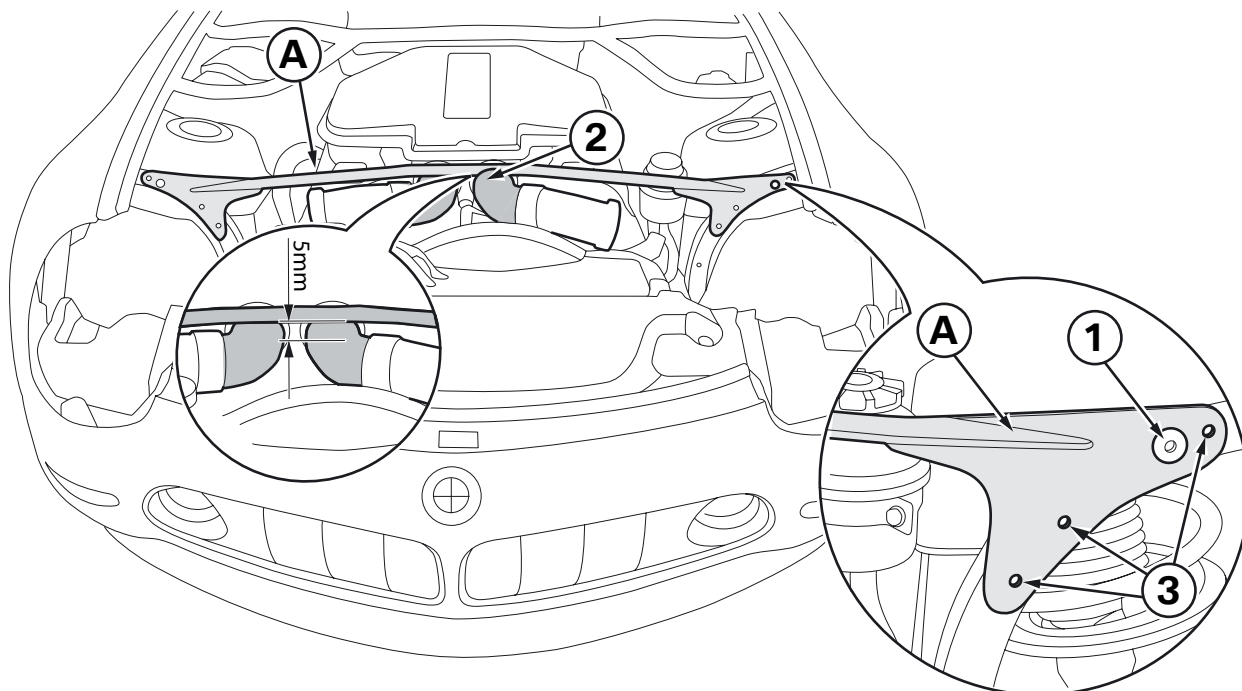

052 0002 V

To fit suspension brace:

- Insert and centralise suspension brace **A** as illustrated above.
- Align the ends of the suspension brace **A** concentrically to the mounting of the intake filter housings (1).

 To ensure that suspension brace **A** is correctly positioned, a gap of 5 mm must be maintained between suspension brace **A** and the air intake hoses (2). ◀

- Mark the positions of the six holes (3) in suspension brace **A** with a pencil to act as drilling marks.
- Remove suspension brace **A**, centre punch at the marked points, drill holes with 11 mm diameter, debur and treat with BMW's standard anti-corrosion agent.
- Insert blind rivet nuts **B** with the riveting tongs.

 Now change the spring strut support bearing as per TIS no. 31 33 001 ◀ (see section 4)

- Insert the intake filter housings, but do not secure them. The suspension brace can otherwise not be secured.
- Insert suspension brace **A** and screw on with torx screws **C**. The tightening torque is 20 Nm. The tightening sequence is:
 - first the two middle crews
 - then the two outer screws
 - then the two inner screws.
- Install the intake filter housings as per TIS no. 13 71 040 and TIS no. 13 71 20.

4. Installing spring strut support bearing

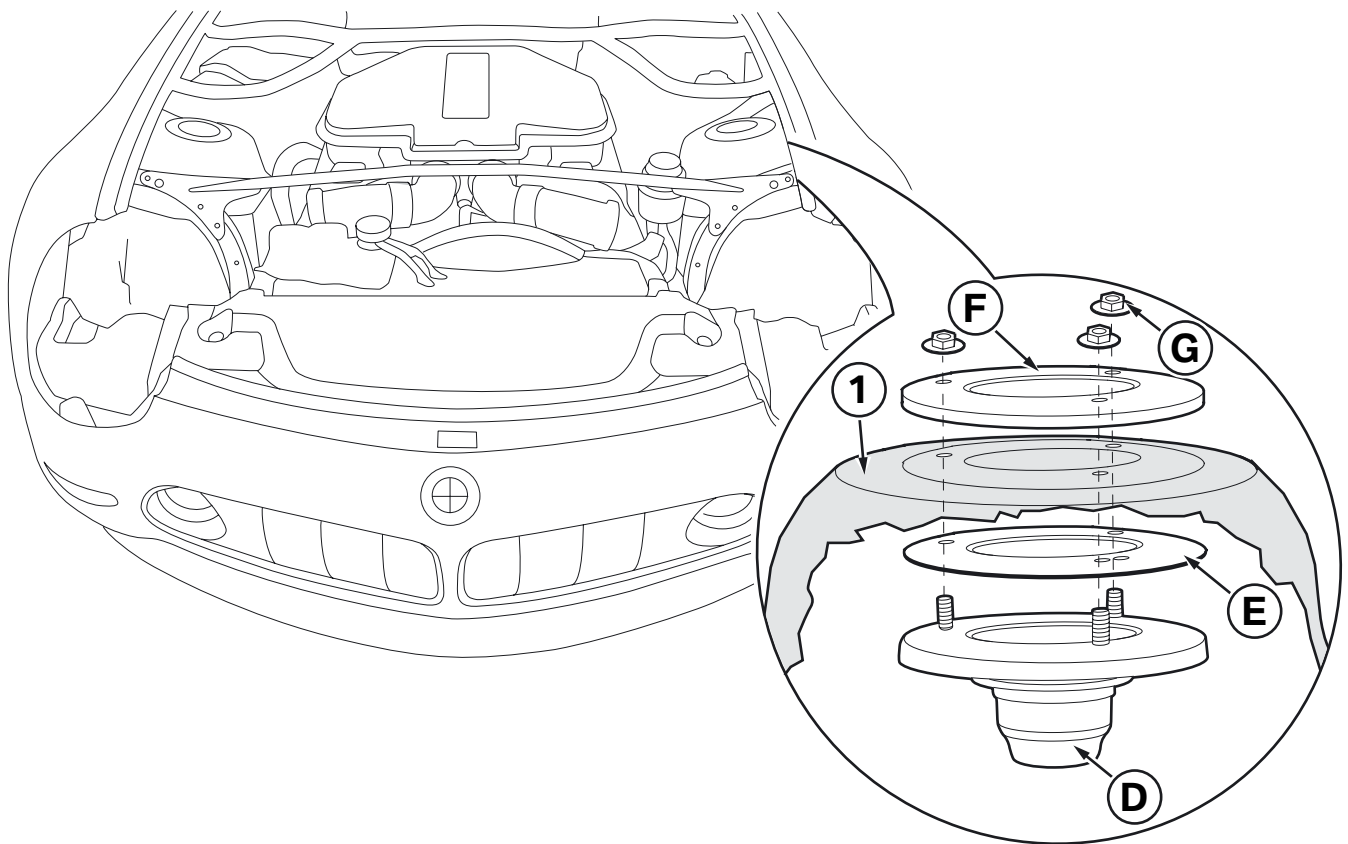

052 0003 V

To fit the spring strut support bearing:

Fit spring strut support bearings **D** as per TIS no. 31 33 001.

- The sealing rings **E** must be inserted between the spring strut support bearing **D** and the domes (1),
- The reinforcement rings **F** must also be fitted on the dome bearing,
- The original nuts must be replaced with collar nuts **G**.

 Now continue with section 3 "Fitting suspension brace". ◀

5. Concluding work and coding

The retrofit system does not require encoding.

- Reassemble vehicle
- Reconnect vehicle battery
- Perform quick test