

THE FOLLOWING ITEMS ARE NOT PERMITTED WITHIN THE VENUE

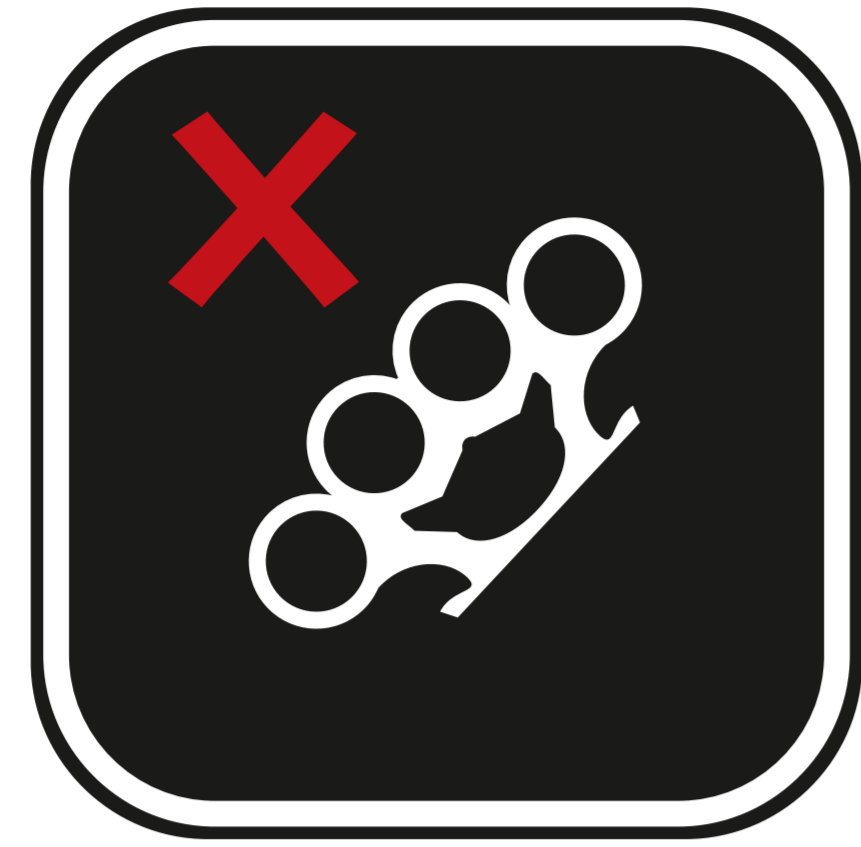

FIREARMS AND / OR AMMUNITION



REPLICA WEAPONS OR BLUNT OFFENSIVE WEAPONS OF ANY KIND



FIREWORKS, FLARES, FIRECRACKERS, EXPLOSIVES



CHEMICALS, INCENDIARY DEVICES



KNIVES



NEEDLES (SAVE FOR MEDICAL REASONS)

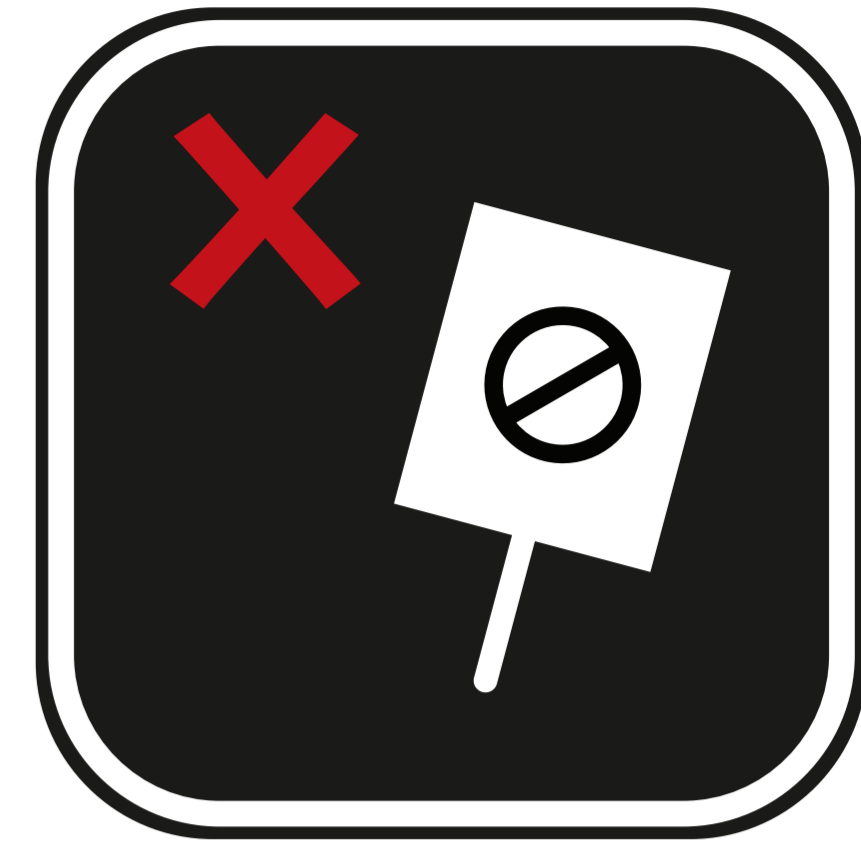

ITEMS INCLUDE ADHESIVES, T-SHIRTS OR COLOURED POWDERS



ANY RECEPTACLE LARGER THAN 1 LITRE / 1000ML / 33.814 FL OZ



ALCOHOLIC BEVERAGES



FOOD (EXCEPT FOR PERSONAL CONSUMPTION)



GLASS BOTTLES, CONTAINERS OR OTHER BLUNT OBJECTS



NON-CONSUMABLE LIQUIDS IN CONTAINERS OF GREATER THAN 100ML



DRONES/UNMANNED AERIALS VEHICLE'S



NOISE MAKERS, HORNS, HELIUM BALLOONS, INFLATABLES (BEACH BALLS, ETC.)



MOTORCYCLES, SCOOTER, BICYCLES, ROLLER SKATES

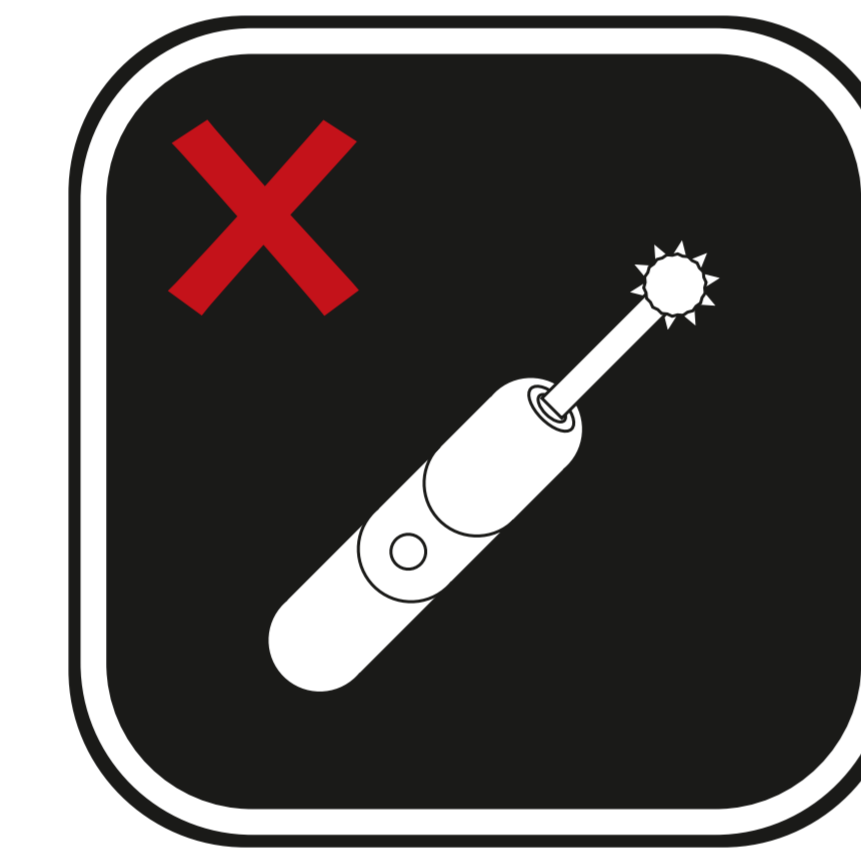

LASER POINTERS, ELECTRONIC TRANSMITTING EQUIPMENT



LARGE OBJECTS WHICH CANNOT BE STORED UNDER A SEAT SAFELY



LARGE PHOTOGRAPHY EQUIPMENT (E.G. TRIPODS)



CONTROLLED SUBSTANCES



BAGS OR RUCKSACKS LARGER THAN A3 (SIZE EQUIVALENT IS: 297 X 420MM/ 11.7 X 16.5 INCHES)



POLES, FLAGPOLES, STICKS LARGER THAN 40MM IN LENGTH. ANY INFLAMMATORY FLAG WILL BE PROHIBITED AS WILL FLAGS LARGER THAN A1 SIZE (594 X 841MM / 23.4 X 33.1 INCHES).

ABB FIA FORMULA E WORLD CHAMPIONSHIP - CONDITIONS OF VENUE ENTRY

1.1 By entering the Venue, you consent to be bound by the following conditions of venue entry. Permission to enter or remain within the Venue (notwithstanding the possession of any ticket or accreditation) is at the absolute discretion of Formula E.

1.2 Safety and Security:

At the point of entry and whilst inside the Venue, you are required to:

- 1.2.1 Comply, at all times, with directions from appointed security or from Formula E staff, including compliance with any security searches;
- 1.2.2 Be responsible for all personal items (Formula E will not be responsible for any damage to, loss or theft of a patron's personal property);
- 1.2.3 Any person who rejects or refuses to comply with a security search, rules and security notices published by Formula E, or who constitutes a source of danger, nuisance or annoyance to any other person, will be refused entry or be required immediately to leave the Venue without refund to the Ticket Holder or Purchaser;
- 1.2.4 Remain responsible for any minors under your charge. A minor is an individual under the age of 16 years;
- 1.3 By entering the Venue, you acknowledge that you do so at your own risk and assume all risk and liability for personal injury and death including that of any minors under your charge. Formula E shall bear, no liability, to the fullest extent permitted by law, for any personal injuries, health problems or death sustained at or after an Event, including directly or indirectly resulting from any existing medical condition.

1.4 Forbidden Behaviour:

Formula E reserves the right to refuse entry or to remove any person from the Venue. This includes, but is not limited to the following circumstances:

- 1.4.1 No ticket or accreditation, or damaged, defaced, forged or copied ticket or accreditation;
 - 1.4.2 Any activity / behaviour related to marketing or advertising (including, for the avoidance of doubt, individual or group ambush marketing), sale of goods by unauthorised individual, unauthorised ticket sales;
 - 1.4.3 Behaviour that creates a dangerous situation, puts at risk an individual's personal security, is against public order, interferes in any way with the orderly execution of an Event or disrupts the enjoyment of an Event;
 - 1.4.4 The presence of the person would be detrimental to, or compromise, safety and enjoyment of others within the Venue - including behaviour deemed disorderly and / or intoxicated behaviour;
 - 1.4.5 Entry to the Venue or specific accredited / non-public area if unauthorised or obtained illegally;
 - 1.4.6 A person is found smoking (including e-cigarettes) within the Venue, unless within a dedicated smoking area;
 - 1.4.7 Failure to provide valid and correct age identification when requested in relation to alcohol sales;
- All to be decided at the absolute discretion of Formula E.

1.5 Prohibited Items:

Any person who is found to be in possession of any of the prohibited items below will be requested to relinquish the item, have the items seized, and/or may be removed from the Venue. Dependent upon the nature of the item, the individual may be subject to arrest and/or prosecution by the relevant authorities, where applicable:

- 1.5.1 Weapons, replica weapons or item resembling weapons - including, but not limited to, knives, firearms, blunt offensive objects / batons and those with sharp ends. Ammunition, replica ammunition or any item resembling ammunition;
- 1.5.2 Glass bottles or other blunt instruments;
- 1.5.3 Explosives, chemicals or incendiary devices;

- 1.5.4 Fireworks, flares, firecrackers;
- 1.5.5 Any receptacle larger than 1 litre / 1000ml / 33.814 fl oz;
- 1.5.6 Alcoholic beverages not purchased inside the Venue;
- 1.5.7 Non-consumable liquids in containers of greater than 100ml/338.14 fl oz in size;
- 1.5.8 Illegal substances, including illicit drugs and needles (save as required for valid medical reasons);
- 1.5.9 Poles, flagpoles, sticks larger than 40mm in length. Any inflammatory flag will be prohibited as will flags larger than A1 size (594 x 841mm / 23.4 x 33.1 inches).
- 1.5.10 Drones or unmanned aerial devices;
- 1.5.11 Motorcycles, bicycles, rollerblades, scooters and skateboards;
- 1.5.12 Electronic transmitting equipment or lasers pointers;
- 1.5.13 Bags or rucksacks larger than A3 (size equivalent is: 297 x 420mm/11.7 x 16.5 inches);
- 1.5.14 Materials, objects or articles of political, ideological, philosophical or religious nature, that promotes the same, including, but not limited to, documents, flyers, banners, badges, insignia;
- 1.5.15 Any other item or material that Formula E deems dangerous, is used for ambush marketing, a safety risk or that may cause injury, damage, distress or disruption to an Event, other patrons and/or personnel;
- 1.5.16 Food (except for personal consumption);
- 1.5.17 Coolers of any size, including soft-sided coolers;
- 1.5.18 Skateboards, scooters or other types of skates.

1.6 Restricted Items:

The following items may be brought into the Venue but are not permitted to be used / brought into certain areas / raised up / displayed for the safety and comfort of others:

- 1.6.1 Umbrellas and flags (See 1.5.9 for reference);
- 1.6.2 Strollers are subject to security search as per all other items. Strollers are not permitted within Grandstands or dedicated seating structures / viewing platforms. Items must be checked into the official cloakroom at N4;
- 1.6.3 All Guide and Assistance Dogs will be permitted into the ExCeL London. Visitors may be challenged if the status of the animal is visibly unclear.

1.7 Photographs, Images and Recording Notice:

- 1.7.1 Persons consent to being photographed, filmed or taped, by Formula E and/or by third parties appointed and/or authorised by Formula E;
- 1.7.2 Non-commercial photography is permitted at the Venue provided that the photographs are for personal use;
- 1.7.3 The use of any recording, data or image taken within the Venue without Formula E's consent for commercial gain, public advertisement, display or any other purpose, except for private non-commercial purpose, is prohibited.