



PROSOCO®

# R•Guard®

AIR & WATER BARRIERS

You. Us. The project.

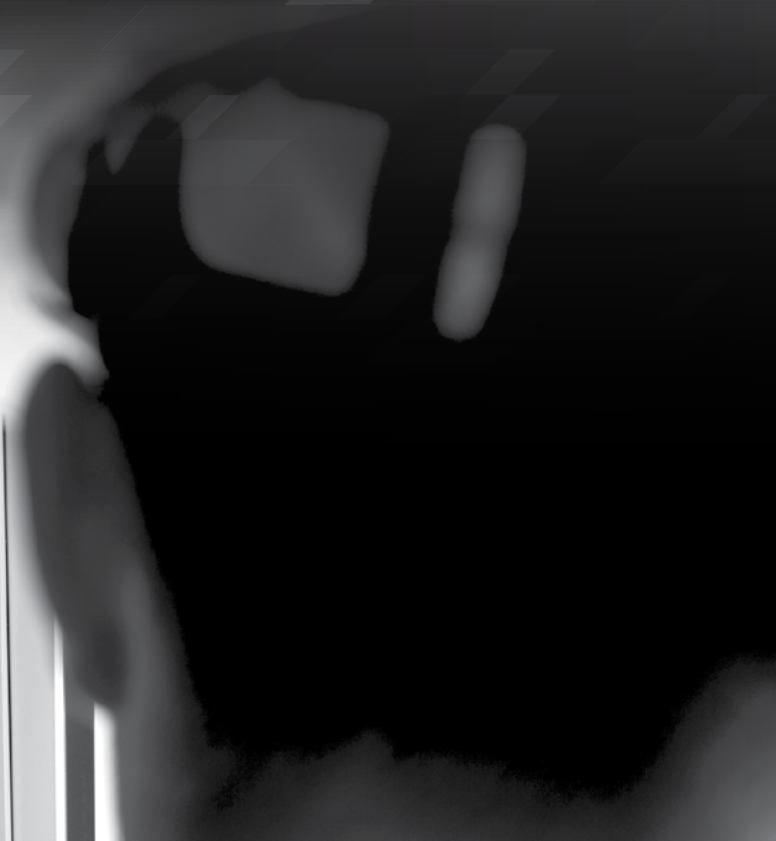

use these links to learn more about PROSOCO



About us



Our website



Email us

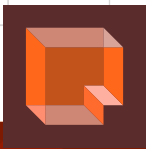

PROSOCO®

# Changing an industry

- Controlling the leakage of air and water is fundamental to designing an energy efficient building
- PROSOCO introduced R-Guard fluid applied products to solve problems & failures with existing techniques
- R-Guard's effectiveness and easy application has driven industry acceptance of fluid applied technology
- Performance tested and proven to withstand code-required AND extreme weather conditions. R-Guard protected buildings are more durable, resilient and sustainable.
- Our understanding of building science, and our contribution to industry sustainability standards make R-Guard stand out among fluid applied manufacturers - *we challenge you to find a more effective and sustainable air and water barrier.*



PROSOCO

## R-Guard®

AIR & WATER BARRIERS

You. Us. The project.

# The R-Guard difference

## Effective

### Responsible Technology

Compared with other fluid applied manufacturers R-Guard STPEs are higher solids and produce a more durable membrane. Solvent free, phthalate free and Red-List compliant, R-Guard STPE air and water barrier products help satisfy the most stringent green standards set forth by the industry's leading organizations such as the International Living Future Institute, U.S. Green Building Council and Passive House.

### Thick where it counts

Many manufacturers claim superior performance from thick mil air barrier membranes applied to the entire wall. R-Guard relies on a logical sequence of fully compatible joint detailing, liquid flashing and primary air barrier membranes seamlessly layered at sheathing joints and through-wall penetrations. This provides thick protection where needed while reducing labor and equipment costs over the rest of the project.

## Tested

**6.0** ACH50



Federal Energy Star requirement \*

An air-tight building is an energy efficient building. **R-Guard** air & water barrier systems stop air leakage through the building envelope **14 times better** than the industry standard.

**0.42** ACH50

R-Guard Fast Flash \*\*

AIR LEAKAGE BLOWER DOOR TEST

ACH50 - Air Change per Hour at 50 Pascals

\* Dependent upon climate zone \*\* Test conducted on Karuna Passive House- Yamhill County, Or



# Apply rain or shine

R-Guard's STPE (Silyl Terminated Polyether) products can be applied to damp substrates and rained on immediately. Not all "polyether" products can do this. It takes rain out of the construction schedule.



# Solutions for Every Project

R-Guard offers a complete air and water barrier system

**Rough Opening & Transition** - Seals the rough opening before the installation of windows & doors and other transitions.

**Primary Wall Barrier** - Stop air and water from getting into the structural wall. Available in a variety of vapor permeable options to meet your building's needs.

**Air Tightening** - Seals windows and doors to the rough opening in new construction and retrofits.

## Easy to use

- Seamless transitions save time and money
- Install windows and doors same day
- Durable- won't rip, tear, dissolve or delaminate
- Low odor, color coded, opaque at target thickness
- Vapor permeable – allows underlying materials to dry
- Stands up to UV exposure for up to 12 months<sup>±</sup>

± Applies to the R-Guard STPE products only

## Recognized

Buildings that meet the world's toughest energy efficiency requirements use R-Guard. The Bullitt Center is considered the world's greenest commercial building.



Bullitt Center, Seattle

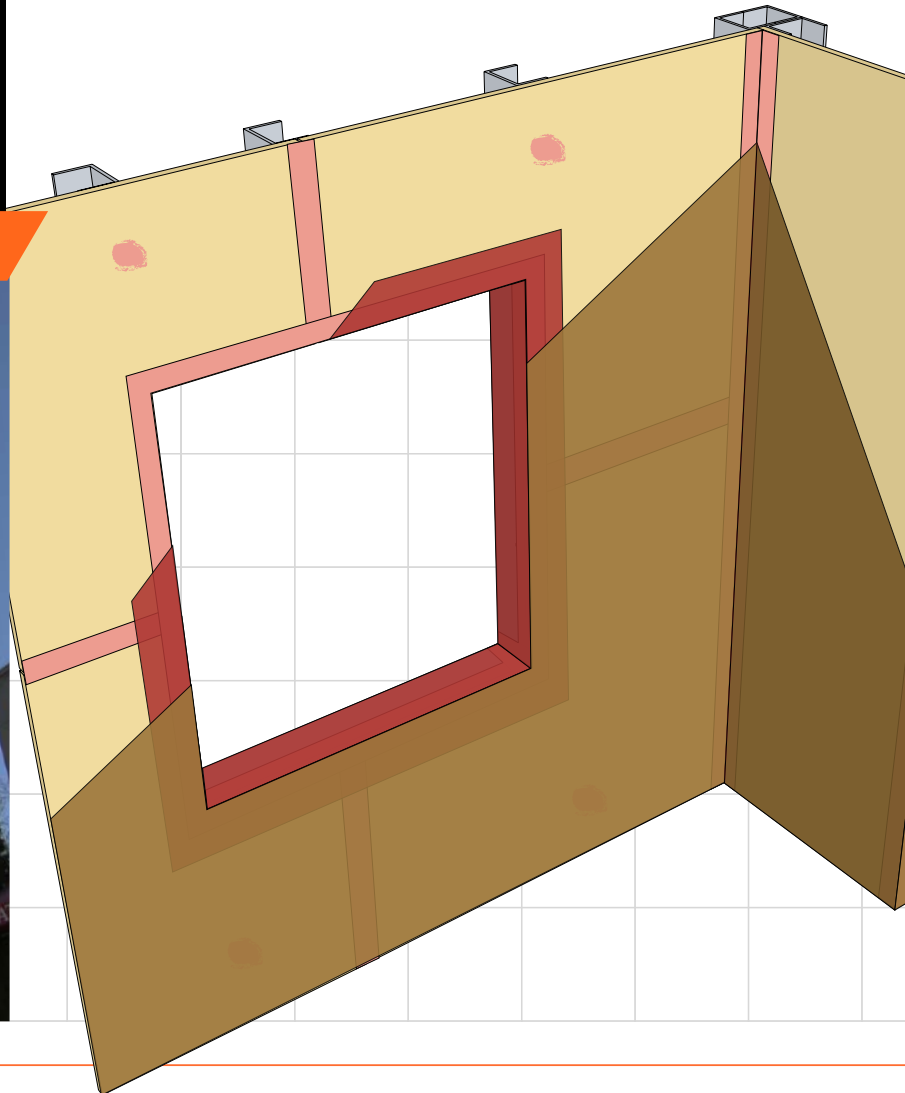

# Sustainable products for more durable buildings

R-Guard STPE products help satisfy the highest green standards established by organizations such as the International Living Future Institute, Passive House and U.S. Green Building Council requirements in contemporary design and construction. It's all part of our broader mission to minimize impact on the natural environment. Many R-Guard products are third party certified for indoor air quality performance. We also partner with leaders in product transparency to provide disclosure of product content and associated health information.



**PROSOCO**

## In the trenches with you



Our dedicated sales, customer care and technical field reps are there when you need them. Our technical reps can be on-site for guidance on a difficult detail, training your crew, or helping on a difficult project.



**PROSOCO®**

# Air and water barriers



About us



Email us your questions



Search our website



**PROSOCO**

3741 Greenway Circle • Lawrence, KS 66046  
800 255 4255