

(12) STANDARD PATENT
(19) AUSTRALIAN PATENT OFFICE

(11) Application No. **AU 2020204344 B2**

(54) Title
Flow sensor system including spring contacts

(51) International Patent Classification(s)
A61M 5/168 (2006.01) **G01F 1/66** (2006.01)
A61M 5/172 (2006.01) **G05D 7/00** (2006.01)

(21) Application No: **2020204344** (22) Date of Filing: **2020.06.29**

(43) Publication Date: **2020.07.16**

(43) Publication Journal Date: **2020.07.16**

(44) Accepted Journal Date: **2022.04.14**

(62) Divisional of:
2018267666

(71) Applicant(s)
CRISI Medical Systems, Inc.

(72) Inventor(s)
Dekalb, Shawn Wayne;Raptis, Mark

(74) Agent / Attorney
FB Rice Pty Ltd, Level 23, 44 Market Street, Sydney, NSW, 2000, AU

(56) Related Art
US 2013/0177455 A1
WO 2014/016315 A1
WO 2011/075706 A1
US 2015/0204705 A1

ABSTRACT

A flow sensor sub-assembly for sensing flow of a fluidic medicament is disclosed. The flow sensor sub-assembly includes a first spring contact and a second spring contact. The spring contacts are secured to a base that has a circuit for conducting an electrical signal to and from the spring contacts to a microprocessor. The first spring contact is in electrical communication with a first piezo element and the second spring contact is in electrical communication with a second piezo element. The first spring contact has a first contact force against the first piezo element and the second spring contact has a second contact force against the second piezo element, and the first and second contact forces are equivalent. A circuit board for interfacing to a flow sensor having a plurality of piezo elements for transmitting a flow signal indicative of flow of fluidic medicament is also disclosed.

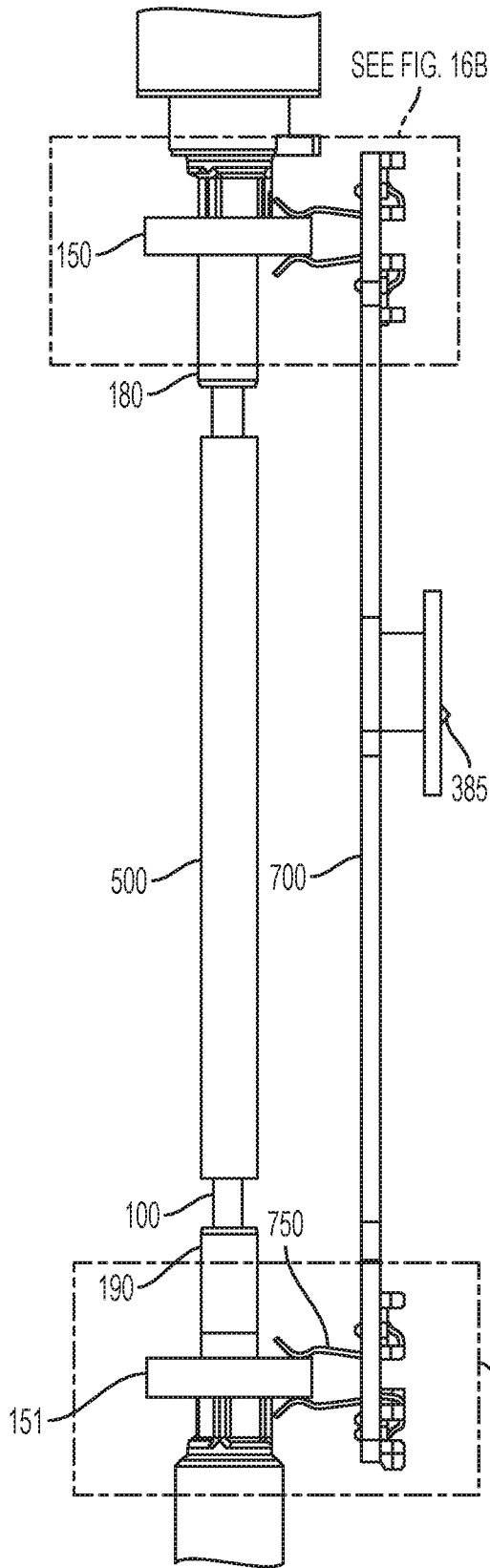

FIG. 16A

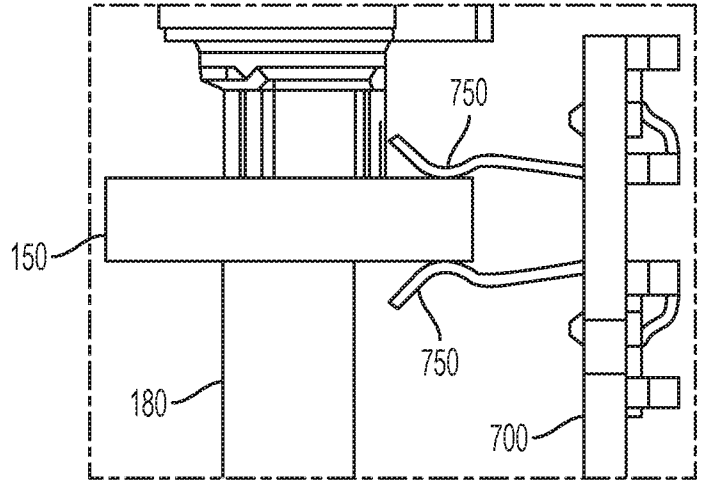

FIG. 16B

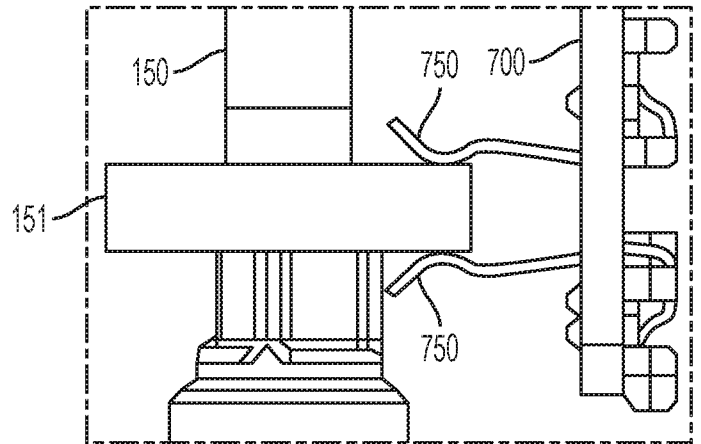

FIG. 16C

2020204344 31 Mar 2022

FLOW SENSOR SYSTEM INCLUDING SPRING CONTACTS

CROSS REFERENCE TO RELATED APPLICATIONS

[0001] This application is a divisional application of Australian patent application no. 2018267666 which is a divisional of 2016316751 which is the national phase application of PCT/US2016/048708 which claims the benefit of U.S. Provisional Patent Application 62/211,116, filed August 28, 2015, the disclosure of each of which is incorporated herein by reference in their entirety.

Background of the invention

Field of the Disclosure

[0002] The present disclosure relates generally to a flow sensor system. More particularly, the present disclosure relates to a flow sensor system for providing intravenous bolus injections of medication to a patient which provides healthcare professionals with an automated record of medication, concentration, volume, dose, and time of each injection. Preferably, the system has an ultrasonic flow sensor.

Description of the Related Art

[0003] There is a need to reduce medication error at bedside during bolus delivery. It would be advantageous to provide a record of, and electronically measure, bolus delivery which allows monitoring bolus delivery and automatic documentation of bolus delivery as part of a patient's health record. Additionally, it would be advantageous to provide alerts when bolus delivery inconsistent with a patient's medical record is about to occur.

[0003A] Any discussion of documents, acts, materials, devices, articles or the like which has been included in the present specification is not to be taken as an admission that any or all of these matters form part of the prior art base or were common general knowledge in the field relevant to the present disclosure as it existed before the priority date of each of the appended claims.

Summary of the invention

[0003B] Throughout this specification the word "comprise", or variations such as "comprises" or "comprising", will be understood to imply the inclusion of a stated element, integer or step, or group of elements, integers or steps, but not the exclusion of any other element, integer or step, or group of elements, integers or steps.

[0003C] An embodiment of the present disclosure provides a flow sensor system comprising: a flow sensor for sensing flow of a fluidic medicament; and a reusable base including a rechargeable battery, wherein the flow sensor is configured to be removably connected to the reusable base, and

wherein the reusable base comprises a plurality of contacts configured to electrically engage corresponding electrically active portions of the flow sensor and corresponding electrically active portions of a charger configured to recharge the rechargeable battery in the reusable base.

[0004] In accordance with another embodiment of the present disclosure, there is provided a system for sensing flow of a fluidic medicament. The system includes an intelligent injection port which may attach to an injection site (such as a “Y Site” or a stop cock) for manually administered IV injections. The system includes two main sub-assemblies: a single-use flow sensor and a reusable base unit, which fit together prior to use.

The flow sensor sub-assembly includes a first spring contact and a second spring contact. In one embodiment, the spring contacts are secured to a base having a circuit for relaying an electrical signal to a microprocessor. The first spring contact is in electrical communication with a first piezo element and the second spring contact is in electrical communication with a second piezo element. The first spring contact has a first contact force against the first piezo element and the second spring contact has a second contact force with the second piezo element, and the first contact force is equivalent to the second contact force.

The present disclosure also provides a circuit board for interfacing to a flow sensor having a plurality of piezo elements for transmitting a flow signal indicative of flow of a fluidic medicament.

[0006] In accordance with an embodiment of the present invention, a flow sensor sub-assembly for sensing flow of a fluidic medicament includes: a flow tube having a flow tube inlet and a flow tube outlet, through which said medicament flows. The flow sensor sub-assembly also includes a first piezo element arranged at an upstream position of the flow tube and a second piezo element arranged at a downstream position of the flow tube, with the first piezo element and the second piezo element mounted a pre-selected distance apart from each other. The flow sensor sub-assembly also includes a first spring contact, and a second spring contact, wherein each of said spring contacts are secured to a base, wherein the base has a circuit for conducting an electrical signal to and from the spring contacts to a microprocessor, and the first spring contact is in electrical communication with the first piezo element and the second spring contact is in electrical communication with the second piezo element. The first spring contact has a first contact force against the first piezo element and the second spring contact has a second contact force against the second piezo element, and the first contact force is equivalent to the second contact force.

[0007] In one configuration, the flow tube further includes an inner flow tube and end fittings for securing the inner flow tube to the end fittings, and the first and second piezo elements are mounted to the end fittings. In another configuration, said first spring contact includes a pair of cantilevered leaf springs, with the second spring contact including a pair of cantilevered leaf springs. In yet another configuration, said circuit is provided on a front and rear surface of a PCB board and the first and second spring contacts are resiliently urged against the first and second piezo elements, respectively, when the first and second piezo elements are inserted between each of said pair of cantilevered leaf springs. In one configuration, the circuit is formed integrally with a flow sensor housing by injection molding. In another configuration, the first piezo element and the second piezo element are annular in shape and encircle the flow tube at each respective mounting point.

[0008] In yet another configuration, the flow sensor sub-assembly is contained within a flow sensor housing, wherein the flow sensor housing is coupled to a flow sensor base which contains the microprocessor and the circuit includes connecting pins for providing the electrical signal from the flow sensor sub-assembly to the microprocessor within the flow sensor base. In one configuration, the flow sensor sub-assembly is disposed of after the flow sensor sub-

assembly is used to sense the flow of at least one fluidic medicament. In another configuration, the flow sensor base is usable with a different flow sensor sub-assembly.

[0009] In accordance with another embodiment of the present invention, a circuit board for interfacing to a flow sensor having a plurality of piezo elements for transmitting a flow signal indicative of flow of a fluidic medicament includes: a base having a plurality of electrical circuit traces having a first end and a second end, a first pair of spring contacts for biasing against an electrical interface with a first piezo element, the first pair of spring contacts are mounted to the first end of the base and in electrical communication with at least one electrical circuit trace. The circuit board further includes a second pair of spring contacts for bias and electrical interface with a second piezo element, the second pair of spring contacts are mounted to the second end of the base and in electrical communication with at least one electrical circuit trace, and a plurality of pins in electrical contact with the plurality of electrical circuit traces. Each of the spring contacts are pre-configured such that the bias against the first piezo element and the bias against the second piezo element are equivalent and the electrical circuit traces are configured such that each of the pins are in electrical communication with a single spring contact.

[0010] In one configuration, each pair of spring contacts includes a pair of cantilevered leaf springs mounted to the base. In another configuration, the electrical circuit traces are provided on a front surface of the base and the spring contacts extend from a rear surface of the base. In yet another configuration, the circuit board is formed integrally with a flow sensor housing by injection molding. In one configuration, each of the cantilevered leaf springs further includes a mound-like protrusion which contacts a surface of the piezo elements. In another configuration, the circuit board is assembled into a flow sensor housing in at least two orientations and provides transmission of the flow signal from the piezo elements to a microprocessor. In yet another configuration, the circuit board is disposed of after the flow sensor is used to sense the flow of at least one fluidic medicament. In one configuration, after the flow sensor is used to sense the flow of at least one fluidic medicament, the circuit board is usable with a different flow sensor.

[0011] In another configuration, the first spring contact includes a pair of opposed cantilevered leaf springs engaging a forward contact point on the first piezo element and an aft or downstream contact point on the first piezo element. The second spring contact includes a pair of opposed cantilevered leaf springs engaging a forward contact point on the second piezo element and an aft or downstream contact point on the second piezo element. In yet another configuration, the first spring contact includes a bifurcated cantilevered leaf spring engaging

the first piezo element, and the second spring contact includes a bifurcated cantilevered leaf spring engaging the second piezo element.

BRIEF DESCRIPTION OF THE DRAWINGS

[0012] The above-mentioned and other features and advantages of this disclosure, and the manner of attaining them, will become more apparent and the disclosure itself will be better understood by reference to the following descriptions of embodiments of the disclosure taken in conjunction with the accompanying drawings, wherein:

[0013] **Fig. 1** is a distally-directed perspective view of a flow sensor system in accordance with an embodiment of the present invention.

[0014] **Fig. 2** is a proximally-directed perspective view of a flow sensor system in accordance with an embodiment of the present invention.

[0015] **Fig. 3A** is a proximal elevation view of a flow sensor system in accordance with an embodiment of the present invention.

[0016] **Fig. 3B** is a distal elevation view of a flow sensor system in accordance with an embodiment of the present invention.

[0017] **Fig. 4A** is a side elevation view of a flow sensor system in accordance with an embodiment of the present invention.

[0018] **Fig. 4B** is an enlarged detail view of a portion of **Fig. 4A** as illustrated by Detail A.

[0019] **Fig. 5A** is a perspective view of a base of a flow sensor system in accordance with an embodiment of the present invention.

[0020] **Fig. 5B** is a perspective view of the base of **FIG. 5A** illustrating the optical and electrical components.

[0021] **Fig. 6** is a perspective view of a flow sensor of a flow sensor system in accordance with an embodiment of the present invention.

[0022] **Fig. 7** is another perspective view of a flow sensor of a flow sensor system in accordance with an embodiment of the present invention.

[0023] **Fig. 8** is an exploded, perspective view of a flow sensor of a flow sensor system in accordance with an embodiment of the present invention.

[0024] **Fig. 9** is a perspective view of a flow sensor of a flow sensor system in accordance with an embodiment of the present invention.

[0025] **Fig. 10A** is a side elevation view of a syringe compatible with a flow sensor system in accordance with an embodiment of the present invention.

[0026] **Fig. 10B** is an enlarged detail view of a portion of **Fig. 10A** as illustrated by Detail B.

[0027] **Fig. 10C** is a side elevation view of a tip label for a syringe compatible with a flow sensor system in accordance with an embodiment of the present invention.

[0028] **Fig. 11A** is a perspective view of a charger for a flow sensor system in accordance with an embodiment of the present invention.

[0029] **Fig. 11B** is an enlarged detail view of a portion of **Fig. 11A** rotated at a clockwise angle as illustrated by Detail C.

[0030] **Fig. 11C** is a top elevation view of a charger for a flow sensor system in accordance with an embodiment of the present invention.

[0031] **Fig. 11D** is a cross-sectional view taken along line **X-X** of **Fig. 11C**, with a base of a flow sensor system received within a portion of the charger, in accordance with an embodiment of the present invention.

[0032] **Fig. 12** is a perspective view of a flow sensor and a mount in accordance with an embodiment of the present invention.

[0033] **Fig. 13** is a perspective view of a flow tube sub-assembly in accordance with an embodiment of the present invention.

[0034] **Fig. 14A** is a schematic representation of a computer display in an anesthesia view in accordance with an embodiment of the present invention.

[0035] **Fig. 14B** is a schematic representation of a computer display in a tabular view in accordance with an embodiment of the present invention.

[0036] **Fig. 15** is a perspective view of a circuit board in accordance with an embodiment of the present invention.

[0037] **Fig. 16A** is an assembled view of a flow tube sub-assembly and a circuit board, with spring contacts engaged with and in electrical communication with respective piezo elements, in accordance with an embodiment of the present invention.

[0038] **Fig. 16B** is an enlarged detail view of a first portion of **Fig. 16A** as illustrated by Detail D.

[0039] **Fig. 16C** is an enlarged detail view of a second portion of **Fig. 16A** as illustrated by Detail E.

[0040] **Fig. 17** is a perspective view of a spring contact in accordance with an embodiment of the present invention.

[0041] **Fig. 18** is a perspective view of a contact area of a spring contact in accordance with an embodiment of the present invention.

[0042] Fig. 19A is a first partial elevation view of a portion of a flow tube sub-assembly and a circuit board, with a spring contact engaged with and in electrical communication with a piezo element, in accordance with an embodiment of the present invention.

[0043] Fig. 19B is a second partial perspective view of a portion of a flow tube sub-assembly and a circuit board, with a bifurcated spring contact engaged with and in electrical communication with a piezo element, in accordance with an embodiment of the present invention.

[0044] Fig. 20 is an elevation view of a flow tube sub-assembly in accordance with an embodiment of the present invention.

[0045] Fig. 21 is a perspective view of a circuit board with spring contacts in accordance with an embodiment of the present invention.

[0046] Fig. 22A is an assembled view of a portion of a flow tube sub-assembly and a circuit board, with a spring contact engaged with and in electrical communication with a piezo element, in accordance with an embodiment of the present invention.

[0047] Fig. 22B is a perspective view of a spring contact mount to a circuit board in accordance with an embodiment of the present invention.

[0048] Corresponding reference characters indicate corresponding parts throughout the several views. The exemplifications set out herein illustrate exemplary embodiments of the disclosure, and such exemplifications are not to be construed as limiting the scope of the disclosure in any manner.

DETAILED DESCRIPTION

[0049] The following description is provided to enable those skilled in the art to make and use the described embodiments contemplated for carrying out the invention. Various modifications, equivalents, variations, and alternatives, however, will remain readily apparent to those skilled in the art. Any and all such modifications, variations, equivalents, and alternatives are intended to fall within the spirit and scope of the present invention.

[0050] For purposes of the description hereinafter, the terms “upper”, “lower”, “right”, “left”, “vertical”, “horizontal”, “top”, “bottom”, “lateral”, “longitudinal”, and derivatives thereof shall relate to the invention as it is oriented in the drawing figures. However, it is to be understood that the invention may assume various alternative variations, except where expressly specified to the contrary. It is also to be understood that the specific devices illustrated in the attached drawings, and described in the following specification, are simply

exemplary embodiments of the invention. Hence, specific dimensions and other physical characteristics related to the embodiments disclosed herein are not to be considered as limiting.

[0051] As used herein, proximal shall refer to a part or direction located away or furthest from a patient (upstream), while distal shall refer to a part or direction towards or located nearest to a patient (downstream). Also, a drug substance is used herein in an illustrative, non-limiting manner to refer to any substance injectable into the body of a patient for any purpose. Reference to a patient may be to any being, human or animal. Reference to a clinician may be to any person or thing giving treatment, e.g., a nurse, doctor, machine intelligence, caregiver, or even self-treatment.

[0052] Figs. 1-12 illustrate an exemplary embodiment of a flow sensor system 200 of the present disclosure. Referring to Figs. 1-12, a flow sensor system 200 of the present disclosure includes two main assemblies which fit together prior to use: a flow sensor 210 and a base 220. In one embodiment, the flow sensor 210 can be a single-use flow sensor which is engageable with reusable base 220. The flow sensor system 200 is an intelligent injection port. The flow sensor system 200 is attachable to an injection site (“Y Site” or stop cock, for example) for manually administered IV injections.

[0053] The flow sensor system 200 of the present disclosure can reduce medication error at bedside during bolus delivery. The flow sensor system 200 of the present disclosure can also provide a record of and electronically measure bolus delivery, which allows monitoring bolus delivery and automatic documentation of bolus delivery as part of a patient’s health record. The flow sensor system 200 of the present disclosure can also provide alerts when bolus delivery inconsistent with a patient’s medical record is about to occur.

[0054] Referring to Figs. 1-5B, in one embodiment, the base 220 is a non-sterile, reusable device that houses a battery, a scanner (either optical, mechanical, inductive, capacitive, proximity, or RFID), electronics, and wireless transmitter. In some embodiments, the base 220 is battery powered, and rechargeable. In some embodiments, each base 220 has a unique serial number imprinted on a surface of the base 220 or embedded therein that may be transmitted to a data system before use. The data system can be a local computer or tablet “Computer”, a cellular phone, another medical device, or a Hospital Data System.

[0055] In one embodiment, the base 220 is removably connectable to the flow sensor 210. Referring to Figs. 5A and 6-9, the base member 220 and the mechanical connection of the flow sensor 210 to the base member 220 is described. The base member 220 includes at least one deflectable wing tab 280 defining an opening for receiving at least a portion of the flow sensor 210 therein and for securing the flow sensor 210 within a portion of the base 220 prior to use.

In one embodiment, a pair of wing tabs 280 secure the flow sensor 210 within the base 220. Optional gripping ribs 395 may be provided on an exterior profile for enabling a user to grasp the base portion 220.

[0056] An interior profile of the wing tab 280 may be provided with a catch 389 for corresponding engagement with a tab 189 provided on the flow sensor 210, as shown in Fig. 6, to restrain the flow sensor 210 within the base 220, as will be discussed further herein. The wing tabs 280 may be flexible to the extent that they may be outwardly deflected to allow for passage of the flow sensor 210 thereover. The interior of the wing tab 280 may be provided with a pin cam 388 which allows a pin 188 of the flow sensor 210, as shown in Fig. 7, to ride along such that the flow sensor 210 is moved proximally during assembly onto the base 220, to precisely align various optical and electrical components of the flow sensor 210 and the base member 220, as will be discussed further herein.

[0057] Referring to Figs. 5B and 6-9, the base member 220 and the electrical connection of flow sensor 210 to the base member 220 is described. The base 220 includes an activation/engagement button 350 which allows for an indication that the flow sensor 210 has been engaged with the base 220. In one embodiment, the activation/engagement button 350 signals to a microprocessor within the base 220 that a syringe has been properly engaged with the sensor 210 and its injection port 130.

[0058] The base 220 further includes a plurality of contacts 386 (Fig. 5B) for electrically engaging corresponding electrically active portions of the plurality of contact pins 385 (Fig. 7). A contour protrusion 488 surrounds at least a portion of the tongue 286. As shown in Fig. 7, a bottom surface of the sensor 200 includes a pin seal 384 surrounding a plurality of contact pins 385 to prevent contamination, thus minimizing electrical disruptions. In some embodiments the plurality of pins 385 comprise a four pin connector with two pins electrically connected to each piezo element 150, 151, as will be discussed further. In other embodiments, the plurality of pins 385 comprise a six pin connector with two pins electrically connected to each piezo element 150, 151 and two pins electrically connected to a battery (not shown) in the flow sensor 210.

[0059] The base member 220 further includes a tongue 286 surrounded by a shoulder 486 having a plurality of contacts 386 for electrically engaging corresponding electrically active portions of sensor 200 and a charger 900 (Fig. 11A), as will be discussed herein.

[0060] Referring to Figs. 1-4B, 6-9, and 13, in one embodiment, the flow sensor 210 is a pre-sterilized disposable having an injection port 130 and a distal tubing connection, such as a Luer tip 109.

[0061] The flow sensor 210 may include a flow tube sub-assembly 10 consisting of a flow tube 100 having an outlet end 101 and an inlet end 102. The outlet end 101 may be provided in fluid communication with an outlet tubing 110 having an outlet connection 105 including a Luer tip 109 which may be optionally covered by a Luer cap 108. In a preferred embodiment, the outlet connection 105 is a plastic connector with a Luer tip 109, however, any suitable method to inject the medicament into a patient is envisaged to be within an aspect of an embodiment of the invention. For example, it may be desirable to replace the outlet connection 105 and tubing 110 with a needle for direct injection/infusion into a patient. Furthermore, it may be desirable to integrate the base 220 into a medication pen or infusion device for the delivery of insulin.

[0062] The inlet end 102 may be coupled to the reservoir of a medication pen or infusion reservoir. The inlet end 102 of the flow tube 100 may be provided in fluid communication with an injection port 130, and may optionally include a connection such as a threaded Luer lock 131 which is engageable with a source of a fluid to be injected. A pierceable septum 139 may be provided with the injection port 130 for maintaining sterility prior to use.

[0063] In a preferred embodiment, the injection port 130 is a plastic container with a split septum 139, however, any suitable method to inject the medicament through a flow sensor inlet 180 to a patient is envisaged to be within an embodiment of the present invention. For example, it may be desirable to replace the injection port 130 for direct connection to a medicament delivery device. In addition, it may be desirable to integrate the flow sensor inlet 180 to accept a direct fluidic connection to a medication delivery device.

[0064] In one embodiment, the flow tube 100 is comprised of a medical grade stainless steel and is approximately 50mm long with a 1.0mm inner diameter and a 1.6mm outer diameter.

[0065] The flow sensor 210 also includes a first piezo element or upstream transducer 150 and a second piezo element or downstream transducer 151. The first piezo element 150 may be provided with an inlet fitting 180, as shown in Fig. 8, for coupling with the injection port 130. Similarly, the second piezo element 151 may be provided with an outlet fitting 190, for coupling with the outlet tubing 110.

[0066] The flow sensor 210 can be supplied in a sterile package for a single patient use. In one embodiment, labeling is printed on the individual sterile package. In one embodiment, each flow sensor 210 has a unique serial number imprinted on a portion of its surface. In some embodiments, there are electronics in the flow sensor 210 which retain a unique identifier. These identifiers are transmitted either automatically or manually to a data system during use and data collection. In one embodiment, at the inlet end 102 of a flow sensor 210 the injection

port 130 is a common needleless, Luer-Lok type. Typically, the inlet port or the injection port 130 is cleaned prior to giving an injection according to hospital policy. Additionally, flushing the flow sensor 210 with an IV fluid (e.g., normal saline syringe) is desirable before use. The injection port 130 on the flow sensor 210 typically supports up to 100 injections. In one embodiment, the flow sensor 210 has a male Luer-Lok connection, e.g., an outlet connection 105 having a luer tip 109, on a one-inch IV tubing pigtail at the outlet end 101. This male Luer-Lok connection may be attached to an IV line at a Y-site or IV manifold. Each flow sensor 210 has a unique serial number, however it may be desirable to only display a portion of the serial number on a portion of the exterior of the flow sensor 210. For example, the last 4 digits of the serial number may be imprinted on the surface next to its bar code. This human readable number is used to visually identify a flow sensor 210 within wireless range of communication of a computer. In some embodiments, the flow sensor 210 measures with an accuracy of $\pm 5\%$ for bolus volumes of 1.0 mL to 55 mL and $\pm 20\%$ for bolus volumes of 0.4 to 1.0 mL and has a dead-space volume of less than 0.3mL.

[0067] Referring to Figs. 11A-11D, in one embodiment, an optional separate charger 900 is compatible with the flow sensor system 200 and recharges a battery in the reusable base 220, if required, for reuse of the base 220. Referring to Figs. 11A-11D, in one embodiment, the charger 900 includes a charger base 905 having an opening 925 for receiving the base 220, the opening 925 having charging pins 950 which engage corresponding contacts 386 in the reusable base 220. The charger 900 may include a sloped floor 930 for allowing disinfection liquid to drain therefrom. The device may also include elevated feet 999 to assist in drainage.

[0068] Reusable bases are typically supplied non-sterile and require disinfection and charging before use. It is preferred to disinfect each base 220 before first use. Typical commercial hospital disinfectants include alcohol-based quaternary ammonium, e.g., Metrex Research Cavi Wipes. In some embodiments, the base 220 can be used up to 500 times. Preferably, a rechargeable lithium ion battery is used within the base 220 and is not removable from the base 220. It is envisaged that a fully-charged base 220 will accommodate an entire patient case. In some embodiments, each base 220 is identified by labeling on the bottom of the device. Optionally, bases 220 are provided in individual boxes and each box is in a case package. The charger 900 may also include a power indicator 995. In one embodiment, when the base 220 is connected to a charger 900, up to four green light bars will illuminate on the top. The number of solid green light bars indicates the level of charge. A green blinking light on the base 220 will indicate it is recharging. In some embodiments, a useful life indicator is employed when the base 220 is connected to a charger 900 by use of a red light that indicates

that the base 220 has exceeded its useful life. Optionally, on the Computer, an error message will display when a flow sensor system 200 whose useful life is completed is wirelessly connected to a tablet during patient setup. It would then be desirable to replace the base 220 with another and repeat the wireless connection to the Computer. Optionally, the flow sensor system 200 is provided in a mount which is an appliance that fits a standard Clarke socket to keep the flow sensor system 200 in place at the patient's bedside. Additionally, it may be desirable to clean and disinfect the charger 900 by using the procedure used for cleaning and disinfecting the base 220.

[0069] In one embodiment, the flow sensor system 200 supports injections using any Luer-lock type syringe. For example, referring to Figs. 10A-10C, the flow sensor system 200 is compatible with a syringe 800 that is labeled. In one embodiment, the syringe 800 includes scale markings 805, a distal tip 810, a luer tip 815, a proximal end 820, a flange 825, a tip label 850 having human readable indicia 852 and machine readable indicia 854, a barrel label 860 having human readable indicia 862, and a plunger 890.

[0070] The base 220 of the flow sensor system 200 includes optics and a digital camera disposed within or behind a first window 360 (Fig. 2) capable of reading the machine readable indicia 854 provided on a label 850 of an encoded syringe. The first window 360 may be precisely aligned with Luer lock threads 131 present on the flow sensor 210 when the flow sensor 210 is assembled with the base 220, thus aligning the machine readable indicia 854 present on the label 850 on the syringe 800 during an injection cycle and/or medication determination cycle. The base 220 may further include a second window 370 (Fig. 5A) having a light source for providing adequate lighting to the camera disposed within or behind window 360.

[0071] Additionally, the flow sensor system 200 is designed to work with encoded syringes that have a special barcode identifier on the Luer collar of the syringe, called "encoding". Preferably, encoded syringes include commercially-available drugs in prefilled syringes with a special barcode that stores information about the medication contained within the syringe. Encoded syringes are ready-to-use, passive, and disposable. The flow sensor system 200 also accommodates syringes not having encoding. The encoding syringes store the drug name and concentration contained within the syringe. Additional characteristics such as drug source, container size, drug manufacturer source, drug category color, among others, may also be included. When an encoded syringe is attached to the injection port 130 of the flow sensor 210, this barcode information is read by a scanner in the base 220 wirelessly transmitted by the

flow sensor system 200 to the data system. Preferably, the 2-D barcodes will be added to syringes during the filling process.

[0072] In one embodiment, the flow sensor system 200 contains a device to capture and transmit an image of a 2-D barcode on the Luer collar of the syringe, and wirelessly transmit this image to a “Computer”. Typically the Computer is a tablet computer communicating with multiple flow sensor systems 200. The 2-D barcode contains data, typically including the name and concentration of the drug in the syringe among other data. The Computer decodes this image, and displays and announces the drug attached. The barcode can contain the drug name and concentration. As the drug is injected, the flow sensor 210 in conjunction with the base 220 ultrasonically measures the volume of the injected drug and the time the drug was administered. This information may be stored in the flow sensor system 200 for later transmission to the Computer. The Computer uses this information to provide clinicians with an automated record of the drug name, concentration, volume, dose, and time of injection. The medication administration information is time stamped and displayed for clinical reference. Not all syringes used by the healthcare professional will contain a 2-D barcode. If a syringe without a 2-D barcode is inserted into the flow sensor system, the injection port 130, the flow sensor system 200 will prompt the user to manually enter the drug name and concentration into the computer. Information that is manually entered into the flow sensor system 200 is included in the patient medication record.

[0073] In one embodiment, the Computer can use a radio to wirelessly communicate with the flow sensor system 200 using an RF signal at 2.4 GHz to form a local medical device network. A number of flow sensor systems 200 and Computers may be used in the same vicinity such as a pre-operative care area or a post anesthesia care unit (PACU). Alert messages are communicated between the flow sensor system 200 and the Computer to advise the clinician of various operational characteristics of the flow sensor system 200. Some of these alerts inform the clinician of potential hazardous situations to allow user action to prevent harm to the patient or loss of medical data. Preferably, a lost wireless communication message will display when communication is lost between the flow sensor system 200 and the Computer. Preferably, all medication administration data from the flow sensor system 200 is transferred to the specific patient’s medical record. In the event of a communication loss, medication administration data will be stored locally at the flow sensor system 200 and transferred to the Computer when communications are resumed.

[0074] The Computer may operate in a variety of modes. Typically the Computer has specialized flow sensor system 200 software for operations, a touch screen, and a wireless

communications (Radio). It is typically mounted near an anesthetist or nursing work envelope and it may be removed for hand-held use. When the Computer is used in a hospital having a paper anesthesia record, the Computer supports features that assist with documenting the flow sheet portion and may help clinicians make the right decisions. In this configuration, the Computer complements the paper recordkeeping activities by tracking and displaying injections given through the flow sensor system 200. The Computer also enables clinicians to manually document other pertinent IV drug injection and infusion information.

[0075] In one embodiment, the software screens follow a three-step approach consisting of: (1) connecting the flow sensor system 200 to the Computer; (2) setting up a patient's flow sensor system 200 for use; and (3) viewing medication administration in multiple views.

[0076] In some embodiments, a view on the computer displays anesthesia based information in an anesthesia view, as shown in Fig. 14A. Preferably, this view provides information about the patient and displays drug name/concentration and dose for a current injection as well as a historical list of medications that have been delivered to the patient since the current case was opened. It may also include a listing of infusions given to the patient, if the clinician recorded them on the Computer. In this view, up to three injection bars display across the top of the screen, one corresponding to each wirelessly connected flow sensor system 200. Each injection bar is a real time representation of the medication being administered through an individual flow sensor system 200. When an encoded syringe is attached to a single flow sensor system 200, the injection bar displays the drug name and concentration. When a non-encoded syringe is attached, the injection bar will prompt the clinician to identify the medication and concentration being delivered. As the medication is being delivered, the volume pushed (in mL) and the corresponding dose displays in real time in the injection bar on the Computer display.

[0077] A flow sensor system 200 of the present disclosure may also provide optional medication history. For example, an anesthesia view can include a historical list of medications delivered to the patient organized by the surgical care area (medications given in the transition time between care areas, will post to the next care area) arranged in a flow sheet format. Preferably, this view includes all medications that were administered to the patient since the flow sensor system 200 was activated with the more recent medication administrations preferably at the bottom of the list. A scroll bar is enabled when the list exceeds the visible space on the screen of the Computer. Preferably, when a new medication is added, the medication list scrolls automatically so the new medication name is visible. In the view, preferably a color tile corresponding to American Society for Testing and Materials

International (ASTM) standards and endorsed by the American Society of Anesthesiologists displays to the left of the drug name. Optionally, a clinician may also specify that an admixture (mixed medication), or a diluted or reconstituted medication was delivered. Optionally, the Computer displays a case header which lists the patient name, date of birth, age in years, medical record number, and patient identification number. Optionally, the Computer will indicate that the patient has “no known allergies”. Preferably, if the patient has allergies, that text is replaced by a button, more preferably, and the button has a number on the button that indicates the number of allergies.

[0078] A flow sensor system 200 of the present disclosure may also provide an optional tabular view, as shown in Fig. 14B. For example, the tabular view is an alternate view for the clinician to interact with the flow sensor system 200. Similar to the anesthesia view described above, this view provides information about the patient and displays drug name/concentration and dose for a current injection as well as a historical list of medications that have been delivered to the patient. It may also include a listing of infusions given to the patient, if recorded by the clinician. The tabular view has many of the features of the anesthesia view; however, it is arranged in a tabular format. Preferably, the column headings in this view include time administered, medication with concentration, dose, and unit total. Optimally, the medications are displayed in reverse chronological order with most recent medication administered at the top of the list.

[0079] In one embodiment, the Computer provides two types of messages: (1) “Clinical” and (2) “System”. Clinical messages are alerts and reminders that relate directly to an aspect of patient care delivery (e.g. contraindication or a reminder that it may be time to re-dose antibiotics). System messages provide status on relevant system operating parameters.

[0080] Messages provide instructions and a button for acknowledging or resolving. Messages display on the Computer until they are acknowledged or are no longer clinically relevant. Messages can be answered any time during a case. Prior to pausing or closing a case, the clinician is prompted to respond/answer unresolved medication messages generated during the case. An allergy alert illuminates the flow sensor system 200 and displays on the Computer when a clinician attaches an encoded syringe or selects a medication for a non-encoded syringe to which the patient has a known allergy. Optionally, this message may be overridden.

[0081] When dosing antibiotics, preferably the Computer tracks elapsed time since an antibiotic was last administered and displays and announces an antibiotic redosing message if the configured redosing interval has elapsed. The redosing interval is individual to each antibiotic, and it is configured in the drug library of the Computer or Gateway (further

described below). In one embodiment, the flow sensor system 200 does not prevent or block the injection of a medication. In other embodiments, the flow sensor system 200 is able to block the injection of a medication.

[0082] In one embodiment, the Computer posts a message when the volume injected through the flow sensor system 200 was not measured. This may occur when the volume measured is outside of a range of sensing of the flow sensor system 200.

[0083] Optionally, the Computer wirelessly communicates bi-directionally with a software application that acts as a central hub to which all Computers (and thus multiple upon multiples of flow sensor systems 200) are connected, the “Gateway”. Preferably, the Gateway is also connected to the hospital’s other networked information systems. The Gateway allows all Computers to share patient case information such as drug name, dose, and time delivered with each other, and with the hospital’s networked information systems. The Gateway also allows Computers to receive patient information such as patient drug allergies and patient drug orders from other networked hospital information systems.

[0084] Utilizing the flow sensor system 200 of the present disclosure encompasses the steps of connecting the flow sensor 210 to the patient’s catheter or injection port (Y-site). Preferably, the flow sensor 210 and line is flushed. The flow sensor 210 is keyed to an individual patient using a unique serial number and the base 220 records medication administration through the port at the inlet end 102 of the flow sensor 210.

[0085] When a syringe 800 is attached to the injection port 130, the flow sensor system 200 identifies the medication and concentration for an encoded syringe by optically imaging and decoding a barcode on the Luer-Lok collar of the syringe 800. This information is wirelessly transmitted to the Computer. Preferably, the Computer displays and audibly announces the drug attached. The Computer also may perform allergy safety checks based on the patient’s medical record.

[0086] In one embodiment, as the drug is injected, the flow sensor system 200 measures the volume dosed ultrasonically. The flow sensor system 200 wirelessly sends volume measurement information to the Computer. The Computer uses this information to provide clinicians with a medication administration record which is time stamped and displays for clinical reference during surgical procedures. Manually entered infusions and other information pertaining to non-encoded drug injections may be included in the patient medication record in the Computer and the Gateway. The Computer wirelessly communicates with the Gateway on the hospital network, and it may send medication administration to Hospital Information Systems, when configured, for reporting and electronic recordkeeping

purposes. Preferably, the Computer wirelessly communicates with the existing Hospital Network using a standards based IEEE 802.11a/b/g/n enterprise WLAN network. The Gateway software and accompanied database will be a part of the hospital's enterprise information system. A number of Computers may be connected to the healthcare enterprise wireless network and to the intended Gateway software and database. Preferably, the Gateway and accompanied database provides a list of patients for the user to select and a formulary library of medications and fluids for injection or infusion. In one embodiment, actual medication and fluid administration data are sent to the Gateway and accompanied database for recordkeeping. Once recorded on the Gateway and accompanied database these data are preferably available in other care areas when the patient is transferred and the flow sensor system 200 is wirelessly connected to a Computer. Preferably, in the event of a communication loss, medication administration data will not be sent to the Gateway and therefore not available in the next care area.

[0087] Referring to Figs. 1-12, use of a flow sensor system 200 of the present disclosure will now be described. First, preparing the flow sensor system 200 for an injection will be discussed.

[0088] In one embodiment, the flow sensor system 200 is prepared, attached to an IV line, and assembled for use. Preferably, there are pre-printed instructions located on the flow sensor 210 sterility pouch. First, a user obtains a flow sensor 210 in its sterile packaging and a fully-charged and disinfected reusable base 220. In one embodiment, a fully-charged base 220 has sufficient power for at least 24 hours of use under typical conditions. Optionally, the base 220 provides a visual indication of charge level via a display.

[0089] Next, the flow sensor 210 is flushed with sterile IV fluid before attaching to the Y-site. In one embodiment, the flow sensor 210 is flushed with more than 8 mL of sterile IV fluid. After flushing, a user can visually inspect the IV line for leaks, air, or blockage.

[0090] Next, a user attaches the flow sensor 210 to the base 220 by joining the flow sensor 210 (tubing side) and base 220 front sections first, and then snapping the two together. Preferably, an audible snapping sound is heard to indicate a secure connection between the flow sensor 210 and the base 220. In one embodiment, connecting the flow sensor 210 to the base 220 automatically powers on the flow sensor system 200. In one embodiment, the connection of the flow sensor 210 to the base 220 is verified by a blinking light on the base 220. In other embodiments, other indicators may be used. Catch 389 of the base 220, shown in Fig. 5A, engages tab 189 of the flow sensor 210, shown in Fig. 6, to restrain the flow sensor 210 with the base 220 prior to initiation of an injection. In one embodiment, deflection of the

wing tab or wing tabs 280 moves tab 189 with respect to catch 389 to initiate engagement or disengagement therewith. When the flow sensor 210 is assembled to the base 220, a cantilever 650 provided on the base 220, such as a lower housing 212 as will be discussed herein, is aligned with button 350 provided on the base 220. The interior of the wing tab 280 may also be provided with a pin cam 388 which allows pin 188 of the flow sensor 210, as shown in Fig. 6, to ride along such that the flow sensor 210 is moved proximally during assembly onto the base 220. During engagement, tongue 286 shown in Fig. 5A, is engaged within an opening 285 shown in Fig. 7. With continued reference to Figs. 5A and 7, a vault 485 having ribs 487 on the flow sensor 210 as shown in Fig. 7, has a corresponding exterior profile taken with the shoulder 486 of the base 220, as shown in Fig. 5A, to engage for alignment of the first window 360 to precisely align with Luer lock threads 131 when the flow sensor 210 is assembled to the base 220.

[0091] In some embodiments, where appropriate, the flow sensor system 200 is secured to a surface in preparation for giving injections. For example, in some embodiments, referring to Fig. 12, a mount 1100 is used to secure the flow sensor system 200 to a surface. During this step, it is important to avoid kinks in the line between the flow sensor system 200 and IV line.

[0092] The flow sensor system 200 is now ready for delivery of IV medications. Preferably, any medications given through the flow sensor system 200 will be recorded in the electronic base 220 memory. In one embodiment, in the event of a flow sensor system 200 failure (excluding the IV fluid pathway), the flow sensor system 200 will still allow standard medication or fluid delivery through the port.

[0093] Next, giving an injection using the flow sensor system 200 will be discussed. First, the injection port 130 is cleaned by swabbing the hub according to normal hospital procedure. Next, a syringe 800 can be attached to the injection port 130 of the flow sensor 210 by completely turning the syringe 800 until the syringe 800 stops, i.e., a secure connection between the syringe 800 and the injection port 130 is made. Ideally, the caregiver double checks each medication name and concentration on the syringe 800 prior to attachment to the injection port 130 to assure the correct medication is given. During the injection cycle and/or medicament determination cycle, when syringe tip 810 contacts a syringe protrusion 652, as shown in Fig. 4B, the cantilever 650 is deflected radially from the longitudinal axis of the syringe 800. A pad protrusion 651 depresses button 350 on the base 220 and the button 350 signals the microprocessor to act.

[0094] Next, the drug and concentration displayed and announced by the Computer is verified as the intended drug and concentration. In one embodiment, the base 220 will alert

the caregiver that an allergy is detected by an alert, for example, by flashing red, green, and yellow lights if a medication allergy is detected. Optionally, the Computer calculates a potential allergy reaction and provides an alert when any of these conditions is true: (1) an encoded syringe is inserted into the flow sensor 210 and the drug matches the patient's allergy profile; or (2) a non-encoded syringe is inserted into a flow sensor 210 and you select a drug from the select medication screen that matches the patient's allergy profile. If one of these conditions is true, the allergy alert flag on the Computer configuration is turned on.

[0095] In one embodiment, there is no check valve in the flow sensor 210, nor is one needed to use the flow sensor 210 safely and effectively. Typically, the flow sensor system 200 measures 0.4 mL to 55 mL per injection. If the injection flow rate is slow or a small volume is delivered (<0.4 mL) preferably an alert will display on the Computer. Optionally, an alarm is configured to detect rapid delivery from a large volume, e.g., 50 mL syringe. In this case, an alert is provided to check the dose.

[0096] In one embodiment an indicator 375, such as a series of four LED indicators, turn on in sequence to indicate to the user that fluid is moving through the flow sensor 210. When base 220 is mounted in the charger 900, the indicator 375 can indicate a level of battery charge of the base 220.

[0097] In one embodiment, it is preferred to follow all medication injections through the flow sensor system 200 with an encoded normal saline flush syringe to ensure the full dose of medications reaches the patient, especially when successively delivering two incompatible medications. Optionally, the flow sensor system 200 records such saline flush activity.

[0098] In one embodiment, injections are recorded whether or not the flow sensor system 200 is wirelessly connected to the Computer. The base 220 stores injection information in its memory and transmits this information upon wireless connection to the Computer.

[0099] In one embodiment, the Computer can accommodate multiple flow sensor systems 200 connected to one patient at a time. An additional flow sensor system 200 may be added at any time during a patient's treatment. When a flow sensor system 200 is connected to a Computer and there is no syringe attached to the flow sensor 210, the active injection bar reads "Sensor Connected, No syringe". On the Computer display, a battery status icon in the upper right corner of the injection bar indicates the battery charge level of the base 220 to which the flow sensor 210 is connected. For each injection a caregiver may enter a comment on the Computer.

[00100] The present disclosure provides a flow sensor sub-assembly for sensing flow of a fluidic medicament. The flow sensor sub-assembly includes a first spring contact and a second

spring contact. In one embodiment, the spring contacts are secured to a base that has a circuit for conducting an electrical signal to and from the spring contacts to a microprocessor. The first spring contact is in electrical communication with a first piezo element and the second spring contact is in electrical communication with a second piezo element. The first spring contact has a first contact force against the first piezo element and the second spring contact has a second contact force against the second piezo element, and the first contact force is equivalent to the second contact force. The present disclosure also provides a circuit board for interfacing to a flow sensor having a plurality of piezo elements for transmitting a flow signal indicative of flow of a fluidic medicament.

[00101] A spring contact of the present disclosure provides electrical contact to a piezo element. For example, a spring contact of the present disclosure provides electrical contact to a silvered surface of a piezoelectric crystal. Furthermore this contact provides a spring force selected to accommodate assembly tolerances, temperature variation, electrical requirements, material selection for a long life to silver, and assembly features for a single-sided printed circuit board assembly (PCBA) attachment. The flow sensor sub-assembly of the present disclosure provides for four contacts used in a sensor to have the same force on both surfaces of each of two piezo elements, such as crystals, in a single transducer.

[00102] A circuit board of the present disclosure provides a single-sided PCBA. The single-sided PCBA of the present disclosure provides a lower cost design than conventional double-sided PCBA designs. The circuit board of the present disclosure also provides a means to maintain mechanical loading of the crystal contacts when the transducer is inserted to the PCBA.

[00103] Electrical contacts to the ultrasound crystal have previously been accomplished by soldering wires to a silver coating. A spring contact of the present disclosure provides a cost reduction method by using the spring contacts to connect to the crystal. In particular, a single-sided printed circuit board (PCB) of the present disclosure provides for a lower cost design and a through hole contact design. The design of the present disclosure includes the force exertion by the spring constant, dimension of separation between contacts, material type of the springs, the range of forces necessary, and tolerance control of forces exerted by the spring contact, which are all important to eliminate soldering. If soldering is too hot, it often takes silver off the surface of the crystal. Another problem with soldering is leaving too much solder behind, which may also cause loading of the ultrasonic physical characteristics. Consistent electrical and physical contact (repeatability) for both crystals is important as well as sensor to sensor

calibration. The forces cannot be too high (potential for a slurry to develop) or too low (variable impedance).

[00104] The flow sensor sub-assembly of the present disclosure provides a high volume, disposable design with benefits for its cost, reliability, and repeatability. The flow sensor sub-assembly of the present disclosure allows for future automation features. The flow sensor sub-assembly of the present disclosure provides for maximal tolerance designed in conditions. The flow sensor sub-assembly of the present disclosure is able to fit inside the housing of a flow sensor 210.

[00105] Referring to Figs. 8 and 13-19B, a sub-assembly 10 for a flow sensor 210 for sensing flow of a fluidic medicament generally includes a flow tube 100 having a flow tube inlet 102 and a flow tube outlet 101, through which a medicament flows, a first piezo element 150 arranged at an upstream position of the flow tube 100 and a second piezo element 151 arranged at a downstream position of the flow tube 100, a first spring contact 750, and a second spring contact 750. In one configuration, the sub-assembly 10 for a flow sensor 210 may be utilized as a flow sensor 210 and inserted into the base 220, where contacts 750 are integrated into the base 220 rather than as a component of a housing 211, 212 of the flow sensor 210. Preferably, the upstream transducer 150 and downstream transducer 151 are interchangeable, however, it is envisaged that they may be purposefully constructed for their respective positions on the flow sensor sub-assembly 10.

[00106] In one embodiment, the first piezo element 150 and the second piezo element 151 are mounted apart a pre-selected distance from each other. In one embodiment, each of the spring contacts 750 are secured to a base, e.g., a circuit board 700. The circuit board 700 includes a circuit for conducting an electrical signal to and from the spring contacts 750 to a microprocessor. The first spring contact 750 is in electrical communication with the first piezo element 150 and the second spring contact 750 is in electrical communication with the second piezo element 151. The first spring contact 750 has a first contact force against the first piezo element 150 and the second spring contact 750 has a second contact force with the second piezo element 151. In one embodiment, the first contact force is equivalent to the second contact force.

[00107] Referring to Figs. 8 and 13-19B, in one embodiment, the flow tube 100 includes an inner flow tube 100 and end fittings, e.g., an inlet fitting 180 at an inlet end 102 and an outlet fitting 190 at an outlet end 101, for securing the inner flow tube to the respective end fittings 180, 190. In one embodiment, the first and second piezo elements 150, 151 are mounted to the end fittings 180, 190.

[00108] Referring to Figs. 16A-18, in one embodiment, the first spring contact 750 comprises a pair of cantilevered leaf springs 759 and the second spring contact 750 comprises a pair of cantilevered leaf springs 759. Referring to Figs. 17 and 18, a cantilevered leaf spring 759 of the present disclosure may include tangs 756, a cantilever arm 757, and a contact area 758 having a bump 780.

[00109] Referring to Figs. 15-16C, in one embodiment, the circuit that conducts an electrical signal to and from the spring contacts 750 to a microprocessor is provided on a front and rear surface of a printed circuit board 700 and the first and second spring contacts 750 are resiliently urged against the first and second piezo elements 150, 151, respectively, when the first and second piezo elements 150, 151 are inserted between each of the pair of cantilevered leaf springs 759.

[00110] In one embodiment, the circuit is formed integrally with a flow sensor housing by injection molding. In one embodiment, referring to Fig. 8, the assembly may include a flow sensor upper housing 211 engageable with a flow sensor lower housing 212 about the flow sensor 210. In one embodiment, the first piezo element 150 and the second piezo element 151 are annular in shape and encircle the flow tube 100 at each respective mounting point.

[00111] Referring to Figs. 1-9 and 13-16C, in one embodiment, the flow sensor 210 sub-assembly of the present disclosure is contained within a flow sensor housing 211, 212. A portion of the flow sensor housing 212 is coupled to a flow sensor base 220 which contains a microprocessor and a circuit that includes connecting pins for providing an electrical signal from the flow sensor 210 sub-assembly to the microprocessor within the flow sensor base 220.

[00112] In some embodiments, the flow sensor 210 sub-assembly is disposed after the flow sensor 210 sub-assembly is used to sense the flow of at least one fluidic medicament. In some embodiments, the flow sensor base 220 is reusable and is usable with different flow sensor 210 sub-assemblies.

[00113] Referring to Figs. 8 and 13-19B, a circuit board 700 of the present disclosure for interfacing to a flow sensor 210 that includes piezo elements 150, 151 for transmitting a flow signal indicative of a flow of a fluidic medicament includes a base or circuit board 700, a first pair of spring contacts 750, a second pair of spring contacts 750, and a plurality of pins 385 in electrical contact with a plurality of electrical circuit traces. In one embodiment, the circuit board 700 includes a plurality of electrical circuit traces having a first end and a second end. In another embodiment, circuit board 700 can contain a non-volatile memory containing the serial number of the sensor 210, calibration data and/or flow calculation constants for communication to the electronic microprocessor of the base 220.

[00114] Referring to Figs. 15-16C, the first pair of spring contacts 750 for bias and electrical interface with a first piezo element 150 are mounted to a first end of the circuit board 700 and are in electrical communication with at least one electrical circuit trace. Also, the second pair of spring contacts 750 for bias and electrical interface with a second piezo element 151 are mounted to a second end of the circuit board 700 and are in electrical communication with at least one electrical circuit trace. The plurality of pins 385 are in electrical contact with the plurality of electrical circuit traces and configured to form electrical contacts with the plurality of contacts 386. In one embodiment, each of the spring contacts 750 are pre-configured such that the bias against the first piezo element 150 and the bias against the second piezo element 151 are equivalent and the electrical circuit traces are configured such that each of the pins 385 are in electrical communication with a single spring contact 750.

[00115] Referring to Figs. 15-18, in one embodiment, each pair of the spring contacts 750 comprise a pair of cantilevered leaf springs 759 mounted to the circuit board 700. Referring to Figs. 17 and 18, a cantilevered leaf spring 759 of the present disclosure may include tangs 756, a cantilever arm 757, and a contact area 758 having a bump 780. The electrical circuit traces are provided on a front surface of the circuit board 700 and the spring contacts 750 extend from a rear surface of the circuit board 700. In one embodiment, each of the cantilevered leaf springs 759 includes a mound-like protrusion, e.g., a bump 780, which contacts a surface of the piezo elements 150, 151.

[00116] In one embodiment, the circuit board 700 is formed integrally with a flow sensor housing 211, 212 by injection molding. The circuit board 700 may be assembled into a flow sensor housing 211, 212 in at least two orientations and provides transmission of a flow signal from the piezo elements 150, 151 to a microprocessor. In one embodiment, the circuit board 700 is disposed of after a flow sensor 210 is used to sense the flow of at least one fluidic medicament. Advantageously, after a flow sensor 210 is used to sense the flow of at least one fluidic medicament, the circuit board 700 is usable with a different flow sensor 210.

[00117] Referring to Figs. 16A-16C, the first spring contact 750 comprises a pair of opposed cantilevered leaf springs 759 engaging an upstream contact point on the first piezo element 150 and a downstream contact point on the first piezo element 150, and the second spring contact 750 comprises a pair of opposed cantilevered leaf springs 759 engaging an upstream contact point on the second piezo element 151 and a downstream contact point on the second piezo element 151.

[00118] Referring to Figs. 16A-16C and 19B, in one embodiment, the first spring contact 750 comprises a bifurcated cantilevered leaf spring first half 750a engaging a first piezo

element 150, and a bifurcated cantilevered leaf spring second half 750b engaging the opposite side of the same piezo element 150.

[00119] Referring to Fig. 20, the flow tube sub-assembly 10 includes a flow tube 100, a first piezo element or upstream transducer 150, a second piezo element or downstream transducer 151, an inlet fitting 180, and an outlet fitting 190.

[00120] Referring to Fig. 21, the spring contacts 750 are secured to a circuit board 700. In an exemplary embodiment, the nominal design of the spring contacts 750 on circuit board 700 are free standing with a 0.5 mm clearance. With a crystal, e.g., transducer 150 or 151, in place, the spring contacts 750 deflect outward and are loaded in a displaced position of 0.75 mm with a nominal load of 75 g on each spring contact 750 for a 100 g/mm design. From analysis, at 1 mm of deflection, the yield stress is near yield strength at a surface area of a large bend, which is satisfactory. The nominal springs measured 145 g/mm and 150 g/mm.

[00121] With the contact gap at a minimum of 0.41 mm, the contact load increases to a nominal value of 148 gms. Based on yield challenges and a margin to 150 gm, the gap could be revised +/- 0.2 mm. If it does yield it will take a set and still provide a spring force. Any reduction in the crystal thickness will have an effect on the loaded condition and is evaluated. Another observation is the tolerance of the standoffs on the spring contacts 750 are larger than the dimension itself.

[00122] Referring to Figs. 22A-22B, a portion of the flow sensor 210 at the outlet end 101 is illustrated and tolerance analysis provided for an exemplary embodiment. In one embodiment, the transducer is parallel to the base. As shown in Figs. 22A-22B, the spring contacts are shown in an uncompressed state. As described herein, the deflection would be transitioned to the edge of the associated piezo element. One observation is that the standoff tolerance of 0.13 mm is more than the standoff itself of 0.05 mm on the spring contact 750. Referring to Fig. 22B, the PCB surface may include dimples 730 for providing a planar reference. In one embodiment, the height of the dimples 730 is 0.05 mm.

[00123] While this disclosure has been described as having exemplary designs, the present disclosure can be further modified within the spirit and scope of this disclosure. This application is therefore intended to cover any variations, uses, or adaptations of the disclosure using its general principles. Further, this application is intended to cover such departures from the present disclosure as come within known or customary practice in the art to which this disclosure pertains and which fall within the limits of the appended claims.

Claims

1. A flow sensor system comprising:
a flow sensor for sensing flow of a fluidic medicament; and
a reusable base including a rechargeable battery,
wherein the flow sensor is configured to be removably connected to the reusable base, and
wherein the reusable base comprises a plurality of contacts configured to electrically engage corresponding electrically active portions of the flow sensor and corresponding electrically active portions of a charger configured to recharge the rechargeable battery in the reusable base.
2. The flow sensor system of claim 1, wherein the reusable base includes a tongue surrounded by a shoulder, and wherein the shoulder includes the plurality of contacts.
3. The flow sensor system of claim 1 or claim 2, further comprising:
the charger, wherein the charger includes a charger base having an opening configured to receive the reusable base, and wherein the opening includes a plurality of charging pins configured to engage the plurality of contacts of the reusable base.
4. The flow sensor system of claim 3, wherein the charger includes a sloped floor for allowing disinfection liquid to drain therefrom.
5. The flow sensor system of claim 4, wherein the charger includes elevated feet on a side of the charger opposite the sloped floor to assist in drainage.
6. The flow sensor system of claim 5, wherein the charger is configured to be cleaned and disinfected by a same procedure used for cleaning and disinfecting the reusable base.
7. The flow sensor system of any one of the preceding claims, wherein the reusable base includes a useful life indicator, and wherein the useful life indicator indicates whether the reusable base has exceeded a useful life when the plurality of contacts of the reusable base electrically engage the corresponding electrically active portions of the charger.

8. The flow sensor system of claim 7, wherein the reusable base includes a power indicator, and wherein the power indicator indicates a level of charge of the rechargeable battery when the plurality of contacts of the base electrically engage the corresponding electrically active portions of the charger.

9. The flow sensor system of any one of the preceding claims, wherein the flow sensor and reusable base are provided in a mount at a bedside of a patient.

10. The flow sensor system of claim 9, wherein the charger is separate from the mount at the bedside of the patient.

11. The flow sensor system of claim 1, wherein the flow sensor includes a flow sensor sub-assembly, wherein the flow sensor sub-assembly includes:

a flow tube having a flow tube inlet and a flow tube outlet, through which said medicament flows;

a first piezo element arranged at an upstream position of the flow tube and a second piezo element arranged at a downstream position of the flow tube, wherein the corresponding electrically active portions of the flow sensor are in electrical communication with the first piezo element and the second piezo element.

12. The flow sensor system of claim 11, wherein the flow sensor sub-assembly further includes:

a first spring contact; and

a second spring contact,

wherein each of said spring contacts are secured to the reusable base, wherein said reusable base has a circuit for conducting an electrical signal to and from said spring contacts to a microprocessor, and wherein said first spring contact is in electrical communication with said first piezo element and said second spring contact is in electrical communication with said second piezo element.

13. The flow sensor system of claim 11, wherein said flow sensor includes a flow sensor housing, wherein said flow sensor sub-assembly is contained within the flow sensor housing, wherein said flow sensor housing is configured to be coupled to the reusable base, wherein said reusable base contains a microprocessor and a circuit including the plurality of electrical contacts, wherein the plurality of electrical contacts are in electrical communication with the microprocessor and the rechargeable battery.

14. The flow sensor system of any one of the preceding claims, wherein said flow sensor is configured to be disposed after said flow sensor is used to sense the flow of the fluidic medicament, and the reusable base is configured to be reused with a different flow sensor.

15. The flow sensor system of claim 1, further comprising:

a circuit board for interfacing to the flow sensor, wherein the flow sensor includes a plurality of piezo elements for transmitting a flow signal indicative of flow of a fluidic medicament, wherein the circuit board includes a plurality of electrical circuit traces having a first end and a second end;

a first pair of spring contacts for bias and electrical interface with a first piezo element, wherein said first pair of spring contacts are mounted to said first end of said circuit board and in electrical communication with at least one electrical circuit trace; and

a second pair of spring contacts for bias and electrical interface with a second piezo element, wherein said second pair of spring contacts are mounted to said second end of said circuit board and in electrical communication with at least one electrical circuit trace.

16. The flow sensor system of claim 15, wherein said circuit board is configured to be disposed of after said flow sensor is used to sense the flow of the fluidic medicament.

17. The flow sensor system of claim 15, wherein after said flow sensor is used to sense the flow of the fluidic medicament, said circuit board is configured to be used with a different flow sensor.

18. The flow sensor system of claim 15, wherein said electrical circuit traces are provided on a front surface of said circuit board, and wherein said spring contacts extend from a rear surface of said circuit board.

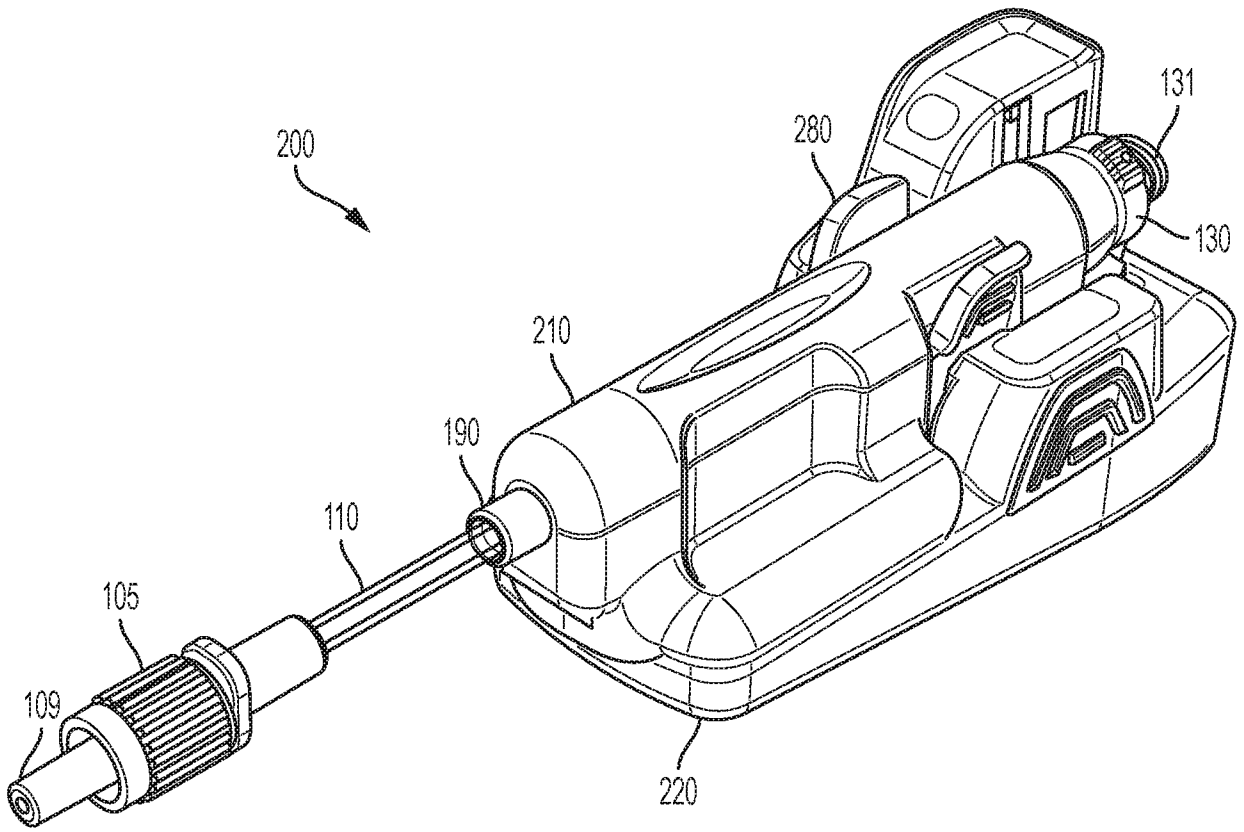

FIG. 1

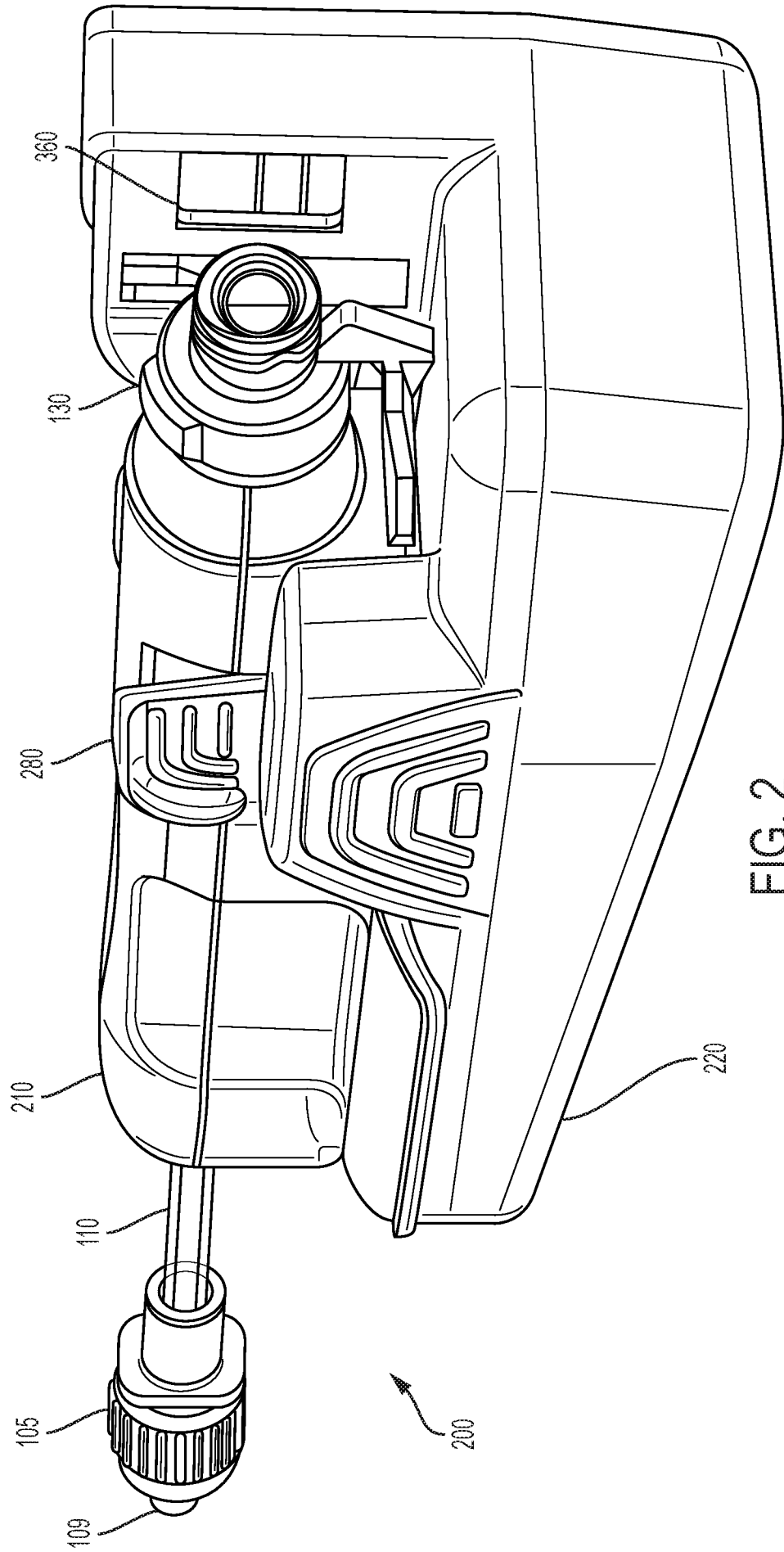

FIG. 2

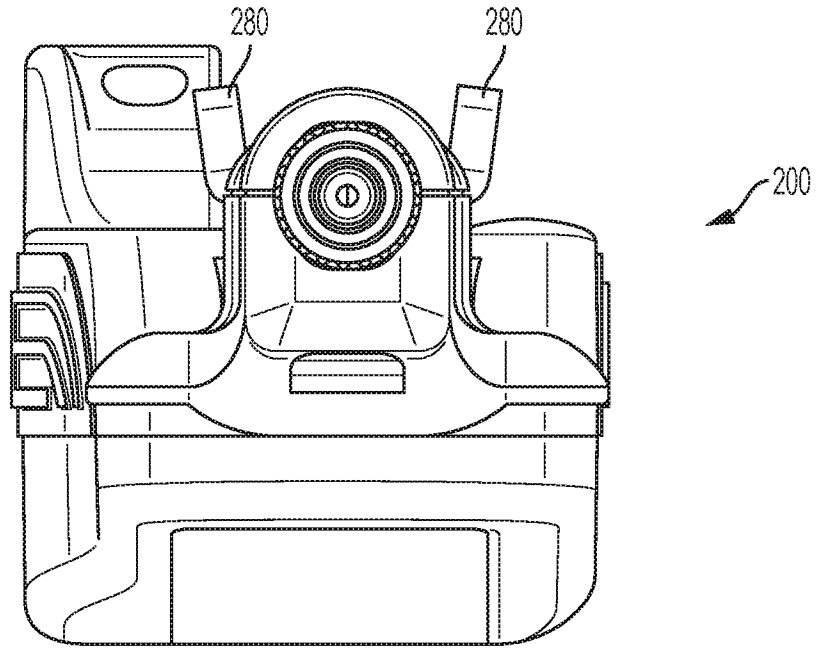

FIG. 3A

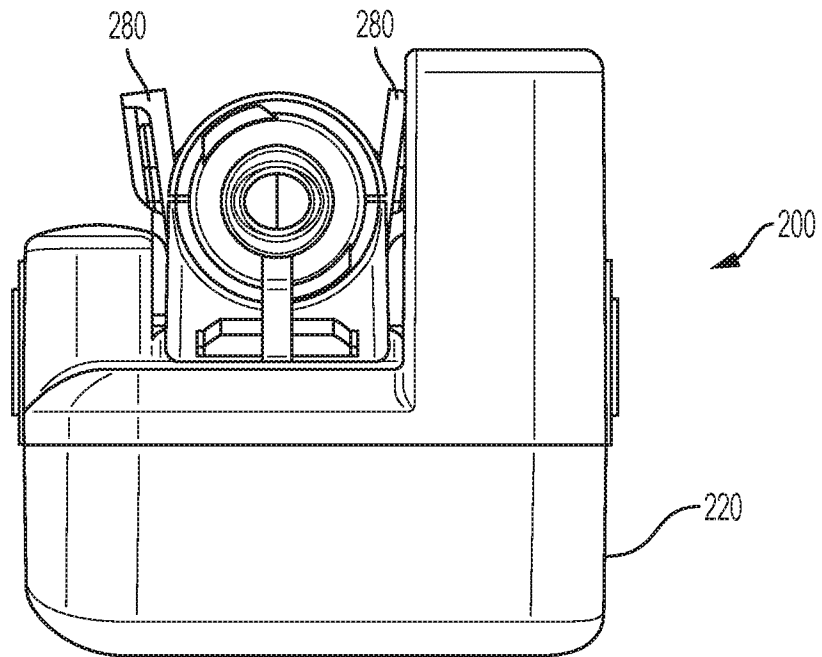

FIG. 3B

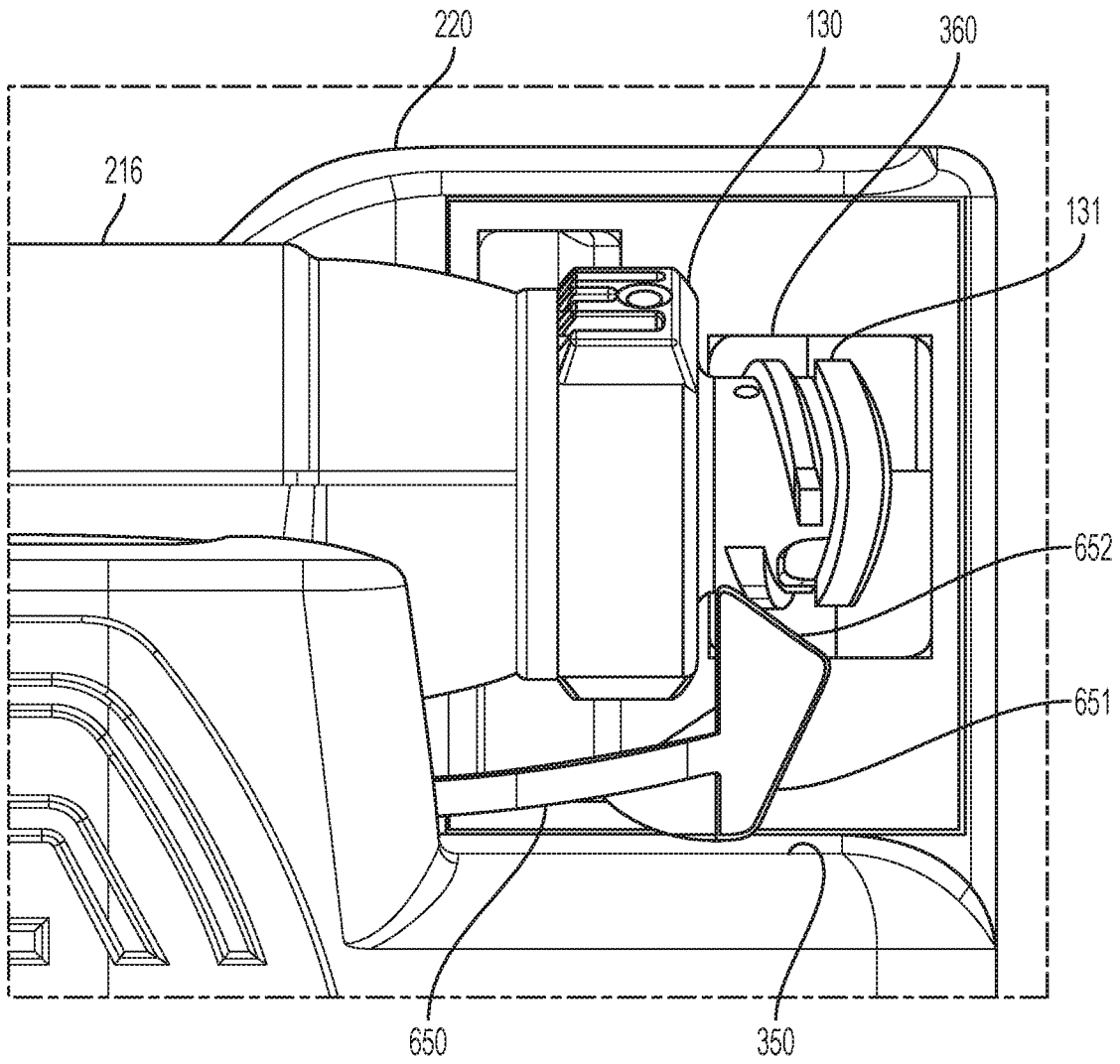
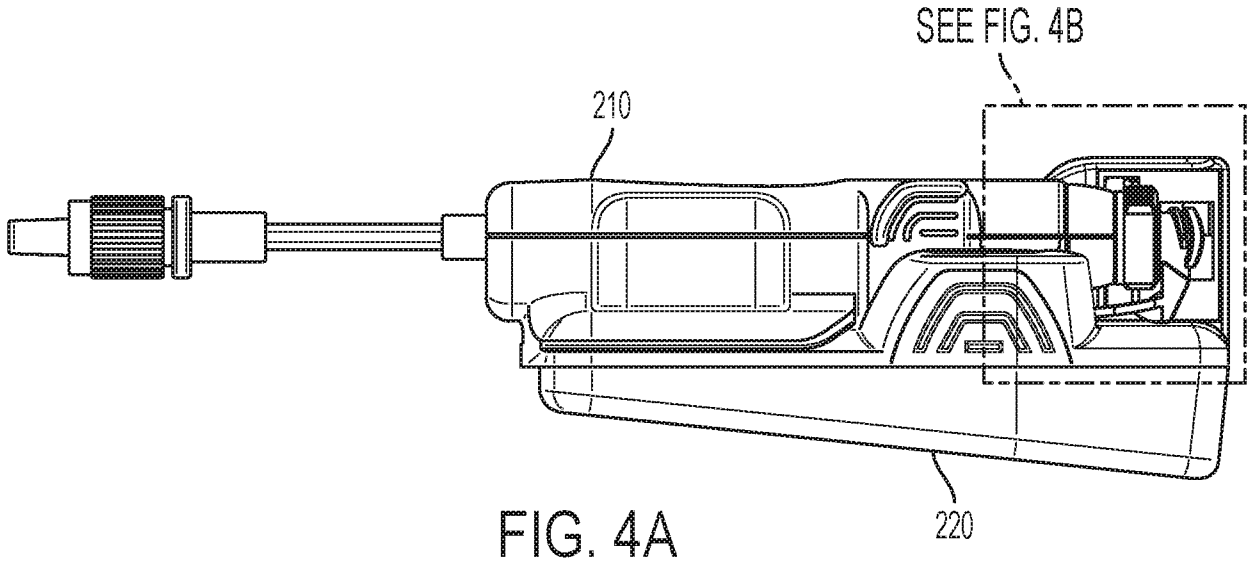

FIG. 4B

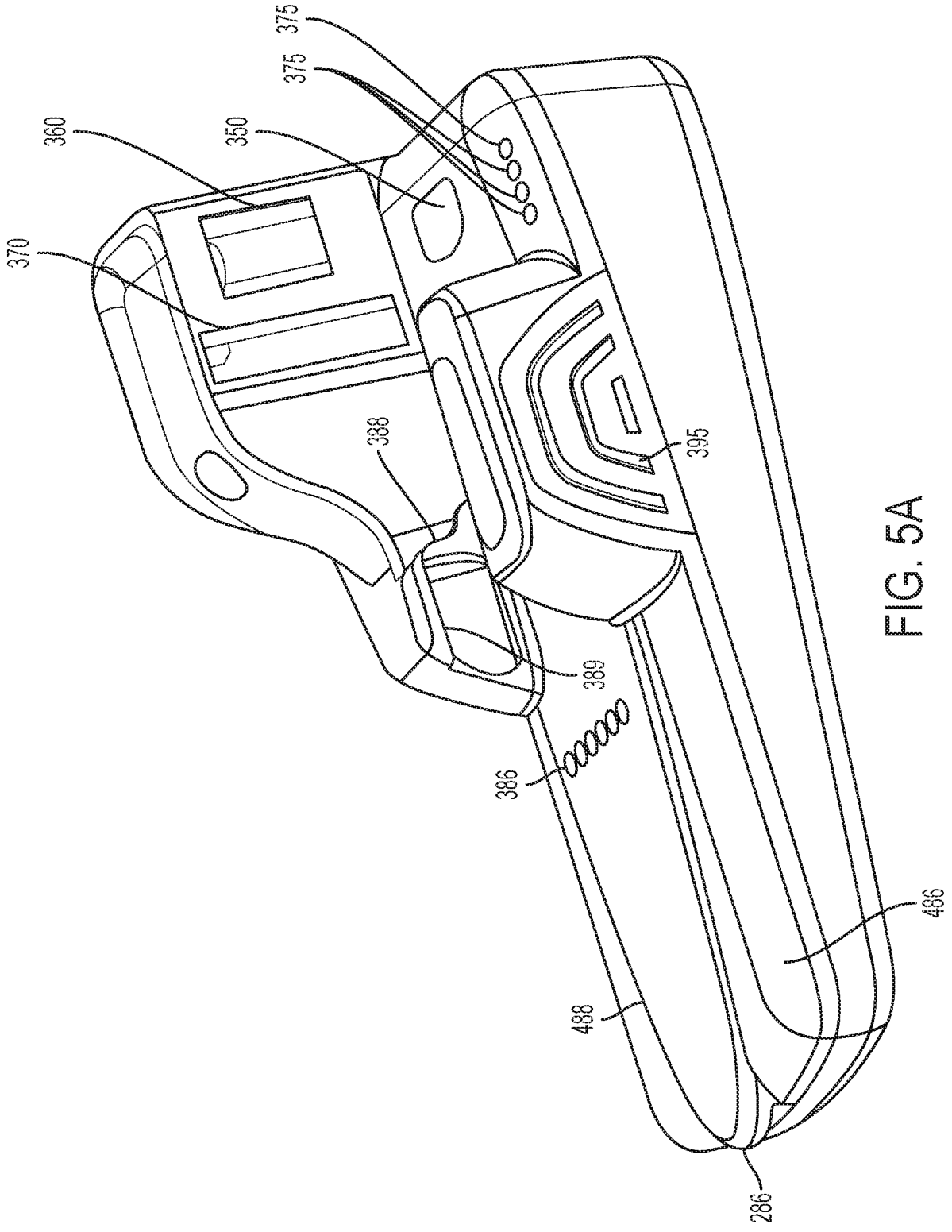

FIG. 5A

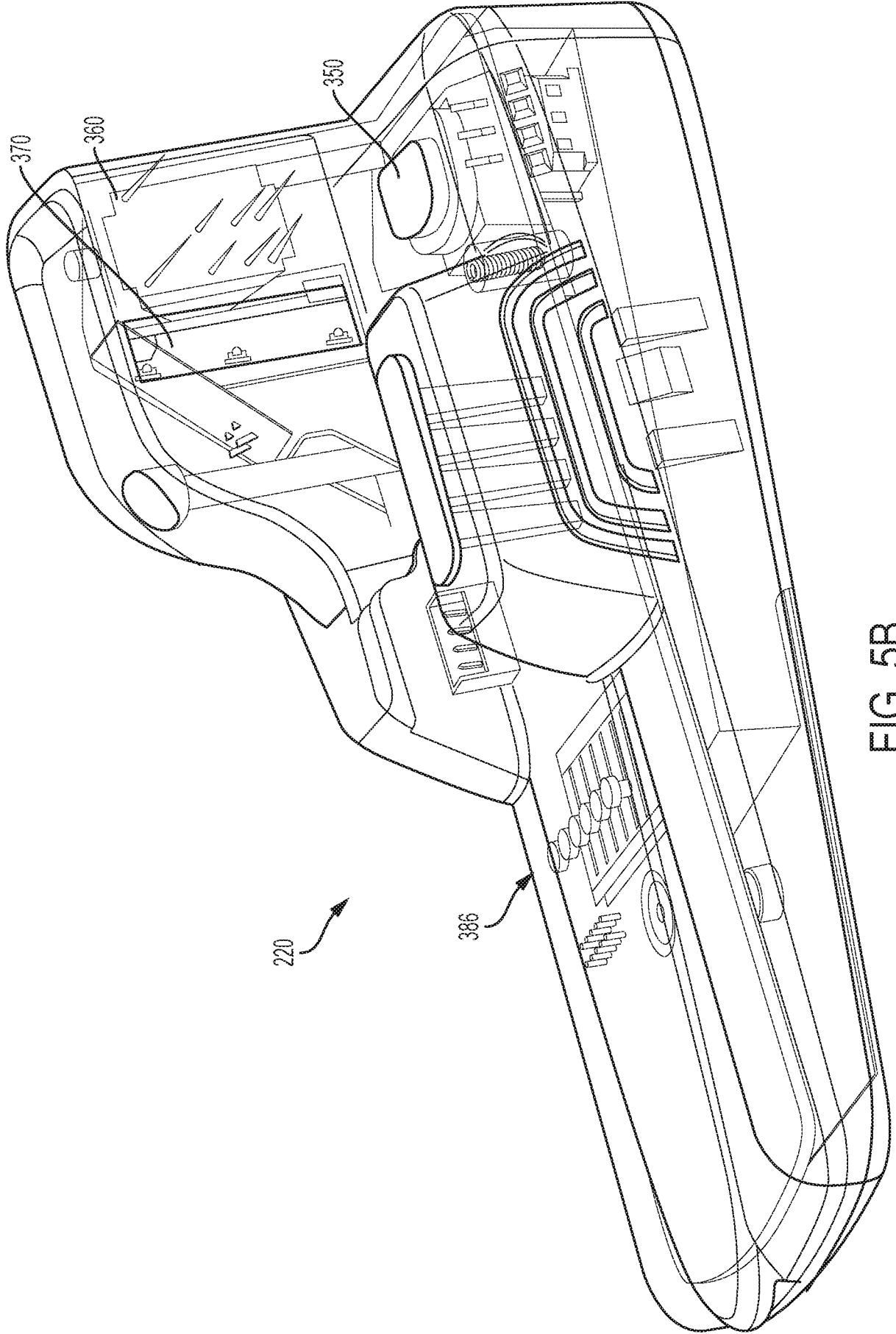

FIG. 5B

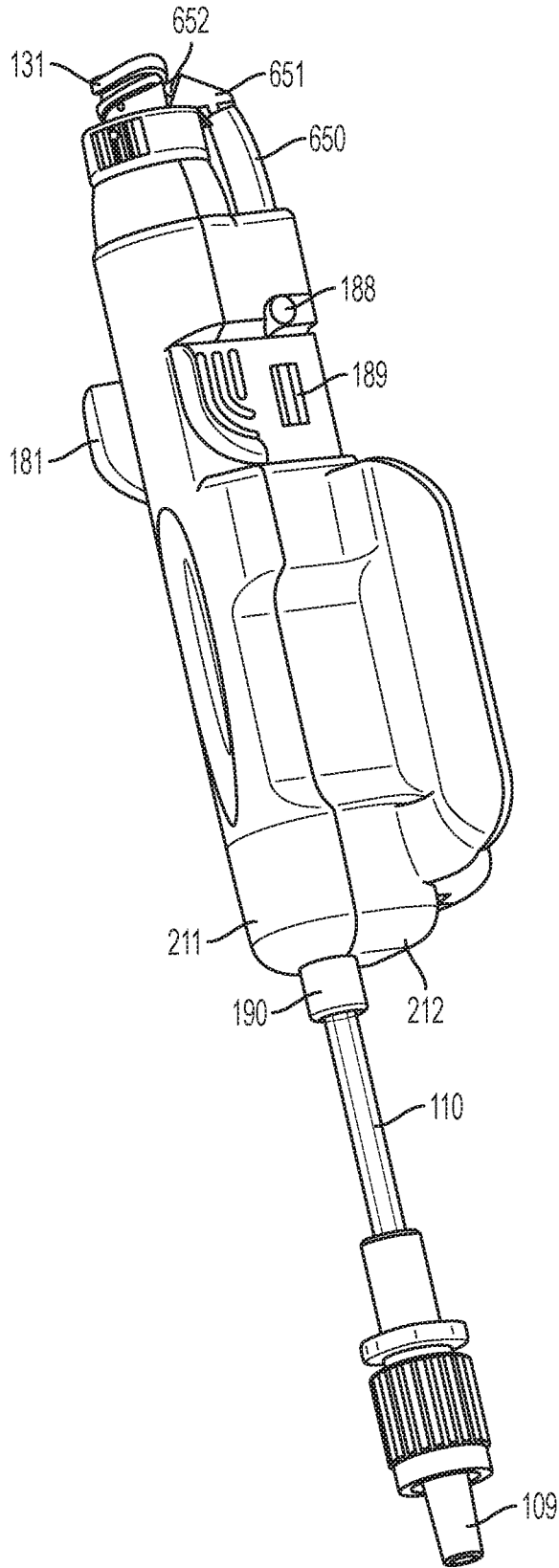

FIG. 6

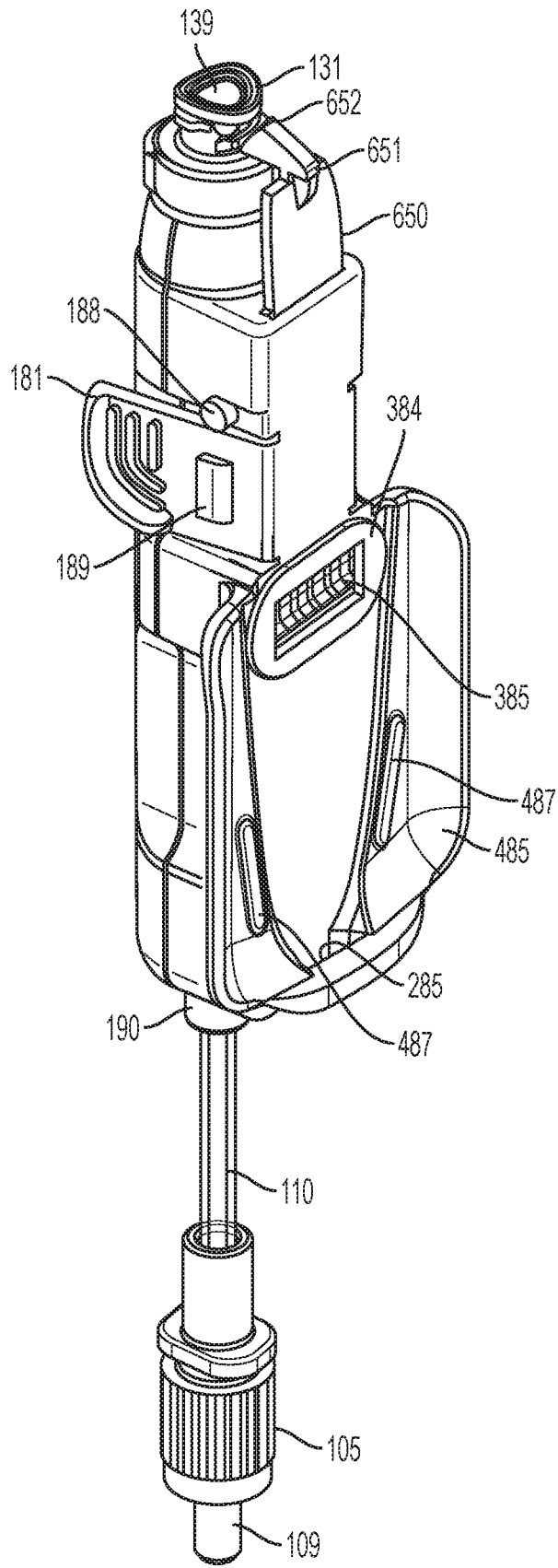

FIG. 7

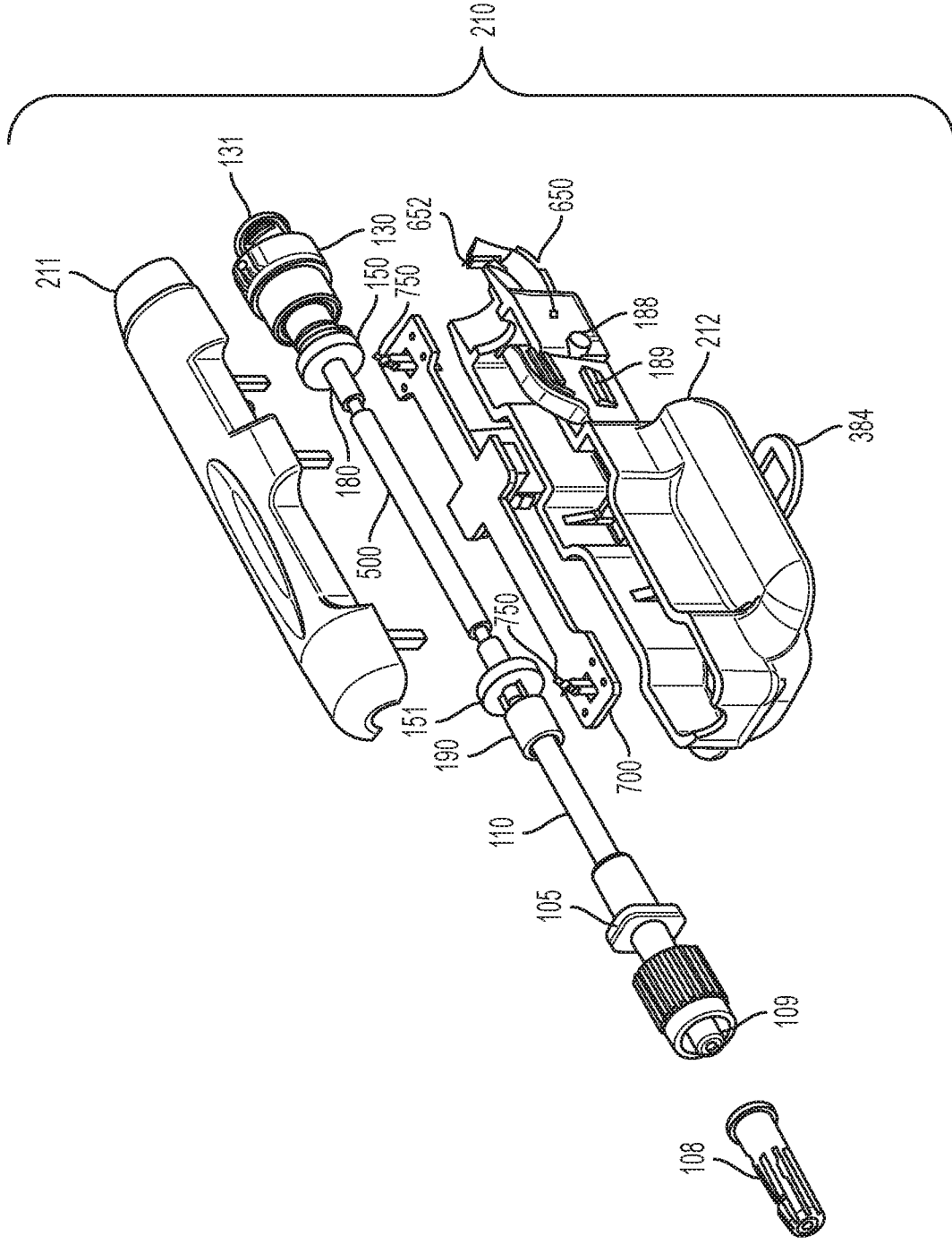

FIG. 8

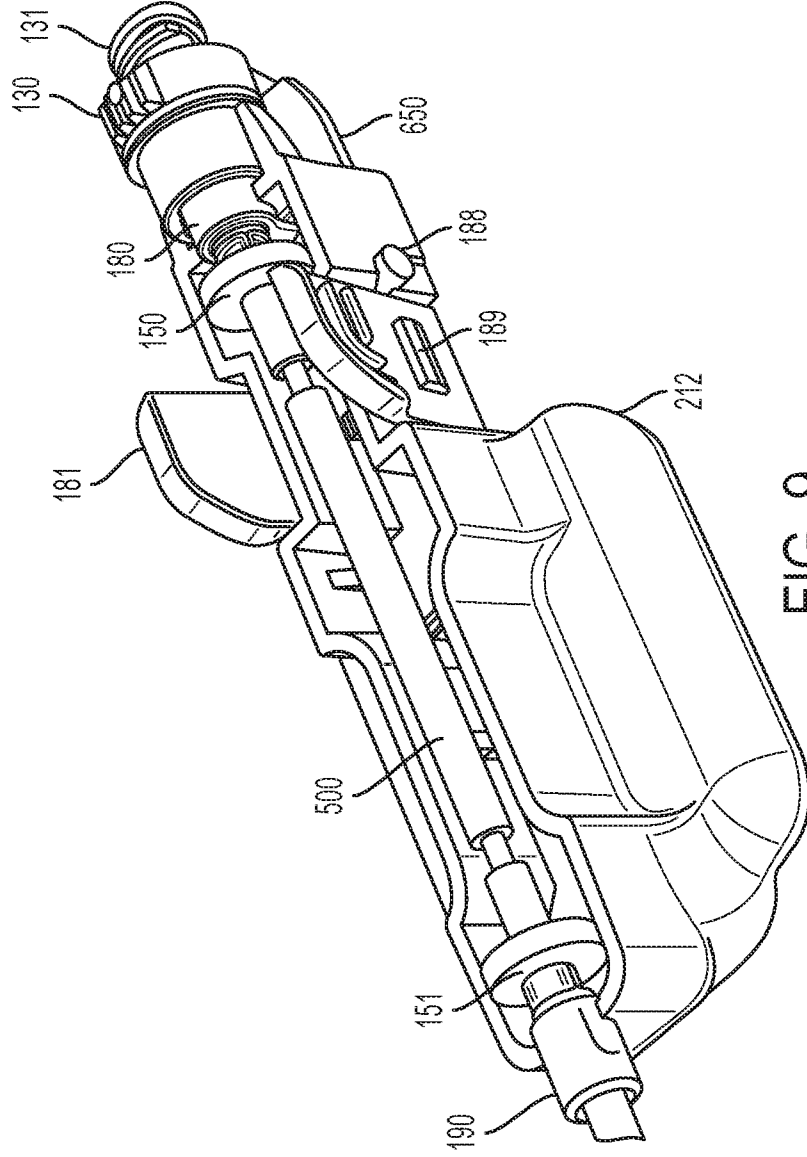

FIG. 9

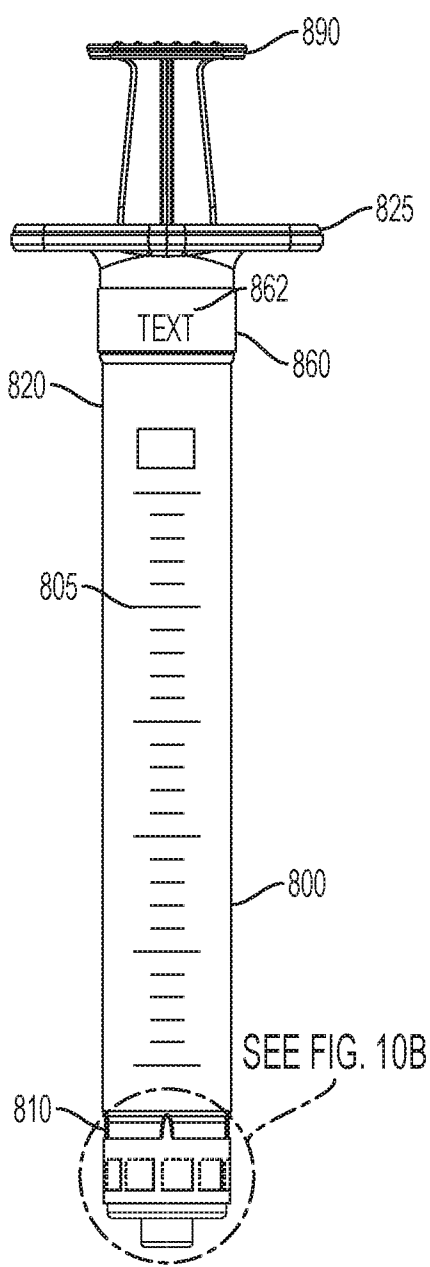

FIG. 10A

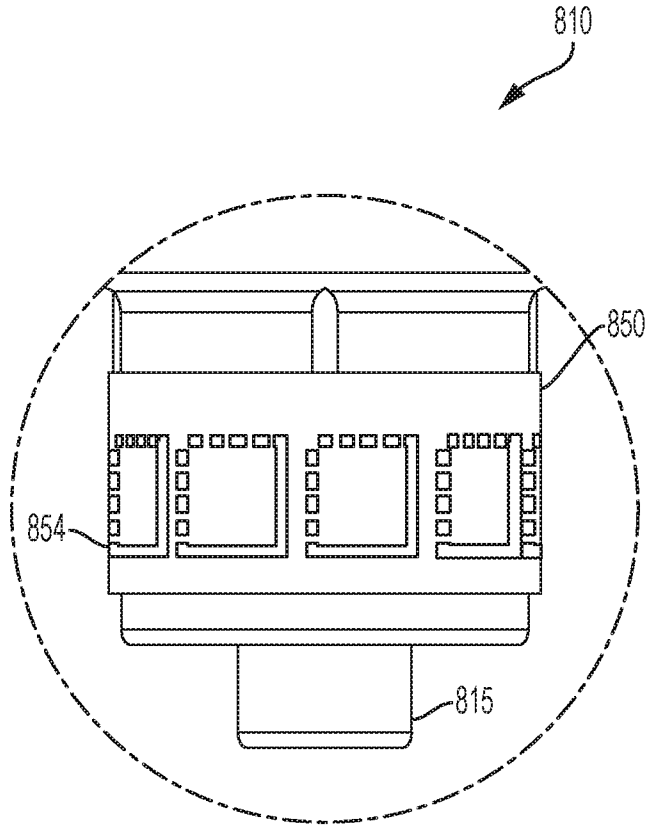

FIG. 10B

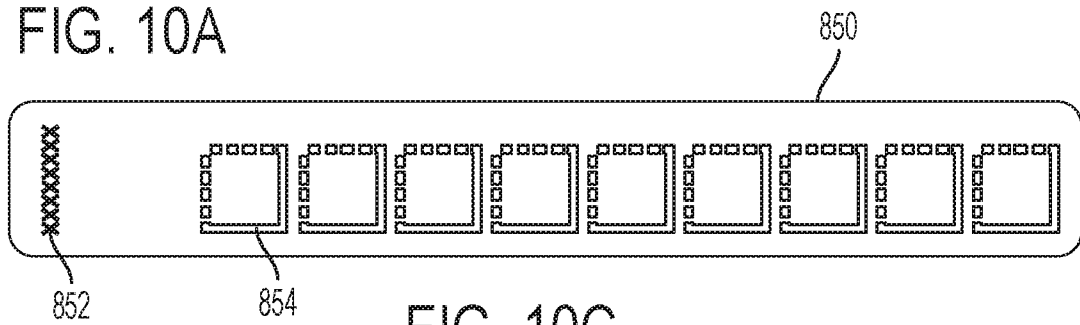

FIG. 10C

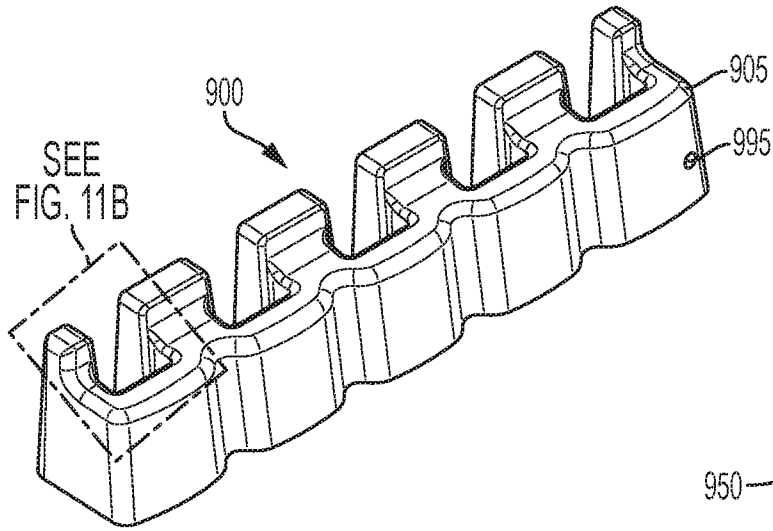

FIG. 11A

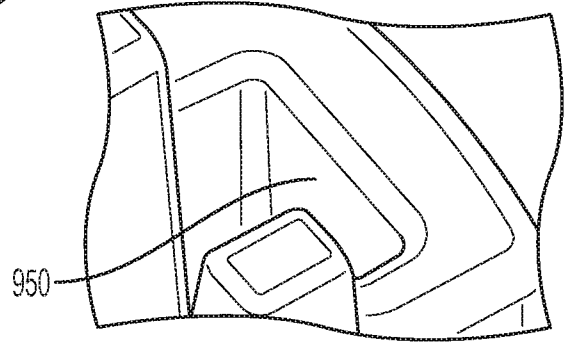

FIG. 11B

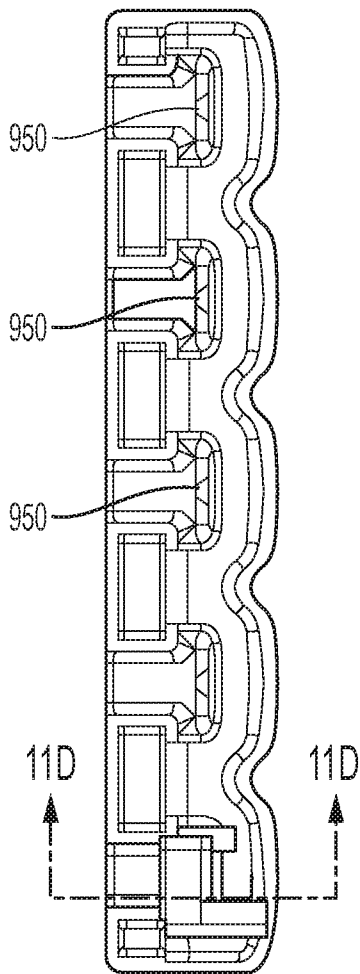

FIG. 11C

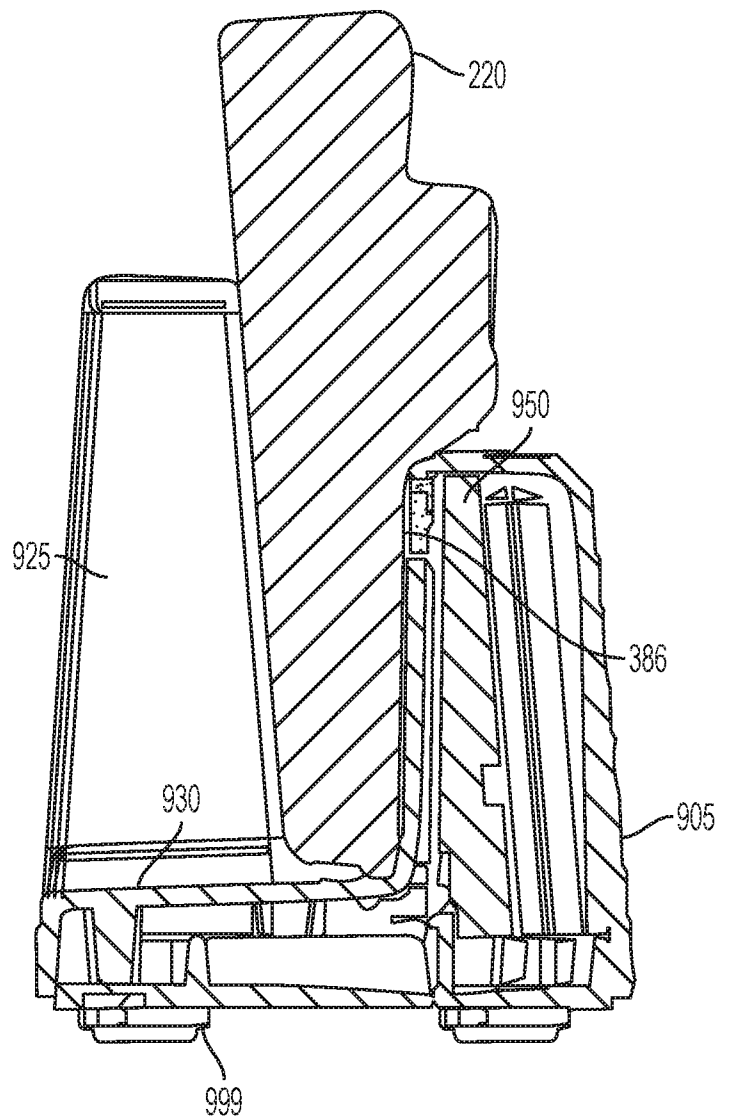

FIG. 11D

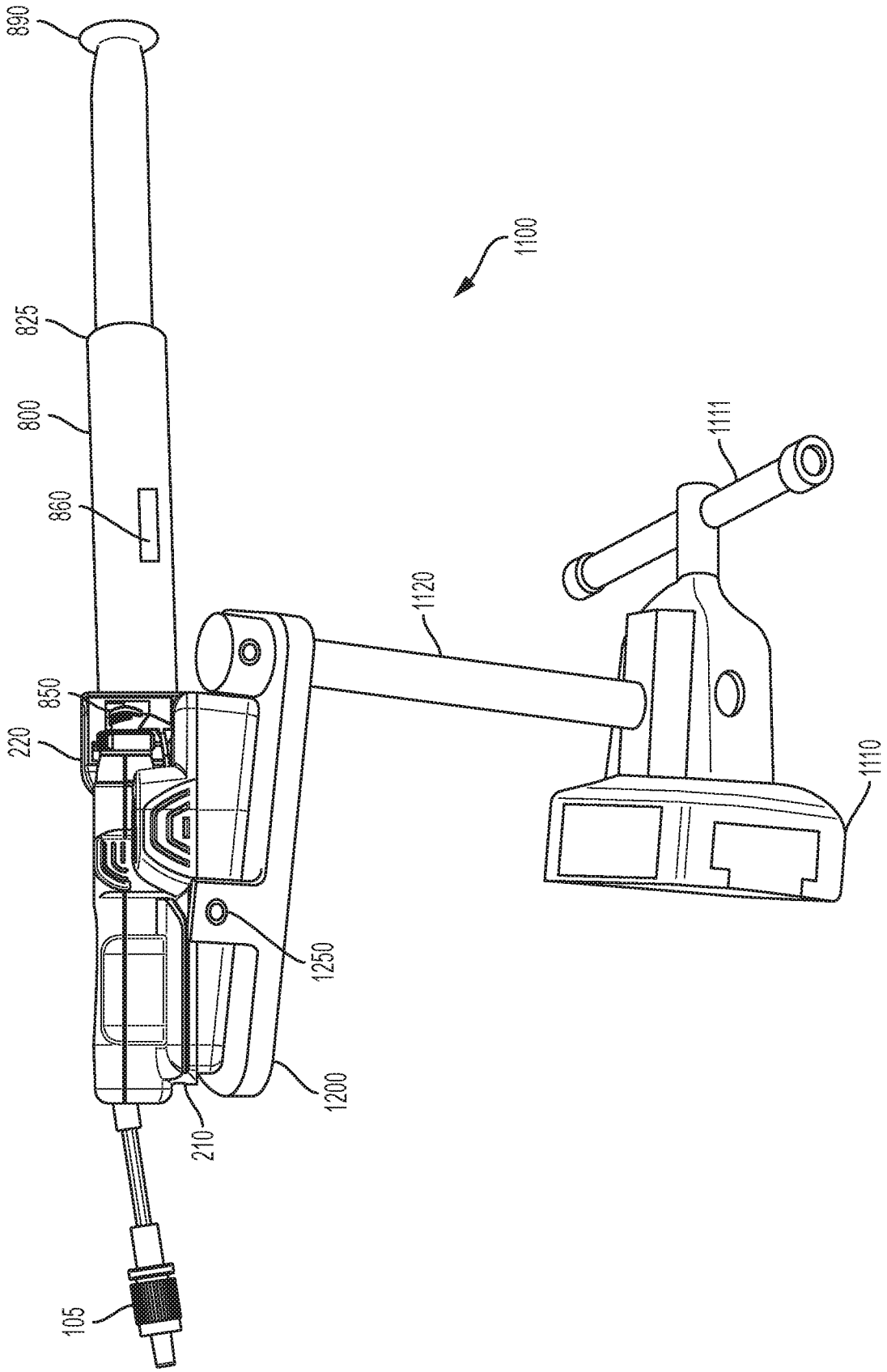

FIG. 12

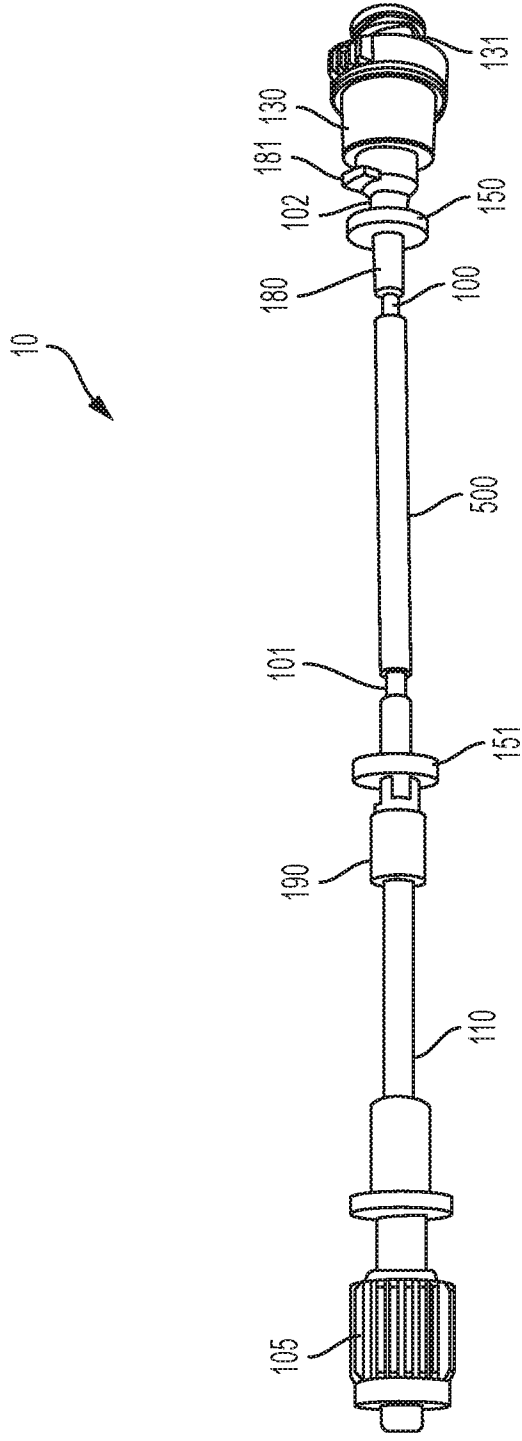

FIG. 13

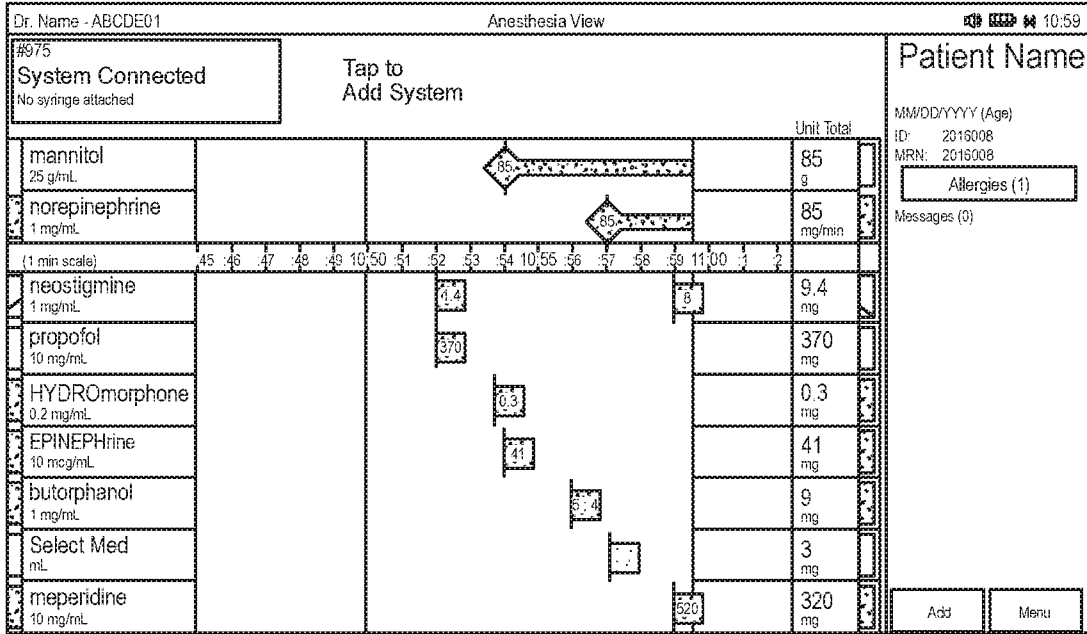

FIG. 14A

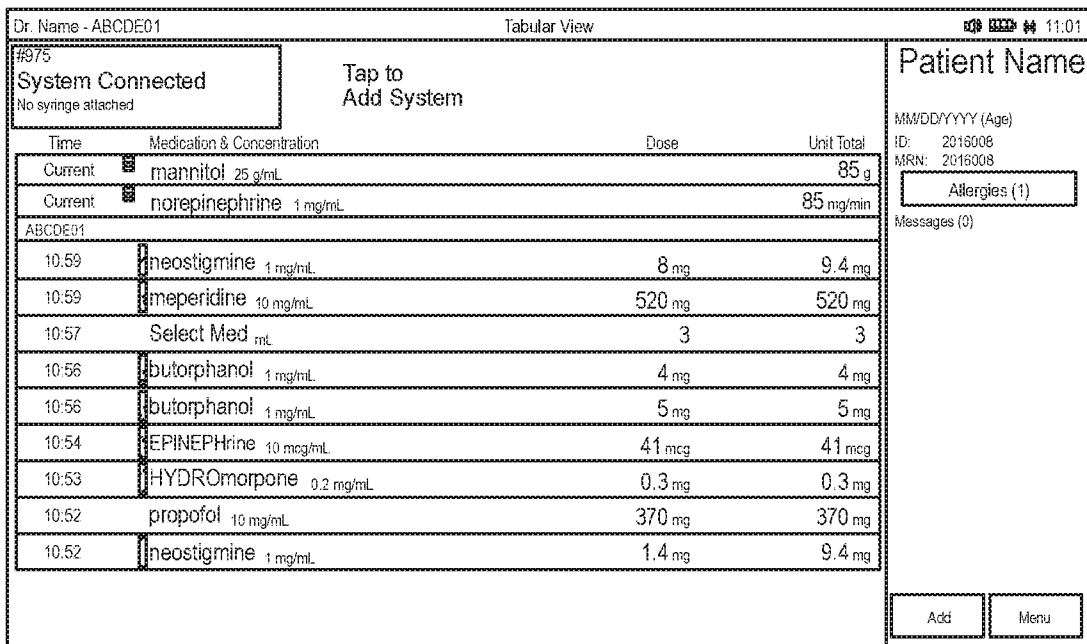

FIG. 14B

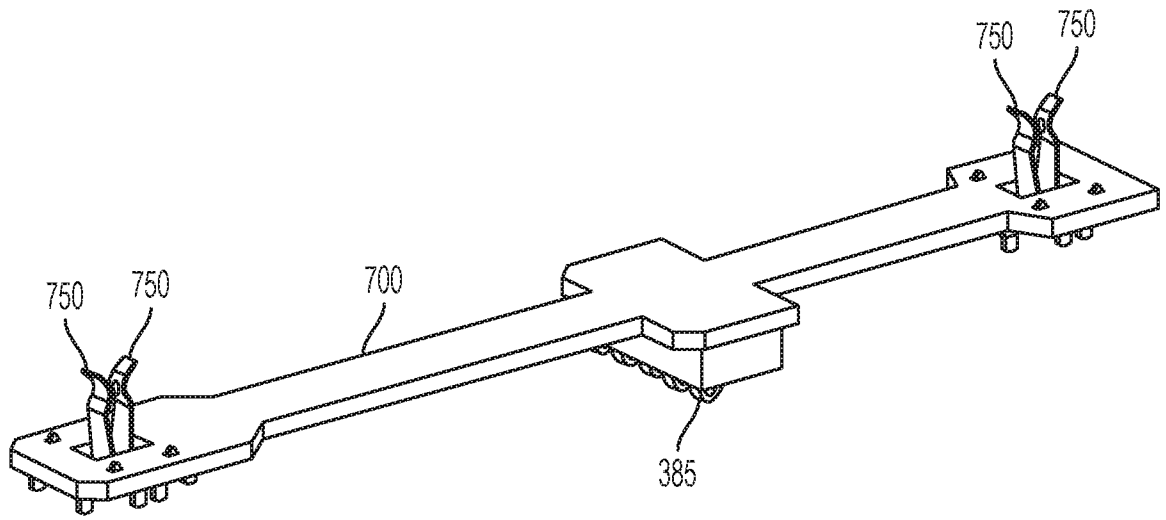

FIG. 15

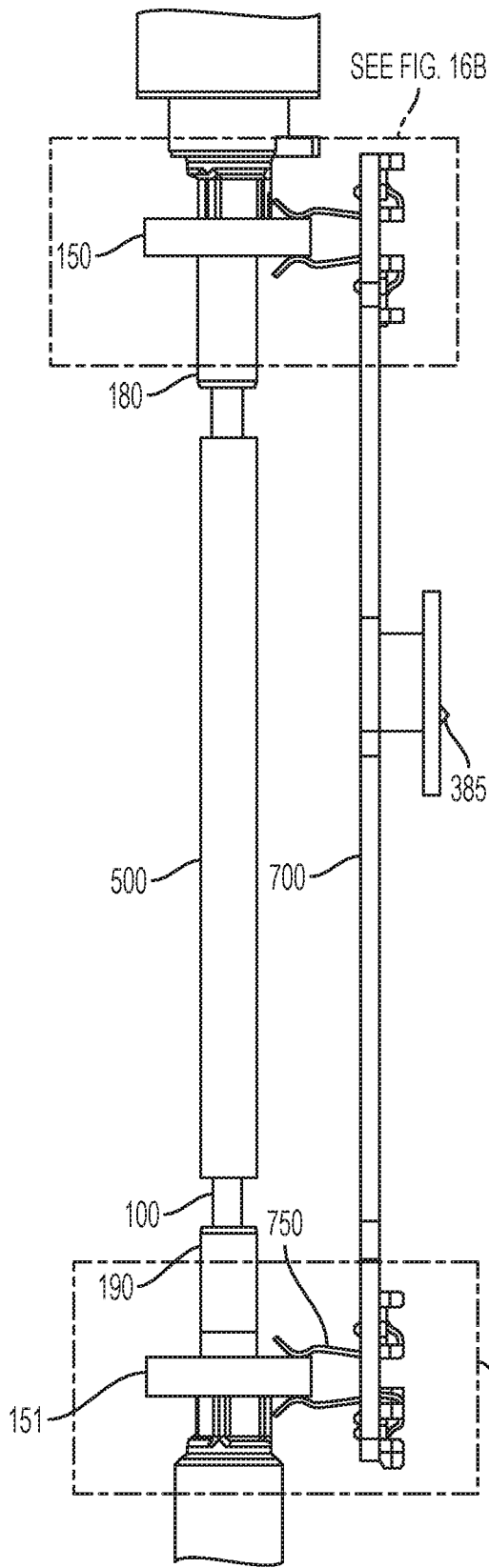

FIG. 16A

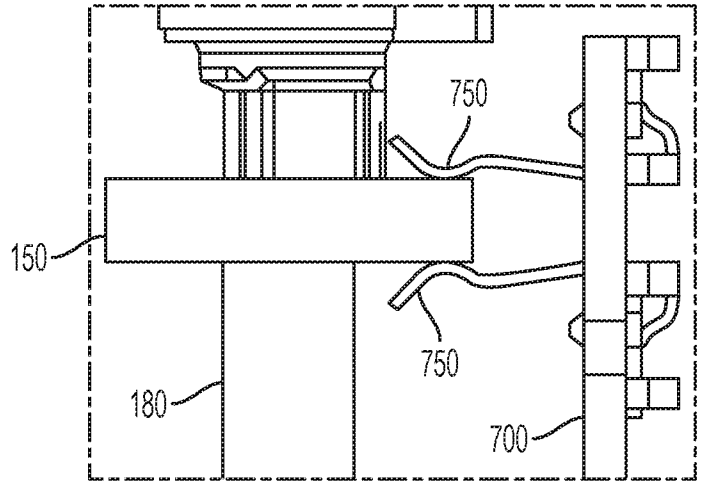

FIG. 16B

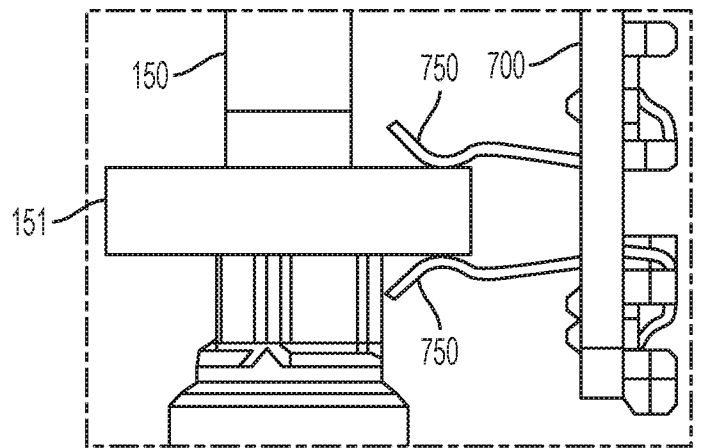

FIG. 16C

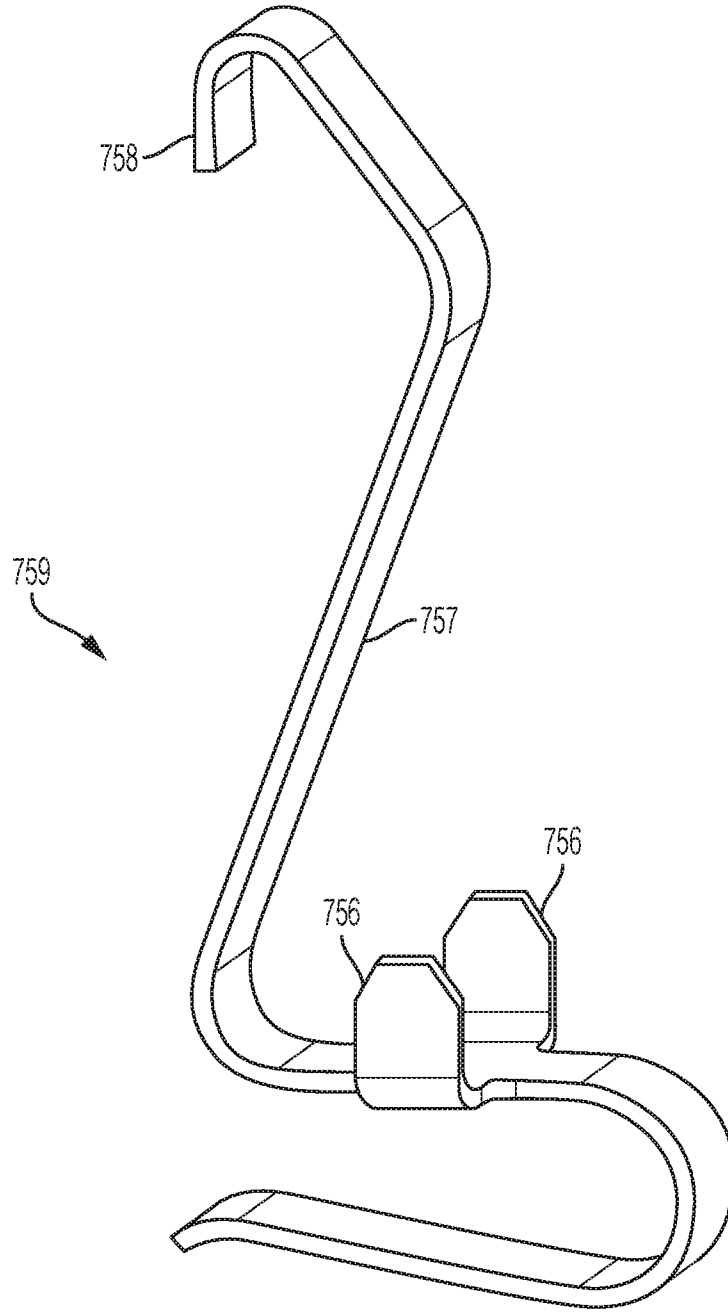

FIG. 17

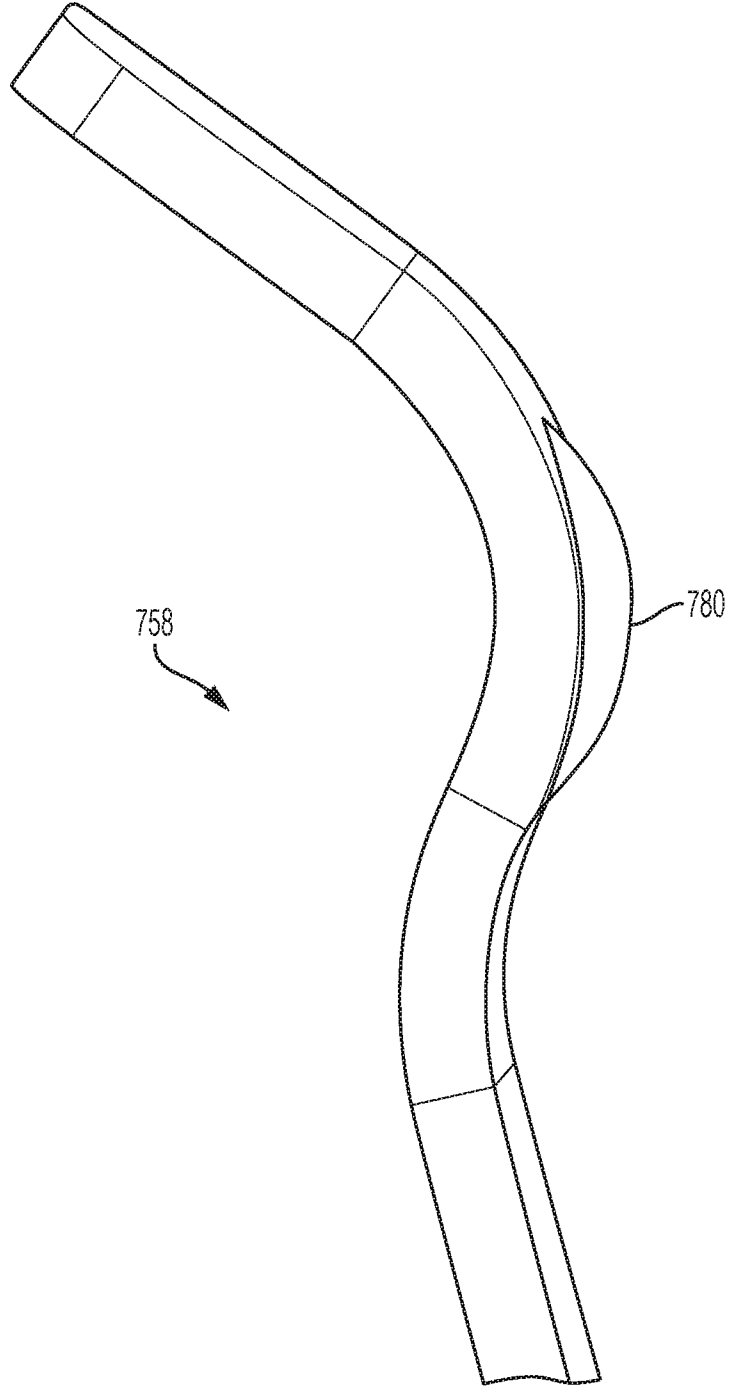

FIG. 18

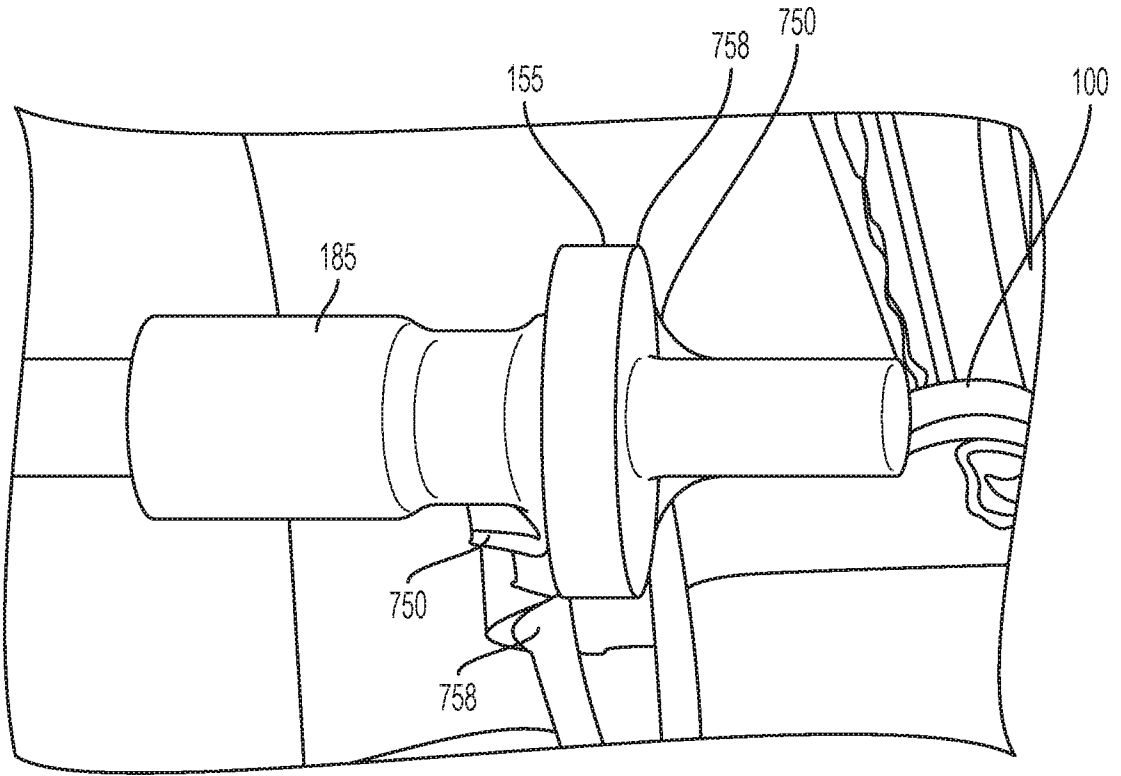

FIG. 19A

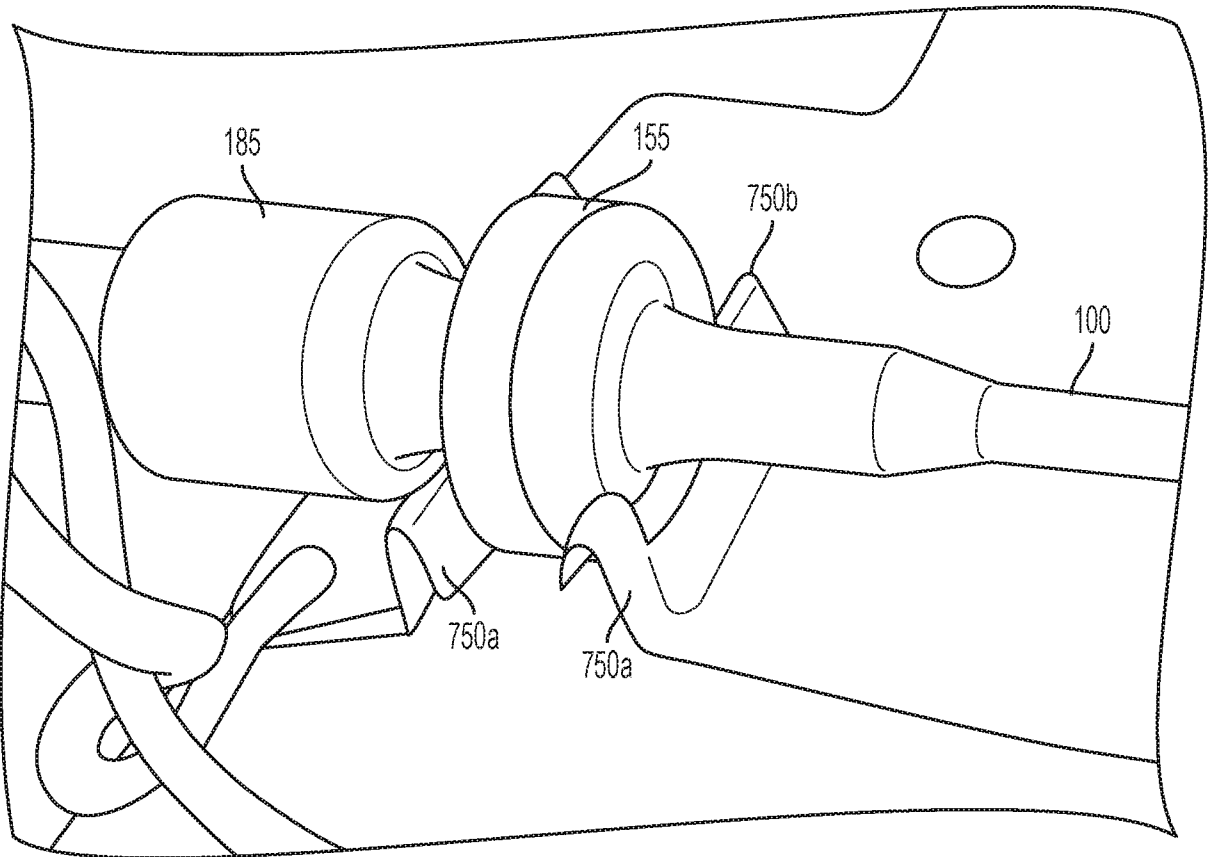

FIG. 19B

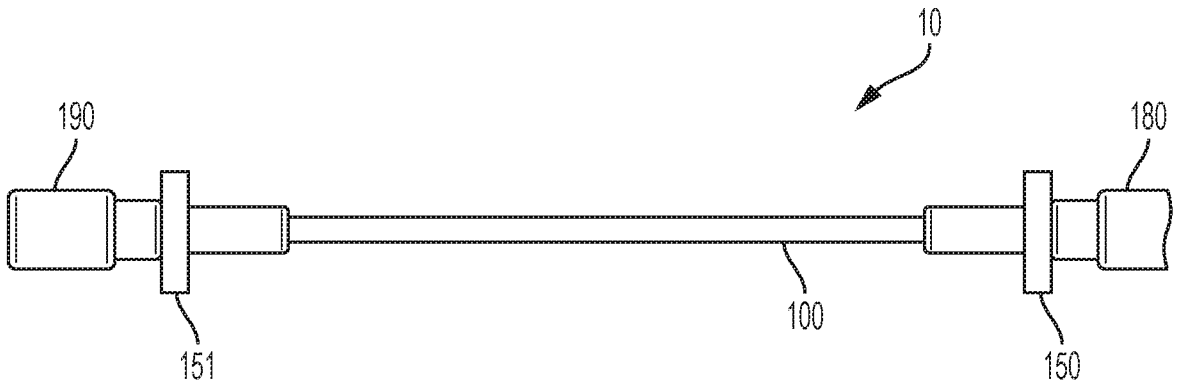

FIG. 20

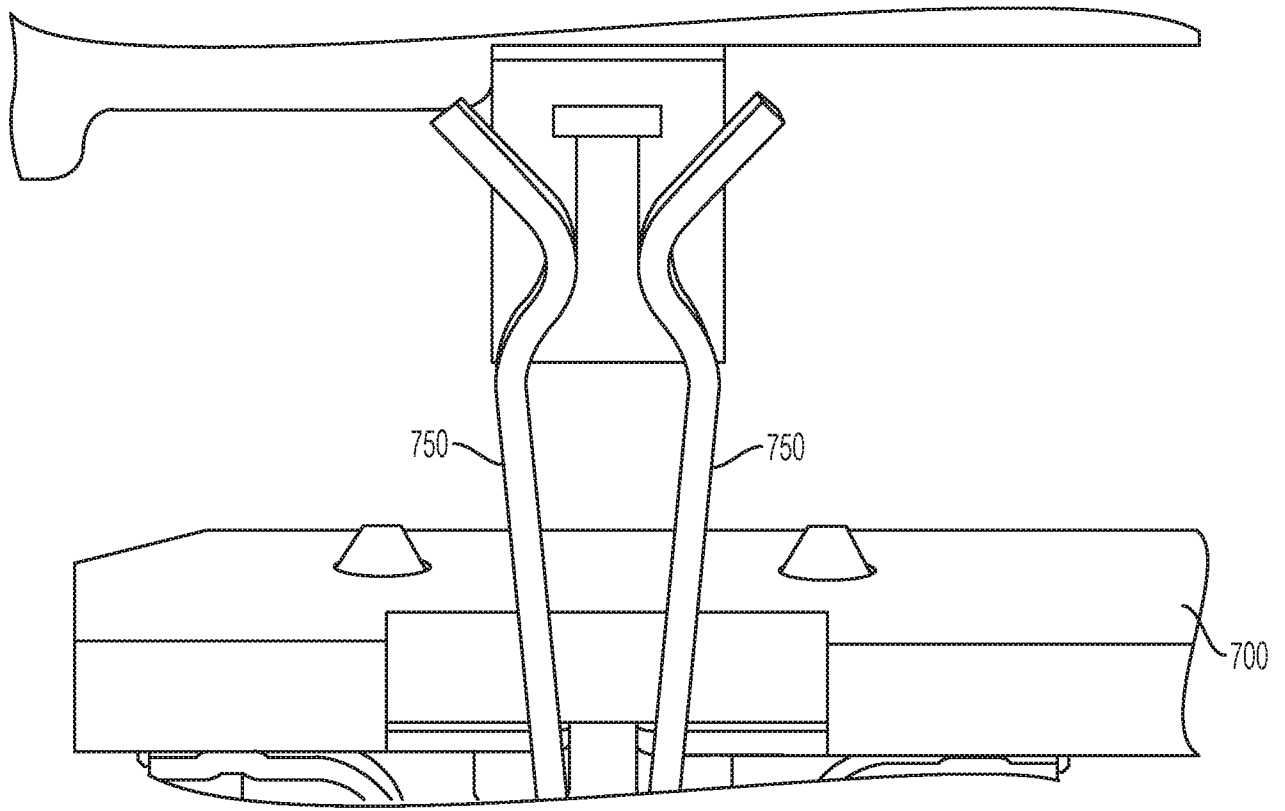

FIG. 21

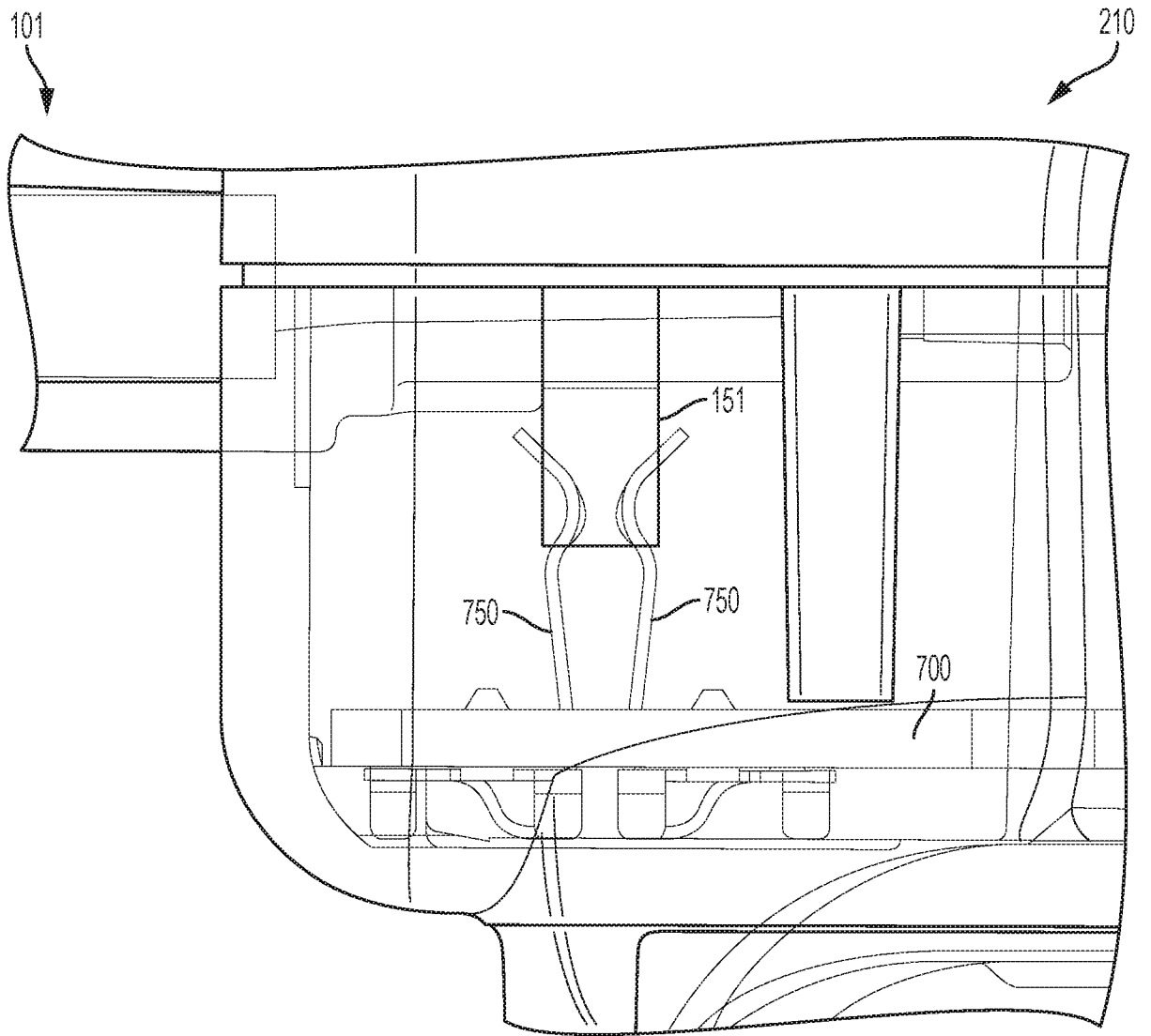

FIG. 22A

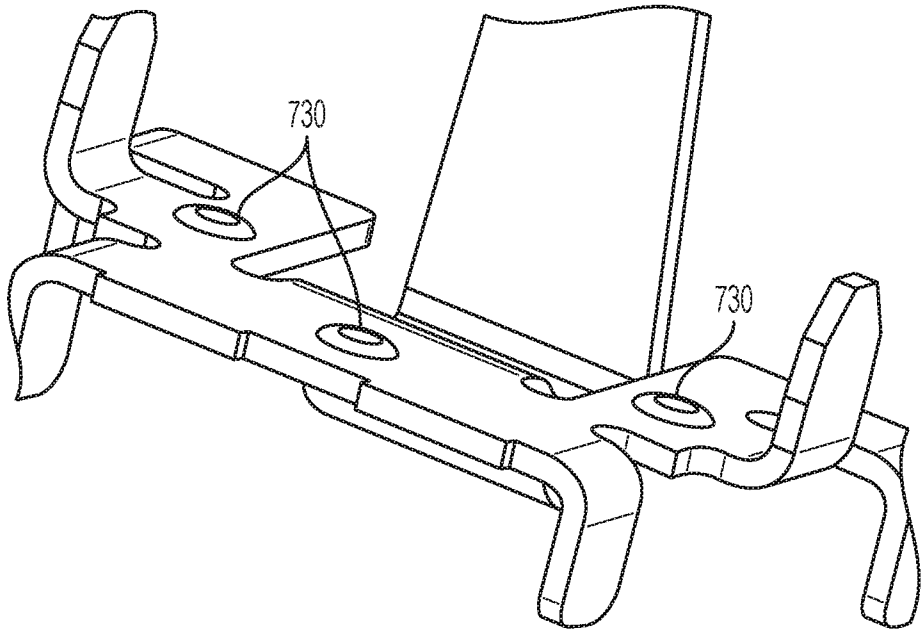

FIG. 22B