



INTERNATIONAL APPLICATION PUBLISHED UNDER THE PATENT COOPERATION TREATY (PCT)

(51) International Patent Classification ⁶ : A61M 16/00	A1	(11) International Publication Number: WO 97/11734 (43) International Publication Date: 3 April 1997 (03.04.97)
<p>(21) International Application Number: PCT/US96/15549</p> <p>(22) International Filing Date: 27 September 1996 (27.09.96)</p> <p>(30) Priority Data: 60/004,463 28 September 1995 (28.09.95) US</p> <p>(71) Applicant (for all designated States except US): NELLCOR PURITAN BENNETT INCORPORATED [US/US]; 4280 Hacienda Drive, Pleasanton, CA 94588 (US).</p> <p>(72) Inventors; and (75) Inventors/Applicants (for US only): FRYE, Mark, R. [US/US]; 3735 N. Birdie Gaylan Road, Bloomington, IN 47408 (US). GRENAWAY, John, R. [US/US]; 1249 W. 81st Street, Indianapolis, IN 46260 (US). DAVIS, Richard, A. [US/US]; 7373 Newcastle Road, Lafayette, IN 47905 (US). LEITHAUSER, Douglas, R. [US/US]; 3667 Stratford Place, Carmel, IN 46033 (US).</p> <p>(74) Agent: KOVACH, Dennis, E.; Nellcor Puritan Bennett Incorporated, Legal Dept., 4280 Hacienda Drive, Pleasanton, CA 94588 (US).</p>	<p>(81) Designated States: AU, CA, JP, US, European patent (AT, BE, CH, DE, DK, ES, FI, FR, GB, GR, IE, IT, LU, MC, NL, PT, SE).</p> <p>Published With international search report. Before the expiration of the time limit for amending the claims and to be republished in the event of the receipt of amendments.</p>	

(54) Title: OXYGEN-CONSERVING REGULATOR ASSEMBLY

(57) Abstract

An apparatus (10) is provided for controlling discharge of oxygen from an oxygen supply source (12) to a patient. The apparatus includes an oxygen supply inlet (47), a pressure regulator (14) coupled to the oxygen supply inlet and configured to reduce pressure of oxygen received from the oxygen supply inlet to a selected magnitude, a flow controller (16) coupled to the pressure regulator (14) and configured to meter oxygen received from the pressure regulator at a selected flow rate, and an oxygen distribution assembly including a pneumatic demand oxygen valve (18) and a conduit (51) conducting oxygen discharged from the flow controller through the pressure regulator to the pneumatic demand oxygen valve for delivery to a patient. The flow controller (16) includes a chamber (110) and a rotary valve (112) for splitting oxygen discharged from chamber (110) into a first stream in an oxygen supply passageway (51) for use by a patient and a second stream in a diaphragm supply passageway (48) for controlling operation of pneumatic demand oxygen valve.

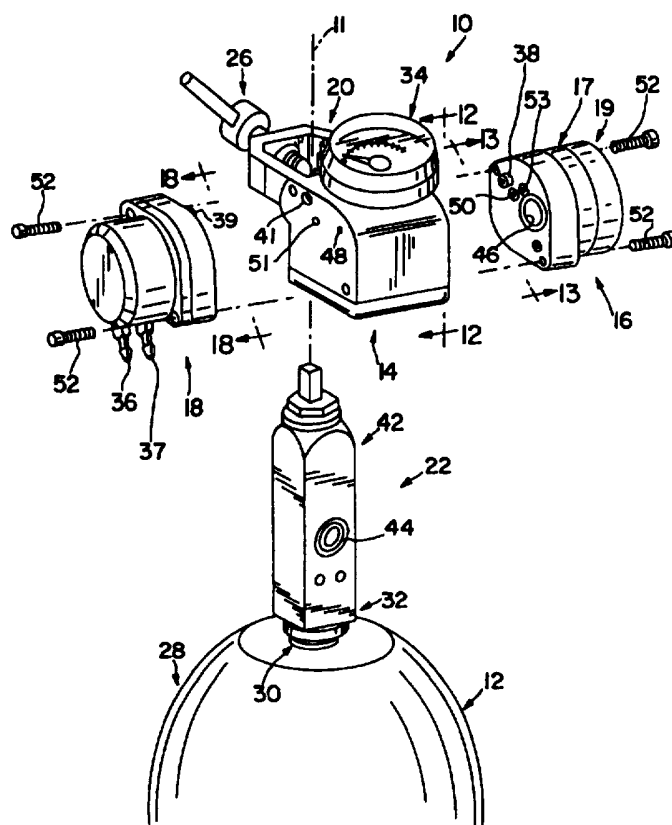

FOR THE PURPOSES OF INFORMATION ONLY

Codes used to identify States party to the PCT on the front pages of pamphlets publishing international applications under the PCT.

AM	Armenia	GB	United Kingdom	MW	Malawi
AT	Austria	GE	Georgia	MX	Mexico
AU	Australia	GN	Guinea	NE	Niger
BB	Barbados	GR	Greece	NL	Netherlands
BE	Belgium	HU	Hungary	NO	Norway
BF	Burkina Faso	IE	Ireland	NZ	New Zealand
BG	Bulgaria	IT	Italy	PL	Poland
BJ	Benin	JP	Japan	PT	Portugal
BR	Brazil	KE	Kenya	RO	Romania
BY	Belarus	KG	Kyrgystan	RU	Russian Federation
CA	Canada	KP	Democratic People's Republic of Korea	SD	Sudan
CF	Central African Republic	KR	Republic of Korea	SE	Sweden
CG	Congo	KZ	Kazakhstan	SG	Singapore
CH	Switzerland	LI	Liechtenstein	SI	Slovenia
CI	Côte d'Ivoire	LK	Sri Lanka	SK	Slovakia
CM	Cameroon	LR	Liberia	SN	Senegal
CN	China	LT	Lithuania	SZ	Swaziland
CS	Czechoslovakia	LU	Luxembourg	TD	Chad
CZ	Czech Republic	LV	Latvia	TG	Togo
DE	Germany	MC	Monaco	TJ	Tajikistan
DK	Denmark	MD	Republic of Moldova	TT	Trinidad and Tobago
EE	Estonia	MG	Madagascar	UA	Ukraine
ES	Spain	ML	Mali	UG	Uganda
FI	Finland	MN	Mongolia	US	United States of America
FR	France	MR	Mauritania	UZ	Uzbekistan
GA	Gabon			VN	Viet Nam

OXYGEN-CONSERVING REGULATOR ASSEMBLYBackground and Summary of the Invention

The present invention relates to an oxygen-
5 conserving regulator assembly, and particularly to an
oxygen-conserving regulator assembly for use with a high-
pressure oxygen system. More particularly, the present
invention relates to a modular oxygen-conserving regulator
assembly and to an integrated pressure regulator, oxygen-
10 flow control valve, and pneumatic demand oxygen valve
assembly.

Supplemental oxygen-delivery systems are provided
to administer medicinal gas, normally oxygen, to a patient
undergoing respiratory therapy. Supplemental oxygen-
15 delivery systems are used by patients that benefit from
receiving and breathing oxygen from an oxygen supply source
to supplement atmospheric oxygen breathed by the patients.

A compact, portable supplemental oxygen-delivery system is
useful in a wide variety of contexts, including hospital,
20 home care, and ambulatory settings.

High-pressure supplemental oxygen-delivery
systems typically include a cylinder or tank containing
oxygen gas at a pressure of up to 3000 psig. A pressure
regulator is used in a high-pressure oxygen-delivery system
25 to "step down" the pressure of oxygen gas in the tank to a
lower pressure level (e.g., 20 or 50 psig) suitable for use
in an oxygen-delivery apparatus used by a patient in
respiratory therapy.

The COMPANION® high-pressure portable oxygen
30 systems available from Nellcor Puritan Bennett
Incorporated, Cryogenic Equipment Division, Indianapolis,
Indiana, USA, include a COMPANION® 360 regulator/flow

controller unit Model No. 77231. This regulator/flow controller unit can be coupled to a high-pressure oxygen gas tank. This regulator/flow controller unit does not include a pneumatic demand valve.

5 A breathing assist apparatus including a flow controller and a pneumatic demand valve is disclosed in U.S. Patent No. 5,360,000 to Carter. A flow controller is included in the breathing assist apparatus to meter the flow rate of low-pressure oxygen (typically in liters per
10 minute) delivered to the patient. A pneumatic demand valve is included in the breathing assist apparatus to distribute oxygen to a patient only when oxygen is "demanded" by the patient during inhalation and thus functions to "conserve" oxygen by not distributing oxygen to an exhaling patient.
15 A demand valve delivers a pulse of oxygen at the onset of patient inspiration and continues to deliver oxygen throughout the entire patient inspiration. These demand valves do not deliver oxygen to the patient as the patient exhales.

20 Pneumatic demand oxygen valves are available from Nellcor Puritan Bennett Incorporated. For example, the COMPANION® 550 is a small lightweight portable liquid oxygen unit with a built-in demand valve and flow controller. A liquid oxygen unit contains liquid oxygen in
25 a reservoir and is very different from a high-pressure oxygen gas cylinder or tank oxygen-delivery system.

 What is needed is an oxygen-conserving regulator assembly that is modular and includes a pressure regulator, an oxygen-flow controller, and a pneumatic demand oxygen
30 valve. Consumers would welcome a modular unit that could be reconfigured easily by replacing one modular component such as, for example, the flow controller or the pneumatic

demand oxygen valve with another modular component to adapt the modular unit to current needs of a patient.

What is further needed is an integrated pneumatic demand oxygen valve and regulator assembly that is suitable
5 for use with a high-pressure oxygen gas system.

Integration of a pneumatic demand oxygen valve in a high-pressure oxygen-delivery system including a pressure regulator, and perhaps also an oxygen-flow controller, would provide a patient using a high-pressure oxygen gas
10 system with the benefits of a pneumatic demand oxygen valve.

What is also needed is an oxygen-flow controller that is operable to provide oxygen to a patient either continuously or on patient demand without requiring a
15 patient to operate a separate continuous/demand oxygen flow selector switch mounted on a separate demand-type pneumatic oxygen valve in the conventional way. Patients would appreciate the ease of using a continuous/demand selector switch integrated in an oxygen-flow controller.

20 According to the present invention, an apparatus is provided for controlling discharge of oxygen from an oxygen supply source to a patient. The apparatus includes an pressure regulator module, a flow controller module coupled to one side of pressure regulator module, and a
25 pneumatic demand valve module coupled to another side of pressure regulator module. Oxygen is constrained to flow from the oxygen supply along a path to a patient through, in sequence, pressure regulator module, flow controller module, and pneumatic demand valve module.

30 In preferred embodiments, flow controller module includes an internal chamber for receiving oxygen discharged by the pressure regulator module and valve means

for splitting the flow of oxygen discharged from the internal chamber into a first oxygen stream and a second oxygen stream. The first oxygen stream is conducted along a conduit through the pressure regulator module and the
5 pneumatic demand valve module to reach a breathing cannula worn by a patient. The second oxygen stream is conducted along an auxiliary conduit through the pressure regulator module to reach and control a valve positioned in the
10 pneumatic demand valve module and pneumatically coupled to an inhale/exhale sensing diaphragm also positioned in the pneumatic demand valve. The splitting means includes a rotary valve that extends into internal chamber and can be rotated about an axis to adjust flow controller module to operate in either "demand" mode, "continuous" mode, or
15 "off" mode.

Additional features and advantages of the invention will become apparent to those skilled in the art upon consideration of the following detailed description of preferred embodiments exemplifying the best mode of
20 carrying out the invention as presently perceived.

Brief Description of the Drawings

The detailed description particularly refers to the accompanying figures in which:

25 Fig. 1 is a perspective view of a modular oxygen-conserving regulator assembly in accordance with the present invention mounted on an oxygen tank;

Fig. 2 is an exploded view of the modular regulator assembly of Fig. 1 showing a central pressure
30 regulator module for mounting on the underlying oxygen tank, a right-side oxygen-flow controller module, and a left-side pneumatic demand oxygen valve module for

delivering oxygen to a patient through one tube and receiving a signal that the patient is inhaling or exhaling through another tube;

Fig. 3 is a top plan view of the regulator assembly and tank shown in Fig. 1;

Fig. 4 is a left-side elevational view of the regulator assembly and tank shown in Fig. 1;

Fig. 5 is a front elevational view of the regulator assembly and tank shown in Fig. 1;

Fig. 6 is a view similar to Fig. 5 showing that other modular components can be mounted to the left side of the pressure regulator module in lieu of the pneumatic demand oxygen valve module;

Fig. 7 is a schematic view of the assembly of Fig. 1 coupled to a patient breathing cannula showing a rotary valve in the right-side oxygen-flow controller module positioned in a "demand" mode to distribute a portion of the oxygen received from the regulator module through a diaphragm supply passageway formed in the regulator module to a diaphragm biasing chamber formed in the left-side pneumatic demand valve module and to distribute another portion of the oxygen through a patient supply passageway formed in the regulator module to an oxygen supply chamber formed in the pneumatic demand valve module and showing that the oxygen pressure in the diaphragm biasing chamber is high enough to move a diaphragm valve member to a closed position blocking discharge of oxygen from the oxygen supply chamber to an exhaling patient wearing the patient breathing cannula;

Fig. 7A is a schematic view similar to Fig. 7 showing that the diaphragm valve member will move to an opened position and the patient will receive oxygen from

the oxygen supply chamber as soon as the patient begins to inhale;

Fig. 8 is a schematic view similar to Fig. 7 showing the rotary valve positioned in a "continuous flow" mode to block oxygen flow from the oxygen-flow controller module to the pneumatic demand valve module through the diaphragm supply passageway to "disable" the pneumatic demand valve module (by allowing the diaphragm to be moved to and retained in its opened position by pressurized oxygen flowing out of the oxygen supply chamber to the patient) and to allow "continuous" oxygen flow from the oxygen-flow controller module to the pneumatic demand valve module through the patient supply passageway so that a patient using the breathing cannula will receive oxygen when inhaling and exhaling;

Fig. 9 is a schematic view similar to Figs. 7 and 8 showing the rotary valve positioned in an "off" mode to block any oxygen flow from the oxygen-flow controller module to the pneumatic demand oxygen module through both of the diaphragm and patient supply passageways formed in the regulator;

Fig. 10 is a transverse sectional view of the pressure regulator module of Fig. 2;

Fig. 11 is a bottom view of the pressure regulator module taken along lines 11-11 of Fig. 10;

Fig. 12 is an elevational view of the right side of the pressure regulator module of Fig. 2 taken from line 12-12 of Fig. 2 looking toward the pressure regulator;

Fig. 13 is an elevational view of the left side of the oxygen-flow controller module taken from line 13-13 of Fig. 2 looking toward the oxygen-flow controller module;

Fig. 14 is a perspective view of the rotary valve included in the oxygen-flow controller module taken from the "front" showing a C-shaped groove and a surrounding ring of flow passage outlets formed in a front face of the rotor in the rotary valve;

Fig. 15 is a perspective view of the rotary valve of Fig. 14 taken from the "rear" showing an inner ring of detent-receiving circular depressions and an outer ring of flow passage inlets formed in a rear face of the rotor in the rotary valve;

Fig. 16 is a sectional view of the oxygen-flow controller module taken along line 16-16 of Fig. 13 showing a housing formed to include a chamber containing the rotor included in the rotary valve, one oxygen input channel for introducing oxygen into the chamber formed in the housing, and two oxygen output channels for receiving oxygen that has been "metered" in the chamber by the rotor to a selected flow rate (liters per minute) and discharging the metered oxygen from the chamber to both of the diaphragm and patient supply passageways formed in the pressure regulator module;

Fig. 17 is an elevational view of the front face of the rotor that is shown diagrammatically in Figs. 7-9 and illustratively in Figs. 14-16;

Fig. 18 is an elevational view of the right side of the pneumatic demand valve module taken from line 18-18 of Fig. 2 looking toward the pneumatic demand valve module;

Fig. 19 is a sectional view of the pneumatic demand valve module taken along line 19-19 of Fig. 18 showing that no oxygen flows from the oxygen supply chamber in the pneumatic demand valve module to the patient as the patient exhales because oxygen supplied through the

diaphragm supply passage pressurizes the biasing chamber in the pneumatic demand valve module to urge the diaphragm valve member to a closed position;

5 Fig. 20 is a view similar to Fig. 19 showing that oxygen flows from the oxygen supply chamber to the patient during patient inhaling because a separate inhale/exhale sensing diaphragm moves to vent pressurized oxygen in the biasing chamber so that the diaphragm valve member is moved by a spring and pressurized oxygen in the oxygen supply
10 chamber to an opened, oxygen-supply position;

Fig. 21 is a view similar to Fig. 19 of an alternative embodiment of a pneumatic demand valve module configured to include a separate "continuous/demand" flow selector switch in the pneumatic demand valve module;

15 Fig. 22 is a sectional view of the selector switch taken along line 22-22 of Fig. 21;

Fig. 23 is a perspective view showing assembly of the oxygen-flow controller module onto a right-side face of the pressure regulator module using a mounting orientation
20 post appended to the oxygen-flow controller module;

Fig. 24 is a perspective view showing assembly of the pneumatic demand valve module onto a left-side face of the pressure regulator module using a mounting orientation post appended to the pneumatic demand valve;

25 Fig. 25 is a plan view of an alternative embodiment of a regulator assembly in accordance with the invention configured to include a nut and tailpiece connector; and

30 Fig. 26 is a side elevation of the regulator assembly of Fig. 25 mounted on an oxygen tank.

Detailed Description of the Drawings

An oxygen-conserving regulator assembly 10 is mounted on a cylinder 12 containing oxygen as shown in Fig. 1. Oxygen-conserving regulator assembly 10 functions as a patient breathing assist apparatus to distribute pressurized oxygen received from cylinder 12 to a patient in need of oxygen at a pressure, flow rate, timing, and mode of delivery (e.g., on-demand flow or continuous flow).

Pressure regulator module 14 functions to convert high-pressure oxygen discharged from cylinder 12 into low-pressure oxygen suitable for use in an oxygen-delivery apparatus used by a patient undergoing oxygen therapy. Oxygen-flow controller module 16 functions to meter low-pressure oxygen discharged from pressure regulator module 14 at a certain flow rate (typically measured in liters per minute). Pneumatic demand oxygen valve module 18 functions to take low-pressure, metered oxygen from the oxygen-flow controller module 16 and distribute it to a patient at various times in response to inhalation of the patient through a cannula (see Figs. 7-9) coupled to pneumatic demand oxygen valve module 18 and worn by the patient.

Oxygen-conserving regulator assembly 10 also includes a yoke 20 connected to regulator module 14 and configured to be connected to post valve 22 as shown, for example, in Fig. 1. Yoke 20 is formed to include a post-receiving channel 24 and T-handle retainer assembly 26 for selectively engaging and fixturing a post valve 22 extending upwardly from cylinder 12 into the post-receiving channel 24 formed in yoke 20.

Cylinder 12 is any cylinder or tank suited for containing high-pressure oxygen. Cylinder 12 includes an upper dome 28 having an oxygen-discharge outlet 30

configured to be coupled in a conventional manner to a lower end 32 of post valve 22 as shown best in Figs. 2 and 4.

Pressure regulator module 14 carries a pressure gauge 34 for advising a consumer of the remaining oxygen pressure in the cylinder 12. Regulator module 14 is a modular unit that provides reduced-pressure oxygen to flow controller module 16. One reason for mounting the regulator module 14 between flow controller module 16 and demand module 18 is to balance the weight and mass of oxygen-conserving regulator assembly 10 relative to underlying cylinder 12. Regulator module 14 is positioned to lie within the "envelope" of cylinder 12 as shown in Figs. 1 and 3-5 to keep the center of gravity of assembly 10 as close as possible to the vertical central axis 11 through cylinder 12.

One reason for routing the oxygen gas back and forth across the regulator module 14 as disclosed herein is to permit a design that keeps the mass of regulator assembly 10 near the vertical central axis 11 of cylinder 12. This helps with stability and packaging concerns. Conventional regulator/flow-control devices tend to be linear and extend out a distance from the central vertical axis of a cylinder like cylinder 12.

The flow controller module 16 shown in the drawings is a variable flow meter configured so that a user can select the flow rate of oxygen to be discharged into the pneumatic demand module 18 for delivery to a patient. Flow controller module 16 is a modular unit including a base 17 and a flow selector knob 19 movable relative to base 17 to change the flow rate of oxygen discharged from flow controller module 16.

It is within the scope of this invention to use a flow controller that contains a preset fixed orifice flow meter instead of a variable flow meter as shown in the drawings. The type of flow controller module 16 is not
5 limited to a fixed orifice. It would be possible to use a Thorp tube type of controller (similar to a needle valve which includes a floating ball indicator).

Oxygen that is discharged from flow controller module 16 passes through at least one oxygen-delivery
10 channel (two channels are shown in Fig. 7) formed in regulator module 14 to reach demand module 18. Flow controller module 16 is configured in accordance with the present invention so that it can be operated by a patient to split the incoming flow of low-pressure oxygen received
15 from the regulator module 14 in the flow controller module 16 into two oxygen flow streams. In the manner explained in more detail below, one of the oxygen flow streams will be used to supply oxygen via demand module 18 to the patient using regulator assembly 10 and the other oxygen
20 flow stream will be used to control opening and closing of a diaphragm valve member (see Figs. 7, 7A, 19, and 20) included in demand module 18 to regulate supply of oxygen to the patient using regulator assembly 10.

Demand module 18 includes a suitable pneumatic
25 demand valve system of the type designed for coupling between a source of pressurized gas and a recipient user. This pneumatic demand valve achieves a high degree of sensitivity and flow control without expensive, bulky valving arrangements characteristic of many demand valves.

30 Demand module 18 includes a sensing port 36 and a gas outlet 37. A cannula 62 (shown in Figs. 7-9) is coupled to port 36 and gas outlet 37 to enable a patient to

receive oxygen from and communicate breath inputs (e.g., inhalation suction and exhalation pressure) to demand module 18.

The modular nature of oxygen-conserving regulator assembly 10 is shown, for example, in Fig. 2. In this exploded assembly view, one can see an upright post valve 22 coupled to oxygen-discharge outlet 30 on oxygen cylinder 12. Pressure regulator module 14 is integrally coupled to yoke 20 and arranged so that an upper end 42 of post valve 22 can pass through post-receiving channel 24 formed in yoke 20. Post valve 22 includes an oxygen-discharge outlet 44 for discharging high-pressure oxygen from cylinder 12 into an inlet orifice 47 (shown in Fig. 7) formed in pressure regulator 14. An example of a suitable post valve 22 is a CGA (Compressed Gas Association) 870 yoke valve.

In the illustrated embodiment, bolts 52 and O-ring sealing gasket 54 are used to establish sealed, mounting connections between the pressure regulator module 14 and pneumatic demand oxygen valve module 18. Bolts 52 and a variety of O-ring seals are also used as shown in Fig. 13 to establish sealed mounting connections between flow controller module 16 and pressure regulator module 14.

It is within the scope of the present invention to use a variety of suitable detachable connector means for attaching regulator module 14 to each of flow controller module 16 and demand module 18. For example, a threaded connection system, a bayonet connection system, or a ball and race attachment connection system could be used to couple these modular components to one another.

Turning now to Fig. 3, which is a plan view of oxygen-conserving regulator assembly 10 and cylinder 12, it will be seen that the T-handle retainer assembly is

rotatably mounted on one end of yoke 20 and operable to engage and couple post valve 22 to regulator module 14. A suitable T-handle retainer assembly is disclosed in U.S. Patent No. 4,752,089. In the illustrated embodiment, regulator module 14 is positioned to lie between demand module 18 and flow controller module 16. In an alternative embodiment (not shown), flow controller valve module 16 could be positioned to lie between regulator module 14 and demand module 18.

10 A side elevation of oxygen-conserving regulator assembly 10 in a mounted position on top of oxygen cylinder 12 is shown in Fig. 4. Also, a front elevation view of oxygen-conserving regulator assembly 10 mounted on cylinder 12 is shown in Fig. 5.

15 A modular oxygen-conserving regulator assembly 10 of the type disclosed herein is configured to enable a healthcare service technician to replace pneumatic demand oxygen valve module 18 in oxygen-conserving regulator 10 with other modular components or units as shown, for example, in Fig. 6. For example, each of a rotatable oxygen discharge outlet unit 56, a designated flow outlet unit 58, or a DISS (i.e., Diameter-Index Safety System) unit 60 can be detachably coupled to pressure regulator module 14 using a suitable attachment mechanism in the position alternatively occupied by pneumatic demand oxygen valve module 18. This type of modular component system enables users to adapt and reconfigure oxygen-conserving regulator assembly 10 as required to suit particular oxygen therapy circumstances facing a patient.

30 Pressure regulator module 14 is formed to include an oxygen outlet 49 (shown, for example, in Fig. 7) for discharging low-pressure oxygen into an inlet passage 53

formed in flow controller module 16 as shown, for example, in Figs. 2 and 7. Flow controller module 16 also includes first outlet means 46 for discharging low-pressure, metered oxygen into a horizontally extending supply passageway 48
5 formed in regulator module 14 and coupled to demand module 18 as shown, for example, in Figs. 2, 7, 7A, and 10-12. Also, low-pressure, metered oxygen can flow through second outlet means 50 formed in flow controller module 16 to demand module 18 through a horizontally extending oxygen
10 supply passageway 51 formed in regulator module 14 as shown, for example, in Figs. 2, 7, 7A, 8, and 10-12. In a presently preferred embodiment, passageways 48, 51 are really drilled passageways formed in pressure regulator module 14.

15 The design in accordance with the present invention is intended to provide a high-pressure oxygen-gas regulation system that allows the application of existing and future oxygen-conservation technology. The modular regulator concept disclosed herein would accommodate
20 various control and outlet modules. Control modules include various ranges of flow control valves, fixed flow orifices, or variable flow-metering valves. Outlet modules would initially include barbed fittings, DISS fittings, multiple fittings, pneumatic demand device conserving
25 devices, or various rotating fittings. Alternative outlet modules may include a pneumatic pulse conservation device or electronic control modules (pulse or feedback compensated precision flow). Customers could upgrade units or configure existing units as desired.

30 Provision of an integral regulator unit 10 including a pneumatic demand oxygen valve module 18, flow controller module 16, and pressure regulator module 14 as

disclosed herein eliminates tubing connections between existing pulse devices and stand-alone regulators (not shown). This design, in accordance with the present invention, provides a lightweight, compact, portable oxygen-conservation system for patients in need of supplemental oxygen.

Diagrammatic illustrations of modular regulator assembly 10 are provided in Figs. 7-9 to show how assembly 10 can be operated to control the flow of oxygen gas from high-pressure oxygen gas cylinder 12 to a patient wearing and using a breathing cannula 62. Regulator assembly 10 is functioning in "demand" mode in Figs. 7 and 7A to deliver oxygen to a patient only when the patient breathing through cannula 62 is inhaling and in "continuous" mode in Fig. 8 to deliver oxygen continuously to the patient whether the patient is inhaling through or exhaling into cannula 62. Regulator assembly 10 is shown in its "off" mode in Fig. 9 so that no oxygen gas is flowing from cylinder 12 to cannula 62 through regulator assembly 10.

Fig. 7 shows how air exhaled by a patient into cannula 62 is transmitted through sensing port 36 to demand module 18 to cause a diaphragm valve member 64 and an inhale/exhale sensing diaphragm 66 positioned in demand module 18 to cooperate to block flow of oxygen passing through oxygen supply passageway 51 formed in regulator module 14 into an oxygen supply chamber 68 formed in demand module 18 from demand module 18 into cannula 62. Fig. 7A shows how the inhale/exhale sensing diaphragm 66 moves to an actuated position whenever a patient breathing through cannula 62 inhales to allow pressurized oxygen in oxygen supply chamber 68 in demand module 18 to assist in moving diaphragm valve member 64 to a venting position so that

oxygen is discharged from demand module 18 into cannula 62 through gas outlet 37.

Dual lumen cannula 62 is shown diagrammatically in Figs. 7-9. Cannula 62 includes a flexible gas supply tube 70 and a sensing tube 72. Gas supply tube 70 is coupled to gas outlet 37 on demand module 18 and adjacent to the patient divides at juncture 74 to present two branch legs 76, 78. These branch legs 76, 78 are interconnected by means of a nasal delivery structure 80 including a pair of spaced-apart gas delivery tubes 82 insertable into the nasal cavities of a patient. Sensing tube 72 is coupled to sensing port 36 on demand module 18 and adjacent to the patient divides at juncture 84 to present two branch legs 86, 88. A pair of short sensing tubes 90 are located within the spaced-apart gas delivery tubes 82 and coupled to branch legs 86, 88. The function of sensing tube 72 is to convey and transmit via short sensing tubes 90 the pressure conditions induced during the patient's breathing efforts, such pressure conditions being transmitted to inhale/exhale sensing diaphragm 66 in demand module 18 via sensing port 16.

Referring now to Fig. 7, regulator assembly 10 is shown in demand mode during patient exhaling. Breath exhaled by the patient wearing cannula 62 into the two short sensing tubes 90 provided in nasal delivery structure 80 is represented diagrammatically by two downwardly pointing arrows 92.

Pressure regulator module 14 includes a conventional internal regulator mechanism 94 coupled to oxygen inlet 47 via inlet conduit 96 and to oxygen outlet 49 via outlet conduit 98. Regulator mechanism 94 (shown in more detail in Figs. 10-12) operates in a conventional

manner to convert high pressure (e.g., 3000 psi) oxygen gas admitted through inlet conduit 96 into low pressure (e.g., 20 or 50 psi) oxygen gas suitable for use in flow controller module 16 and demand module 18 and by the
5 patient wearing cannula 62.

Flow controller module 16 is formed to include a sealed internal chamber 110 coupled to inlet conduit 53 and first and second outlet means 46, 50. Low-pressure oxygen discharged from regulator module 14 is admitted into
10 internal chamber 110 via inlet conduit 53. A rotary valve 112 included in flow controller module 16 includes a rotor disk 114 positioned to lie in internal chamber 110 and a drive shaft 116 fixed to rotor disk 114 and coupled to rotate with flow selector knob 19 relative to base 17. The
15 rotor disk 114 is formed to include various oxygen flow-metering apertures 118, an oxygen flow channel 120, and a flow-shutoff plate 122.

Demand module 18 is formed to include an oxygen flow chamber 124 on one side of diaphragm valve member 64
20 and a diaphragm biasing chamber 126 on the other side of diaphragm valve member 64. A central passage 128 conducts pressurized oxygen from oxygen supply chamber 68 into oxygen flow chamber 124 for delivery to gas outlet 37 (and cannula 62) whenever diaphragm valve member 64 is moved to
25 disengage a valve seat 130 around central passage 128.

Demand module 18 also includes a vent chamber 132 on one side of inhale/exhale sensing diaphragm 66 and a venting control chamber 134 on the other side of inhale/exhale sensing diaphragm 66. A central passage 136 conducts
30 pressurized oxygen from diaphragm biasing chamber 126 into vent chamber 132 for discharge to the atmosphere through vent passageway 140 whenever inhale/exhale sensing

diaphragm 66 is moved to disengage a valve seat 138 around central passage 136. A breath conduit 142 interconnects sensing port 36 and venting control chamber 134 in fluid communication so that a vacuum is applied to venting
5 control chamber 134 via cannula 62, sensing port 36, and breath conduit 142 whenever a patient breathing through cannula 62 inhales.

To place regulator assembly 10 in demand mode, the user turns flow selector knob 19 in flow controller
10 module 16 to cause inlet 144 of first outlet means 46 to communicate with oxygen flow channel 120 formed in rotor disk 114 and inlet 146 of second outlet means 50 to communicate with one of the oxygen flow-metering apertures 118 formed in rotor disk 114 as shown in Figs. 7 and 7A.
15 When in demand mode, regulator assembly 10 operates to supply oxygen to the patient breathing through cannula 62 only when the patient inhales.

As shown in Figs. 7 and 7A, low-pressure oxygen 147 discharged from regulator module 14 into flow
20 controller module 16 is split into two flow streams in sealed internal chamber 110 by rotor disk 114 so that one stream of oxygen 148 is discharged from flow controller module 16 into diaphragm supply passageway 48 formed in regulator module 14. As shown diagrammatically in Figs. 7
25 and 7A, the one oxygen stream 148 flows from internal chamber 110 into inlet 144 of first outlet means 46 after gaining access to the open mouth of inlet 144 by first passing through a portion of oxygen flow channel 120 formed in rotor disk 114. Simultaneously, the other oxygen stream
30 151 flows from internal chamber 110 through a selected oxygen flow-metering aperture 118a formed in rotor disk 114 into inlet 146 of second outlet means 50.

As shown in Fig. 7, diaphragm valve member 64 in demand module 18 is retained in a closed position engaging valve seat 130 to block flow of oxygen from oxygen supply chamber 68 through central passage 128 into oxygen flow chamber 124 whenever a patient wearing cannula 62 exhales.

By exhaling, the patient discharges exhaled air 152 through gas delivery tubes 82 in nasal delivery structure 80, branch legs 86, 88, sensing tube 72, sensing port 36, and breath conduit 142 to pressurize venting control chamber 134 in demand module 18 and urge inhale/exhale sensing diaphragm 66 to a closed position engaging valve seat 138 to close central passage 136. Simultaneously, the first stream of oxygen 148 discharged from flow controller module 16 passes through diaphragm supply passageway 48 to reach diaphragm biasing chamber 126 and urge diaphragm valve member 64 to a closed position engaging valve seat 130 to close central passage 128. When central passage 128 is closed, pressurized oxygen is unable to pass from oxygen supply chamber 68 out of demand module 18 through gas outlet 37. Even though exhaling air 152 from a patient is passing through gas outlet 37 into oxygen flow chamber 124, the pressure of the exhaled air 153 in chamber 124 acting on the left side of diaphragm valve member 64 does not generate a force that is great enough to move diaphragm valve member 64 from its closed position.

As shown in Fig. 7A, diaphragm valve member 64 has been moved to an opened position to allow oxygen 156 to flow to a patient wearing cannula 62 from oxygen supply chamber 68 in demand module 18 through central passage 128, oxygen flow chamber 124, oxygen discharge channel 158, gas outlet 37, gas supply tube 70, leg branches 76, 78, and gas delivery tubes 82 in nasal delivery structure 80.

Diaphragm valve member 64 is able to move to an opened position as shown in Fig. 7A because pressurized oxygen extant in diaphragm biasing chamber 126 is discharged to the atmosphere through central passage 136, vent chamber 5 132, and vent passageway 140. Because the patient is now inhaling (and drawing air 154 out of venting control chamber 134), the sensing diaphragm 66 is free to move to an opened position under a force generated by pressurized oxygen 157 escaping diaphragm biasing chamber 126 through 10 central passage 136.

To place regulator assembly 10 in continuous mode, the user turns flow selector knob 19 (about axis of rotation 117 relative to base 17) to the position shown diagrammatically in Fig. 8 to cause inlet 144 of first 15 outlet means 46 to engage only a flat wall portion 160 (extending between opposite ends 121, 123 of oxygen flow channel 120) of rotor disk 114 so that inlet 144 does not communicate with the C-shaped oxygen flow channel 120 formed in rotor disk 114. When rotor disk 114 is in this 20 position, no oxygen is able to flow out of internal chamber 110 formed in flow controller module 16 into diaphragm supply passageway 48 to reach diaphragm biasing chamber 126 because inlet 144 sealingly engages flat wall portion 160 of rotor disk 114. As a result, there is insufficient 25 oxygen pressure extant in diaphragm biasing chamber 126 to act on the diaphragm valve member 64 and generate a force sufficient to move diaphragm valve member 64 to a closed position and thus diaphragm valve member 64 remains open continuously to allow continuous oxygen flow 156 from 30 oxygen supply chamber 68 in demand module 18 to a patient breathing through cannula 62 via central passage 128,

oxygen flow chamber 124, oxygen discharge channel 158, gas outlet 37, and cannula 62.

To place regulator assembly 10 in off mode, the user turns flow selector knob 19 (about axis of rotation 5 117 relative to base 17) in flow controller module 16 to cause (1) inlet 144 of first outlet means 46 to engage only flat wall portion 160 of rotor disk 114 so that inlet 144 does not communicate with the C-shaped oxygen flow channel 120 formed in rotor disk 114 (and hence oxygen extant in 10 chamber 110) and (2) inlet 146 of second outlet means 50 to engage only flow-shutoff plate 122 on rotor disk 114 so that inlet 146 does not communicate with any one of the oxygen flow-metering apertures 118 formed in rotor disk 114. As a result, no oxygen is discharged from internal 15 chamber 110 in flow controller module 16 through the diaphragm and oxygen supply passageways 48, 51 formed in regulator module 14 toward the demand module 18 and the regulator assembly 10 is inactive.

Referring now to Figs. 10-12, regulator module 14 20 includes a regulator body 162 formed to include a chamber 164 containing regulator mechanism 94 and an end cap 166 closing chamber 164. A seal assembly 168 is positioned inside oxygen inlet 47. Regulator mechanism 94 is a conventional design and includes a piston 170, a spring 25 171, and a relief valve assembly 172. Groove pins 173 are aligned with inlet 47 and register regulator body 162 to post valve 22 when regulator module 14 is mounted on post valve 22. Regulator body 162 includes two vent passageways 174 communicating with chamber 164 and operating to vent 30 excess pressure from chamber 164. A seal assembly 168 is positioned around oxygen inlet 47 and a filter 169 is positioned inside oxygen inlet 47.

Flow controller module 16 and rotary valve 112 are shown in Figs. 13-17. The left-side face 175 of module 16 carries a mounting orientation post 38 for engaging a post receptacle 40 formed in regulator module 14 and a sealing ring 176 for surrounding an opening 177 of first outlet means 46. Front face 178 of rotor disk 114 includes an outlet opening for each of the oxygen flow-metering apertures 118 as shown in Fig. 14 and rear face 179 of rotor disk 114 includes an inlet opening for each of apertures 118 as shown in Fig. 15. Each aperture 118 includes a conventional flow restriction passage of a predetermined internal diameter therein as shown, for example, in Fig. 16 to regulate the flow rate of oxygen passing therethrough. A user selects a desired flow rated by turning rotary valve 116 about axis 117 to place the oxygen flow-metering aperture 118 having the desired internal diameter in communication with the inlet 44 of the first outlet means 46 in flow controller module 16 so that low-pressure oxygen gas is discharged from internal chamber 110 into first outlet means 46 through the selected oxygen flow-metering aperture 118 at a selected flow rate (typically measured in liters per minute).

As shown in Fig. 14, front face 178 of rotor disk 114 includes a C-shaped oxygen flow channel 120 having opposite ends 121, 123 and an "arcuate" flat wall portion 160 extending between opposite ends 121, 123 of channel 120. Front face 178 also includes a surrounding ring of outlet openings for apertures 118 and a flow-shutoff plate 122 located between two of the outlet openings for apertures 118.

As shown in Fig. 15, rear face 179 of rotor disk 114 includes an inner ring of circumferentially spaced-

apart detent-receiving circular depressions 180 for receiving a ball 181 loaded by a spring 182 (see Fig. 16) to fix rotor disk 114 in one of several predetermined positions following rotation of flow selector knob 19 about axis 117 to a selected flow-metering position. Rear face 179 also includes an outer ring of inlet openings for apertures 118.

Base 17 in flow controller module 16 includes a mounting plate 183 for mounting on regulator module and an interface plate 184 interposed between mounting plate 183 and rotatable flow selector knob 19 as shown best in Fig. 16. Mounting plate 183, interface plate 184, and drive shaft 116 of rotary valve 112 cooperate to define sealed internal chamber 110 within flow controller module 16 as shown, for example, in Fig. 16. Two O-ring seals 185 engage drive shaft 116 and a central portion 186 of interface plate 184 and a single O-ring seal 187 lies in an annular groove formed in mounting plate 183 and engages interface plate 184. Rotor disk 114 is positioned by drive shaft 116 to lie wholly within sealed internal chamber 110 as the flow selector knob 19 is turned by a user to rotate rotary valve 112 about axis 117.

A detent mechanism is mounted in central portion 186 of interface plate 184 to project toward and engage circular depressions 180 formed in rear face 179 of rotor disk 114 to fix the position of rotary valve 112 in one of several predetermined fixed positions within base 17 of flow controller module 16. The detent mechanism includes ball 181 and compression spring 182 positioned to lie in a channel 188 formed in central portion 186 of interface plate 184 and open toward rear face 179 of rotor disk 114.

Spring 182 yieldably urges ball 181 away from interface

plate 184 to engage a circular depression 180 formed in rear face 179 whenever rotor disk 114 is rotated to a predetermined position matching either an oxygen flow-metering orifice 118 or flow-shutoff plate 122 in
5 communication with the inlet 146 of the second outlet means 50 of flow controller module 16.

As shown in Fig. 16, front face 178 of rotor disk 114 is supported for rotation about axis 117 in spaced-apart relation to surface 189 of mounting plate 183 by two
10 stacks 190, 191 of O-ring seals. A first O-ring seal stack 190 is mounted in inlet 144 of first outlet means 46 as shown, for example, in Fig. 16 to rotatably support and sealingly engage front face 178 of rotor disk 114. A
15 second O-ring seal stack 191 is mounted in inlet 146 of second outlet means 50 as shown, for example, in Fig. 16 to rotatably support and sealingly engage front face 178 of rotor disk 114. Essentially, rotor disk 114 "floats" in interior chamber 110 so that low-pressure oxygen gas 147 discharged into interior chamber 110 from regulator module
20 14 through inlet passage 53 and "surrounds" rotor disk 114.

Stop posts 192, 193 are positioned in flow controller module 16 to limit rotation of flow selector knob 19 relative to base 17 to less than 360°. Stop post 192 is fixed to central portion 186 of interface plate 184
25 and arranged to extend in a radially outward direction away from axis of rotation 117. Stop post 193 is fixed to flow selector knob 19 and arranged to extend in spaced-apart parallel relation to axis 117 in a direction toward regulator module 14 so as to engage stop post 192 at some
30 point during rotation of flow selector knob 19 in either direction about axis of rotation 117.

Referring now to Fig. 17, in a currently preferred embodiment, oxygen flow-metering apertures 118 are sized so that aperture 118b is sized to include the greatest flow restriction (i.e., smallest internal diameter) to produce a minimum oxygen flow rate (e.g., 0.5 liters/minute) to a patient when matched with inlet 146 of second outlet means 50. Oxygen flow-metering aperture 118c is sized to include the smallest flow restriction (i.e., largest internal diameter) to produce a maximum oxygen flow rate (e.g., 6.0 liters/minute) to a patient when matched with inlet 146.

A presently preferred embodiment of demand valve module 18 is shown in Figs. 18-20. A description of a suitable pneumatic demand oxygen valve is included in U.S. Patent No. 5,360,000, which description is incorporated by reference herein.

Preferably, the pneumatic demand valve contained in demand module 18 includes a valve body presenting a gas flow passageway, together with pneumatically coupled sensing and slave diaphragms 66, 64. The sensing diaphragm 66 is a differential pressure diaphragm mounted in a chamber in the valve body and exposed to patient breathing inputs and other pressure inputs. The slave diaphragm is a diaphragm valve member 64 that is interposed in the flow passageway and prevents gas flow during the exhalation phases of the patient's breathing cycle. During inhalation sensed by the sensing diaphragm 66, the slave diaphragm valve member 64 is shifted to open the gas flow passageway in the valve, thus permitting passage of gas to the patient through cannula 62.

Referring now to Fig. 19, demand module 18 includes a mounting plate 210 carrying mounting orientation

post 39, a housing 212, and a central body 214 trapped
between mounting plate 210 and housing 212. Mounting plate
210 is coupled to regulator module 14 and an O-ring seal 54
is used to establish a seal between mounting plate 210 and
5 regulator module 14.

A biasing spring 216 is positioned in oxygen flow
chamber 124 to surround central passage 128. One end of
spring 216 engages mounting plate 210 and an opposite end
of spring 216 engages diaphragm valve member 64. Spring
10 216 yieldably urges diaphragm valve member 64 in a
direction away from engagement with valve seat 130.

A removable, drop-in, apertured disk 218 is
placed in a chamber 220 formed in central body 214 to lie
in diaphragm supply passageway 48. O-ring seals 222 are
15 positioned in chamber 220 on opposite sides of apertured
disk 218 to block flow of pressurized oxygen in passageway
48 around disk 218. Apertured disk 218 is formed to
include a central aperture defining means for reducing the
flow rate of pressurized oxygen delivered to diaphragm
20 biasing chamber 126 through diaphragm supply passageway 48.

Disk 218 is removable so that the flow rate of oxygen to
diaphragm biasing chamber 126 can be changed simply by
disassembling regulator module 18, removing disk 218 from
chamber 220, and dropping another disk having a desired
25 flow-rate characteristic (e.g., central aperture size) in
chamber 220.

Sensitivity adjustment means 224 is provided in
housing 212 for selectively and positively bringing the
inhale/exhale sensing diaphragm 66 and vent valve seat 138
30 closer together so that the precise location of the vent
valve seat 138 relative to the sensing diaphragm 66 can be
varied. As shown in Figs. 19 and 20, housing 212 includes

a bore 226 that is internally threaded and communicated with inhale/exhale sensing diaphragm 66. A threaded member 228 is received in bore 226 and terminates in a tip 230. A compression spring 232 positioned in bore 226 has one end engaging tip 230 and an opposite end engaging sensing diaphragm 66. Threaded member 228 is rotatable in bore 226 so as to provide a sensitivity adjustment, i.e., the precise location of inhale/exhale sensing diaphragm 66 relative to vent valve seat 138 can be varied by rotating member 228 to adjust load on compression spring 232 engaging inhale/exhale sensing diaphragm 66.

During the exhalation phase of operation illustrated in Fig. 19, the pressure conditions within venting control chamber 134 maintain inhale/exhale sensing diaphragm 66 in engagement with seat 138. When the patient inspires, the negative pressure within venting control chamber 134 causes sensing diaphragm 66 to lift as shown in Fig. 20, whereby biasing gas 157 within chamber 132 passes to the atmosphere through communicating passageway 140. This creates an inequality of forces on the diaphragm valve member 64, whereby the latter is lifted thus opening the gas flow passageway 128 so that gas may pass through chamber 124, path 158, and ultimately out the gas outlet 37 to the patient wearing cannula 62.

It will be seen that the inhale/exhale sensing diaphragm 66 and diaphragm valve member 64 are pneumatically coupled for operation of the diaphragm valve member 64 in response to movement of the sensing diaphragm 66; the latter is in turn moved in response to the patient's breathing efforts as transmitted through the cannula 62.

A very desirable feature of the invention results from its fail-safe characteristics. Specifically, a fail-safe demand device is one that, upon a mechanical failure of one or more components, establishes a continuous flow of oxygen to be delivered to the recipient at the prescribed rate.

An alternative demand module 318 is shown in Figs. 21 and 22. This demand module 318 is the same as demand module 18 except that it includes a "demand/continuous" flow selector switch 340 in communication with diaphragm supply passageway 48. Thus, it is not necessary to use a flow controller module like module 16 which is configured to regulate flow of oxygen through diaphragm supply passageway 48 by rotating flow selector knob 19 to position inlet 144 of first outlet means 46 in communication with either (1) oxygen flow channel 120 formed in rotor disk 114 to allow oxygen to flow from interior chamber 110 into inlet 144 or (2) flat wall portion 160 on rotor disk 114 to block flow of oxygen from interior chamber 110 into inlet 144.

A system is provided inside pneumatic demand oxygen valve 318 to control the "mode of distribution" of oxygen flow from the pneumatic demand oxygen valve to a patient. This system is shown in Figs. 21 and 22 and is controlled by a pulse/continuous oxygen flow switch 340. This switch 340 gives a healthcare provider or the patient the option to distribute pulsed oxygen flow or continuous oxygen flow to the patient as controlled by the pneumatic demand oxygen valve 318.

As shown in Fig. 22, flow switch 340 includes a switch plate 342, tab 344, grip portion 346, and exhaust 354. A user can slide grip portion 346 relative to housing

212 in direction 348 to the position shown in Fig. 22 to
cause switch plate 342 to move to a position blocking flow
of low-pressure oxygen 148 in diaphragm supply passageway
48 to diaphragm biasing chamber 126. Alternatively, a user
5 can slide grip portion 346 relative to housing 212 in
direction 350 to another position (not shown) placing an
aperture 352 formed in switch plate 342 in line with
diaphragm supply passageway 48 to allow flow of oxygen
through passageway toward diaphragm biasing chamber 126.

10 It is within the scope of the present invention
disclosed herein to use regulator assembly 10 in connection
with other gases such as nitrogen. Other gases or
applications may benefit from a modular regulator assembly
of the type disclosed herein. For example, nitric oxide
15 therapy is needed for impaired patients and there may be a
use for regulator assembly 10 in that context.

At the present time, regulator assembly 10
preferably includes a pneumatic device. It is within the
scope of the present invention to include an electronics
20 valve device. Continuous flow following the initial
precharge bolus may also be truncated but not at the
present time.

Although the invention has been described in
detail with reference to preferred embodiments, variations
25 and modifications exist within the scope and spirit of the
invention as described and defined in the following claims.

CLAIMS

1. Apparatus for controlling discharge of oxygen from an oxygen supply source to a patient, the apparatus comprising

5 an oxygen supply inlet,
a pressure regulator coupled to the oxygen supply inlet and configured to reduce pressure of oxygen received from the oxygen supply inlet to a selected magnitude,

10 a flow controller coupled to the pressure regulator and configured to meter oxygen received from the pressure regulator at a selected flow rate, and
an oxygen distribution assembly including a pneumatic demand oxygen valve and a conduit conducting

15 oxygen discharged from the flow controller to the pneumatic demand oxygen valve for delivery to a patient.

2. The apparatus of claim 1, wherein the pressure regulator includes a regulator body formed to include a portion of the conduit so the oxygen discharged

20 from the flow controller passes through the regulator body before said oxygen is admitted into the pneumatic demand oxygen valve.

3. The apparatus of claim 1, wherein the conduit includes an inlet end coupled to the flow

25 controller, an outlet end coupled to the pneumatic demand oxygen valve, and a middle portion interconnecting the inlet and outlet ends and passing through the pressure regulator.

4. The apparatus of claim 1, wherein the pneumatic demand oxygen valve includes a valve body formed

30 to include a supply passageway having a gas inlet for attachment to the conduit and a gas outlet for attachment

to a breathing line and a valve seat in the supply
passageway, a valve member for engaging and disengaging the
valve seat to control flow of gas inlet to the gas outlet
through the supply passageway, and a differential pressure
5 control means for moving the valve member from a closed
position against the valve seat to an opened position away
from the valve seat in response to inhalation of a patient
breathing through the gas outlet.

5. The apparatus of claim 4, wherein the flow
10 controller includes means for splitting the flow of oxygen
received from the pressure regulator means into a first
oxygen stream discharged into the conduit and a second
oxygen stream conducted to the differential pressure
control means.

15 6. The apparatus of claim 1, including first
detachable connector means for detachably connecting the
flow controller to the pressure regulator and second
detachable connector means for detachably connecting the
pneumatic demand oxygen valve to the pressure regulator.

20 7. The apparatus of claim 1, wherein the oxygen
distribution assembly further includes an auxiliary
conduit, the pneumatic demand oxygen valve includes valve
means for controlling flow of oxygen from the conduit to
25 the patient and an inhale/exhale sensing diaphragm
pneumatically coupled to the valve means, the valve means
is fluidly coupled to the auxiliary conduit, the flow
controller includes a housing formed to include an internal
chamber and a passageway conducting oxygen from the
30 pressure regulator to the internal chamber and a flow
control valve extending into the internal chamber, and the
flow control valve is formed to include an oxygen flow

channel to conduct oxygen from the internal chamber into the auxiliary conduit upon movement of the flow control valve to a predetermined position in the internal chamber communicating the auxiliary conduit to the oxygen flow
5 channel so that oxygen is communicated through the auxiliary conduit to the valve means.

8. The apparatus of claim 7, wherein the pressure regulator includes a regulator body formed to include a portion of the auxiliary conduit.

10 9. The apparatus of claim 8, wherein the pressure regulator includes a regulator body formed to include a portion of the conduit.

10. The apparatus of claim 7, wherein the flow control valve is also formed to include a flat wall portion
15 to block oxygen from flowing from the internal chamber into the auxiliary conduit upon movement of the valve to another predetermined position in the internal chamber.

11. The apparatus of claim 7, wherein the flow control valve includes a rotor disk and shaft means for
20 supporting the rotor disk for rotational movement in the internal chamber about an axis of rotation and the oxygen flow channel has an arcuate shape.

12. The apparatus of claim 11, wherein the rotor disk further includes a plurality of oxygen flow-metering
25 apertures surrounding the arcuate oxygen flow channel.

13. The apparatus of claim 11, wherein the flow controller further includes a flow selector knob coupled to the shaft means and supported to rotate about the axis of rotation relative to the housing between a first position
30 range placing the oxygen flow channel in communication with the auxiliary conduit to allow oxygen to flow from the internal chamber into the auxiliary conduit to reach the

valve means in the pneumatic demand oxygen valve and a
second position range placing flat wall portion in
communication with the auxiliary conduit to block oxygen
from flowing from the internal chamber into the auxiliary
5 conduit toward the valve means.

14. Apparatus for controlling discharge of
oxygen from an oxygen supply source to a patient, the
apparatus comprising

an oxygen supply inlet,
10 a modular pressure regulator coupled to the
oxygen supply inlet and configured to reduce pressure of
oxygen received from the oxygen supply inlet to a selected
magnitude,

a modular flow controller configured to meter
15 oxygen received from the pressure regulator at a selected
flow rate,

a first connector means coupled to the modular
pressure regulator and to the modular flow controller to
position the modular pressure regulator adjacent to the
20 modular flow controller and to communicate oxygen from the
modular pressure regulator to the modular flow controller,

an oxygen distribution assembly including a
modular pneumatic demand oxygen valve and a conduit
conducting oxygen discharged from the flow controller to
25 the pneumatic demand oxygen valve for delivery to a
patient, and

a second connector means coupled to the modular
pressure regulator and the modular pneumatic demand oxygen
valve to position the modular pneumatic demand oxygen valve
30 adjacent to the modular pressure regulator.

15. The apparatus of claim 14, wherein the
modular pressure regulator and the modular pneumatic demand

oxygen valve are positioned to lie in side-by-side abutting relation.

16. The apparatus of claim 14, wherein the conduit passes through the second connector means.

5 17. The apparatus of claim 14, wherein the conduit includes an inlet end coupled to the modular flow controller, an outlet end coupled to the modular pneumatic demand oxygen valve, and a middle portion interconnecting the inlet and outlet ends and passing through the modular
10 pressure regulator.

18. The apparatus of claim 14, wherein the modular pneumatic demand valve includes a diaphragm valve member communicating with the conduit and an inhale/exhale sensing diaphragm pneumatically coupled to the diaphragm
15 valve member and the modular flow controller includes an internal chamber and means for splitting the flow of oxygen received in the internal chamber from the modular pressure regulator into a first oxygen stream discharged into the conduit and a second oxygen stream, and the apparatus
20 further comprises means for selectively communicating the second oxygen stream to the diaphragm valve member in the modular pneumatic demand valve.

19. An apparatus for controlling discharge of oxygen from an oxygen supply source to a patient through a
25 breathing line coupled to the patient as the patient inhales and exhales, the apparatus comprising

an oxygen supply inlet,
a modular pressure regulator coupled to the oxygen supply inlet and configured to reduce pressure of
30 oxygen received from the oxygen supply inlet to a selected magnitude,

a modular flow controller configured to meter oxygen received from the pressure regulator at a selected flow rate,

5 means for conducting oxygen provided by the modular flow controller through a supply passageway having a gas inlet coupled to the modular flow controller and a gas outlet for attachment to a breathing line, the conducting means including a valve seat in the supply passageway,

10 means for storing a supply of oxygen extant in the supply passageway in a first chamber to develop a pressure head in the first chamber, the storing means including auxiliary conduit means for admitting oxygen from the modular flow controller into the first chamber and
15 outlet means for discharging oxygen from the first chamber to the atmosphere,

means for selectively blocking flow of oxygen through the supply passageway from the gas inlet to the gas outlet, the blocking means including a flexible diaphragm
20 valve member including a first side communicating with oxygen admitted into the first chamber and a second side facing the valve seat in the supply passageway, the diaphragm valve member being mounted for movement between a flow-blocking position engaging the valve seat in the
25 supply passageway and a flow-delivery position disengaging the valve seat in the supply passageway, and

control means for closing the outlet means during exhalation of a patient breathing thorough the gas outlet to store pressurized oxygen in the first chamber so that
30 oxygen pressure in the first chamber acting against the first side of the diaphragm valve member will increase to move the diaphragm valve member to its flow-blocking

position and opening the outlet means in response to
inhalation of a patient breathing through the gas outlet to
vent pressurized oxygen in the first chamber to the
atmosphere through the outlet means so that oxygen pressure
5 in the first chamber will decrease to allow pressurized
oxygen in the supply passageway to move the diaphragm valve
member away from the valve seat to its flow-delivery
position, the modular flow controller including an internal
chamber and means for selectively splitting the flow of
10 oxygen received in the internal chamber from the modular
pressure regulator into a first oxygen stream discharged
into the supply passageway for distribution to a patient
and a second oxygen stream discharged into the auxiliary
conduit means for distribution to the first chamber.

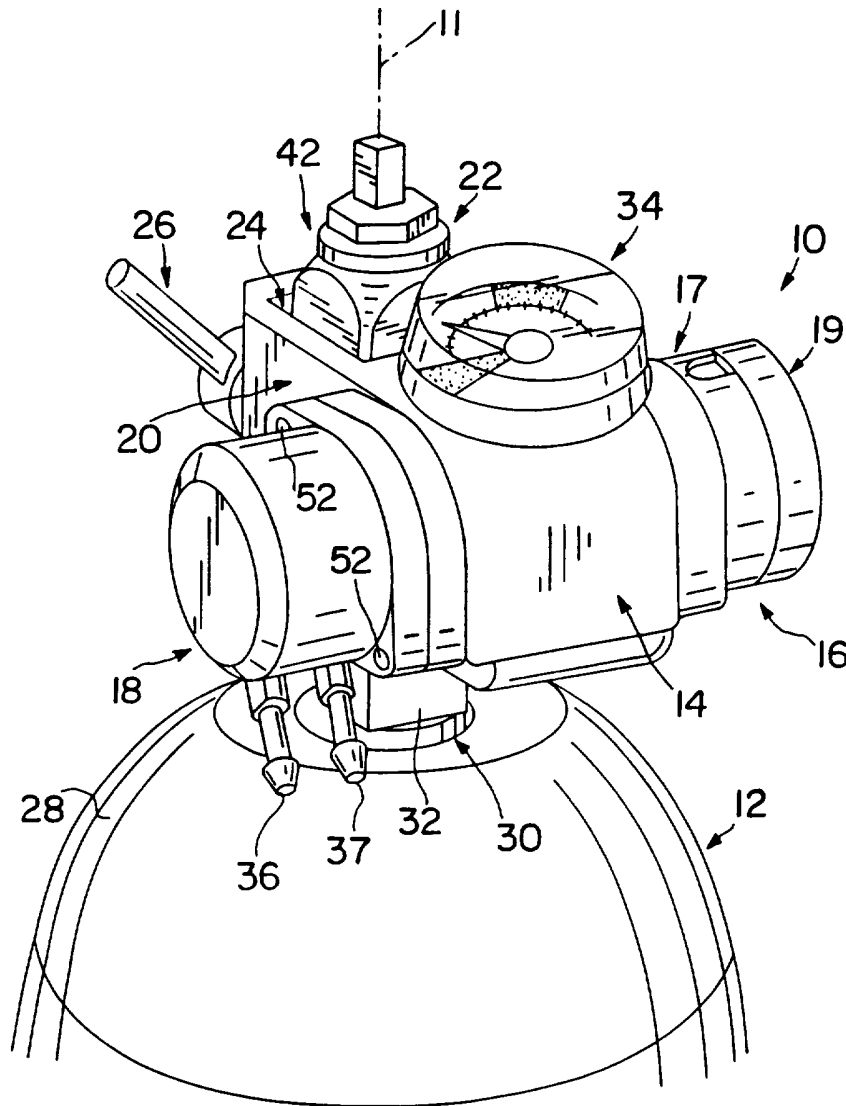

FIG. 1

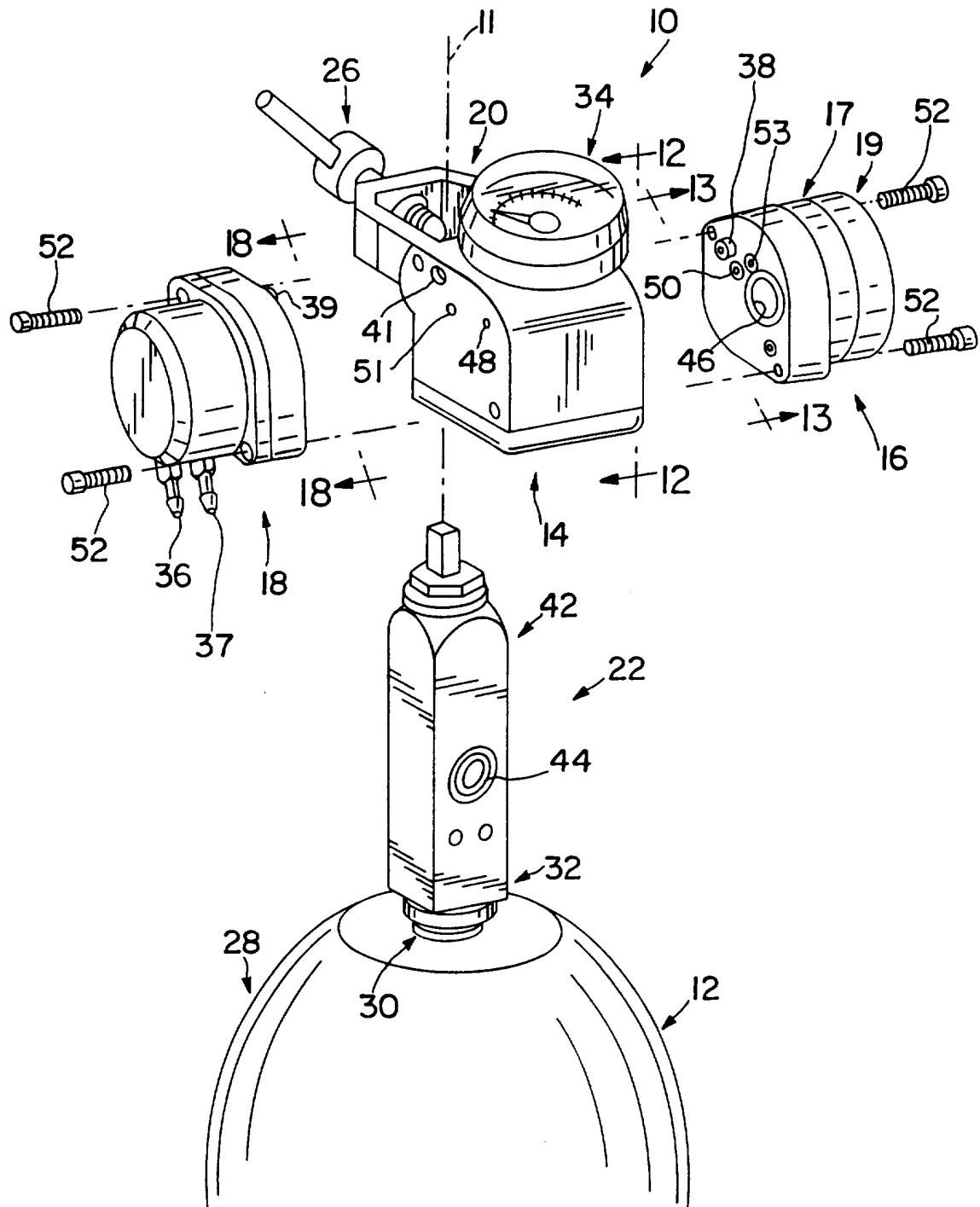

FIG. 2

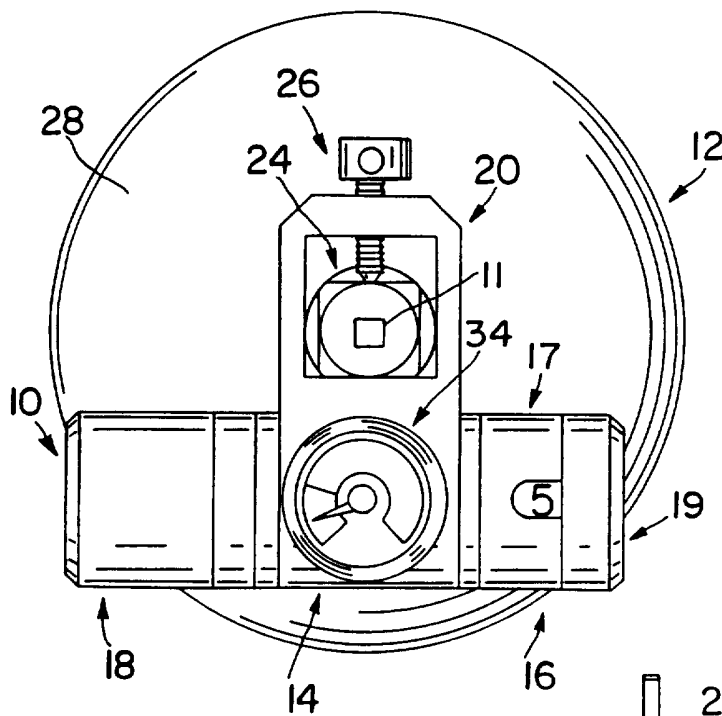

FIG. 3

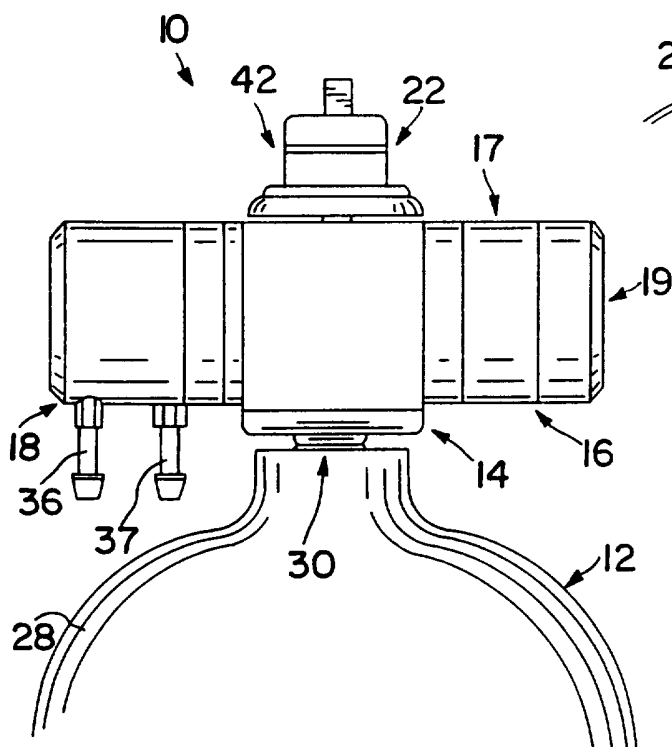
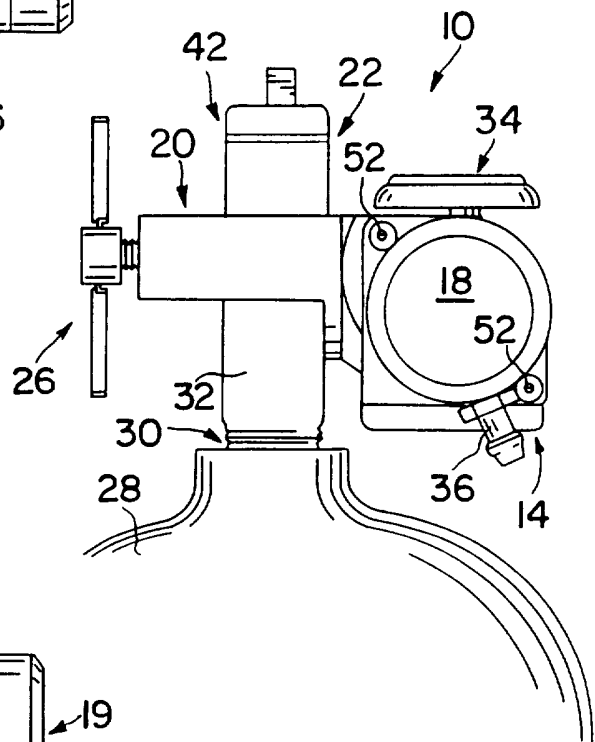

FIG. 4

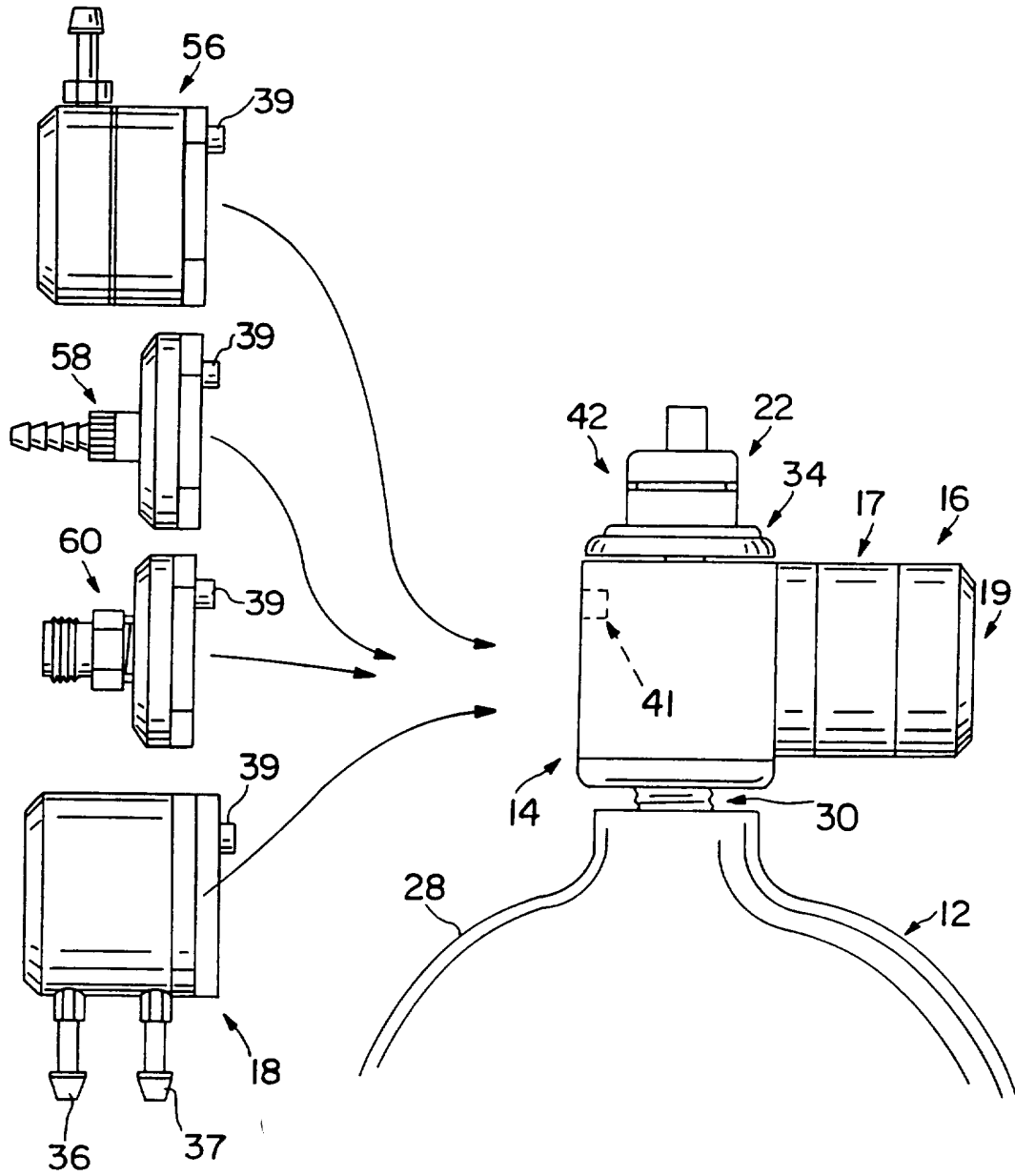

FIG. 6

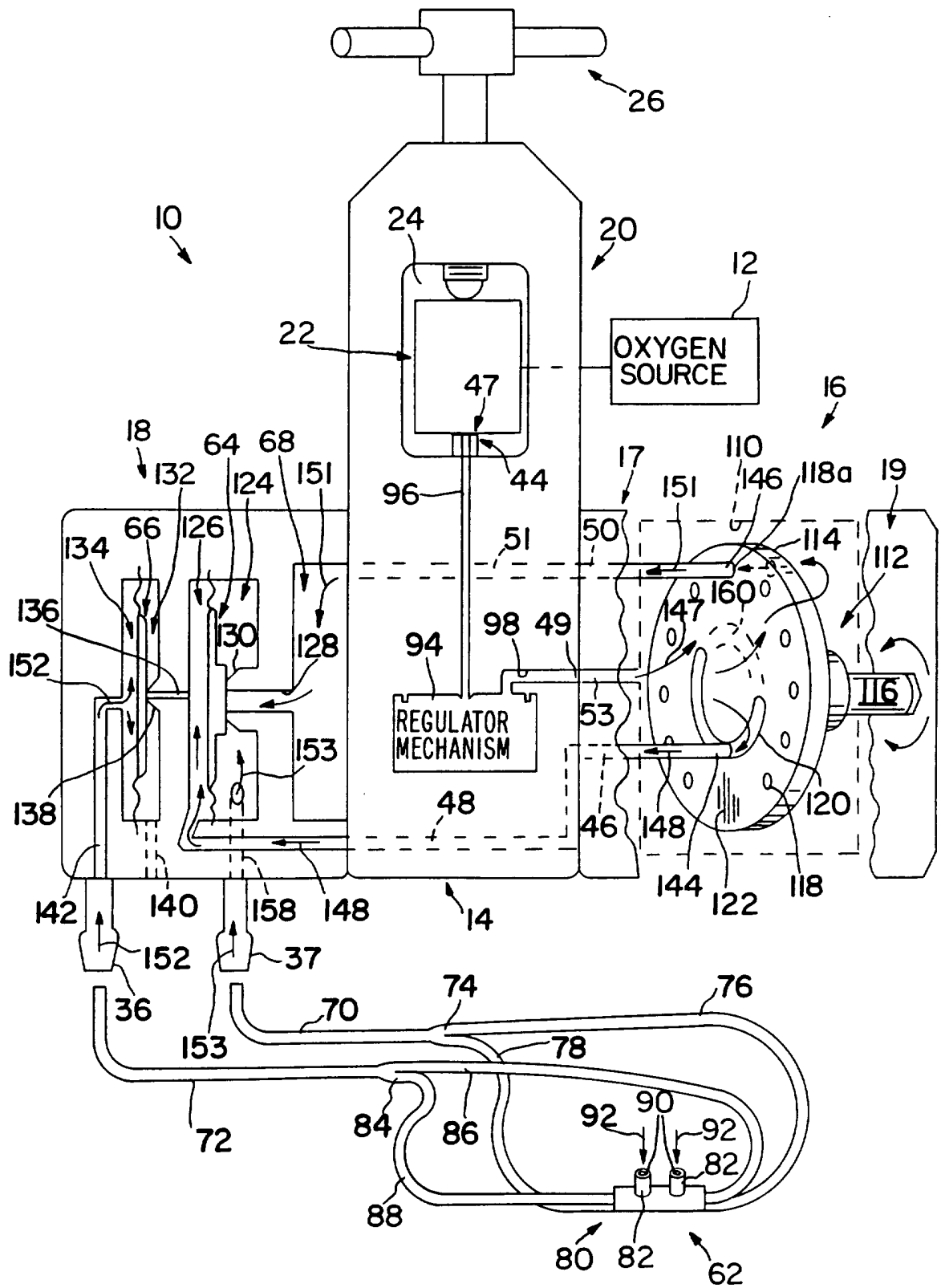
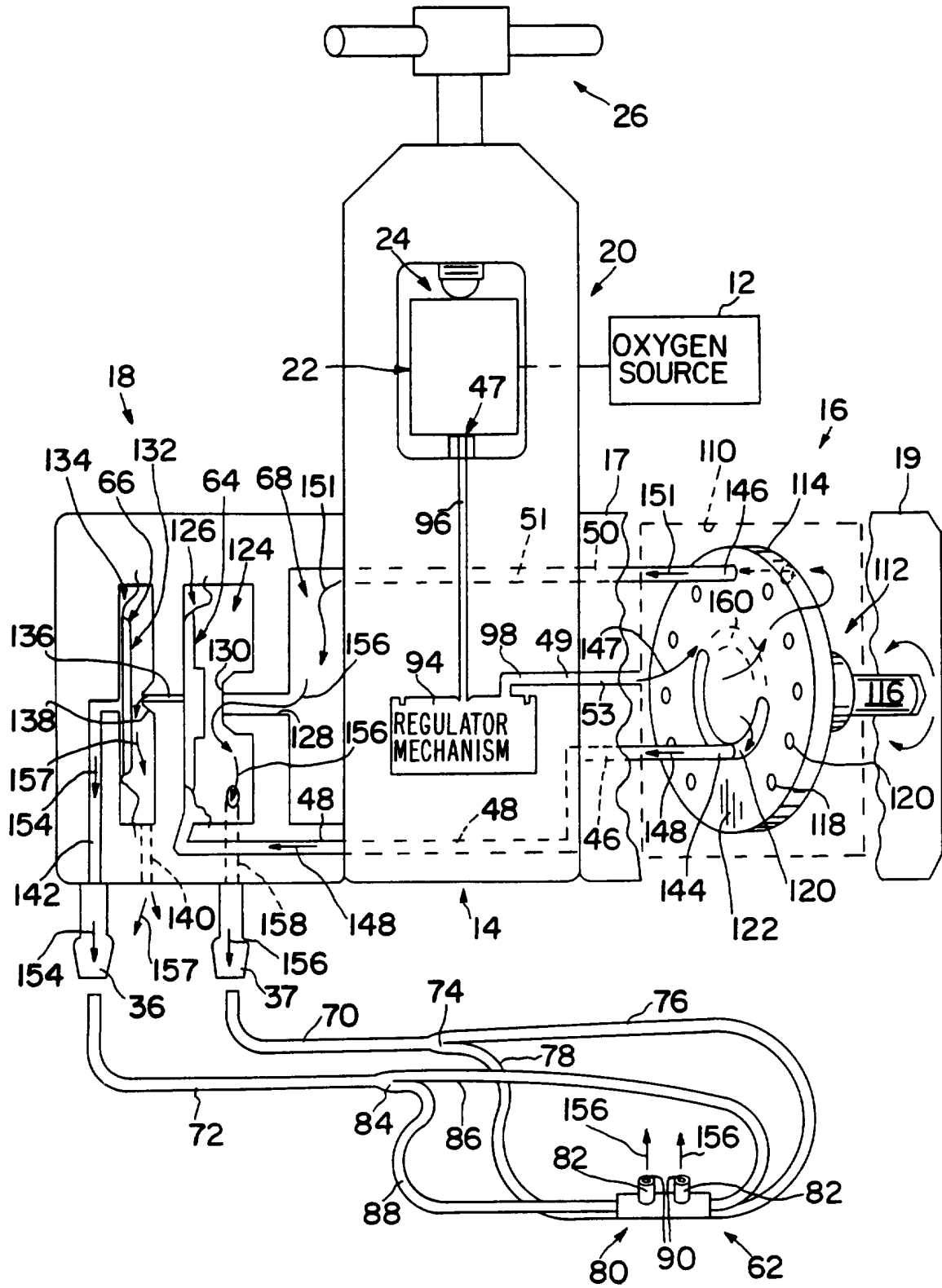
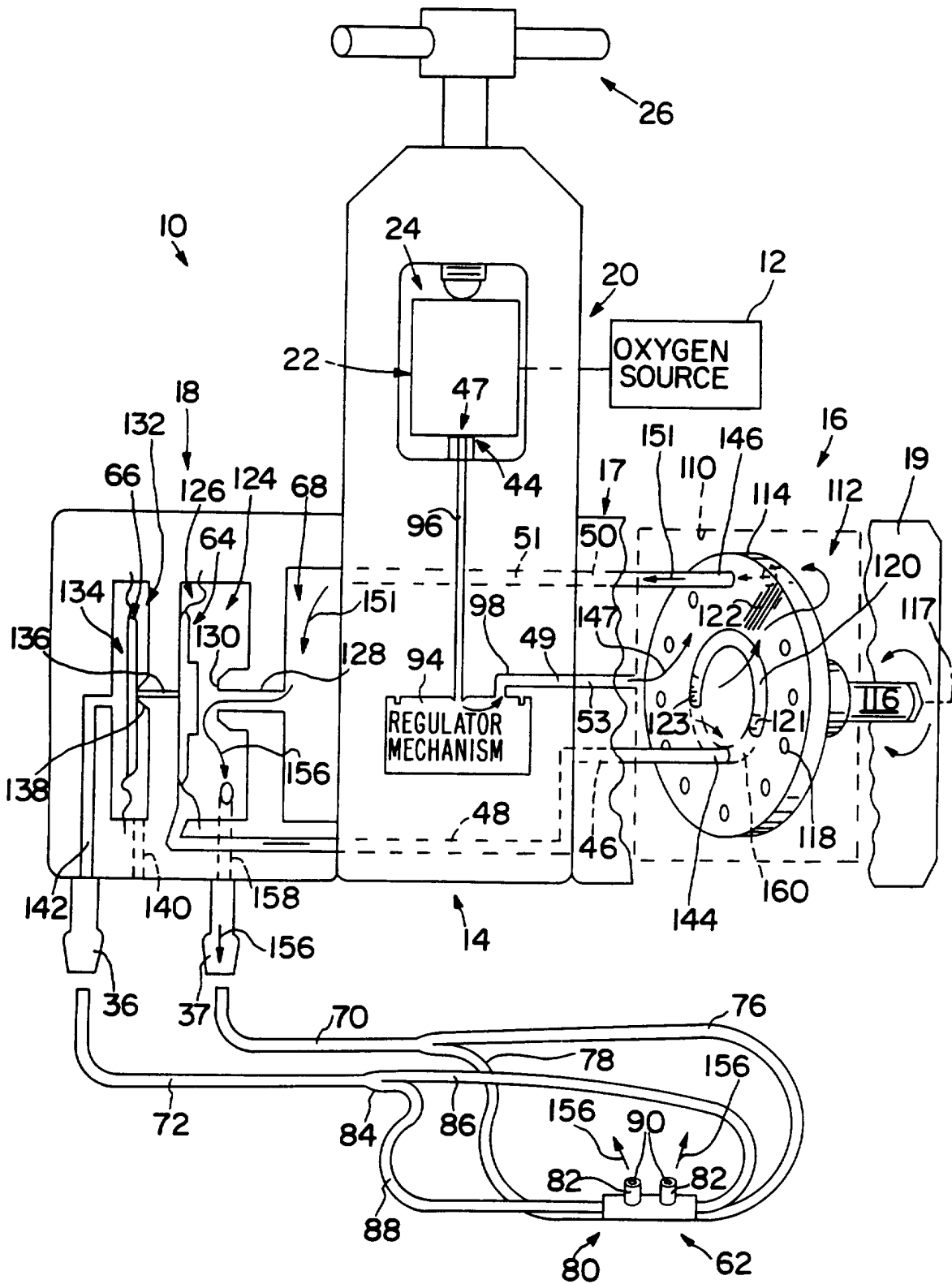
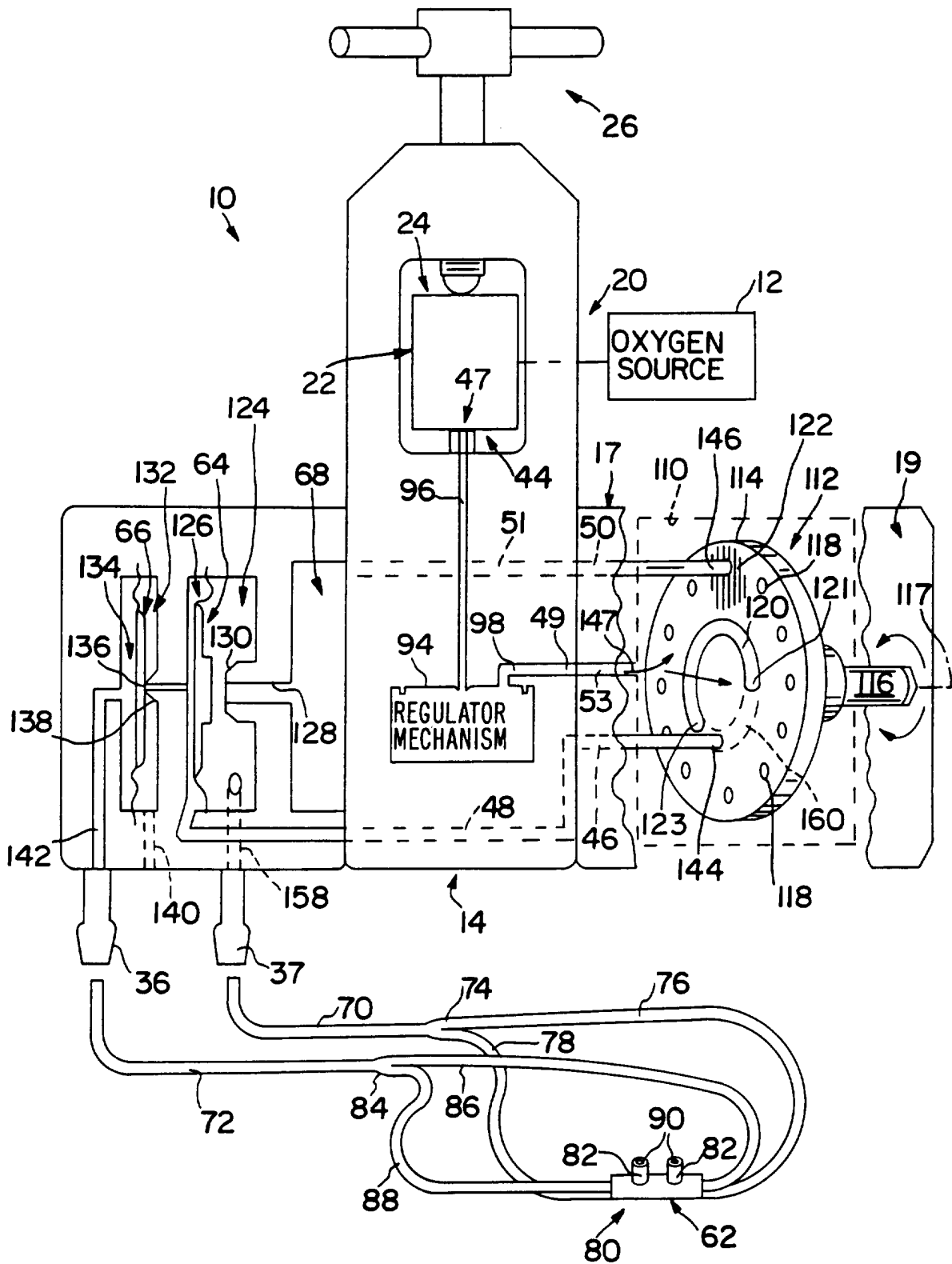

FIG. 7







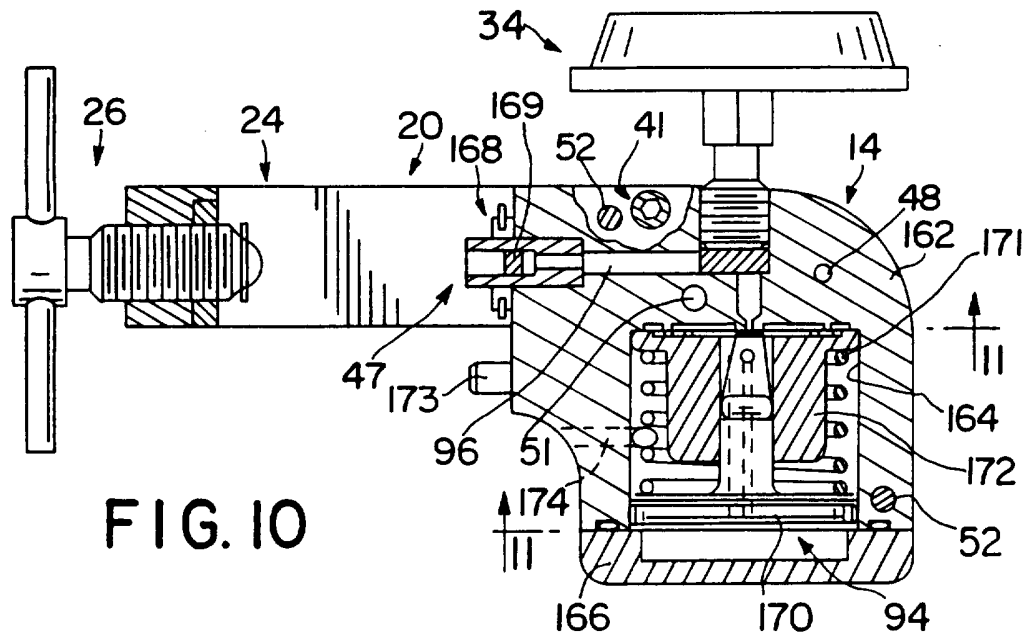

FIG. 10

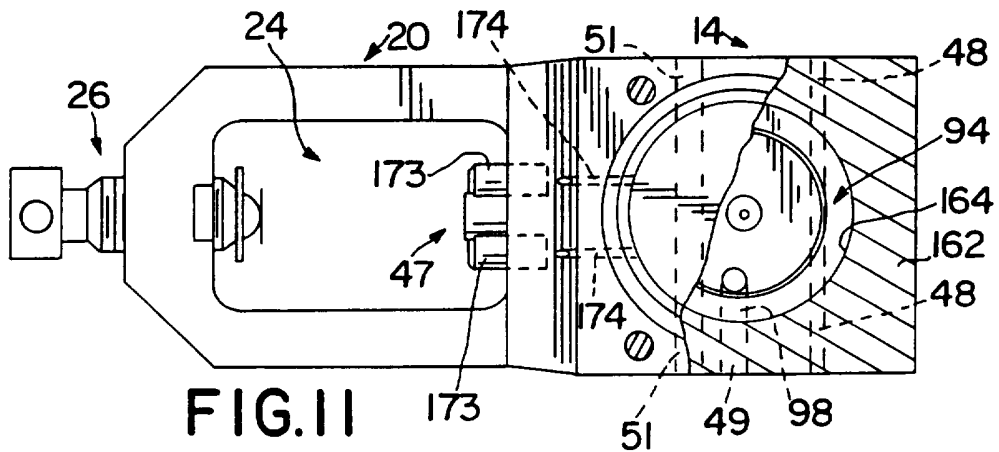

FIG. 11

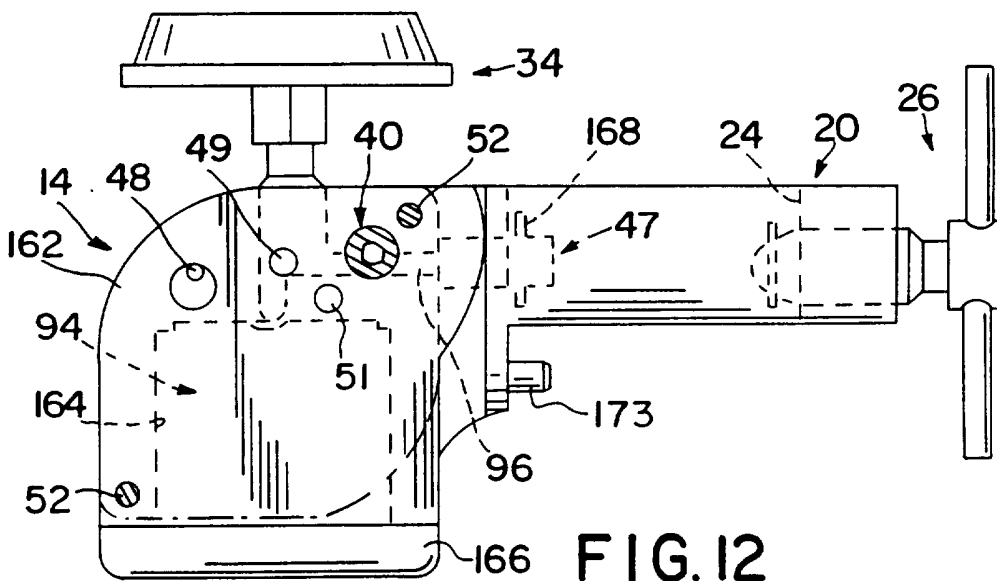

FIG. 12

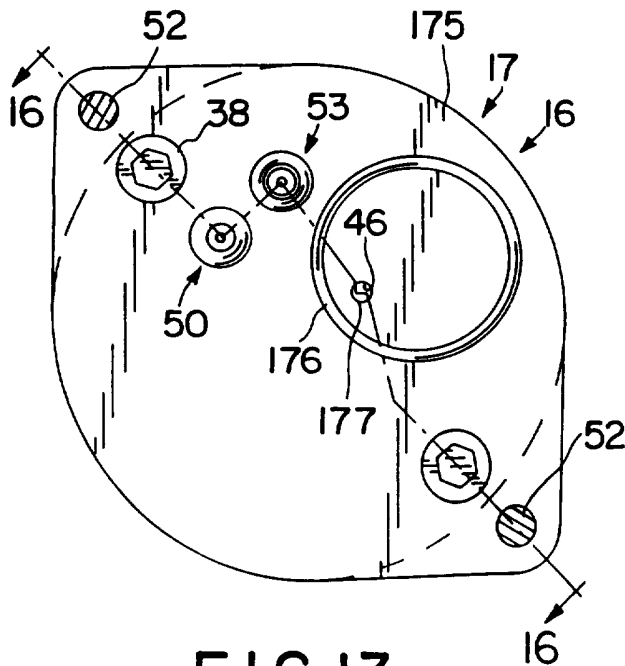

FIG. 13

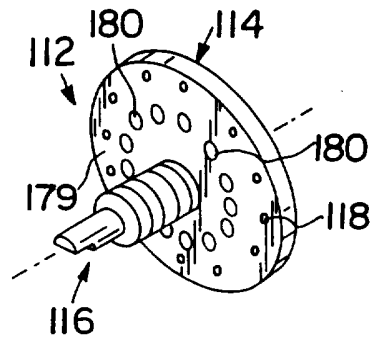

FIG. 15

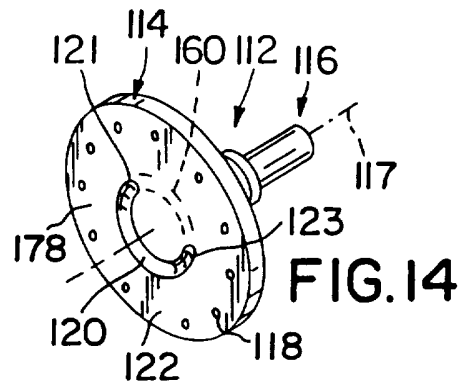

FIG. 14

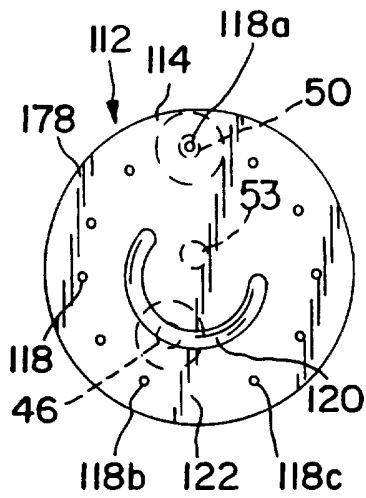
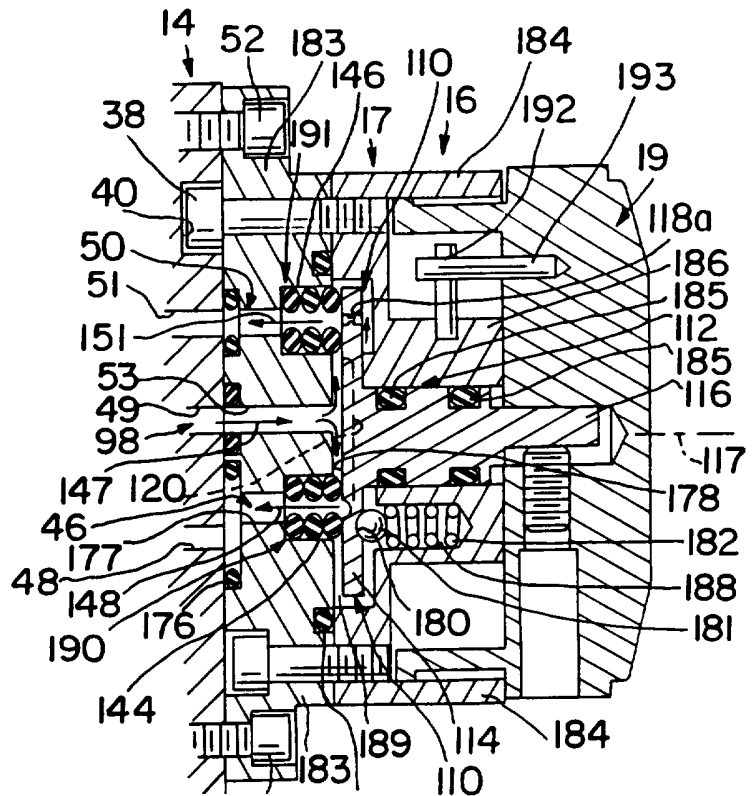

FIG. 17



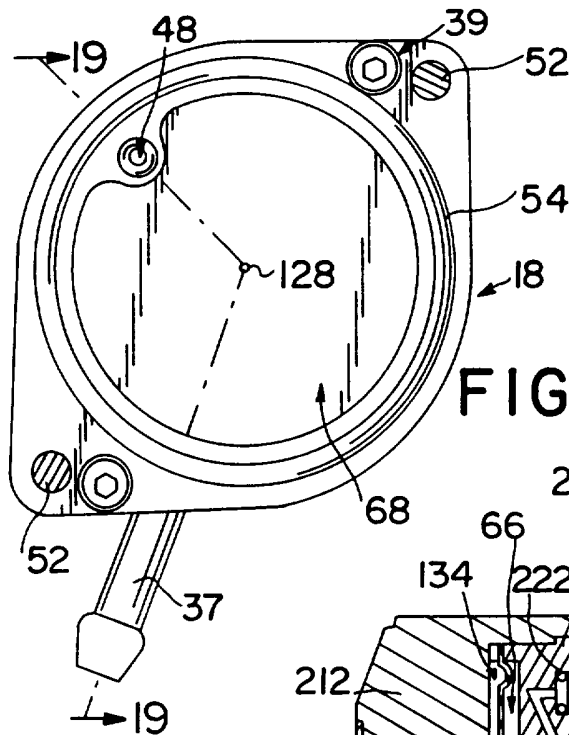

FIG. 18

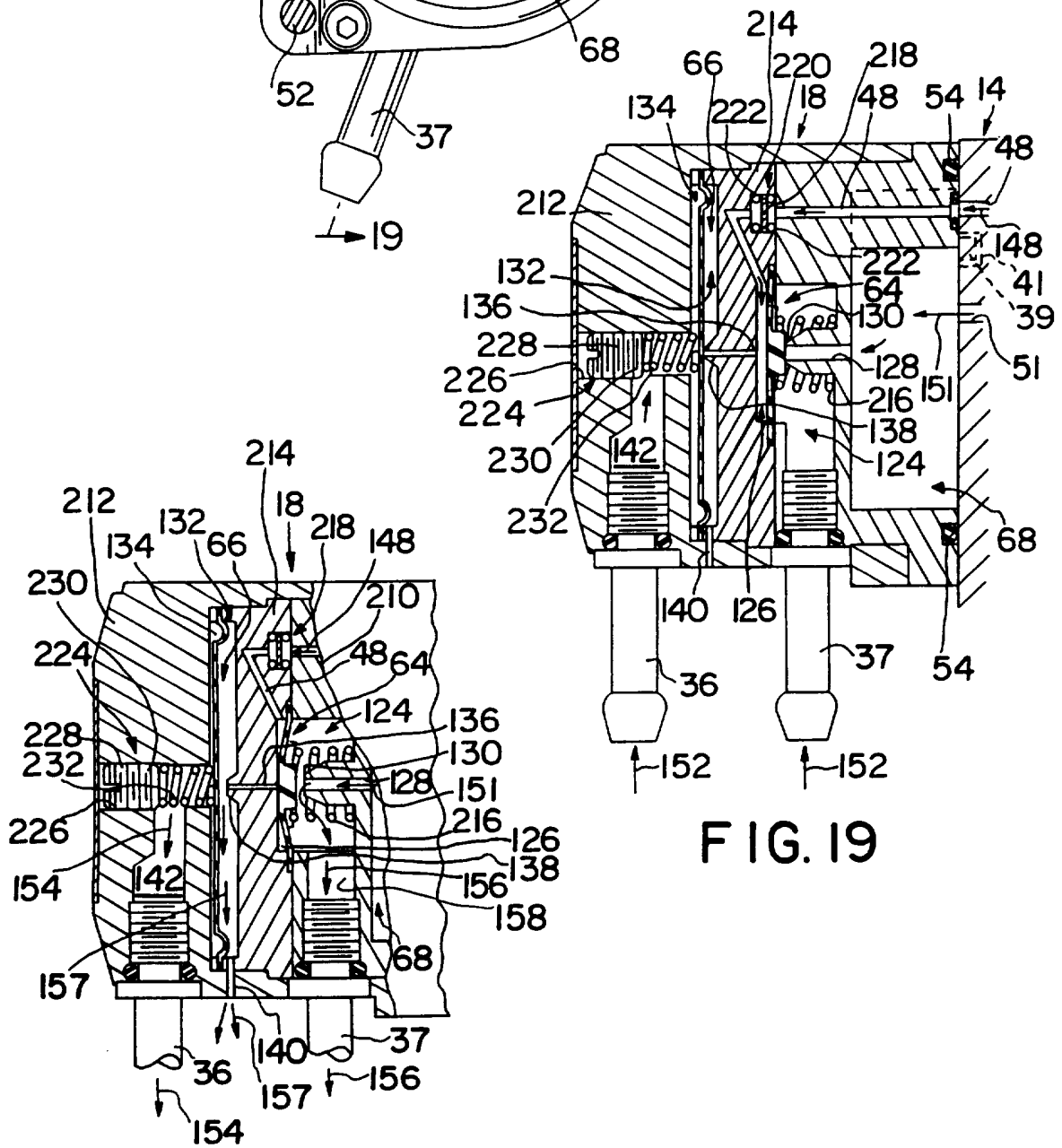

FIG. 19

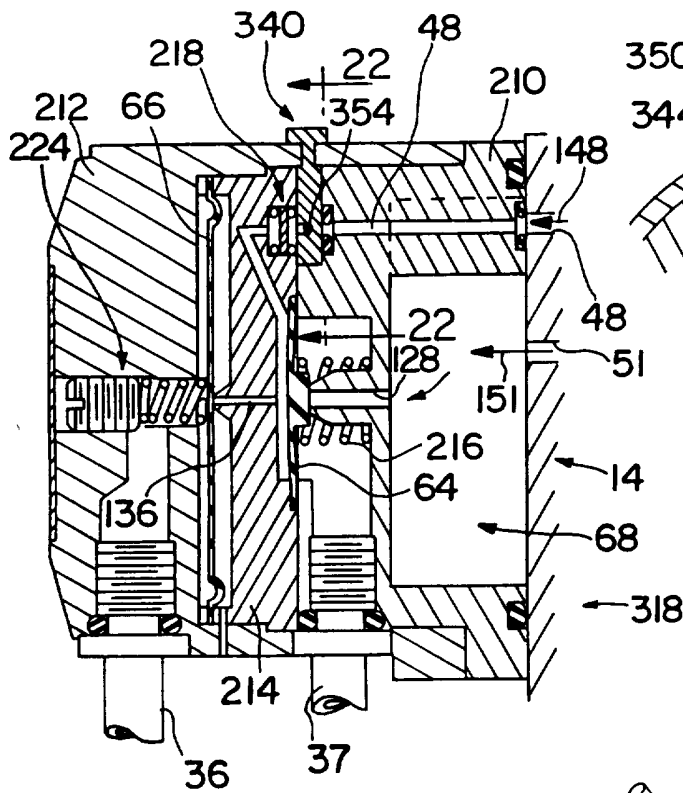

FIG. 21

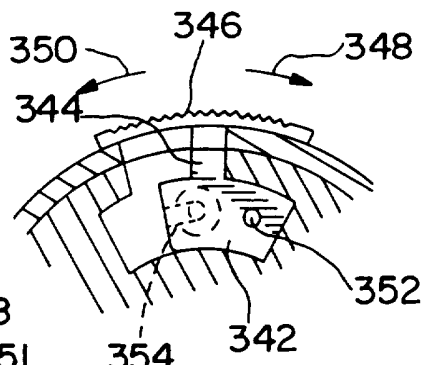

FIG. 22

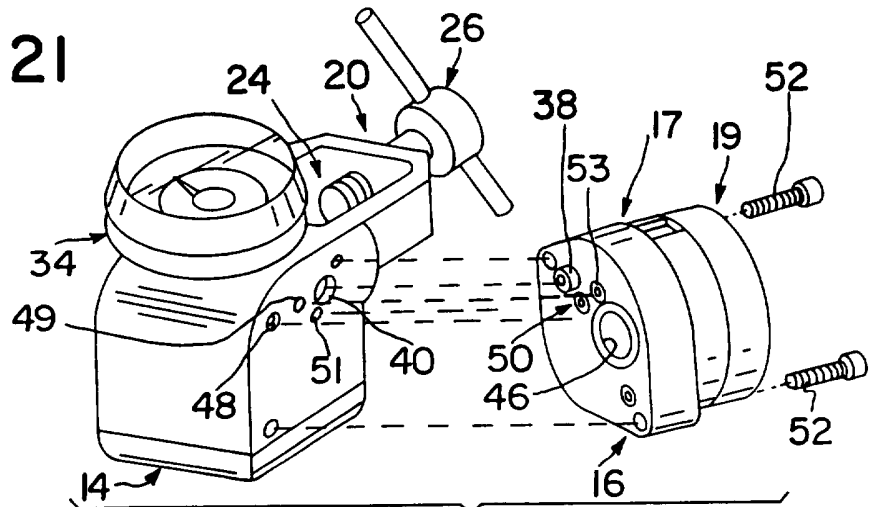
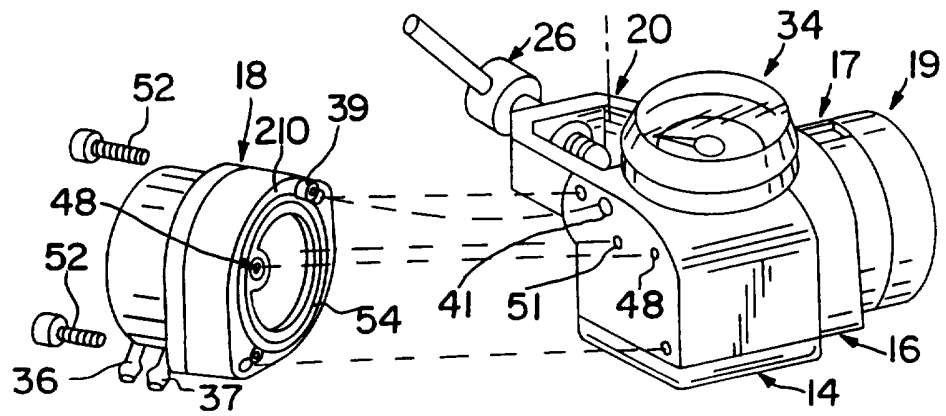

FIG. 23



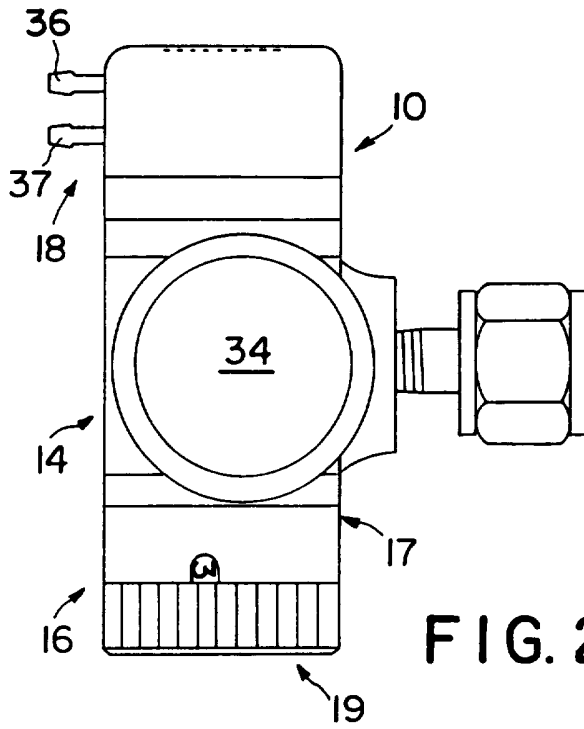

FIG. 25

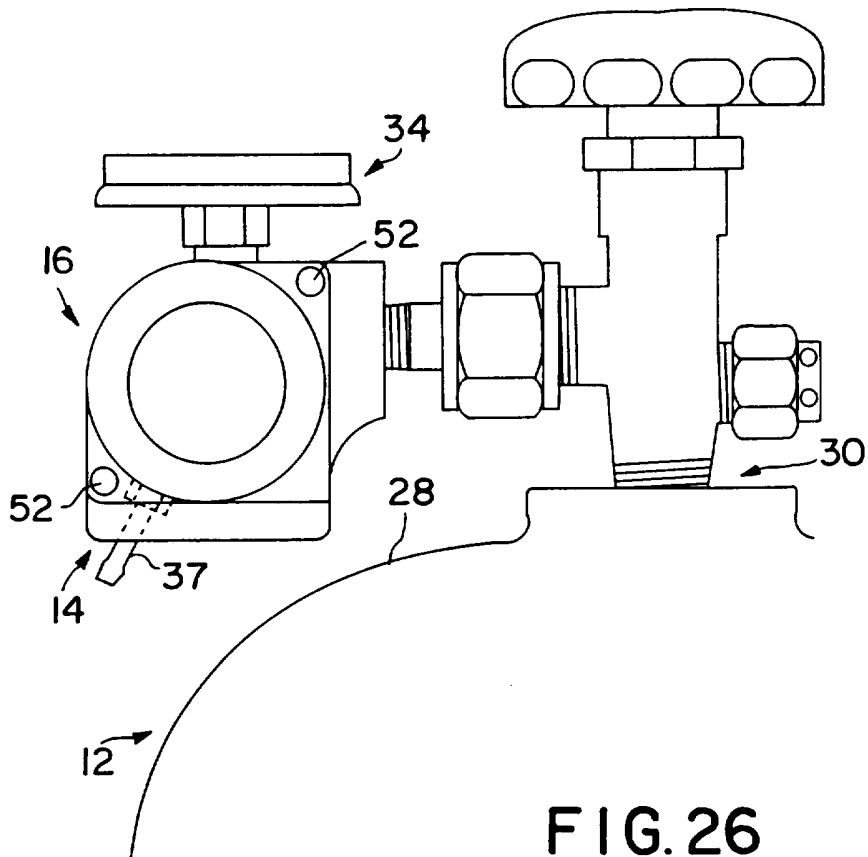

FIG. 26

INTERNATIONAL SEARCH REPORT

International application No.
PCT/US96/15549

A. CLASSIFICATION OF SUBJECT MATTER

IPC(6) :A61M 16/00

US CL :Please See Extra Sheet.

According to International Patent Classification (IPC) or to both national classification and IPC

B. FIELDS SEARCHED

Minimum documentation searched (classification system followed by classification symbols)

U.S. : 128/203.15, 204.18, 204.26, 204.27, 205.15, 205.24, 207.12, 207.16

Documentation searched other than minimum documentation to the extent that such documents are included in the fields searched

Electronic data base consulted during the international search (name of data base and, where practicable, search terms used)

C. DOCUMENTS CONSIDERED TO BE RELEVANT

Category*	Citation of document, with indication, where appropriate, of the relevant passages	Relevant to claim No.
X	US 4,054,133 (MYERS) 18 October 1977, col. 6, lines 9-62.	1-3, 4-10
Y	US 5,020,531 (GAROFALO) 04 June 1991, col. 2, lines 49 - 50.	11
Y	US 3,814,093 (GREGORY) 04 June 1974, col. 3, lines 1 - 24.	12, 13

Further documents are listed in the continuation of Box C. See patent family annex.

* Special categories of cited documents:	*T* later document published after the international filing date or priority date and not in conflict with the application but cited to understand the principle or theory underlying the invention
A document defining the general state of the art which is not considered to be of particular relevance	*X* document of particular relevance; the claimed invention cannot be considered novel or cannot be considered to involve an inventive step when the document is taken alone
E earlier document published on or after the international filing date	*Y* document of particular relevance; the claimed invention cannot be considered to involve an inventive step when the document is combined with one or more other such documents, such combination being obvious to a person skilled in the art
L document which may throw doubts on priority claim(s) or which is cited to establish the publication date of another citation or other special reason (as specified)	*G* document member of the same patent family
O document referring to an oral disclosure, use, exhibition or other means	
P document published prior to the international filing date but later than the priority date claimed	

Date of the actual completion of the international search

11 JANUARY 1997

Date of mailing of the international search report

04 FEB 1997

Name and mailing address of the ISA/US
Commissioner of Patents and Trademarks
Box PCT
Washington, D.C. 20231

Facsimile No. (703) 305-3230

Authorized officer

VIRENDRA SRIVASTAVA

Telephone No. (703) 308-0858

INTERNATIONAL SEARCH REPORT

International application No.
PCT/US96/15549

A. CLASSIFICATION OF SUBJECT MATTER:

US CL :

128/203.15, 204.18, 204.26, 204.27, 205.15, 205.24, 207.12, 207.16