



US 20030196283A1

(19) **United States**

(12) **Patent Application Publication**

Eliav et al.

(10) **Pub. No.: US 2003/0196283 A1**

(43) **Pub. Date: Oct. 23, 2003**

(54) **POWERED TOOTHBRUSH**

Publication Classification

(76) Inventors: **Eyal Eliav**, New York, NY (US); **John J. Gatzemeyer**, Hillsborough, NJ (US)

(51) **Int. Cl.⁷** **A61C 17/22**

(52) **U.S. Cl.** **15/22.1; 15/28; 15/110; 15/167.2; 15/188; 601/141; 601/142**

Correspondence Address:
COLGATE-PALMOLIVE COMPANY
909 River Road
P.O. Box 1343
Piscataway, NJ 08855-1343 (US)

(57) **ABSTRACT**

A powered toothbrush include a head containing a rotating or oscillating first bristle carrier and also containing a second bristle carrier movably connected to said head, which second bristle carrier may include elastomeric walls for enhanced cleaning and may include a weakened section to permit it to at least partially collapse during a brushing motion to couter to the teeth in use for enhanced cleaning.

(21) Appl. No.: **10/128,617**

(22) Filed: **Apr. 23, 2002**

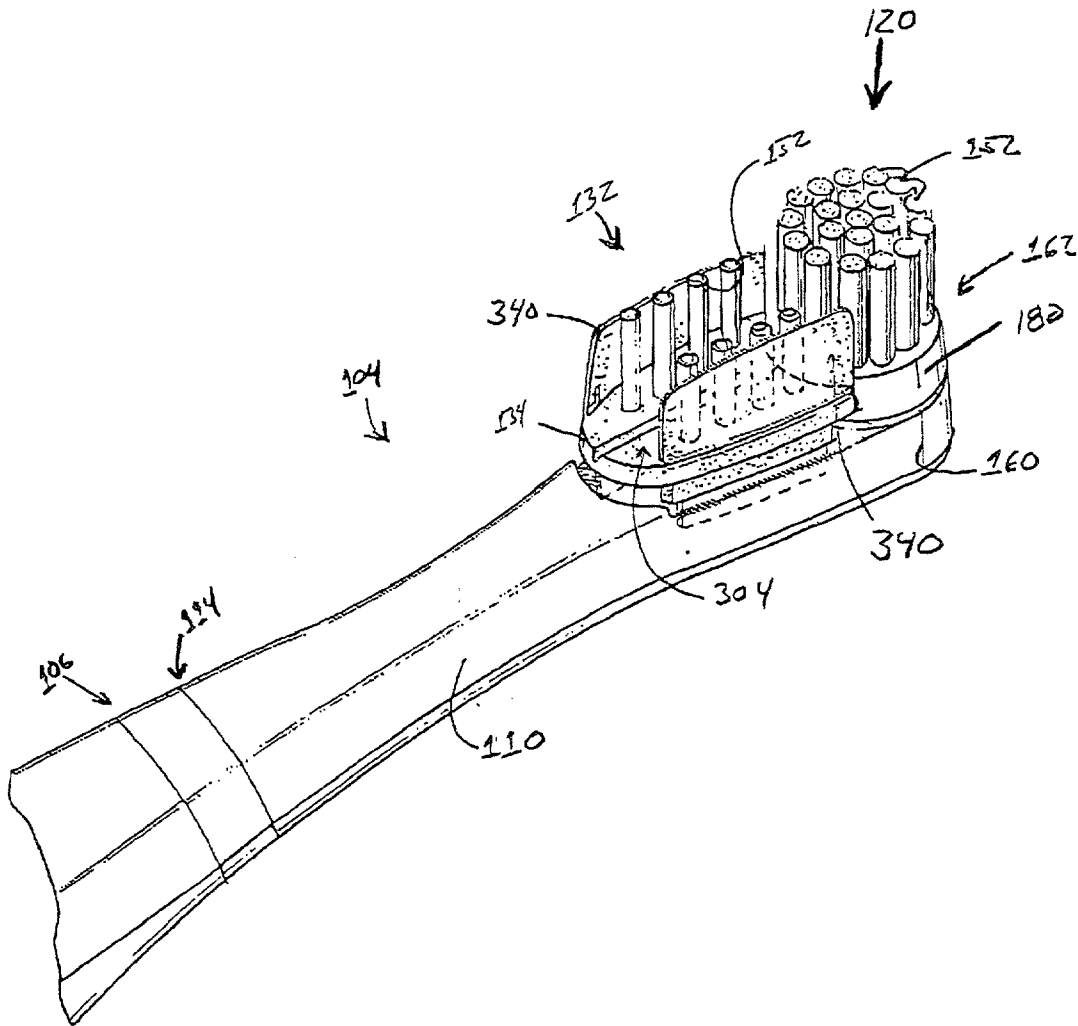

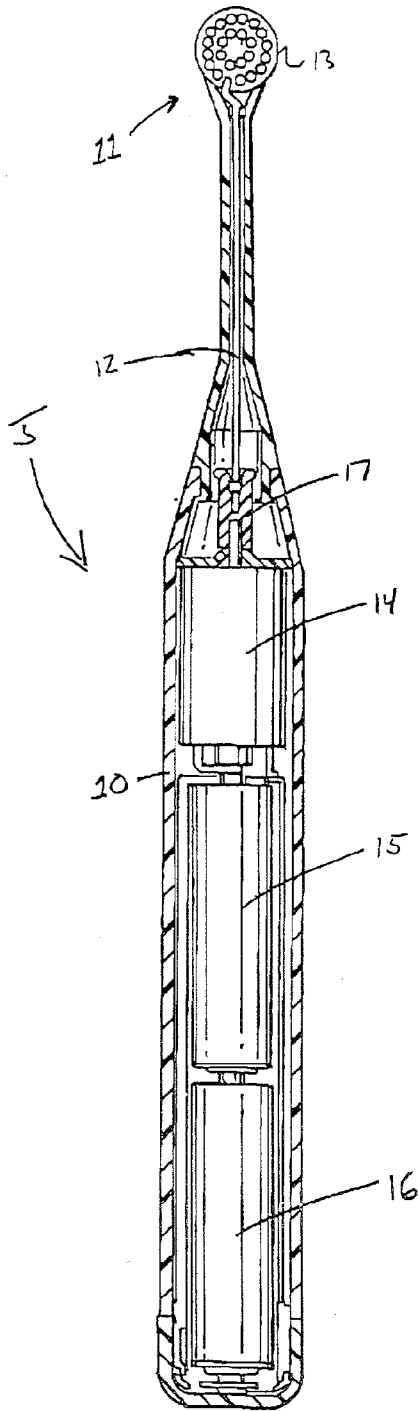

FIG 1A
(PREF. VIEW)

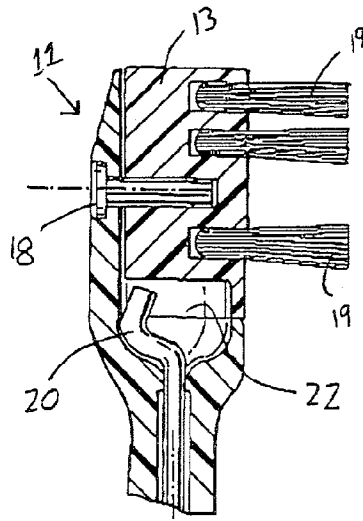

FIG 1B
(PREF. VIEW)

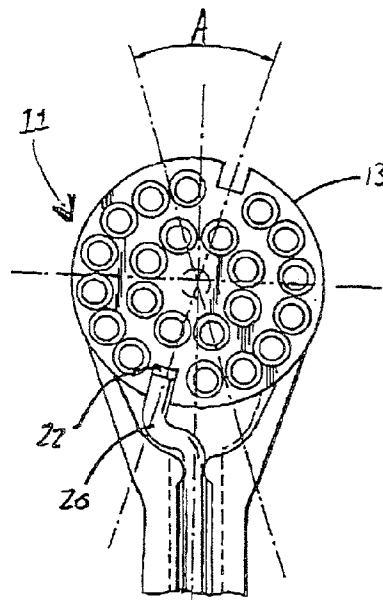

FIG 1C
(PREF. VIEW)

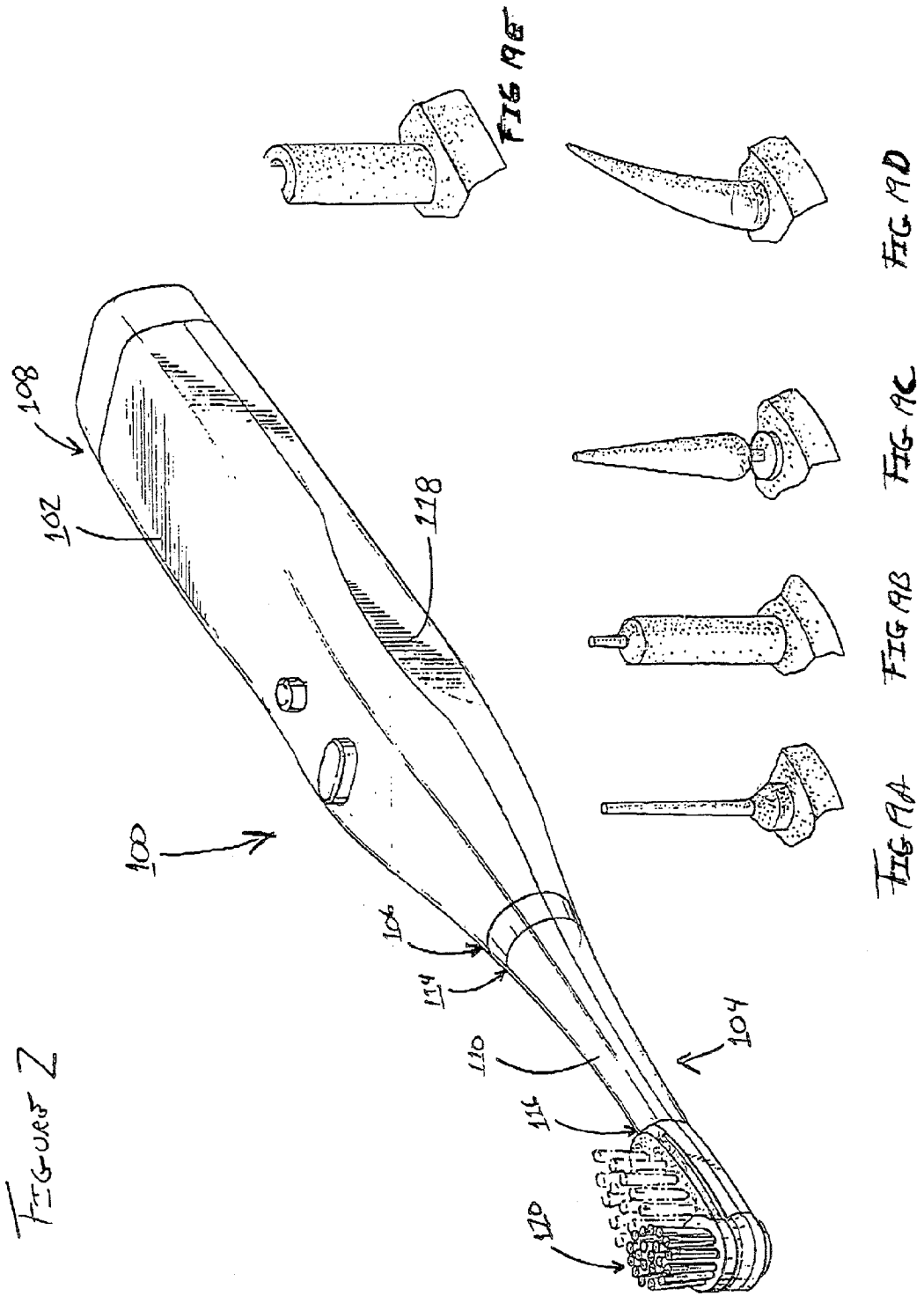

FIGURE 2

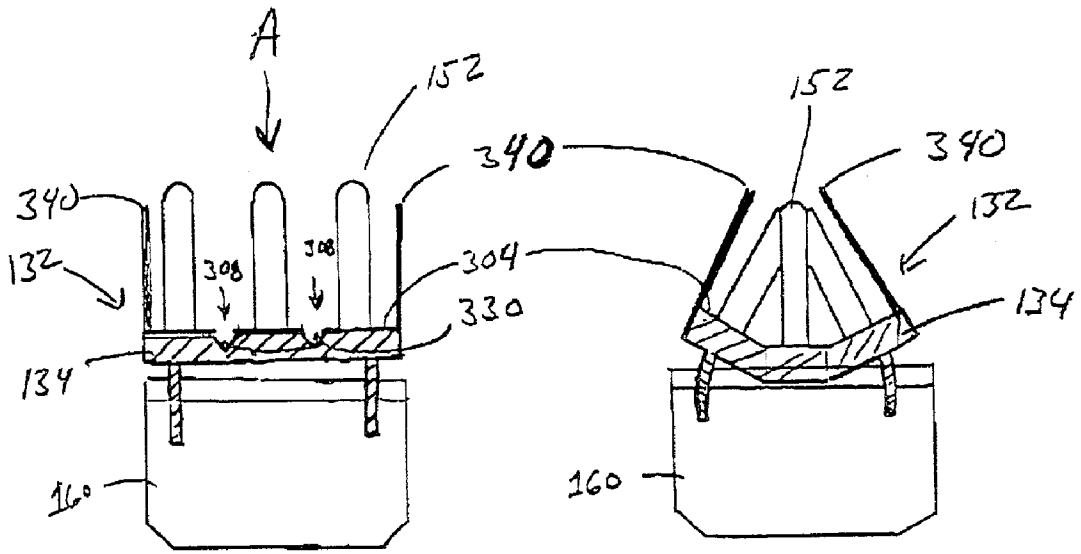

FIG. 4B

FIG. 4C

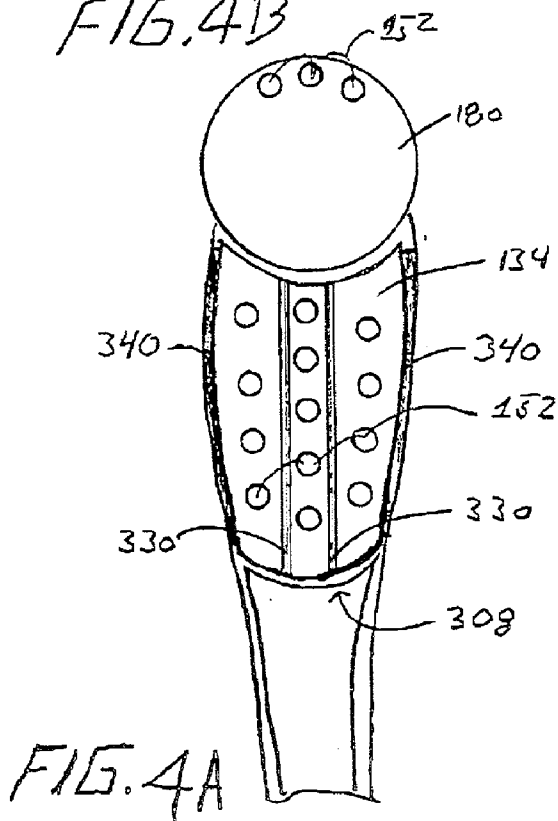

FIG. 4A

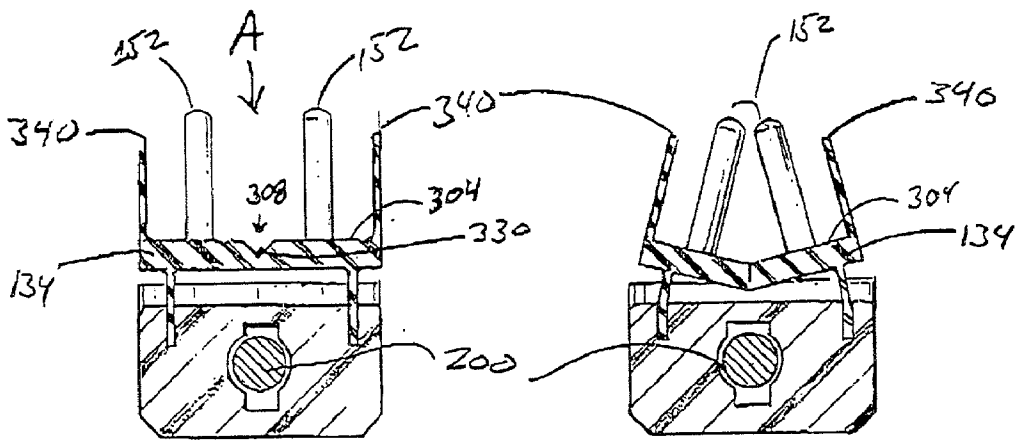

FIG. 6a

FIG. 6b

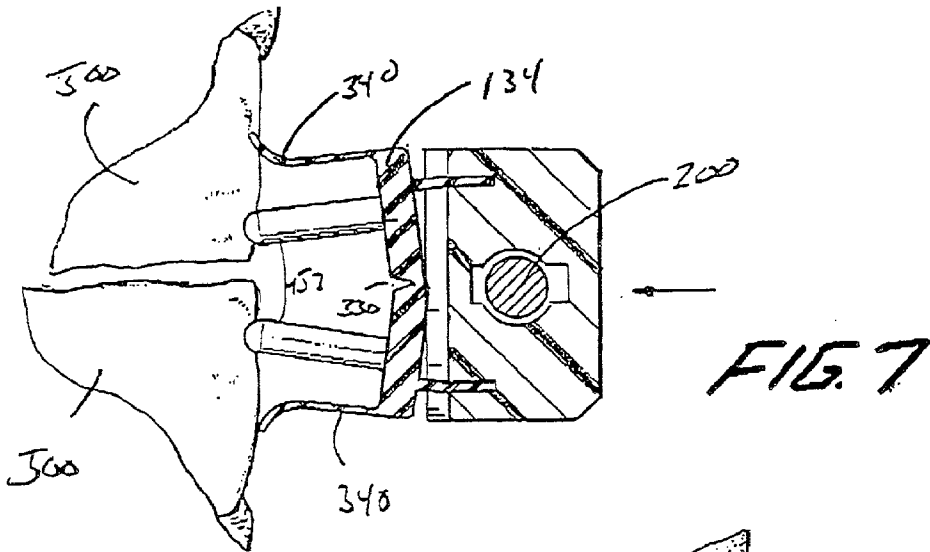

FIG. 7

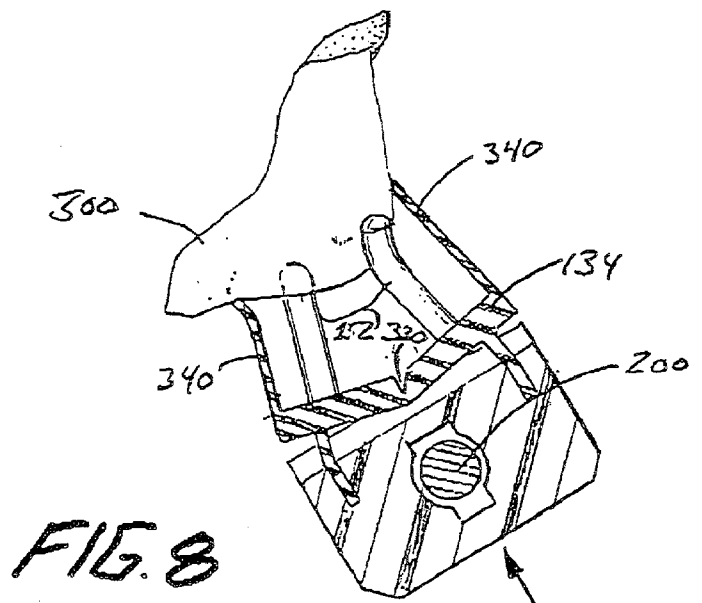
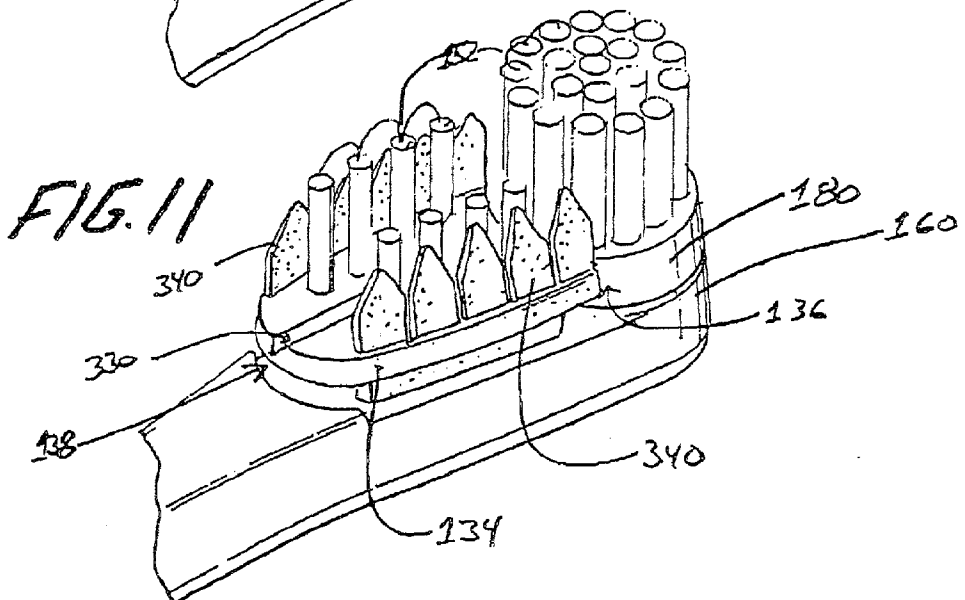
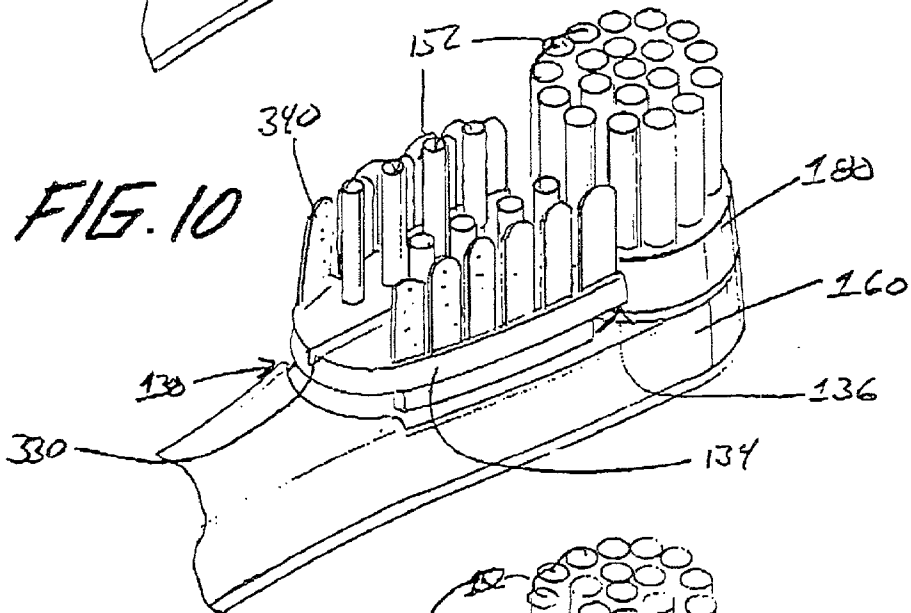
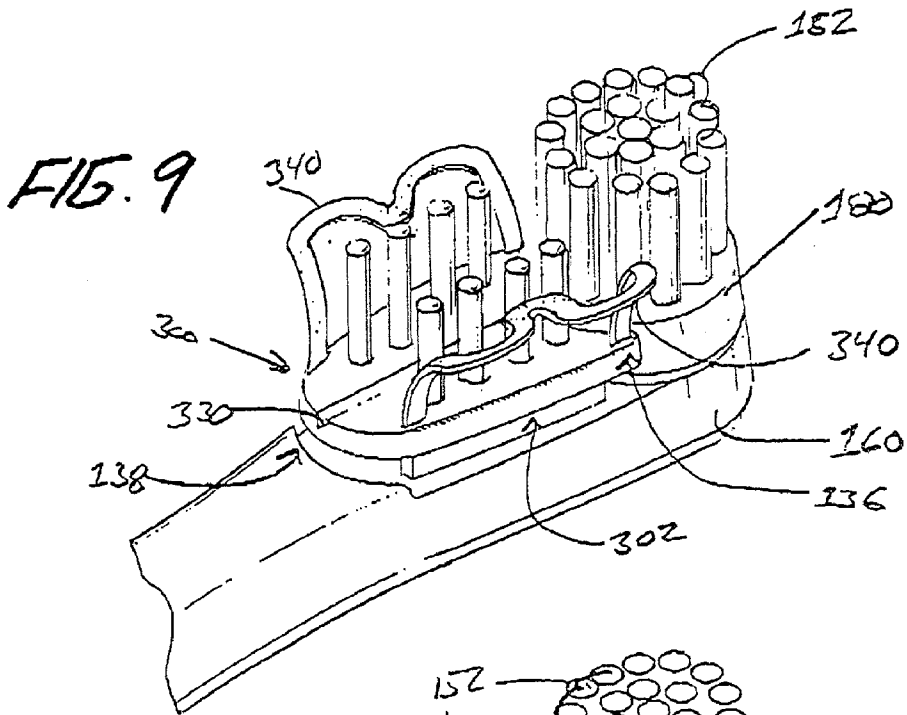
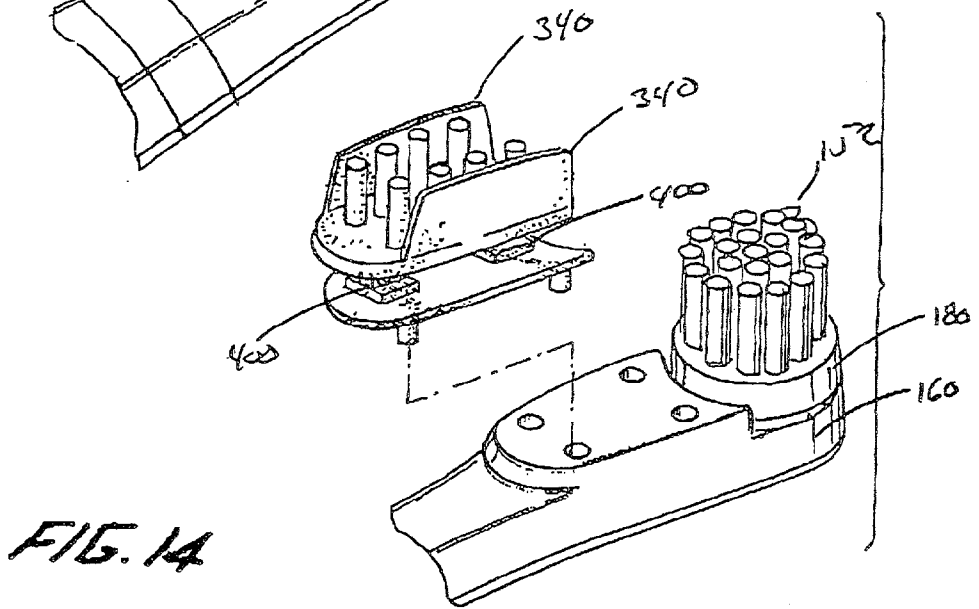
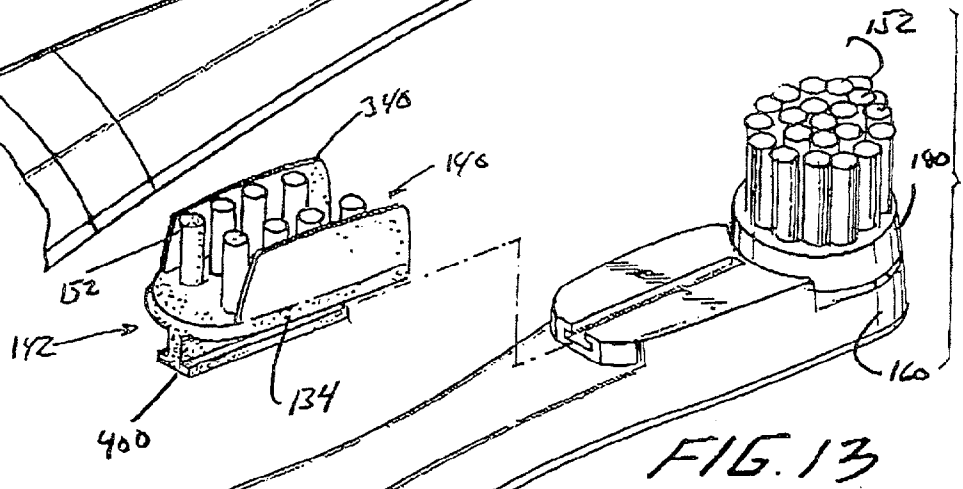
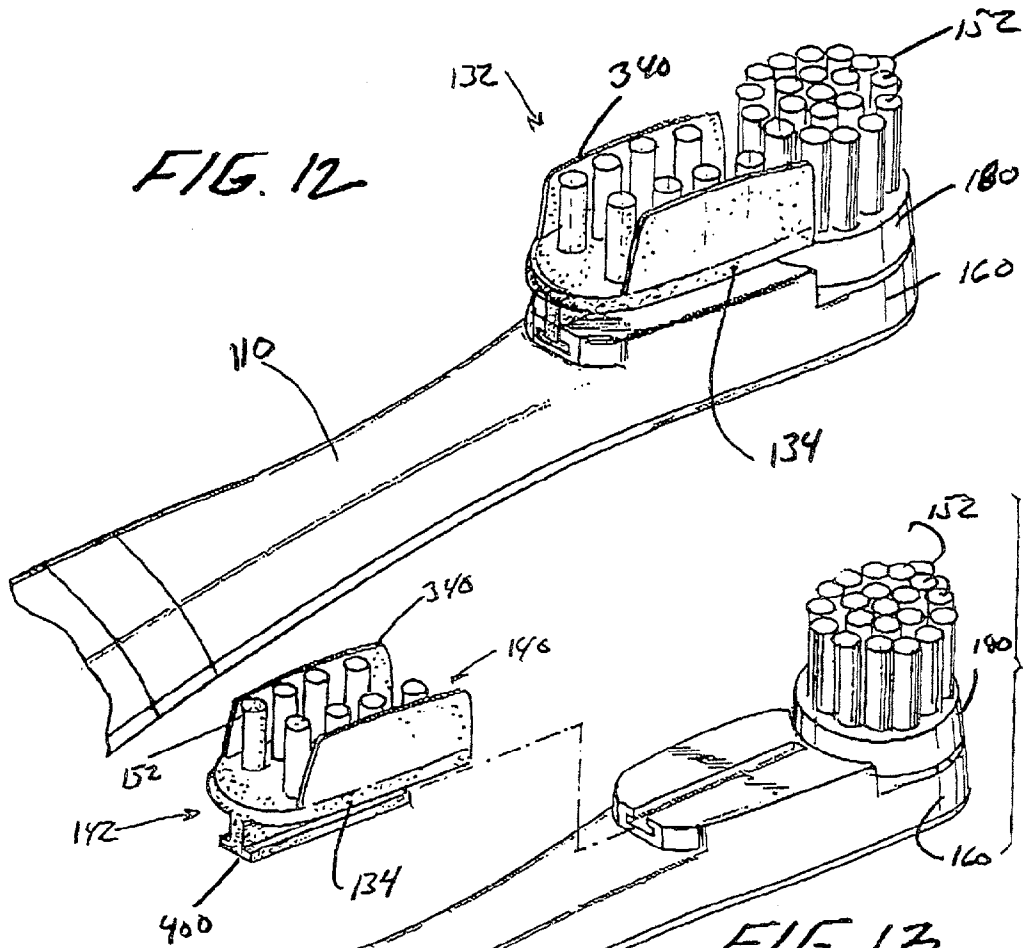
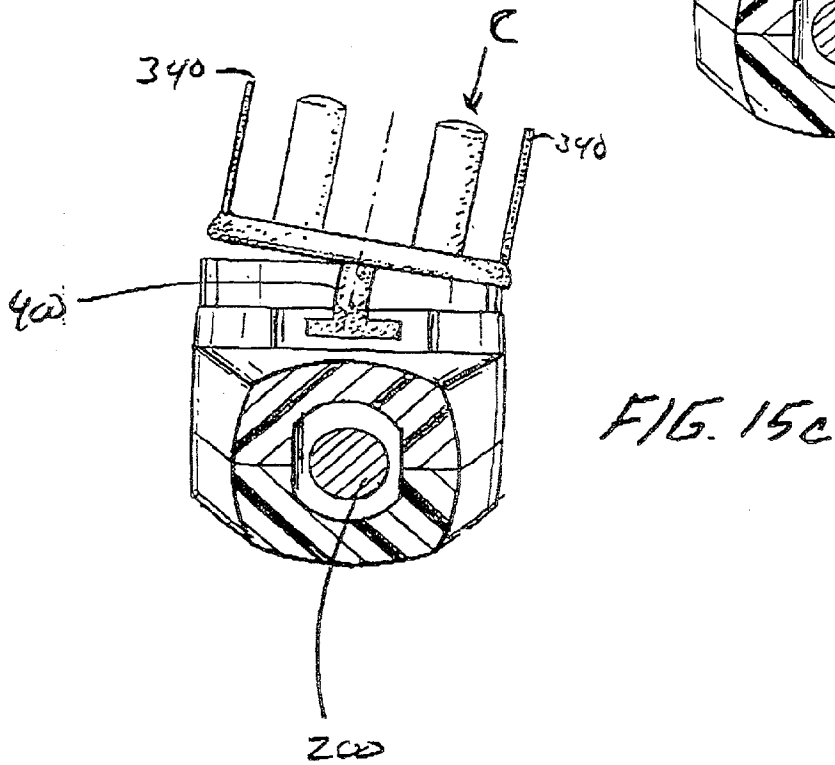
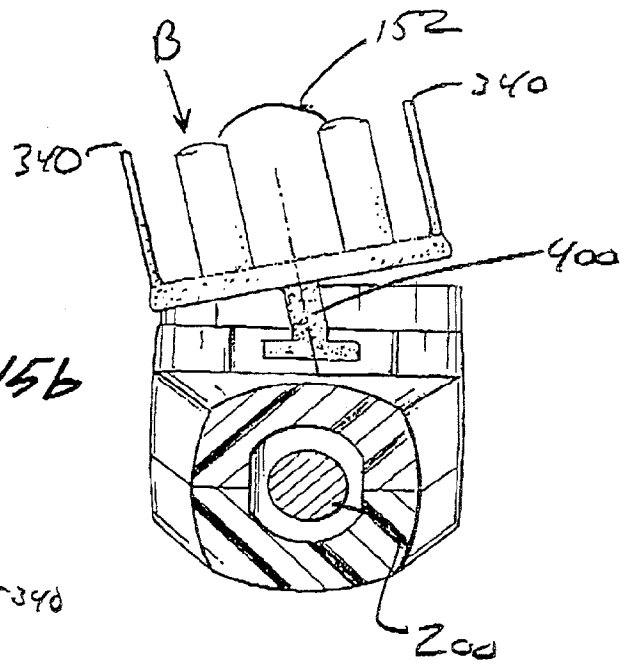
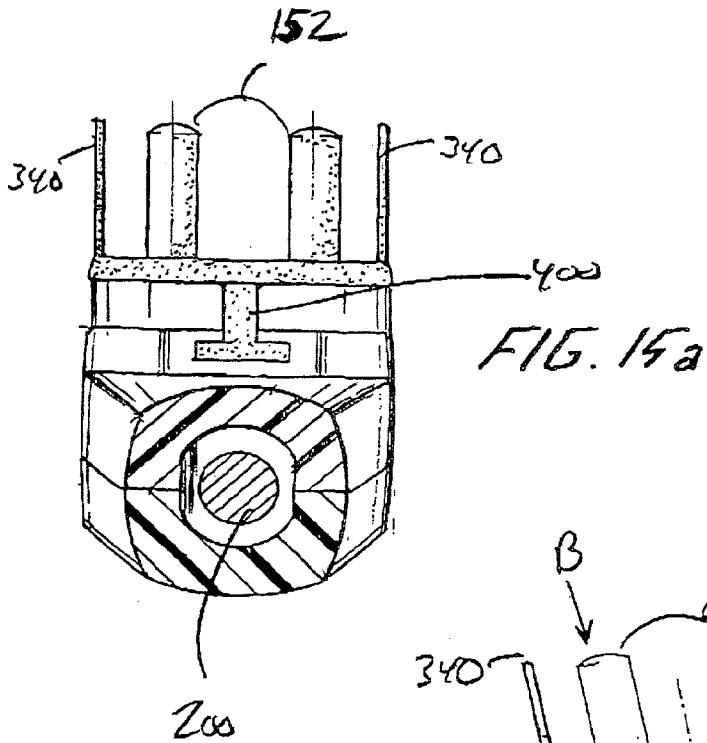

FIG. 8







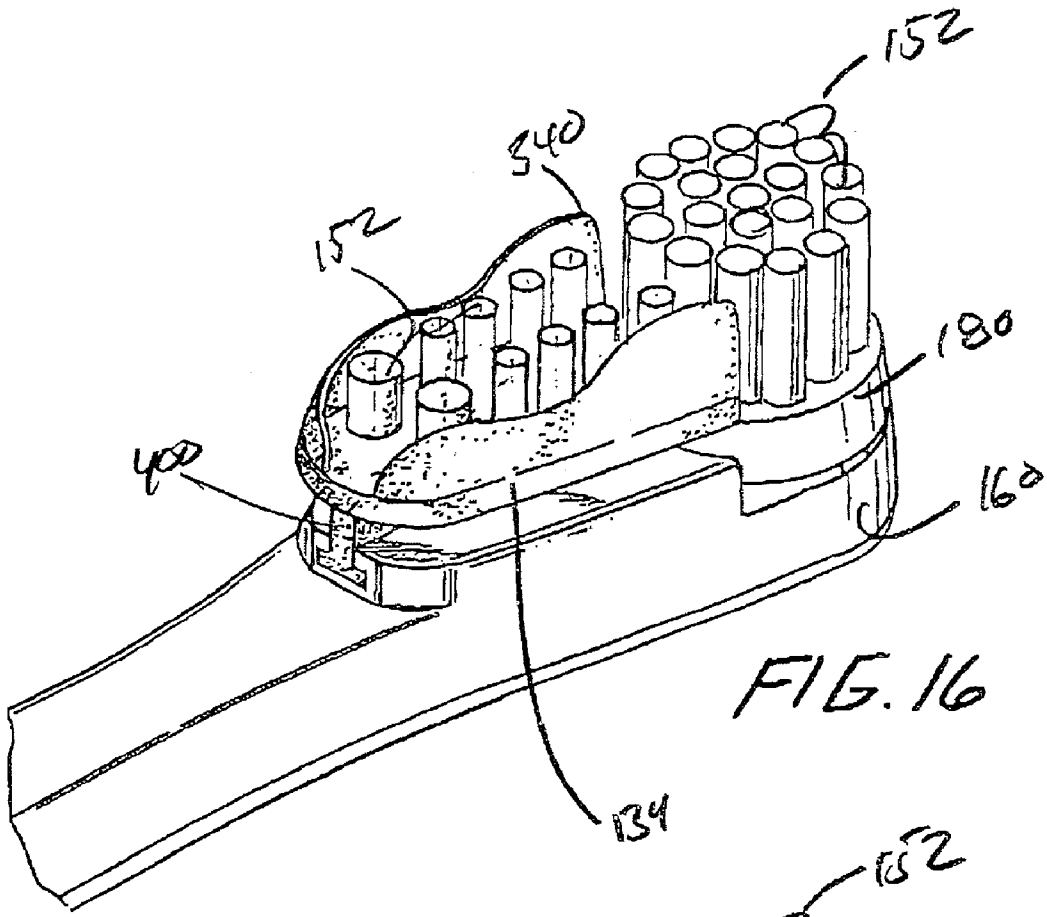

FIG. 16

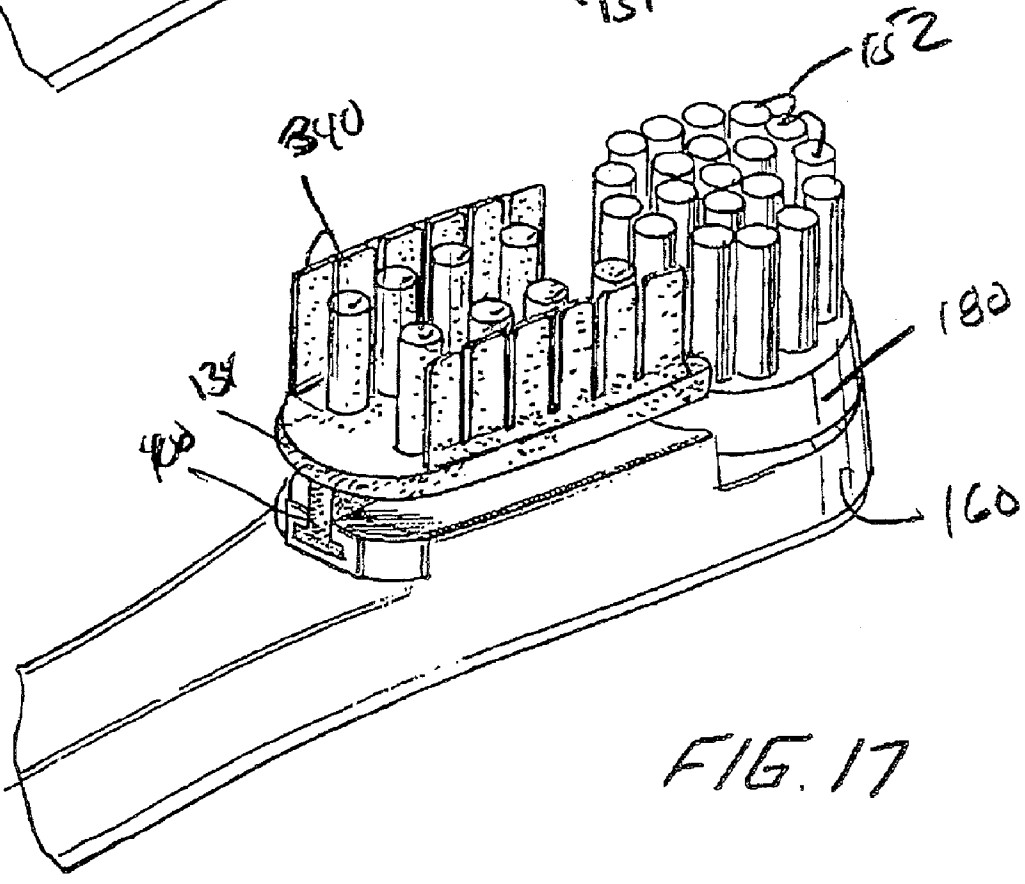
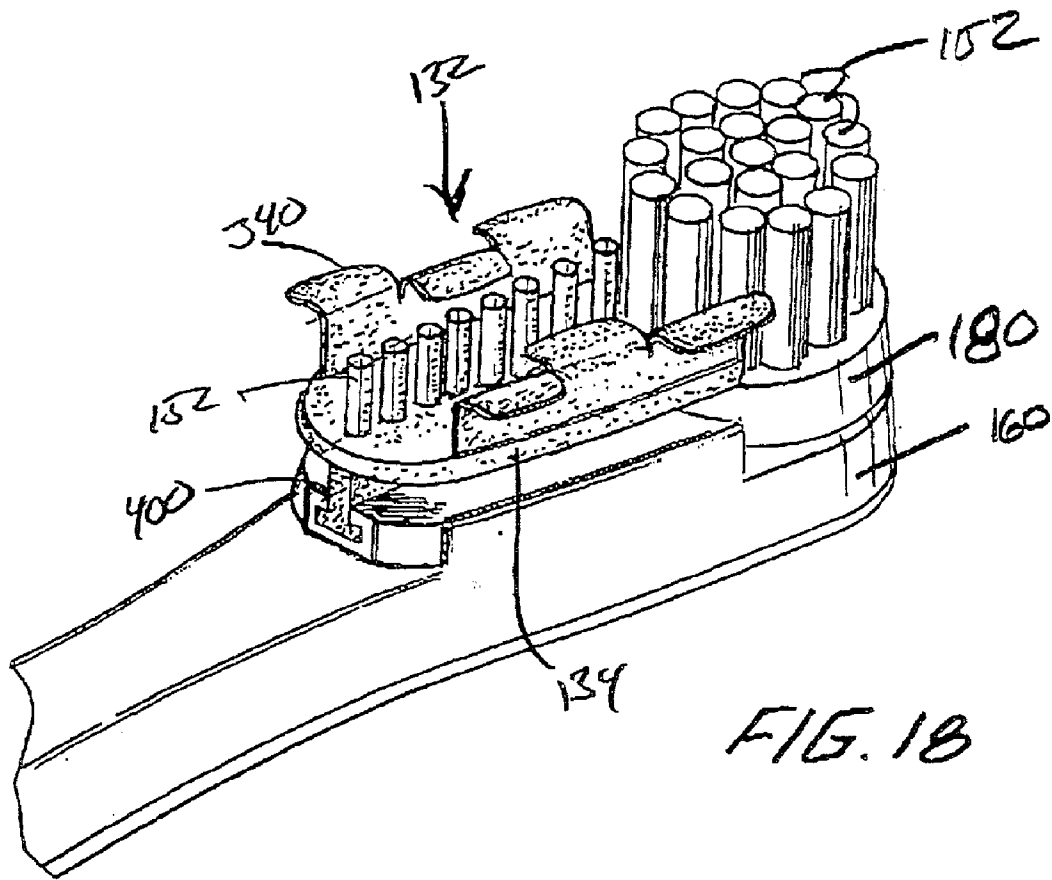

FIG. 17



POWERED TOOTHBRUSH

BACKGROUND OF THE INVENTION

[0001] 1. Field of the Invention

[0002] The present invention relates to powered toothbrushes, and more particularly, to a toothbrush having a head with two distinct sections that each provides cleaning and/or massaging oral health benefits to the soft and hard tissues of the mouth.

[0003] 2. Discussion of Related Art

[0004] Toothbrushes provide many oral hygiene benefits, including for example, toothbrushes remove plaque and food debris to help avoid tooth decay and disease. They remove stained pellicle from the surface of each tooth to help whiten the teeth. Also, the bristles combined with the brushing motion massage the gingival tissue for stimulation and increased health of the tissue.

[0005] Powered toothbrushes have been available for some time. Powered toothbrushes have advantages over manual (non-powered) toothbrushes in that they impart movement to the bristles at much higher speeds than possible manually. They also may impart different types and directions of motion. These motions, in combination with manual movement of the toothbrush by the user, generally provides superior cleaning than manual toothbrushes. Typically, powered toothbrushes are powered by disposable or rechargeable batteries that power an electric motor that in turn drives the toothbrush head.

[0006] Known powered toothbrushes include a brush head with a bristle carrier portion that rotates, oscillates or vibrates in some manner so as to clean the teeth. The bristles, which typically comprise bristle tufts, are generally uniform with one end fixed into the bristle carrier portion and the other end free to contact the surface of the teeth while brushing. The free ends of the various tufts present a surface envelope that is capable of some deformation when the bristles bend. When in contact with the surface to be brushed, the bristles may deform so that the surface envelope tends to conform to the complex surface of the teeth. Human teeth generally lie in a "C" shaped curve within the upper and lower jaw, and each row of teeth consequently has a convex outer curve and a concave inner curve. Individual teeth often have extremely complex surfaces, with areas that may be flat, concave, or convex. The more precise conformation between the bristles and the tooth surface, the more effective the toothbrush may be in cleaning, whitening and/or stimulating.

[0007] Known powered toothbrushes typically arrange the bristles in a compact conical or cylindrical pattern on a generally circular, disk-shaped bristle carrier. The powered toothbrush heads are traditionally compact, generally circular face from which a flat trimmed bristle pattern extends. Alternatively, other head shapes and bristle patterns are available.

[0008] One example of a powered toothbrush is depicted in U.S. Pat. No. 5,625,916 to McDougall, which is hereby incorporated by reference in its entirety. The toothbrush shown in McDougall has a disc-shaped bristle carrier. The bristle carrier, and thus the bristles, are driven in a vibrating or oscillating manner. This type of toothbrush is described

herein with reference to FIGS. 1A-1C. A toothbrush 5 includes a handle portion 10 at a proximal end of the toothbrush 5 and a head 11 at a distal end of the toothbrush 5. The handle portion 10 has compartments for containing a powered motor 14 and batteries 15 and 16. The head 11 includes a generally circular bristle holder (carrier) 13. A rotatable shaft 12 extends from the motor 14 to the head 11. A shaft coupling 17 may be located along the shaft 12 and configured to provide for the shaft 12 to be separated at a point between the motor 14 and the head 11. This permits the head 11 to be removed from the toothbrush 5, e.g., for cleaning, servicing, or replacement.

[0009] The head 11 includes a post 18 that provides a rotational pivot axis for the bristle holder 13 containing bristle tufts 19. The distal end of the shaft 12 has a journal or offset 20 that is radially displaced from the longitudinal axis of the shaft 12, which may be integrally formed therewith. The bristle holder 13 has a slot 22 that receives the offset 20. The offset 20 and slot 22 are configured so as to be oriented toward the intersection of the shaft 12 axis and the longitudinal axis of the post 18. When the motor 14 rotates the shaft 12, the motion of the offset 20 defines a circle about the shaft 12 axis and drivingly engages the slot 22 such that the bristle holder 13 vibrates or oscillates about the post 18 axis through a rotational angle A. The rotational angle A is defined by the displacement of the offset 20 from the shaft 12 axis relative to the diameter of the bristle holder 13.

[0010] Although powered toothbrushes such as those described immediately above provide advantages over manual toothbrushes, they are subject to various limitations.

[0011] Providing a rotating or oscillating bristle holder (carrier) with a typical circular, oblong or oval toothbrush head constrains the size of the moving bristle holder, and consequently the area of bristles available for teeth cleaning. Also, when the bristles are placed in contact with the teeth during brushing, there is less bristle contact with adjacent areas, such as the gums. Thus, while these compact bristle patterns provide for cleaning, there is minimal whitening and stimulation.

[0012] One attempt to overcome the limitations associated with a small powered bristle area is shown in U.S. Pat. No. 6,000,083 to Blaustein et al. The toothbrush in Blaustein et al. has a bristle area and pattern similar to a manual toothbrush, but an area of the bristles has simply been replaced by a powered bristle section. The result is that the head has a powered or moving bristle section and static bristle section. The limitation of Blaustein et al. is that the static bristle section provides no better cleaning, whitening or stimulation than a manual toothbrush.

[0013] International Application No. PCT/EP01/07615 of Braun GmbH discloses a powered toothbrush with two separate bristle parts that can move. Each bristle part can have a different range and/or type of motion. However, only one bristle part is powered. The other unpowered bristle part moves due to a resonance effect imparted by the frequency of the movement of the first bristle part. This free resonance causes a number of difficulties. First, because any contact between the bristle parts will dampen or cancel any resonance of the unpowered bristle part, the unpowered bristle part "floats" separately from the powered bristle part. This necessitates separation or gaps between them. These gaps

expose the internal workings of the head to foreign matter such as water, saliva, toothpaste, and food particles. This foreign matter may interfere with the workings of the unpowered bristle head. For example, the unpowered bristle part is spring-loaded to assist its resonance. Foreign matter may accumulate on or around the spring, interfering with its function. In addition, food particles may remain in the head and may fester and host microorganisms, which are undesirable if not potentially harmful when introduced directly into the mouth. Another limitation of such a design is that movement of the unpowered bristle part may be damped by contact with the teeth, or lessened when the frequency of the powered part shifts from the resonance frequency. This can occur due to pressure imparted against the powered bristle part by the teeth or gums during brushing. Finally, the energy imparted to the unpowered bristle part is only a portion of the energy input into the powered part. Therefore, the unpowered bristle part is less effective in cleaning than the powered part, limiting the overall effectiveness of the toothbrush.

[0014] Thus, there is a need in the art for a powered toothbrush with increased effectiveness through a larger area of powered or driven bristles or bristles that are otherwise movable. There is also a need for a toothbrush having increased whitening and/or stimulation than known toothbrushes. There is further a need for such improved toothbrushes to be comparable in manufacturing and purchasing costs as known powered toothbrushes.

SUMMARY OF THE INVENTION

[0015] A powered toothbrush is provided and includes a handle portion at a proximal end and a head at a distal end with a neck being formed between the handle portion and the head. According to one embodiment, the head has two distinct movable parts that provide cleaning and/or massaging oral health benefits since each is adapted to have a number of bristles or elastomeric cleaning members extending therefrom to contact surfaces of the teeth and surrounding areas. The toothbrush has a drive mechanism that imparts movement to the first movable part to deliver a cleaning, polishing, whitening action that supplements the cleaning efficiency of a typical powered toothbrush.

[0016] In one embodiment, the first movable head part is a first bristle carrier that supports at least one set of bristle tufts. The first bristle carrier is operatively mounted to the head and is coupled to the drive mechanism such that the first bristle carrier rotates and/or oscillates back and forth in a direction parallel to the toothbrush head. Preferably, the first bristle carrier oscillates back and forth in a rotational direction. The second movable part is in the form of a second bristle carrier that includes a platform (formed of a rigid and/or elastomeric material) that is operatively mounted to the head and includes upstanding elastomeric walls formed at first and second sides of the platform. The second bristle carrier also preferably includes at least one set of bristles disposed between the upstanding elastomeric walls. During a brushing motion, the bristles and elastomeric walls flex as they encounter the teeth and gingival tissue to provide the oral care benefits that are disclosed herein.

[0017] In another exemplary embodiment, the platform has a weakened section formed therein in a direction that is parallel to a longitudinal axis of the head such that upon

application of a force to the second bristle carrier, the platform at least partially collapses along the weakened section. This results in movement (e.g., inward flexing) of the elastomeric walls and the at least one set of bristles to provide oral care benefits.

[0018] In yet another embodiment, the second bristle carrier has an "I-beam" construction in that it includes a platform extending across the head and a web that connects the platform to the head. The platform includes at least one set of bristles extending upwardly therefrom. According to one configuration, at least the web is formed of an elastomeric material to permit the platform and at least one set of bristles formed as a part thereof to flex and move during a brushing motion. It will also be appreciated that the platform can also be formed of an elastomeric material and/or a rigid material used in combination with a web that is formed of a rigid material and/or an elastomeric material. The platform can also include elastomeric side walls that flex during the brushing motion.

[0019] Other features and advantages of the present invention will be apparent from the foregoing detailed description when read in conjunction with the accompanying drawings.

BRIEF DESCRIPTION OF THE DRAWING FIGURES

[0020] The foregoing and other features of the present invention will be more readily apparent from the following detailed description and drawings of illustrative embodiments of the invention in which:

[0021] **FIG. 1A** is a front cross-sectional view of a conventional powdered toothbrush including a head;

[0022] **FIG. 1B** is a partial cross-sectional side view of the toothbrush head of **FIG. 1A**;

[0023] **FIG. 1C** is a partial cross-sectional front view of the toothbrush head of **FIG. 1A**;

[0024] **FIG. 2** is a front and side perspective view of a powered toothbrush according to the present invention with a toothbrush head having distinct first and second sections, said second section being shown in general, i.e. dotted lines to indicate that several alternative embodiments are possible for said second section;

[0025] **FIG. 3** is a front and side perspective view of an embodiment of the powered toothbrush head of the powered toothbrush of **FIG. 2**, wherein a particular embodiment of said second section is shown in detail;

[0026] **FIG. 4** is a top plan view of the powered toothbrush head of the powered toothbrush embodiment of **FIG. 3**;

[0027] **FIGS. 4A-4C** are a top plan view and elevated cross-section views of an alternate embodiment of the powered toothbrush head of the powered toothbrush embodiment of **FIG. 3**, in motion;

[0028] **FIG. 5** is a top plan view of an alternate embodiment of the powered toothbrush head of the powered toothbrush embodiment of **FIG. 3**;

[0029] **FIGS. 6A-6B** are elevated cross-section views of another embodiment of the powered toothbrush head of **FIG. 3** in motion;

[0030] FIG. 7 is a cross-section view of the powered toothbrush head of the powered toothbrush of FIGS. 6a-6b engaging teeth;

[0031] FIG. 8 is a cross-section view of the powered toothbrush head of the powered toothbrush of FIGS. 6a-6b engaging teeth at an oblique angle;

[0032] FIG. 9 is a front and side perspective view of the powered toothbrush head of the powered toothbrush of FIG. 2, wherein another embodiment of said second section is shown in detail;

[0033] FIG. 10 is a front and side perspective view of the powered toothbrush head of the powered toothbrush of FIG. 2, wherein another embodiment of said second section is shown in detail;

[0034] FIG. 11 is a front and side perspective view of the powered toothbrush head of the powered toothbrush of FIG. 2, wherein another embodiment of said second section is shown in detail;

[0035] FIG. 12 is a front and side perspective view of another preferred embodiment of the powered toothbrush head of the powered toothbrush of the present invention;

[0036] FIG. 13 is a front and side perspective exploded view of the powered toothbrush head of the powered toothbrush of FIG. 12;

[0037] FIG. 14 is a front and side perspective exploded view of another embodiment of the powered toothbrush head of the powered toothbrush of FIG. 12;

[0038] FIGS. 15A-15C are elevated cross-section views of the powered toothbrush head of the embodiment of FIG. 12, in motion;

[0039] FIG. 16 is a front and side perspective view of the powered toothbrush head of the powered toothbrush of FIG. 2, wherein another embodiment of said second section is shown in detail;

[0040] FIG. 17 is a front and side perspective view of the powered toothbrush head of the powered toothbrush of FIG. 2, wherein another embodiment of said second section is shown in detail;

[0041] FIG. 18 is a front and side perspective view of the powered toothbrush head of the powered toothbrush of FIG. 2, wherein another embodiment of said second section is shown in detail;

[0042] FIG. 19A is a perspective view of an elastomeric tooth care element having a first configuration and adapted for use in the toothbrush head;

[0043] FIG. 19B is a perspective view of an elastomeric tooth care element having a second configuration and adapted for use in the toothbrush head;

[0044] FIG. 19C is a perspective view of an elastomeric tooth care element having a third configuration and adapted for use in the toothbrush head;

[0045] FIG. 19D is a perspective view of an elastomeric tooth care element having a fourth configuration and adapted for use in the toothbrush head;

[0046] FIG. 19E is a perspective view of an elastomeric tooth care element having a fifth configuration and adapted for use in the toothbrush head.

DESCRIPTION OF THE PREFERRED EMBODIMENT

[0047] Referring first to FIGS. 2 through 11 in which an exemplary powered toothbrush according to a first embodiment is illustrated and generally indicated at 100. The toothbrush 100 includes a handle 102 at a proximal end that defines an interior compartment (not illustrated) for housing various toothbrush components and a brush section 104 that is defined by a neck 110 that terminates in a head 120 at a distal end of the toothbrush 100. The handle 102 has a free proximal end 108 and an opposite neck end 106. The neck 110 generally extends from a first end 114 to a second end 116 with the first end 114 being located at the neck end 106 of the handle 102 and the second end 116 being located at the head 120. In other words, the neck 110 is the portion of the toothbrush 100 that extends between the handle 102 and the head 120. The neck 110 also defines an interior compartment (not illustrated) for housing various working components of the toothbrush 100. The head 120 is may be generally aligned with the longitudinal axis of the toothbrush 100 or may be mounted on a neck 110 with is angled with respect to said handle 102.

[0048] According to one embodiment, the neck 110 and the handle 102 are constructed as a unitary member by forming the neck 110 integral to the handle 102 at the neck end 106 of the handle 102. In another embodiment, the neck 110 is detachable from the handle 102 at the neck end 106 of the neck 110. In this embodiment, the combined neck 110 and head 120 can be removed from the handle 102 to permit cleaning, servicing and/or interchanging of either the handle 102 or the combined neck 110 and head 120. When the neck 110 is detachable from the handle 102, i.e. a replaceable head 120/neck 110 assembly, the first neck end 114 can include a connector (not illustrated) that is adapted to be detachably joined to the handle 102 using traditional techniques.

[0049] It will further be appreciated that the illustrated shapes of the handle 102 and neck 110 are merely exemplary in nature and the handle 102 and/or neck 110 can be formed to have any number of shapes. Preferably, the shapes of the handle 102 and the neck 110 are ergonomically efficient and pleasing to a user of the toothbrush 100 and provide a toothbrush that is easily gripped, held and manipulated by the user. For example, the handle 102 can include slightly recessed finger sections 118 which are formed on opposite sides of the handle 102. One recessed finger section 118 is designed to receive the thumb of one hand and the other recessed finger section 118 is designed to receive one or more other fingers of the same hand to thereby assist the user in proper placement of the toothbrush 100 in the user's hand. One or more of the recessed finger sections 118 can include ribs or another type of roughened surface to assist the user in gripping the toothbrush in the recessed finger sections 118.

[0050] As illustrated in FIGS. 3, 9, 10, 11, et seq., the head 120 of the toothbrush 100 includes a head base 160 that partially defines an inner compartment of the head 120. The head base 160 can be constructed so that it terminates in a rounded distal end 162, which actually defines the distal end of the toothbrush 100. Preferably, the head base 160 is integrally attached to the second end 116 of the neck 110.

[0051] The head 120 also includes a first movable bristle carrier 180 which is illustrated as being at the outermost or

distal portion of the head **120**. The first bristle carrier **180** can have a construction that is either identical to or similar to that of the bristle holder **13** illustrated in FIGS. **1A-1C**. The first movable bristle carrier **180** is preferably a disk with a circular cross-section face which it is intended to rotate or oscillate in a rotational manner. However, it will be appreciated that the first movable bristle carrier **180** is not limited to having a disk shape and can have any number of different shapes, such as egg-shaped, an oval or various other regular or irregular shapes, so long as the first moveable bristle carrier **180** can oscillate in a rotational manner. A circular shape is preferred since it requires the least amount of clearance to accommodate the oscillating movement.

[**0052**] A plurality of bristles **152** are coupled to and extend outwardly from the first movable bristle carrier **180**. As used herein, the term "bristles" generally defines tooth care elements and includes any type of structure that is commonly used or is suitable for use in providing oral health benefits (e.g., tooth cleaning, tooth polishing, tooth whitening, etc.) by making intimate contact with surfaces of the teeth and surrounding areas (e.g., gingival tissue). Such bristles include but are not limited to individual bristle strands or tufts of bristles (i.e., a set of bristles) that can be formed to have a number of different shapes and sizes and the bristles can also be in the form of elastomeric members, i.e. elongated elastomeric walls which may be linear or serpentine and/or elastomeric fingers, such as illustrated in FIGS. **19A-19E**, or the bristles can include a combination of any of the aforementioned tooth care elements. As illustrated, the arrangement of bristle tufts are only exemplary configurations or bristle patterns and it will be understood that other bristle configurations secured to the head in a conventional way (such as stapled, IMT technology, etc.) can be used and the bristle tufts can be formed of the same or different bristle materials (such as nylon bristles, spiral bristles, rubber bristles, etc.) Moreover, while the bristles can be arranged so that they are generally perpendicular to the surface or face of the toothbrush from which they extend, some or all of the bristles can be angled at various angles with respect to the face of the toothbrush. Using such different configurations, types and angles of bristles helps provide enhanced cleaning and massaging of the teeth and gums, especially in hard to penetrate areas, such as between the teeth and below the gum line.

[**0053**] FIGS. **19A-19E** illustrate various exemplary elastomeric members that serve as bristles **152**. FIG. **19A** shows an elastomeric tooth care element in the form of a thin spike; FIG. **19B** shows an elastomeric tooth care element in the form of a barrel spike; FIG. **19C** shows an elastomeric tooth care element in the form of a squeegee point; FIG. **19D** shows an elastomeric tooth care element in the form of an angled point; and FIG. **19E** shows an elastomeric tooth care element in the form of a section of an elastomeric wall. The elastomeric wall of FIG. **19E** can have a linear, planar shape; a zigzag shape; a serpentine shape, etc. All of the above elastomeric tooth care elements can have smooth textures or can have rough surfaces. In addition, the wall sections of the elastomeric tooth care elements can be vertically straight, taper toward inward toward one end or expand toward one end. The tops of the elastomeric tooth care walls can have a planar surface or can have a protrusion (i.e., hump) or the like formed thereat.

[**0054**] The toothbrush **100** includes a drive mechanism to effectuate movement of certain parts of the toothbrush **100** and more specifically, for causing movement of the first movable bristle carrier **180**. Any known geared type of drive structure can be used to oscillate said first movable bristle carrier **180**, such as disclosed in U.S. Pat. No. 6,000,083 or that disclosed in PCT publication WO 01/19281. One exemplary drive mechanism is disclosed in U.S. Pat. No. 5,625,916 to McDougall, which has been previously incorporated herein by reference and includes a rotating drive shaft **200** that extends at least through the neck **110** (i.e., the inner compartment thereof). The drive shaft **200** preferably has a construction that is the same as or similar in nature to the shaft **12** illustrated in FIGS. **1A-1C**.

[**0055**] The drive mechanism for the powered toothbrush **100** can be any type of drive, e.g., a rotating drive, an oscillating drive, an eccentric drive, an unbalanced-generated drive, a drive having one more gearing mechanisms, and/or the like, that is capable of performing the intended function. The drive mechanism can be realized in the form of an electric motor or other type of motor and the movement generated by the drive can be imparted to one or more sections of the head **120** or to other elements that can be present at the brush section, such as bristle tufts, elastomeric members. The movement can be imparted directly through a driving axle, such as drive shaft **200** or it can be imparted through a driving post attached to the driving axle. When the toothbrush **100** includes an oscillating drive mechanism either identical to or similar to the exemplary drive mechanism illustrated in FIGS. **1A through 1C**, the interior compartment of the handle **102** houses a motor operatively connected to the drive shaft **200** and a source to power the motor, such as one or more batteries

[**0056**] The toothbrush **100** further includes a second bristle carrier **132** that is operatively mounted on the head **120**. The second movable bristle carrier **132** comprises a platform **134** having a first end **136**, a second end **138**, a first end midpoint **140**, a second end midpoint **142**, a midpoint **144**, a far side **300**, a near side **302**, an upper surface **304** and a lower surface **306**. The platform **134** is attached to the head base **160** by supports which may be of such a thin plastic so as to bend readily or of an elastomer, so as to bend readily. In the preferred embodiment, the platform **134** is attached along two sections, at the far side **300** and the near side **302**. The platform **134** can be formed of a rigid material or can be formed of an elastomeric material.

[**0057**] The platform **134** may have a weakened section **308** incorporated therein to facilitate movement of the second bristle carrier **132** upon application of a force to the upper surface **304**. For example, a longitudinal groove (i.e., a score) **330** can be formed in at least one of the upper surface **304**. In the illustrated embodiment, a single groove **330** is formed across the upper surface **304**. The groove **330** forms a weakened section **308** longitudinally within the platform **134** (a so called "living hinge" is formed).

[**0058**] FIGS. **4A through 4C** illustrate another embodiment of a platform **134** including two grooves **330**. Herein, the center section may be deformed about grooves **308** which form hinges when a force **A** is applied. FIG. **4B** illustrates the second bristle carrier **132** in the relaxed condition, prior to any application of force **A**. FIG. **4C** illustrated that when a stress or force, force **A**, is applied to

the face or upper surface **304**, the center section may collapse toward the head base **160** and the tooth care elements **152** and the vertical elastomeric elements **340** formed on the upper surface **304** flex inwardly toward one another as a result of such deformation.

[0059] FIG. 5 illustrates the platform **134** with the weakened section **308** in another embodiment wherein openings (slots or gaps) **310** are formed along the weakened section **308** so as to define a number of discrete weakened sections to allow for more flexibility to the hinge. The cross-section of FIG. 6A illustrates another embodiment of the second bristle carrier **132** in a relaxed condition prior to application of a force to the face or upper surface **304**. FIG. 6B illustrates the second bristle carrier **132** and platform **134** in a stressed or deformed condition after a force A is applied to the upper surface **304**. When a force is applied to the upper surface **304**, the upper surface **304** deforms about the hinge created by the one or more grooves **330**. This results in the upper surface **304** at least partially collapsing along the hinge section. The bristles **152** formed on the upper surface **304** flex inwardly toward one another as a result of such deformation, as illustrated in FIG. 6B. The elastomeric second bristle carrier **132** can thus be thought of as a hinged block that has shock absorbing characteristics. When the applied force is removed, the second bristle carrier **132** returns to its relaxed condition due to its elastomeric nature.

[0060] Referring to FIGS. 7 and 8, illustrating the deforming movement when the head **120** is in contact with the teeth **500**. FIG. 7 illustrates the second carrier **132** pressed against the side of the teeth **500** and FIG. 8 illustrates the second carrier pressed against the teeth **500** at an oblique angle. Both figures illustrate the deformation of the platform **134** and the bristles and elastomeric elements extending therefrom. The vertical elastomeric element **340** is collapsed upon the surface of the teeth **500** to increase contact. This will enhance cleaning, whitening and massaging.

[0061] Preferably, the bristles **152** that extend upwardly from the upper surface **304** are a plurality of elastomeric members (such as those shown in FIGS. 9-11 and 16-18) that are formed integrally with the elastomeric second bristle carrier **300**. For example, the bristles **152** can be formed in the same molding operation that forms the elastomeric second bristle carrier **132**. Thus, while the elastomeric second bristle carrier **132** is described as a bristle carrier, it will be understood that the carrier **132** need not necessarily have to include traditional nylon bristles.

[0062] FIGS. 3, 9-11 and 16-18 illustrate numerous elastomeric members/ vertical elastomeric elements **340**. The vertical elastomeric elements **340** are typically located proximate to the far side **300** and the near side **302** of the platform **134**. However, a single vertical elastomeric element or a combination of such vertical elastomeric elements **340** can extend across the width of the second bristle carrier **132**. These vertical elastomeric elements **340** may be numerous different shapes and embodiments. FIG. 3 illustrates a straight wall; FIG. 9 illustrates a "butterfly wing", where the element is curvilinear and is only attached proximate to the first end **136** and the second end **138**; FIG. 10 illustrates a "paddle" formation, where the element has wide rounded-edge protrusions; FIG. 11 illustrates "dragon teeth"; where the element has a series of short pointed protrusions spaced

close together; FIG. 16 illustrates an element that is curvilinear in shape; FIG. 17 illustrates "fingers", narrow, closely spaced protrusions; and FIG. 18 illustrates opposing flaps. It will also be appreciated that any of the foregoing embodiments can be interchanged onto any second carrier regardless of the how or even if that second carrier is hinged or how that second carrier is mounted to the head base **160**.

[0063] FIGS. 12 through 18 illustrate views of another exemplary head embodiment of the present invention. The handle **102**, neck **110**, drive, and head base **160** may be the same as described above. However, referring to FIGS. 12 and 13, the second movable bristle carrier **132** is supported from said head base **160** by an "I-beam" type formation. The platform **134** of the second bristle carrier **132** is supported by an "I-beam" type formation or a web **400** which may be constructed of an elastomeric material possibly with a rigid polymer core to add strength thereto or according to an alternative embodiment, a rigid web **400** can be used in combination with an elastomeric platform **134**. The web **400** may extend, in a preferred embodiment, from about the first end midpoint **140** to about the second end midpoint **142**. The platform **134** can flex and bend about the web **400**. FIG. 14 illustrates a plurality of webs **400** spanning the longitudinal length of lower surface of the platform **134**.

[0064] FIGS. 15A-15C illustrate the embodiment of FIGS. 12-14 in motion. FIG. 15B illustrates the platform **134**, tilting about the web **400**, toward the far side **300** due to force B. FIG. 15C illustrates the platform **134** tilting toward the near side **302** due to a force C and 15A shows the platform **134** at rest.

[0065] FIGS. 16-18 illustrate further embodiments of the vertical elastomeric elements **340** which may be used with the described invention.

[0066] It will also be appreciated that in any of the foregoing embodiments, the toothbrush head can have a number of static tooth care elements disposed thereabout in a number of different locations.

[0067] The toothbrush **100** according to the various embodiments disclosed herein can be made from any number of materials that are suitable for use in oral care products, such as toothbrushes, etc. For example, many of the components that are included in the toothbrush **100** are formed of plastic materials. Accordingly, the handle **102** and head **120** of the powered toothbrush **100** can be molded from polyolefins such as polypropylenes and polyethylenes, polyamids such as nylons, and polyesters such as polyethylene terephthalate. Other suitable materials include polymethylmethacrylate, styrene acrylonitrile and cellulose esters, for example cellulose propionate.

[0068] When the tooth care elements are in the form of tufts of bristles, the bristles of can be made from a flexible material suitable for dental hygiene. Generally, materials suitable for bristles are polyamides such as nylon or polyesters such as polybutylene terephthalate. When the tooth care elements are in the form of elastomeric members, they can be made from any number of suitable elastomeric materials, such as a block copolymer. Preferred block copolymers include styrenes (for example styrene ethylene butadiene styrene, or styrene butadiene styrene), polyolefins (for example polypropylene/ethylene propylene diamine modified systems (i.e. synthetic rubber)), polyamides (for

example polyamide (2 or polyamide 6), polyesters (for example polyester ester or polyether ester), polyurethanes (for example polyesterurethane, polyetherurethane or poly-esteretherurethane).

[0069] Thus, while there have been shown, described, and pointed out fundamental novel features of the invention as applied to a preferred embodiment thereof, it will be understood that various omissions, substitutions, and changes in the form and details of the devices illustrated, and in their operation, may be made by those skilled in the art without departing from the spirit and scope of the invention. For example, it is expressly intended that all combinations of those elements and/or steps which perform substantially the same function, in substantially the same way, to achieve the same results are within the scope of the invention. Substitutions of elements from one described embodiment to another are also fully intended and contemplated. It is also to be understood that the drawings are not necessarily drawn to scale, but that they are merely conceptual in nature. It is the intention, therefore, to be limited only as indicated by the scope of the claims appended hereto.

What is claimed is:

1. A powered toothbrush comprising:
 - a handle portion having a neck formed at one end;
 - a head coupled to the neck, the head having an outer surface and further including:
 - a first bristle carrier coupled to the head and operatively connected to a first drive feature for rotationally or oscillatingly moving the first carrier, the first bristle carrier having at least one set of bristles extending outwardly therefrom; and
 - a second bristle carrier coupled to the head, the second bristle carrier including a platform with upstanding elastomeric walls formed at first and second sides of the platform, the second bristle carrier having at least one set of bristles extending outwardly from an upper surface of the platform between the elastomeric walls.
2. The powered toothbrush as defined in claim 1, wherein the first bristle carrier oscillates in a direction parallel to an outer surface of the head.
3. The powered toothbrush as defined in claim 1, wherein each of the upstanding elastomeric walls has a shape selected from the group consisting of: linear, butterfly wing, paddle, dragon teeth, wave, and opposing flaps.
4. The powered toothbrush as defined in claim 2, wherein the platform is formed of one of a rigid material and/or an elastomeric material.
5. The powered toothbrush as defined in claim 2, wherein the at least one set of bristles of the second bristle carrier comprises a plurality of elastomeric fingers disposed between the upstanding elastomeric walls.
6. A powered toothbrush comprising:
 - a handle portion having a neck formed at one end;
 - a head coupled to the neck, the head having an outer surface and further including:
 - a first bristle carrier coupled to the head and operatively connected to a first drive feature for rotationally or oscillatingly moving the first bristle carrier, the first bristle carrier having at least one set of bristles extending outwardly therefrom; and
 - a second bristle carrier coupled to the head, the second bristle carrier including a platform having at least one set of bristles extending outwardly from an upper surface thereof, the platform having at least one weakened section formed therein in a direction that is parallel to a longitudinal axis of the head such that upon application of a force to the second bristle carrier, the platform at least partially collapses along the at least one weakened section resulting in movement of the at least one set of bristles.
7. The powered toothbrush as defined in claim 6, wherein the first bristle carrier oscillates in a direction that is parallel to an outer surface of the head.
8. The powered toothbrush as defined in claim 6, wherein the first bristle carrier oscillates in a back and forth manner.
9. The powered toothbrush as defined in claim 6, wherein the first bristle carrier is oscillated in a rotational direction.
10. The powered toothbrush as defined in claim 6, wherein the second bristle carrier moves substantially in a direction perpendicular to an outer surface of the head when the force is applied thereto.
11. The powered toothbrush as defined in claim 6, wherein the drive mechanism includes a motor driven shaft having a drive end that drives the first bristle carrier.
12. The powered toothbrush as defined in claim 6, wherein the at least one weakened section comprises a groove formed in the platform.
13. The powered toothbrush as defined in claim 6, wherein the at least one weakened section extends substantially from a first end to a second end of the platform.
14. The powered toothbrush as defined in claim 6, wherein the at least one weakened section has at least one opening formed therealong, the at least one opening partitioning the at least one weakened section into two or more weakened sections.
15. The powered toothbrush as defined in claim 6, wherein the platform is formed of a rigid and/or an elastomeric material.
16. The powered toothbrush as defined in claim 6, wherein the second bristle carrier includes a first elastomeric wall formed along a first side of the platform and a second elastomeric wall formed along an opposing second side of the platform.
17. The powered toothbrush as defined in claim 16, wherein the platform is attached to the head generally at the first and second sides of the platform.
18. The powered toothbrush as defined in claim 16, wherein a shape of each of the first and second elastomeric walls is selected from the group consisting of: linear, butterfly wing, paddle, dragon teeth, wave, and opposing flaps.
19. The powered toothbrush as defined in claim 6, wherein the at least one weakened section comprises a plurality of weakened sections formed parallel to one another.
20. The powered toothbrush as defined in claim 19, wherein a plurality of elastomeric cleaning members is formed between two weakened sections.
21. The powered toothbrush as defined in claim 19, wherein the plurality of weakened sections are each in the form of a groove formed in the upper surface of the platform.

22. A powered toothbrush comprising:

a handle portion having a neck formed at one end; and

a head coupled to the neck, the head having an outer surface and further including:

a first bristle carrier coupled to the head and operatively connected to a first drive feature for rotationally or oscillatingly moving the first bristle carrier, the first bristle carrier having at least one set of bristles extending outwardly therefrom; and

a second bristle carrier coupled to the head, the second bristle carrier having at least one set of bristles extending outwardly from an upper surface thereof, the second bristle carrier comprising:

a platform extending across the head, an upper surface of the platform supporting the at least one set of bristles; and

a web attached to and extending between the platform and the head.

23. The powered toothbrush as defined in claim 22, wherein both the platform and web are both formed of a rigid or elastomeric material, or combinations thereof.

24. The powered toothbrush as defined in claim 22, wherein the web is formed of an elastomeric material and the platform is formed of an elastomeric material.

25. The powered toothbrush as defined in claim 22, wherein the web extends in a direction parallel to a longitudinal axis of the head.

26. The powered toothbrush as defined in claim 22, wherein the web extends substantially the length of the platform.

27. The powered toothbrush as defined in claim 22, wherein the web has openings formed therealong resulting in the web being partitioned into a plurality of discrete sections.

28. The powered toothbrush as defined in claim 22, wherein the platform includes at least two vertical elastomeric elements formed generally along the first and second sides of the platform.

29. The powered toothbrush as defined in claim 28, wherein the vertical elastomeric elements comprise walls.

30. The powered toothbrush as defined in claim 22, wherein the web is formed along a medial longitudinal axis of the platform.

31. The powered toothbrush as defined in claim 22, wherein the handle portion includes recessed finger sections formed on opposite sides of the handle portion for providing a gripping area for holding the handle portion.

32. The powered toothbrush as defined in claim 31, wherein the recessed sections include roughened surfaces.

* * * * *