

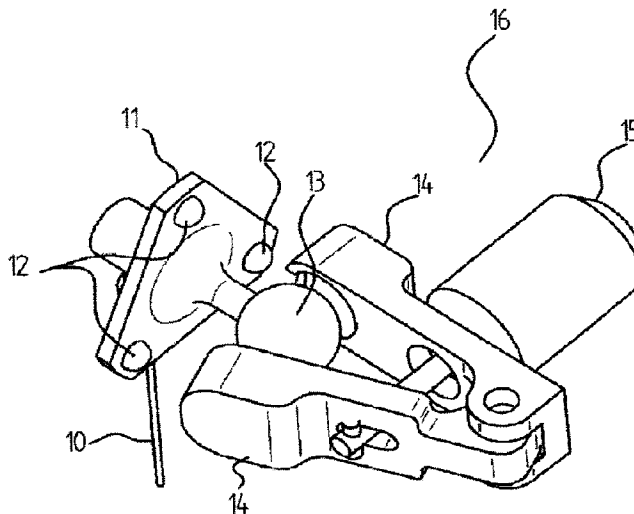

(86) Date de dépôt PCT/PCT Filing Date: 2014/10/07  
 (87) Date publication PCT/PCT Publication Date: 2015/04/16  
 (45) Date de délivrance/Issue Date: 2022/08/02  
 (85) Entrée phase nationale/National Entry: 2016/04/06  
 (86) N° demande PCT/PCT Application No.: IL 2014/050890  
 (87) N° publication PCT/PCT Publication No.: 2015/052718  
 (30) Priorité/Priority: 2013/10/07 (US61/887,634)

(51) Cl.Int./Int.Cl. *A61B 17/06* (2006.01),  
*A61B 17/062* (2006.01), *A61M 25/06* (2006.01)  
 (72) Inventeurs/Inventors:  
GLOZMAN, DANIEL, IL;  
DASKAL, GONEN, SE;  
SHOHAM, MOSHE, IL;  
ARAD, MICHAEL, IL;  
PINSKY, YOAV, IL  
 (73) Propriétaire/Owner:  
TECHNION RESEARCH & DEVELOPMENT  
FOUNDATION LTD., IL  
 (74) Agent: PRAXIS

(54) Titre : SYSTEME DE PREHENSION POUR L'INSERTION ROBOTISEE D'UNE AIGUILLE GUIDEE PAR IMAGE  
 (54) Title: GRIPPER FOR ROBOTIC IMAGE GUIDED NEEDLE INSERTION



(57) **Abrégé/Abstract:**

A system and method for ensuring safe and tolerable insertion of a needle into a subject's body according to a preplanned or continuously monitored sequence of insertion steps. The system comprises a gripping device for gripping the needle in order to perform robotic insertion steps, yet for releasing the grip between such insertion steps, until the next insertion step is initiated. Thereby, the robot has full control of the needle during insertion steps, but does not constrain the needle between insertions, such that movement of the subject can cause neither damage nor discomfort. The gripping and insertion steps may be coordinated to keep in synchronization with the subject's breathing cycles, such that the insertion steps may be performed in the same segment of each cycle of motion of the subject's chest. The gripper can either fully disconnect from the needle, or can partially disconnect but constrain motion within limits.

(12) INTERNATIONAL APPLICATION PUBLISHED UNDER THE PATENT COOPERATION TREATY (PCT)

(19) World Intellectual Property  
Organization  
International Bureau(10) International Publication Number  
**WO 2015/052718 A1**(43) International Publication Date  
16 April 2015 (16.04.2015)

## (51) International Patent Classification:

A61B 17/06 (2006.01) A61B 19/00 (2006.01)  
A61B 17/062 (2006.01) A61M 25/06 (2006.01)

## (21) International Application Number:

PCT/IL2014/050890

## (22) International Filing Date:

7 October 2014 (07.10.2014)

## (25) Filing Language:

English

## (26) Publication Language:

English

## (30) Priority Data:

61/887,634 7 October 2013 (07.10.2013) US

(71) Applicant: **TECHNION RESEARCH & DEVELOPMENT FOUNDATION LTD.** [IL/IL]; Senate House, Technion City, 32000 Haifa (IL).(72) Inventors: **GLOZMAN, Daniel**; 10 Rotem Street, 90618 Kfar Adummim (IL). **DASKAL, Gonen**; Bayit 1, 12305 Kefar Hanassi (IL). **SHOHAM, Moshe**; 22 Bedolach Street, 17915 Hoshaya (IL). **ARAD, Michael**; 32 Remez Street, 62192 Tel Aviv (IL). **PINSKY, Yoav**; Bayit No. 8, Beit Keshet, 15247 M.P. Lower Galilee (IL).(74) Agent: **SECEMSKI, Ephraim**; P.O. Box 4500, 91044 Jerusalem (IL).

(81) Designated States (unless otherwise indicated, for every kind of national protection available): AE, AG, AL, AM, AO, AT, AU, AZ, BA, BB, BG, BH, BN, BR, BW, BY, BZ, CA, CH, CL, CN, CO, CR, CU, CZ, DE, DK, DM, DO, DZ, EC, EE, EG, ES, FI, GB, GD, GE, GH, GM, GT, HN, HR, HU, ID, IL, IN, IR, IS, JP, KE, KG, KN, KP, KR, KZ, LA, LC, LK, LR, LS, LU, LY, MA, MD, ME, MG, MK, MN, MW, MX, MY, MZ, NA, NG, NI, NO, NZ, OM, PA, PE, PG, PH, PL, PT, QA, RO, RS, RU, RW, SA, SC, SD, SE, SG, SK, SL, SM, ST, SV, SY, TH, TJ, TM, TN, TR, TT, TZ, UA, UG, US, UZ, VC, VN, ZA, ZM, ZW.

(84) Designated States (unless otherwise indicated, for every kind of regional protection available): ARIPO (BW, GH, GM, KE, LR, LS, MW, MZ, NA, RW, SD, SL, ST, SZ, TZ, UG, ZM, ZW), Eurasian (AM, AZ, BY, KG, KZ, RU, TJ, TM), European (AL, AT, BE, BG, CH, CY, CZ, DE, DK, EE, ES, FI, FR, GB, GR, HR, HU, IE, IS, IT, LT, LU, LV, MC, MK, MT, NL, NO, PL, PT, RO, RS, SE, SI, SK, SM, TR), OAPI (BF, BJ, CF, CG, CI, CM, GA, GN, GQ, GW, KM, ML, MR, NE, SN, TD, TG).

## Published:

— with international search report (Art. 21(3))

(54) Title: GRIPPER FOR ROBOTIC IMAGE GUIDED NEEDLE INSERTION

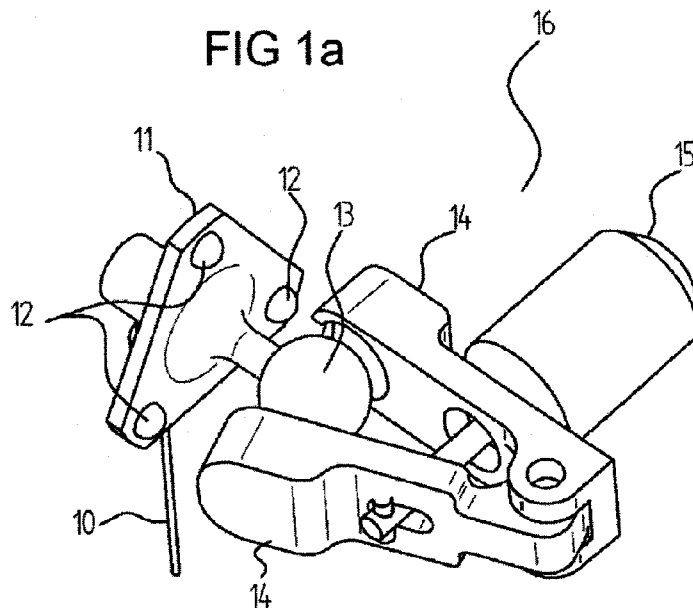

(57) Abstract: A system and method for ensuring safe and tolerable insertion of a needle into a subject's body according to a preplanned or continuously monitored sequence of insertion steps. The system comprises a gripping device for gripping the needle in order to perform robotic insertion steps, yet for releasing the grip between such insertion steps, until the next insertion step is initiated. Thereby, the robot has full control of the needle during insertion steps, but does not constrain the needle between insertions, such that movement of the subject can cause neither damage nor discomfort. The gripping and insertion steps may be coordinated to keep in synchronization with the subject's breathing cycles, such that the insertion steps may be performed in the same segment of each cycle of motion of the subject's chest. The gripper can either fully disconnect from the needle, or can partially disconnect but constrain motion within limits.

## GRIPPER FOR ROBOTIC IMAGE GUIDED NEEDLE INSERTION

### FIELD OF THE INVENTION

The present invention relates to the field of needle holding devices for image guided needle insertion, especially using robotic insertion.

### BACKGROUND

Many routine treatments employed in modern clinical practice involve percutaneous insertion of needles and catheters, such as for biopsy or drug delivery. The aim of a needle insertion procedure is to place the tip of an appropriate needle safely and accurately in a lesion, organ or vessel. Examples of treatments requiring needle insertions include vaccinations, blood/fluid sampling, regional anesthesia, tissue biopsy, catheter insertion, cryogenic ablation, electrolytic ablation, brachytherapy, neurosurgery, deep brain stimulation and various minimally invasive surgeries.

There is a growing trend of performing needle insertion with offline or intra-operative image guidance. Guiding the needle based on offline images has a disadvantage, because the patient keeps breathing and the offline image then becomes historic in nature. In addition, because of gravitational force the abdomen soft tissues deform with time. The imaging scan is thus valid for several seconds only.

Even when the needle is inserted under real-time, fluoroscopic vision of the needle insertion procedure is not simple and requires proficient performance. Moreover as shown in the PCT published application WO 2007/141784 for "Controlled Steering of a Flexible Needle", having a common co-inventor with the present application, the needle can be inserted in numerous ways even when the needle tip is required to follow the same trajectory.

In order to overcome these difficulties and improve needle placement accuracy, use is made of the model for flexible needle steering and control in soft tissue, as described in the above referenced PCT. As shown there, the manipulation required on the needle base is too complex to perform manually. Therefore the needle insertion is performed with a robot.

In a typical robotic image guided needle insertion procedure, the needle insertion will be done step-wise. The needle is not inserted in a single iteration for safety reasons. The usual procedure flow is as follows:

1. An image is taken with the needle and the target.
2. The operator analyses the image and decides whether correction to the movement is necessary.
3. The robot is then commanded to move the needle by the next step.

It can take from several seconds to several minutes to take the image and to decide how to proceed. During this time the patient continues breathing with the needle inside his/her body, such that its position is constantly changing, albeit quasi-periodically. Even when the procedure is performed without operator feedback, being based only on image data, besides the quasi-periodic breathing motion, the patient may also move his body because of pain or a cough. If the needle base is held stiffly by the insertion robot, a fixed needle could cause injury, or at least discomfort or pain to the patient.

There therefore exists a need for an automatic needle insertion system which reduces or eliminates the danger of the insertion procedure, and reduces discomfort to the subject.

## SUMMARY

The current disclosure describes a novel system and method for ensuring the safe and tolerable insertion of a needle into a subject's body according to a preplanned or a continuously monitored sequence of insertion steps. The system comprises a device for gripping the needle in order to perform robotic insertion steps, yet for disconnecting rigid mechanical contact with the needle between such insertion steps, until the next insertion step is initiated. By this means, the robot has full control of the needle during each insertion step, but does not constrain the needle at all between insertion steps, such that movement of the subject should cause neither damage nor discomfort. The gripping actions and insertion steps may advantageously be coordinated by the combined robot/gripper control system to keep in synchronization with the subject's breathing cycles, such that the insertion steps are generally performed in the same part of each cycle of motion of the

subject's chest and any organs which move with it. Assuming that the time for each insertion step is significantly shorter than the subject's breathing cycle time, this arrangement also has the advantage that the robot can take up its grip on the needle at approximately the same position on the needle as the position at which it released the grip, either one or several breathing cycles previously.

The methods include either full disconnection, where the disconnected needle is free to move in space between insertion steps, or partial disconnection, which leaves a partial limiting linkage with the gripper, allowing the needle free movement with one or more limited degrees of freedom. The connecting mechanism can employ magnetic, electrostatic or other attraction forces or it can incorporate a mechanical connector. It should be such as to operate within a time which is only a small fraction of the breathing cycle time, so as to minimize any interference of the breathing motion with the insertion step.

The gripper must be able to grip the needle firmly, such that the force required to insert the needle into the subject can be transferred to the needle. For this reason, it is generally impractical to grip the needle directly, because of the thin diameter of most needles, and the needle is generally held in a needle holder accordingly designed. The needle holder is then adapted to be gripped or released by the gripper, and may also incorporate sensing elements to enable determination of its position relative to the gripper. It may also be feasible to use a needle with a thickened shaft section where the gripping is performed, and it should be understood that this invention is not intended to be limited by the physical nature of the way in which the needle itself is gripped. In co-pending PCT Application, filed by the same applicant as the present application, and claiming priority from US Provisional Patent Application 61/887,634, for "Needle Steering by Shaft Manipulation", there is described a dedicated robotic system and needle gripper for gripping and inserting a needle into a patient, and this needle gripper could also be used as the functional element of the present application. When reference is made to gripping of the needle hereinbelow, it is to be understood that the meaning is either to gripping of the needle itself or more usually, to gripping of the needle holder. Likewise, the needle location may mean either the needle location itself or the needle holder location, depending on context.

The device can also include an optical, magnetic, ultrasound or other tracking device, which tracks the needle's or the needle holder's location in space relative to that of

the gripper, whose position is known from the robot's control system. When connection is required, the robot moves the gripper close to the needle position using the tracking information and then catches the needle or its holder using its capture mechanism.

The needle movement may be quasi-periodic because of the patient's breathing or sporadic movements, such as from a cough or because of pain. Because the exact needle position in space is unpredicted in such cases, it will generally be difficult to bring the robot exactly to the needle in order to catch it. Therefore the catching device should have the ability to grip the needle even if the gripper does not perfectly coincide with the needle. In such a case, the connection to the needle should preferably be done in the same region in space where the needle was left the previous time, which, at least because of the breath synchronization process, will approximately correspond to the same stage in the breath cycle. The robot will come to the point where it previously left the needle and will wait for the needle there. It is possible to use the tracking device which tracks the needle movement to also track the patient's breathing motions. Additionally, for ventilated patients, it is possible to use a signal from the ventilator in order to determine the predetermined gripping point in the patient's breath cycle, and to synchronize therewith.

There is thus provided in accordance with an exemplary implementation of the devices described in this disclosure, a system for needle insertion into a subject, the system comprising:

- (i) a capture unit comprising a mechanism for alternately gripping and releasing either of the needle or a holder incorporating the needle, and
- (ii) a controllable drive mechanism adapted to insert the needle into the subject in a series of separate steps,

wherein the controllable drive mechanism is synchronized with the capture unit mechanism such that the capture unit grips the holder during an insertion step, and releases the holder between insertion steps.

Such a system may further comprise a tracking system for determining the position of the needle or the holder relative to the capture unit. The tracking system may comprise sets of emitters and sensors, wherein one of the set of emitters and the set of sensors may be disposed on the needle or the holder, and the other one of the set of emitters and the set of sensors may be disposed on the capture unit.

In any of the above described systems, the controllable drive mechanism may be adapted to synchronize the insertion steps with the breathing cycle of the subject, such that

the capture unit can be commanded to grip the needle or the holder at a predetermined point in time of the subject's breathing cycle. For such a case, the system may further comprise at least one tracking sensor to monitor the subject's breathing cycle. The tracking sensor then determines the position of the body of the subject close to the point of insertion of the needle. Furthermore, the at least one tracking sensor may be part of an external tracking system, or part of a sensing system operative between the body of the subject close to the point of insertion of the needle and at least one of the controllable drive mechanism and the capture unit.

In these implementations, the predetermined point in time of the subject's breathing cycle may be obtained from a signal derived from a ventilator. Furthermore, the capture unit may be commanded to grip the needle or the holder at the same general point in time of the subject's breathing cycle as a previous release point of time of the holder in the breathing cycle. If so, then

the robotically guided capture unit may anticipate the position of the needle or the holder between subsequent insertion steps, from the position of release of the needle or the holder following a previous insertion step.

In any of the above described systems, the controllable drive mechanism may be either a robotic actuator attached to the capture unit, or a motion mechanism adapted to move the needle or the holder relative to the capture unit.

Additionally, alternative implementations of any of the above-described systems may further involve a system for needle insertion into a subject, the system comprising:

- (i) a needle holder for holding the needle, the holder having a protrusion,
- (ii) a gripper device having mechanical clamping jaws, and
- (iii) an actuating mechanism adapted to close the clamping jaws on the protrusion, such that the needle holder is clamped by the gripper device,

wherein the gripper device is adapted to be held by a robot, such that when the actuating mechanism is operated, the robot can insert the needle into the subject.

In such an implementation, the protrusion may have a generally cylindrical shape, and the mechanical clamping jaws may form a peripheral barrier to the needle holder, to confine movement of the needle holder therewithin when the needle holder is not clamped by the gripper device. Either of the above implementations may further comprise sets of emitters and sensors, wherein one of the set of emitters and the set of sensors is disposed on the needle holder, and the other one of the set of emitters and the set of sensors is

disposed on the gripper device, such that the position of the needle holder relative to the gripper device can be determined. The system may then further comprise an external tracking system for determining the positions of the needle holder and the gripper device, such that the position of the needle holder relative to the gripper device can be determined.

Another example implementation provides a system for needle insertion into a subject, the system comprising:

- (i) a needle holder for holding the needle, the holder having a base with a first set of locating features, and a locating spigot,
- (ii) a gripper device having a second set of locating features, adapted to mate with the first set of locating features on the needle holder, and a clamping system adapted to close on the spigot, and
- (iii) an actuating mechanism adapted to close the clamping system on the spigot, after the first and second locating features are mated, such that the needle holder is clamped by the gripper device.

wherein the gripper device is adapted to be held by a robot, such that when the actuating mechanism is operated, the robot can insert the needle into the subject. The system may then further comprise sets of emitters and sensors, and either one of the set of emitters and the set of sensors may be disposed on the needle holder, and the other one of the set of emitters and the set of sensors disposed on the gripper device, such that the position of the needle holder relative to the gripper device can be determined. Additionally, the system may further comprise an external tracking system for determining the positions of the needle holder and the gripper device, such that the position of the needle holder relative to the gripper device can be determined.

A yet further exemplary implementation of the systems for needle insertion into a subject, described in this disclosure may comprise:

- (i) a needle holder for holding the needle, the holder having a base with a first set of locating features and a ferromagnetic section,
- (ii) a gripper device having a second set of locating features, adapted to mate with the first set of locating features on the needle holder, and a switchable source of magnetic field, and
- (iii) an actuating mechanism adapted to switch the magnetic field on such that the first and second locating features are mated, and the ferromagnetic section of the needle holder is clamped by the magnetic field of the gripper device,



wherein the gripper device is adapted to be held by a robot, such that when the actuating mechanism is operated, the robot can insert the needle into the subject.

Such a system may further comprise sets of emitters and sensors, wherein either one of the set of emitters and the set of sensors is disposed on the needle holder, and the other one of the set of emitters and the set of sensors is disposed on the gripper device, such that the position of the needle holder relative to the gripper device can be determined. The system may also advantageously further comprise an external tracking system for determining the positions of the needle holder and the gripper device, such that the position of the needle holder relative to the gripper device can be determined.

Still other example implementations involve a system for needle insertion into a subject, the system comprising a needle holder for holding the needle, the holder having a flexible cord attached thereto, and a gripper device, the gripper device comprising:

- (i) an actuator to which the flexible cord may be attached remotely from the needle holder, and adapted to draw in the flexible cord when actuated,
- (ii) a docking port shaped such that the needle holder fits firmly therein when the flexible cord is drawn in, and
- (iii) a pair of arms disposed on either side of the docking port, to confine movement of the needle holder therebetween,

wherein the gripper device is adapted to be held by a robot, such that when the actuating mechanism is operated, the needle holder is docked firmly in the docking port, and the robot can insert the needle into the subject.

This system may further comprise sets of emitters and sensors, wherein either one of the set of emitters and the set of sensors is disposed on the needle holder, and the other one of the set of emitters and the set of sensors is disposed on the gripper device, such that the position of the needle holder relative to the gripper device can be determined. Alternatively, the system may further comprise an external tracking system for determining the positions of the needle holder and the gripper device, such that the position of the needle holder relative to the gripper device can be determined.

Another example implementation can involve a method for needle insertion into a subject, the method comprising:

- (i) providing a holder incorporating the needle,
- (ii) providing a capture unit for controllably gripping and releasing the holder, and

(iii) robotically guiding the capture unit to insert the needle into the subject in a series of separate steps, comprising:

- (a) gripping the holder in the capture unit during an insertion step of the needle, and
- (b) releasing the holder from the capture unit between insertion steps.

In such a method, the insertion steps may be synchronized with the breathing cycle of the subject, such that the capture unit can be instructed to grip the holder at a predetermined point in time of the subject's breathing cycle. This method then may further comprise the step of monitoring the subject's breathing cycle using a tracking sensor, or may further comprise the step of monitoring the subject's breathing cycle using a signal obtained from a ventilator. The tracking sensor may determine the position of the body of the subject close to the point of insertion of the needle. Alternatively, the method may further comprise the step of instructing the capture unit to grip the holder at the same general point in time of the subject's breathing cycle as a previous release point of time of the holder in the breathing cycle. Finally, in any of these methods, the robotically guided capture unit may be configured to anticipate the position of the holder between a subsequent insertion step from the position of release of the holder following the previous insertion step.

In another aspect there is provided a robotic system for inserting a needle into a subject, said robotic system comprising:

a capture unit configured for alternately and repeatedly gripping and releasing either of said needle or a holder configured for holding said needle;

a controllable drive mechanism configured to insert said needle into the subject in a series of separate insertion steps; and

a tracking system configured to determine the relative position between said needle or said holder and said capture mechanism;

wherein said controllable drive mechanism is synchronized with said capture unit such that said capture unit grips said needle or said holder during an insertion step, and releases said needle or said holder between insertion steps; and

wherein said robotic system is configured to move said capture unit toward said needle or said holder, based on the relative position determined by said tracking system.

## BRIEF DESCRIPTION OF THE DRAWINGS

The present invention will be understood and appreciated more fully from the following detailed description, taken in conjunction with the drawings in which:

Figs. 1a, 1b, 1c illustrate schematically a first exemplary gripper using a mechanical clamping implementation;

Fig. 2 illustrates schematically a needle holder connected to the robot by a flexible link;

Figs. 3a and 3b show two views of a magnetic gripper, taken from different isometric angles of view;

Figs. 4a to 4d show different views of a needle holder similar in structure to the magnetic gripper implementation shown in Figs. 3a to 3b, but in which the gripping is done mechanically;

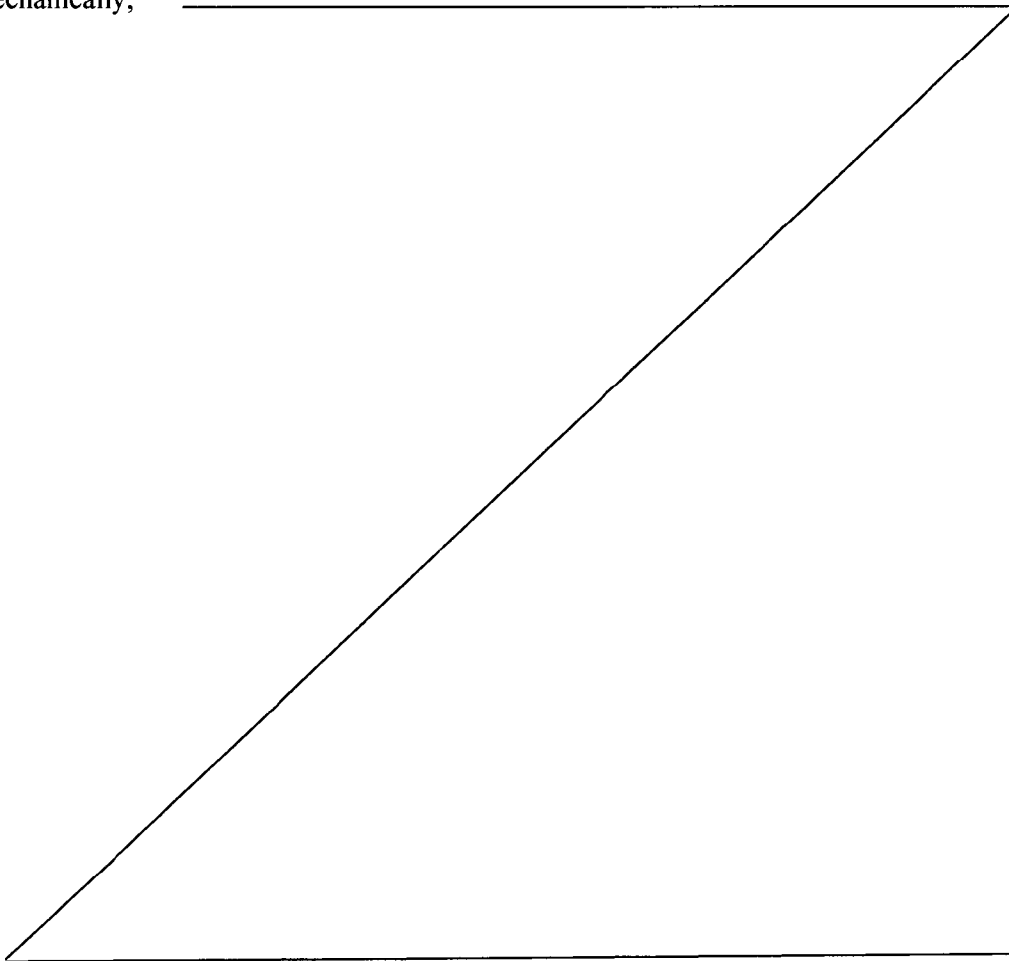

Fig. 5 shows a second type of needle gripper, in which the needle holder is freed from positive contact with the gripper device, but is held within the confines of a defined space outside of which it cannot move;

Figs. 6a, 6b show an additional example of a semi-constrained needle gripper assembly;

Figs. 6c and 6d show a similar arrangement to that of Figs. 6a and 6b, but wherein the needle is clamped directly; Fig 6d also shows schematically an additional implementation in which the gripper is used also in order to advance the insertion of the needle step by step into the patient; and

Fig. 7 illustrates a complete robotic needle insertion system, actuated on a subject being imaged in a CT system.

## DETAILED DESCRIPTION

There are many methods by which the needle gripping functions described in this disclosure can be performed, and the mechanics of such methods are numerous. Without wishing to limit the generality of the devices and methods described in this disclosure, a number of such mechanisms are now described, merely as non-limiting examples of how the present invention could be practically implemented. The types of needle gripper mechanisms described can be divided into two main groups:

- (i) Grippers which fully disconnect from the needle, and
- (ii) Grippers in which the needle connection is freed, but the needle base is constrained.

These groups are now described in separate sections hereinbelow.

### (I) FULLY DISCONNECTING GRIPPERS.

The needle is disconnected fully and sensors keep track of the needle base location, so that the robot can be positioned in the correct position in order to catch the needle when commanded to do so. A number of possible alternative implementations are possible for achieving this, as follows:

Catching using a mechanical gripper.

Reference is made to Figs. 1a, 1b, 1c, which illustrate schematically a first exemplary gripper using a mechanical clamping implementation. Fig. 1a is an isometric

view of the gripper 16, while Figs. 1b and 1c are cross sectional views, showing the gripper respectively open and gripped shut on the needle. The needle 10 is connected to a lightweight needle holder 11 which has a clamping element in the form of a ball 13 attached to it. This ball can be clamped by the needle holder gripper 16. This ball is kept located within the slightly opened jaws of a clamp 14, but is only gripped when the jaws are closed by operation of the actuator 15, which can be mechanically, pneumatically or electro-magnetically actuated. Sensors 12 located on the needle holder can track the needle holder position and orientation in real-time. One method of tracking the needle holder position and orientation could be by means of an external tracking system remotely mounted from the needle and robot. A more advantageous method may be to mount the tracking system emitters on the gripping mechanism 16 which is held by the robotic actuator. This will be fully described below in relation to the example grippers of Figs. 3a-3b. The emitters/sensors for the tracking functions could be ultrasound proximity sensors, infra-red, laser, magnetic, static or any other system which measures distance or relative position between objects. When there is a need to connect to the needle, the robot moves the needle catcher clamps 14 close to the needle holder ball, as shown in Fig. 1b, using the tracker system to ascertain where the ball should be situated, and activates the clamps 14 to grip the needle holder as shown in Fig. 1c.

Disconnecting by means of a flexible link that can be made rigid on demand.

Reference is now made to Fig. 2. The needle holder 20 is always connected to the robot by a flexible link, such as one composed of rigid tubes 22 and spherical ball joints 21, as shown in Fig. 2. The flexible link can be stiffened on demand by pulling the wire 23. Using this connection the needle can instantly be gripped wherever it is located. The orientation of the needle holder relative to the robot is known from the sensors 12.

Catching using a magnetic gripper.

Reference is made to Figs. 3a and 3b, which show two views of a magnetic gripper, taken from different isometric angles of view. The needle 10 is connected to a lightweight needle holder 30 with a triangular spider-like base in which are disposed at least two locating holes 34 or one locating hole 34 and one locating slot 35. In the example shown in Figs. 3a, 3b, a hole 34 and slot 35 implementation is shown. The needle catcher 33 has auto-orienting pins 32, which are dimensioned and spaced to mate with the spider base

openings 34, 35. The one or more sensors 12 track the needle holder 30 in real-time. The sensors 12 can be ultrasound proximity sensors, infra-red, laser, magnetic, static or other sensor which measures distance or relative position of an object.

A more advantageous method than the use of an external tracking system may be to mount the tracking system emitters 36 on the gripping mechanism 16 which is held by the robotic actuator. The emitters 36 and sensors 12 can then determine the mutual position of the nearby needle holder 11, whose position is then known relative to the capture mechanism 16, or even absolutely in space, since the robot pose can be known absolutely in space. Alternatively, the emitters 36 could be on the needle holder 11 and the sensors on the capture mechanism 16, or the emitters and sensors could be incorporated in the same package on one of these two component parts of the system, and their relative sensed position be acquired by means of a reflector on the opposing component.

The needle base is kept connected to the needle catcher by means of magnetic attraction forces of actuator 31, powered by an electromagnet 33, though a solenoid driven moving magnet may also be used. The needle base is kept aligned by means of the aligning pins 32. When there is a need to disconnect from the needle the magnetic force is removed and the needle can disconnect and move freely in space, while the sensors 12 keep track of needle position. When there is a need to connect to the needle, the robot moves the needle catcher close to the needle holder position, so that the orienting pins coincide with the relevant openings in the spider base, and the magnetic force is applied which pulls the spider base into contact with the catcher.

Catching using mechanical gripper.

Reference is made to Figs. 4a to 4d, which show different views of a needle holder similar in structure to the magnetic gripper implementation shown in Figs. 3a to 3b, but in which, instead of the magnetic clamping of Figs. 3a to 3b, the gripping is done mechanically with a clamp 43 actuated by a solenoid or motor 42, which tightens onto a post element in the needle holder 40. Figs. 4a and 4b are overall isometric views of the gripper 41 and needle holder 40, taken from two different directions to show all aspects of the gripping mechanism, while Figs. 4c and 4d are cross sectional drawings showing how the mechanical clamping operation takes place.

(ii) FREEING THE NEEDLE CONNECTION BUT CONSTRAINING THE NEEDLE.

Reference is now made to Fig. 5, which shows a first example of the second type of needle gripper, in which the needle holder is freed from any positive contact with the gripper device, but is held within the confines of a defined space outside of which it cannot move, such that robotically moving the gripper to the region of the needle holder, and then regripping the needle holder can be done efficiently and speedily. In the example of Fig. 5, the needle holder 51 is gripped in a predefined and repeatable position of the gripper device by means of a tensioned wire 52. When the needle holder is released, it is constrained by a flexible wire 52 and by the static jaws 50 which constrain the needle position to within its confines. The needle position and orientation may be tracked by the sensors 12 and the length of the released wire 52. When re-connection is required, the wire is pulled back into the needle catcher by means of actuator 53.

Reference is now made to Fig. 6a, 6b, which show an additional example of a semi-constrained needle gripper assembly. The needle holder 61 is disconnected fully but is constrained by a circle structure created by clamp arms 60. When catching of the needle is required, the catcher 62 is moved by the robot such that the needle base will be located in the center of the circle created by the clamps 60. Then the clamp arms are closed, as shown in Fig. 6b.

Figs. 6c and 6d show a similar arrangement but wherein the needle is clamped directly instead of through a shank having an increased diameter for gripping, as in Figs. 6a and 6b.

Fig. 6d also shows an additional implementation of the needle grippers of the present disclosure, in which the gripper is also used in order to advance the insertion of the needle step by step into the patient. The gripper incorporates an insertion mechanism that enables the gripper itself to advance the needle or the needle holder step by step. This can be used either entirely in place of the robotic insertion, or in addition to the robotic insertion, such as when the robot is used for initial positioning or for large insertion steps, and the insertion mechanism implementation of Fig. 6d is used for small incremental insertion steps. In this exemplary implementation, a motion mechanism is associated with the needle gripper, and is adapted to move the needle distally by a predetermined amount once the gripper has caught the needle or the needle holder firmly in its grip. The motion mechanism can be of any controllable type, and most conveniently may be electro-mechanical, such as using a mechanical slide and a lead screw, or electromagnetic, using a

linear solenoid, or hydraulic or pneumatic, using a driven piston. The extent of the motion imparted to the needle gripper is determined by the signal imparted by the control system, according to the step size selected by the medical personnel. In the implementation shown in Fig. 6d, the insertion mechanism is made up of a slide base 81, which may be attached to the end effector of the robotic placement arm, with a set of rails 82, along which the base of the needle gripper 62 can run, under the influence of the motion mechanism, shown in Fig 6d as a piston 80. The base 81 can preferably be held by the end of the robot effector arm. The motion insertion mechanism of Fig. 6d can be applied to incrementally insert either the needle 10 itself, as shown in Figs. 6c and 6d, or a needle gripper, as shown in the previous drawings of this application.

Reference is now made to Fig. 7, which illustrates a complete robotic needle insertion system, showing some of the overall features enabled by the use of the devices of the present disclosure. In Fig. 7 there is shown a subject 74 being imaged in a CT system. In this exemplary system, the robot 72 used for the insertion of the needle 10 is a serial robot, mounted by the CT-bedside. However, it is to be understood that any suitable robot for needle insertion can equally well be used, and especially the type of miniature robots shown in the current applicant's co-pending PCT Patent Application for "Needle Steering by Shaft Manipulation". Though only schematically shown in Fig. 7, the needle 10 is held by the robot arm in a releasable gripper device, such as any of the types whose operational model are described in this disclosure. A motion or respiration sensor 73 is mounted on the body of the subject to provide data regarding the breathing cycle of the subject. The data from this sensor is input to the system controller 71, where it is used to synchronize at least one of the needle insertion and the needle gripping and release action with a point of time in the breathing cycle.

It is appreciated by persons skilled in the art that the present invention is not limited by what has been particularly shown and described hereinabove. Rather the scope of the present invention includes both combinations and subcombinations of various features described hereinabove as well as variations and modifications thereto which would occur to a person of skill in the art upon reading the above description and which are not in the prior art.



**WHAT IS CLAIMED IS:**

1. A robotic system for inserting a needle into a subject, said robotic system comprising:

a capture unit configured for alternately and repeatedly gripping and releasing either of said needle or a holder configured for holding said needle;

a controllable drive mechanism configured to insert said needle into the subject in a series of separate insertion steps, said controllable drive mechanism being synchronized with said capture unit such that said capture unit grips said needle or said holder during an insertion step, and releases said needle or said holder between insertion steps;

a tracking system configured to determine the relative position between said needle or said holder and said capture mechanism; and

at least one breathing tracking sensor configured to monitor the subject's breathing cycles,

wherein said system is configured to correlate the position of said capture unit to the position of said needle or said holder, using said tracking system, and to synchronize the releasing and gripping of said needle or said holder with the subject's breathing cycle, such that the insertion steps are performed at a predetermined point in time of the subject's breathing cycle.

2. A system according to claim 1, wherein said tracking system comprises a set of emitters and a set of sensors, and wherein one of said set of emitters and said set of sensors is disposed on said needle or said holder, and the other one of said set of emitters and said set of sensors is disposed on said capture unit.

3. A system according to any one one of claims 1 or 2, wherein said at least one breathing tracking sensor is part of an external tracking system.

4. A system according to any one of claims 1 to 3, wherein said predetermined point in time of the subject's breathing cycle is obtained from a signal derived from a ventilator.

5. A system according to any one of claims 1 to 3, wherein said capture unit is commanded to grip said needle or said holder at the same general point in time of said subject's breathing cycle as a previous release point in time of said needle or said holder in said breathing cycle.
6. A system according to any one of claims 1 to 5, wherein said controllable drive mechanism is either a robotic actuator attached to said capture unit, or a motion mechanism adapted to move said needle or said holder relative to said capture unit.
7. A system according to any one of claims 1 to 5, wherein:
  - said holder comprises a protrusion;
  - said capture unit comprises mechanical clamping jaws; and
  - said system further comprises an actuating mechanism adapted to close said clamping jaws on said protrusion, such that said holder is clamped by said capture unit.
8. A system according to claim 7, wherein said protrusion has a cylindrical shape, and wherein said mechanical clamping jaws form a peripheral barrier to said holder, to confine movement of said holder therewithin when said holder is not clamped by said capture unit.
9. A system according to any one of claims 1 to 6, wherein:
  - said holder comprises a base with a first set of locating features, and a locating spigot;
  - said capture unit comprises a second set of locating features, adapted to mate with said first set of locating features on said holder, and a clamping system adapted to close on said spigot; and
  - said system further comprises an actuating mechanism adapted to close said clamping system on said spigot, after said first and second sets of locating features are mated, such that said holder is clamped by said capture unit.
10. A system according to any one of claims 1 to 6, wherein:
  - said holder comprises a base with a first set of locating features and a ferromagnetic section;

said capture unit comprises a second set of locating features, adapted to mate with said first set of locating features on said holder, and a switchable source of magnetic field; and

said system further comprises an actuating mechanism adapted to switch on said source of magnetic field, such that said first and second sets of locating features are mated, and said ferromagnetic section of said holder is clamped by the magnetic field applied by said source of magnetic field of said capture unit.

11. A system according to any one of claims 1 to 6, wherein:  
 said holder includes a flexible cord attached thereto; and  
 said capture unit comprises:
- an actuator to which said flexible cord is attached remotely from said holder, and adapted to draw in said flexible cord when actuated;
  - a docking port shaped such that said holder fits firmly therein when said flexible cord is drawn in; and
  - a pair of arms disposed on either side of said docking port, and configured to confine movement of said holder therebetween.
12. A system according to claim 7, wherein said controllable drive mechanism includes a slide base having a set of rails along which a base of said capture unit is configured to be driven by a motion mechanism of said controllable drive mechanism, to insert said needle into the subject.

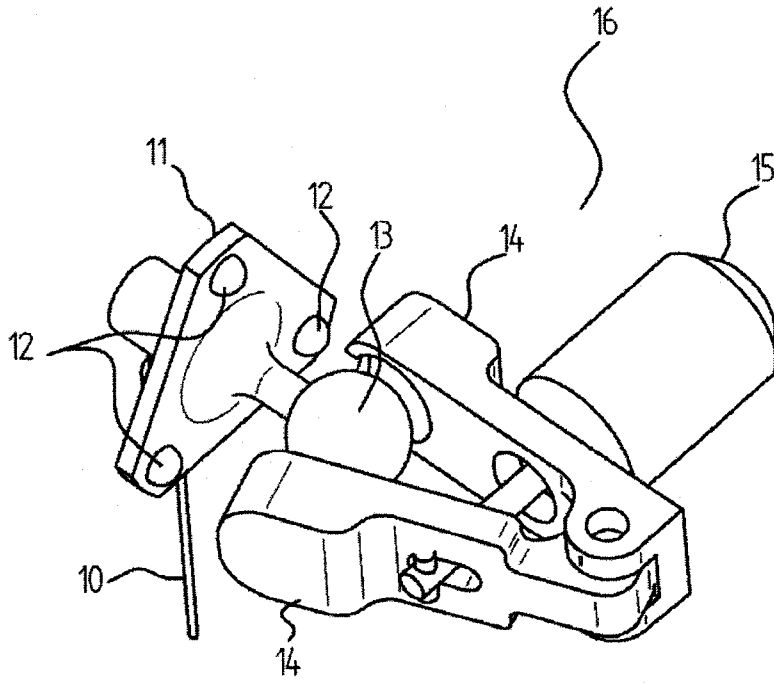

FIG 1a

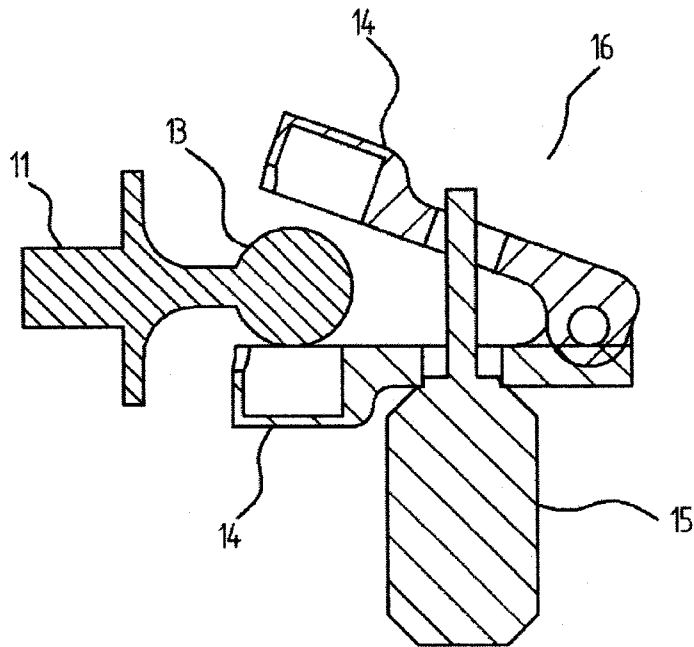

FIG 1b

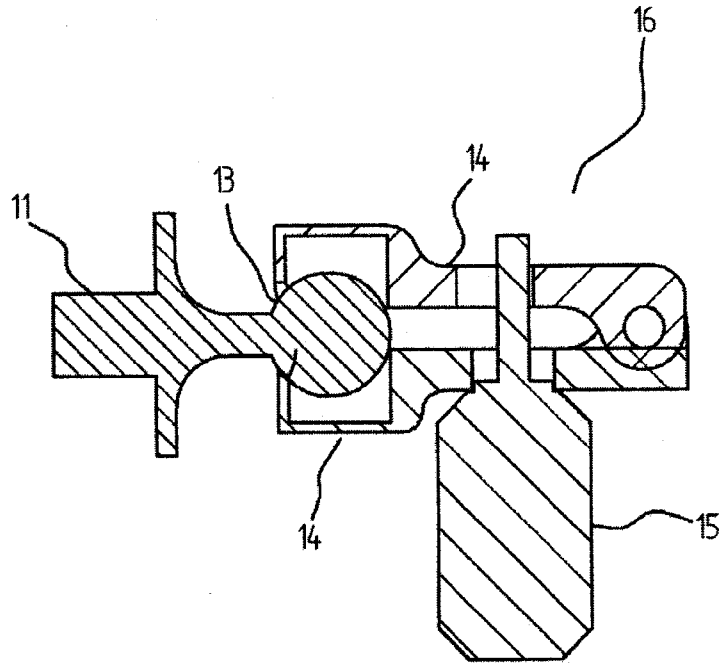

FIG 1c

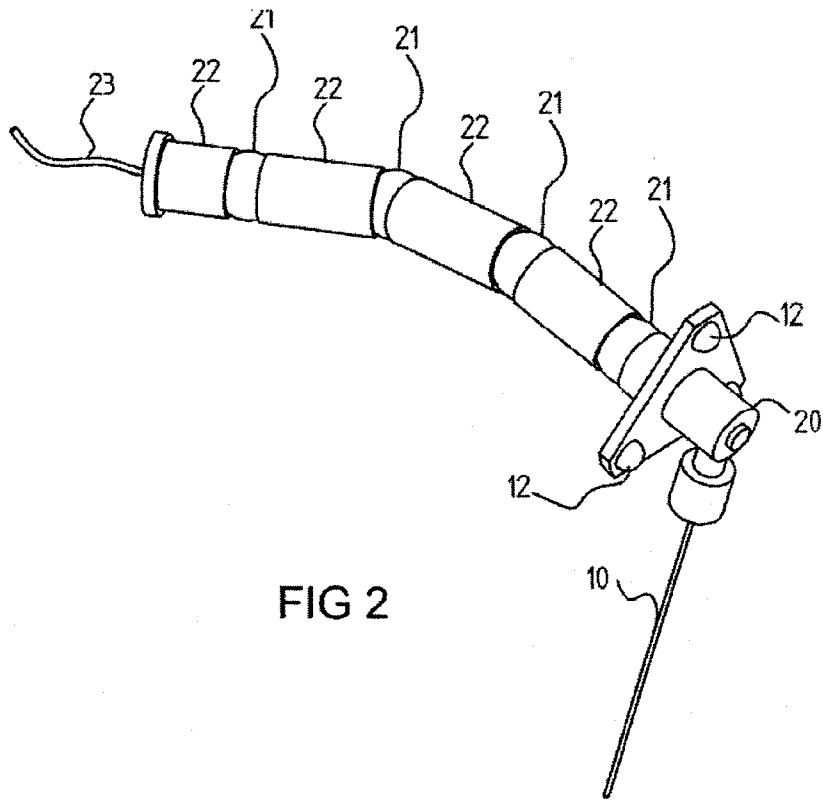

FIG 2

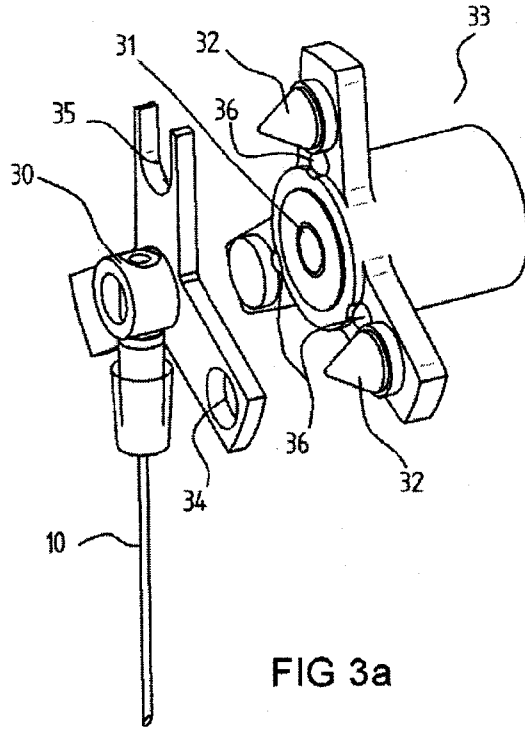

FIG 3a

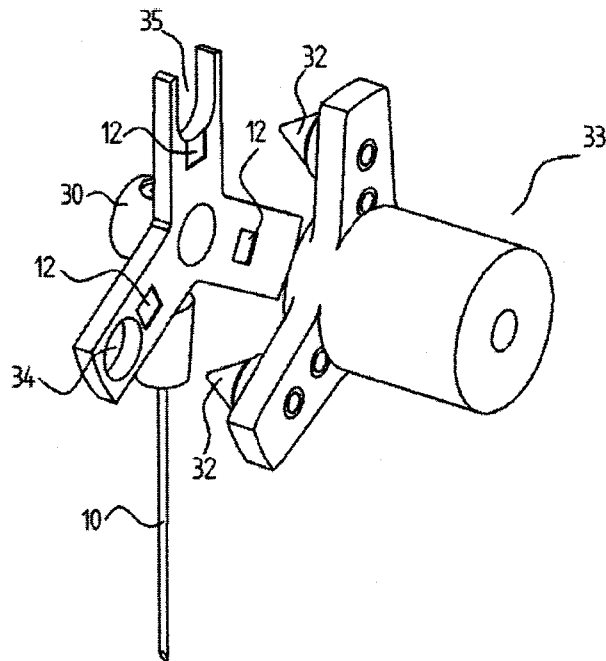
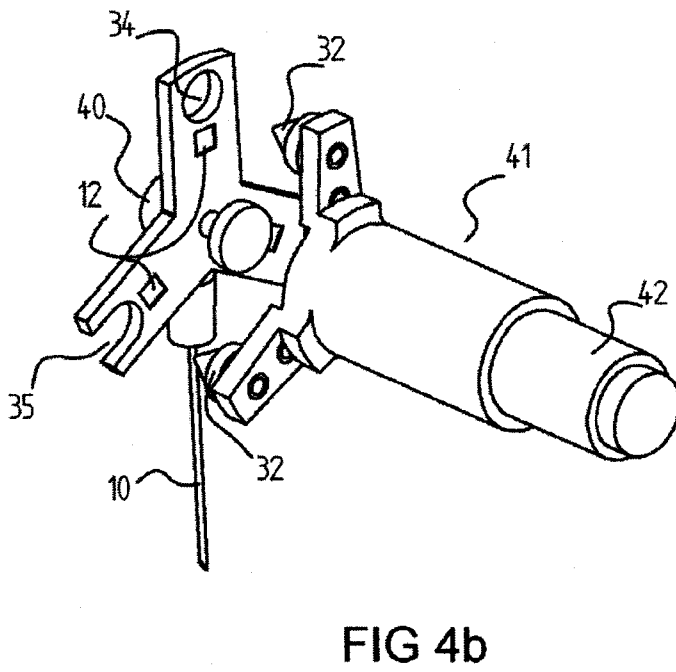
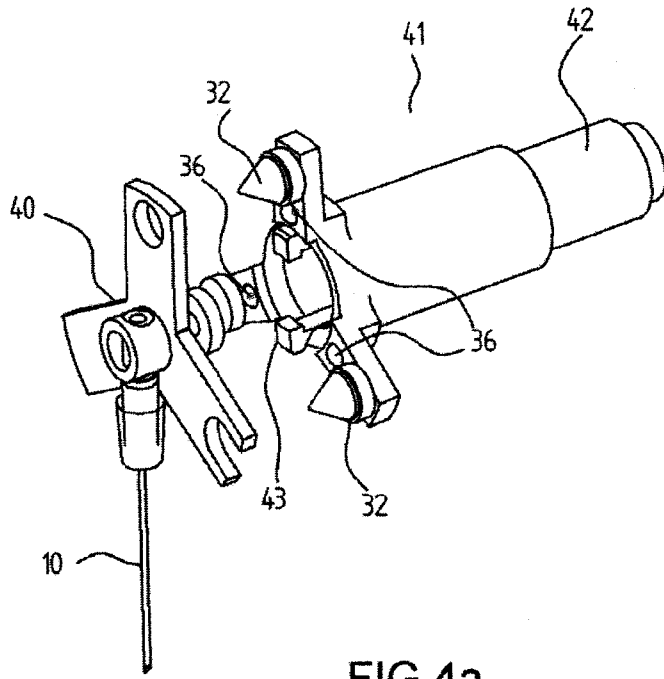

FIG 3b



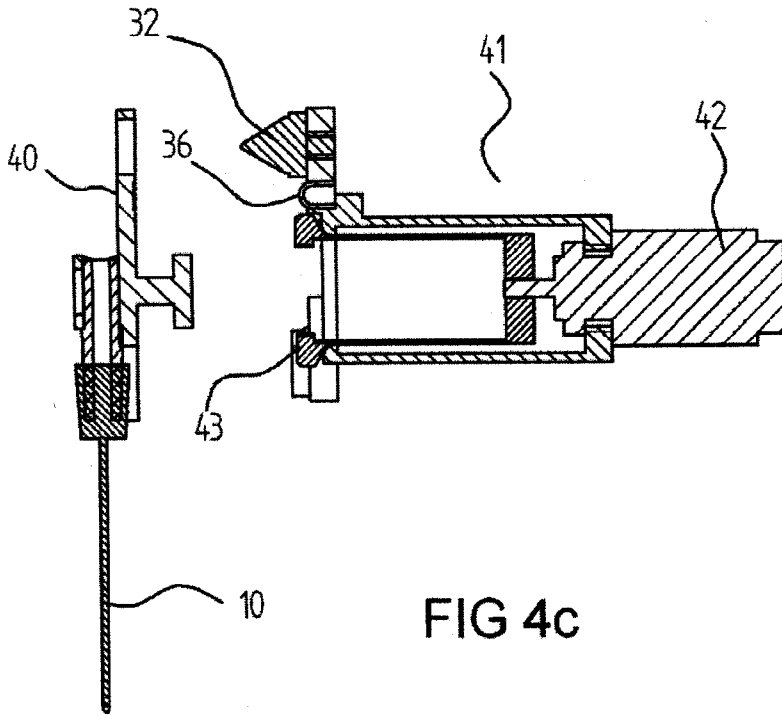

FIG 4c

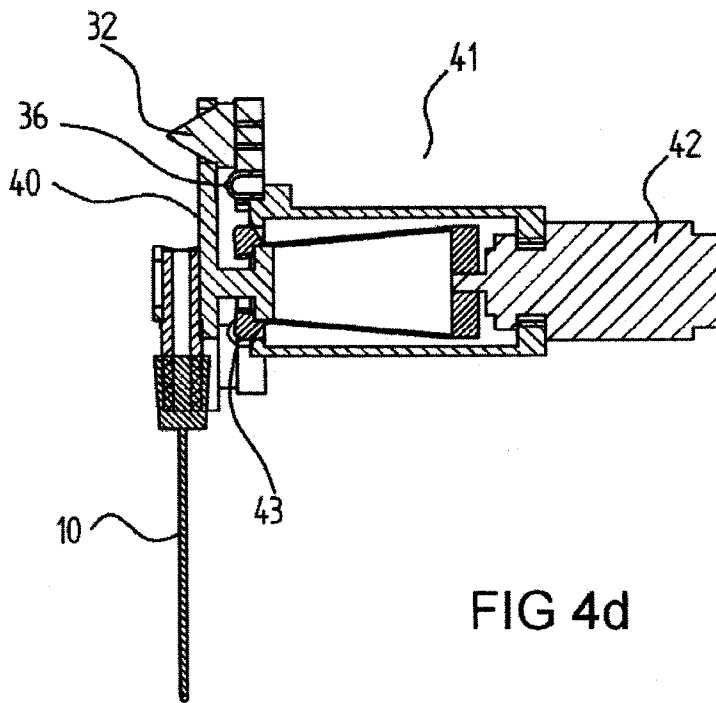

FIG 4d



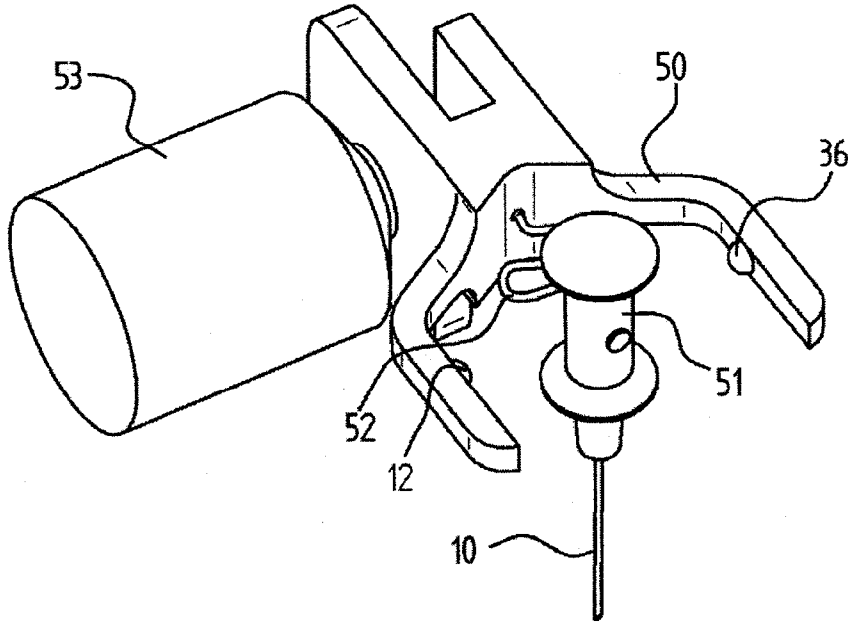

FIG 5

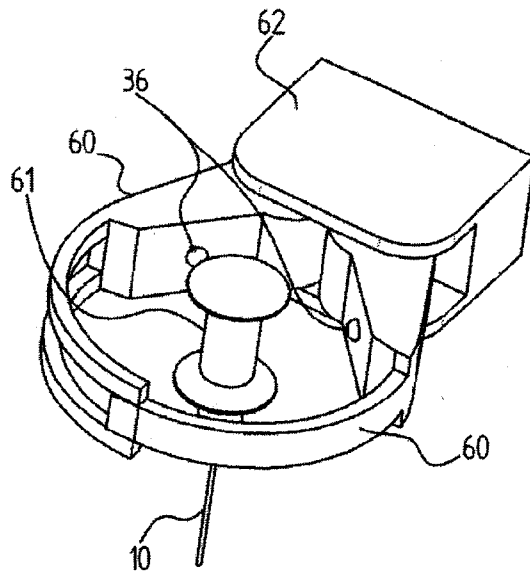

FIG 6a

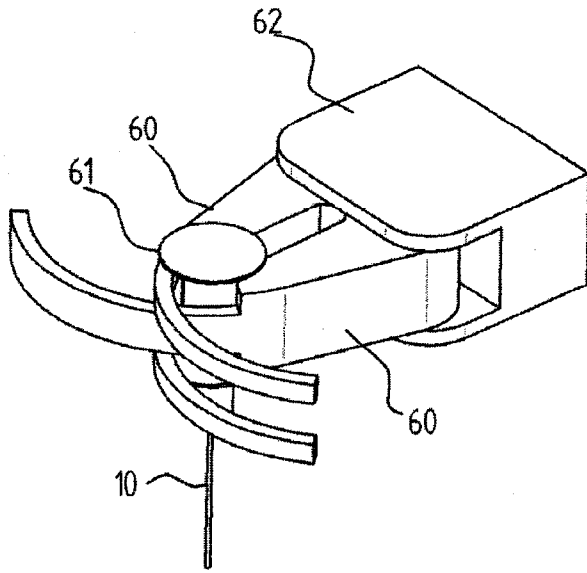

FIG 6b

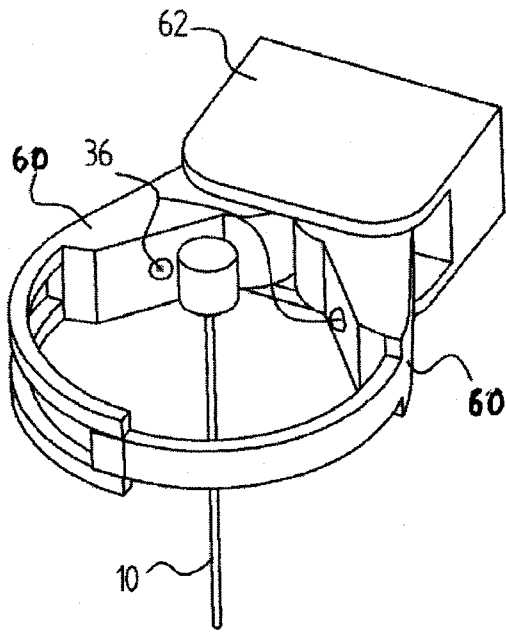

FIG 6c

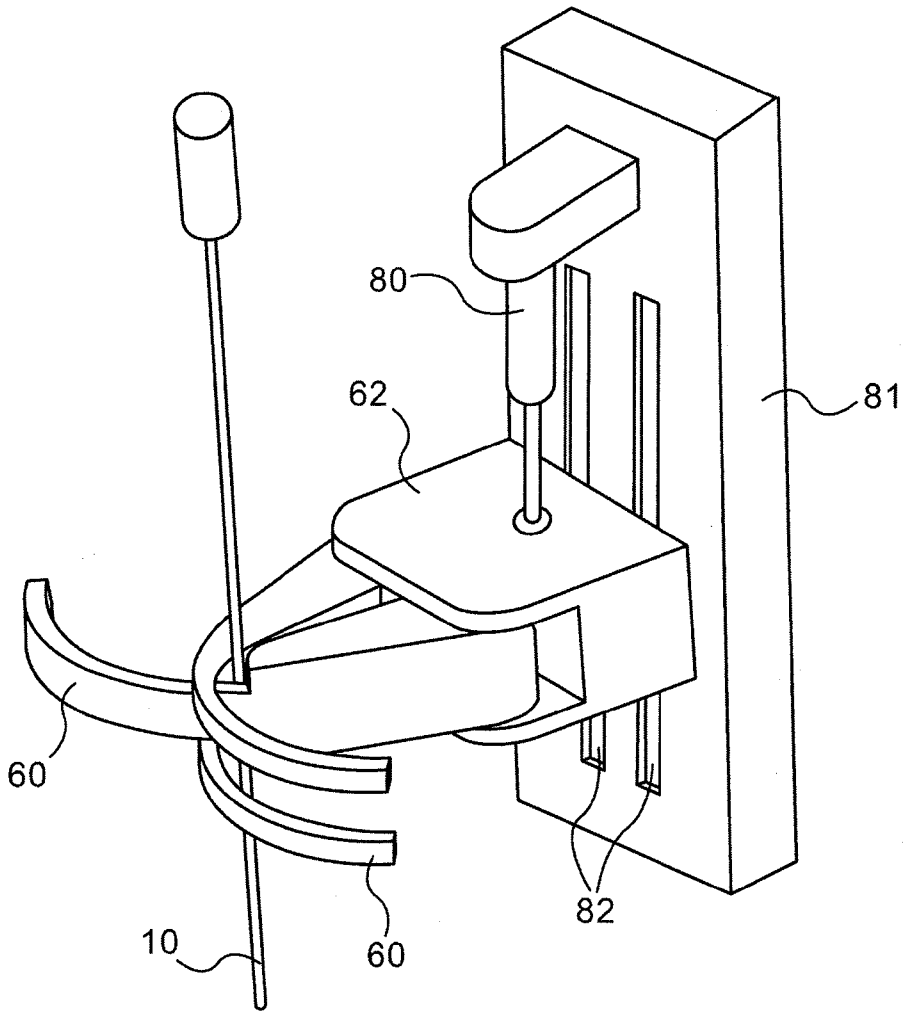

FIG 6d

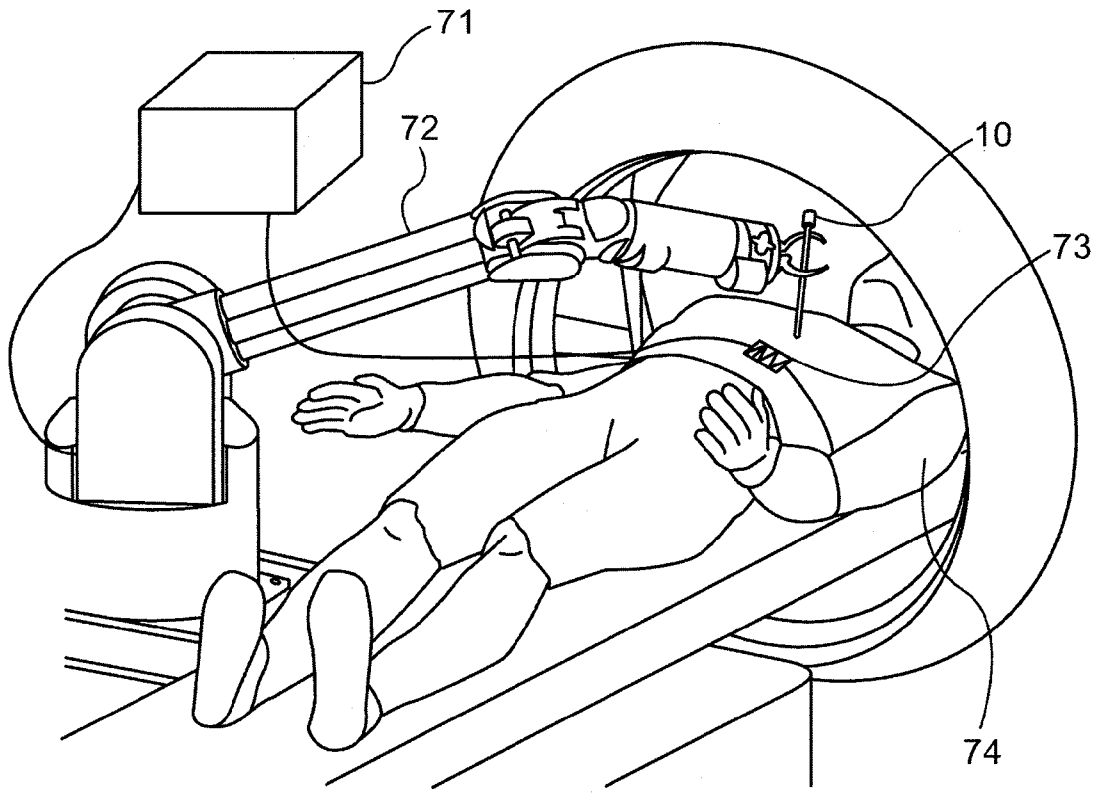

FIG 7

