

(19) (12) (KR) (A)

(51) 。 Int. Cl.7

B41J 33/24

B41J 33/14

B41J 35/28

(11)

(43)

10-2005-0006166

2005 01 15

(21) 10-2004-7016589

(22) 2004 10 15

2004 10 15

(86) PCT/US2003/000731

(87)

WO 2003/095214

(86) 2003 01 10

(87)

2003 11 20

(30) 10/141,322 2002 05 08 (US)

(71) , 08, 3

(72) 60071 459

(74)

:

(54) 가

, (46) (44) (donor) (16) 가
 , (48) 가 (16)
 , (68)(70) (68)(70)
 ained) (68)(70) (48) 가 (46) (self-cont
 (44) (44) 가 (42) (42)
 (72)(74) , (68)(70) (66) (72)(74)

(backfeed)

(non-sensitized web) 가 , 가 가

가 , 가

가

edge) (tag), (print) (backfeed)가 (ticket), (head) 가 (label) (tear-off edge) (trailing

가

(feed)

가 가

가

(Inoue) 0 408 356 A2

(Masamura et. al.) 2가 5,284,396 가 (spool) 가 (collar) , 2가

가,

(Kitagishi) 0 165 396 가 “H ” (drag) (released)

(Takayama et al) 6,126,344 5,595,447 (winding core) (anti-rotational) (engagement piece) (a nti-slack) 가 가

가 (Shinada) 4,838,716 (driven) - (take-up)

ng) (passive) (support) 가 가 (cooperati

가

1

2

3a 3b

4

5

6

(16) 1 (14) (10) (10) (18)
 (14) (12) (14) (platen)(20) (14) (18)

) (15) (14) (14) (16) (20) (18)
 (22) 가 (24) (26) 가 (cutting edge)(28) (14)

가 (torn edge)(30) (spent) (32) (18) 가 (34) (takeup) (38)
 (36) (38) (24) (40) ()

(16) (44) (46) (42) ,가
 (47) (18) (10) (shelf)(48) (46) (46)

(46) (42)
 (47) (44) (48) (92)(94) (48)

(47) (facing) (wall) (48)

3a (48) (66), (68)(70) (72)(74)
 (66) (44) 가 (48) (durometer)

(44)가 (66) (42) (48) (92)(94)

()

(68)(70) (44) , 3b
가 (66) (16) (66)
(44) 가
(68)(70) (16)
(68)(70) (48) (notch) (slit)

4 (48) 90 (58)
(60) (44) (62)(64) (42)
(58)(60) (48) (59)(61) (58)(60)

(48) 5
(multi-diametral)(가) (76) (44)
가 (78) , 2 (80)(
82) 가 (76) (overall) (88)(90) (84)(86)(
(46) (facing wall) (inserts)

6 (48) (96) (42) (10)
(passive) (98) (48) (99)
(10)

(48) - (76)

(interference fit) (free motion)

가,
가
(46) (44), (48) (76) (16)

가

가 가

(57)

1.
(donor)

가 (feed)

;

;

가

;

가 (resilient) (release) (slack) ; (backfed) (retraction)

1 2. ,

1 3. ,

1 4. ,

(common)

1 5. ,

1 6. ,

1 7. ,

(multi-diametral)

8. (donor) 가 (feed) ;

(release) (slack) ; (backfed) (retraction)

8 9. ,

8 10. ,

8 11. ,

8 12. ,

8 13. ,

8 14. ,

15. (self-contained) 가 (roll) :
(空洞) ;
(component) 가 ,
;

15 16. ,

16 17. ,

17 18. ,
(section)

17 19. ,
(constraint) (key) (section
)

16 20. ,

20 21.

가

21 22.

가 가 ,

23. (self-contained)

가

;

(hollow) ;

(component) 가 ,

;

;

;

23 24.

23 25.

(support) ,

25 26.

23 27.

27 28.

28 29.

28 30. ,

27 31. ,

31 32. ,

가

32 33. ,

23 34. ,

가

27 35. ,

가 가

36. , (platen), (feed) (locator) 가 , ; (self-contained) 가 ; , ;

가 ,

36 37. ,

36 38.

38 39.

36 40.

40 41.

41 42.

41 43.

40 44.

44 45.

가

45 46.

36 47.

가

40 48.

가 , . ,

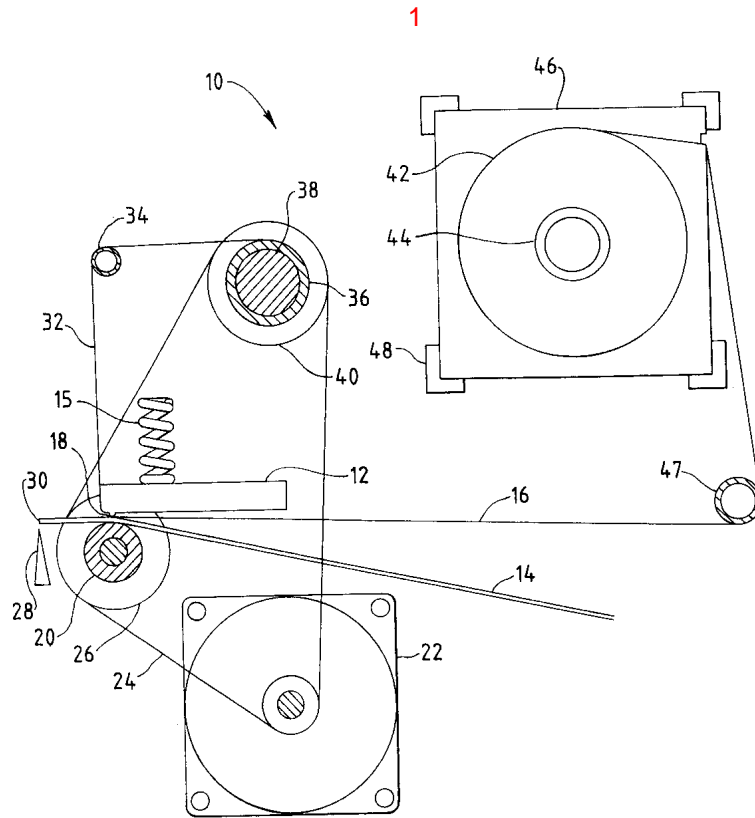

2

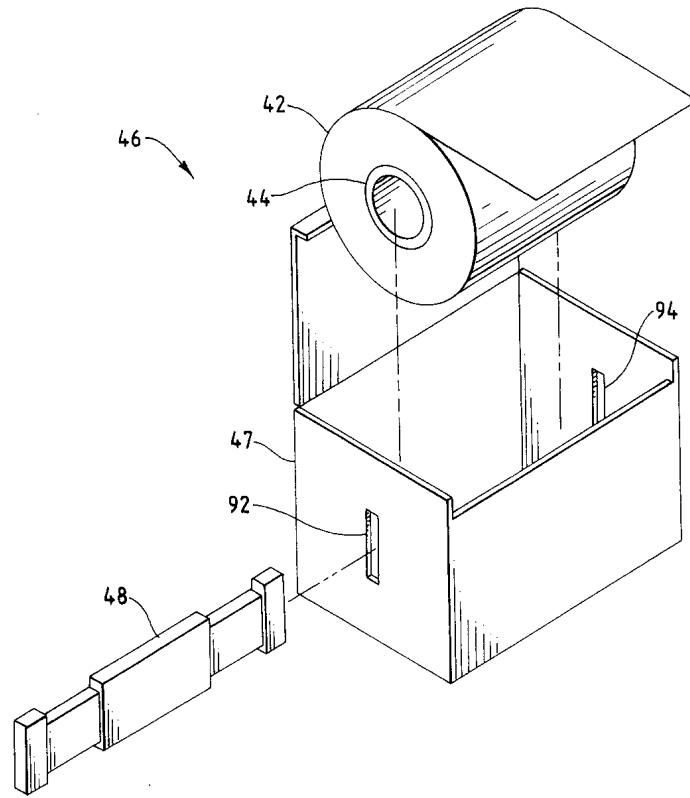

3a

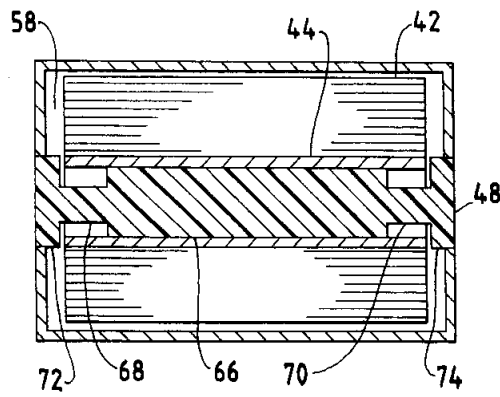

3b

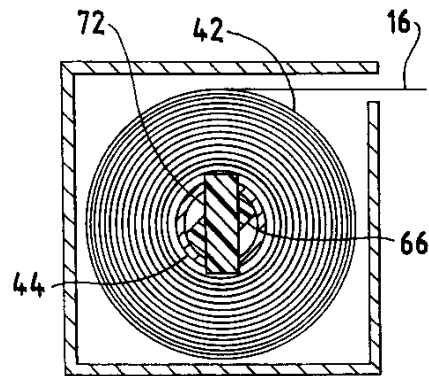

4a

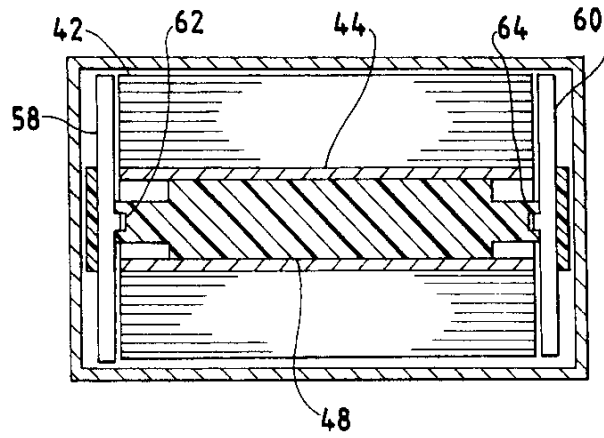

4b

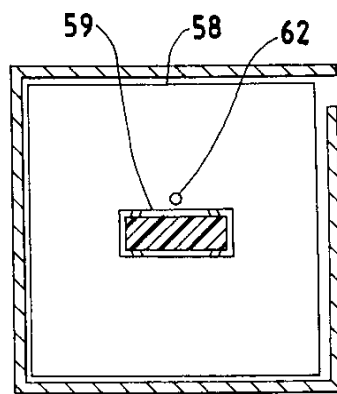

5a

