



- (51) International Patent Classification:
A61B 19/00 (2006.01)
- (21) International Application Number:
PCT/EP2014/063793
- (22) International Filing Date:
30 June 2014 (30.06.2014)
- (25) Filing Language: English
- (26) Publication Language: English
- (30) Priority Data:
13174509.3 1 July 2013 (01.07.2013) EP
- (71) Applicant: **ADVANCED OSTEOTOMY TOOLS - AOT AG** [CH/CH]; Hochbergerstrasse 60c, CH-4057 Basel (CH).
- (72) Inventors: **CATTIN, Philippe**; Muelligerstrasse 16M, CH-5210 Windisch (CH). **GRIESEN, Mathis**; Maienstrasse 6, CH-3613 Steffisburg (CH). **BRUNO, Alfredo**; Fichtlirain 40, CH-4105 Biel-Benken (CH).
- (74) Agent: **LATSCHA, Silvan**; Latscha Schöllhorn Partner AG, Austrasse 24, CH-4051 Basel (CH).
- (81) Designated States (unless otherwise indicated, for every kind of national protection available): AE, AG, AL, AM, AO, AT, AU, AZ, BA, BB, BG, BH, BN, BR, BW, BY,

BZ, CA, CH, CL, CN, CO, CR, CU, CZ, DE, DK, DM, DO, DZ, EC, EE, EG, ES, FI, GB, GD, GE, GH, GM, GT, HN, HR, HU, ID, IL, IN, IR, IS, JP, KE, KG, KN, KP, KR, KZ, LA, LC, LK, LR, LS, LT, LU, LY, MA, MD, ME, MG, MK, MN, MW, MX, MY, MZ, NA, NG, NI, NO, NZ, OM, PA, PE, PG, PH, PL, PT, QA, RO, RS, RU, RW, SA, SC, SD, SE, SG, SK, SL, SM, ST, SV, SY, TH, TJ, TM, TN, TR, TT, TZ, UA, UG, US, UZ, VC, VN, ZA, ZM, ZW.

- (84) Designated States (unless otherwise indicated, for every kind of regional protection available): ARIPO (BW, GH, GM, KE, LR, LS, MW, MZ, NA, RW, SD, SL, SZ, TZ, UG, ZM, ZW), Eurasian (AM, AZ, BY, KG, KZ, RU, TJ, TM), European (AL, AT, BE, BG, CH, CY, CZ, DE, DK, EE, ES, FI, FR, GB, GR, HR, HU, IE, IS, IT, LT, LU, LV, MC, MK, MT, NL, NO, PL, PT, RO, RS, SE, SI, SK, SM, TR), OAPI (BF, BJ, CF, CG, CI, CM, GA, GN, GQ, GW, KM, ML, MR, NE, SN, TD, TG).

Declarations under Rule 4.17:

- as to applicant's entitlement to apply for and be granted a patent (Rule 4.17(ii))

Published:

- with international search report (Art. 21(3))

(54) Title: CUTTING HUMAN OR ANIMAL BONE TISSUE AND PLANNING SUCH CUTTING

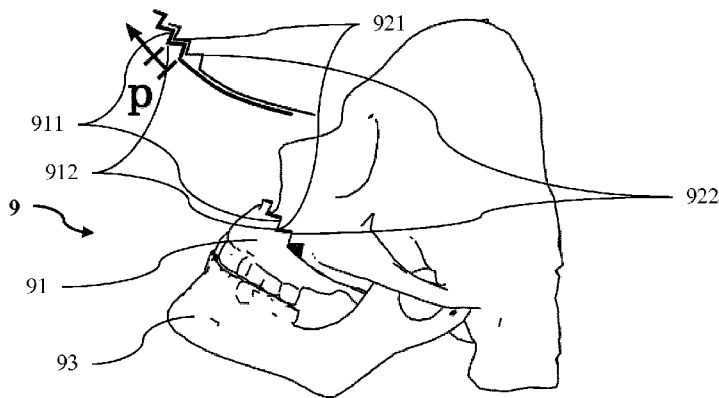

Fig. 14

(57) Abstract: A method for planning a process of cutting human or animal bone tissue (9) comprises: obtaining initial data of an initial situation of the bone tissue (9); defining target data of a target situation of the bone tissue (9); and computing a cut geometry using the initial data and the target data for cutting the bone tissue (9) apart. The cut geometry comprises a structure being shaped such that the bone tissue (9) is reassemblable in an at least in one degree of freedom distinct manner in the target situation after being cut apart along the cut geometry. By shaping the structure of the cut geometry in accordance with the target situation of the bone the planned cut can be provided with a particular function. I.e., such a functional cut can geometrically define and restrict possible movements of cut apart bone portions in relation to each other. Thereby, the functional cut can allow for comparably precisely repositioning the bone into the target position and any movement therefrom at least in the one degree of freedom can be prevented. Thus, the method according to the invention allows for cutting bone tissue whereas reassembling cut apart portions of the bone tissue in accordance with the intended application is already initially considered. Thereby, it is possible to assure that the bone tissue can be comparably precisely and stably reassembled in the target position without mandatorily requiring additional fixing means or the like. Inaccuracies of manual or similar positioning of the cut apart bone portions while reassembling can be minimized or even excluded.



5 DESCRIPTIONTitle

CUTTING HUMAN OR ANIMAL BONE TISSUE AND PLANNING SUCH CUTTING

10 Technical Field

[0001] The present invention relates to a method for planning a process of cutting human or animal bone tissue, to a computer program for implementing such a method and to a process of cutting human or animal bone tissue. Such methods in which data of an initial situation of the bone tissue is obtained, a cut geometry is designed, the bone tissue is cut along the cut geometry and the bone tissue is reassembled after being cut apart can be used in many medical or surgical applications such as in reconstructive surgery.

Background Art

20 [0002] In today's surgery it is often needed to separate human or animal bone tissue in plural pieces, to remove the single pieces from each other and to reassemble the pieces again. For example, in many applications in reconstructive surgery it is necessary to separate a bone in plural pieces and to reassemble the plural pieces in an adapted position for reshaping the bone to a target shape or situation. One example of such a reconstructive surgery application is correction of a patient's overbite. Thereby, in some cases the maxilla is divided in two or more pieces and reassembled in a target position. In the target position the two portions of the bone grow together during the healing process or are fixed together and the bone is reshaped accordingly. For separating or dividing the bone in such an application suitable cutting tools are used which allow applying a cut to the bone.

[0003] Or in other surgery applications it is necessary to temporarily divide a bone, e.g., in order to access a space covered by the bone. For example, in order to access

the interior of the chest, e.g. in order to access the heart or lung, often the sternum is divided apart and reassembled after the intervention in the original position. Similarly, also for such dividing suitable bone cutting tools are used for separating the bone apart.

[0004] A problem occurring in today's surgery including separation of human or animal bone tissue is that conventional cutting tools usually have an insufficient precision such that reassembling the bone tissue causes adverse effects or an unsatisfying result. For example, conventional surgical saws produce a comparably wide cut and thereby remove comparably much bone substance. Also conventional cutting tools often cause collateral damages to the bone tissue near the cut which are to prevent if possible.

[0005] In this context, cutting tools have been developed which allow for an improved precise cutting of human and animal bone tissue. For example, WO 2011/035792 A1 describes a computer assisted and robot guided laser osteotome medical device. This device uses a robot arm guided laser, such as an Er:YAG laser, to cut human or animal bone tissue by photoablating the tissue along a predefined osteotomic line. With such a device bone or other bone tissue can be cut with comparably high precision and comparably low collateral damages.

[0006] However, even though the mentioned modern cutting tools allow for improved applications in surgery, cutting bone tissue for reassembling it in a target position or shape can still be problematic. In particular, after being reassembled, the separated portions of the bone tissue can be at least comparably slightly shifted or moved in relation to each other such that the reassembled bone tissue is not precisely reshaped or rearranged in the target position. A possible way for preventing such shifting or moving can be to fix the separated portions of the bone tissue in the target position by external mechanical means such as screws, nails or the like. Such fixing can, however, be comparably cumbersome and laborious. Additionally, often the cut apart portions of the bone tissue are not suitably shaped in order to be properly reassembled in the target position such that auxiliary constructions have to be used.

[0007] Therefore, there is a need for cutting human or animal bone tissue in manner allowing reassembling cut apart portions of the bone tissue in a manner adapted to the intended application.

Disclosure of the Invention

[0008] According to the invention this need is settled by a method as it is defined by the features of independent claim 1, by a computer program as it is defined by the features of independent claim 11 and by a process as it is defined by the features of independent claim 12. Preferred embodiments are subject of the dependent claims.

[0009] In particular, the gist of the invention is the following: A method for planning a process of cutting human or animal bone tissue comprises: obtaining initial data of an initial situation of the bone tissue; defining target data of a target situation of the bone tissue; and computing a cut geometry using the initial data and the target data for cutting the bone tissue apart. Thereby, the cut geometry comprises a structure being shaped such that the bone tissue is reassemblable in an at least in one degree of freedom distinct manner in the target situation after being cut apart along the cut geometry.

[0010] The method according to the invention can completely or also partially be a computer implemented method. The term "bone tissue" in the context of the invention can relate to any human or animal bone or bone-like tissue. Particularly, it covers skeleton bones such as jaw bones, maxillas, sternums, skulls, cartilage and the like. The term "situation of the bone tissue" can relate to position and/or shape of the bone tissue. The initial situation of the bone tissue can be a bone tissue situation which has to be corrected or adapted. In such a case the initial situation of the bone tissue is different from the target situation of the bone tissue. The initial situation of the bone tissue can also be a situation which has to be temporarily changed, e.g. in order to open the interior of the body or the like. Thereby, the initial situation can be identical to the target situation. The terms "initial data" and "target data" can particularly relate to geometrical data defining the situation of the bone tissue. This geometrical data can be defined within a suitable coordinate system. The initial data can be obtained by measuring the bone tissue, e.g., by means of computer tomography (CT) or the like and providing measurement information, e.g., as digital data.

[0011] The term "degree of freedom" as used in connection with the invention relates to the movement of cut apart portions or pieces of the bone tissue in relation to each other. It can particularly relate to a rotational movement and/or a lateral movement in any possible direction. The term "distinct manner" in the context of the invention relates

to an at least in one degree of freedom non-deviatable reassembling of the bone tissue in the target situation. In particular, it can relate to one or plural comparably precise target positions from which a continuous or stepless modification is excluded at least in the mentioned one degree of freedom. This means that in accordance with this term the bone tissue is reassemblable in any predefined target situation only and any continuous or floating deviation thereof in the at least one degree of freedom is not reasonably feasible. This can particularly differentiate the method according to the invention from any method in which bone tissue is cut apart and reassembled in a continuous manner along the cut, e.g., until an intended target situation is more or less achieved.

5 [0012] By shaping the structure of the cut geometry in accordance with the target situation of the bone the planned cut can be provided with a particular function. I.e., such a functional cut can geometrically define and restrict possible movements of cut apart bone portions in relation to each other. Thereby, the functional cut can allow for comparably precisely repositioning the bone into the target position and any movement therefrom at least in the one degree of freedom can be prevented. Also, such a functional cut allows for providing additional contact surface area compared to conventional cuts such that stronger connection can be achieved after reassembling and healing together.

[0013] Thus, the method according to the invention allows for cutting human or animal bone tissue whereas reassembling cut apart portions of the bone tissue in accordance with the intended application is already initially considered and implemented. Thereby, it is possible to assure that the bone tissue can be comparably precisely and stably reassembled in the target position without mandatorily requiring additional fixing means or the like. Inaccuracies of manual or similar positioning of the cut apart bone portions while reassembling can be minimized or even excluded.

[0014] Preferably, the structure of the cut geometry is shaped such that the bone tissue is reassemblable in all degrees of freedom distinct manner in the target situation after being cut apart along the cut geometry. The term "all degrees of freedom" relates in this context to a movement of the cut apart bone portions in relations to each other. This does particularly not include any movement for separating the cut apart bone portions from each other but only for positioning the cut apart bone portions in relation to each other. Like this, the target position can precisely be predefined by the geometry of the cut itself and any unintended movement of the cut apart bone portions in relation

to each other can be prevented. Also tracking of the reassembling by external means can be prevented.

[0015] In one preferred embodiment, the structure of the cut geometry is shaped such that the bone tissue is reassemblable exclusively in one single target situation after being cut apart along the cut geometry.

[0016] In another preferred embodiment, the structure of the cut geometry is shaped such that the bone tissue is reassemblable in plural stepwise distinct target situations after being cut apart along the cut geometry. Thereby, the structure of the cut geometry preferably is computed using a periodic function and is periodically shaped in accordance with the periodic function. In this context, the term "periodic function" can relate to a complicated periodic function wherein complicated function can mean a function on top of a regular function such as a circular function or the like. The periodic function can particularly be a sinus or similar function, a triangular function or the like.

[0017] Preferably, the structure of the cut geometry comprises a convex curved portion and a concave curved portion corresponding to the convex curved portion wherein the convex curved portion is arranged in the concave curved portion when the bone tissue is in the target situation. With such a cut geometry a twist movement or rotation of the cut apart bone portions can be prevented whereas, in some embodiments, a rotational movement perpendicular to the cutting face can still be possible.

[0018] Preferably, the structure of the cut geometry comprises a convex wedged portion and a concave wedged portion corresponding to the convex wedged portion wherein the convex wedged portion is arranged in the concave wedged portion when the bone tissue is in the target situation. Thereby, the wedged portions can be defined by non-perpendicular surface angles on different sides of the wedged portion. With such a structure parallel displacement of the cut apart bone portions can be prevented.

[0019] Preferably, the structure of the cut geometry comprises a projection and a recess corresponding to the projection wherein the projection is arranged in the recess when the bone tissue is in the target situation. Thereby, the projection preferably comprises a bar and the recess a groove corresponding to the bar. Such an arrangement allows for blocking the cut apart bone portions in relation to each other

whereas a parallel or lateral movement may still be possible. By providing a plurality of bars and corresponding grooves the distance between the bars can define a desired displacement distance.

5 [0020] Also, the projection preferably comprises a pin and the recess comprises a hole corresponding to the projection. Such a structure allows the cut to be provided with a plug like function. In particular, by arranging the pin inside the hole the cut apart portions of the bone tissue can be precisely plugged together in the target position.

10 [0021] A further aspect of the invention relates to a computer program comprising computer readable commands causing a computer to implement a method as described above when being loaded to or executed by the computer. Such a computer program allows for efficiently implementing the method according to the invention and its according effects.

15 [0022] Another further aspect of the invention relates to a process of cutting human or animal bone tissue. The process comprises: obtaining initial data of an initial situation of the bone tissue; defining target data of a target situation of the bone tissue; computing a cut geometry using the initial data and the target data for cutting the bone tissue apart, wherein the cut geometry comprises a structure being shaped such that the bone tissue is reassemblable in an at least in one degree of freedom distinct manner in the target situation after being cut apart along the cut geometry; cutting the cut geometry into the bone tissue; taking the bone tissue apart along the cut geometry; and reassembling the bone tissue in the target situation.

25 [0023] The process which can be an in vitro process implements the method according to the invention described hereinbefore. Accordingly, it also implements the effects and advantages of this method as described above. In consequence, the process according to the invention allows for cutting human or animal bone tissue whereas reassembling cut apart portions of the bone tissue in accordance with the intended application is already initially considered. Thereby, it is possible to assure that the bone tissue can be comparably precisely and stably reassembled in the target position without mandatorily requiring additional fixing means or the like. Inaccuracies of manual or similar positioning of the cut apart portions while reassembling can be minimized or even excluded.

30

[0024] Preferably, the cut geometry is cut into the bone tissue by a laser beam. Such a laser beam allows for precisely applying cuts in any angle and depth without substantially impairing the bone tissue or neighboring other tissue. Thereby, the laser beam preferably is provided by a laser source mounted to a robot arm. Such an arrangement allows for precisely moving and directing the laser beam in any degree of freedom such that comparably complicated cutting geometries can be applied. Thereby, the laser beam and the robot arm preferably are controlled by a computer, wherein the computer is arranged to compute the cut geometry using the initial data and the target data. In particular, the computer can use data previously obtained and determined from an algorithm which a-priori calculates the cutting path or geometry with the initial data to achieve the target geometry or position.

[0025] Preferably, by cutting the cut geometry into the bone tissue the bone tissue is cut in a first bone portion and a second bone portion wherein in the target situation the first bone portion and the second bone portion are displaced in relation to each other. In this way, the bone tissue can conveniently be reshaped which is necessary in many surgical applications.

[0026] These and other aspects of the invention will be apparent from and elucidated with reference to the embodiment(s) described hereinafter.

20 Brief Description of the Drawings

[0027] In the following, the method according to the invention, the computer program according to the invention and the process according to the invention are described in more detail by way of exemplary embodiments and with reference to the attached drawings, in which:

- 25 Fig. 1 shows a computer assisted surgery apparatus for implementing an embodiment of a method, computer program and process in accordance with the invention;
- Fig. 2 shows a curvature cut based on a cut geometry having a structure with a convex curved portion and a concave curved portion provided by a method and process according to the invention;
- 30 Fig. 3 shows a wedged cut based on a cut geometry having a structure with a convex wedged portion and a concave wedged portion provided by a method and process according to the invention;

- Fig. 4 shows a plug cut based on a cut geometry having a structure with bars and grooves provided by a method and process according to the invention;
- Fig. 5 shows a periodic cut based on a cut geometry having a periodic shape overlaying a curved cutting line provided by a method and process according to the invention;
- Fig. 6 shows a complicated periodic cut based on a cut geometry having a complicated periodic shape overlaying a straight cutting line provided by a method and process according to the invention;
- Fig. 7 shows a discontinuous cut provided by a method and process according to the invention;
- Fig. 8 shows a removing cut provided by a method and process according to the invention;
- Fig. 9 shows a replacing cut provided by a method and process according to the invention;
- Fig. 10 shows an initial situation of an example of maxillary orthognathic surgery applying a method and process in accordance with the invention;
- Fig. 11 shows a target situation of the example of Fig. 10;
- Fig. 12 shows cutting geometries of the example of Fig. 10;
- Fig. 13 shows an example of sternum opening surgery applying a method and process in accordance with the invention; and
- Fig. 14 shows an example of maxilla displacement surgery applying a method and process in accordance with the invention.

Description of Embodiments

- [0028] In the following description certain terms are used for reasons of convenience and are not to be interpreted as limiting. The terms "right", "left", "up", "down", "horizontal", "vertical", "upper", "lower", "under" and "above" refer to directions in the figures. The terminology comprises the explicitly mentioned terms as well as their derivations and terms with a similar meaning.
- [0029] Fig. 1 shows a schematic view of a computer assisted surgery apparatus 1 comprising an embodiment of a computer program according to the invention and being arranged for applying the method according to the invention and the process according to the invention. The apparatus 1 comprises a robot arm 11 being fixedly arranged at its

one longitudinal end on a support platform. On the other longitudinal end of the robot arm a laser head 12 is arranged which is movable by the robot arm 11 in all degrees of freedom. The laser head 12 has a laser source, a focusing optics and adjustable mirrors for redirecting the laser. Fixedly mounted to the laser head 12 is a monitoring system of the laser head 12 having two cameras 15. Furthermore, a marker shield 13 is attached to the laser head 12. The apparatus 1 also comprises a tracking device 14 and a control unit having a computer 16 running the computer program.

[0030] In the sphere of action of the apparatus 1 a mandibula 2 or lower jaw as bone tissue is arranged. A marker shield 22 is attached to the mandibula. The laser head 12 of the apparatus provides a laser beam 31 onto the mandibula 2 along an osteotomic line 21 defining a cut geometry. Thereby, the mandibula 2 is cut by the laser beam 31 along the osteotomic line 21. The osteotomic line has a realized portion 211, i.e. the cut, in which the mandibula 2 is cut by the laser beam 31 already and a planned portion 212 in which the mandibula 2 still is to cut. The osteotomic line 21 has a periodic rectangular shape with right angles such that plural parallel bars and grooves are formed in the mandibula 2.

[0031] In use of the apparatus 1, initial geometrical data of the mandibula 2 is obtained, e.g. by means of computer tomography (CT), three-dimensional stereo reconstruction using the two cameras 15, using one camera and a scanned laser beam for three-dimensional reconstruction or optical coherence tomography (OCT). The initial geometrical data is processed by the computer 16 wherein target geometrical data of a target situation of the mandibula 2 is a-priori defined by means of the computer 16. The computer 16 then models and calculates an ideal or suitable cut geometry, i.e., in Fig. 1, the osteotomic line 21. Thereby, the osteotomic line 21 structures the cut geometry such that the mandibula 2 can be divided apart and reassembled in a horizontally distinct manner by creating the bars and grooves.

[0032] The mandibula 2 is then arranged at a suitable location in the sphere of action of the apparatus 1 and the laser beam 31 provided by the laser head 12 cuts the mandibula 2 along the osteotomic line 21. For that purpose the laser head 12 is moved by the robot arm 11 and the laser beam 31 is adjusted by the mirrors of the laser head 12. In particular, the position and orientation of the laser beam 31 is automatically controlled by the control unit such that the mandibula 2 is precisely cut along the osteotomic line 21.

[0033] After being cut the mandibula 2 is taken apart by vertically moving the lower portion from the upper portion of the mandibula 2. The lower portion is then shifted by an appropriate number of bars and reassembled by arranging bars in grooves other than the grooves they originate from. Thereby, the lower portion can be horizontally and distinctly or stepwise displaced to the right by a suitable number of bars such that the mandibula 2 is in the target situation.

[0034] The following applies to the rest of this description. If, in order to clarify the drawings, a figure contains reference signs which are not explained in the directly associated part of the description, then it is referred to previous description sections.

[0035] In the following, examples of cut geometries for cutting bone tissue apart and examples of applications of such cut geometries or functional cuts are explained in more detail. These cut geometries which can be generated in a method or a process according to the invention particularly comprise a structure which is shaped to allow reassembling the bone tissue in an at least in one degree of freedom distinct manner after being cut apart along the cut geometry.

[0036] Fig. 2 shows a schematic view of a bone tissue 4 which is cut apart along a cut geometry having a curvature shaped structure into an upper first bone portion 41 and a lower second bone portion 42. In particular, the structure has a convex curved portion 411 at the first bone portion 41 and a corresponding concave curved portion 421 at the second bone portion 42.

[0037] The curvature shaped structure of the bone tissue 4 is defined by a center C and a radius r of the curvature cut creating the convex curved portion 411 and the concave shaped portion 421. Whereas the first bone portion 41 and the second bone portion 42 can be moved in a tangential direction 5 allowing a rotation perpendicular to a cutting line and in a lateral direction 6 in relation to each other, other degrees of freedom such as twisting or the like are avoided by the cut geometry. Thus, the cut geometry only allows a distinct reassembling of the first bone portion 41 and the second bone portion 42.

[0038] In Fig. 3 a schematic view of a bone tissue 49 which is cut apart along a cut geometry having a wedged shaped structure in an upper first bone portion 419 and a lower second bone portion 429. In particular, the structure has a convex wedged portion

4119 at the first bone portion 419 and a corresponding concave wedged portion 4219 at the second bone portion 429.

[0039] The wedged shaped structure of the bone tissue 49 is defined by a center C and a radius r , wherein the radius r changes in a lateral direction such that a non-perpendicular angle δ is formed laterally between the surface of the convex wedged portion 4119 and the radius r . By doing cuts with such non-perpendicular cutting angle from both sides the wedged surfaces of the convex wedged portion 4119 and the corresponding concave wedged portion 4219 can be achieved which prevents from parallel or lateral displacement but still allows the first bone portion 419 and the second bone portion 429 to be moved in a tangential direction 59. Thus, the cut geometry only allows a distinct reassembling of the first bone portion 419 and the second bone portion 429.

[0040] Fig. 4 shows a schematic view of a bone tissue 48 which is cut apart along a cut geometry having a structure with plural bars 4128, 4228 and plural grooves 4118, 4218 into an upper first bone portion 418 and a lower second bone portion 428. In particular, the structure has two bars 4128 separated from each other by a groove 4118 at the first bone portion 418 and two corresponding grooves 4218 separated by a bar 4228 at the second bone portion 428. Thereby, the bars 4128 of the first bone portion 418 are projecting downwardly into the direction of the second bone portion 428 and the bar 4228 of the second bone portion 428 is projecting upwardly into the direction of the first bone portion 418. The bars 4128, 4228 and the grooves 4118, 4218 have an equal width, i.e. distance d .

[0041] As shown in Fig. 4 the bone tissue 48 is reassembled after being taken apart such that one of the bars 4128 of the first bone portion 418 is arranged in one of the grooves 4218 of the second bone portion 428 neighbouring the groove 4218 it is originating from. In particular, the right-hand bar 4128 of the first bone portion 418 which originally was associated to the right-hand groove 4218 of the second bone portion 428 is arranged in the left-hand groove 4218 of the second bone portion 428. Like this, the first bone portion 418 is shifted in relation to the second bone portion 428 in a longitudinal direction 58 by the distance $2*d$. Thereby, the distance $2*d$ defines the desired displacement distance such that longitudinal shifting of the first bone portion 418 in relation to the second portion 428 is exactly predefined and a deviation thereof can be prevented. Thus, the cut geometry only allows a distinct reassembling of the first

bone portion 418 and the second bone portion 428 into a predefined target position. Tracking the shifting movement with an external tracking system and manually tuning the shifting is not necessary.

[0042] In Fig. 5 a schematic view of a bone tissue 47 which is cut apart along a cut geometry having a periodic shaped structure into an upper first bone portion 417 and a lower second bone portion 427 is shown. In particular, in the structure of the cut geometry a base cutting line 517 is overlaid with a periodic triangular function 527 such that the first bone portion 417 is provided with series of triangular projections 4127 and triangular recesses 4117 having a period p and the second bone portion 427 is provided with corresponding series of triangular projections 4227 and triangular recesses 4217 having the period p . Thereby, a displacement distance is defined in steps corresponding to the period p .

[0043] As shown in Fig. 5 the bone tissue 47 is reassembled after being taken apart such that the triangular projections 4127 of the first bone portion 417 are arranged in triangular recesses 4217 of the second bone portion 427 neighbouring the recesses 4217 they originate from. Thereby, the second bone portion 427 is shifted along the base cutting line 517 by the period p . The period p defines the desired displacement step distance such that longitudinal shifting of the first bone portion 417 in relation to the second portion 427 is exactly predefined and a deviation from the predefined steps can be prevented. Thus, the cut geometry only allows a distinct reassembling of the first bone portion 417 and the second bone portion 427 into a predefined target position. Tracking the shifting movement with an external tracking system and manually tuning the shifting is not necessary.

[0044] In an embodiment not explicitly shown in the Figs. the periodic shaped structure shown in Fig. 5 is combined with the wedged shaped structure of Fig. 3.

[0045] Fig. 6 shows a schematic view of a bone tissue 46 which is cut apart along a cut geometry having a complicated shaped structure into an upper first bone portion 416 and a lower second bone portion 426. In particular, in the structure of the cut geometry a base cutting line 516 is overlaid with a sinusoidal function 526 with a non-uniform period p generating plural non-uniform projections 4126 and recesses 4116 at the first bone portion 416 and corresponding plural non-uniform projections 4216 and recesses 4216 at the second bone portion 426. In addition thereto, the sinusoidal function 526

varies in a lateral direction of the bone tissue 46 such that a non-perpendicular lateral cutting angle δ is formed.

[0046] By changing the cutting angle δ with varying sinusoidal functions, a twisted cutting surface is achieved. This prevents from parallel or lateral displacement as well as from longitudinal displacement. While using the non-uniform period p and the changing cutting angle δ , the first bone portion 416 and the second bone portion 426 only match at one single position along the cutting line 516. Thus, such slanted cutting surface and non-period cutting function combined results in two bone portions 416, 426 which only match together at the original position of the initial situation. Thus, the cut geometry only allows a distinct reassembling of the first bone portion 416 and the second bone portion 426 into a predefined target position which is equal to the initial position.

[0047] In Fig. 7 a schematic view of a bone tissue 45 which is cut apart along a cut geometry having a discontinuously shaped structure into an upper first bone portion 415 and a lower second bone portion 425 is shown. In particular, in the structure of the cut geometry the first bone portion 415 comprises a first hook member 4115 and the second bone portion a second hook member 4215. The first hook member 4115 engages into the second hook member 4215 such that first bone portion 415 is movable in relation to the second bone portion mainly in a shifting direction 55 only.

[0048] As shown in Fig. 7 the second bone portion 425 is displaced in relation to the first bone portion 415 along the shifting direction 55 such that cavities are formed between the first bone portion 415 and the second bone portion 425. Like this, the comparably complicated discontinuous structure allows for combinations with plates and/or spacers to create a target position where the first bone portion 415 is only partially connected to the second bone portion 425.

[0049] Fig. 8 shows a schematic view of a mandibula 44 which is cut apart along a cut geometry into an right-hand first mandibula portion 414 and a left-hand second mandibula portion 424 wherein the cut geometry is structured to remove a mandibula piece 444. In particular, the structure of the cut geometry comprises a first triangular projection 4114 and a first triangular recess 4124 arranged at the first mandibula portion 414 and a corresponding second triangular projection 4214 and a second triangular recess 4224 arranged at the second mandibula portion 424.

[0050] As shown in Fig. 8 when being reassembled the mandibula piece 444 is removed. Furthermore, the structure of the cut geometry is shaped such that the second mandibula piece is displaced in a displacement direction 514 and rotated in a pivot direction 524 when the first projection 4114 is arranged in the second recess 4224 and the second projection 4214 is arranged in the first recess 4124. Thus, the cut geometry only allows a distinct reassembling of the first mandibula portion 414 and the second mandibula portion 424 into a predefined target position in which the first mandibula portion 414 is shifted and rotated in relation to the second mandibula portion 424. Thus, the cut geometry only allows a distinct reassembling of the first bone portion 416 and the second bone portion 426 into a predefined target position.

[0051] Like this, dependent on the application, cuts can be provided where a certain part or piece is removed. For example, in orthognathic surgery an overbite can be corrected by removing a part from the mandibula as shown in Fig. 8. Doing this with a designed removal cut, the displacement and rotation of the mandibula 44 can be exactly defined.

[0052] In Fig. 9 a schematic view of a bone tissue 43 cut apart along a cut geometry structured for a replacement into an upper first bone portion 413 and a lower second bone portion 423 is shown. In particular, the structure of the cut geometry has a trapezoid recess 4113 in the first bone portion 413 and the second bone portion 423 has a corresponding trapezoid body 4213. Like this, the second bone portion 423 can only be connected to the first bone portion 413 by shifting it into a connection direction 53. In the reassembled bone tissue 43 the second bone portion 423 is held in the first bone portion 413 such that it cannot be displaced downwardly therefrom such as, e.g., by a weight 433.

[0053] Such a cut geometry does also allow for a transplantation of bone or similar tissue. Thereby, the second bone portion 423 is not reassembled to the first bone portion 413 it is originating from but to a different first bone portion of a target bone tissue. Such an application could, e.g., be a ligament replacement in the knee.

[0054] Fig. 10 shows a schematic view of a skull 7 in an initial situation of an example of a maxillary orthognathic process. The skull 7 comprises a cranium 72 with a maxilla 71 and a mandibula 73. The mandibula 73 projects above the maxilla 71 in a distal

direction by displacement d such that an overbite is formed. To correct the overbite the maxilla 71 has to be cut and displaced.

[0055] In Fig. 11 the skull 7 is shown in a target situation wherein for allowing a comparison the initial situation of the skull 7 is indicated in dotted lines. The reference signs related the initial situation are the same as the reference signs related to the target situation provided with an apostrophe. This cut for correcting the overbite is done from the concha nasalis toward the pterygoideus. As the corresponding cutting line t is not parallel to the displacement d of the bite, shifting along this cutting line t does also lift the maxilla 71. To get a suitable match of maxilla 71 and mandibula 73 in the target situation the curvature of the cutting line t is chosen such that a rotation α of the maxilla 71 and a rotation β of the mandibula 73 are essentially the same.

[0056] As shown in Fig. 12 this is done with a wedged cutting surface γ guiding the displacement d into the desired direction and also preventing from cutting the palatina.

[0057] Fig. 13 shows an example of a sternum opening surgery process. A sternum 8 is cut along a cut geometry with a twisted structure into a right-hand first sternum portion 81 and a left-hand second sternum portion 82. The structure of the cut geometry is defined by a periodic sinus function with a non-uniform period generating plural non-uniform projections 811 and recesses 812 at the first sternum portion 81 and corresponding plural non-uniform projections 821 and recesses 822 at the second sternum portion 82. In addition thereto, the sinusoidal function varies in a proximal or interior direction of the sternum 8 such that a non-perpendicular respective cutting angle is formed. Using such a non-periodic cutting function and a twisted cutting surface for opening the sternum 8 can guarantee that the chest is closed again at the original position. Thus, the cut geometry only allows a distinct reassembling of the first sternum portion 81 and the second sternum portion 82 into a predefined target situation which is equal to the initial situation.

[0058] In Fig. 14 a schematic view of a skull 9 in a target situation of another example of maxilla displacement surgery is shown. Thereby, the skull 9 comprises a cranium 92 with a maxilla 91 and a mandibula 93. The mandibula 93 which originally projected above the maxilla 91 in a distal direction is corrected by cutting the maxilla 91 from the cranium 92 along a cut geometry and reassembling it in the target situation. The cut geometry comprises a structure with a periodic triangular function with period p such

that plural triangular projections 911 and plural triangular recesses 912 are formed at the maxilla 91 and corresponding plural triangular projections 921 and plural triangular recesses 922 are formed at the cranium 92.

5 [0059] The maxilla 91 is advanced in relation to the cranium 92 by one period p such that the projections 911 of the maxilla 91 are arranged in the recesses 922 of the cranium 92 distally neighbouring the recesses 922 they originate from. Like this, it is possible to make sure that the cut maxilla 91 is displaced exactly by the target distance, i.e. the period p .

10 [0060] While the invention has been illustrated and described in detail in the drawings and foregoing description, such illustration and description are to be considered illustrative or exemplary and not restrictive. It will be understood that changes and modifications may be made by those of ordinary skill within the scope and spirit of the following claims. In particular, the present invention covers further embodiments with any combination of features from different embodiments described above and below.

15 [0061] The invention also covers all further features shown in the Figs. individually although they may not have been described in the afore or following description. Also, single alternatives of the embodiments described in the figures and the description and single alternatives of features thereof can be disclaimed from the subject matter of the invention or from disclosed subject matter. The disclosure comprises subject matter
20 consisting of the features defined in the claims or the exemplary embodiments as well as subject matter comprising said features.

[0062] Furthermore, in the claims the word "comprising" does not exclude other elements or steps, and the indefinite article "a" or "an" does not exclude a plurality. A single unit or step may fulfil the functions of several features recited in the claims. The
25 mere fact that certain measures are recited in mutually different dependent claims does not indicate that a combination of these measures cannot be used to advantage. The terms "essentially", "about", "approximately" and the like in connection with an attribute or a value particularly also define exactly the attribute or exactly the value, respectively. The term "about" in the context of a given numerate value or range refers to a value or
30 range that is, e.g., within 20%, within 10%, within 5%, or within 2% of the given value or range. Any reference signs in the claims should not be construed as limiting the scope.

[0063] A computer program may be stored/distributed on a suitable medium, such as an optical storage medium or a solid-state medium supplied together with or as part of other hardware, but may also be distributed in other forms, such as via the Internet or other wired or wireless telecommunication systems. In particular, e.g., a computer
5 program can be a computer program product stored on a computer readable medium which computer program product can have computer executable program code adapted to be executed to implement a specific method such as the method according to the invention. Furthermore, a computer program can also be a data structure product or a signal for embodying a specific method such as the method according to the invention.

CLAIMS

- Claim 1: Method for planning a process of cutting human or animal bone tissue (2; 4; 43; 44; 45; 46; 47; 48; 49; 7; 8; 9), comprising
- obtaining initial data of an initial situation of the bone tissue (2; 4; 43; 44; 45; 46; 47; 48; 49; 7; 8; 9);
 - defining target data of a target situation of the bone tissue (2; 4; 43; 44; 45; 46; 47; 48; 49; 7; 8; 9); and
 - computing a cut geometry using the initial data and the target data for cutting the bone tissue (2; 4; 43; 44; 45; 46; 47; 48; 49; 7; 8; 9) apart;
- wherein the cut geometry comprises a structure being shaped such that the bone tissue (2; 4; 43; 44; 45; 46; 47; 48; 49; 7; 8; 9) is reassemblable in an at least in one degree of freedom distinct manner in the target situation after being cut apart along the cut geometry.
- Claim 2: Method according to claim 1, wherein the structure of the cut geometry is shaped such that the bone tissue (2; 4; 43; 44; 45; 46; 47; 48; 49; 7; 8; 9) is reassemblable in an in all degrees of freedom distinct manner in the target situation after being cut apart along the cut geometry.
- Claim 3: Method according to claim 1 or 2, wherein the structure of the cut geometry is shaped such that the bone tissue (2; 4; 43; 44; 45; 46; 47; 48; 49; 7; 8; 9) is reassemblable exclusively in one single target situation after being cut apart along the cut geometry.
- Claim 4: Method according to claim 1 or 2, wherein the structure of the cut geometry is shaped such that the bone tissue (2; 4; 43; 44; 45; 46; 47; 48; 49; 7; 8; 9) is reassemblable in plural stepwise distinct target situations after being cut apart along the cut geometry.

- Claim 5: Method according to claim 4, wherein the structure of the cut geometry is computed using a periodic function (526; 527) and periodically shaped in accordance with the periodic function (526; 527).
- Claim 6: Method according to any one of the preceding claims, wherein the structure of the cut geometry comprises a convex curved portion (411) and a concave curved portion (421) corresponding to the convex curved portion (411) wherein the convex curved portion (411) is arranged in the concave curved portion (421) when the bone tissue (2; 4; 43; 44; 45; 46; 47; 48; 49; 7; 8; 9) is in the target situation.
- Claim 7: Method according to any one of the preceding claims, wherein the structure of the cut geometry comprises a convex wedged portion (4119) and a concave wedged portion (4219) corresponding to the convex wedged portion (4119) wherein the convex wedged portion (4119) is arranged in the concave wedged portion (4219) when the bone tissue (2; 4; 43; 44; 45; 46; 47; 48; 49; 7; 8; 9) is in the target situation.
- Claim 8: Method according to any one of the preceding claims, wherein the structure of the cut geometry comprises a projection (811, 821; 911, 921; 4114, 4214; 4126, 4216; 4127, 4227; 4128, 4228) and a recess (812, 822; 912, 922; 4124, 4224; 4116, 4226; 4117, 4217; 4118, 4218) corresponding to the projection (811, 821; 911, 921; 4114, 4214; 4126, 4216; 4127, 4227; 4128, 4228) wherein the projection (811, 821; 911, 921; 4114, 4214; 4126, 4216; 4127, 4227; 4128, 4228) is arranged in the recess (812, 822; 912, 922; 4124, 4224; 4116, 4226; 4117, 4217; 4118, 4218) when the bone tissue (2; 4; 43; 44; 45; 46; 47; 48; 49; 7; 8; 9) is in the target situation.
- Claim 9: Method according to claim 8, wherein the projection comprises a bar (911, 921; 4127, 4227; 4128, 4228) and the recess comprises a groove (912, 922; 4117, 4217; 4118, 4218) corresponding to the bar (911, 921; 4127, 4227; 4128, 4228).
- Claim 10: Method according to claim 8 or 9, wherein the projection comprises a pin and the recess comprises a hole corresponding to the projection.

- Claim 11: Computer program comprising computer readable commands causing a computer to implement a method in accordance with any one of the preceding claims when being loaded to or executed by the computer.
- Claim 12: Process of cutting human or animal bone tissue (2; 4; 43; 44; 45; 46; 47; 48; 49; 7; 8; 9) comprising
- obtaining initial data of an initial situation of the bone tissue (2; 4; 43; 44; 45; 46; 47; 48; 49; 7; 8; 9);
 - defining target data of a target situation of the bone tissue (2; 4; 43; 44; 45; 46; 47; 48; 49; 7; 8; 9);
 - computing a cut geometry using the initial data and the target data for cutting the bone tissue (2; 4; 43; 44; 45; 46; 47; 48; 49; 7; 8; 9) apart, wherein the cut geometry comprises a structure being shaped such that the bone tissue (2; 4; 43; 44; 45; 46; 47; 48; 49; 7; 8; 9) is reassemblable in an at least in one degree of freedom distinct manner in the target situation after being cut apart along the cut geometry;
 - cutting the cut geometry into the bone tissue (2; 4; 43; 44; 45; 46; 47; 48; 49; 7; 8; 9);
 - taking the bone tissue (2; 4; 43; 44; 45; 46; 47; 48; 49; 7; 8; 9) apart along the cut geometry; and
 - reassembling the bone tissue (2; 4; 43; 44; 45; 46; 47; 48; 49; 7; 8; 9) in the target situation.
- Claim 13: Process according to claim 12, wherein the cut geometry is cut into the bone tissue (2; 4; 43; 44; 45; 46; 47; 48; 49; 7; 8; 9) by a laser beam.
- Claim 14: Process according to claim 13, wherein the laser beam (31) is provided by a laser source mounted to a robot arm (11).
- Claim 15: Process according to claim 14, wherein the laser beam (31) and the robot arm (11) are controlled by a computer (16), wherein the computer (16) is arranged to compute the cut geometry using the initial data and the target data.
- Claim 16: Process according to any one of claims 12 to 15, wherein by cutting the cut geometry into the bone tissue (2; 4; 43; 44; 45; 46; 47; 48; 49; 7; 8; 9) the bone

tissue (2; 4; 43; 44; 45; 46; 47; 48; 49; 7; 8; 9) is cut in a first bone portion (41; 71; 81; 91; 413; 414; 415; 416; 417; 418; 419) and a second bone portion (42; 72; 82; 92; 423; 424; 425; 426; 427; 428; 429) wherein in the target situation the first bone portion (41; 71; 81; 91; 413; 414; 415; 416; 417; 418; 419) and the second bone portion (42; 72; 82; 92; 423; 424; 425; 426; 427; 428; 429) are displaced in relation to each other.

DRAWINGS

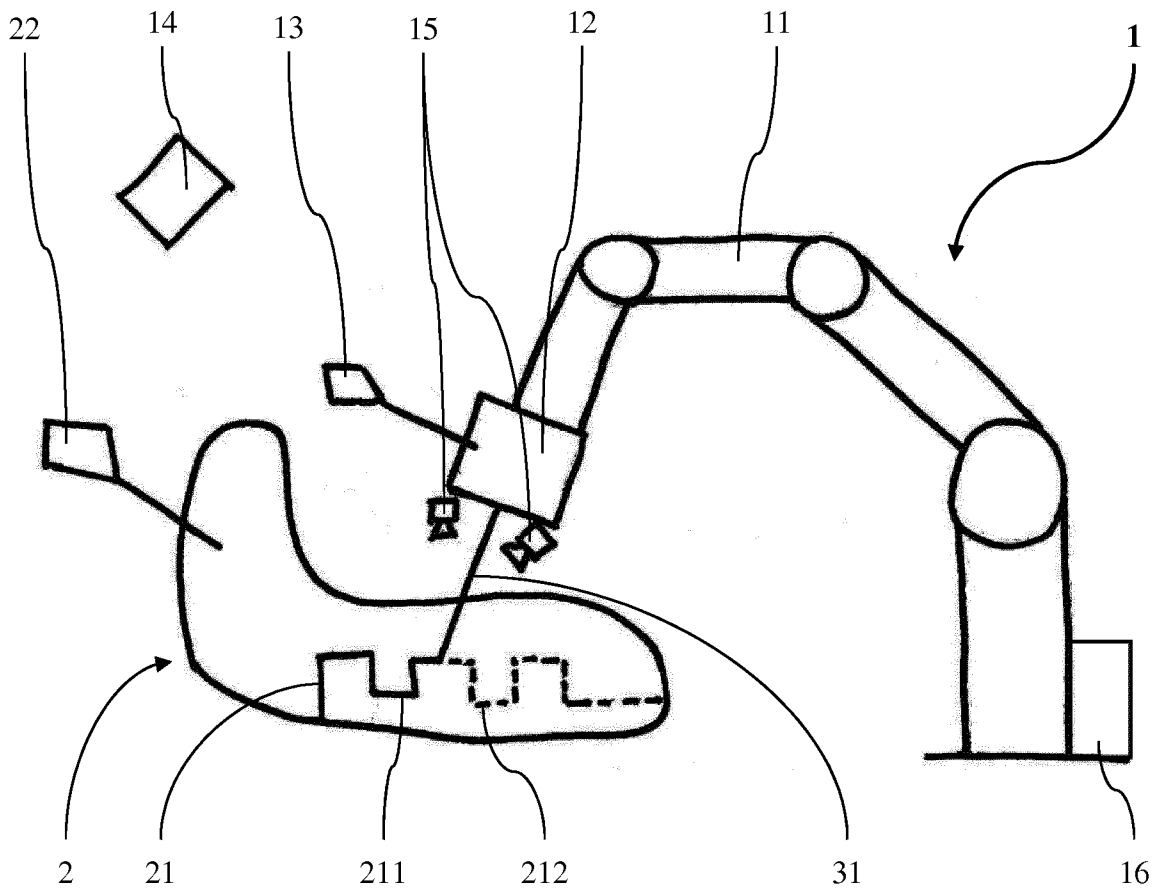

Fig. 1

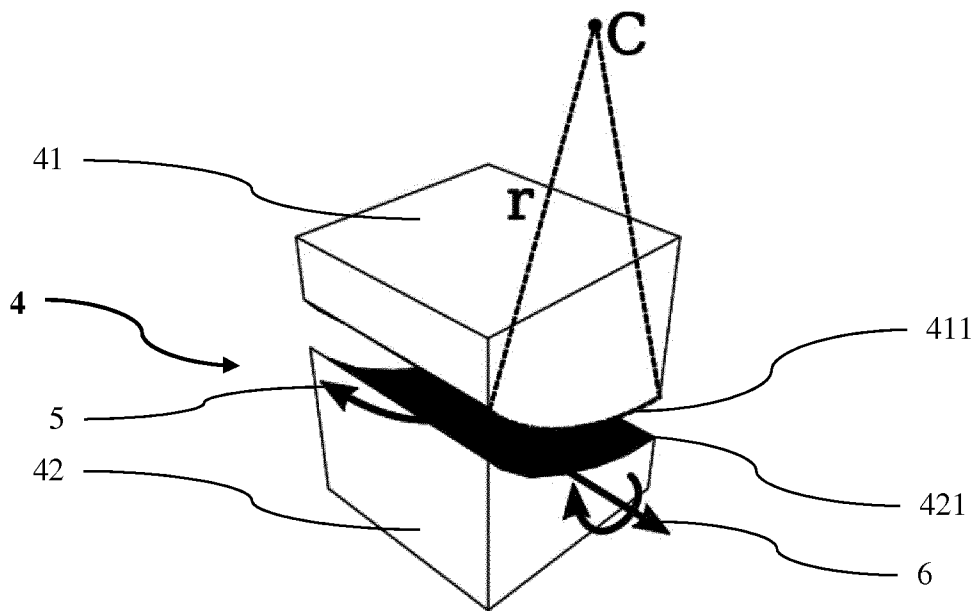
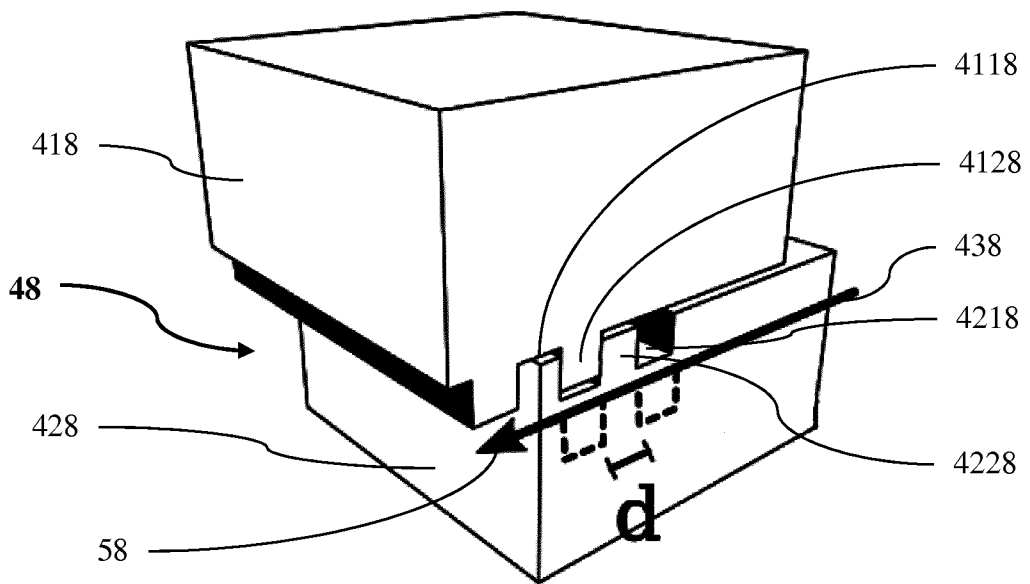
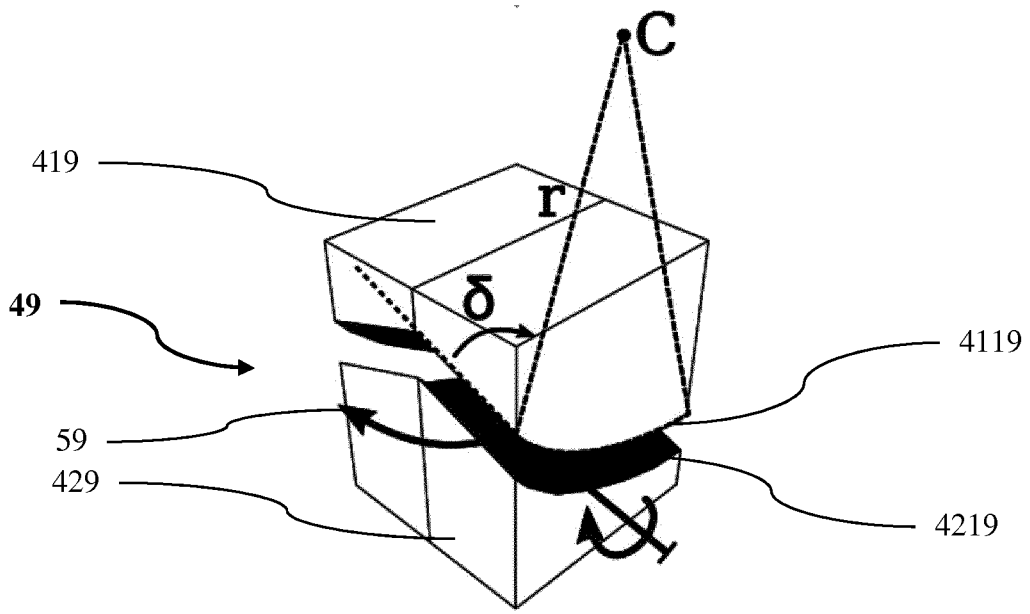

Fig. 2



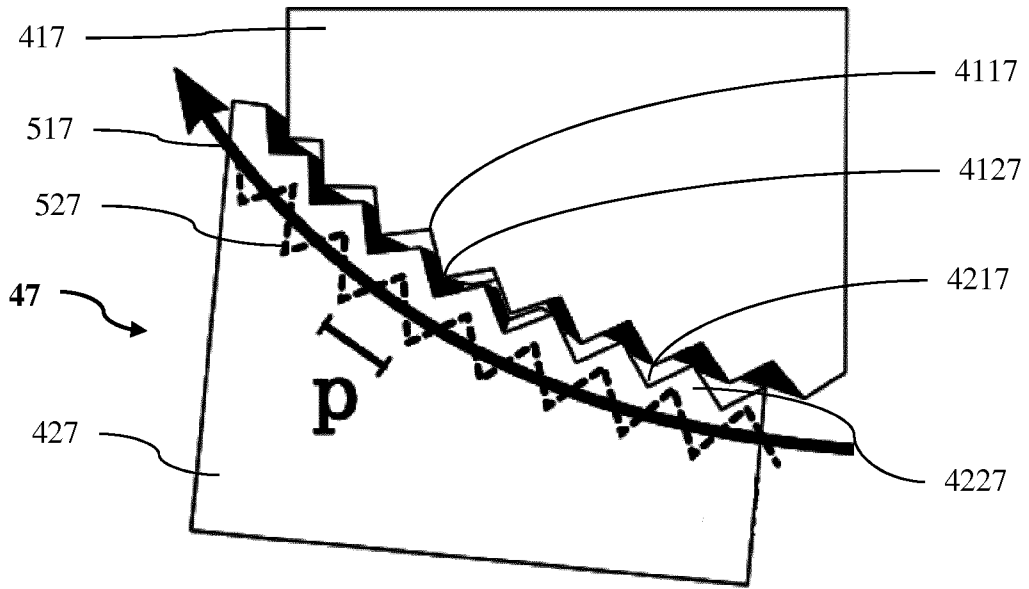

Fig. 5

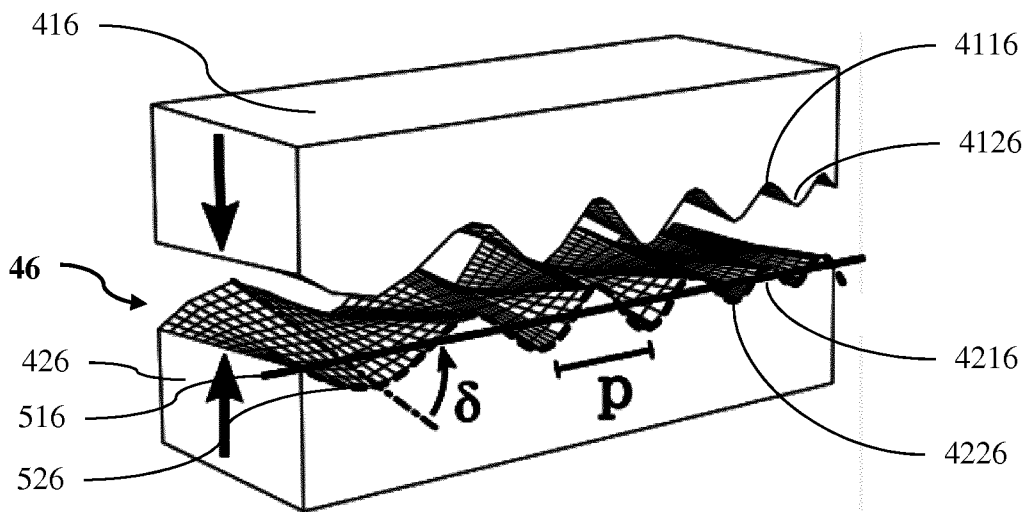

Fig. 6

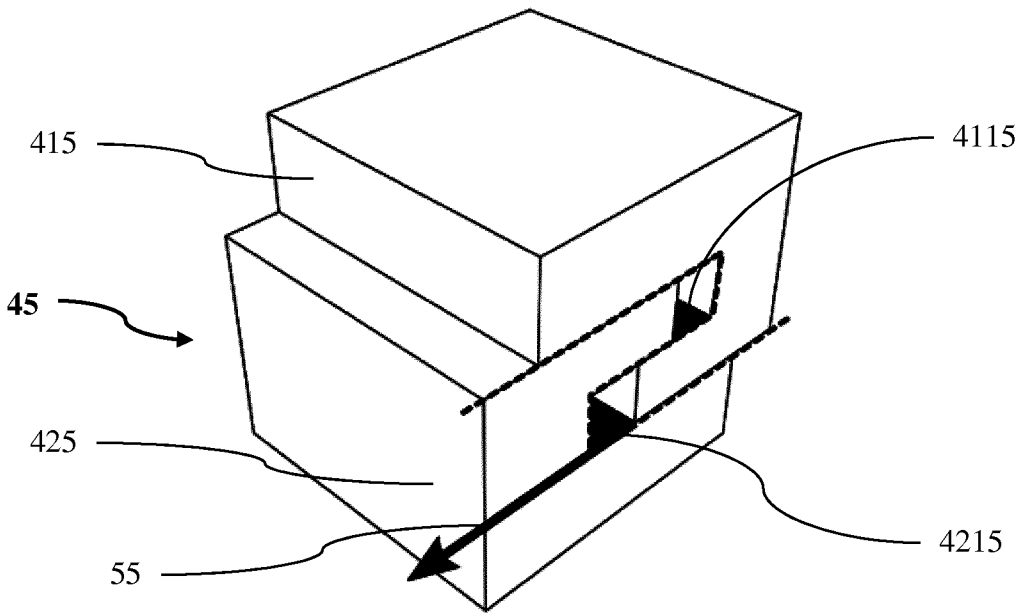

Fig. 7

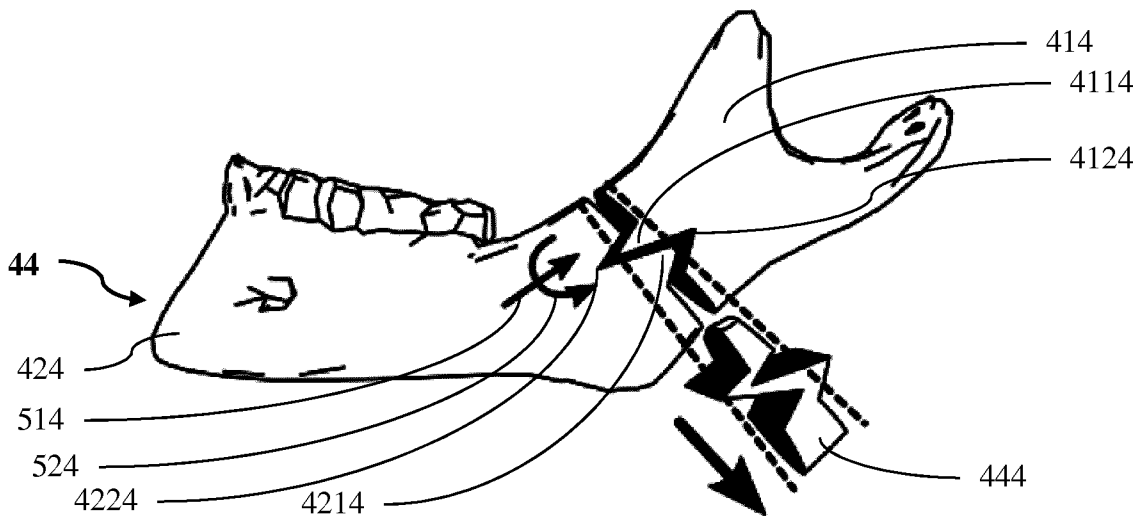

Fig. 8

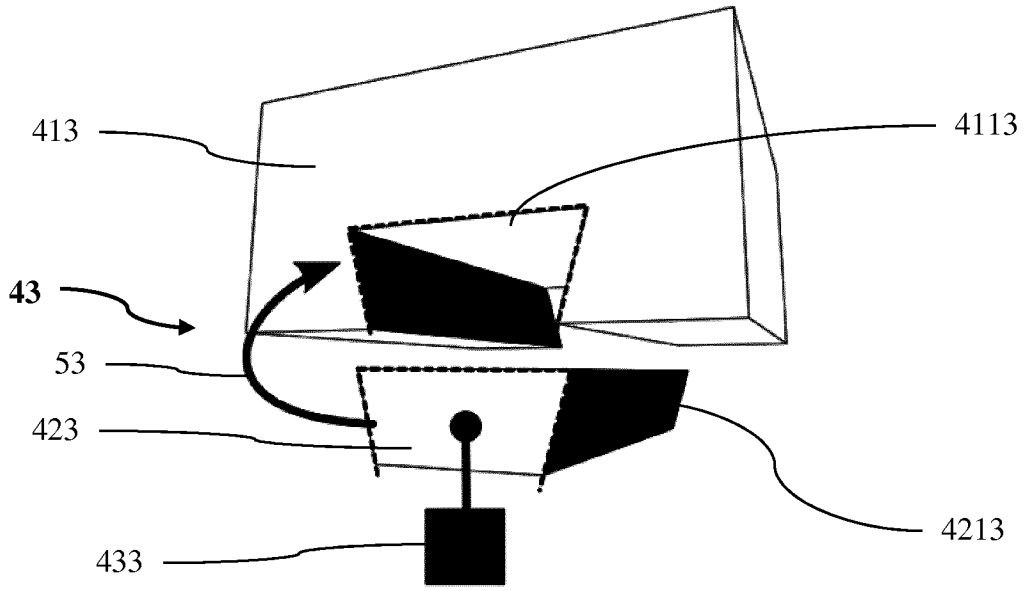

Fig. 9

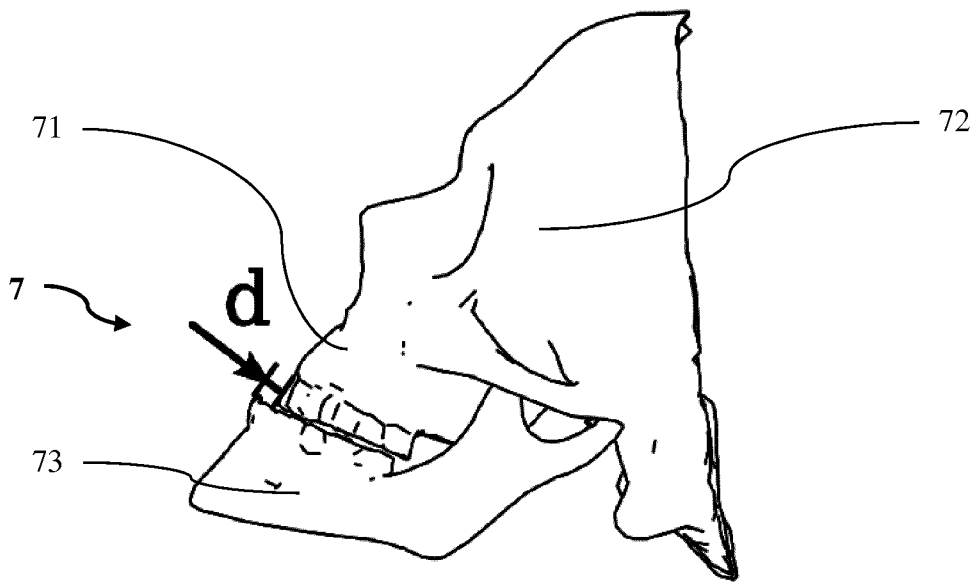

Fig. 10

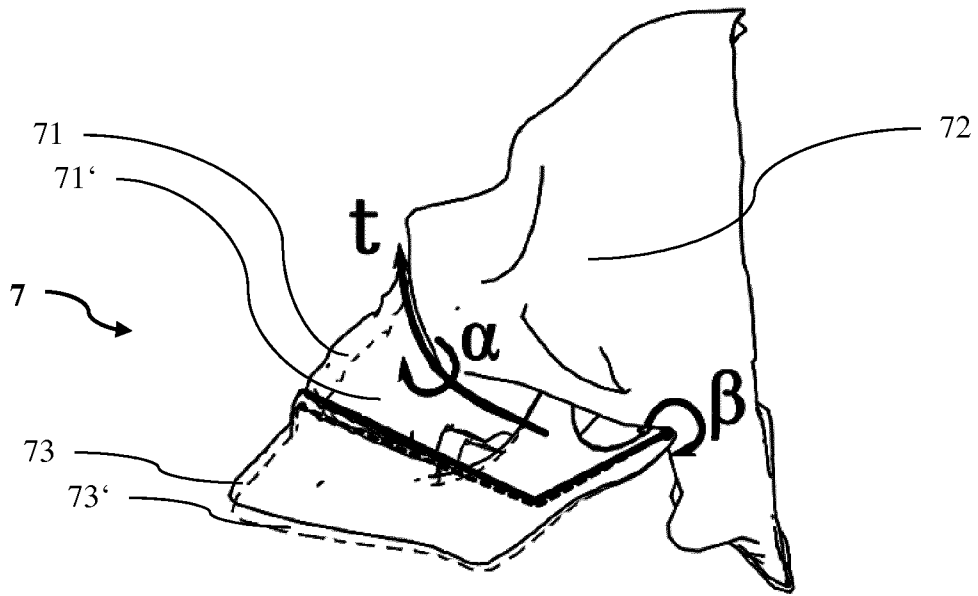

Fig. 11

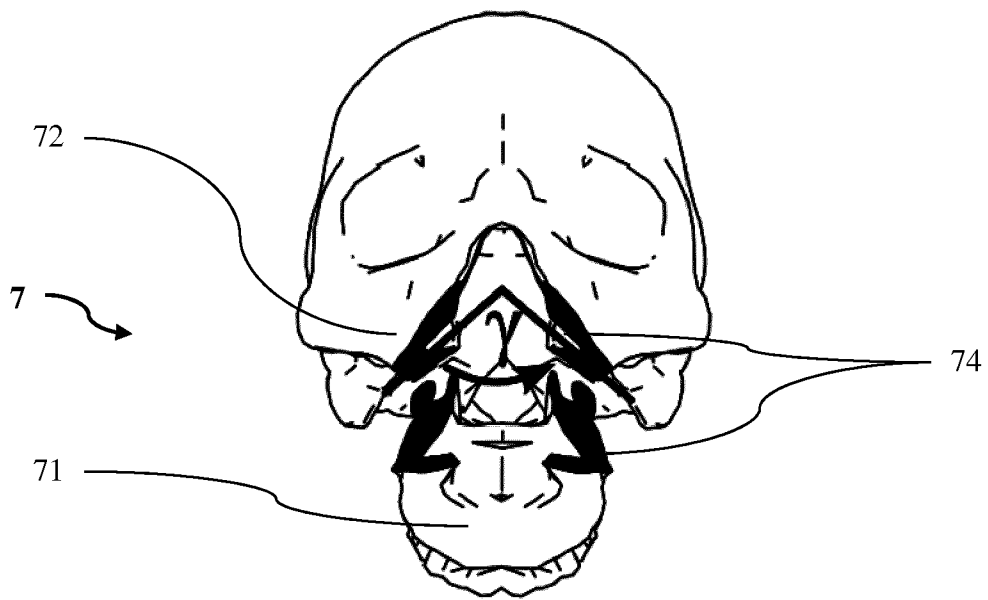

Fig. 12

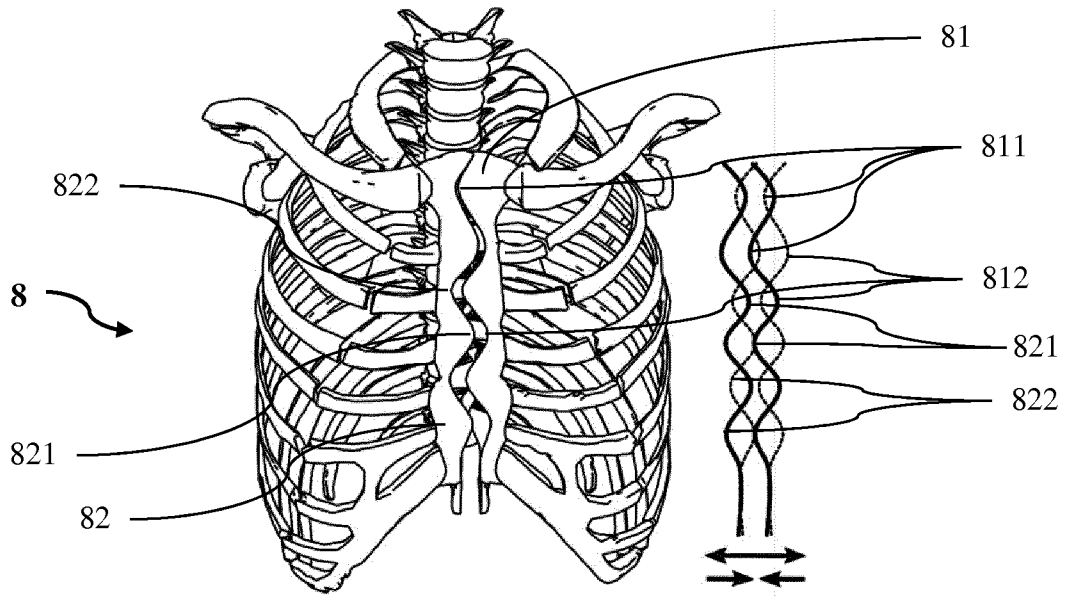

Fig. 13

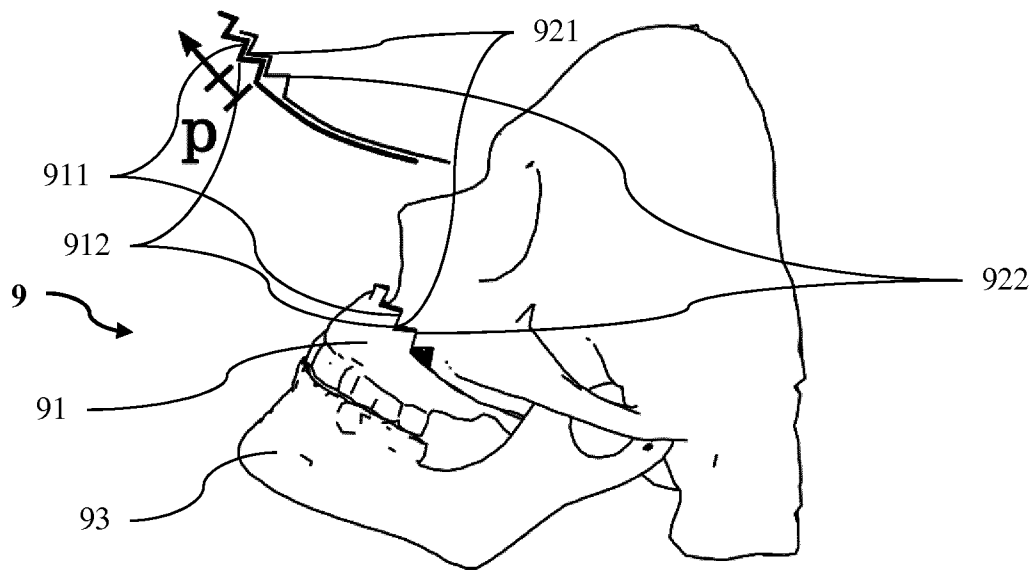

Fig. 14

INTERNATIONAL SEARCH REPORT

International application No
PCT/EP2014/063793

A. CLASSIFICATION OF SUBJECT MATTER
INV. A61B19/00
ADD.

According to International Patent Classification (IPC) or to both national classification and IPC

B. FIELDS SEARCHED
Minimum documentation searched (classification system followed by classification symbols)
A61B

Documentation searched other than minimum documentation to the extent that such documents are included in the fields searched

Electronic data base consulted during the international search (name of data base and, where practicable, search terms used)
EPO-Internal, WPI Data

C. DOCUMENTS CONSIDERED TO BE RELEVANT

Category*	Citation of document, with indication, where appropriate, of the relevant passages	Relevant to claim No.
X	US 2011/082459 A1 (ARAVOT DAN [IL]) 7 April 2011 (2011-04-07) paragraph [0025] - paragraph [0048] claims 1-5	1-11
X	----- CN 202 554 079 U (UNIV ZHEJIANG TECHNOLOGY) 28 November 2012 (2012-11-28) the whole document	1-3,8-11
X	----- US 2012/215227 A1 (FITZPATRICK NOEL [GB] ET AL) 23 August 2012 (2012-08-23) paragraph [0018] - paragraph [0048] paragraph [0116] - paragraph [0117]; figure 23	1,6,7,11
	----- -/--	

Further documents are listed in the continuation of Box C.

See patent family annex.

* Special categories of cited documents :

"A" document defining the general state of the art which is not considered to be of particular relevance	"T" later document published after the international filing date or priority date and not in conflict with the application but cited to understand the principle or theory underlying the invention
"E" earlier application or patent but published on or after the international filing date	"X" document of particular relevance; the claimed invention cannot be considered novel or cannot be considered to involve an inventive step when the document is taken alone
"L" document which may throw doubts on priority claim(s) or which is cited to establish the publication date of another citation or other special reason (as specified)	"Y" document of particular relevance; the claimed invention cannot be considered to involve an inventive step when the document is combined with one or more other such documents, such combination being obvious to a person skilled in the art
"O" document referring to an oral disclosure, use, exhibition or other means	"&" document member of the same patent family
"P" document published prior to the international filing date but later than the priority date claimed	

Date of the actual completion of the international search 16 September 2014	Date of mailing of the international search report 29/09/2014
--	--

Name and mailing address of the ISA/ European Patent Office, P.B. 5818 Patentlaan 2 NL - 2280 HV Rijswijk Tel. (+31-70) 340-2040, Fax: (+31-70) 340-3016	Authorized officer Roudaut, Tanguy
--	---

INTERNATIONAL SEARCH REPORT

International application No
PCT/EP2014/063793

C(Continuation). DOCUMENTS CONSIDERED TO BE RELEVANT		
Category*	Citation of document, with indication, where appropriate, of the relevant passages	Relevant to claim No.
A	US 6 485 495 B1 (JENKINSON EDWIN O [US]) 26 November 2002 (2002-11-26) paragraph [0080] - paragraph [0091]; figures 5-13 -----	1-10
A	US 4 433 681 A (COMPARETTO JOHN E [US]) 28 February 1984 (1984-02-28) the whole document -----	1-10

INTERNATIONAL SEARCH REPORT

International application No.
PCT/EP2014/063793

Box No. II Observations where certain claims were found unsearchable (Continuation of item 2 of first sheet)

This international search report has not been established in respect of certain claims under Article 17(2)(a) for the following reasons:

1. Claims Nos.: 12-16
because they relate to subject matter not required to be searched by this Authority, namely:
Rule 39.1(iv) PCT - Method for treatment of the human or animal body by surgery
2. Claims Nos.:
because they relate to parts of the international application that do not comply with the prescribed requirements to such an extent that no meaningful international search can be carried out, specifically:
3. Claims Nos.:
because they are dependent claims and are not drafted in accordance with the second and third sentences of Rule 6.4(a).

Box No. III Observations where unity of invention is lacking (Continuation of item 3 of first sheet)

This International Searching Authority found multiple inventions in this international application, as follows:

1. As all required additional search fees were timely paid by the applicant, this international search report covers all searchable claims.
2. As all searchable claims could be searched without effort justifying an additional fees, this Authority did not invite payment of additional fees.
3. As only some of the required additional search fees were timely paid by the applicant, this international search report covers only those claims for which fees were paid, specifically claims Nos.:
4. No required additional search fees were timely paid by the applicant. Consequently, this international search report is restricted to the invention first mentioned in the claims; it is covered by claims Nos.:

Remark on Protest

- The additional search fees were accompanied by the applicant's protest and, where applicable, the payment of a protest fee.
- The additional search fees were accompanied by the applicant's protest but the applicable protest fee was not paid within the time limit specified in the invitation.
- No protest accompanied the payment of additional search fees.

INTERNATIONAL SEARCH REPORT

Information on patent family members

International application No

PCT/EP2014/063793

Patent document cited in search report	Publication date	Patent family member(s)	Publication date
US 2011082459	A1	07-04-2011	NONE
		AU 2008246938 A1	13-11-2008
		EP 2306887 A2	13-04-2011
		JP 2011519659 A	14-07-2011
		US 2011082459 A1	07-04-2011
		WO 2008136001 A2	13-11-2008

CN 202554079	U	28-11-2012	NONE

US 2012215227	A1	23-08-2012	NONE

US 6485495	B1	26-11-2002	NONE
		AU 4814800 A	05-12-2000
		CA 2373608 A1	23-11-2000
		US 6485495 B1	26-11-2002
		WO 0069347 A1	23-11-2000

US 4433681	A	28-02-1984	NONE
