



US 20180275865A1

(19) **United States**

(12) **Patent Application Publication**
Fröjdh et al.

(10) **Pub. No.: US 2018/0275865 A1**
(43) **Pub. Date: Sep. 27, 2018**

(54) **LIGHT-BASED TOUCH CONTROLS ON A STEERING WHEEL AND DASHBOARD**

(71) Applicant: **Neonode Inc.**, San Jose, CA (US)

(72) Inventors: **Gunnar Martin Fröjdh**, Dalaro (SE); **Simon Fellin**, Floda (SE); **Thomas Eriksson**, Stockholm (SE); **John Karlsson**, Marsta (SE); **Maria Hedlin**, Sollentuna (SE); **Richard Berglind**, Alvsjö (SE)

(21) Appl. No.: **15/992,162**

(22) Filed: **May 29, 2018**

Related U.S. Application Data

(63) Continuation of application No. 15/190,705, filed on Jun. 23, 2016, now Pat. No. 10,007,422, which is a continuation of application No. 14/551,096, filed on Nov. 24, 2014, now Pat. No. 9,389,710, which is a continuation of application No. 14/312,711, filed on Jun. 24, 2014, now Pat. No. 8,918,252, which is a continuation of application No. 14/088,458, filed on Nov. 25, 2013, now Pat. No. 8,775,023, which is a continuation-in-part of application No. 13/854,074, filed on Mar. 30, 2013, now Pat. No. 8,810,551, which is a continuation-in-part of application No. 13/775,269, filed on Feb. 25, 2013, now Pat. No. 8,917,239, which is a continuation-in-part of application No. 13/424,543, filed on Mar. 20, 2012, now Pat. No. 9,052,777, said application No. 13/854,074 is a continuation of application No. 13/424,592, filed on Mar. 20, 2012, now Pat. No. 8,416,217, said application No. 13/775,269 is a continuation-in-part of application No. 13/732,456, filed on Jan. 2, 2013, now Pat. No. 8,643,628, which is a continuation-in-part of application No. PCT/US11/29191, filed on Mar. 21, 2011, which is a continuation-in-part of application No. 12/371,609, filed on Feb. 15, 2009, now Pat. No. 8,339,379, which is a continuation-in-part of application No. 12/760,567, filed on Apr. 15, 2010, now Pat. No. 9,213,443, which is a continuation-in-part of application No. 12/760,568, filed on Apr. 15, 2010, now abandoned.

(60) Provisional application No. 61/730,139, filed on Nov. 27, 2012, provisional application No. 61/564,868, filed on Nov. 30, 2011, provisional application No. 61/564,164, filed on Nov. 28, 2011, provisional ap-

plication No. 61/379,012, filed on Sep. 1, 2010, provisional application No. 61/380,600, filed on Sep. 7, 2010, provisional application No. 61/410,930, filed on Nov. 7, 2010, provisional application No. 61/169,779, filed on Apr. 16, 2009.

Publication Classification

- (51) **Int. Cl.**
 - G06F 3/0488* (2013.01)
 - B60K 37/06* (2006.01)
 - G06F 3/042* (2006.01)
 - H04N 21/422* (2011.01)
 - B60R 16/037* (2006.01)
 - G06F 3/01* (2006.01)
 - G01C 21/36* (2006.01)
 - G06F 3/0362* (2013.01)
 - H04M 1/725* (2006.01)
 - G06F 3/03* (2006.01)
 - B62D 1/04* (2006.01)
 - G06F 3/033* (2013.01)
 - G06F 3/041* (2006.01)

- (52) **U.S. Cl.**
 - CPC *G06F 3/04883* (2013.01); *H04M 2250/22* (2013.01); *G06F 3/0421* (2013.01); *H04N 21/42201* (2013.01); *B60R 16/037* (2013.01); *G06F 3/017* (2013.01); *G01C 21/3664* (2013.01); *G06F 3/0362* (2013.01); *H04M 1/72583* (2013.01); *G06F 3/0304* (2013.01); *B62D 1/046* (2013.01); *B60K 2350/1012* (2013.01); *B60K 2350/1036* (2013.01); *B60K 2350/928* (2013.01); *G06F 3/033* (2013.01); *G06F 3/041* (2013.01); *G06F 2203/04808* (2013.01); *B60K 37/06* (2013.01)

(57) **ABSTRACT**

An adjustable mirror, including a mirror within a fixed housing, whereby at least one angle of the mirror relative to the housing is adjustable, electrical equipment within the housing and attached to the rear of the mirror, operative to adjust the at least one angle of the mirror, a rounded surface projecting toward an operator of the mirror, and a sensor, connected to the electrical equipment, operative to detect the operator's hand following the rounded surface, and to instruct the electrical equipment to adjust the at least one angle of the mirror in response to the detection.

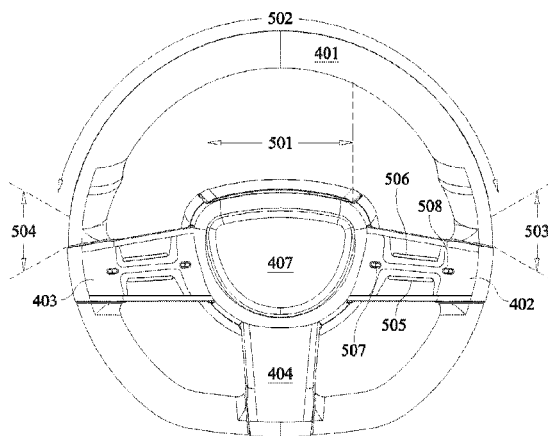

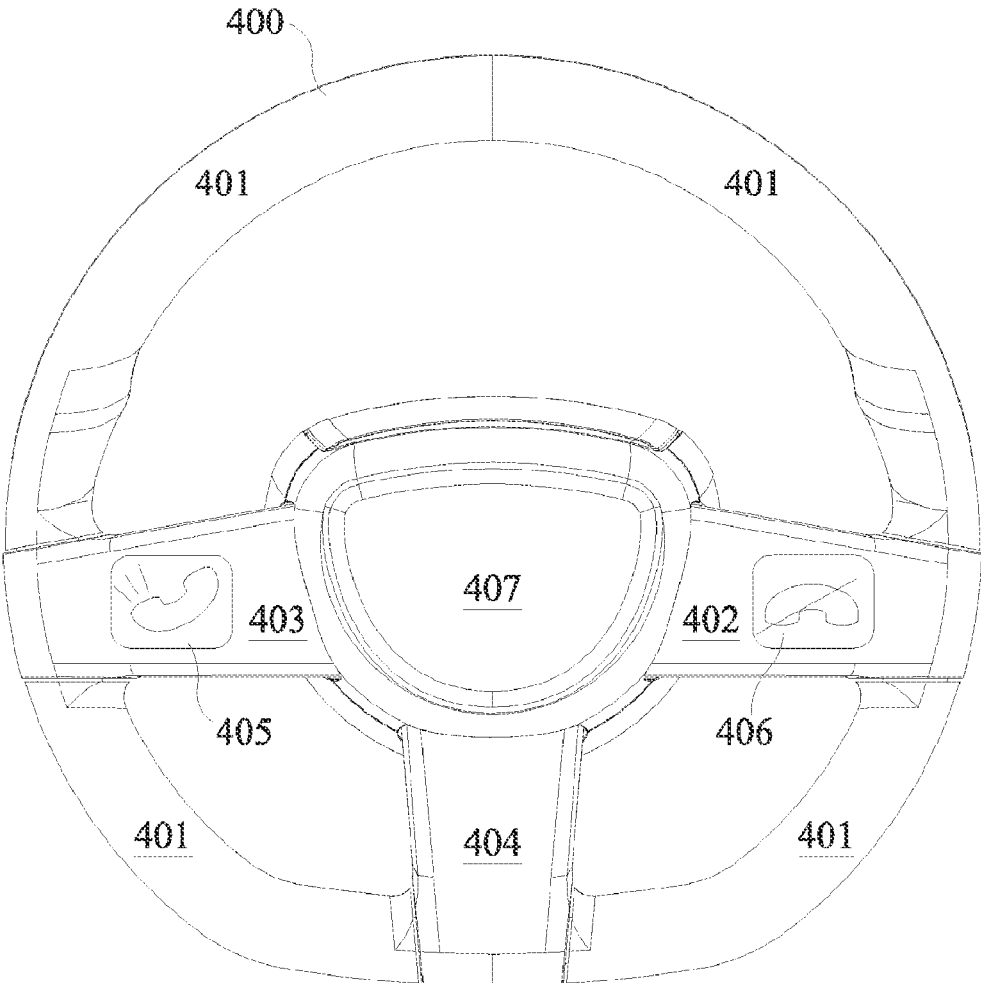

FIG. 1
(PRIOR ART)

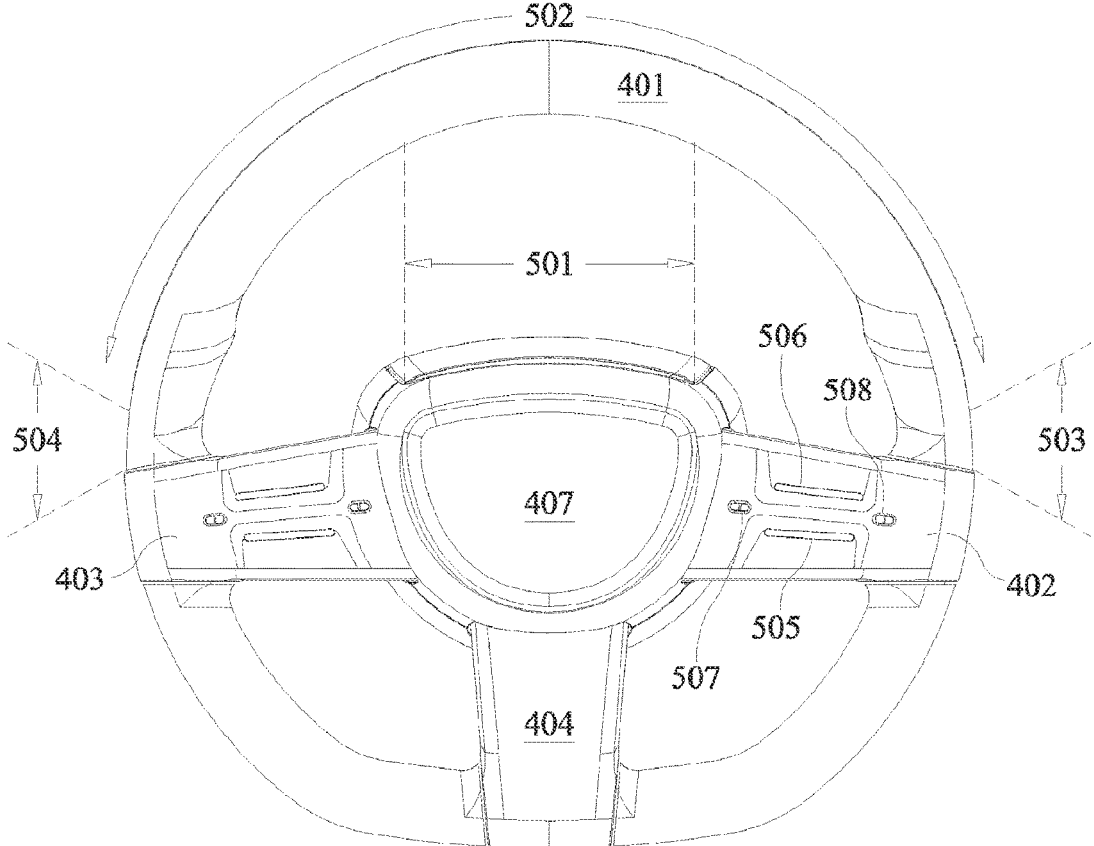

FIG. 2

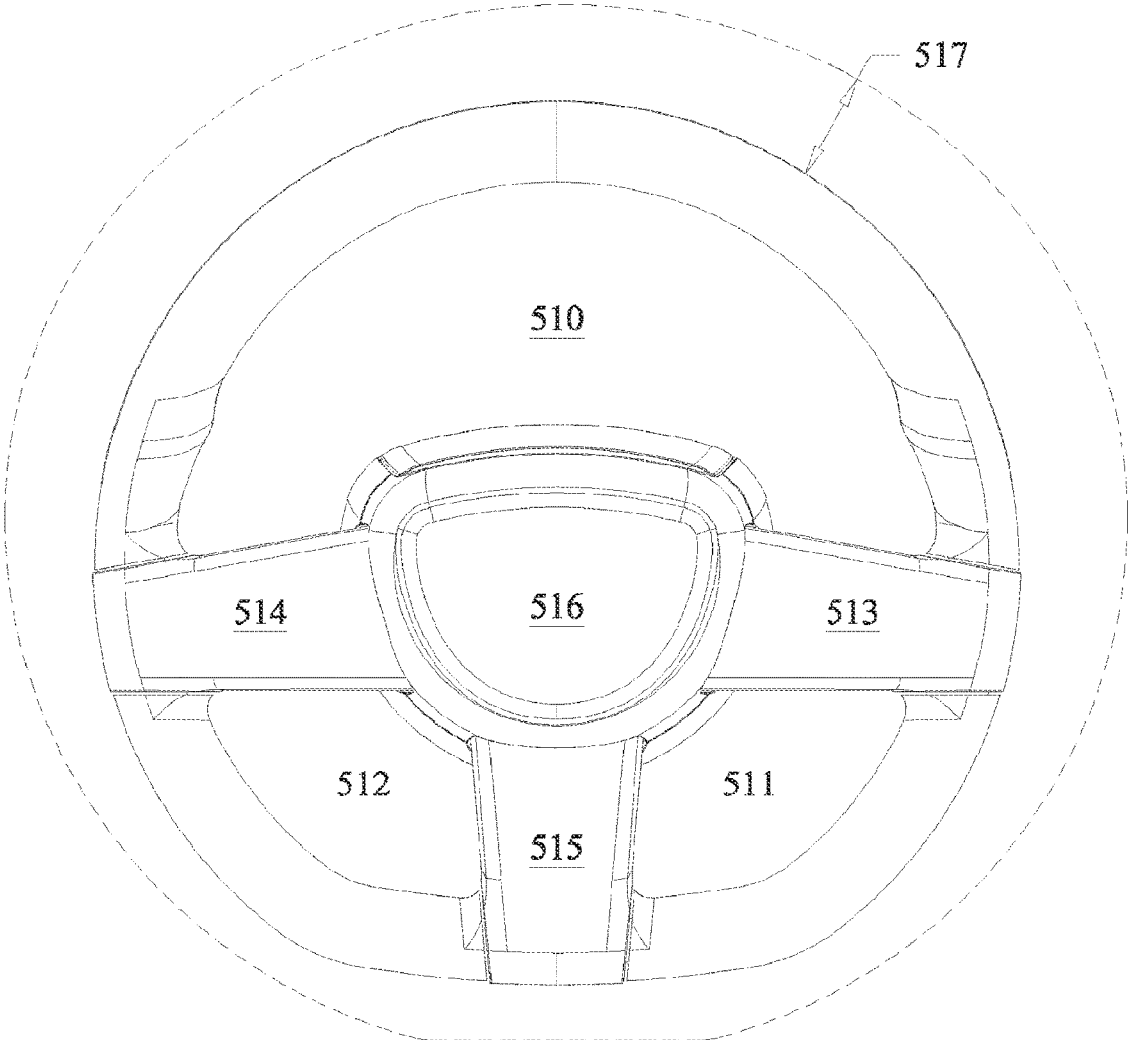

FIG. 3

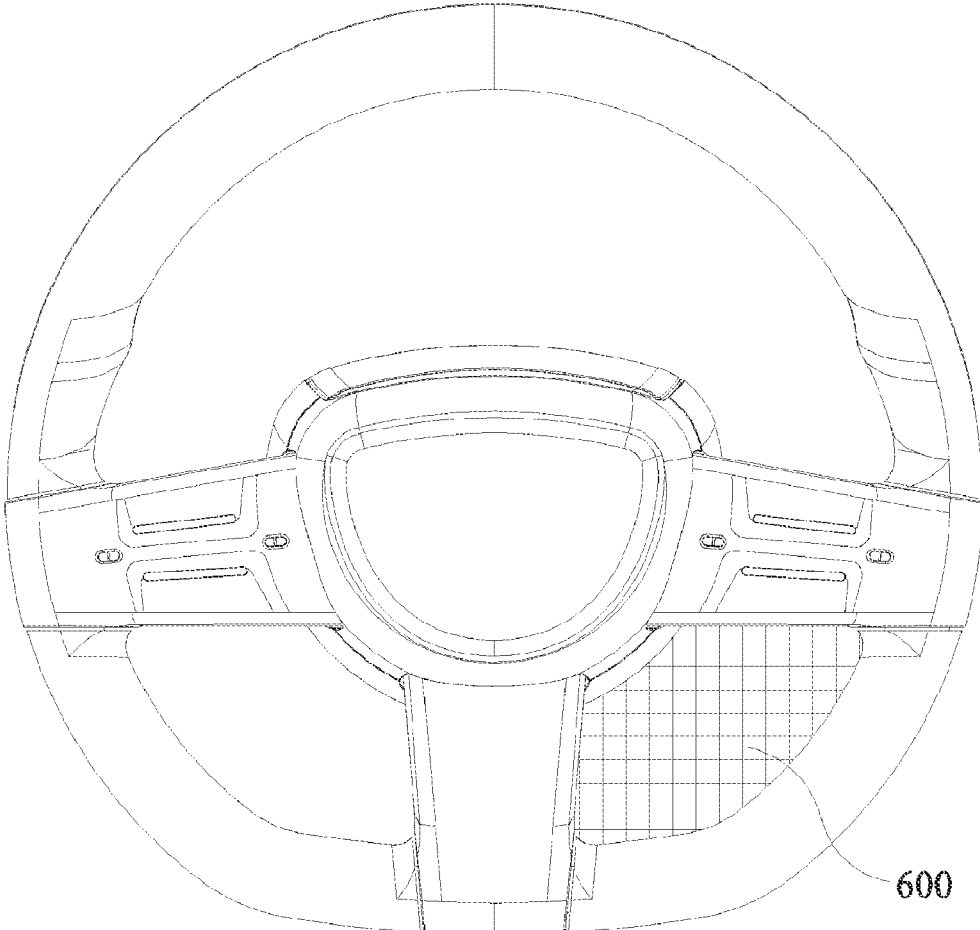

FIG. 4

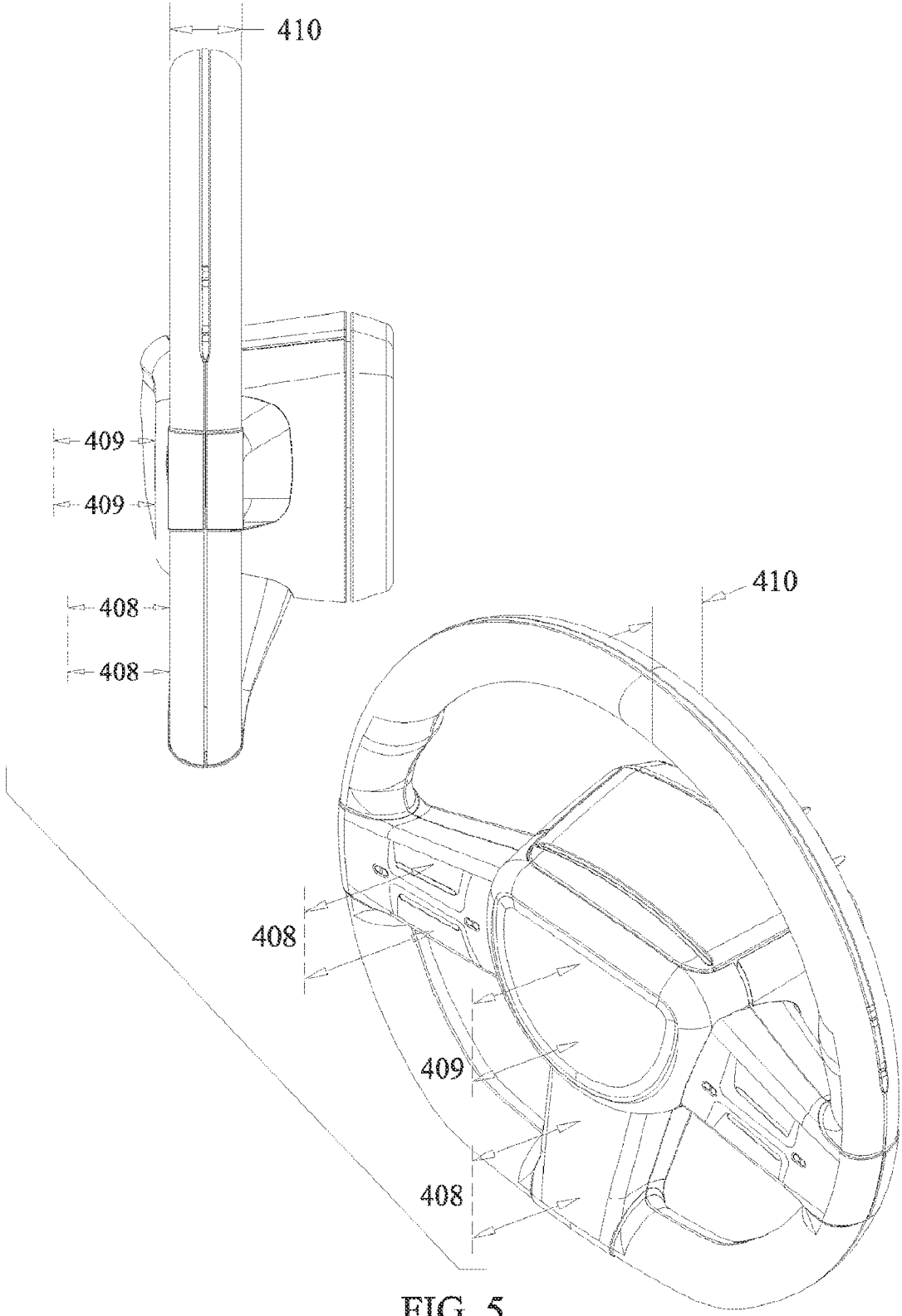

FIG. 5

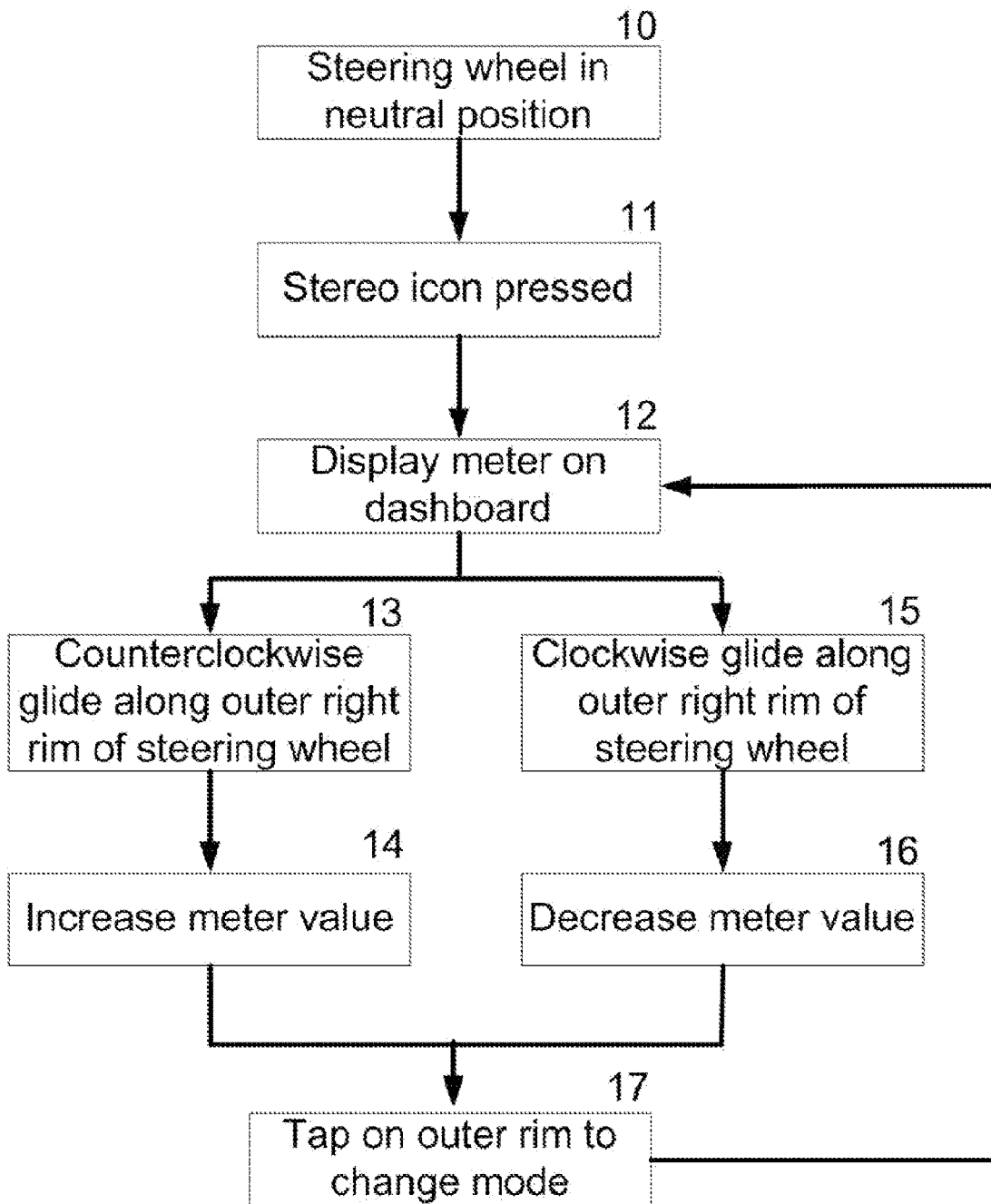

FIG. 6

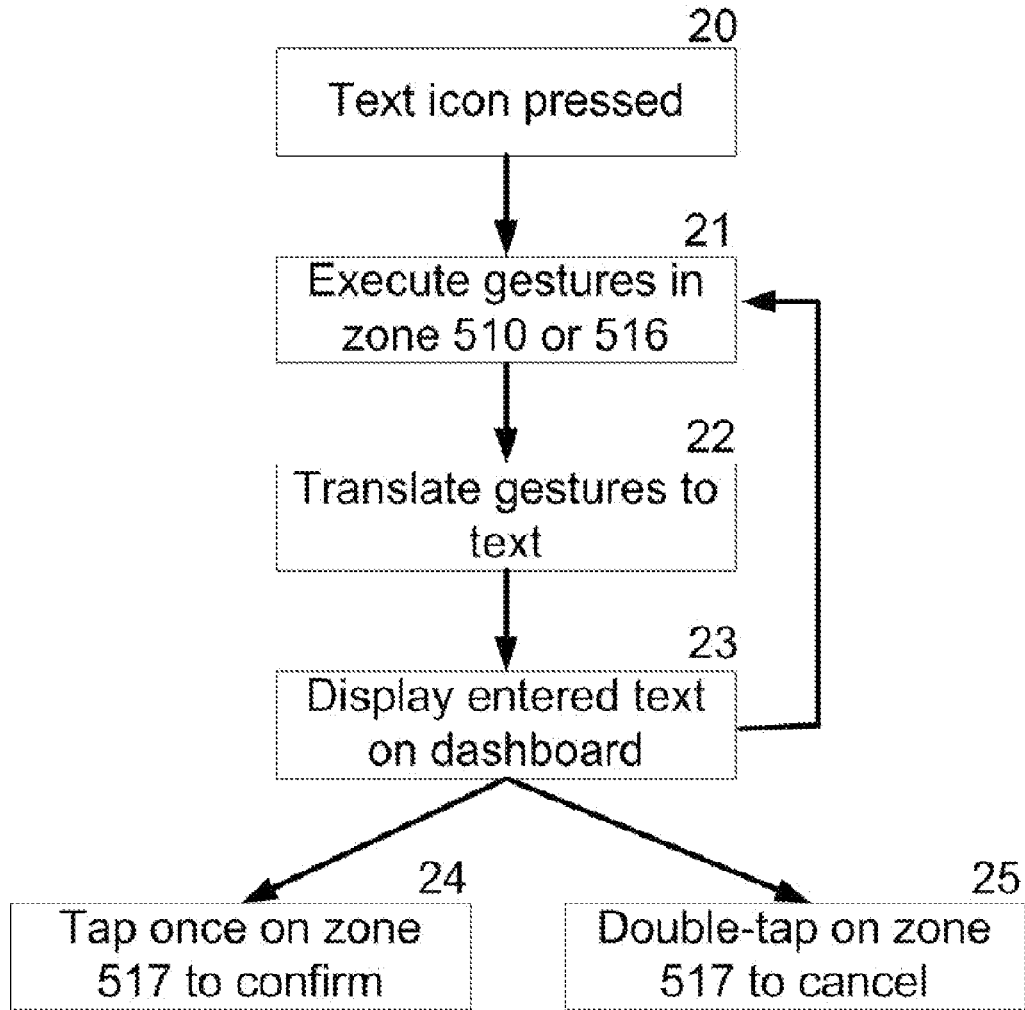

FIG. 7

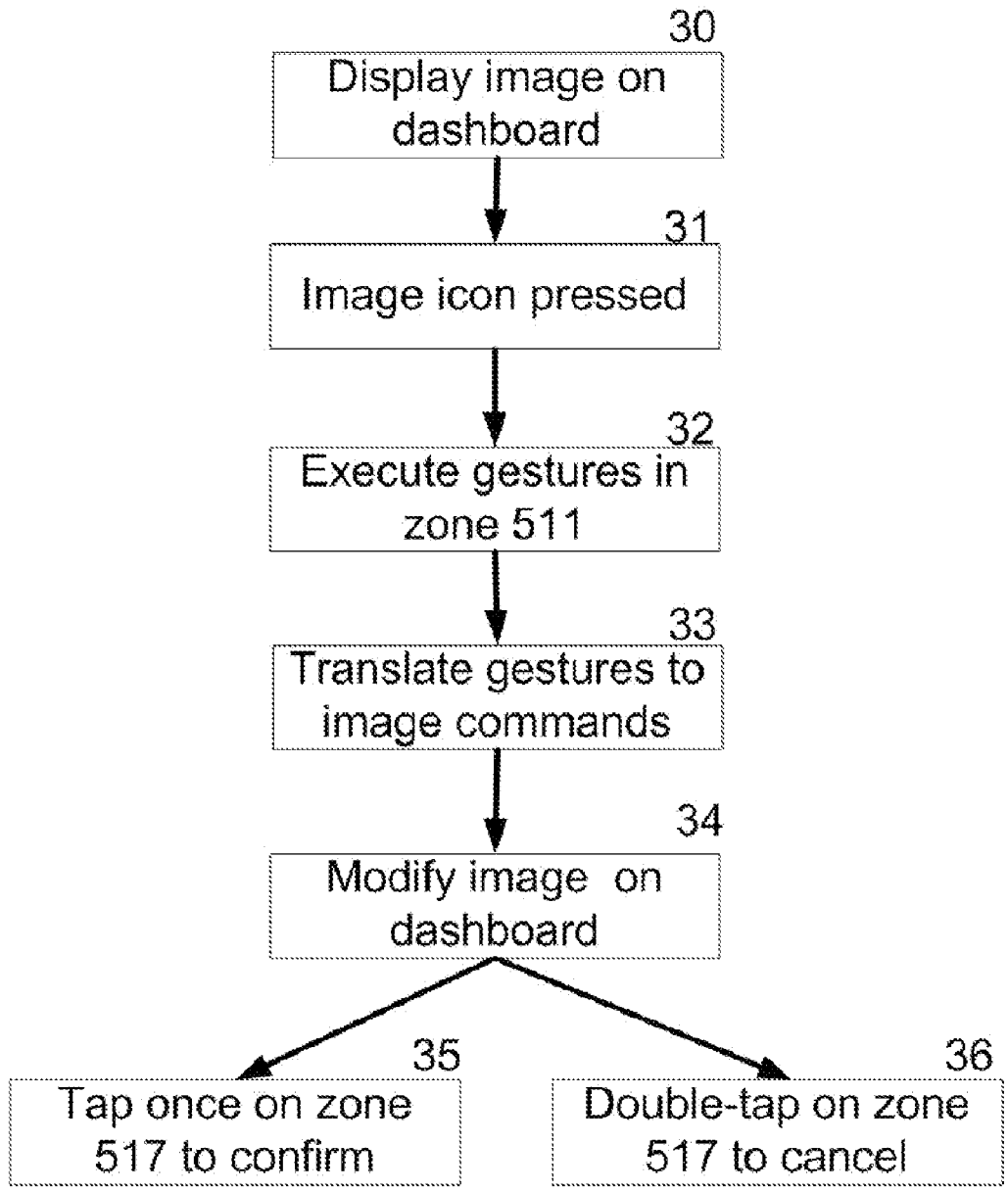

FIG. 8

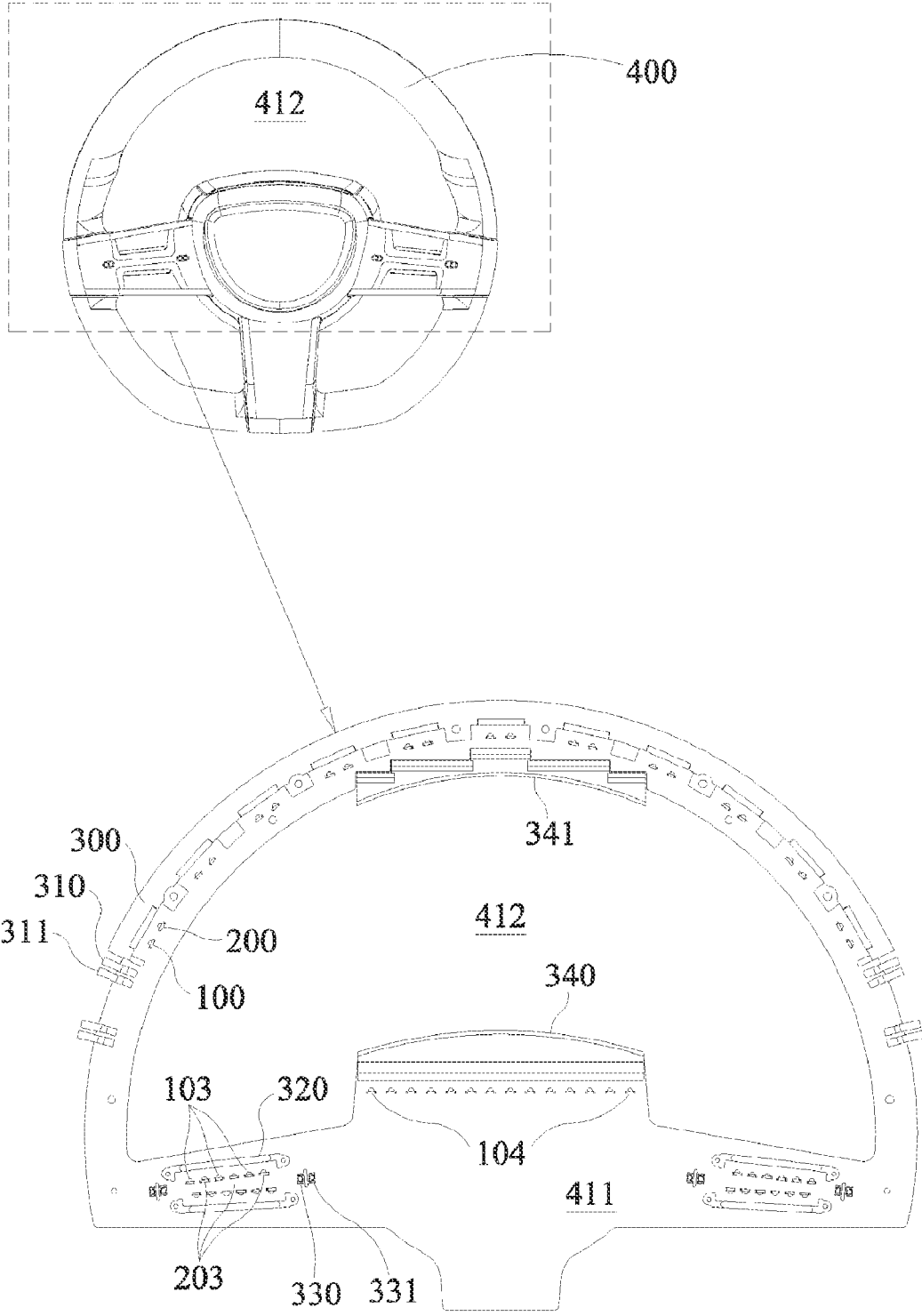

FIG. 9

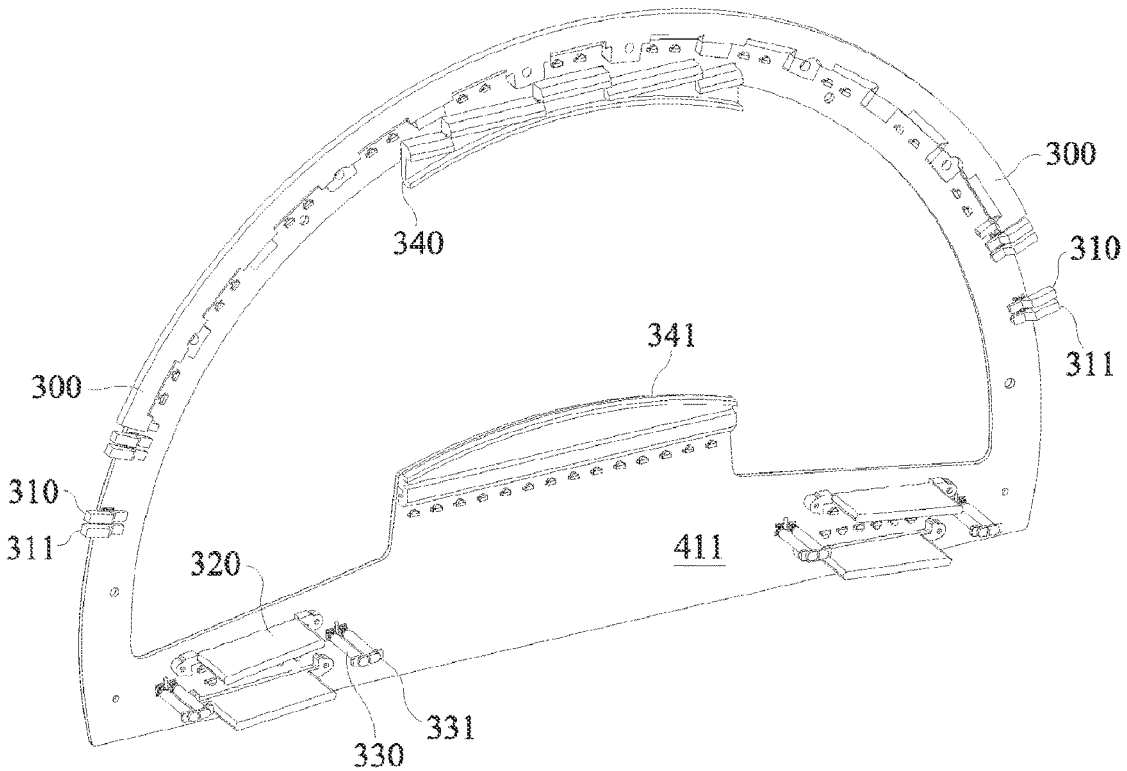

FIG. 10

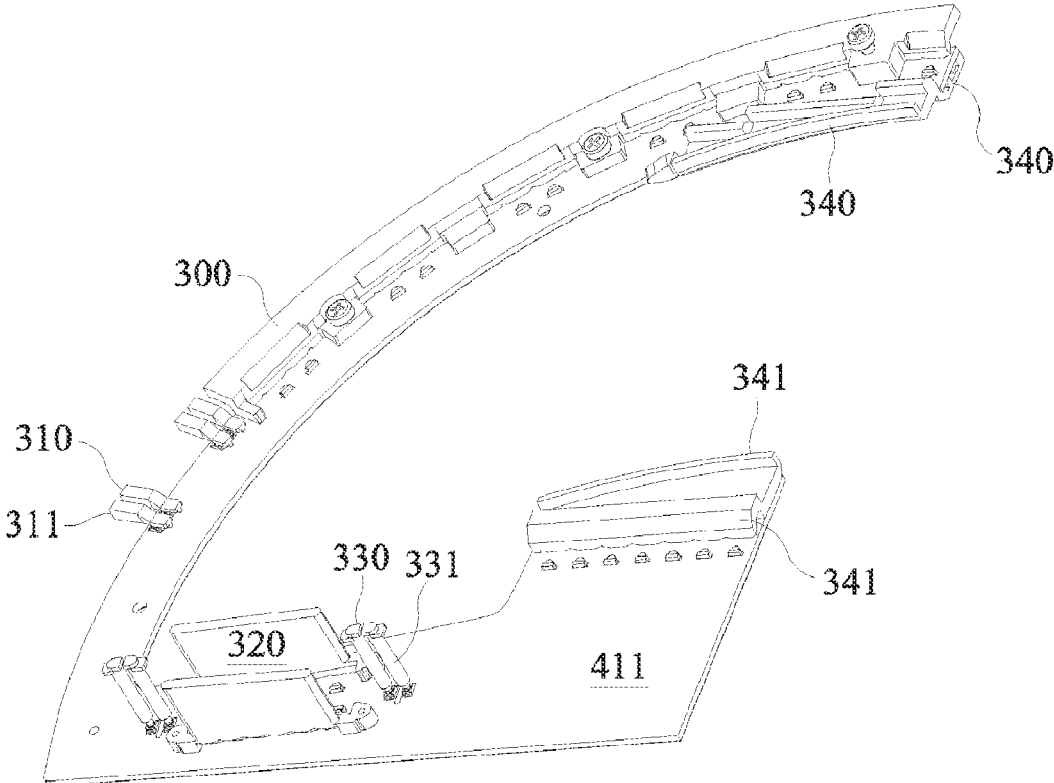

FIG. 11

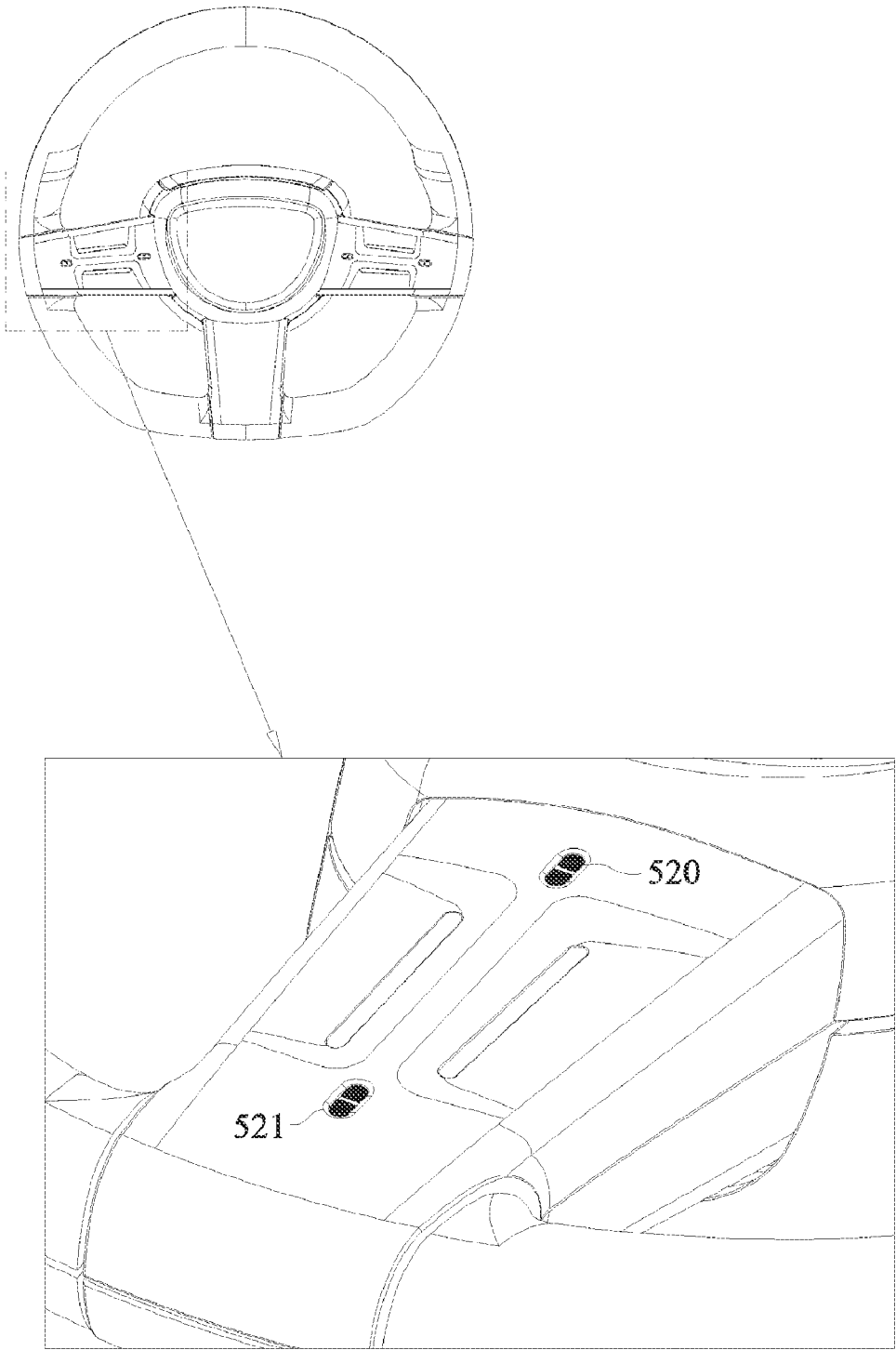

FIG. 12

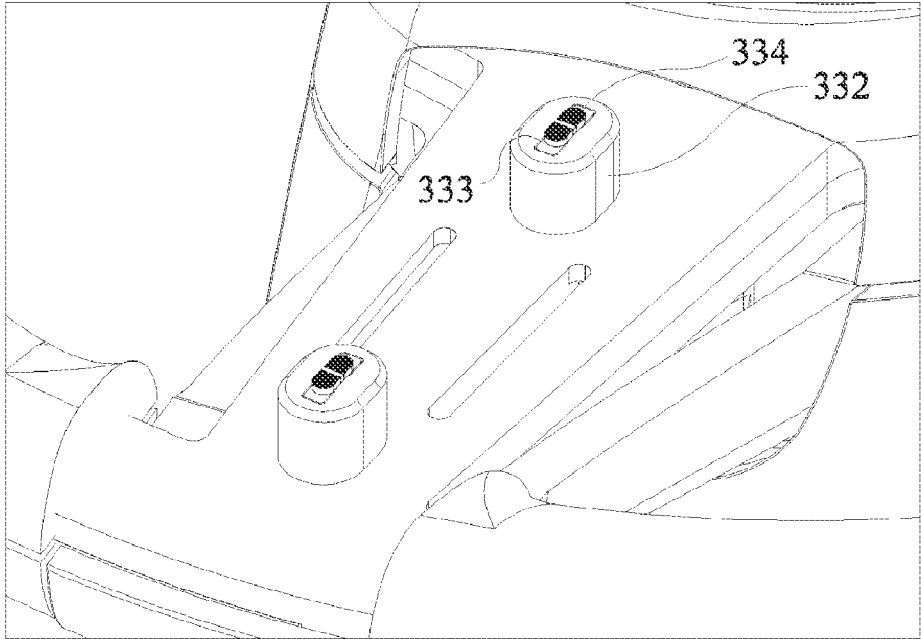
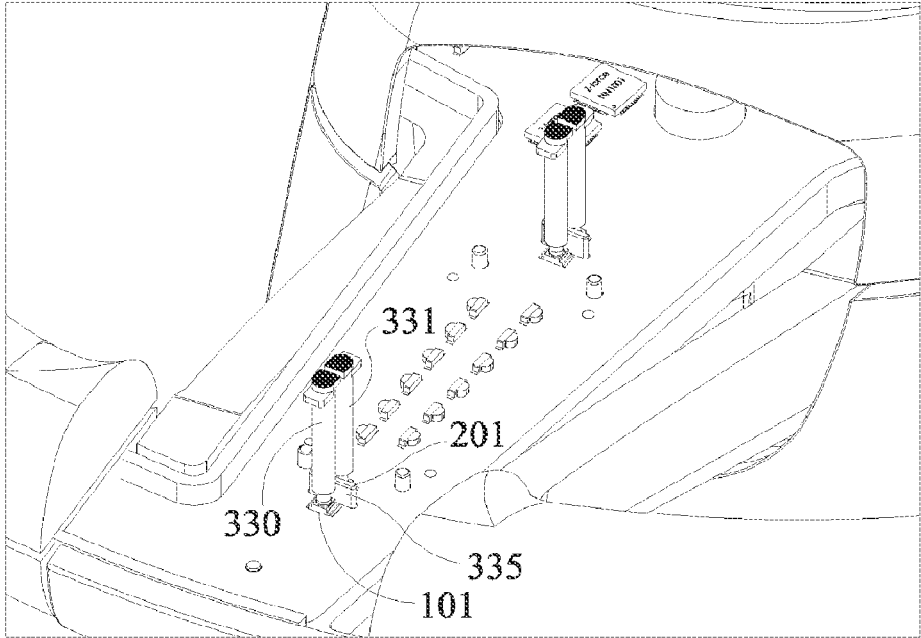

FIG. 13



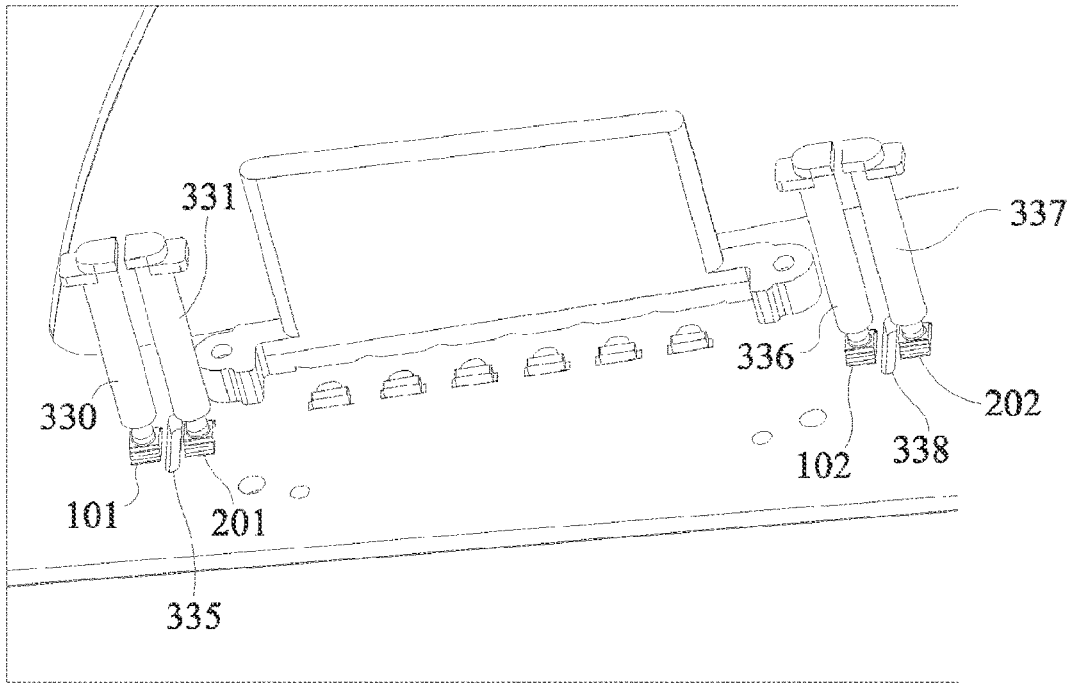

FIG. 15

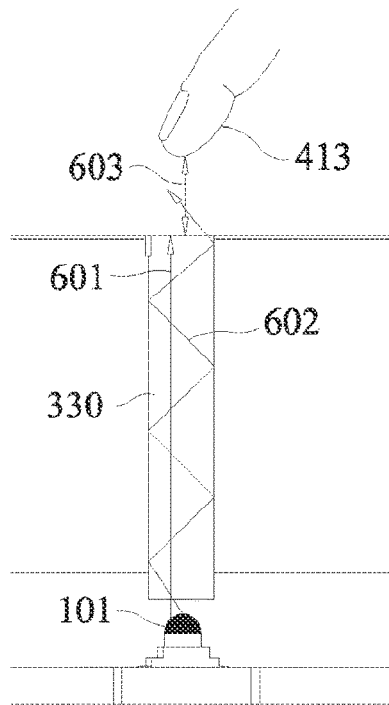

FIG. 16

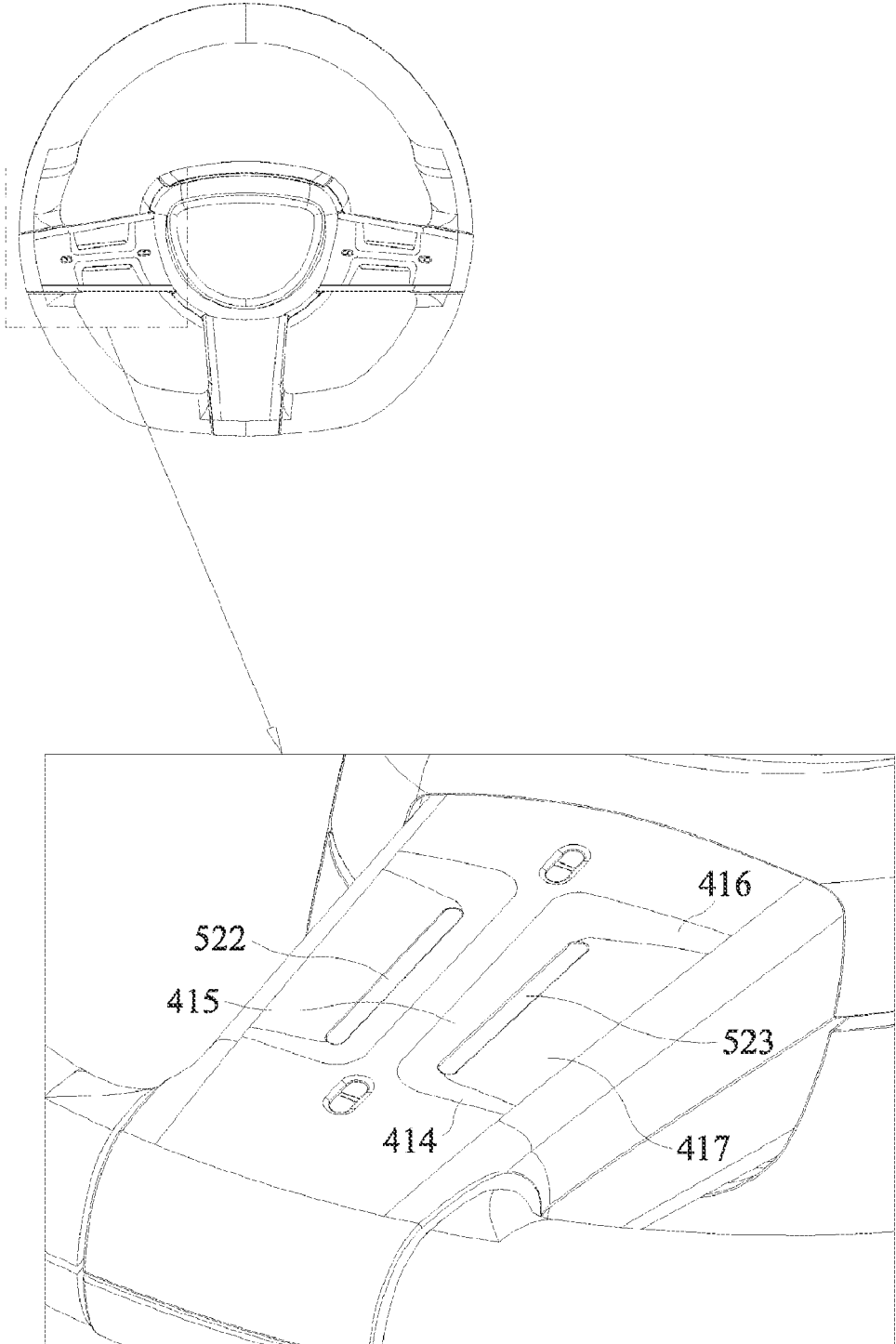

FIG. 17

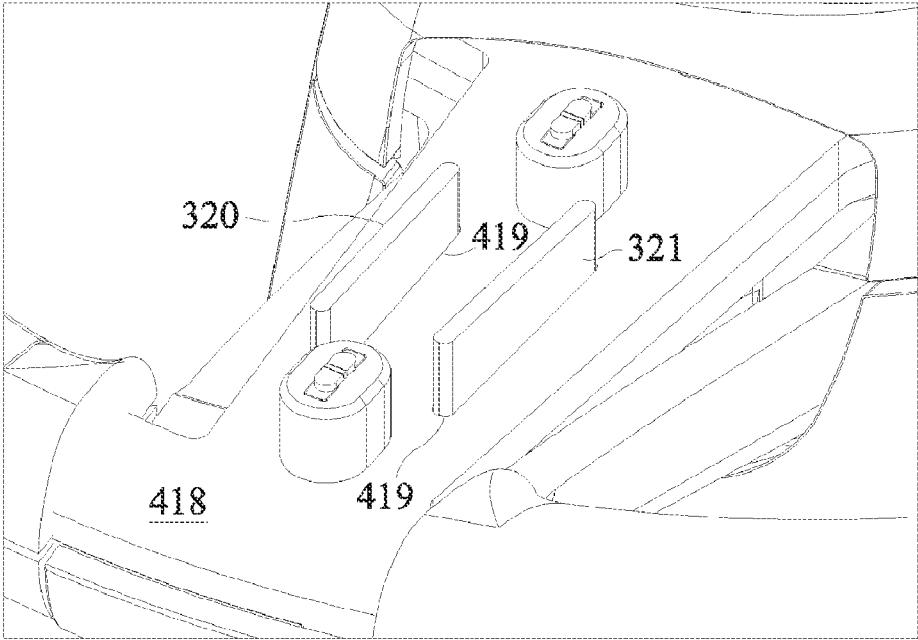

FIG. 18

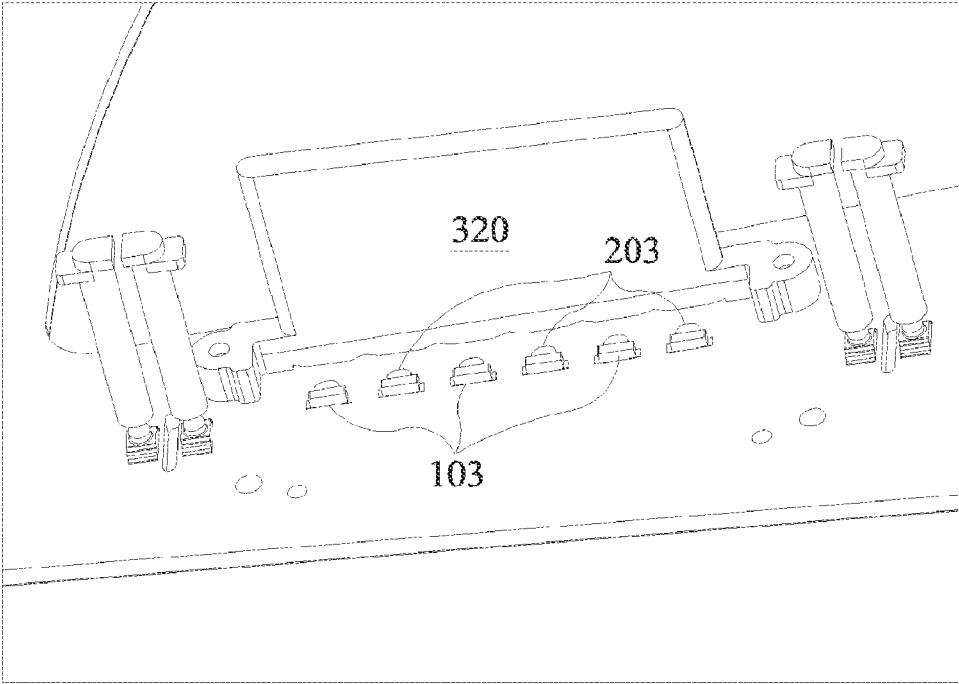

FIG. 19

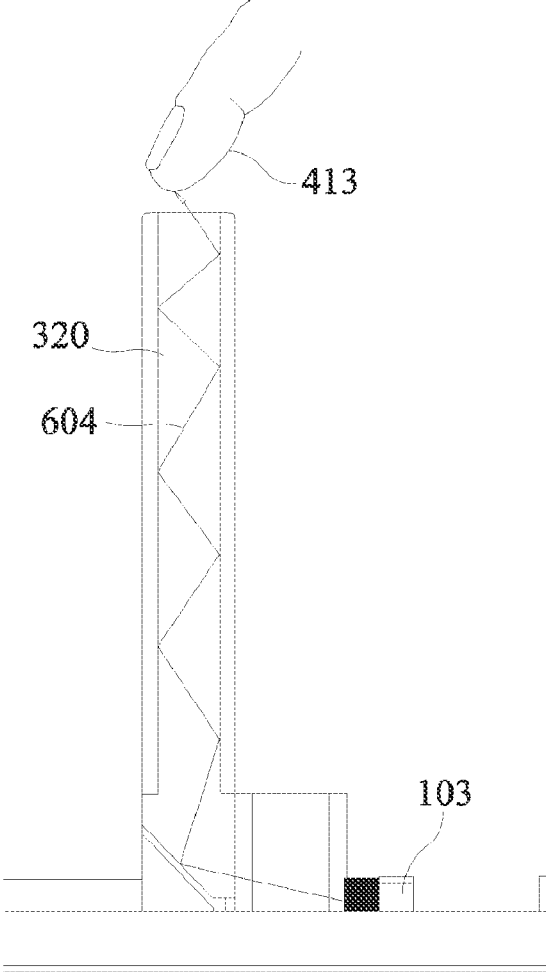

FIG. 20

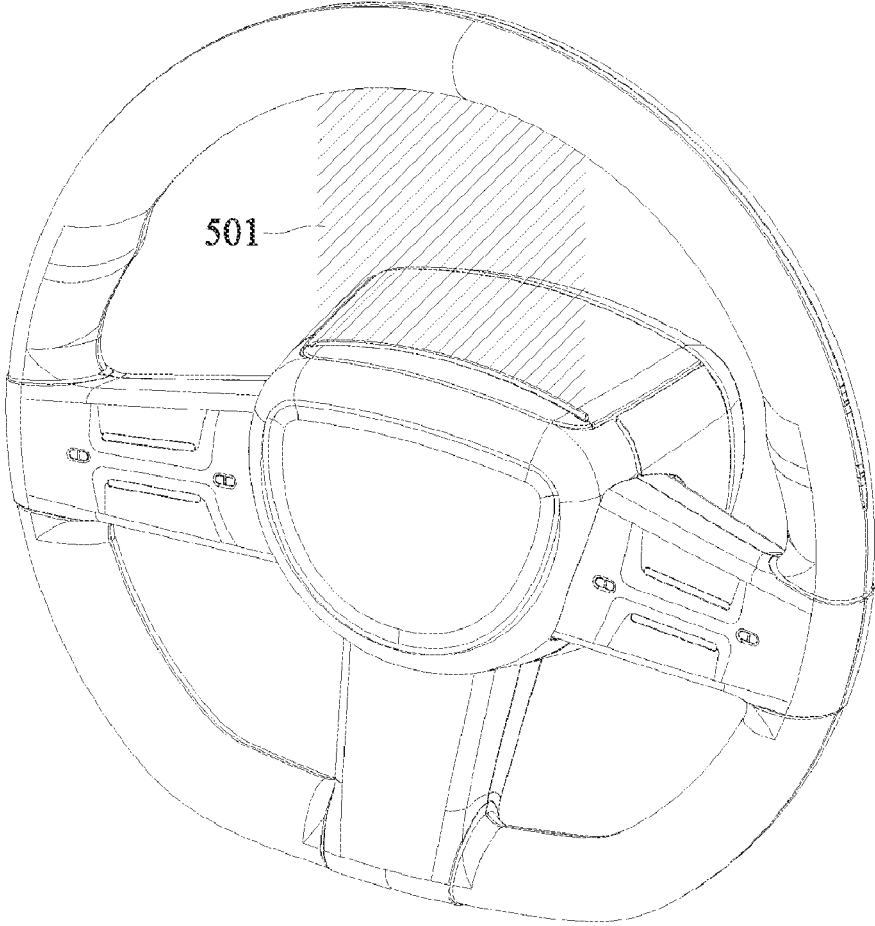

FIG. 21

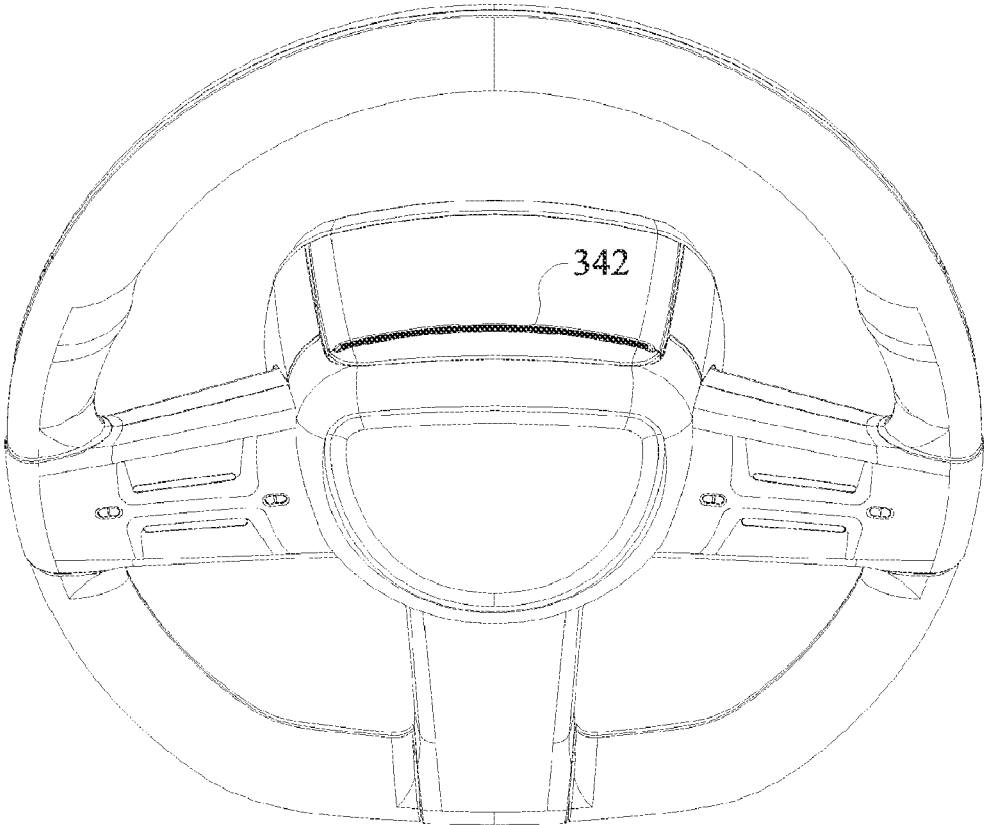

FIG. 22

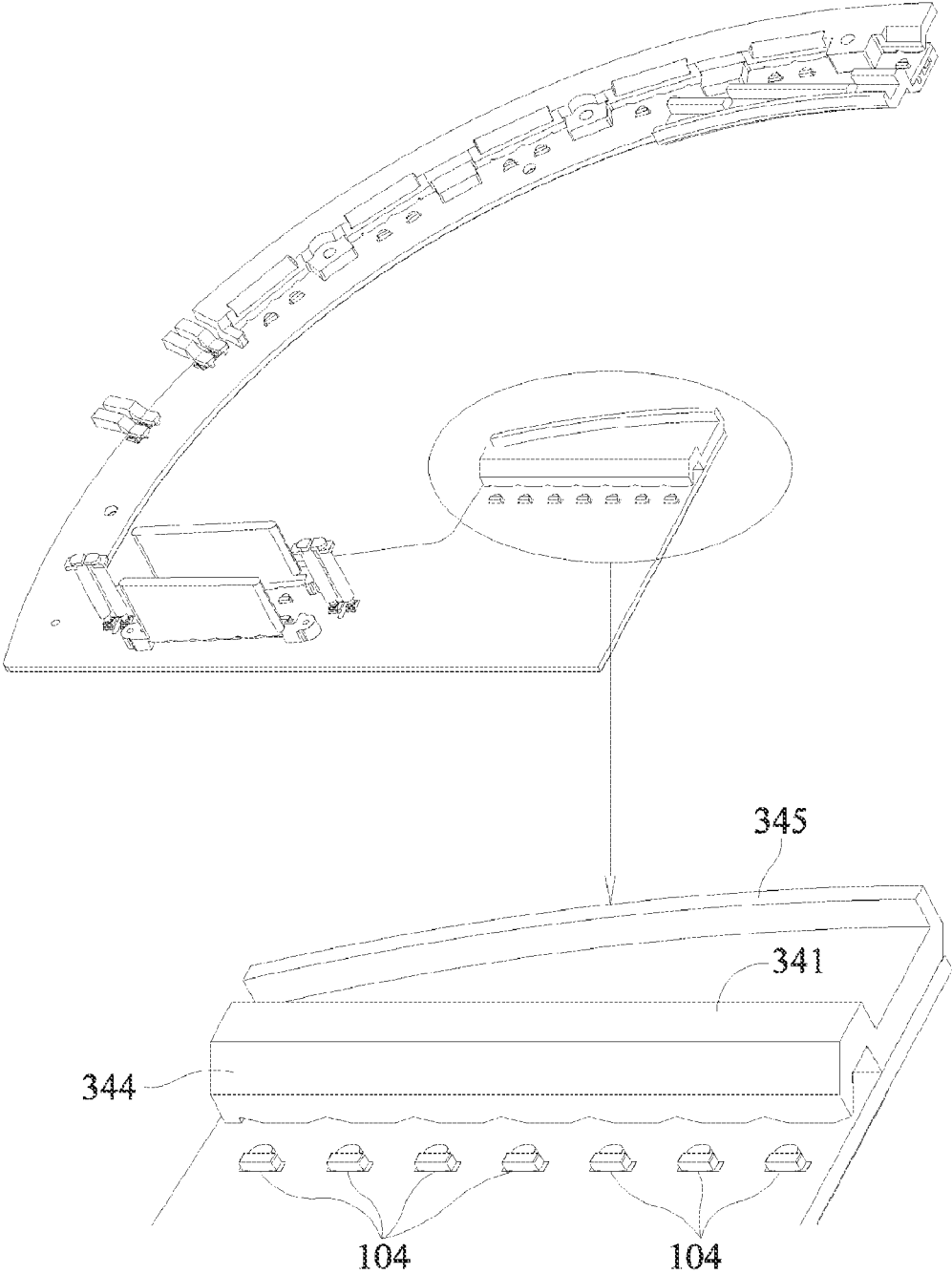

FIG. 23

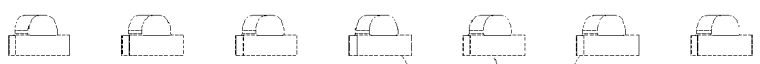
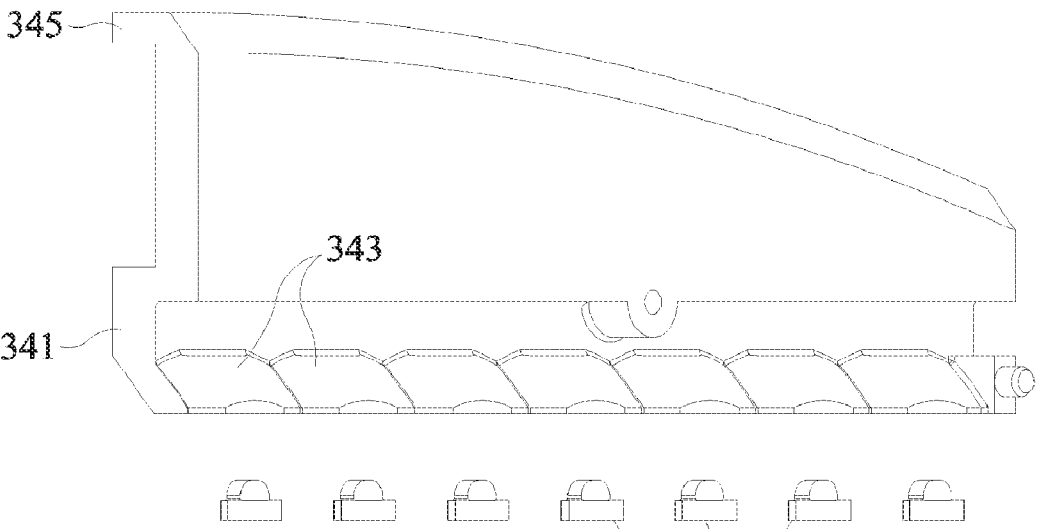

FIG. 24 104

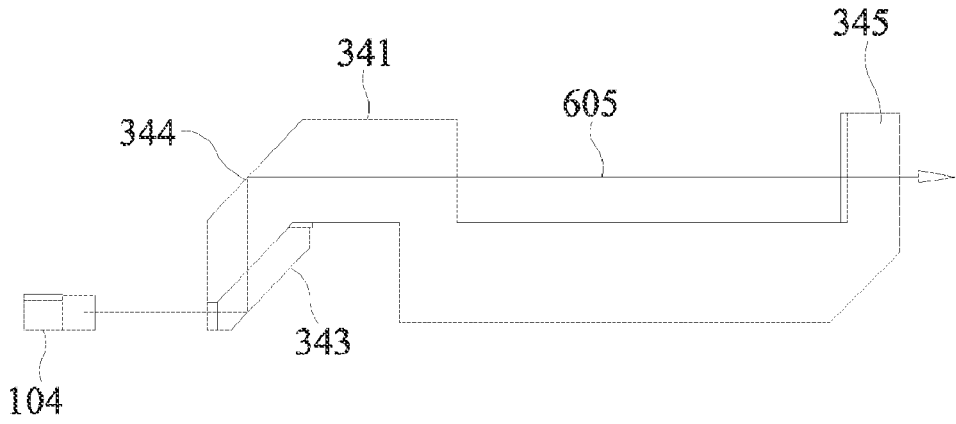

FIG. 25

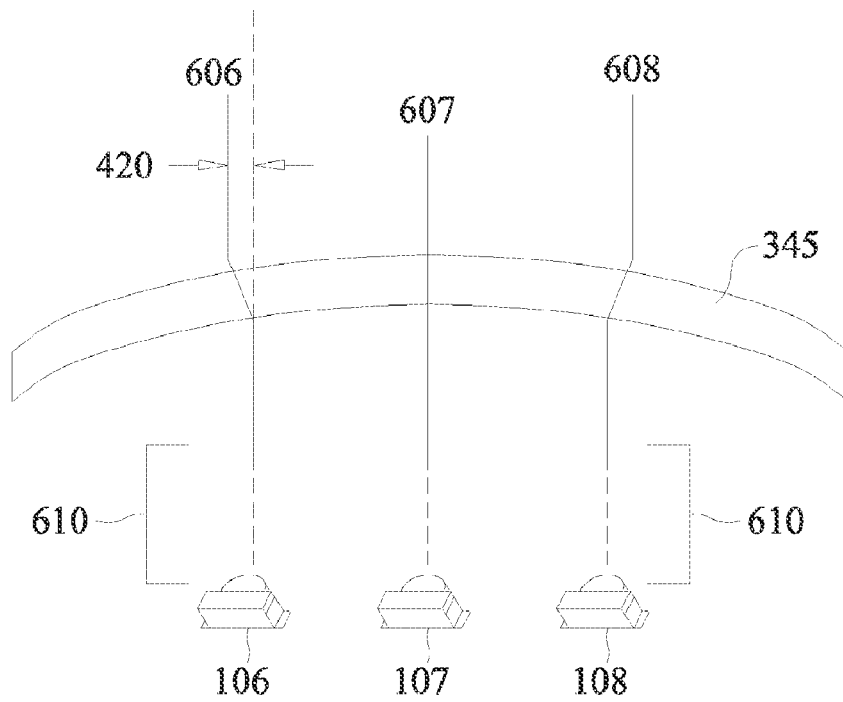

FIG. 26

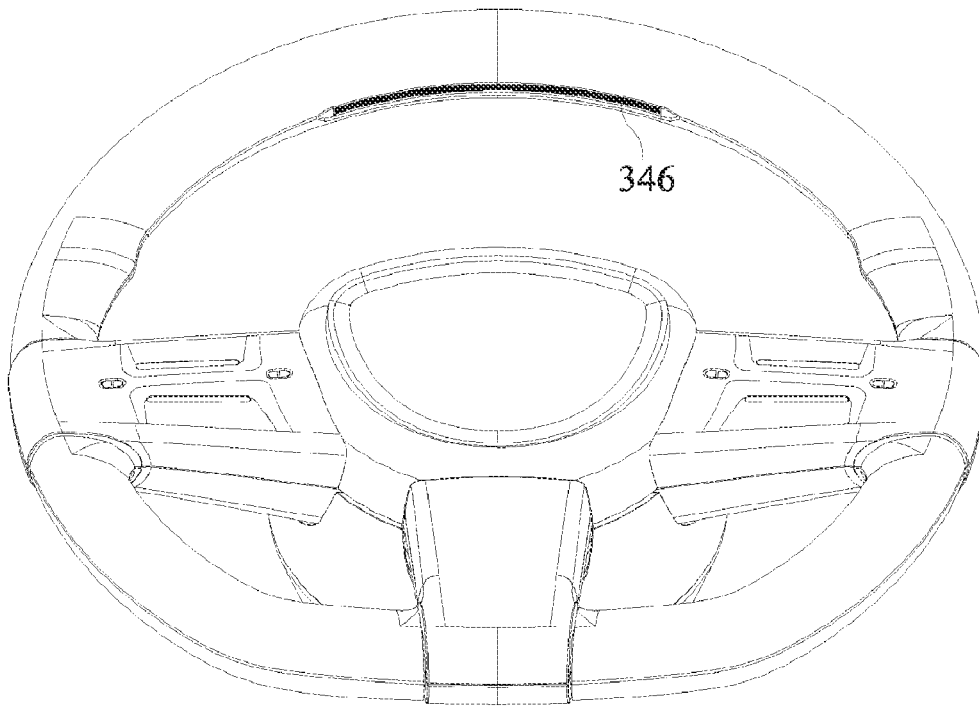

FIG. 27

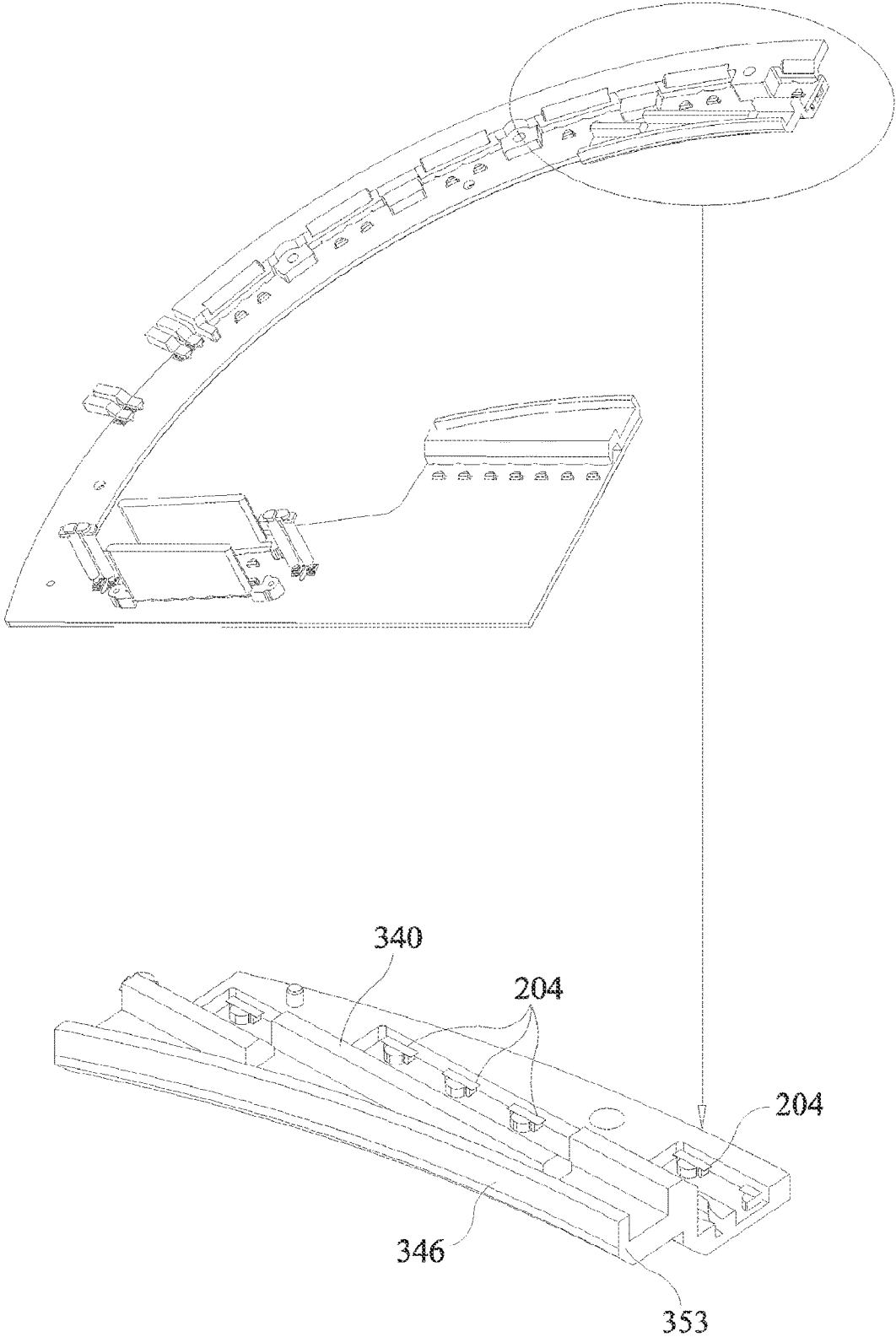

FIG. 28

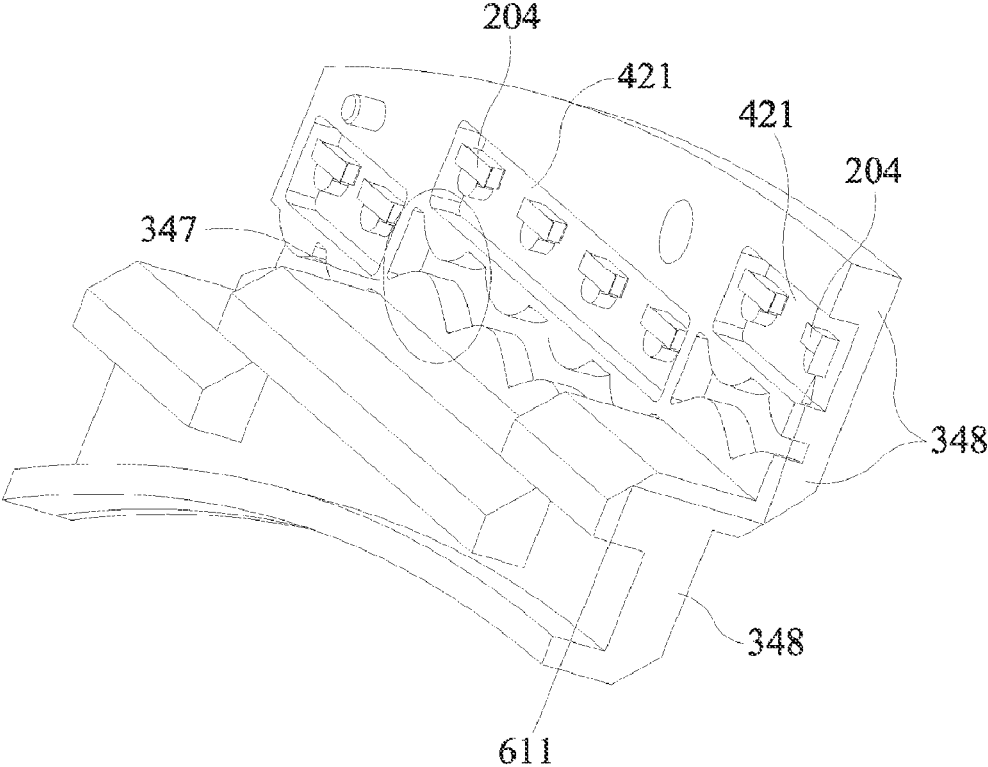

FIG. 29

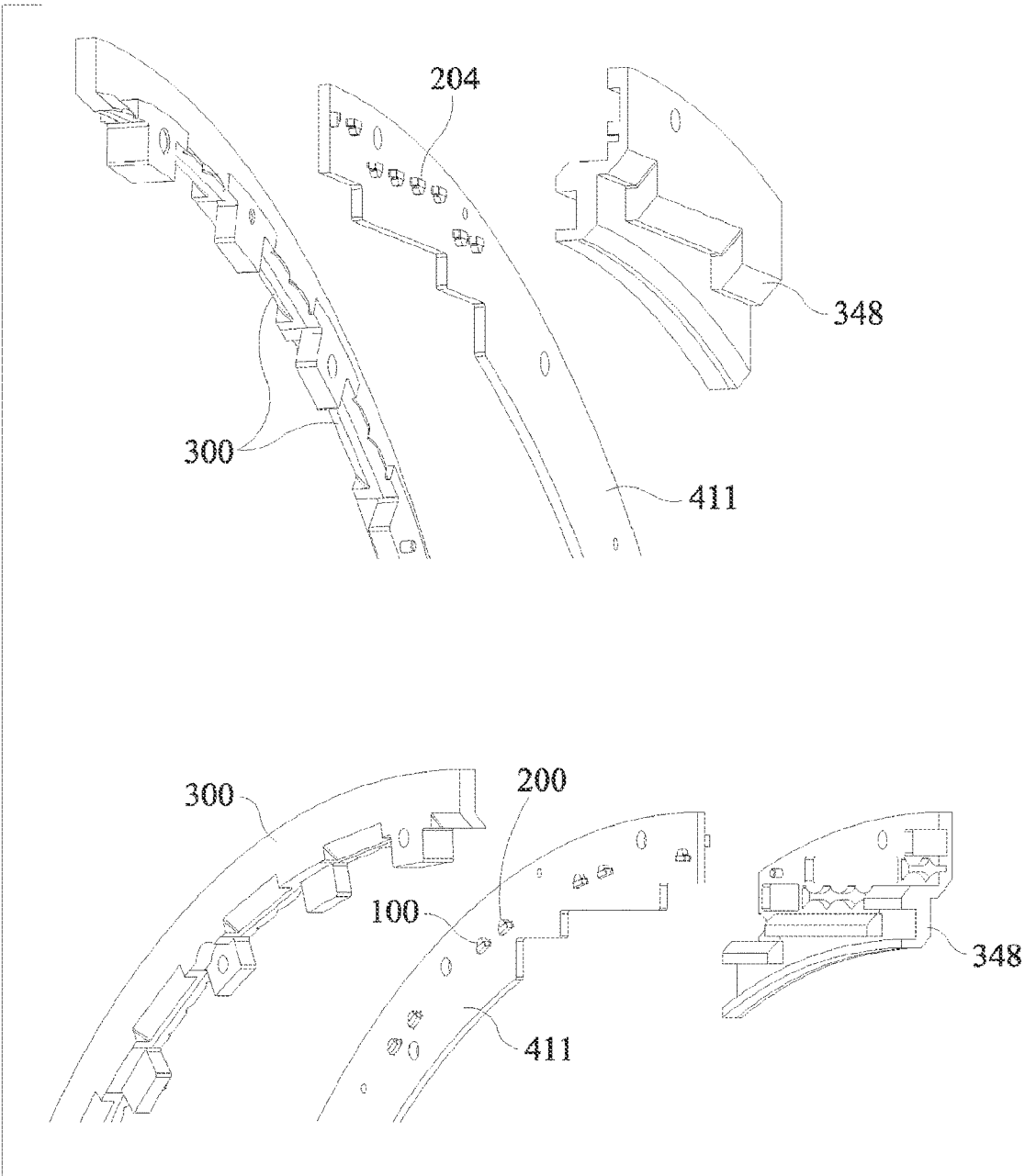

FIG. 30

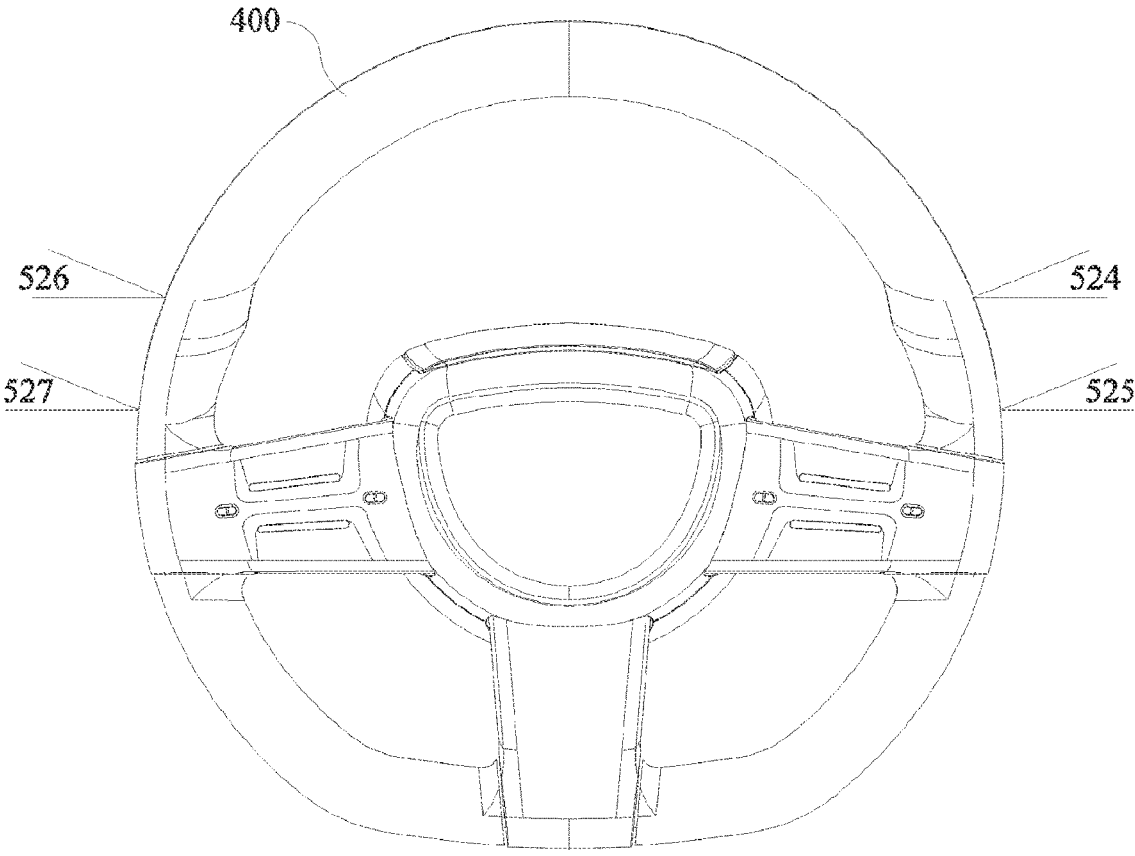

FIG. 31

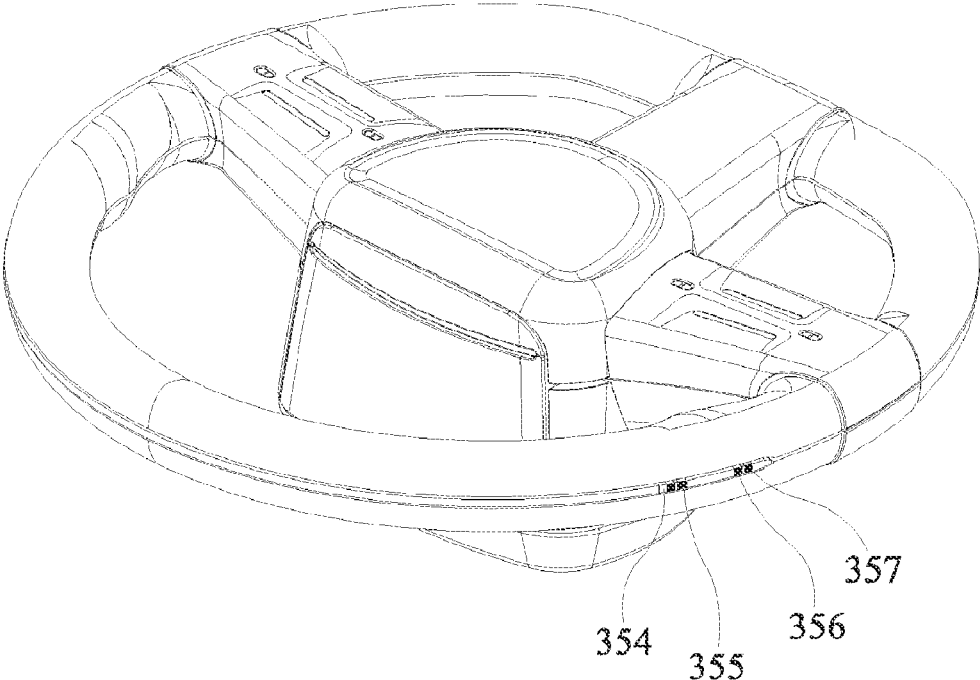

FIG. 32

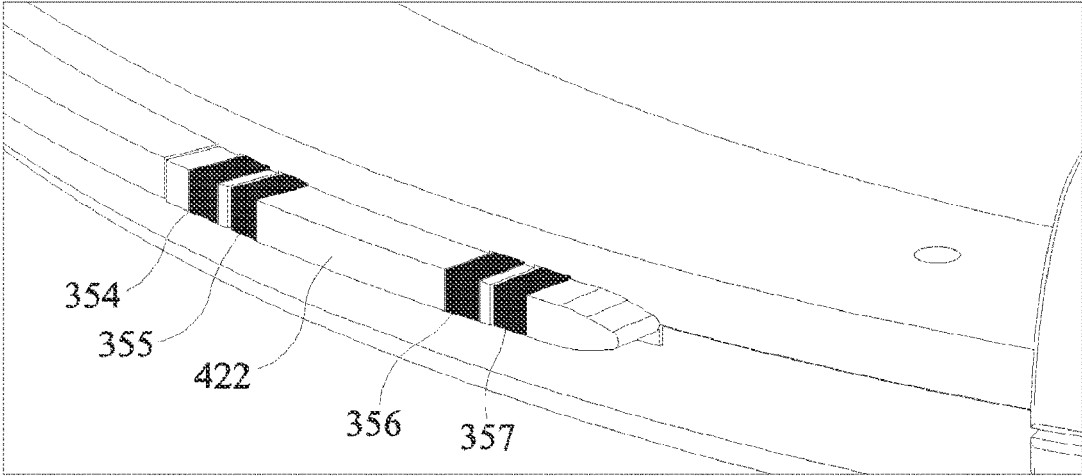

FIG. 33

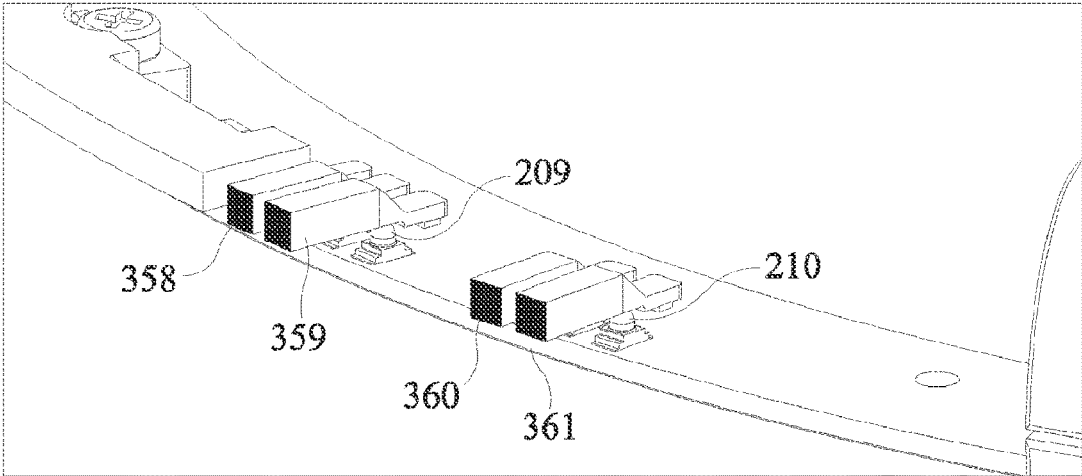

FIG. 34

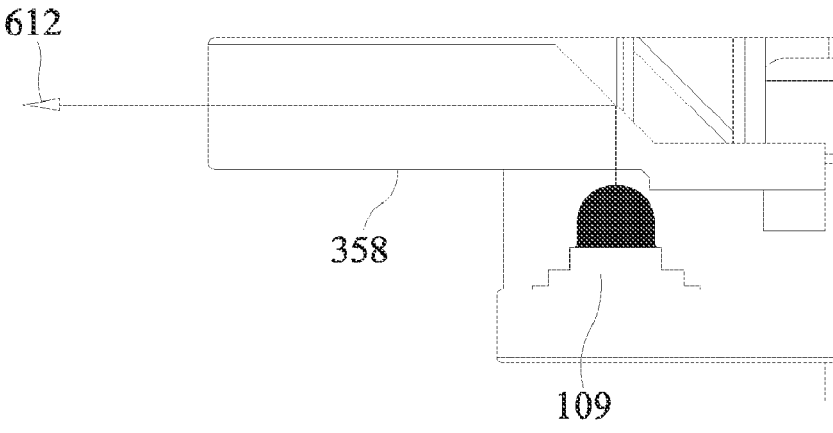

FIG. 35

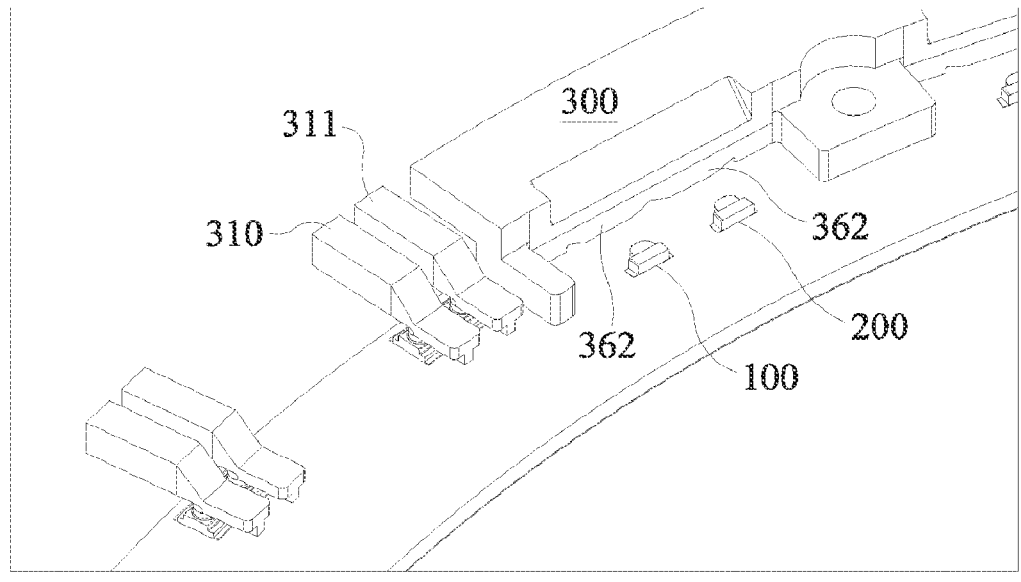
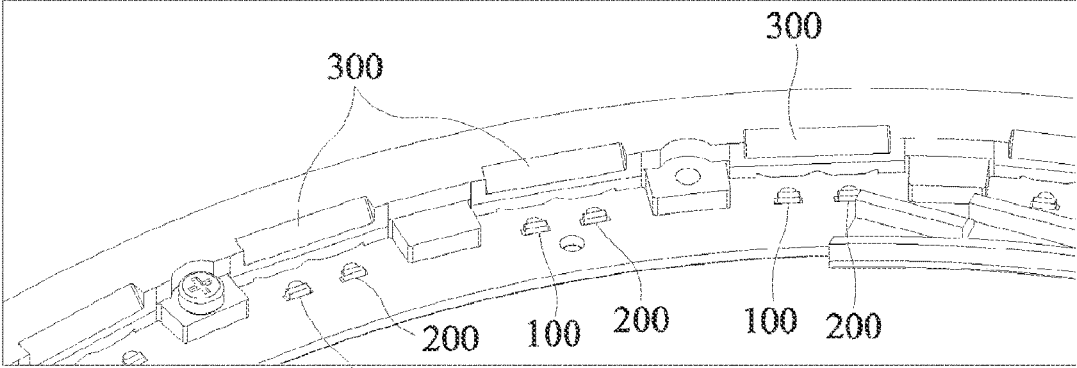

FIG. 36



100 FIG. 37

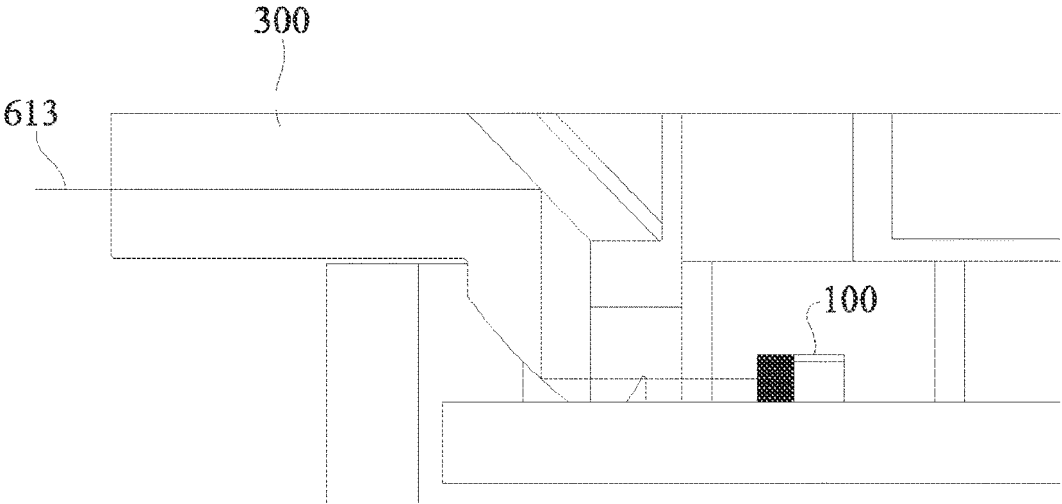

FIG. 38

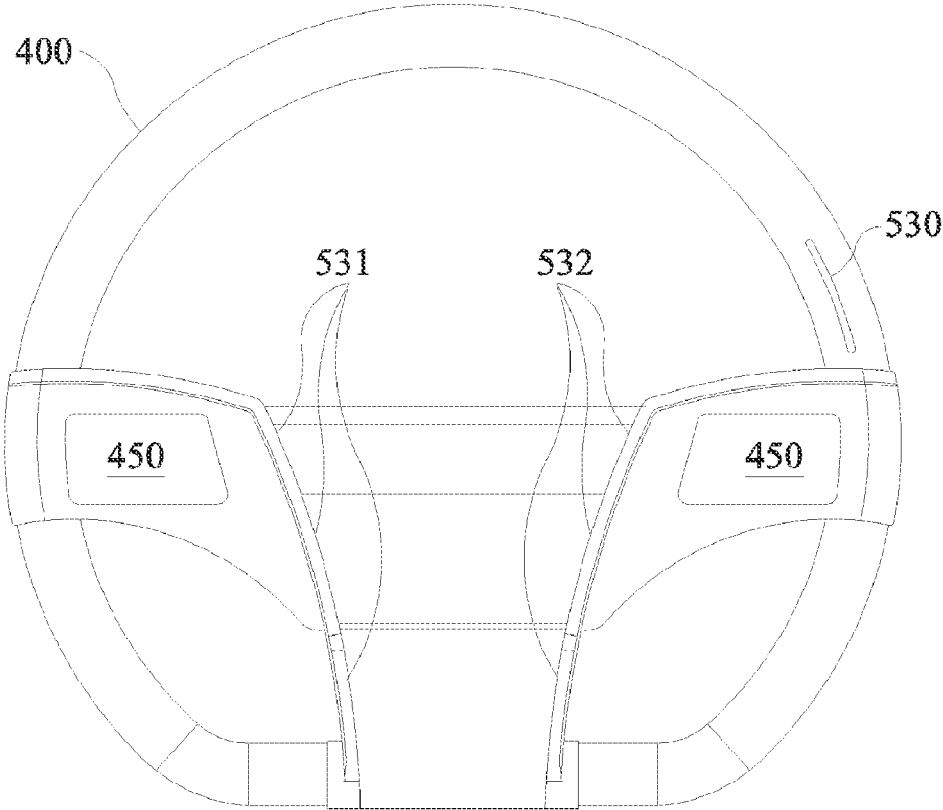

FIG. 39

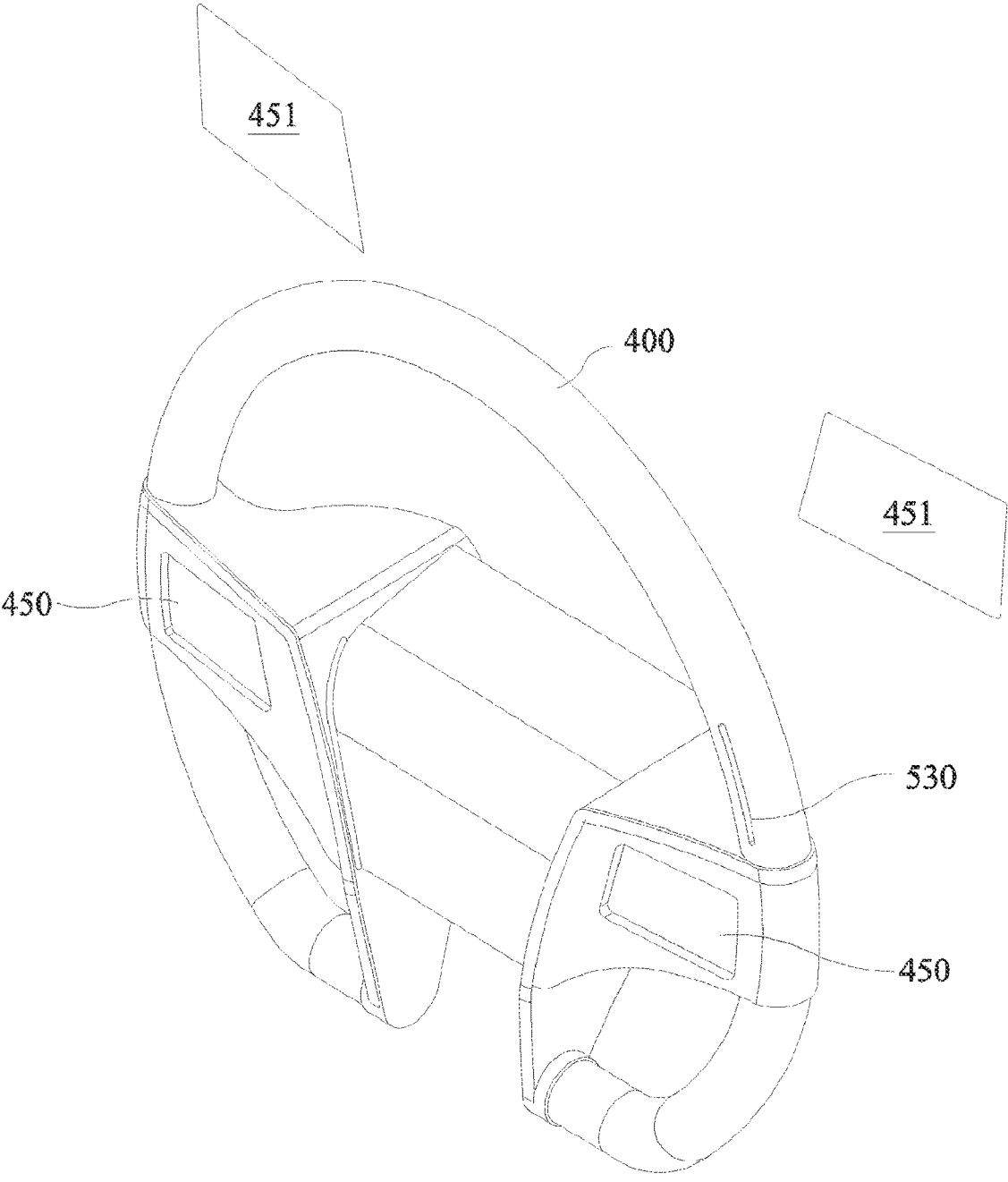

FIG. 40

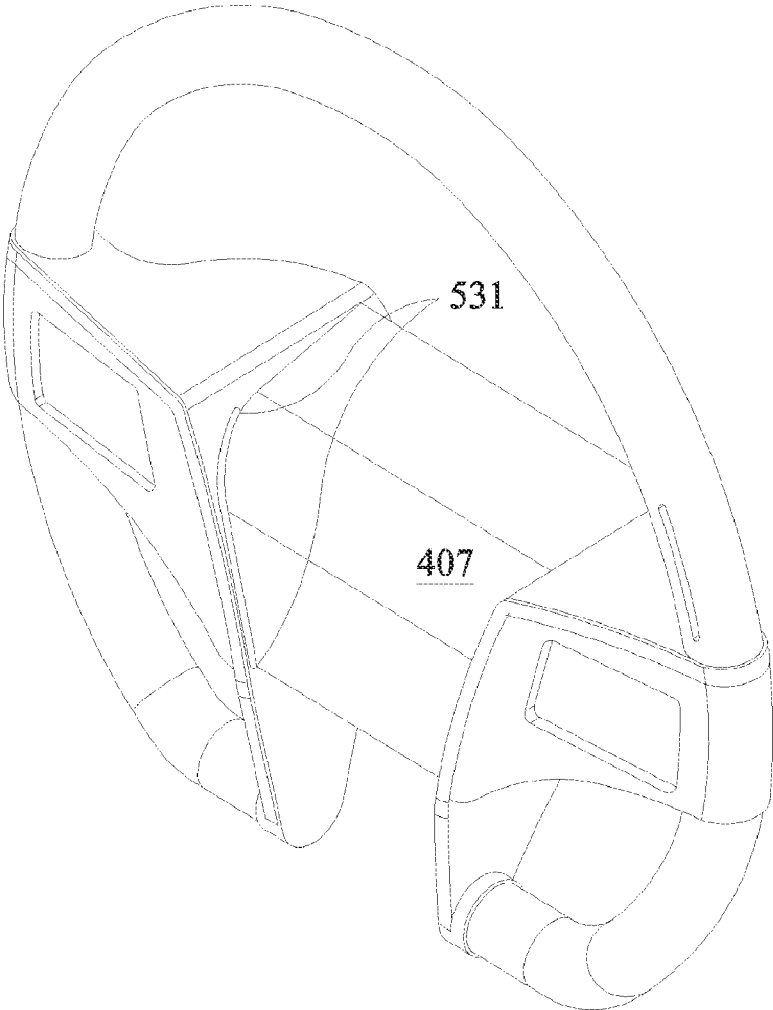

FIG. 41

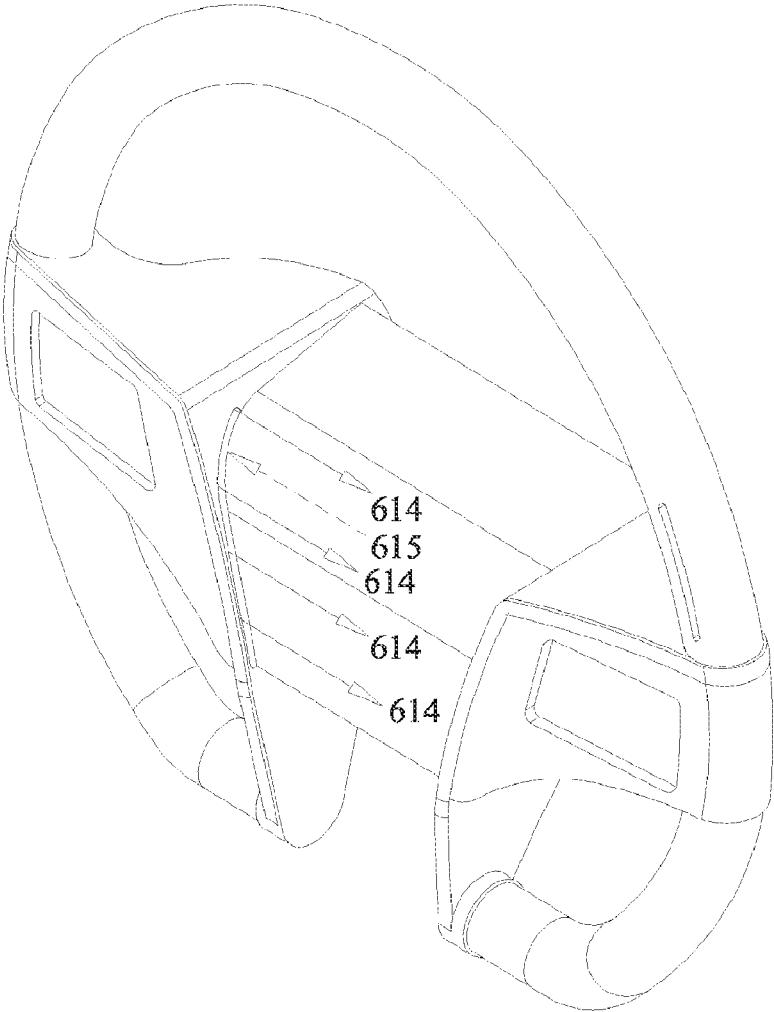

FIG. 42

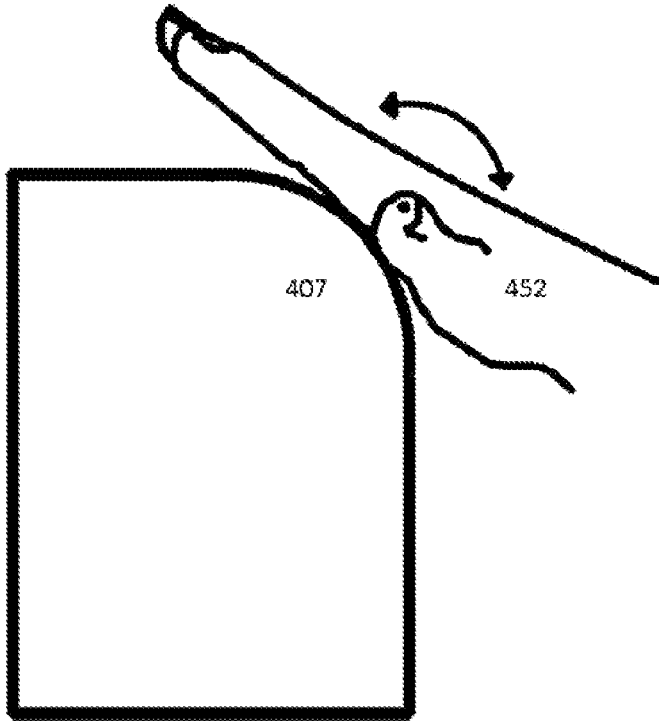

FIG. 43

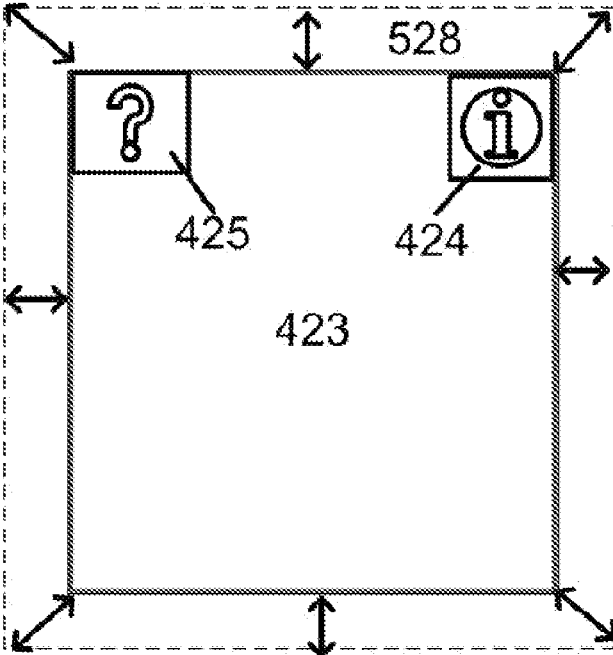

FIG. 44

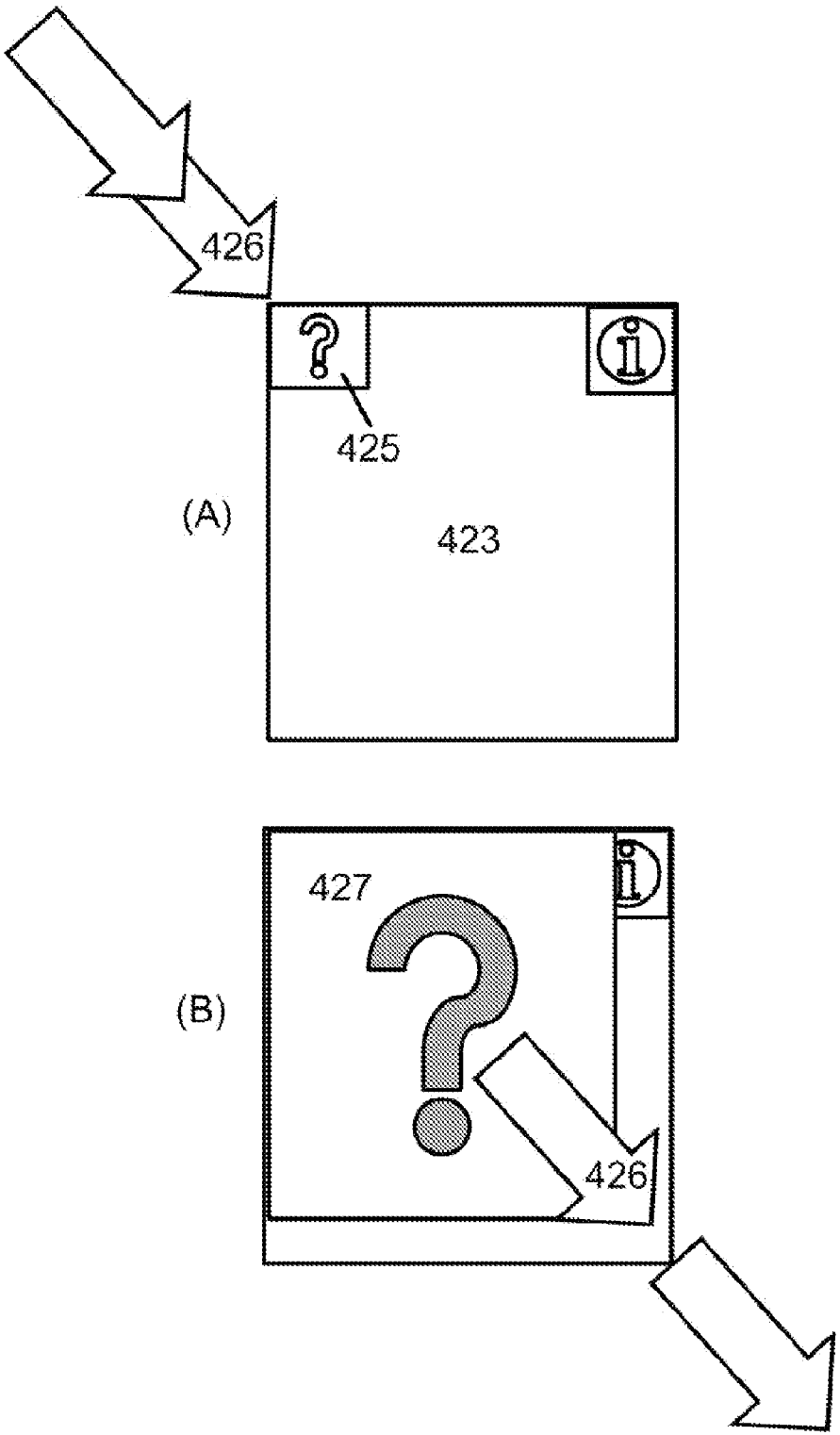

FIG. 45

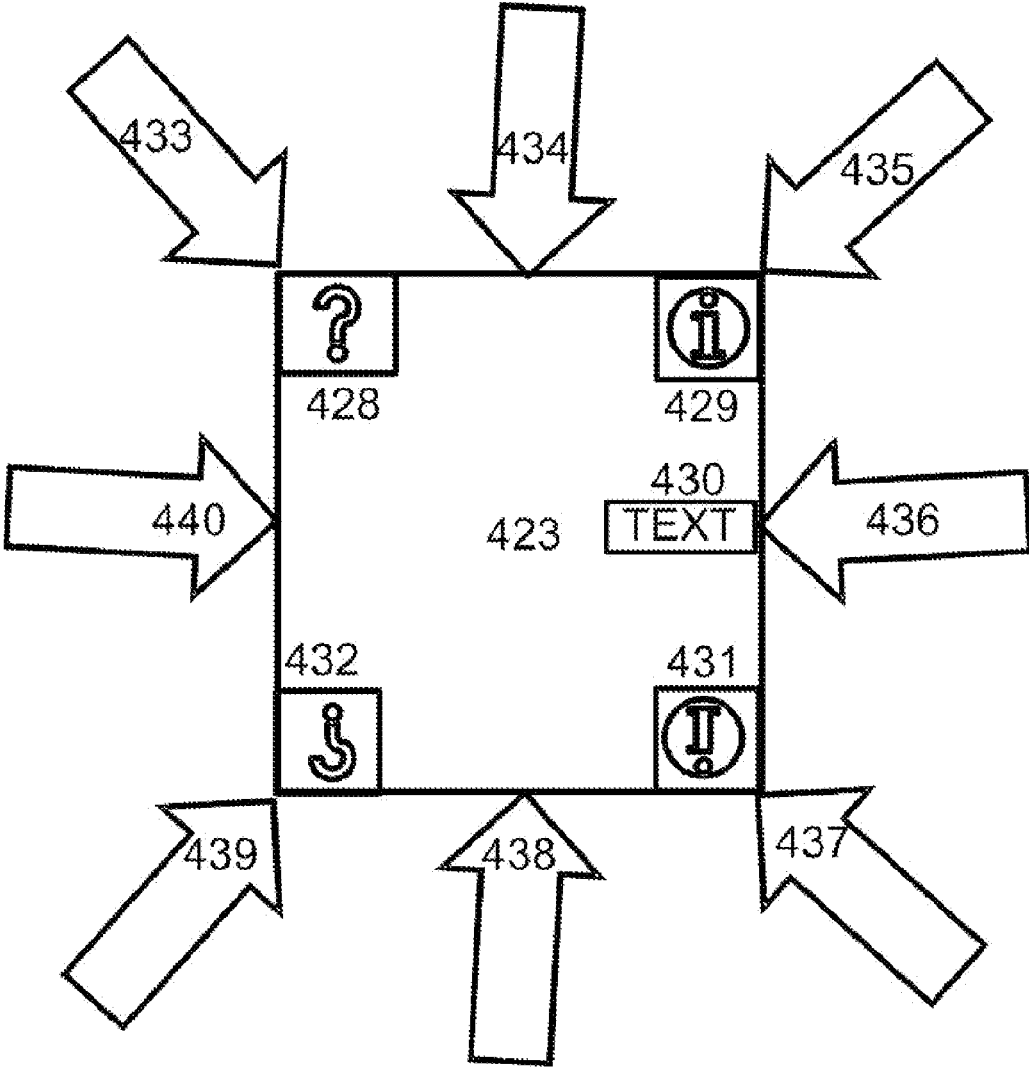

FIG. 46

LIGHT-BASED TOUCH CONTROLS ON A STEERING WHEEL AND DASHBOARD**CROSS REFERENCES TO RELATED APPLICATIONS**

[0001] This application is a non-provisional of U.S. Provisional Application No. 61/730,139, entitled LIGHT-BASED TOUCH CONTROLS ON A STEERING WHEEL AND DASHBOARD, and filed on Nov. 27, 2012 by inventors Gunnar Martin Fröjdh, Thomas Eriksson, John Karlsson, Maria Hedin and Richard Berglind, the contents of which are hereby incorporated herein in their entirety.

[0002] This application is also a continuation-in-part of U.S. application Ser. No. 13/854,074, entitled LIGHT-BASED FINGER GESTURE USER INTERFACE, and filed on Mar. 30, 2013 by inventors Thomas Eriksson, Per Leine, Jochen Laveno Mangelsdorff, Robert Pettersson and Anders Jansson, the contents of which are hereby incorporated herein in their entirety.

[0003] This application is also a continuation-in-part of U.S. application Ser. No. 13/775,269 entitled REMOVABLE PROTECTIVE COVER WITH EMBEDDED PROXIMITY SENSORS, and filed on Feb. 25, 2013 by inventors Thomas Eriksson, Stefan Holmgren, John Karlsson, Remo Behdasht, Erik Rosengren and Lars Sparf, the contents of which are hereby incorporated herein in their entirety.

[0004] This application is also a continuation-in-part of U.S. application Ser. No. 13/424,543, entitled OPTICAL ELEMENTS WITH ALTERNATING REFLECTIVE LENS FACETS, and filed on Mar. 20, 2012 by inventors Stefan Holmgren, Lars Sparf, Magnus Goertz, Thomas Eriksson, Joseph Shain, Anders Jansson, Niklas Kvist, Robert Pettersson and John Karlsson, the contents of which are hereby incorporated herein in their entirety.

[0005] U.S. application Ser. No. 13/854,074 is a continuation of U.S. Ser. No. 13/424,592, entitled LIGHT-BASED FINGER GESTURE USER INTERFACE, and filed on Mar. 20, 2012 by Inventors Thomas Eriksson, Per Leine, Jochen Laveno Mangelsdorff, Robert Pettersson and Anders Jansson, now U.S. Pat. No. 8,416,217, the contents of which are hereby incorporated herein in their entirety.

[0006] U.S. application Ser. No. 13/424,592 claims priority benefit of U.S. Provisional Application Ser. No. 61/564,868, entitled LIGHT-BASED FINGER GESTURE USER INTERFACE, and filed on Nov. 30, 2011 by inventors Thomas Eriksson, Per Leine, Jochen Laveno Mangelsdorff, Robert Pettersson and Anders Jansson, the contents of which are hereby incorporated herein in their entirety.

[0007] U.S. application Ser. No. 13/775,269 is a continuation-in-part of U.S. patent application Ser. No. 13/732,456 entitled LIGHT-BASED PROXIMITY DETECTION SYSTEM AND USER INTERFACE, and filed on Jan. 3, 2013 by inventors Thomas Eriksson and Stefan Holmgren, the contents of which are hereby incorporated herein in their entirety.

[0008] U.S. application Ser. No. 13/424,543 claims priority benefit of U.S. Provisional Application Ser. No. 61/564,164, entitled OPTICAL ELEMENTS WITH ALTERNATIVE REFLECTIVE LENS FACETS, and filed on Nov. 28, 2011 by inventors Stefan Holmgren, Lars Sparf, Thomas Eriksson, Joseph Shain, Anders Jansson, Niklas Kvist, Robert Pettersson and John Karlsson, the contents of which are hereby Incorporated herein in their entirety.

[0009] U.S. application Ser. No. 13/424,543 also claims priority benefit of PCT Application No. PCT/US11/29191, entitled LENS ARRANGEMENT FOR LIGHT-BASED TOUCH SCREEN, and filed on Mar. 21, 2011 by inventors Magnus Goertz, Thomas Eriksson, Joseph Shain, Anders Jansson, Niklas Kvist, Robert Pettersson, Lars Sparf and John Karlsson, the contents of which are hereby incorporated herein in their entirety.

[0010] U.S. application Ser. No. 13/424,543 is also a continuation-in-part of U.S. application Ser. No. 12/371,609, entitled LIGHT-BASED TOUCH SCREEN, and filed on Feb. 15, 2009 by inventors Magnus Goertz, Thomas Eriksson and Joseph Shain, now U.S. Pat. No. 8,339,379, the contents of which are hereby incorporated herein in their entirety.

[0011] U.S. application Ser. No. 13/424,543 is a continuation-in-part of U.S. application Ser. No. 12/760,567, entitled OPTICAL TOUCH SCREEN SYSTEMS USING REFLECTED LIGHT, and filed on Apr. 15, 2010 by inventors Magnus Goertz, Thomas Eriksson and Joseph Shain, the contents of which are hereby incorporated herein in their entirety.

[0012] U.S. application Ser. No. 13/424,543 is also a continuation-in-part of U.S. application Ser. No. 12/760,568, entitled OPTICAL TOUCH SCREEN SYSTEMS USING WIDE LIGHT BEAMS, and filed on Apr. 15, 2010 by inventors Magnus Goertz, Thomas Eriksson and Joseph Shain, the contents of which are hereby incorporated herein in their entirety.

[0013] PCT Application No. PCT/US11/29191 claims priority benefit of U.S. Provisional Application Ser. No. 61/379,012, entitled OPTICAL TOUCH SCREEN SYSTEMS USING REFLECTED LIGHT, and filed on Sep. 1, 2010 by inventors Magnus Goertz, Thomas Eriksson, Joseph Shain, Anders Jansson, Niklas Kvist and Robert Pettersson, the contents of which are hereby incorporated herein in their entirety.

[0014] PCT Application No. PCT/US11/29191 also claims priority benefit of U.S. Provisional Application Ser. No. 61/380,600, entitled OPTICAL TOUCH SCREEN SYSTEMS USING REFLECTED LIGHT, and filed on Sep. 7, 2010 by inventors Magnus Goertz, Thomas Eriksson, Joseph Shain, Anders Jansson, Niklas Kvist and Robert Pettersson, the contents of which are hereby incorporated herein in their entirety.

[0015] PCT Application No. PCT/US11/29191 also claims priority benefit of U.S. Provisional Application Ser. No. 61/410,930, entitled OPTICAL TOUCH SCREEN SYSTEMS USING REFLECTED LIGHT, and filed on Nov. 7, 2010 by inventors Magnus Goertz, Thomas Eriksson, Joseph Shain, Anders Jansson, Niklas Kvist, Robert Pettersson and Lars Sparf, the contents of which are hereby incorporated herein in their entirety.

[0016] U.S. application Ser. No. 12/760,567 claims priority benefit of U.S. Provisional Application Ser. No. 61/169,779, entitled OPTICAL TOUCH SCREEN, and filed on Apr. 16, 2009 by inventors Magnus Goertz, Thomas Eriksson and Joseph Shain, the contents of which are hereby incorporated herein in their entirety.

FIELD OF THE INVENTION

[0017] The field of the present invention is light-based user interfaces for vehicles.

BACKGROUND OF THE INVENTION

[0018] Reference is made to FIG. 1, which is a simplified illustration of prior art steering wheel. A prior art steering wheel 400, shown in FIG. 1, includes a circular gripping member 401, one or more connecting members 402-404 that connect the gripping member 401 to steering column 407, and buttons 405 and 406 on connecting members 402 and 403 for controlling various devices in the vehicle. Connecting members 402-404, which connect gripping member 401 to steering column 407, are also referred to as spokes. In FIG. 1, button 405 is used to answer an incoming phone call on the vehicle's BLUETOOTH® speaker phone and button 406 hangs up the call. BLUETOOTH is a trademark owned by the Bluetooth SIG of Kirkland, Wash., USA. Controls mounted in a steering wheel can be operated comfortably and safely since the driver is able to control and operate these controls without taking hands off the wheel or eyes off the road.

[0019] Originally, the first button added to a steering wheel was a switch to activate the car's electric horn. When cruise control systems were introduced, some automakers located the operating switches for this feature on the steering wheel as well. Today additional button controls for an audio system, a telephone and voice control system, a navigation system, a stereo system, and on board computer functions are commonly placed on the steering wheel.

[0020] US Patent Publication No. 2012/0232751 A1 for PRESSURE SENSITIVE STEERING WHEEL CONTROLS teaches adding pressure-sensitive controls to the circular gripping member of the steering wheel. Pressure sensors are located at various locations along the perimeter of the gripping member, and different locations correspond to different controls. A control is actuated in response to an application of pressure at a sensor location, e.g., by the user tightening his grip.

[0021] Many present-day vehicle dashboard consoles involve much more than simply displaying information to the driver. The driver, in many instances, is required to navigate a series of touch screen menus and icons in order to operate the dashboard console.

SUMMARY

[0022] The present invention relates to buttons and controls mounted in a steering element and associated dashboard user interfaces. More broadly, the present invention relates to remote controls for on board vehicle systems and associated user interfaces. The term "steering element" in the context of the present specification includes any physical element used to navigate a vehicle, such as a steering wheel, aircraft yoke, side-sticks and center-sticks, ship's wheel, bicycle or motorcycle handle bars.

[0023] Embodiments of the present invention provide a sensor system that detects position, proximity and pressure, separately or in combination, to enable input of complex gestures on and around a steering element. In some embodiments, the sensor system of the present invention is used in conjunction with a head-up display (HUD) or wearable goggles with built in picture presentation. In this case, the HUD or goggles render icons or a grid in the user's field of view. The user extends his hand to interact with the rendered image elements. The sensor detects the user's gestures in 3D space and these coordinates are then mapped onto the rendered image to interpret the user input.

[0024] Embodiments of the present invention also provide a dashboard coupled with a sensor system that utilizes the dashboard display for relevant information without cluttering the dashboard with buttons. The sensor system detects position, proximity and direction for input of complex gestures on the dashboard. In some embodiments, the dashboard is presented to the driver through a HUD or wearable goggles with built in picture presentation. In this case the sensor system enables the driver to interact with graphics presented by the HUD or goggles, by detecting the driver hand gestures and mapping them onto the projected HUD or goggle images. Embodiments of the present invention facilitate operation of the vehicle dashboard system by eliminating irrelevant information from the display. Moreover, a user interface in accordance with the present invention provides context-relevant options, namely, options related to the state and circumstances of the vehicle. E.g., the user interface presents parking options when the user stops the vehicle, and presents options to unlock various doors, such as the trunk and gas tank, when the motor is turned off.

[0025] The present invention relates to a motor vehicle, that includes a steering wheel situated opposite a driver seat in the motor vehicle, the steering wheel including a plurality of proximity sensors encased in the periphery of the steering wheel for detecting hand slide gestures along the outer periphery of the steering wheel, an entertainment and navigation system housed in a dashboard in the vehicle, and, a processor housed in the vehicle and connected to the sensors and to the entertainment and navigation system for controlling the entertainment and navigation system in response to the detected hand slide gestures.

[0026] In some embodiments, in response to a detected upward slide gesture the processor increases an adjustable setting for the entertainment and navigation system and in response to a detected downward slide gesture the processor decreases the adjustable setting.

[0027] In some embodiments, the entertainment and navigation system includes a plurality of adjustable features, wherein a setting for a selected feature is adjusted in response to the hand slide gestures, and wherein the processor changes the selected feature in response to at least one tap on the outer periphery of the steering wheel. When the processor changes the selected feature, a graphic indicating the newly selected feature is rendered on a display connected to the entertainment and navigation system, such as a dashboard-mounted display or HUD. In some embodiments, this display is situated inside goggles worn by the driver. Examples of adjustable settings include raising or lowering the audio volume, selecting a radio channel and selecting a track in a music library, bass, treble, image view in a GPS system—e.g., 2D view, 3D view, satellite view, and zooming an image.

[0028] In some embodiments, a second plurality of proximity sensors encased in the steering wheel facing the driver, detects hand wave gestures between the steering wheel and the driver, wherein the processor changes a mode of the entertainment and navigation system in response to the hand wave gestures. This said second plurality of proximity sensors is also operative to detect the driver entering the motor vehicle.

[0029] In some embodiments, the steering wheel further comprises a cavity, i.e., an air gap, an array of light emitters connected to the processor that project light beams across the cavity and an array of light detectors connected to the

processor that detect the projected light beams. This enables detecting wave gestures inside the cavity that interrupt the light beams, which allows the user to control the entertainment and navigation system through these detected gestures inside the cavity. These wave gestures are performed by one or more fingers or by the palm of a hand.

[0030] In some embodiments having a steering wheel cavity, there are multiple arrays of light emitters connected to the processor that project light beams at different geometric planes across the cavity and multiple arrays of light detectors connected to the processor that detect the projected light beams, for detecting wave gestures across multiple geometric planes inside the cavity that interrupt the light beams. This enables detecting wave gestures across a depth of the cavity for a wide range of wave gestures. For example, these sensors detect an angle at which the finger or hand penetrates the cavity. They also detect a velocity of approach by measuring the different times at which the finger or hand crosses each geometric plane. In some embodiments of the cavity the light beams are all projected vertically across the cavity. In other embodiments, a bidirectional grid of light beams is projected across the cavity.

[0031] In order to prevent inadvertent adjusting of the entertainment system controls during driving, in certain embodiments the hand slide gestures control the entertainment and navigation system only when the steering wheel is not substantially rotated, namely, that it is at the “twelve-o’clock” position, or has not deviated more than a threshold amount from the “twelve-o’clock” position.

[0032] In some embodiments, the entertainment and navigation system includes a display, and the processor zooms an image on the display in response to detecting a spread gesture performed by two or more fingers in the cavity, and pans the image in response to a translation gesture performed by one or more fingers in the cavity. In some embodiments of the present invention, the finger spread gesture is performed by spreading or separating the tips of all fingers of one hand inside the cavity. In other embodiments of the present invention, the finger spread gesture is performed by extending all fingers of one hand inside the cavity. The image is, inter alia, a map related to the navigation system, a rear view camera image, or a graphic related to the entertainment system.

[0033] In some embodiments, the vehicle includes a wireless phone interface, inter alia a BLUETOOTH® interface, that is controlled using tap gestures or hand slide gestures on the outer perimeter of the steering wheel. For example, a single tap answers a call and a double-tap hangs up or declines the call.

[0034] In some embodiments, a sudden quick hand slide gesture along the outer periphery of the steering wheel mutes the entertainment and navigation system.

[0035] In some embodiments, when the processor changes the selected feature, the processor renders an image of the steering wheel on a display mounted in the vehicle, the image indicating which command is associated with each steering wheel input zone.

[0036] The present invention also relates to a motor vehicle having a dashboard display surrounded by a frame of proximity sensors for detecting wave gestures above the frame. A graphic representing a group of related functions is presented in a corner of the display. In response to a diagonal wave gesture above the frame beginning above this corner, the graphic is translated across the display revealing icons

for the related functions. In some embodiments different graphics representing different groups of functions are presented in respective display corners, and a diagonal wave gesture beginning at a corner opens that corner’s group of functions by translating the corresponding graphic diagonally across the display.

[0037] There is thus provided in accordance with an embodiment of the present invention, a system for use in a vehicle, including a steering element situated opposite a driver seat in a vehicle, the steering element including a plurality of proximity sensors encased in the periphery of the steering element operable to detect hand gestures along the outer periphery of the steering element, an interactive deck housed in the vehicle, for providing at least one of radio broadcast, video broadcast, audio entertainment, video entertainment and navigational assistance in the vehicle, and a processor housed in the vehicle, coupled with the proximity sensors and the deck, operable to identify the hand gestures detected by the proximity sensors, and to control the deck in response to thus-identified hand gestures.

[0038] There is additionally provided in accordance with an embodiment of the present invention a dashboard for a vehicle, including a display, a frame including proximity sensors for detecting hand gestures above the frame, and a processor coupled with the display and the frame, operable to present a graphic representing a group of related functions in a corner of the display, and to identify the hand gestures detected by the proximity sensors, and wherein, in response to identifying a diagonal hand wave gesture above the frame and beginning above the corner of the display, the processor translates the graphic across the display thereby revealing icons for the related functions.

BRIEF DESCRIPTION OF THE DRAWINGS

[0039] The present invention will be more fully understood and appreciated from the following detailed description, taken in conjunction with the drawings in which:

[0040] FIG. 1 is a simplified illustration of prior art steering wheel;

[0041] FIG. 2 is a simplified illustration of a first embodiment of a steering wheel having multiple detection zones, in accordance with an embodiment of the present invention;

[0042] FIG. 3 is a simplified illustration of a second embodiment of a steering wheel having multiple detection zones, in accordance with an embodiment of the present invention;

[0043] FIG. 4 is a simplified illustration of a bidirectional light grid, namely, horizontal and vertical light beams, for detecting objects inserted into a hollow portion of the steering wheel of FIG. 3, in accordance with an embodiment of the present invention;

[0044] FIG. 5 is a simplified side view and profile view of the steering wheel of FIG. 3, in accordance with an embodiment of the present invention;

[0045] FIG. 6 is a flow chart describing a sequence of user interface events for adjusting car stereo controls, in accordance with an embodiment of the present invention;

[0046] FIG. 7 is a flow chart describing a sequence of user interface events for entering text, in accordance with an embodiment of the present invention;

[0047] FIG. 8 is a flow chart describing a sequence of user interface events for manipulating an image displayed on a car dashboard, in accordance with an embodiment of the present invention;

[0048] FIGS. 9-11 are simplified illustrations of a PCB assembly (PCBA) in a steering wheel, in accordance with an embodiment of the present invention;

[0049] FIGS. 12-16 are simplified diagrams of proximity sensors on a steering wheel, in accordance with an embodiment of the present invention;

[0050] FIGS. 17-20 are simplified illustrations of slider controls embedded in a steering wheel, in accordance with an embodiment of the present invention;

[0051] FIGS. 21-30 are simplified diagrams of sensors embedded in a steering wheel that detect gestures inside an open cavity in the steering wheel, in accordance with an embodiment of the present invention;

[0052] FIGS. 31-35 are simplified diagrams of proximity sensors embedded in the outer rim of a steering wheel, in accordance with an embodiment of the present invention;

[0053] FIGS. 36-38 are simplified diagrams of touch sensors embedded across the outer rim of a steering wheel, in accordance with an embodiment of the present invention;

[0054] FIG. 39 is a simplified illustration of a steering wheel with multiple touch sensors and embedded touch screen displays, in accordance with an embodiment of the present invention;

[0055] FIG. 40 is a simplified illustration of the steering wheel of FIG. 39 with a head-up display, in accordance with an embodiment of the present invention;

[0056] FIGS. 41 and 42 are simplified illustrations or proximity sensors that line the steering column of the steering wheel of FIG. 39, in accordance with an embodiment of the present invention;

[0057] FIG. 43 is a simplified illustration of a user interface gesture performed on the steering column of the steering wheel of FIG. 39, in accordance with an embodiment of the present invention; and

[0058] FIGS. 44-46 are simplified illustrations of user interfaces and associated sweep gestures that are enabled on a vehicle dashboard, in accordance with an embodiment of the present invention.

[0059] In the specification and figures, the following numbering scheme is used. Steps in flow charts are numbered between 1-99, light transmitters are numbered in the 100's, light receivers are numbered in the 200's, light guides and lenses are numbered in the 300's, miscellaneous items are numbered in the 400's, detection zones and sensors are numbered in the 500's, and light beams are numbered in the 600's. Like numbered elements are similar but not necessarily identical.

[0060] The following tables catalog the numbered elements and list the figures in which each numbered element appears.

Light Transmitters	
Element	FIGS.
100	9, 30, 36, 37, 38
101	14, 15, 16
102	15
103	9, 19, 20
104	9, 23, 24, 25
106	26
107	26
108	26
109	35

Light Receivers	
Element	FIGS.
200	9, 30, 36, 37, 38
201	14, 15
202	15
203	9, 19
204	28, 29, 30
209	35
210	35

Light Guides and Lenses	
Element	FIGS.
300	9, 10, 11, 30, 36, 37, 38
310	9, 10, 11, 36
311	9, 10, 11, 36
320	9, 10, 11, 18, 19, 20
321	18
330	9, 10, 11, 14, 15, 16
331	9, 10, 11, 14, 15
332	13
333	13
334	13
335	14, 15
336	15
337	15
338	15
340	9, 10, 11, 28
341	9, 10, 11, 23, 24, 25
342	22
343	24, 25
344	23, 25
345	23, 24, 25, 26
346	27, 28
347	29
348	29, 30
353	28
354	32, 33
355	32, 33
356	32, 33
357	32, 33
358	34, 35
359	34
360	34
361	34
362	36

Miscellaneous Items		
Element	FIGS.	Description
400	1, 9, 31, 39-43	steering wheel
401	1, 2	grip
402	1, 2	right spoke
403	1, 2	left spoke
404	1, 2	bottom spoke
405	1	answer button
406	1	reject button
407	1, 2, 41, 43	steering column
408	5	nominal range
409	5	nominal range
410	5	thickness of grip
411	9, 10, 11, 30	PCB
412	9	opening in steering wheel
413	16, 20	finger
414	17	recessed cavity wall
415	17	recessed cavity wall
416	17	recessed cavity wall

-continued

Miscellaneous Items		
Element	FIGS.	Description
417	17	inclined surface
418	18	intermediate layer
419	18	narrow openings
420	26	beam offset
421	29	cavities for light receivers in light guide
422	33	plastic rim
423	44, 45, 46	dashboard display
424	44	icon
425	44, 45	icon
426	45	diagonal sweep gesture
427	45	icon
428	46	icon
429	46	icon
430	46	text
431	46	icon
432	46	icon
433	46	directional sweep gesture
434	46	directional sweep gesture
435	46	directional sweep gesture
436	46	directional sweep gesture
437	46	directional sweep gesture
438	46	directional sweep gesture
439	46	directional sweep gesture
440	46	directional sweep gesture
450	39, 40	Touch screen display
451	40	Head-up display
452	43	Hand

Detection Zones and Sensors

Element	FIGS.	Description
501	2, 21	zone
502	2	zone
503	2	zone
504	2	zone
505	2	zone
506	2	zone
507	2	zone
508	2	zone
510	3	zone
511	3	zone
512	3	zone
513	3	zone
514	3	zone
515	3	zone
516	3	zone
517	3	zone
520	12	sensor
521	12	sensor
522	17	sensor
523	17	sensor
524	31	zone
525	31	zone
526	31	zone
527	31	zone
528	39	Zone
530	39, 40	Slider sensor
531, 532	39, 41	Proximity sensor strip

Light Beams

Element	FIGS.	Description
600	4	light beam grid
601	16	light beam

-continued

Light Beams		
Element	FIGS.	Description
602	16	light beam
603	16	light beam
604	20	light beam
605	25	light beam
606	26	light beam
607	26	light beam
608	26	light beam
610	26	portion of light beam
611	29	light beam
612	35	light beam
613	38	light beam
614	42	Proximity sensor beam
615	42	Proximity sensor reflected beam

DETAILED DESCRIPTION

[0061] Aspects of the present invention relate to light-based touch controls that allow a driver to keep his hands on a steering element while operating peripheral electronic devices in a vehicle.

[0062] Reference is made to FIG. 2, which is a simplified illustration of a first embodiment of a steering wheel having multiple detection zones, in accordance with an embodiment of the present invention. Shown in FIG. 2 is a steering wheel with multiple detection zones for user input, indicated by numbers in the figure. Detection properties for each zone are listed below.

[0063] Zone 501 is a portion of a cavity surrounded by gripping member 401 and the top of steering column 407. The present invention enables detection of user gestures in this cavity. An example gesture is sweeping a hand or finger horizontally across the cavity.

[0064] Zone 502 is related to a portion of the outer rim of gripping member 401. This zone is configured to receive sliding gestures, where the driver slides a finger or hand along this portion of the outer rim. An example application for this gesture is to control the volume on the vehicle's audio system, where a clockwise hand-slide or sweep gesture increases the volume, a counterclockwise hand-slide or sweep gesture reduces the volume, and a fast hand-slide or sweep gesture along zone 502 mutes the audio. If the audio is on mute, a fast hand-slide or sweep gesture along zone 502 cancels the mute. Another application is to use hand-slide or sweep gestures to answer or reject an incoming phone call. In this case a hand-slide or sweep gesture in a first direction, e.g., clockwise, answers the call, and a hand-slide or sweep gesture in the opposite direction rejects the call.

[0065] Zones 503 and 504 are proximity sensor zones configured to detect movement of a hand in the detection zone which is the airspace several inches outward on either side of the steering wheel. An example application uses zone 503 for controlling the windshield wipers and zone 504 for controlling the directional signals, i.e., blinking lamps mounted near the left and right front and rear corners of a vehicle activated by the driver on one side of the vehicle at a time to advertise intent to turn or change lanes toward that side. In this example, the windshield wipers are activated, or their speed is increased, when an upward hand gesture is detected in zone 503, and the windshield wipers are slowed down or turned off when a downward hand gesture is detected in zone 503. Similarly, the right directional signal

is activated when an upward hand gesture is detected in zone **504**, and the left directional signal is activated when a downward hand gesture is detected in zone **504**.

[0066] Another example application for zones **503** and **504** is modeled on Formula One sports cars, where the gear shifter is adapted to fit onto the steering wheel in the form of two paddles; depressing the right paddle shifts into a higher gear, while depressing the left paddle shifts into a lower one. In the present embodiment, a gesture corresponding to depressing the right paddle is detected in zone **503**, and a gesture corresponding to depressing the left paddle is detected in zone **504**.

[0067] Zones **505** and **506** are two touch and slider controls on the right connecting member **402**. An additional two touch and slider controls (not numbered) are shown on the left connecting member **403**. These zones receive touch gestures and glide gestures. A glide gesture includes the steps of a user touching this sensor and then sliding his finger along the sensor. Slider controls are suitable for selecting a value within a range, e.g., to adjust dashboard brightness or audio volume. A glide gesture in one direction gradually increases the value, and a glide gesture in the opposite direction gradually decreases the value.

[0068] These controls determine a location of a touch along the slider and are therefore suitable for touch gestures as well. For example, extended touches or taps can be used for selecting a value within a range, such as to adjust dashboard brightness or audio volume. A tap or touch at one end of the slider increases the value, and a tap or touch at the opposite end decreases the value.

[0069] Zones **507** and **508** are hover and proximity sensors, configured to detect objects that are opposite but not touching the steering wheel. One example application detects when a driver enters the vehicle. This can wake up the system and display a greeting message to the driver. In some embodiments of the present invention, these sensors detect a distance between the driver and the wheel, inter alia, in order to adjust the driver's air bags according to this distance; namely, a larger distance requires a greater degree of inflation.

[0070] An additional two hover and proximity sensors (not numbered) are shown on the left connecting member **403**. In some embodiments of the present invention, these zones are also configured to detect touch gestures. Another application for zones **507** and **508** is to select a user input mode. For example, zone **502** has two associated applications: a music library and a radio station selector. Hand-slide or sweep gestures along zone **502** either browse the music library or scan radio channels depending on the active mode. The active mode is toggled or selected by touching one of zones **507** and **508**. For example, a tap on zone **508** activates music library mode and a tap on zone **507** activates radio mode. Alternatively, a right-to-left wave gesture above zones **507** and **508** activates music library mode, and a left-to-right wave gesture above zones **507** and **508** activates radio mode.

[0071] In general, the different zones are coordinated to provide fluent and flexible navigation for a plurality of applications. The user selects an application by interacting with zones **507** and **508** and each of the other zones **501-506** is assigned an aspect of the active application. Each time an application is selected, an image of the steering wheel appears on the dashboard indicating which command is associated with each of the input zones.

[0072] Reference is made to FIG. **3**, which is a simplified illustration of a second embodiment of a steering wheel having multiple detection zones, in accordance with an embodiment of the present invention. The multiple detection zones for user input are indicated by numbers in the figure. Detection properties for each zone are listed below.

[0073] Zones **510-512** are air gaps in the steering wheel. A two-dimensional grid of light beams is projected into each air gap to detect any object inserted therein.

[0074] Reference is made to FIG. **4**, which is a simplified illustration of a bidirectional light grid, namely, horizontal and vertical light beams, for detecting objects inserted into a hollow portion of the steering wheel of FIG. **3**, in accordance with an embodiment of the present invention. Shown in FIG. **4** is a light-beam grid **600** in zone **511**.

[0075] In some embodiments more than one layer of light beams is projected into each air gap to provide a series of detections at different points along the thickness of the air gap.

[0076] Reference is made to FIG. **5**, which is a simplified side view and profile view of the steering wheel of FIG. **3**, in accordance with an embodiment of the present invention. FIG. **5** shows the steering wheel of FIGS. **3** and **4** in profile view and at an angle from above the wheel's upper right corner. Both views indicate thickness **410** of gripping member **401** along which the multiple light grids are stacked. This enables detecting an angle at which an object is inserted into the air gap. A full explanation of multiple detection layers and their use for z-axis coordinate detection is provided in U.S. Pat. No. 8,416,217 for LIGHT-BASED FINGER GESTURE USER INTERFACE, the contents of which are incorporated herein by reference.

[0077] Returning to FIG. **3**, detection zone **517** is a hovering space surrounding the outer perimeter of the steering wheel. Objects that enter zone **517** are detected by sensors embedded in the gripping member of the steering wheel.

[0078] Zones **513-515** detect the position of one or more objects touching, or in close proximity to, these zones. The range of proximity detection is indicated in FIG. **5** by nominal range **408**. In some embodiments zones **513-515** are also adapted to detect an amount of pressure applied by a touch object.

[0079] Zone **516** detects the position of one or more objects touching, or in close proximity to, it. The range of proximity detection is indicated in FIG. **5** by nominal range **409**. In some embodiments zone **516** is also adapted to detect an amount of pressure applied by a touch object.

[0080] In order to avoid inadvertent input to the detection zones while steering the vehicle, the touch-sensitive input system is activated only under particular conditions. For example, in order that the system register touch input the user first performs a specific touch gesture on one or more of the detection zones. As another example, the user must activate a toggle switch located away from the steering wheel before the detection zones register user input. Yet another example is that the position of the steering wheel enables touch input to be registered, only when the steering wheel is in the "twelve o'clock" or neutral position the system registers input from the detection zones, whereas once the wheel is rotated a given number of degrees from the neutral position, the system actively monitors the detection zones but does not generate input to other devices.

[0081] A few use cases will demonstrate the user interface of the present invention. A first use case is adjusting the volume in the car stereo.

[0082] Reference is made to FIG. 6, which is a flow chart describing a sequence of user interface events for adjusting car stereo controls, in accordance with an embodiment of the present invention. At step 10 the steering wheel is in neutral position to enable touch input. At step 11 the driver presses a location in zone 513 that activates controls for the entertainment system. The first parameter to be adjusted by the controls is the volume. At step 12 a volume meter is presented on a display device such as a dashboard display or HUD. The driver adjusts the volume level by performing a hand-slide or sweep gesture along the right outer rim of the steering wheel, i.e., the right section of zone 517. Steps 13-16 show that a counterclockwise gesture along the right hand side of detection zone 517 increases the volume, and a clockwise gesture along this zone decreases the volume. This counterclockwise gesture can be performed by raising the driver's right hand along the steering wheel. At step 17 one or more taps on the outside of the steering wheel (zone 517) puts the input system into a different mode, e.g., to adjust the bass or treble. The system then returns to step 12 where it displays a meter relevant for the active mode, e.g., bass or treble, instead of volume. While the right hand is performing gestures that activate system functions, the left hand can perform additional gestures in the detection zones that do not interfere with the right hand gestures. In some instances these left hand gestures do not generate any commands.

[0083] A second use case is text input of an address to a vehicle navigation system.

[0084] Reference is made to FIG. 7, which is a flow chart describing a sequence of user interface events for entering text, in accordance with an embodiment of the present invention. At step 20 the driver presses a location on zone 514 marked by a text input symbol to activate text input mode. At steps 21 and 22, gestures inside zone 510 are interpreted as characters or symbols. Alternatively, characters are input by finger or stylus glide gestures on the surface of zone 516. At step 23 the entered text is displayed on the dashboard or HUD. Steps 21-23 continue in a loop until the displayed text forms a name or word (or portion thereof). To confirm the input, the driver taps once on the outer rim of the steering wheel (zone 517) as indicated by step 24. To delete or reject the input, the driver double-taps on the outer rim of the steering wheel (zone 517) as indicated by step 25. The system operates independently of right/left handedness.

[0085] A third use case is an image viewer.

[0086] Reference is made to FIG. 8, which is a flow chart describing a sequence of user interface events for manipulating an image displayed on a car dashboard, in accordance with an embodiment of the present invention. At step 30 an image is displayed on the dashboard. Alternatively, this image is displayed on an HUD. This image may be a map, a rear-view camera viewfinder image or any other image. At step 31 the driver activates image manipulation mode, e.g., by tapping a location on zone 515 marked by an image symbol. At steps 32-34 hand movements in detection zone 511 are interpreted as image manipulation commands. These commands include panning, zooming and rotating the image. The hand movements supported include one-finger and multi-finger translation gestures, and two-finger pinch, two-finger spread and two-finger rotation gestures. Further

hand movements supported include full-hand spreads, whereby a user spreads all fingers on one hand inside the air gap. Other supported gestures include full-hand pinch gestures, which begin when all fingertips of one hand are not touching each other, and the user draws his fingertips together. When multiple layers of light-beam guides provide z-axis detection, tilt gestures are also supported. A tilt gesture uses the angle at which a finger is inserted through air gap 511 as one of the gesture attributes. A full discussion of supported gestures and commands is included in the aforementioned U.S. Pat. No. 8,416,217 for LIGHT-BASED FINGER GESTURE USER INTERFACE. The driver taps once on the outer rim of the steering wheel (zone 517) to accept an input, as indicated at step 35, and taps twice on the outer rim of the steering wheel (zone 517) to cancel an input as indicated at step 36. This system operates independently of right/left handedness.

[0087] Discussion now turns to implementing sensors for each of the various detection zones. Generally speaking, a light-based touch or proximity sensor includes a light transmitter and a light receiver, and is based on the principle that an object such as a finger placed on or near the sensor changes the coupling of light between the transmitter and the receiver. Thus, a channel that conducts signals between the transmitter and the receiver indicates whether there is a touch inside the channel. There are two types of channels; namely,

[0088] A. channels for which a finger activates a signal between the transmitter and the receiver; and

[0089] B. channels for which a finger blocks a signal between the transmitter and the receiver.

[0090] For channels of type A, a low signal, near 0, indicates no touch, and a high signal indicates a touch. For channels of type B, a high signal indicates no touch, and a low signal, near 0, indicates a touch.

[0091] Reference is made to FIGS. 9-11, which are simplified illustrations of a PCB assembly (PCBA) in a steering wheel, in accordance with an embodiment of the present invention. FIGS. 9-11 show a printed circuit board assembly (PCBA) 411 populated with various touch and proximity sensor components for a steering wheel 400 according to embodiments of the present invention. FIG. 9 shows the PCBA from above, FIG. 10 shows the PCBA rotated, and FIG. 11 shows a cross-sectional view, to show the three-dimensional features of the light guides. The embodiment illustrated in FIGS. 9-11 includes five different sensor systems.

[0092] A first sensor system provides detection zones 507 and 508 in FIG. 2. Each sensor in this first system includes a pair of light guides 330 and 331, as shown in FIGS. 9-11. Light guide 330 is coupled to a transmitter (not shown) and light guide 331 is coupled to a receiver (also not shown). When a driver hovers his hand above one of these sensors he generates a high signal as his hand reflects light from light guide 330 back into light guide 331. This is a type A channel. In some embodiments similar sensors placed along spokes 402-404 that connect the gripping member 401 of wheel 400 to the steering column 407 are used to provide detection zones 513-515 in FIG. 3. Similar sensors placed inside steering column 407 of wheel 400 also provide detection zone 516 in FIG. 3, in certain embodiments of the invention.

[0093] A second sensor system provides detection zones 505 and 506 in FIG. 2. Each sensor in this second system includes an alternating row of transmitters 103 and receivers

203, coupled to a light guide 320, as shown in FIGS. 9-11. When a driver touches the upper edge of light guide 320 he generates a high signal as his touch reflects light from one or more of transmitters 103 onto a respective one or more neighboring receivers 203. This too, is a type A channel. In some embodiments similar sensors placed along the spokes 402-404 that connect the gripping member 401 of wheel 400 to the steering column 407 are used to provide detection zones 513-515 in FIG. 3. Similar sensors placed inside steering column 407 of wheel 400 also provide detection zone 516 in FIG. 3, in certain embodiments of the invention.

[0094] A third sensor system provides detection zone 501 in FIG. 2. This system includes a row of emitters 104 that project collimated light beams across opening 412 with the aid of collimating light guide 340. A row of receivers (not shown) at the opposite end of opening 412 receives the collimated light beams with the aid of a second collimating light guide 341 embedded in the gripping member 401 of wheel 400. When a driver inserts a hand or finger into the active detection zone 501 in opening 412, he generates a low signal as his hand or finger blocks a portion of the collimated light beams. This is a type B channel.

[0095] The illustrated third sensor system features vertical collimated light beams and detects objects along only one axis. In some embodiments, an additional, similar sensor system embedded in the left and right portions of gripping member 401 is added to project horizontal collimated beams across opening 412. In this case, the two sets of orthogonal collimated beams provide two-dimensional (2D) detection of inserted objects. In some embodiments, similar sets of orthogonal beams are used in openings 511 and 512 of FIG. 3 to provide 2D detection as illustrated by light grid 600 in FIG. 4.

[0096] A fourth sensor system includes two sensors along each side of steering wheel 400. These sensors provide detection zones 503 and 504 in FIG. 2. Each sensor in this fourth system includes a pair of light guides 310 and 311, as shown in FIGS. 9-11. Light guide 310 is coupled to a transmitter (not shown) and light guide 311 is coupled to a receiver (also not shown). When a driver hovers his hand opposite one of these sensors he generates a high signal as his touch reflects light from light guide 310 back into light guide 311. This is a type A channel. In some embodiments, similar sensors are placed around the entire wheel to provide detection zone 517 in FIG. 3.

[0097] A fifth sensor system includes a series of sensors along the upper outer rim of steering wheel 400. These sensors provide detection zone 502 in FIG. 2. Each sensor in this fifth system includes a transmitter 100, a receiver 200 and a light guide 300. A driver touching the outer rim of the wheel opposite one of these sensors generates a high signal as his touch reflects light from emitter 100 back onto receiver 200. Therefore this is a type A channel. Similar sensors placed around the entire wheel can be used to provide detection zone 22 in FIG. 3.

[0098] In some embodiments of the present invention, in addition to the near-infrared light used for the sensors, visible light elements are also embedded in the steering wheel, to light up the various detection zones. The visible light elements are used, inter alia, in order to illuminate a hand inside zones 510-512, or to follow hand movements inside zones 510-512 or along zones 502-506, so as to provide visible feedback to the driver who is interacting with the sensors.

[0099] The type A channel sensor systems described herein above detect light from the transmitter reflected off the driver's finger or hand onto a nearby receiver. The maximum distance that this type A sensor can detect is defined as the sensor's "nominal range". In some embodiments, the different sensor systems have different nominal ranges. For example, when the second and fifth sensor systems are designed to be used as a touch switch or slider control, they are adjusted to a very short nominal range. Similarly, when the first and fourth sensor systems are designed to detect hover gestures in the air above or opposite the sensor, they are adjusted to a nominal range of several inches. And when the first system is designed to detect a driver entering the car it is adjusted to a very large nominal range.

[0100] There are several ways to adjust the nominal range, based inter alia on the intensity of the transmitter, on the detection threshold used to decide whether an object is present in the channel, and on the light guide. Specifically, when the light guide absorbs a portion of the light in the detection channel the sensor has a shorter nominal range.

[0101] The first sensor system, used for detection zones 507 and 508, is now addressed in detail.

[0102] Reference is made to FIGS. 12-16, which are simplified diagrams of proximity sensors on a steering wheel, in accordance with an embodiment of the present invention. FIGS. 12-15 show layers of components that form sensors 520 and 521. FIG. 12 shows proximity sensors 520 and 521 as seen by a driver. FIG. 13 shows proximity sensors 520 and 521 with the upper steering wheel casing layer removed. As seen in FIG. 13, these proximity sensors feature a supporting column 332 having a transmitter light guide upper surface 333 and a receiver light guide upper surface 334 at the top of the column. In FIG. 14 column 332 is removed, exposing upward facing transmitter 101 directly beneath light guide 330, upward facing receiver 201 directly beneath light guide 331, and light barrier 335 between transmitter 101 and receiver 201 to prevent scattered light from transmitter 101 from reaching receiver 201. FIG. 15 is another view of the elements in both proximity sensors 520 and 521: transmitters 101 and 102, receivers 201 and 202, light guides 330, 331, 336 and 337 and light barriers 335 and 338. Light guides 330, 331, 336 and 337 are adapted to use total internal reflection (TIR) to maximize the amount of light in this detection channel.

[0103] The operation of sensors 520 and 521 is illustrated in FIG. 16 showing emitter 101 sending a direct light beam 601 and a TIR beam 602 through light guide 330 out above the sensor. A finger 413 hovering above the sensor reflects a portion of the emitter beam back into neighboring light guide 331 and onto receiver 201, as illustrated by two-sided arrow 603. Light guide 331 and receiver 201 are not shown in FIG. 16.

[0104] The second sensor system, adjusted to a very short nominal range and used for zones 502, 505 and 506, is now addressed in detail.

[0105] Reference is made to FIGS. 17-20, which are simplified illustrations of slider controls embedded in a steering wheel, in accordance with an embodiment of the present invention. FIGS. 17-20 show layers of components that form slider controls 522 and 523. In the illustrated embodiment each of these slider controls is situated inside a gently sloping recessed cavity to facilitate gliding a finger along the control without taking eyes off the road. A first recessed cavity is formed by inclined surface 417 sur-

rounded on three sides by walls **414-416**. Slider control **523** is located along the boundary joining surface **417** to wall **415**.

[0106] FIG. **18** shows that the exposed surface of slider controls **522** and **523** is the long, thin, top surface of upright light guides **320** and **321**. Light guides **320** and **321** are supported in their upright position by being inserted through narrow opening slots **419** in intermediate layer **418**.

[0107] FIG. **19** shows the inner components of slider control **522** after intermediate layer **418** has been removed. Slider control **522** includes one alternating row of transmitters **103** and receivers **203**, and one upright light guide **320**. Slider control **522** is a linear series of detection channels where each channel has a transmitter at one end of the channel and its neighboring receiver in the alternating row of transmitters and receivers at the other end of the channel.

[0108] Reference is made to FIG. **20** illustrating the light beam path through this channel. Light beam **604** exits transmitter **103** and is directed upward through light guide **320**. A finger **413** touching the top of light guide **320** reflects a portion of the beam back down into light guide **320**. A portion of this reflected light is directed through light guide **320** onto a neighboring receiver **203** (shown in FIG. **19**) completing the detection channel. As a driver's finger glides along the exposed surface of light guide **320** different detection channels are activated indicating the location of the finger along this slider control. Light guides **320** and **321** are adapted to use TIR to maximize the amount of light in the detection channels.

[0109] The type B sensor system used for zone **501** will now be discussed in detail.

[0110] Reference is made to FIGS. **21-30**, which are simplified diagrams of sensors embedded in a steering wheel that detect gestures inside an open cavity in the steering wheel, in accordance with an embodiment of the present invention. Detection zone **501** is illustrated in FIG. **21**. FIG. **22** shows the exposed upper edge **342** of light guide **341** that projects light beams into zone **501**. FIG. **23** shows a rotated cross section of light guide **341** and an array of transmitters **104** situated below light guide **341** in the steering column. Light guide **341** includes collimating, internally reflective elements (not shown) that collimate light inside the light guide, internally reflective facet **344**, and curved window **345**. Curved window **345** is required in order that this light guide follow the contours of the rounded steering column in which it is mounted. The outer surface of window **345** is exposed upper edge **342** of FIG. **22**. In some embodiments of the present invention, window **345** is formed with a uniform thickness, in order to minimize the lens effect that this window has on the sensor light beams. In some embodiments, window **345** is also formed as thin as possible, in order to minimize the distance that the light beams are shifted laterally when they pass through the window.

[0111] Reference is made to FIG. **24** showing light guide **341** viewed from underneath. In this view, internally reflective collimating surfaces **343** are visible. Each surface **343** collimates a wide light beam emitted by a transmitter into the light guide. In addition, surface **343** also redirects the collimated light onto internally reflective surface **344** as light beam **605** in FIG. **25** illustrates.

[0112] FIG. **26** shows three beams **606-608** from respective emitters **106-108**, passing through lens **345**. FIG. **26** illustrates how a uniform thickness and a large radius of curvature relative to the width of the beam of window **345**,

minimize the lens effect on three light beams **606-608**. E.g., beam **606** is offset to the left of emitter **106** when it exits curved window **345**, but is not redirected as a result of passing through the window. The offset for beam **606** is indicated in the figure by distance **420**. When window **345** is thin, the offset is negligible. In some embodiments, for which the offset is not negligible and for which the emitters and receivers are evenly spaced on PCB **411**, beam offsets are handled in software, inter alia by calculating the position of the corresponding blocked beam according to the beam position when it crosses the screen, which is offset from the emitter and receiver location. In other embodiments, for which the offset is not negligible, the emitters and receivers are not evenly spaced on PCB **411**, in order for the offset to cause the beams crossing detection zone **501** to be evenly spaced. The dotted portions **610** of the beams represent the beams passing through light guides **340** and **341**, which are not shown in this figure.

[0113] The second half of the light sensor for zone **501** is now discussed. FIG. **27** shows the exposed lower edge **346** of a light guide that receives the projected light beams and directs the beams onto receivers embedded inside the circular gripping member of the steering wheel. FIGS. **28** and **29** are two cross-sectional views showing three staggered rows of receiver elements **204** together with their respective light guides inside the circular gripping member of steering wheel **400**. Collimated light crossing detection zone **501** enters the gripping member through curved window **353**. In order to maintain the collimation of the light beams, window **353** has a uniform width and substantially similar arcs at both its inner and outer surfaces, like window **345** described hereinabove.

[0114] FIG. **29** shows light guide **340** from a different angle than in FIG. **28**. The collimating portion of this light guide is circled section **347**. This collimating portion uses two air-to-plastic interfaces to direct the collimated wide beam onto a respective receiver **204**. The operation of these collimating lenses is more fully explained in U.S. patent application Ser. No. 13/424,543 for OPTICAL ELEMENTS WITH ALTERNATING REFLECTIVE LENS FACETS, the contents of which are incorporated herein by reference. In particular, reference is made to FIGS. 50-52 and associated paragraphs [00267]-[00271] in U.S. patent application Ser. No. 13/424,543. In the embodiment illustrated in FIG. **29** the light guides are formed of a single piece of plastic **348**. The receivers **204** are shown suspended in cavities **421** formed in plastic **348**. The PCB on which these receivers are mounted is not shown in the figure: it is above the receivers, and covers cavities **421**. The path of a light beam **611** through light guide **340** is shown.

[0115] Light transmitters and receivers for two different sensors are mounted on two sides of PCB **411**. FIG. **30** shows exploded views from both sides of steering wheel PCB **411**. The light receivers **204** for detection zone **501** are on one side of the PCB, and transmitter-receiver pairs **100-200** for detection zone **502** are mounted on the reverse side of this PCB. The exploded view also shows light guide **300**, used for detection zone **502**, and plastic element **348** that forms light guide **340**, both mounted on PCB **411**.

[0116] The type A sensor used for detection zones **503** and **504** described hereinabove will now be described in detail.

[0117] Reference is made to FIGS. **31-35**, which are simplified diagrams of proximity sensors embedded in the outer rim of a steering wheel, in accordance with an embodi-

ment of the present invention. FIG. 31 shows four detection zones 524-527 on either side of steering wheel 400. FIG. 32 shows two of the sensors that provide these detection zones on one side of the steering wheel by projecting light beams away from the wheel and detecting a portion of the beams that is reflected back by a hovering finger or hand. As seen by the driver, each sensor includes a light emitting surface 354 or 356, and a neighboring light receiving surface 355 or 357. FIG. 33 shows a plastic rim 422 inlaid in the outer rim of the steering wheel and having near-infrared (NIR) transmissive portions 354-357 that allow the passage of NIR light for these sensors. FIG. 34 shows that the NIR transmissive portions are actually separate light guides 358-361, where a pair of light guides forms a detection channel. Each of light guides 358-361 is coupled to a respective transmitter or receiver component. Thus, light guides 358 and 360 are coupled to respective transmitters (blocked from view in the figure by light guides 359 and 361), and light guides 359 and 361 are coupled to receivers 209 and 210, respectively. FIG. 35 shows a light beam path 612 through light guide 358. FIG. 35 also shows transmitter 109 coupled to light guide 358.

[0118] Reference is made to FIGS. 36-38, which are simplified diagrams of touch sensors embedded across the outer rim of a steering wheel, in accordance with an embodiment of the present invention. FIGS. 36 and 37 show the components in a type A sensor used for detection zone 502 described hereinabove; namely, transmitter-receiver pairs 100-200 and light guide 300. Light guide 300 is shared by both transmitter 100 and receiver 200, and light guide 300 has a collimating lens portion 362 opposite each transmitter and opposite each receiver. FIG. 38 shows how light guide 300 acts as a periscope for the light beams, such as light beam 613 emitted by emitter 100. As described above, a steering wheel equipped with a series of these sensors along its outer rim is enabled to detect tap gestures and hand-slide gestures along the wheel's outer rim.

[0119] In some embodiments of the present invention, a processor connected to the touch sensors along the steering wheel rim or spokes detects the number of fingers on each hand touching the wheel. This is performed by heuristically determining the size of the segment covered by a hand holding the wheel, or by detecting a series of up to four objects next to each other along the sensor array. When the driver taps the wheel with only one finger as he grips the wheel, e.g., by tapping on the wheel with one finger while continuing to grip the wheel with the other fingers, the processor determines which finger performed the tap according to the location of the tap within the segment of the wheel being held. This enables a user Interface whereby different fingers are associated with different functions. For example, taps by an index finger control the stereo and taps by the middle finger control the telephone. Determination of which finger is tapping the wheel is based on the finger's relative position within the segment of the wheel that is held, as detected by the touch sensors. As such, this user Interface is not dependent on which segment of the wheel is being touched. It is thus applied anywhere on the wheel, based on relative finger position. In some cases, the processor distinguishes between right and left hands according to right and left halves of the wheel.

[0120] In some embodiments of the present invention, multiple sensors are arranged around the tubular or cylindrical surface of the wheel grip in order to detect when the

driver rotates his hand around the grip in the manner of a motorcycle driver revving a motorcycle engine by rotating the handle bar grip. The user interface is configured to control a particular feature by this gesture. In applications of the present invention to motorcycle handlebars, these sensors provide an alternative to rotating handlebar grips for controlling the speed of the motorcycle engine.

[0121] In some embodiments of the present invention, proximity detectors or touch detectors are also mounted on the rear of the steering wheel grip or spokes to detect tap gestures on the back of a spoke or on the back of the wheel grip performed by fingers wrapped around the wheel. For example, these gestures are used to shift gears, or to shift the drive mode. Drive modes include, inter alia, eco mode, sport mode, 2-wheel drive and 4-wheel drive.

[0122] In some embodiments of the present invention, the vehicle loads a user profile that configures the user interface, including assigning various gestures to respective control settings. The vehicle supports multiple users by allowing each user to download his settings to the vehicle. Thus, settings for multiple users are uploaded to an Internet server. When a driver enters a car, the driver downloads his settings from the Internet server to the vehicle, thus adapting the vehicle to his customized settings. For example, different gestures can be mapped to control different features by the driver. One application for this system is a rental car. When a driver rents a car he downloads his user profile to the rental car so that the user interface is familiar. Another application is for car dealerships, whereby a car's user interface is customized for a buyer while the buyer tries out a test model or sits inside a dummy cockpit. The dealer configures the user's profile in the demo car and uploads it to the Internet server. The dealer does not need to customize the purchased car when it arrives beyond downloading the buyer's profile.

[0123] Aspects of the present invention also relate to contextual user interfaces. When a driver enters the car, the car's user Interface asks the driver what he wants to do and guides him to do so, using a display screen. Thus the UI presents options based on context. If the engine is off, the UI asks if the driver wants to start the car. If the driver turns off the motor, the UI presents the following initial options: open doors, open gas tank, open trunk, and open hood. In some embodiments, the display renders a map of the different hand slide and tap gestures that the driver can perform on the steering element to execute these options. If the driver stops the car, the UI asks if the driver wants to park. If the driver responds that he does wish to park, the UI presents parking options, e.g., park on the street or in a nearby lot. In an automated car, capable of traveling without a driver, the UI offers the further option to refill gas, battery or solar panel (depending on how the car is powered) while the driver is out shopping or working. Before leaving the car, the UI asks the driver when to return to the parking spot.

[0124] In some embodiments, a biometric sensor is also added to the steering element of the present invention. In order to access the UI, the biometric sensor must first register the driver. If the biometric sensor detects that the driver is not fit to drive the car, e.g., the sensor detects a high heart rate or high alcohol content, the UI responds accordingly and does not allow the driver to drive.

[0125] Another embodiment of a steering wheel according to the present invention is illustrated in FIGS. 39-42. In this embodiment, the steering wheel includes two embedded touch-sensitive display screens. The display screen informa-

tion is displayed on a head-up display to the driver so that the driver need not remove his eyes from the road to look down at the displays.

[0126] Reference is made to FIG. 39, which is a simplified illustration of a steering wheel with multiple touch sensors and embedded touch screen displays, in accordance with an embodiment of the present invention FIG. 39 shows steering wheel 400 having two embedded touch screens 450 and a slider control 530. Slider control 530 is implemented as a series of light emitters and receivers similar to slider controls 522 and 523 described hereinabove with reference to FIGS. 17-20. Touch screens 450 are touch-enabled by a series of emitters and receivers along the screen edges that form a touch-detection light grid that covers each screen 450. Steering wheel 400 is also shown having two proximity sensor strips 531 and 532 for detecting a driver's hand placed on the steering column between these two strips.

[0127] Reference is made to FIG. 40, which is a simplified illustration of the steering wheel of FIG. 39 with a head-up display, in accordance with an embodiment of the present invention. FIG. 40 shows steering wheel 400 viewed at an angle. Two head-up displays 451 are provided for rendering graphics from screens 450 at a location easily viewable by the driver. The driver can interact with a user interface on screens 450 by viewing head-up displays 451 and performing touch gestures on screens 450.

[0128] Reference is made to FIGS. 41 and 42, which are simplified illustrations or proximity sensors that line the steering column of the steering wheel of FIG. 39, in accordance with an embodiment of the present invention. FIG. 41 shows that the front and top of steering column 407 is touch sensitive by virtue of two strips of proximity sensors. A first proximity sensor strip 531 is shown. This strip is formed by an alternating series of emitters and detectors that emit light beams across the outer surface of column 407. This strip curves along the contours of steering column 407. When the driver places his hand on steering column 407, the hand reflects the projected light beams back into the proximity sensor where neighboring detectors sense an increase in reflected light. The operation of this type of proximity sensor is described in applicant's co-pending U.S. patent application Ser. No. 13/775,269 entitled REMOVABLE PROTECTIVE COVER WITH EMBEDDED PROXIMITY SENSORS, especially FIGS. 4-10 there. The second proximity sensor strip 532 is opposite strip 531 and is not visible given the viewing angle of FIG. 41.

[0129] FIG. 42 shows the light beams of proximity sensor strip 531. Emitter beams 614 are shown adhering to the contours of steering column 407. One reflected beam is shown as dashed beam 615. When the driver places a hand on steering column 407 his hand reflects one or more of beams 614 back as beam 615.

[0130] Reference is made to FIG. 43, which is a simplified illustration of a user interface gesture performed on the steering column of the steering wheel of FIG. 39, in accordance with an embodiment of the present invention. FIG. 43 shows a hand gesture detected by the two proximity sensors lining steering column 407. In this gesture the driver tilts palm 452 along the rounded corner formed by steering column 407. In some applications, this gesture is used to adjust the angle of a side view mirror. Thus, titling the palm downward and touching a higher portion of column 407 tilts the mirror upwards; tilting the palm to be more vertical tilts the mirror downward.

[0131] The two proximity sensors lining two opposite edges of steering column 407 form a unique two-dimensional detector. A location along the proximity sensor at which the reflected beam is detected is a location along one dimension. The nearer the reflecting object is to strip 531 or 532, the greater the detection signal. Comparing the detection signals of proximity strip 531 to those of proximity strip 532 provides a coarse estimation of where the finger is located between the two strips. Thus, if both strips detect similar amounts of reflected light, the finger is roughly in the middle between the two strips. Whereas if one proximity sensor strip detects more light than the other, the finger is nearer to the high detection strip.

[0132] Embodiments of the present invention also relate to vehicle dashboards, driver display systems and related user interfaces.

[0133] Reference is made to FIGS. 44-46, which are simplified illustrations of user interfaces and associated sweep gestures that are enabled on a vehicle dashboard, in accordance with an embodiment of the present invention. FIG. 44 shows dashboard display 423 having proximity sensors along its edges. In some embodiments of the present invention, the display itself does not provide touch detection, i.e., it is not a touch screen. A frame 528 is shown surrounding the display. This frame indicates a detection zone for detecting proximity and hover gestures. The display shows two icons 424 and 425 in the upper right and left corners, each representing a family of related functions. When the driver performs a sweeping gesture with his hand above a portion of the display, he expands a corresponding icon to reveal a complete set of related functions.

[0134] FIG. 45 shows the effect of a gesture in this context. Dashboard display 423 is shown in the upper portion of FIG. 45 marked (A). A sweeping gesture across the upper left corner of the display and continuing diagonally across the display is indicated by arrows 426. As the gesture progresses across the screen diagonal, icon 425 expands across the screen. The expanded icon is shown as Icon 427 in the lower portion of FIG. 45 marked (B). In some embodiments, this expanded area is populated with icons related to the function represented by icon 425. In other embodiments, the expanded icon presents further options for similar gestures that expand, providing multiple layers of expanded screens.

[0135] Embodiments of the present invention thus provide easy access to an extensive array of functions with a simple hand gesture in an associated corner or side of the display. This allows the user interface to present a limited number of icons on the initial display without cluttering up the display, and to expand a selected icon to reveal a full list of related functions in response to the aforementioned sweeping gesture.

[0136] FIG. 46 shows dashboard display 423 with four icons 428, 429, 431 and 432 in the four corners of the display and a text box 430 at the right edge of the display. Eight arrows 433-440 indicating eight different sweep gestures are shown. Each sweep gesture changes the display in accordance with an icon or text associated with that gesture. In FIG. 46, gestures 433, 435, 437 and 439 are each associated with a respective icon, and gesture 436 is associated with text 430. Additional gestures such as gliding along the edges of the display also provide functionality in some embodiments.

[0137] The hover and proximity sensors that detect the dashboard sweep gestures described hereinabove are substantially the same sensors described with respect to the steering wheel. These sensors are distributed at discrete locations around the dashboard display.

[0138] In the foregoing specification, the invention has been described with reference to specific exemplary embodiments thereof. It will, however, be evident that various modifications and changes may be made to the specific exemplary embodiments without departing from the broader spirit and scope of the invention. Accordingly, the specification and drawings are to be regarded in an illustrative rather than a restrictive sense.

1-21. (canceled)

22. An adjustable mirror, comprising:

- a mirror within a fixed housing, whereby at least one angle of the mirror relative to the housing is adjustable;
- electrical equipment within the housing and attached to the rear of said mirror, operative to adjust the at least one angle of said mirror;
- a rounded surface projecting toward an operator of said mirror; and
- a sensor, connected to said electrical equipment, operative to detect the operator's hand following said rounded surface, and to instruct said electrical equipment to adjust the at least one angle of said mirror in response to the detection.

23. The adjustable mirror of claim **22**, wherein in response to said sensor detecting the operator's hand rotating as a tangent around said rounded surface, said sensor instructs said electrical equipment to rotate said mirror in the same direction as the operator's hand.

24. The adjustable mirror of claim **22**, wherein said mirror is a vehicle side-view mirror and said rounded surface is a portion of a steering wheel for the vehicle.

25. The adjustable mirror of claim **24**, wherein said rounded surface is the hub of the steering wheel.

26. An adjustable mirror, comprising:

- a mirror within a fixed housing, whereby at least one angle of the mirror relative to the housing is adjustable;

- electrical equipment within the housing and attached to the rear of said mirror, operative to adjust the at least one angle of said mirror;

- a rounded surface projecting toward an operator of said mirror;

- a sensor operative to generate outputs for detecting the operator's hand following said rounded surface;

- a processor that receives the sensor outputs and that controls said electrical equipment;

- memory; and

- a program stored in said memory and configured to be executed by said processor, the program including instructions causing said processor to control said electrical equipment to adjust the at least one angle of said mirror in response to the sensor outputs.

27. The adjustable mirror of claim **26**, wherein said program includes instructions whereby in response to the sensor outputs indicating that the operator's hand is rotating as a tangent around said rounded surface, said processor causes said electrical equipment to rotate said mirror in the same direction as the operator's hand.

28. A non-transitory computer readable storage medium storing one or more programs, the one or more programs comprising instructions which, when executed by a processor, cause adjustment of orientation of a mirror in response to detection signals, wherein the processor is connected to a sensor and connected to electrical equipment, wherein the sensor is operable to output detection signals indicating movement of a hand along a rounded surface projecting toward the hand, and wherein the electrical equipment is operable to adjust at least one angle of the mirror relative to a fixed housing of the mirror.

29. The non-transitory computer readable storage medium of claim **28**, wherein the one or more programs include instructions whereby in response to sensor detection signals indicating that the hand is rotating as a tangent around the rounded surface, the processor causes the mirror to be rotated in the same direction as the hand.

* * * * *