

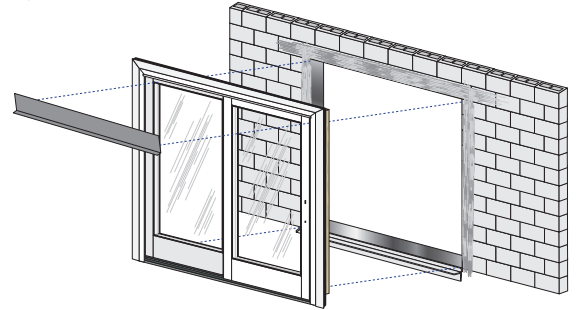

PELLA INSTALLATION INSTRUCTIONS SLIDING DOORS WITH FLUSH FLANGE OR ENDURACLAD EXTERIOR TRIM FOR REPLACEMENT

THE FOLLOWING INSTALLATION METHODS ARE INCLUDED IN THIS BOOKLET:

Flush Flange Sliding Doors into Masonry Openings with Wood Bucks



Pocket Replacement with Flush Flange

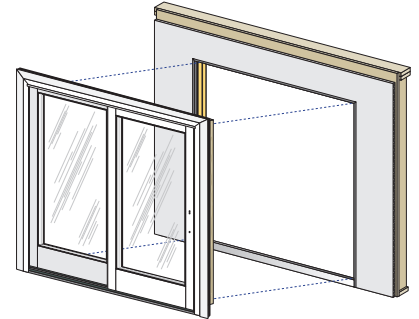

Full Frame Replacement of a Wood Brickmould Door with Sliding Doors with Pella® EnduraClad® Exterior Trim

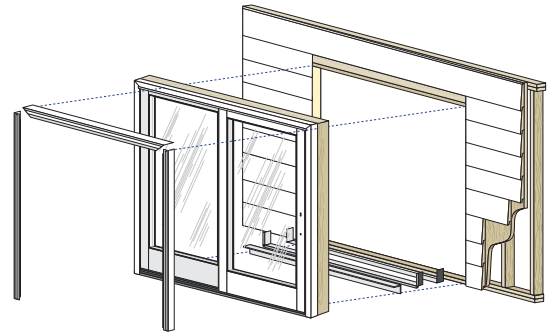

Full Frame Replacement in Stucco with Flush Flange

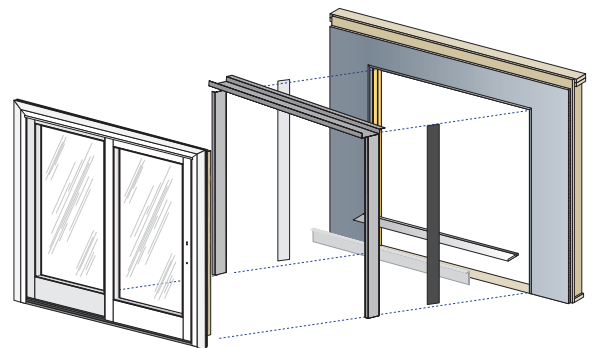

These instructions were developed and tested for use with wall systems designed to manage water. **These instructions are not to be used with any other construction methods or window frame types.** Installation instructions for use with other construction methods or frame types may be obtained from Pella Corporation, your local Pella retailer or www.installpella.com. Building designs, construction methods, building materials, and site conditions unique to your project may require an installation method different from these instructions and/or additional care. Determining the appropriate installation method is the responsibility of you, your architect, or construction professional.



BY PURCHASING, INSTALLING OR USING PELLA PRODUCTS (INCLUDES PELLA GOODS AND PELLA SERVICES), YOU AGREED TO THE TERMS OF THE LIMITED WARRANTY AND YOU AND PELLA FURTHER AGREE TO ARBITRATE DISPUTES ARISING OUT OF OR RELATING TO PELLA PRODUCTS, AND YOU WAIVE ANY RIGHT TO PARTICIPATE IN A CLASS ACTION RELATED TO PELLA PRODUCTS unless you notify Pella of your decision to opt out of the Arbitration Agreement no later than ninety (90) calendar days from the date you purchased or otherwise took ownership of Your Pella Goods. Opting out of the Arbitration Agreement will not affect the coverage provided by any applicable limited warranty pertaining to Your Pella Products. For opt out information and additional details please read the Limited Warranty and Arbitration Agreement for your Pella Products at www.Pella.com/arbitration.



CAUTION: Many doors in older homes are painted with lead-based paint. Removal of old doors may disturb this paint. Proper precautions must be taken to minimize exposure to dust and debris. Consult state or local authorities and/or go to www.epa.gov/lead for more information.

WARNING: To ensure safety and security and help prevent property damage, including possible damage to your window or door, close and lock windows and doors any time they are not being used for venting on a nice day, and particularly during high winds or rain.

IMPORTANT NOTICE

Because all construction must anticipate some water infiltration, it is important that the wall system be designed and constructed to properly manage moisture. Pella Corporation is not responsible for claims or damages caused by anticipated and unanticipated water infiltration; deficiencies in building design, construction and maintenance; failure to install Pella products in accordance with Pella's installation instructions; or the use of Pella products in wall systems which do not allow for proper management of moisture within the wall systems. The determination of the suitability of all building components, including the use of Pella products, as well as the design and installation of flashing and sealing systems are the responsibility of the Buyer or User, the architect, contractor, installer, or other construction professional and are not the responsibility of Pella.

Pella products should not be used in barrier wall systems which do not allow for proper management of moisture within the wall systems, such as barrier Exterior Insulation and Finish Systems (EIFS) (also known as synthetic stucco) or other non-water managed systems. Except in the states of California, New Mexico, Arizona, Nevada, Utah and Colorado, Pella makes no warranty of any kind on and assumes no responsibility for Pella windows and doors installed in barrier wall systems. In the states listed above, the installation of Pella Products in barrier wall or similar systems must be in accordance with Pella's installation instructions. Product modifications that are not approved by Pella Corporation will void the warranty.

Care and Maintenance

Care and maintenance information is available by contacting your local Pella retailer. This information is also available at www.pella.com.

Cleaning Instructions

GLASS—Remove any protective film and labels and clean the glass, using a soft, clean, grit-free cloth and mild soap or detergent. Be sure to remove all liquid by wiping dry or use a clean squeegee.

FACTORY FINISHED PRODUCT: Pella Product that has been prefinished with stain or paint from the factory requires no additional finishing. Clean the surface with mild soap and water.

PELLA® ALUMINUM CLAD OR IMPERVIA FRAMES: The interior and exterior frame and panels are protected with a tough factory finish. Clean this surface with mild soap and water. Stubborn stains and deposits may be removed with mineral spirits. DO NOT use abrasives. DO NOT scrape or use tools that might damage the surface.

ENCOMPASS BY PELLA®, PELLA 250° SERIES AND PELLA® 150 SERIES DOOR FRAMES: The vinyl frame may be cleaned using the same method as the glass. For stubborn dirt, a "non-abrasive" cleaner such as Bon-Ami® or Soft Scrub® may be used. Do not use solvents such as mineral spirits, toluene, xylene, naphtha or muriatic acid as they can dull the finish, soften the vinyl and/or cause failure of the insulated unit seal. Do not use Isopropyl Alcohol on laminated surfaces as it will damage the finish. Keep door tracks clear of dirt and debris. Keep weep holes open and clear of obstructions.

DO NOT use abrasives. DO NOT scrape or use tools that might damage the surface.

Notice: DO NOT use inappropriate solvents or brickwash or cleaning chemicals. If you do, permanent damage can result and the product failure, loss or damage would not be covered by the Limited Warranty.

Finishing Instructions (Wood Patio Doors and Fiberglass Entry Doors)

Paint or finish immediately after installation.

If products cannot be finished immediately, cover with clear plastic to protect from dirt, damage and moisture. Remove any construction residue before finishing. Sand all wood surfaces lightly with 180 grit or finer sandpaper. DO NOT use steel wool. BE CAREFUL NOT TO SCRATCH THE GLASS. Remove sanding dust. Pella products must be finished according to these instructions; failure to follow these instructions voids the Limited Warranty. Finishing panel edges is optional for Patio Doors.

Note: To maintain proper product performance do not paint, finish or remove the weatherstripping, mohair dust pads, gaskets or vinyl parts. Air and water leakage will result if these parts are removed. After finishing, allow venting Doors and doors to dry completely before closing them. If paint, stain or finish gets on the weatherstripping, wipe it off immediately with a damp cloth.

Panel Cleaning and Prep Instructions for Unfinished or Primed Panels: Dry wipe dust from doors gently. Examine door for possible smudges or fingerprints made from normal handling or construction. To remove smudges, lightly wipe surface with warm water. DO NOT sand surface of fiberglass panel. Scuff sand with light grade sand paper or abrasive pad (220 grit or higher). Rinse surface with mineral spirits for fiberglass panels and warm water for steel panels. Let door and sidelight surfaces dry completely before applying finish. Finish the door panels as soon as possible after installation.

STAINING FIBERGLASS PANELS OR UNFINISHED INTERIOR FRAME MEMBERS: Fiberglass door and sidelight panels may be stained with a gel stain if a wood look is desired. Pella offers stain kits in a variety of colors. Apply and finish per the stain kit manufacturer's instruction. Ensure that all exposed panel edges are finished to minimize the chance of damage.

Unprimed interior frame parts may be stained with wood stains and should be finished with a minimum of two coats of a clear polyurethane finish. DO NOT bridge the top coat between the outer edge of the glazing frame and the door panel.

NOTE: The fiberglass base color tone will vary. This variance is normal and will not impact the stain color of the door.

PAINTING INSTRUCTIONS: Wood door frame exteriors, premium steel door panels and sidelights are factory primed. Wood doors require painting immediately after installation. The factory applied primer is not intended for long term exterior exposure. Sand all un-primed interior wood surfaces lightly with 180 grit or finer sandpaper before priming and painting. Fiberglass door and sidelight panels do not require priming. Use two coats of a 100% latex paint that has a good blocking resistance. On units with glass, do not bridge paint between the outer edges of the glazing frame and the door panel. On fiberglass products, brush the paint in the same direction as the simulated wood grain. For entry doors, ensure that all exposed panel edges are finished to minimize the chance of panel damage. Finishing panel edges is optional for Patio Doors.

Pella Corporation is not responsible for interior paint and stain finish imperfections for any product that is not factory-applied by Pella Corporation. For additional information on finishing see the Pella Owner's Manual or go to www.pella.com.

The use of unapproved finishes, solvents or cleaning chemicals may cause adverse reactions with door materials. Pella will not be responsible for problems caused by the use of unapproved materials. If in doubt, contact your local retailer or representative.

Exterior Finish of Existing Frame (Pocket Replacement)

It is the responsibility of the homeowner, contractor or installer to ensure any exposed unfinished wood is covered or finished. Possible methods include, however are not limited to, covering with aluminum coil stock or painting.



FULL FRAME OR PANEL REMOVAL WHEN PREPARING TO INSTALL A NEW SLIDING DOOR

CAUTION: Many doors in older homes are painted with lead-based paint. Removal of old doors may disturb this paint. Proper precautions must be taken to minimize exposure to dust and debris. Consult state or local authorities for more information and/or go to www.epa.gov/lead for more information.

TOOLS REQUIRED:

- Utility knife 
- Pry bar 
- Hammer 
- Heat gun 
- Angle grinder 
- Phillips and Standard screwdrivers 
- Reciprocating saw 
- Putty knife 
- Deglazing wheel 

REMEMBER TO USE APPROPRIATE PERSONAL PROTECTIVE EQUIPMENT.

Apply adhesive film or duct tape to the glass to prevent breakage.

ALUMINUM PANEL AND/OR FRAME REMOVAL

- Score the paint or varnish** between the interior trim and the wall or between the drywall return and the door frame to minimize damage. (Frame removal only).
- Remove the interior trim.**
- Score the sealant or paint** between the exterior siding or brick and the door frame.
- Remove the screen and vent panel** from the old door. If it is not removable, see steps G-I.
- Remove the division bar** by removing the screws at the ends or cutting it with a reciprocating saw.
- Remove the other panel.** Remove any screws holding the fixed panel. Slide it and lift it out of the frame.

If the panels are not removable or the glass is sealed to the frame:

- Remove the glazing bead** using a putty knife or small pry bar.
- For single pane doors with divided lights (grids).** Use an angle grinder with a cut-off wheel to cut the end of the bars where they intersect with the sash or frame. This will allow the door glass to be removed more quickly.
- Heat the glazing seal** using an electric heat gun.
- While applying heat, press a de-glazing wheel** between the glass and panel or frame. Continue around the perimeter of the panel. Apply light, constant pressure to separate the glass from the panel or frame. Dispose or recycle of the glass properly.

NOTE: Wear appropriate personal protective equipment and keep the heat source away from flammable materials.

Stop here for pocket replacement, complete steps K-L for full frame replacement (Not applicable for flush flange pocket replacement).

- Cut through the frame using a reciprocating saw.**
- Pry the frame away from the brick or siding.** Use a block of wood under the pry bar to protect interior or exterior finishes. Dispose or recycle of the frame materials properly.

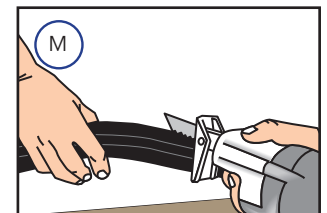
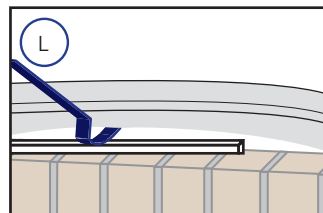
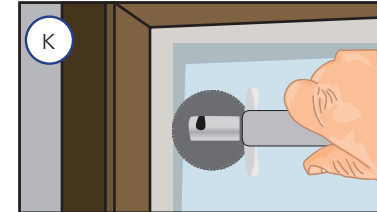
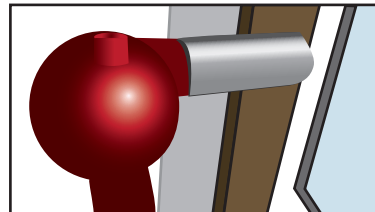
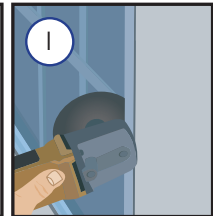
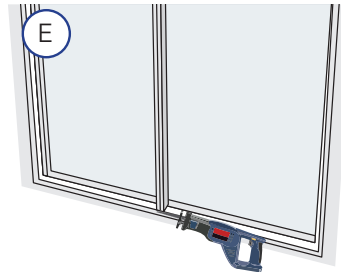
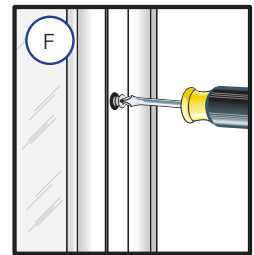
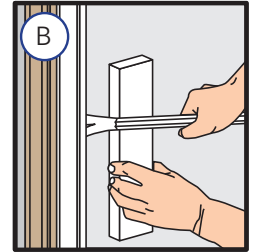

BRICKMOULD FRAME REMOVAL

- Score paint or varnish** between the interior trim and the wall with a sharp utility knife.
NOTE: This will minimize the damage to the interior wall and trim.
- Remove the interior trim.** Remove the interior trim from all the four sides of the door including the stool at the bottom of the door. If the interior trim is being reused, pull the nails out through the back side of the board with nipper pliers.
- Cut the exterior sealant line** between the exterior brickmould or trim and the exterior siding or wall cladding.
- Remove the exterior brickmould or flat trim.**
Remove hinge and strike screws.
NOTE: DO NOT disturb existing head flashings.
- Remove the door frame.**

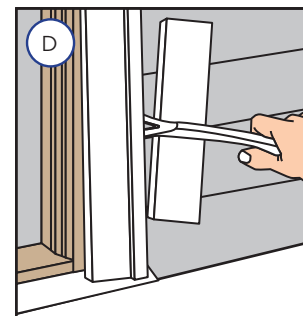
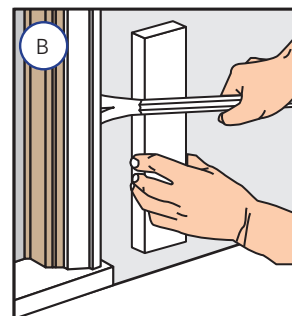

Consult with local providers and authorities to recycle or properly dispose of old door components.



PREPARING FOR SLIDING DOOR INSTALLATION WITH FLUSH FLANGE OR ENDURACLAD EXTERIOR TRIM FOR REPLACEMENT

YOU WILL NEED TO SUPPLY:

- Moisture resistant shims/spacers (12 to 20)
- 2" galvanized roofing nails (1/4 lb.)
- #10 x 3-1/2" corrosion resistant wood screws (Performance Upgrade & Impact-Resistant)
- Masonry screws for concrete applications (Minimum of 3/16" diameter x 3")
- Closed cell foam backer rod/sealant backer (21 to 30 ft.)
- Pella® SmartFlash™ foil backed butyl window and door flashing tape or equivalent
- Pella Window and Door Installation Sealant or equivalent high quality, multi-purpose sealant.
- Low Expansion, low pressure polyurethane insulating window and door foam sealant. DO NOT use high pressure or latex foams
- Sill pan (optional) 6-5/8" x (Rough Opening Width +2)
- Pella aluminum sill support or wood blocking
- Interior trim and/or jamb extensions (15 to 40 ft.)

INSTALLATION CLIP OPTION:

- 6" or 8" installation clips
- #6 x 5/8" corrosion resistant flat head wood screws
- #8 x 1-1/2" corrosion resistant screws or 3/16" x 1-1/2" masonry screws

TOOLS REQUIRED:

- Tape measure
- Level
- Square
- Hammer
- Stapler
- Sealant Gun
- Scissors or utility knife
- Tin Snips
- Screwdrivers (#2 Phillips with 8" shaft and small flat blade)
- Drill
- Drill Bits 13/64" and 1/8" and masonry bit for concrete applications

INSTALLATION WILL REQUIRE (2) OR MORE PERSONS FOR SAFETY REASONS.

Store doors in upright position, out of direct sunlight.

ROUGH OPENING VERIFICATION

A. Confirm the opening is plumb and level.

NOTE: It is critical the bottom is level and it does not slope to the interior or exterior.

B. Remove dirt, oil or debris from the opening and surrounding wall surfaces.

C. Confirm the door will fit the opening. Measure all four sides of the opening to make sure it is 1/2" to 3/4" larger than the door in both width and 1/2" larger in height. Measure the width and height in several places to ensure the header or studs are not bowed.

NOTE: 1-1/2" or more of solid wood blocking is required around the perimeter of the opening. Fix any problems with the rough opening before proceeding.

PREPARE THE DOOR FOR INSTALLATION

A. Remove plastic wrap and cardboard packaging from the door. On laminate units, remove protective film from parts. DO NOT open the door until it is securely fastened. DO NOT cut the strap that goes from the lock holes to the sill of the door (if applicable).

B. Inspect the product for any damage such as cracks, dents or scratches. DO NOT install damaged products.

C. Architect Series® (850) and Pella® Lifestyle Series Sliding doors: Remove the shipping spacers by sliding the movable panel halfway open and take the spacers off the top and bottom of the panel.

All Doors: Remove the vent panel prior to installation. You will need to first remove the vent panel retainer near the interlocker on the sill. Then remove the vent panel by opening the panel about 8" then lifting it out of the lower track, tilting the bottom of the panel away from the door frame, and lowering the panel out of the top track. Carefully set the panel aside. Reinstall the vent panel and panel retainer after installation of the door frame.

For 4 Panel sliding doors shipped in 2 half sections, complete the field assembly instructions before proceeding.

Encompass by Pella®, Pella® 150 Series: If reversing the door slide, refer to the instructions later in this booklet.

D. Units with wide EnduraClad Exterior trim and narrow fins with NO pre-punched holes: Install clips or pre-drill holes for frame screws.

See anchor instruction at the end of this booklet.

Additional preparation may be required for performance upgrade, impact-resistant products or to comply with local building code requirements. See advanced performance or hurricane shield anchor schedule.

Doors using clips: Secure installation clips to the frame using (2) #6 x 5/8" corrosion resistant screws. Refer to the anchor instructions at the end of this booklet.

E. Read the entire instruction before proceeding.

These instructions were developed and tested for use with wall systems designed to manage water. **These instructions are not to be used with any other construction methods or door frame types.** Installation instructions for use with other construction methods or frame types may be obtained from Pella® Corporation, your local Pella retailer or www.installpella.com. Building designs, construction methods, building materials, and site conditions unique to your project may require an installation method different from these instructions and/or additional care. Determining the appropriate installation method is the responsibility of you, your architect, or construction professional.

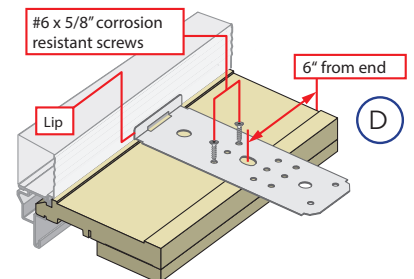
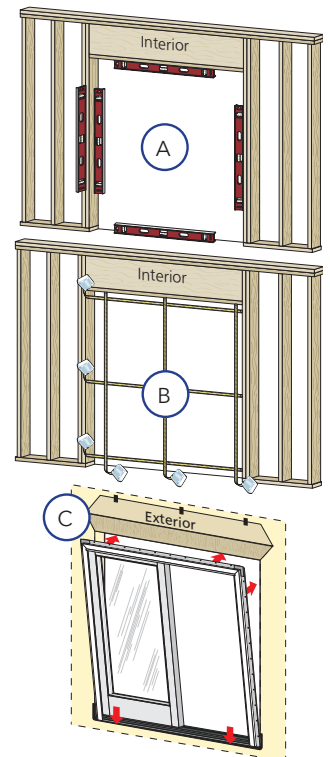

BY PURCHASING, INSTALLING OR USING PELLA PRODUCTS (INCLUDES PELLA GOODS AND PELLA SERVICES), YOU AGREED TO THE TERMS OF THE LIMITED WARRANTY AND YOU AND PELLA FURTHER AGREE TO ARBITRATE DISPUTES ARISING OUT OF OR RELATING TO PELLA PRODUCTS, AND YOU WAIVE ANY RIGHT TO PARTICIPATE IN A CLASS ACTION RELATED TO PELLA PRODUCTS unless you notify Pella of your decision to opt out of the Arbitration Agreement no later than ninety (90) calendar days from the date you purchased or otherwise took ownership of Your Pella Goods. Opting out of the Arbitration Agreement will not affect the coverage provided by any applicable limited warranty pertaining to Your Pella Products. For opt out information and additional details please read the Limited Warranty and Arbitration Agreement for your Pella Products at www.Pella.com/arbitration.

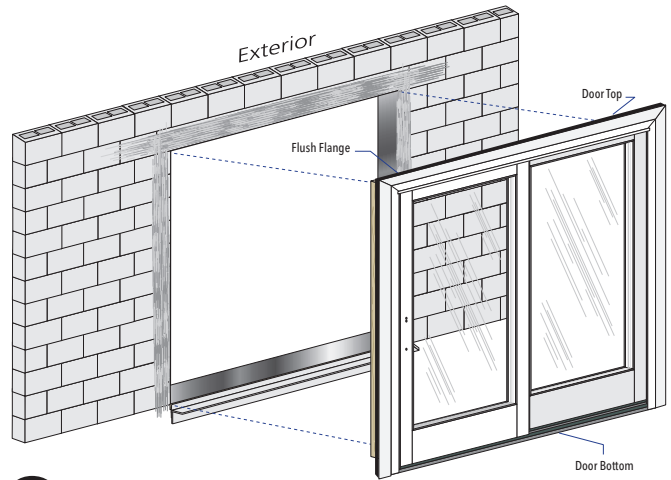
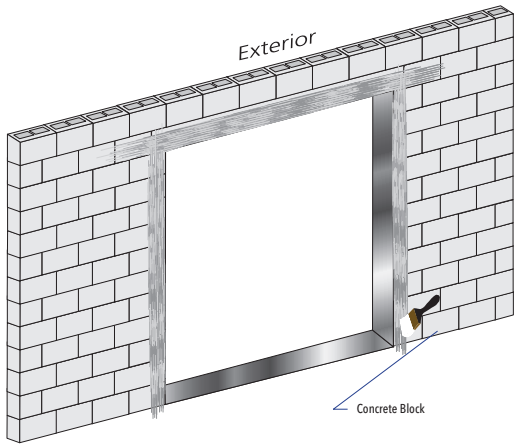

1 PREPARE THE OPENING

Refer to the installation preparation section at the beginning of this booklet.

- A. **Apply water resistant coating.** Extend the coating into the opening on all four sides and onto the wall surface at least 9". The water resistant coating may be a self-adhered sheet membrane (SASM) or a liquid applied flashing. Ensure continuity between the water resistant coating in the opening and the rest of the wall surface. SASM's must be overlapped in a water shed fashion. Apply all water resistant coatings according to the manufacturer's directions.

NOTE: Allow liquid flashing to dry according to the manufacturer's recommendations.

- B. **Apply 2 beads of sealant** to the masonry opening where the wood buck will be attached.

NOTE: Ensure the sealant is compatible with the water resistant coating.

- C. **Pre-drill and fasten the treated wood buck** to the masonry opening using code-approved fasteners and spacing. The wood buck should be recessed from surface of the masonry for flush flange doors and wood brickmould doors where siding or brick veneer is not being installed.

- D. **Apply water resistant coating (optional)** over the wood buck and onto the masonry opening. If using liquid applied flashing, allow it to dry according to the manufacturer's recommendations before proceeding.

- E. **If using an optional sill pan,** refer to the sill pan instruction page at the end of this booklet.

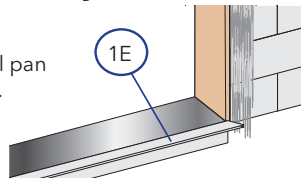
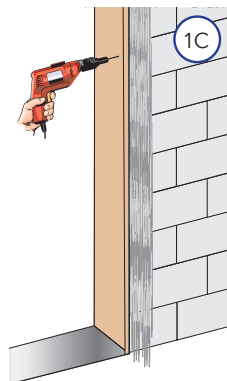
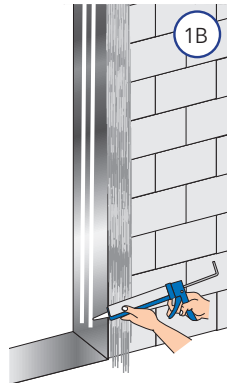
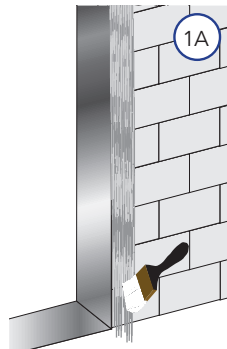

2 PREPARE THE DOOR

Architect Series® (850) and Pella® Lifestyle Series:

- A. **Install the clips into the fin grooves.** Start one corner of the clip in the fin groove. Tap the corner into the fin groove with a hammer, then continue to tap the other corner until the clip is locked into the groove.
- B. **Secure the clips to the frame.** Drive one #8 x 5/8" screw through the slotted hole in the center of the clip.

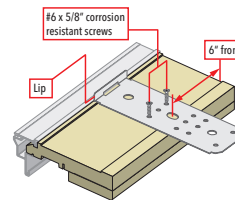
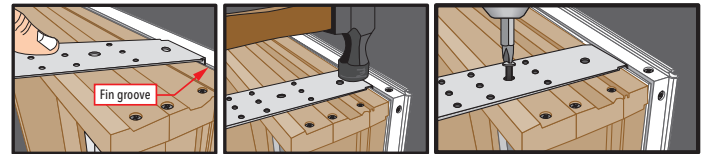

Alternatively, it is acceptable to use two #6 x 5/8" screws through the clip with the clip on its back and not engaged in the fin groove.

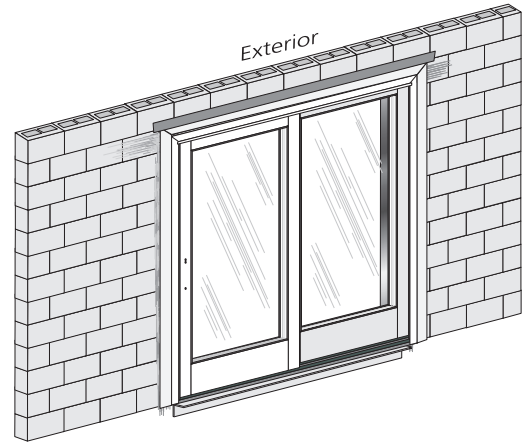
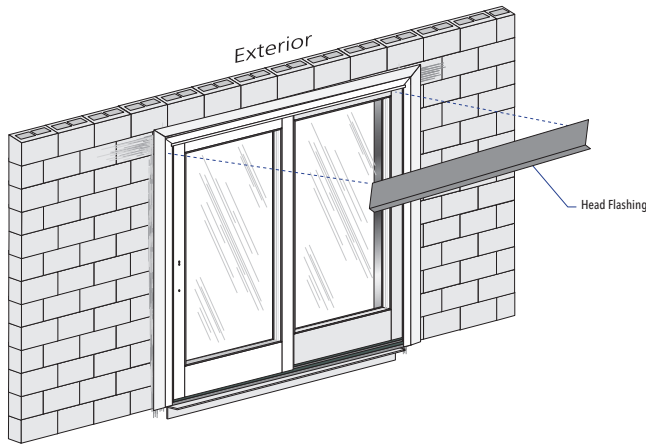

3 SETTING AND FASTENING THE DOOR

A. **Attach a Pella aluminum sill support** or wood blocking flush with the opening sill if a concrete slab will not provide support for the exterior edge of the frame and the door has no sill nailing fin.

For vinyl doors skip to step C.

B. **Dry fit the door.** Make sure that the door is plumb, square and level. Mark and drill anchor locations. Mark the interior of the door frame at the sill to show a boundary for sealant placement. Carefully remove and set the door aside.

C. **Place three 3/8" beads of sealant** across the opening sill. Place the interior-most bead 1/2" from where the interior of the door sill will remain after installation. Continue this bead 6" up each jamb. Place a second bead 1/2" from the exterior of the framing. Place a 3rd bead in the groove of the sill support or 1/4" from the exterior edge of the wood blocking. The 3rd bead is not necessary for vinyl doors with sill nail fins. **Proceed to step 2F.**

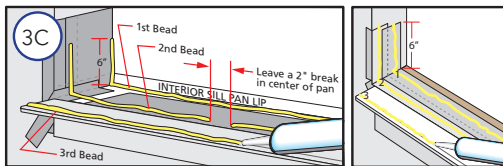

Vinyl Doors use steps C-F:

D. **Remove the sill track** by beginning at one end and carefully pulling it up. This will expose the slide panel pocket.

NOTE: A hooked tool like an Allen wrench will easily get the track started.

E. **Drill 3/16" holes through the sill every 18"**, starting from each corner and 1-3/16" from the interior. Counter-drill with a 3/8" bit through the first wall of the door frame only. Use a drill guide set 1/4" from the end of the bit to prevent drilling through the second wall.

F. **Apply 2 continuous 1/4" to 3/8" diameter beads of sealant** across the sill of the opening and 12" up the jambs, towards the interior side of the door (between the anchor holes and interior edge of door). **DO NOT** apply sealant between the anchor holes and the exterior side of the sill plate or floor.

NOTE: Failure to properly seal the sill attachment screws and sill plate may allow water to penetrate the interior of the home.

All Doors:

G. **Apply sealant** to the back of the brickmould or flush flange.

H. **Center the bottom of the door in the opening** and tilt the door into position. Do not slide the door into the opening. Sliding will damage the sealant lines.

Check the jambs for plumb and confirm there is room for shimming between the jambs and opening on each side.

I. **Plumb and square the door.** Place shims at lock strike. Keep shims 1/2" short of door frame depth. Insert additional shims starting 6" from the bottom as needed to keep jambs straight and panel reveals even on all four sides.

NOTE: Additional shims are required at screw locations for advanced performance, impact-resistant units and combinations. See the anchor instructions at the end of this booklet.

3 SETTING AND FASTENING THE DOOR (CONTINUED)

J. **Check the door placement by measuring** from the interior surface of the door frame or jamb extension to the interior surface of the wall for consistency.

K. **Drive screw(s) into the keeper strike on the vent side of 2 panel doors.** Refer to the anchoring instructions at the end of this booklet.

L. **Position and secure the roller retainer** by drilling holes through the remaining holes and insert a screw in each hole. (Refer to the anchor instructions at the end of this booklet or in the hardware package.)

M. **Install the sliding panel.** From the exterior, tilt the top of the panel and insert it into the top track. Move the bottom of the panel toward the door frame and set it on the bottom track. Be careful not to pinch your fingers between the two panels. **DO NOT** close the sliding panel until the hardware is installed. The door may lock when closed.

N. **Check door operation.**

NOTE: Adjust shims to correct any issues with plumb, square, operation or reveal.

O. **Install panel retainers.** Refer to the instructions included in the panel retainer hardware package.

WARNING Panel Retainer **MUST** be installed to reduce risk of serious injury or death from a falling door panel. If panel retainer is lost or damaged, **DO NOT** INSTALL DOOR. Contact your Local Pella Retailer or Pella Customer Service (877) 473-5527 for replacement.

Install bumpers (if applicable). Refer to the anchor instructions at the end of this booklet.

P. **Install the handles.** Refer to the instruction in the hardware box.

Q. **Adjust the panel height to ~1/8" clearance to head of unit** by removing the hole cover and using a #2 Phillips screwdriver to turn the roller adjustment screw clockwise (raise) or counterclockwise (lower).

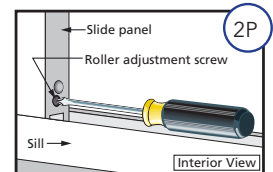

NOTE: For doors with heavy impact-resistant or triple pane glass use a small pry bar to raise the panel while turning the adjustment screw. This will prevent the threads from being stripped.

R. **Adjust the footbolt (if applicable)** refer to the anchor instructions at the end of this booklet.

S. **Encompass by Pella® and Pella® 150 Series doors:** Install the keeper and adjust the lock hook (if necessary). Refer to the anchor instructions at the end of this booklet.

T. **Check door operation** by opening and closing the door.

U. **Install interior sealant.** Refer to the interior sealant instructions at the end of this booklet.

V. **Install head flashing,** properly incorporating it with the siding and water management system according to applicable code requirements.

W. **Install exterior sealant.** (After wall cladding is installed) Refer to the exterior sealant instructions at the end of this booklet.



POCKET REPLACEMENT WITH FLUSH FLANGE

FOR THE INSTALLATION OF NEW FLUSH FLANGE DOORS IN EXISTING ALUMINUM FRAMES WITH STUCCO WALLS IN ARID CLIMATES

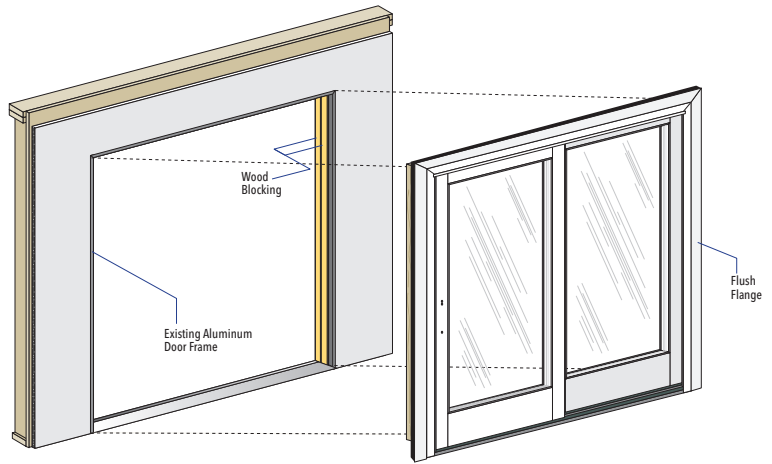
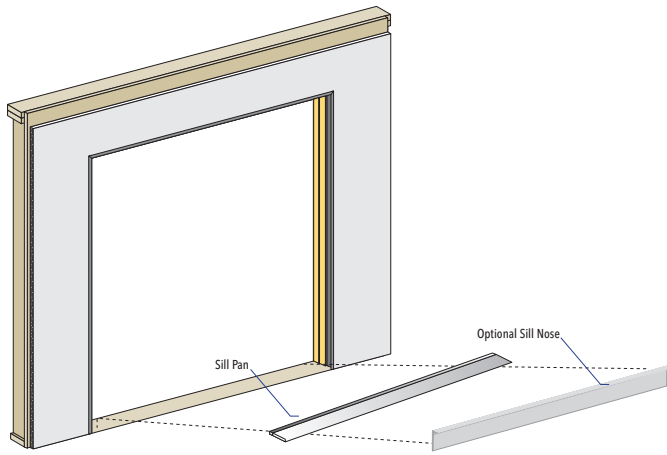

1 PREPARE THE OPENING

- A. Measure the width and height of the opening in the remaining aluminum frame after sash/glass removal. The new door must be 1/2" to 3/4" smaller in width and height.
- B. Remove the sash and/or glass from the existing aluminum door. It may be necessary to cut the divider between the venting panel and fixed glass areas with a reciprocating saw. Refer to the sash removal instructions at the beginning of this booklet.

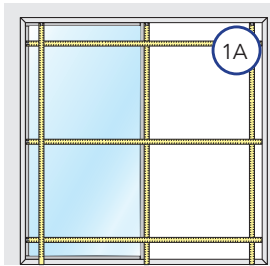

- C. Cut the existing door sill out of the opening as close to the jamb as possible using a reciprocating saw or side grinder.
- D. Clean the existing frame and sill so it is free of dirt and debris.
- E. Remove the door lock strike from the lock jamb of the existing door frame.
- F. Place a bead of sealant at each joint where the existing door frame jams meet the existing door sill pieces. Fill any holes in the jamb and head with sealant.
- G. If the weep holes of the existing sill have been cut away, drill new weep holes in the existing door jambs. Be sure to drill weep holes in all vertical jamb legs, except the most interior leg.

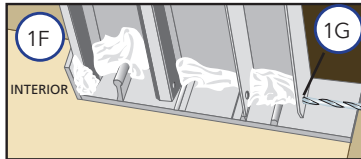

NOTE: Ensure all new or existing weep holes are open before proceeding with the installation.

- H. Cut one piece of flashing tape 6" longer than the existing aluminum frame width.
- I. Cut wood blocking to fill the channels in the head and jambs of the existing door frame. The blocking will support new shims and hinge screws. The blocking should be flush with the protruding legs of the frame.
- J. Set the blocking in 3/16" sealant lines and secure with #8 x 2-1/2" screws.
- K. Construct a sill pan for the door. Measure the rough opening width and add 2". Measure 1" up from each end and cut through the vertical leg of the pan material. If there is a step down at the exterior of the door opening, make the sill pan depth equal to the door frame depth - 2-1/8". If there is NO step down, make the sill pan depth equal to the frame depth. Bend the bottom (side) flaps of the pan material up, then bend the back leg around the end of the pan.

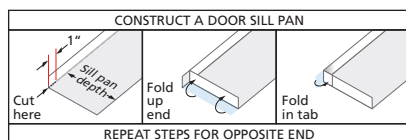
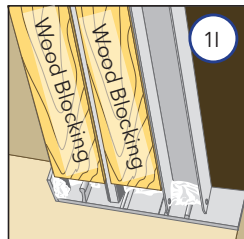

Dry fit the sill pan and the door into the opening.

1 PREPARE THE OPENING (CONTINUED)

For three-sided flush flange doors:

- L. If there is a step down at the exterior of the door opening, cut the sill nosing to the rough opening width plus two times the flange width. Notch the sill nosing. If there is NO step down, skip to step M.

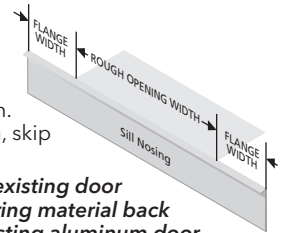

NOTE: If the new door frame is deeper than the existing door frame, it will be necessary to cut the interior flooring material back to allow the door flush flanges to contact the existing aluminum door frame.

- M. Apply lines of 3/8" diameter sealant across the rough opening sill in the location shown. Make sure the lines of the sealant covers the area between the stucco and rough opening.
- N. Place a 3/8" bead of sealant at each corner of the rough opening from the stucco along the edge of the rough opening as shown.

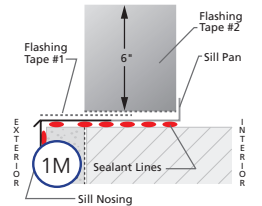

NOTE: It is important to avoid letting the sealant skin over prior to applying the sill pan.

- O. If using sill nosing with a step down, install the sill pan and sill nosing into the opening. Press down to seal them into the opening. DO NOT overlap.
- P. Apply sealant at nosing ends continuing from the front of the sill pan around the exterior surface of the wall where the sill nosing will end.
- Q. Cut two pieces of flashing tape 12" longer than the rough opening width. Place tape #1 across the sill nosing just up to where the nosing begins to slope down and extending 6" up each jamb. Apply the second piece of flashing tape over-lapping the first piece and the exterior edge of the sill pan and 6" up each jamb.

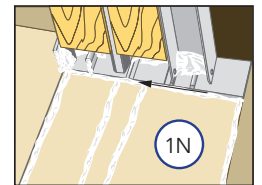

NOTE: Fix any problems before proceeding.

If the flange(s) must be trimmed to fit in a recessed opening, use a utility knife or circular saw for vinyl or fiberglass flanges. Use an electric scissor-style shear for aluminum flanges.

Steps P and Q apply only to aluminum clad wood doors.

- R. Apply Pella SmartFlash tape across the head of the door extending 6" down each jamb.
- S. Place the tape starting on the aluminum cladding and extending onto the wood frame.
- T. Place three 3/8" beads of sealant. Place the first beads sealant 1/2" in front of the base of the interior sill pan lip. This bead should also continue up the corner of the sill pan at each end, sealing the vertical joints of the sill pan and up 6" onto each jamb side of the rough opening. The second bead should be approximately 1/2" from the exterior edge of the frame wall, running from jamb to jamb with a 2" break in the middle of the opening. Place a third sealant bead 1/4" from the exterior edge of the flat portion of the sill nose or the sill pan. Start and stop this sealant line 1" from each jamb.

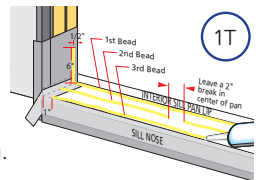



POCKET REPLACEMENT WITH FLUSH FLANGE

FOR THE INSTALLATION OF NEW FLUSH FLANGE DOORS IN EXISTING ALUMINUM FRAMES WITH STUCCO WALLS IN ARID CLIMATES

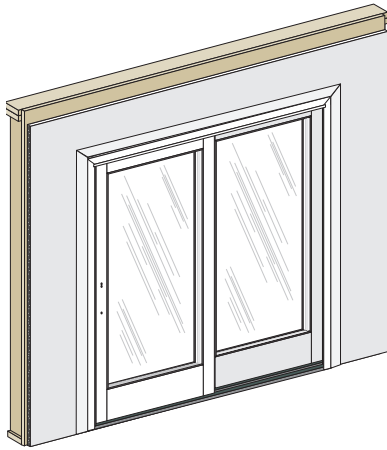

2 SET AND FASTEN THE DOOR

- A. Apply a 3/8" bead of sealant to the back of the flush flange. On 4-sided flush flange doors, leave 1" gaps in the sealant at each end of the door sill.
- B. Center the bottom of the door in the opening and tilt the door into position. Do not slide the door into the opening. Sliding will damage the sealant lines.
- C. Plumb and square the door. Place shims at the lock strike. Keep shims 1/2" short of door frame depth. Insert additional shims starting 6" from the bottom as needed to keep jambs straight and plumb.

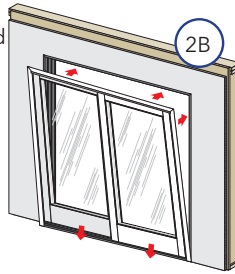

NOTE: Additional shims are required at screw locations for advanced performance, impact-resistant units and combinations and combinations. See the nail fin anchor instructions at the end of this booklet.

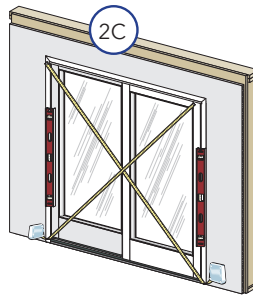

- D. Check the door placement by measuring from the interior surface of the door frame or jamb extension to the interior surface of the wall for consistency.
 - E. Drive screw(s) into the keeper strike on the vent side of 2 panel doors. Refer to the anchoring instructions at the end of this booklet.
 - F. Drive additional anchor screws through the frame. Shim as required at each location. Refer to anchoring instructions at the end of this booklet.
 - G. Install the sliding panel. From the exterior, tilt the top of the panel and insert it into the top track. Move the bottom of the panel toward the door frame and set it on the bottom track. Be careful not to pinch your fingers between the two panels. DO NOT close the sliding panel until the hardware is installed. The door may lock when closed.
 - H. Check door operation.
- NOTE:** Adjust shims to correct any issues with plumb, square, operation or reveal.

2 SET AND FASTEN THE DOOR (CONTINUED)

- I. Install panel retainers. Refer to the instructions included in the panel retainer hardware package.

WARNING Panel Retainer **MUST** be installed to reduce risk of serious injury or death from a falling door panel. If panel retainer is lost or damaged, DO NOT INSTALL DOOR. Contact your Local Pella Retailer or Pella Customer Service (877) 473-5527 for replacement.

Install bumpers (if applicable). Refer to the anchor instructions at the end of this booklet.

- J. Install the handles. Refer to the instruction in the hardware box.
- K. Adjust the panel height to ~1/8" clearance to head of unit by removing the hole cover and using a #2 Phillips screwdriver to turn the roller adjustment screw clockwise (raise) or counterclockwise (lower).

NOTE: For doors with heavy impact-resistant or triple pane glass use a small pry bar to raise the panel while turning the adjustment screw. This will prevent the threads from being stripped.

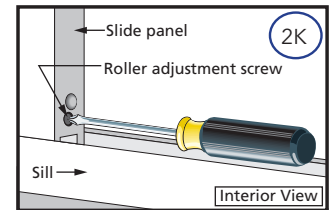

- L. Adjust the footbolt (if applicable) refer to the anchor instructions at the end of this booklet.
- M. Encompass by Pella® and Pella® 150 Series doors: Install the keeper and adjust the lock hook (if necessary). Refer to the anchor instructions at the end of this booklet.
- N. Check door operation by opening and closing the door.
- O. Install interior sealant. Refer to the interior sealant instructions at the end of this booklet. Use additional sealant around clips to prevent air and water infiltration.
- P. Install exterior sealant around the edge of the flush flange at the top and sides.

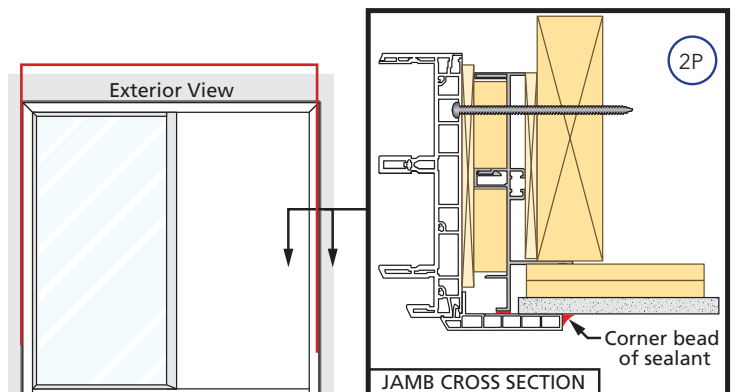



FULL FRAME REPLACEMENT WITH ENDURACLAD BRICKMOULD
FULL FRAME REPLACEMENT OF WOOD BRICKMOULD DOORS WITH NEW PELLA® ENDURACLAD® EXTERIOR TRIM

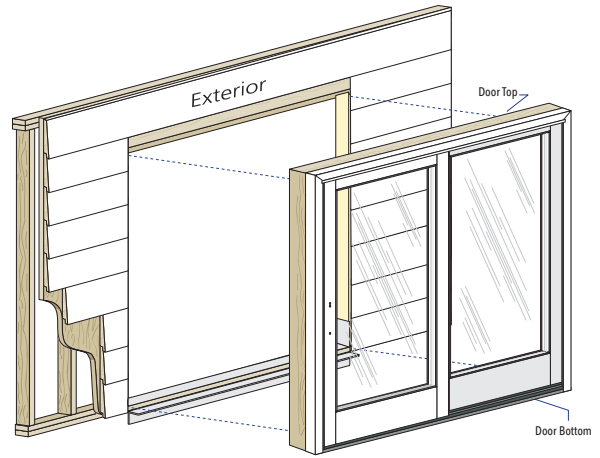
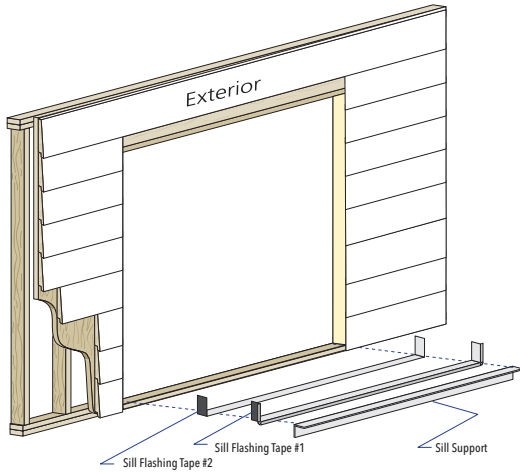

1 PREPARE THE OPENING

Refer to the brickmould frame removal instructions at the beginning of this booklet.

- A. **Measure the width and height** of the brick/siding opening and the rough opening. The new brickmould must be 1/2" to 3/4" smaller than the brick/siding opening. The new window frame must be 1/2" to 3/4" smaller than the rough opening in width and at least 3/8" smaller in height.
- B. **Repair the wall surface around the opening** (if necessary) by installing new blocking flush with the surface of the existing sheathing. Repair the existing building wrap with by cutting it flush with the rough opening and covering any gaps with flashing tape.

Applications with Building Wrap

- C. **Install head flashing** by applying sealant to the back of the upturned leg and inserting the upturned leg behind the building wrap as shown.

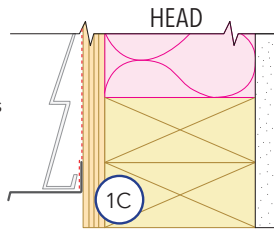

Applications without Building Wrap (steps D and E).

- D. **Cut a piece of flashing tape** equal to the width of the rough opening.
- E. **Apply the tape across the top** of the rough opening so it extends onto the surface of the wall at least 1". Place the tape below any existing head flashing.
- F. **Cut 2 pieces of flashing tape** 12" longer than opening width.
- G. **Apply sill flashing tape #1** at the sill extending 1" to the exterior and 6" up each jamb.
- H. **Cut 1" wide tabs at each corner** by tearing the foil 1/2" each way from corner.
- I. **Apply sill flashing tape #2** overlapping tape #1 by 1" minimum.

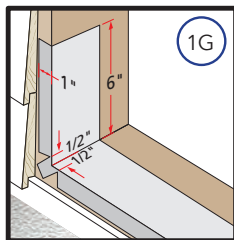
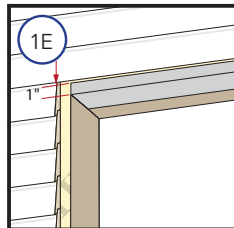

NOTE: Press all tape down firmly.

- J. **Attach a Pella aluminum sill support** or wood blocking flush with the opening sill to support the exterior edge of the door frame if existing materials will not provide support. Skip this step for doors with sill nailing fins.

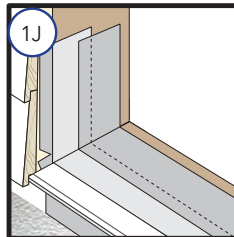
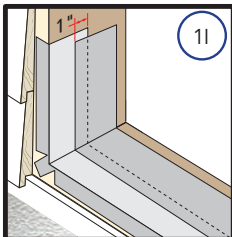

2 SETTING AND FASTENING THE DOOR

- A. **Place three 3/8" beads of sealant** across the opening sill. Place the interior-most bead 1/2" from where the interior of the door sill will remain after installation. Continue this bead 6" up each jamb. Place a second bead 1/2" from the exterior of the framing. Place a 3rd bead in the groove of the sill support or 1/4" from the exterior edge of the wood blocking.

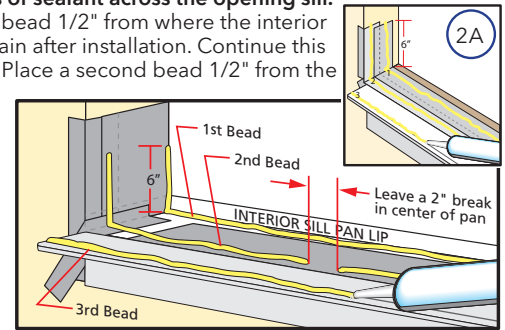

- B. **Place a continuous 3/8" bead of sealant** on the weather barrier (or sheathing if weather barrier is not present) along the jambs and head, approximately 1/2" from the rough opening edge.

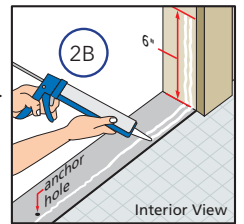

- C. **Insert the door from the exterior of the building** DO NOT slide the bottom of the door into the opening. Sliding will damage the sealant lines. Place the bottom of the door at the bottom of the opening with the door centered between the sides of the opening to allow for shimming, then tilt the top into position.

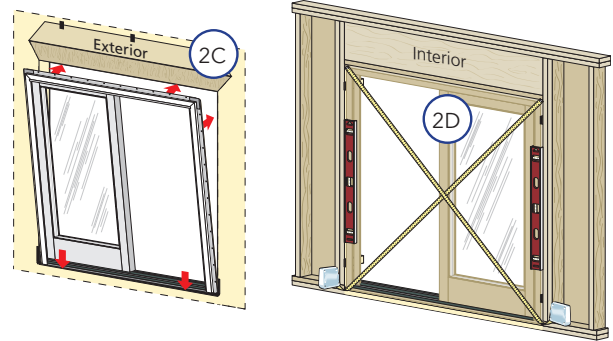

- D. **Plumb and square the door.** Place shims at each lock strike. Keep shims 1/2" short of door frame depth. Insert additional shims starting 6" from the bottom as needed to keep jambs straight and panel reveals even on all four sides.

NOTE: Additional shims are required at screw locations for advanced performance, impact-resistant units and combinations. See the anchor instructions at the end of this booklet.

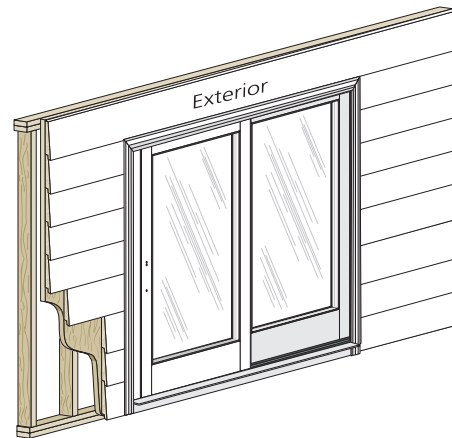
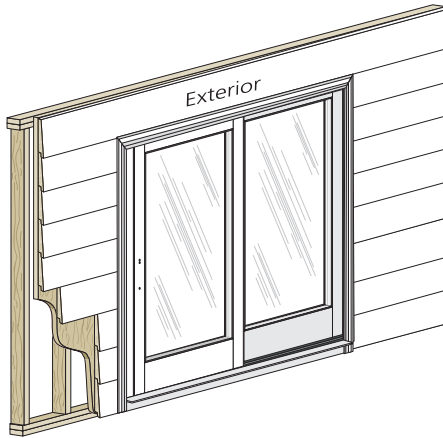

2 SETTING AND FASTENING THE DOOR (CONTINUED)

- E. Check the door placement by measuring from the interior surface of the door frame or jamb extension to the interior surface of the wall for consistency.
- F. Pre-drill and drive two screws one near the top of each side of the door through the frame or clip. (See anchor instructions at the end of this booklet for screw or clip spacing.)

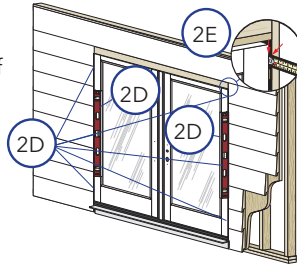

Refer to the anchor instructions at the end of this booklet.

- G. Drive screw(s) into the keeper strike on the vent side of 2 panel doors. Refer to the anchoring instructions at the end of this booklet.
- H. Drive additional anchor screws through the frame. Shim as required at each location. Refer to anchoring instructions at the end of this booklet.
- I. Install the sliding panel. From the exterior, tilt the top of the panel and insert it into the top track. Move the bottom of the panel toward the door frame and set it on the bottom track. Be careful not to pinch your fingers between the two panels. DO NOT close the sliding panel until the hardware is installed. The door may lock when closed.

J. Check door operation.

NOTE: Adjust shims to correct any issues with plumb, square, operation or reveal.

- K. Install panel retainers. Refer to the instructions included in the panel retainer hardware package.

WARNING Panel Retainer **MUST** be installed to reduce risk of serious injury or death from a falling door panel. If panel retainer is lost or damaged, DO NOT INSTALL DOOR. Contact your Local Pella Retailer or Pella Customer Service (877) 473-5527 for replacement.

Install bumpers (if applicable). Refer to the anchor instructions at the end of this booklet.

- L. Install the handles. Refer to the instruction in the hardware box.

2 SETTING AND FASTENING THE DOOR (CONTINUED)

- M. Adjust the panel height to ~1/8" clearance to head of unit by removing the hole cover and using a #2 screwdriver to turn the roller adjustment screw clockwise (raise) or counterclockwise (lower).

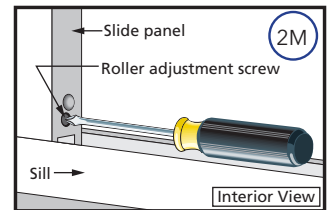

NOTE: For doors with heavy impact-resistant or triple pane glass use a small pry bar to raise the panel while turning the adjustment screw. This will prevent the threads from being stripped.

- N. Adjust the footbolt (if applicable) refer to the anchor instructions at the end of this booklet.
- O. Encompass by Pella® and Pella® 150 Series doors: Install the keeper and adjust the lock hook (if necessary). Refer to the anchor instructions at the end of this booklet.
- P. Check door operation by opening and closing the door.

3 APPLY SEALANTS

- A. Install interior sealant. Refer to the interior sealant instructions at the end of this booklet. Use additional sealant around clips to prevent air and water infiltration (if applicable).
- B. Install exterior sealant between the edge of the brickmould and the finished wall material or flashing. Refer to the exterior sealant instructions at the end of this booklet.



FULL FRAME REPLACEMENT IN STUCCO WITH FLUSH FLANGE
 ROUGH OPENING PREPARATION USING WATER MANAGEMENT LINER (US PATENT 8,833,035)

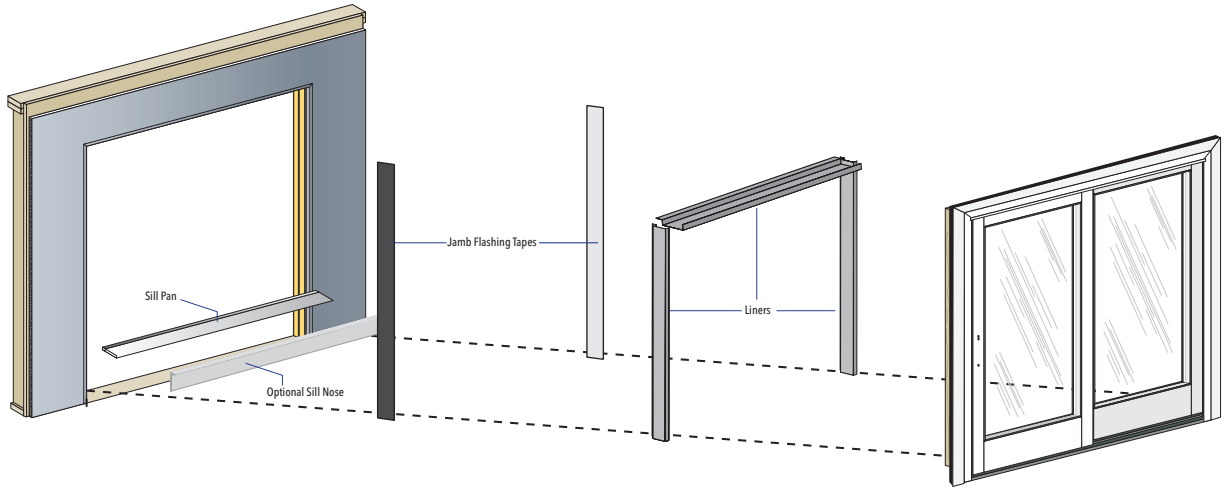

1 REMOVE THE EXISTING DOOR

CAUTION: Many doors in older homes are painted with lead-based paint. Removal of old doors may disturb this paint. Proper precautions must be taken to minimize exposure to dust and debris. Consult state or local authorities for more information.

REMEMBER TO USE APPROPRIATE PERSONAL PROTECTIVE EQUIPMENT.

- A. Measure the width and height of the opening inside the drywall return. The new door frame size must be at least 1/2" to 3/4" smaller than this measurement in width and 3/8" minimum in height.
- B. Cut through the existing door nailing fin on all sides. Cut against the edge of the frame with an angle grinder or circular saw with diamond blade. Use a reciprocating saw to finish the cutting the corners. Be careful not to chip or crack the stucco.

NOTE: Use a vacuum with a HEPA filter to minimize dust while cutting. Maintain a safe distance between the vacuum and power tool.

- C. Remove the existing door and dispose of it properly.

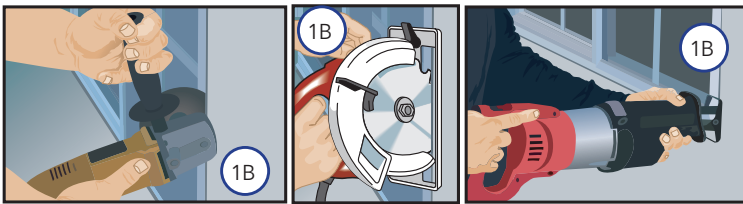

- D. Make any modifications or repairs to the opening at this time.
- E. Cut the stucco and existing door fin along the opening sill to ensure the stucco does not project above the sill framing (if applicable).
- F. Clean the rough opening by vacuuming all dust and debris.

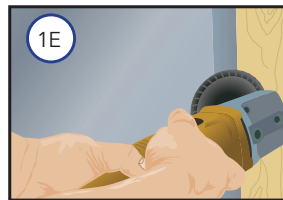

NOTE: If the new door frame is deeper than the existing door frame, it will be necessary to cut the interior flooring material back to allow the door flush flanges to contact the existing aluminum door frame.

2 PREPARE THE OPENING

- A. Construct a sill pan for the door. Measure the rough opening width and add 2". Measure 1" up from each end and cut through the vertical leg of the pan material. Bend the bottom (side) flaps of the pan material up, then bend the back leg around the end of the pan. Make the sill pan depth equal to the door frame depth minus 2-1/8". Seal all the corners and overlaps.

Dry fit the sill pan and the door into the opening.

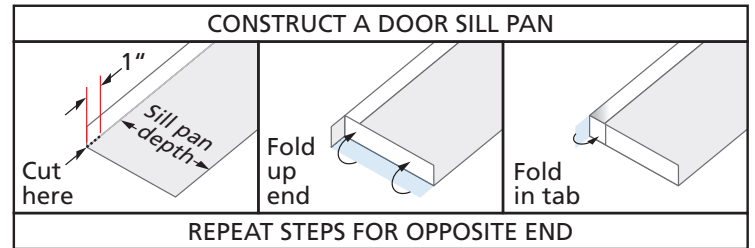

- B. Cut the sill nosing to the rough opening width plus two times the flange width. Notch the sill nosing.

NOTE: 4-sided flush flange doors and openings with an exterior concrete slab flush with the opening sill do not require the sill nosing

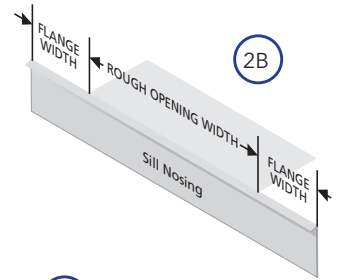

- C. Apply beads of 3/8" diameter sealant across the rough opening sill in the locations shown. Make sure the lines of the sealant covers the area between the stucco and rough opening.

- D. Place a 3/8" bead of sealant at each corner of the rough opening from the stucco along the edge of the rough opening as shown.

NOTE: It is important to avoid letting the sealant skin over prior to applying the sill pan.

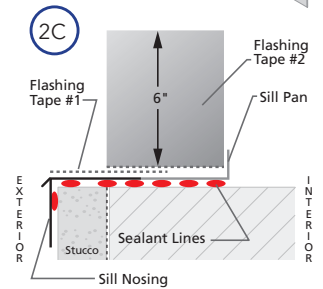

- E. Install the sill pan and sill nosing into the opening. Press down to seal them into the opening. DO NOT overlap.

NOTE: Cut back drywall return on jamb as needed to allow clearance for sill pan.

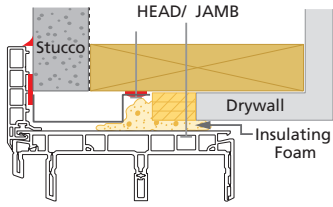

FINISHED DOOR INSTALLATION AND SEALANT DETAILS

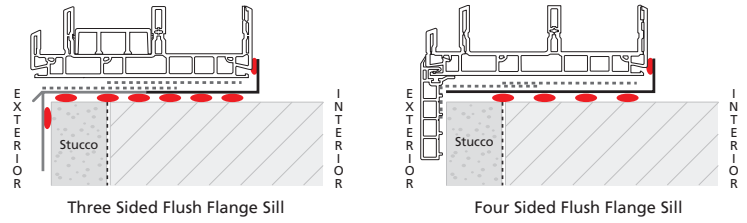

2 PREPARE THE OPENING (CONTINUED)

F. Apply sealant at nosing ends continuing from the front of the sill pan around the exterior surface of the wall where the sill nosing will end.

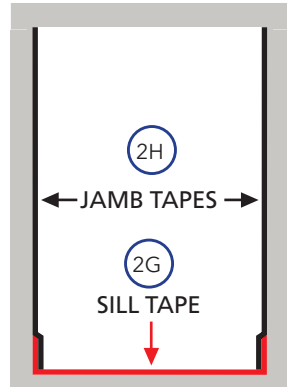
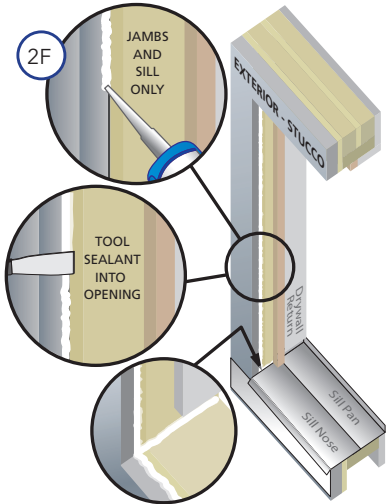

- G. Cut two pieces of flashing tape 12" longer than the rough opening width. Place tape #1 across the sill nosing just up to where the nosing begins to slope down and extending 6" up each jamb. Apply the second piece of flashing tape over-lapping the first piece and the exterior edge of the sill pan and 6" up each jamb.
- H. Cut two pieces of flashing tape equal to the height of the rough opening. Place the exterior edge of the tape along the exterior edge of the stucco. Press the tape down firmly over the sealant, exposed framing, edge of filler strip and onto the surface of the drywall.
- I. Cut 1/2" thick wood or expanded PVC filler strips for the jambs and head. Make the width of the strips equal to the distance from the surface of the stucco to the surface of the drywall minus 2-1/8".
- J. Install filler strip using #8 x 1-1/2" wood screws at 16" on center maximum spacing.
- K. Place a 3/8" bead of sealant (or enough to cover the area) between the stucco and the rough opening at the jambs. **DO NOT seal the head.** Tool the sealant with a putty knife to press the sealant into the opening.
CAUTION: The cut fin may have sharp edges!
- L. Cut the head liner equal to the opening width.

2 PREPARE THE OPENING (CONTINUED)

- M. Make 1/4" deep by 3/4" wide tabs, bending them down as shown.
- N. Apply a 3/8" bead of sealant across the top of the opening 1-3/4" from the surface of the stucco and 1" down the sides.
- O. Secure the head liner over the sealant using self-drilling screws 6" from ends and every 12". The liner may be shifted to allow the stucco to extend below the rough opening.
- P. Cut two jamb liners to fit between the sill and the head liner.

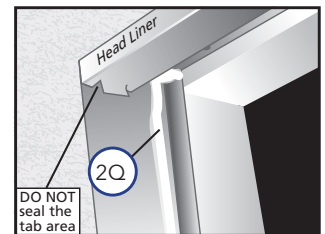
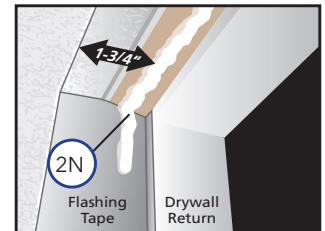
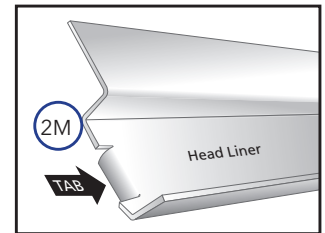
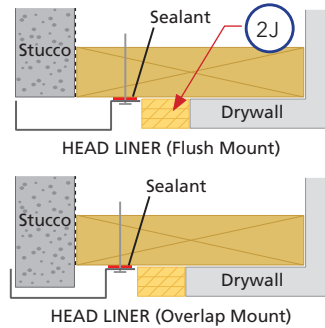

- Q. Apply 3/8" beads of sealant down each jamb 1-3/4" from the surface of the stucco.
- R. Secure the jamb liner over the sealant using self-drilling screws 6" from ends and every 12". The liner may be shifted to allow the stucco to extend into the rough opening.
- S. Seal the upper corners where the head and jamb liners meet.
- T. Seal the lower corners where the jamb liner meets the sill. Do not seal the notch.
- U. Refer to the Pocket Replacement with Flush Flange instruction beginning at step 1T in this booklet to complete the installation.

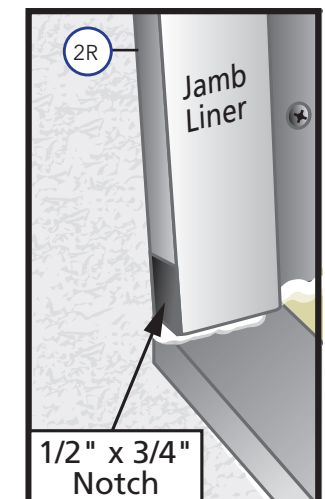



ANCHOR INSTRUCTIONS - FLUSH FLANGE AND ENDURA CLAD EXTERIOR TRIM FOR REPLACEMENT INSTALLATION METHODS FOR CLAD EXTERIOR ARCHITECT SERIES® AND PELLA® LIFESTYLE SERIES SLIDING PATIO DOORS (INCLUDING ARCHITECT SERIES IMPACT-RESISTANT)

Pella® Impact-Resistant Products have been tested in accordance with the large missile impact testing requirements of ASTM E 1886 and ASTM E 1996. Pella Impact-Resistant Products are neither hurricane proof nor are they shatter proof. Severe wind and rain may produce temporary conditions which exceed product performance standards. When these units are subjected to intense storms or extreme conditions, which exceed the intended design pressures, air, water and flying debris infiltration may occur. Advanced performance and Impact-Resistant require the use of installation clips or screws through the frame. The use of fins or brickmould is optional and will not affect anchorage requirements. Local building codes may have additional anchoring requirements.

Units with Pella Enduraclad exterior trim with narrow fins and NO pre-punched holes must be anchored using frame screws or installation clips.

An "X" in the chart below indicates the fastener (row) to be used, under a specific installation method column. All fasteners marked with an "X" in an installation method column are necessary to meet documented performance values.

FASTENER LETTER ALPHA CHARACTER	INSTALLATION METHOD			OPENING SUBSTRATE TYPE		ILLUSTRATION
	Nail Fin & Screws	Screws Through Frame	Clip & Screws	Wood	Masonry	
A	X*			2" 11 Ga. Roof Nail		I, II, IV
B	X*	X	X	#8 x 2-1/2"	3/16" x 2-1/2" Masonry Screw	VI, VII
C		X		#10 x 3-1/2"	1/4" x 3-1/2" Masonry Screw	V
D	X*	X	X	#8 x 3"	3/16" x 3" Masonry Screw	I, II, VII
E			X	#6 x 1-1/4"***	3/16" x 1-1/4" Masonry Screw	III, V

* Architect Series Impact-Resistant must be installed with either Screw Through Frame or Clip & Screw method, but may also have nail fins.

** For light gauge steel framing, use #10 self-tapping screws.

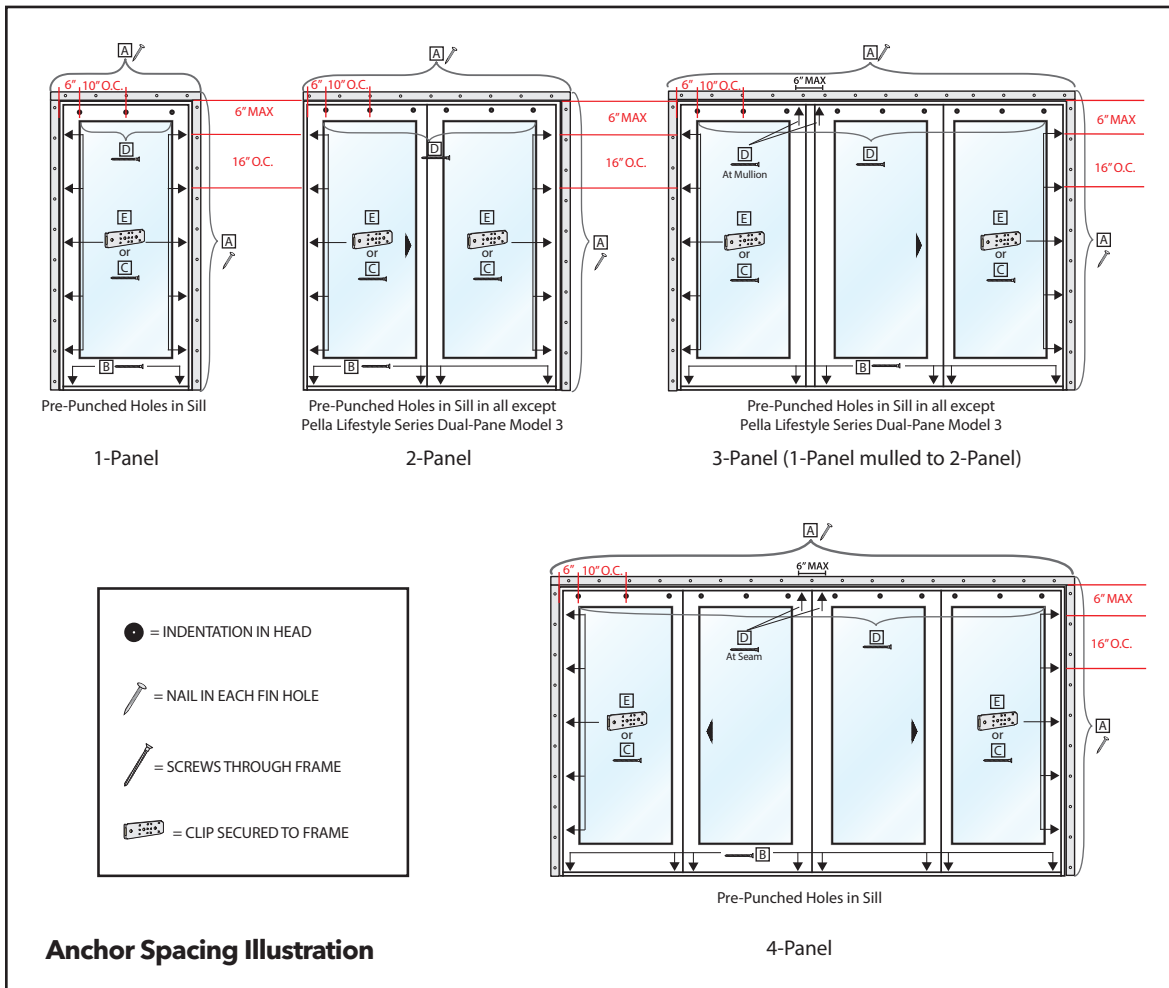

- Alpha Character = Fastener Letter listed in the chart with corresponding locations shown on illustrations. i.e. A
- Multiple installation methods may be shown in each illustration.
- See chart for fastener descriptions and if fastener is used per installation method.



**ANCHOR INSTRUCTIONS - FLUSH FLANGE AND ENDURA CLAD EXTERIOR TRIM FOR REPLACEMENT
INSTALLATION METHODS FOR CLAD EXTERIOR ARCHITECT SERIES® AND PELLA® LIFESTYLE SERIES
SLIDING PATIO DOORS (INCLUDING ARCHITECT SERIES IMPACT-RESISTANT)**

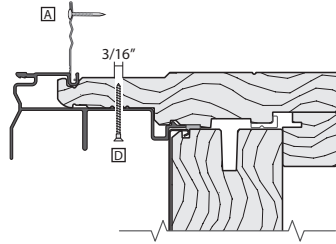

Head, 1-Panel, 2-Panel

Illustration I

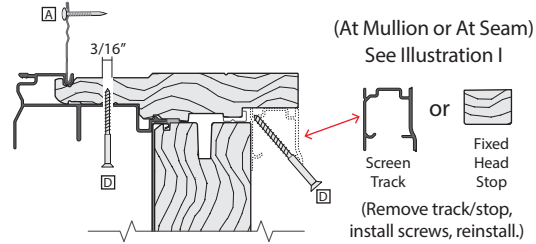

Head, 3-Panel, 4-Panel

Illustration II

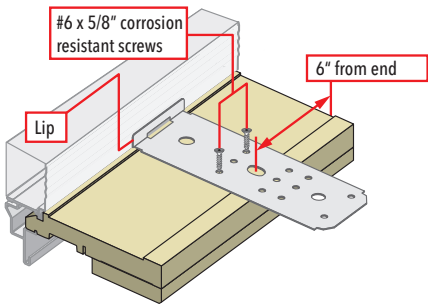

Clip and Screw Installation Method

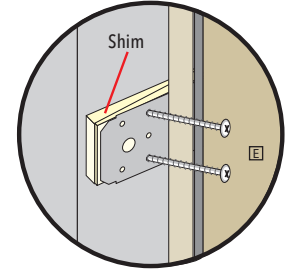
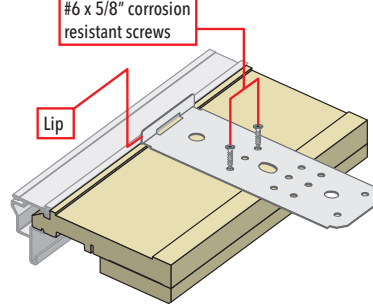

Jamb Clips

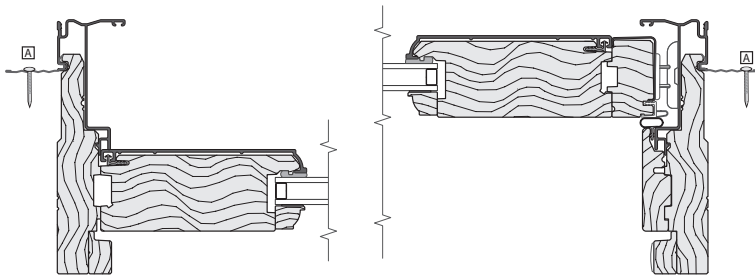

Nail Fin, Jamb

Illustration IV

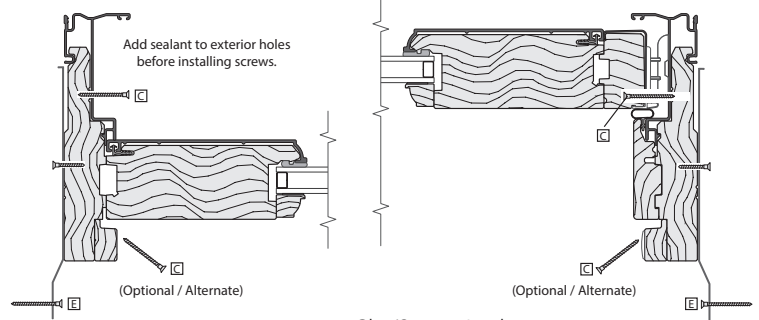

Clip/Screw, Jamb

Illustration V

Drive screws through plugs at each pre-punched hole or drill pilot holes if none are present. Add sealant in drilled pilot holes before installing screws.

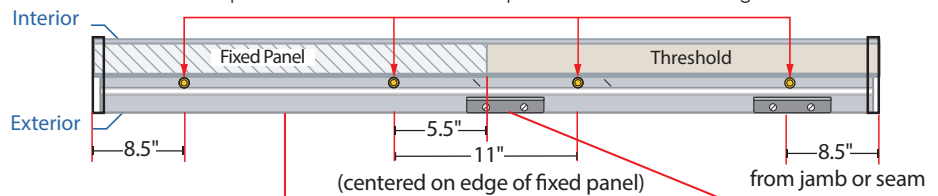

Exterior sill edge must be supported to meet performance values. Apply Pella aluminum sill support or wood blocking as required to support the exterior edge of the door frame.

Reapply the vent panel retainer after all anchoring is complete and vent panel is installed.

Sill

Illustration VI

There may be a plug in the pre-punched holes.

Sill Support or Wood Blocking

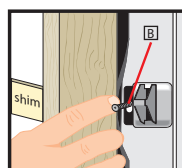
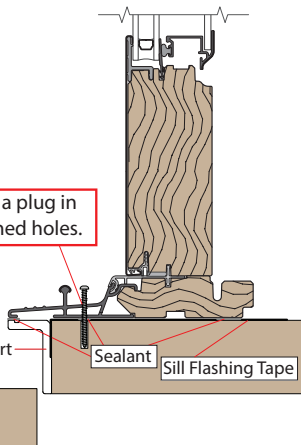

OR

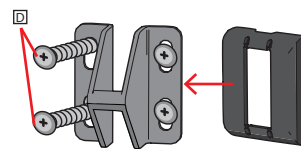

Install cover after screws

Jamb with lock strikes (1 or 2 strikes may be present)

NOTE: Strikes Factory installed for 4-Panel and 3-Panel with mullied lock jambs.

Illustration VII



ANCHOR INSTRUCTIONS - FLUSH FLANGE INSTALLATION METHODS FOR ENCOMPASS BY PELLA®, PELLA® 250 SERIES AND PELLA® 150 SERIES SLIDING PATIO DOORS

Note: Standard performance only. Additional anchoring may be required for performance upgrade, impact-resistant products or to comply with local building code requirements.

Product	Location		Anchor Type		Instructions	Illustration
			Wood	Masonry		
Pella® 150 Series and Encompass by Pella	Head / Jamb / Sill Frame Screws		#10 x 2" Corrosion Resistant (provided)	N/A	Pre-drill through both walls with 5/32" pilot hole. Drill through the first wall only with a 3/8" bit. Then drive screws. Refer to the illustrations for location and spacing. Screws through the sill require sealant and self-sealing washer.	A, B
	Head and Sill - Interlockers only		#10 x 2" Corrosion Resistant (provided)	N/A	Pre-drill through both walls with 5/32" pilot hole. Drill through the first wall only with a 3/8" bit. Then drive screws. Refer to the illustrations for location and spacing. Screws through the sill require sealant and self-sealing washer.	A, B
	Jamb	Strike / Lock / Keeper	#6 x 1/2" starter screw and 3" screws (provided)	1/4" x 3-1/2" Masonry Screw	Refer to installing the keeper instructions on page BMFFSD - 16 and illustrations below.	C
Pella 250 Series	Head / Jamb / Sill Frame Screws		#10 x 2" Corrosion Resistant (provided)	1/4" x 2" Masonry Screw	Drive screws at each pre-drilled installation hole. Apply sealant prior to driving screws in the sill.	A, B
	Head and Sill - Interlockers and Mullions		#10 x 2" Corrosion Resistant (provided)	3/16" x 1-1/2" Masonry Screw	Drive screws at each pre-drilled installation hole at interlockers. Pre-drill and drive screws on each side of mullions. Refer to the illustrations for location and spacing. Apply sealant prior to driving screws through the sill.	A, B
	Jamb	Strike / Lock	#8 x 2" (provided)	N/A	OX / XO / OOX / XO: Drive screws at each hole in the lock strike (4 total).	C
	Astragal	Strike / Lock	#8 x 3/4" (provided)	N/A	OXO / OXXO: Drive screws at each hole in the lock strike (4 total).	C

A

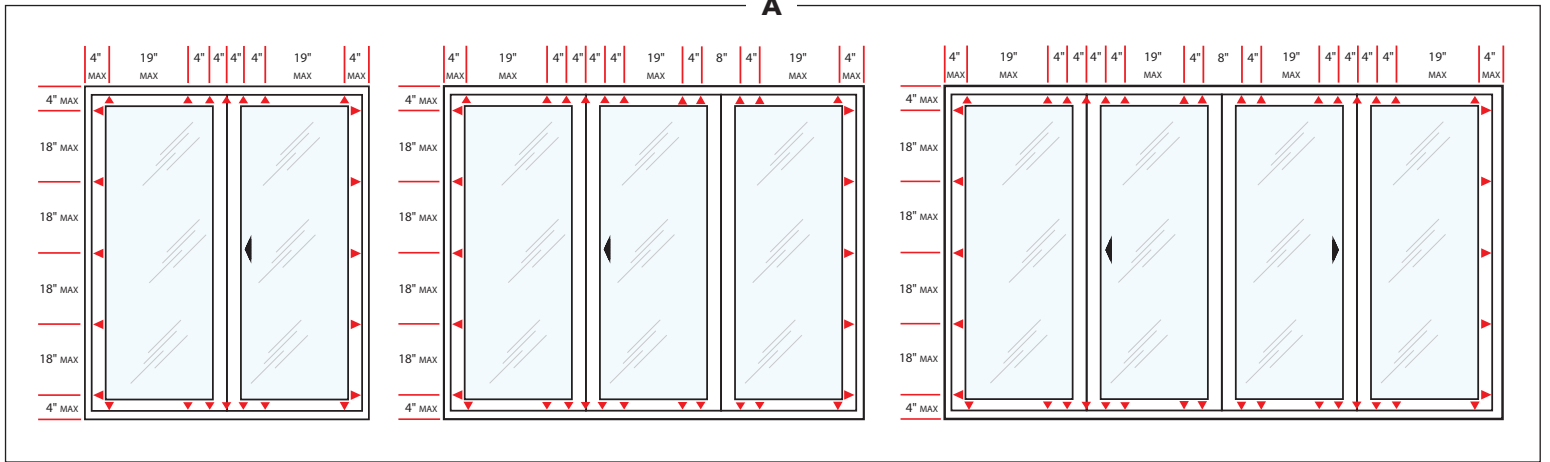

B

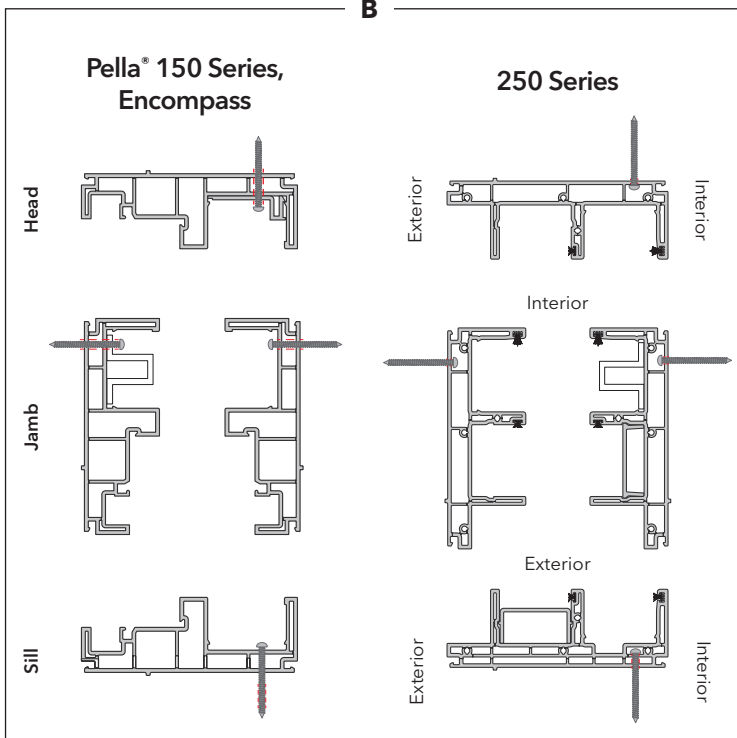

C

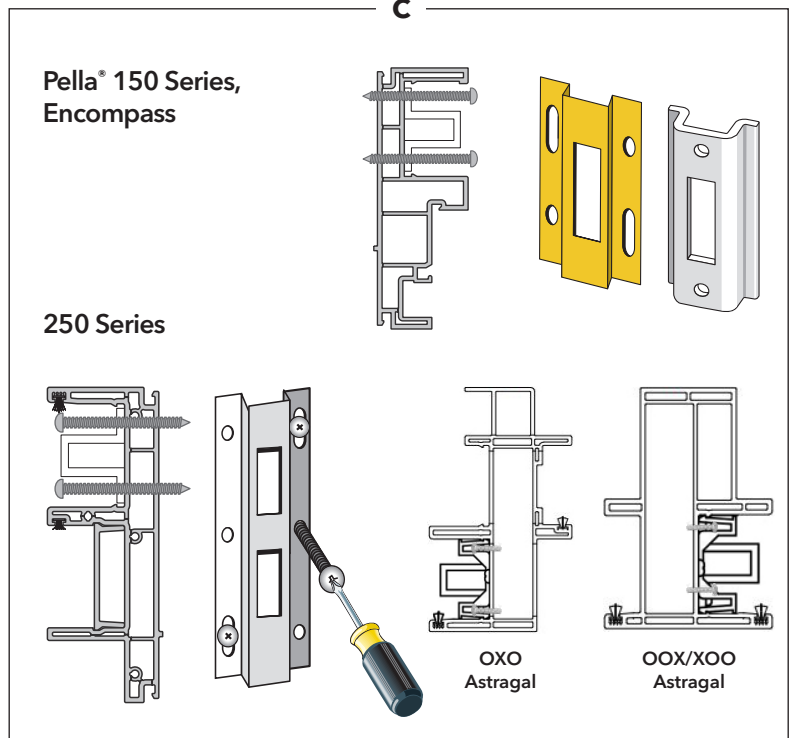



INSTALLING THE KEEPER FOR PELLA® 250 SERIES, PELLA® 150 SERIES AND ENCOMPASS BY PELLA® SLIDING PATIO DOORS AND REVERSING DOOR SLIDE FOR PELLA® 150 SERIES AND ENCOMPASS BY PELLA®

KEEPER INSTALLATION FOR PELLA® 150 SERIES AND ENCOMPASS BY PELLA®:

D. **Identify the keeper** in the hardware package and perform the keeper attachment steps based on which keeper is in the package. Determine the keeper location by opening the panel a few inches and extending the lock hook. With a pencil, mark the location on the jamb directly across from the top of the shank.

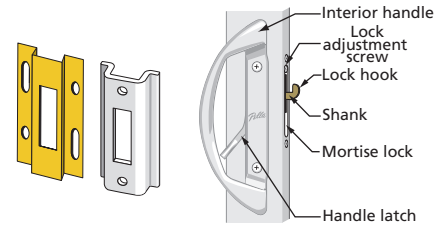

E. **Place the keeper with 4 screw holes** on the jamb so the top of the slot is aligned with the pencil mark. Attach by inserting a #6 x 1/2" starter screw into one of the slotted keeper holes.

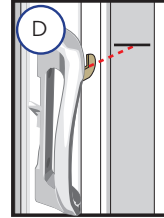

F. **Place the keeper with 2 screw holes** on the jamb by "snapping" it into the frame jamb at the desired location. The keeper may be moved up or down to align with the pencil mark. The keeper will stay in position until attached with screws.

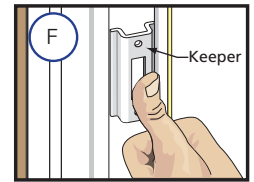
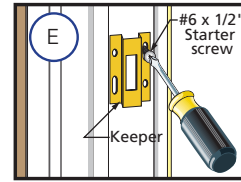

G. **Insert a shim** between the frame jamb and the rough opening at the keeper location.

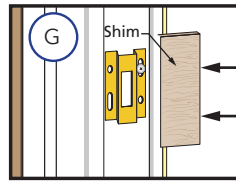

H. **Adjust the lock hook** by turning the door lock adjustment screw clockwise to loosen or counter-clockwise to tighten until the mortise lock is aligned properly, the door locks easily, and there is less than 1/16" movement when the door is locked.

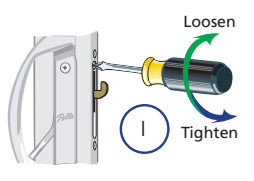
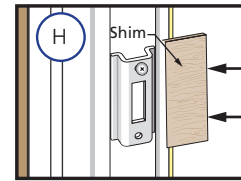

I. **Install the keeper** by inserting 3" long screws (provided) through the keeper holes, the shim and into the rough opening frame members. Remove the starter screw from the 4 screw hole keeper and replace it with a 3" long screw.

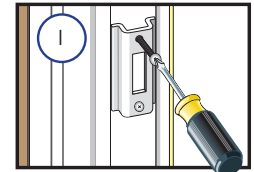
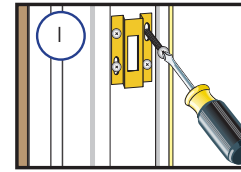

Note: Doors with Blinds-Between-the-Glass are not reversible.

REVERSING DOOR SLIDE FOR PELLA® 150 SERIES AND ENCOMPASS BY PELLA®:

A. **Remove the sill and screen tracks** from the door. (Use an Allen wrench or small hook to begin removal.)

B. **Rotate the main frame 180°** (so the sill becomes the head). Snap the sill and screen tracks into place at the bottom of the door. Carefully lay the panel on saw horses or a clean surface.

C. **Extend the lock hook** and clamp the lock hook with the vise grip.

NOTE: Use of the vise grip on the lock hook will prevent the mortise lock from falling when the lock mounting screws are removed.

D. **Remove the door handle** by removing the two attachment screws.

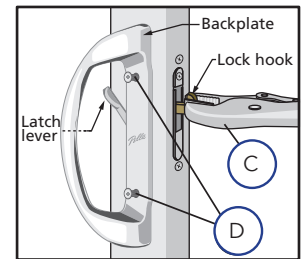

E. **Remove the mortise lock.** Remove the two screws that attach the lock assembly to the door panel. Work the lock down, then tilt it out and pull up.

F. **Rotate 180° and reinstall the lock.** Insert the mortise lock into the door panel with the lock adjusting screw positioned at the bottom, then tilt the top in and lift the lock into position. Insert the two mounting screws into the lock mounting holes.

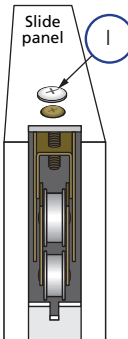
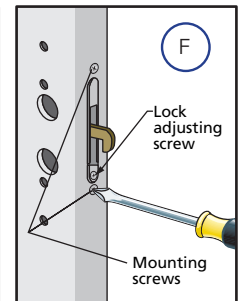
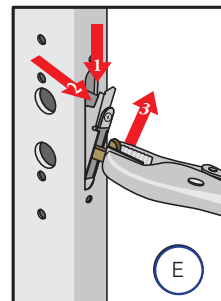
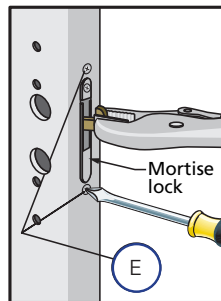

G. **Rotate the handle 180°** and install the door handle by inserting the two backplate screws through the door panel and into the exterior handle.

NOTE: Rotating the handle will result in "Pella" script being upside down. A new handle must be ordered for "Pella" to be in correct orientation.

NOTE: The latch lever must engage the slot in the side of the mortise lock assembly.

H. **Remove the bottom rollers** from the slide panel by removing the upper screw. Reinstall the rollers in the opposite end of the door panel.

I. **High Performance Doors only:** Remove the blocks from the top rail of the door panel and reinstall them at the opposite end of the panel.

J. **High Performance Doors only:** Move the frame exterior vent plugs (white foam rods) from the head of the frame to the opposite side of the frame. A soap solution may be needed as a lubricant for re-installing the plugs.



Interior Sealant Instructions

CAUTION: Continuous backer rod (as necessary) and a high quality, low-odor interior sealant such as Pella Window and Door Installation Sealant (or equivalent) is recommended for commercial or high performance installations to create the continuous interior seal. Follow the directions on the cartridge. For standard performance or products with factory applied jamb extensions, use low pressure polyurethane insulating foams. Follow the directions on the can. Do not use high pressure or latex foams. Fiberglass batt or similar insulation is not recommended as it can absorb water and does not act as an air seal.

- A. Insert the nozzle or straw between the rough opening and door frame from the interior. Use a pliers (if necessary) to compress the end of a straw tube to allow it to fit in tight openings.
 - B. Place a 1" deep bead of foam approximately 1" from the interior of the frame to allow for expansion. DO NOT fill the entire depth of the rough opening cavity.
- NOTE:** Apply foam between the frame and rough opening, NOT between jamb extensions and the rough opening.
- C. Re-Check door operation and remove remaining shipping spacers after foam installation. Excess foam may be removed with a serrated knife after it cures.
 - D. To ensure a continuous interior seal, apply sealant over or around any shims or clips interrupting the foam seal.
 - E. Place a continuous bead of sealant across the inner sill at the intersection of the door sill and subfloor. Continue the sealant 6" up each jamb.

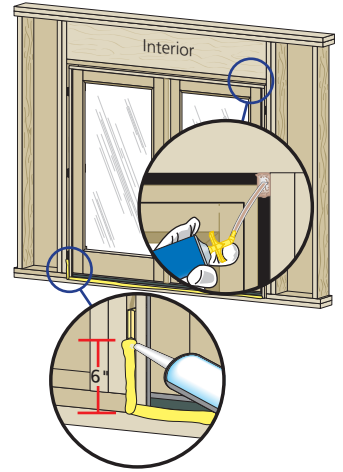

Exterior Sealant Instructions

CAUTION: Use a high quality, multi-purpose exterior sealant such as Pella Door and Door Installation Sealant. Follow the directions on the cartridge.

Flush Flange Doors:

- A. Place a corner bead of sealant on the edge of the flush flange on the top and sides.

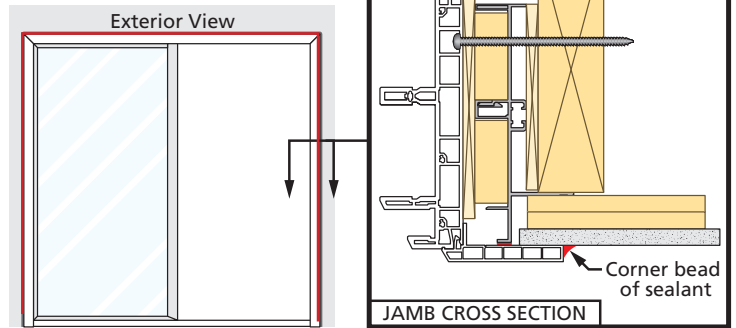

Flush Flange Doors

- B. For a door without the flush flange at the sill, install a corner cap at the bottom of each jamb flush flange. Remove the release paper from the adhesive strips on the back of the corner cap, and press the corner cap onto the bottom of the jamb flush flange.

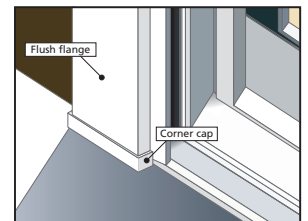
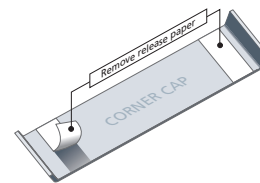

Enduraclad Exterior Trim Doors:

- A. Insert backer rod 3/8" deep in the space around the door. Backer rod adds shape and controls the depth of the sealant line.
- B. Apply a continuous bead of sealant to the entire perimeter of the door.
- C. Shape, tool and clean excess sealant. When finished, the sealant should be the shape of an hourglass.

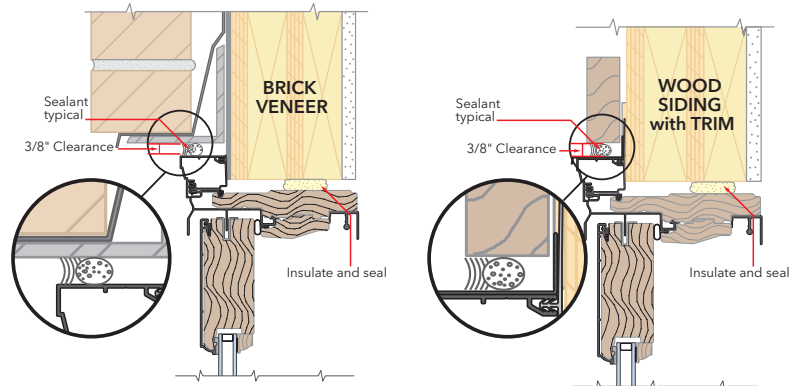



OPTIONAL SILL PAN INSTRUCTIONS

A. **Cut the sill pan** to the width of the rough opening plus 2".
NOTE: The 2" added onto the rough opening width is for a 1" bend on each end.

B. **Make a 1" cut** in each fold at both end of the sill pan.
NOTE: These cuts will allow the edges of the sill pan to be bent.

C. **Cut 1" off each end** of the interior sill pan lip.

D. **Bend each end** of the center panel up.

E. **Install the sill pan** by sliding into place until the exterior sill pan lip is flush with the exterior of the rough opening.

F. **Apply sill flashing tape.** Cut a piece of flashing tape 2" longer than the opening width. Apply at the bottom of the opening, covering the exterior sill pan lip as shown.

NOTE: If applicable, apply spray adhesive to building felt prior to applying the flashing tape.

G. **Cut a piece of flashing tape** to the width of the opening. Install tape to the sill pan and overlap the flashing tape from step 1F by 1". If needed add a second or third piece of flashing tape until the sill pan is covered to the interior sill pan lip.

NOTE: The purpose of this tape is to seal the sill screws when installing the door.

H. **Cut two 9" pieces of flashing tape** with a 1" x 3" tab at the bottom, on opposite corners as shown.

I. **Apply the tabbed 9" pieces of flashing tape.** The tape is applied so 2" will cover the inside of the rough opening and lap over the side flange of the sill pan. The 1" x 3" tab laps over the bottom flashing tape as shown.

J. **Cut two 6" pieces of flashing tape** and apply to each side of the rough opening, overlapping the first piece by 1" and lapping the bottom over the side flange of the sill pan as shown.

K. **Cut two pieces of flashing tape 1-1/2" x 6"** and apply to the bottom corners of the opening by beginning in the corner of the sill pan, with 3/4" of the tape applied to the sill pan and 3/4" of the tape applied to the side flange. The remainder of the tape is to be at a 45 degree angle onto the exterior.

L. **Attach the aluminum sill support** or wood blocking to the exterior of the box plate to support the edge of the door sill. Place the sill support flush with the subfloor.

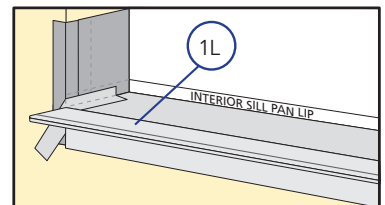
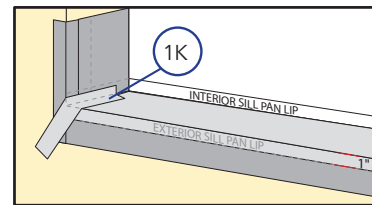
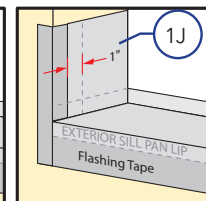
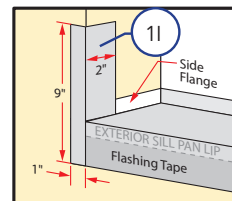
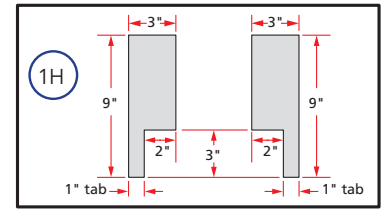
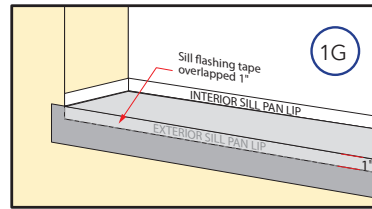
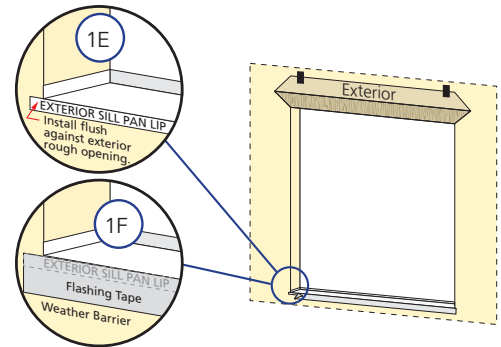
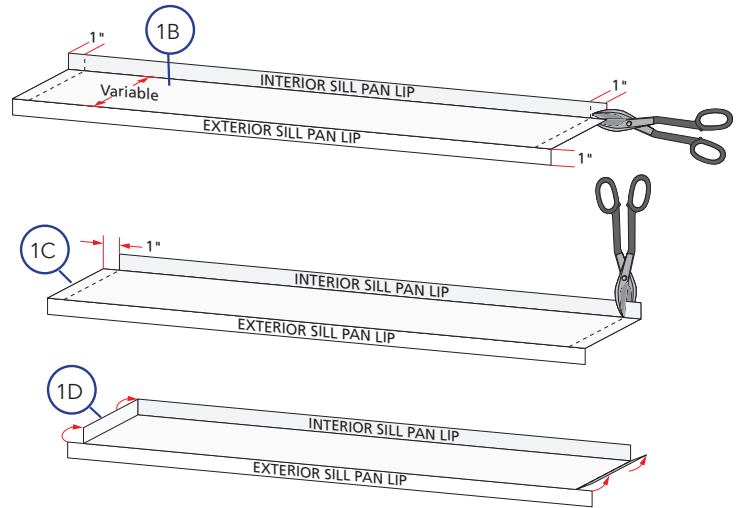

Concrete Slab (without sill pan) Instructions

NOTE: Thoroughly clean the slab where sealants will be installed. Instead of installing flashing tape across the bottom of the rough opening, complete the following:

- Install flashing tape at the bottom 6" of the rough opening jambs.
- Cut (2) 9" pieces of flashing tape as shown in step 1H above.
- Install them overlapping the flashing tape installed in step A by 1".
- Place a 3/8" bead of sealant where the bottom edge of the flashing tape meet the concrete slab.
- When folding building wrap in at the jambs, cut at a 30 degree angle as illustrated.

Follow the applicable installation method pages to complete the installation except seal the door sill directly to the slab.

