

RICHMOND
REGION
TOURISM'S

MEETING PROFESSIONALS GUIDE



PATIOS, ROOFTOPS
AND OTHER HOT
SPOTS FOR
GREAT
GATHERINGS

Unforgettable Events

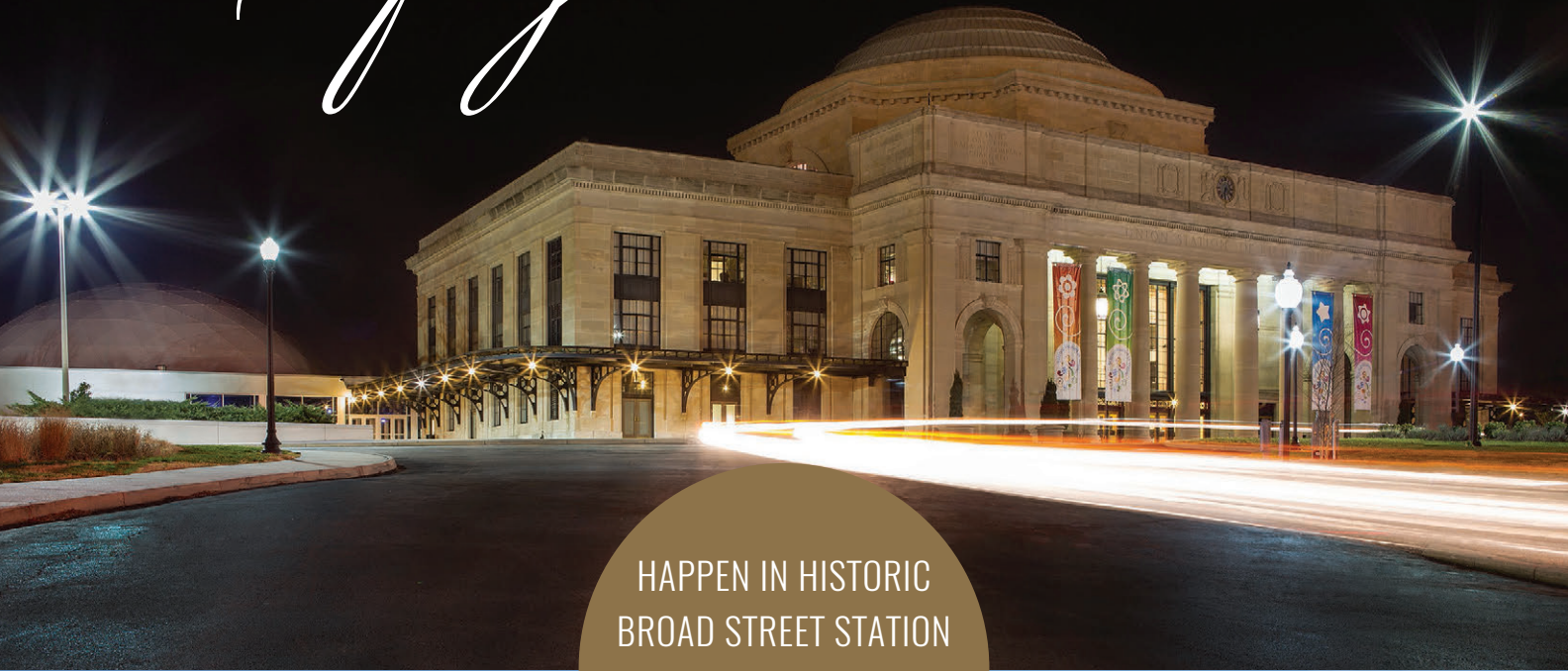

HAPPEN IN HISTORIC
BROAD STREET STATION
AND THE NEW
DEWEY GOTTWALD
CENTER

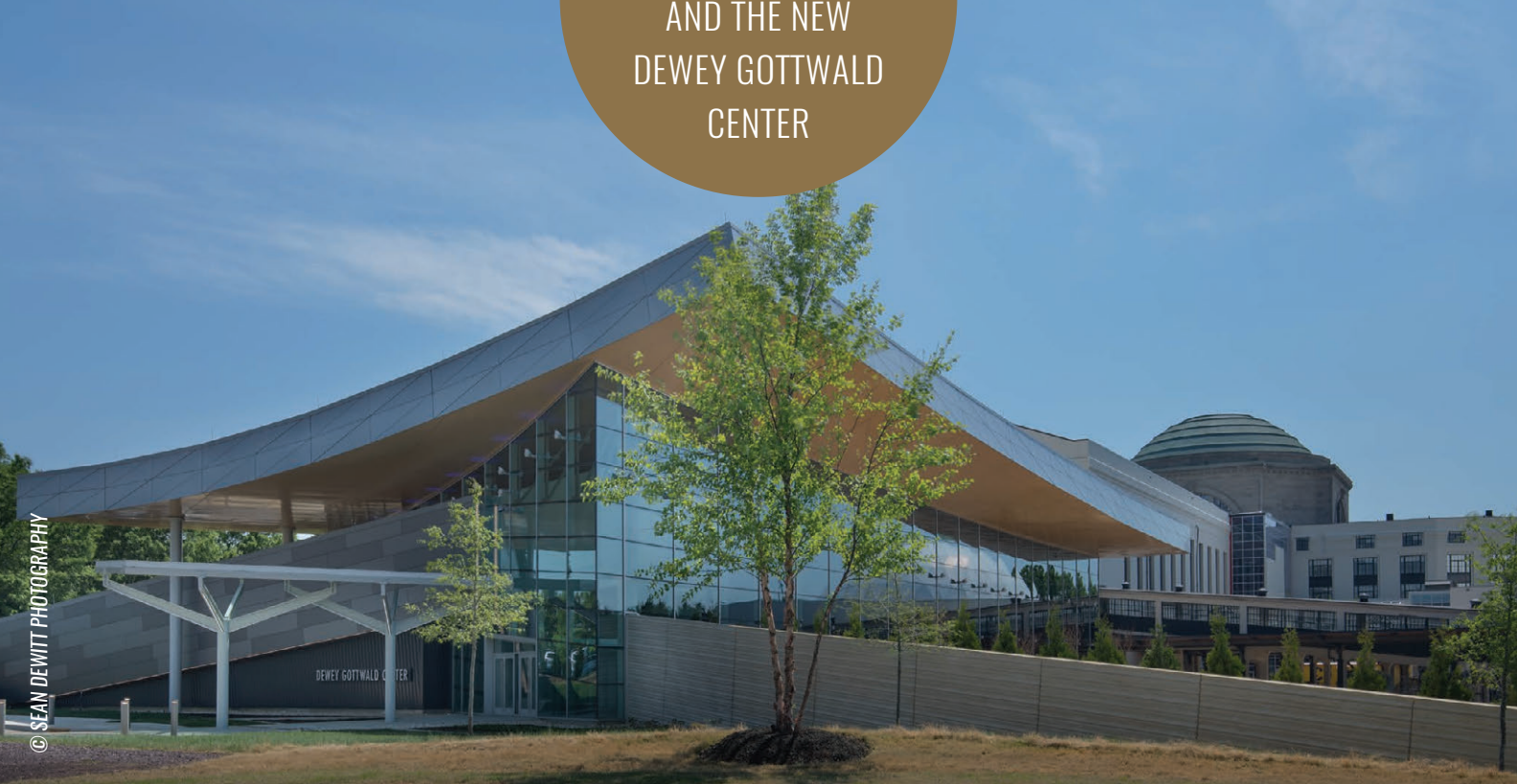

© SEAN DEWITT PHOTOGRAPHY



Contact us today at 804.864.1400 or info@smv.org to schedule a tour. www.smv.org

Special thanks to our premier partners:



Virginia529

MAIN STREET STATION



Clifton Williams II

Richmond's most notable National Historic Landmark and voted one of Virginia's favorite architecture. Our Head House occupancy will accommodate up to 740, and our new 47,000 sq. ft. Shed will accommodate up to 2,210.

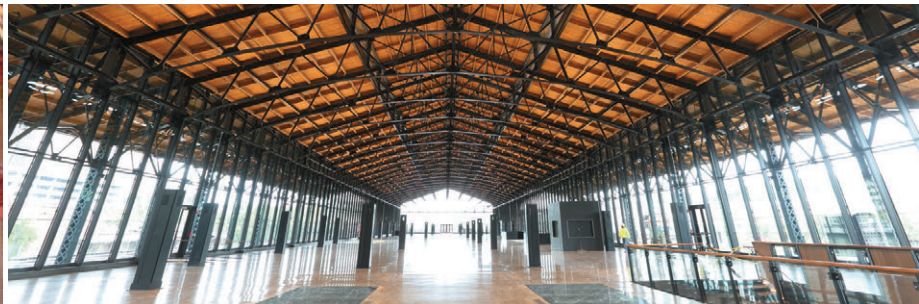

1500 East Main St, Richmond, VA

Carolyn Daughtry: (804) 646-1768
Carolyn.Daughtry@RichmondGov.com

RMTA: (804) 523-3329

FOLLOW US!

-  Main Street Station, Richmond
-  mainstreetstationva
-  mainststationva





Details Matter. Make them Perfect

Experience the NEW Delta Hotels by Marriott® Richmond Downtown! Our hotel features 298 rooms with beautiful views of the James River, spacious indoor pool, full-service fitness center, fast free Wi-Fi, in-room microwave, fridge and safe, onsite parking & complimentary downtown shuttle. We are located near many of the city's top businesses, such as Federal Reserve Bank, CoStar, SunTrust, UPS, VA Bio+Tech Park, Dominion Energy & Virginia Commonwealth University. Our hotel is just minutes away from the Virginia State Capitol, Richmond Coliseum and the Greater Richmond Convention Center.

- Over 13,000 square feet of newly renovated, flexible meeting space
- Can accommodate events ranging from 2 to 400 guests
- Complimentary wireless internet in all meeting rooms
- Filtered water stations throughout hotel
- Quench Food + Spirits- On-site restaurant and bar
- Rapids Fast Fare - On-site Grab & Go
- Free bottled water refreshed in guest rooms daily
- Meeting Planners can earn up to 50,000 Marriott Rewards points with the Rewarding Events program



For sales call 804.344.2967
or visit www.deltarichmond.com

Delta Hotels by Marriott® Richmond Downtown
555 East Canal Street
Richmond, VA 23219
804.788.0900

Operated under license from Marriott International, Inc. or one of its affiliates.



Richmond Region Tourism is the official destination marketing and tourism organization for the counties of Chesterfield, Hanover, Henrico and New Kent, and the City of Richmond.

RICHMOND REGION TOURISM

401 N. Third St.
 Richmond, VA 23219
 804-782-2777;
 804-780-2577 FAX
 1-888-RICHMOND
 MeetRichmondVa.com

- /VisitRichmondVA
- @VisitRichmond
- @VisitRichmondVA
- VisitRichmondVA

OR VISIT:

Richmond Region
 Visitor Center
 405 N. Third St.
 Richmond, VA 23219
 804-783-7450
 VisitRichmondVa.com



Tarrant's West

P. 12

© Richmond Region Tourism 2017, Meeting Professionals Guide. This publication may not be reproduced in whole or part in any form or by any means without written permission from the publisher. Publisher is not responsible for errors or omissions. The listings and advertisements in this publication do not imply any endorsement by the publisher or Richmond Region Tourism. Printed in Richmond, Virginia, by Cadmus Communications, a Cenveo Company. Published for Richmond Region Tourism by Target Communications Inc.

EDITOR

Nicole Cohen

ART DIRECTOR

Sarah Barton

COVER

Photo by Justin Chesney

For advertising information, questions or comments, contact Rich Malkman, Target Communications Inc., 2201 W. Broad St., Suite 105, Richmond, VA 23220-2022, 804-355-0111.



MEETING PROFESSIONALS GUIDE

CONTENTS

ABOUT RICHMOND

- 4 WELCOME
- 6 COMMUNITY SERVICES
- 8 WHAT'S NEW
- 10 TRAVEL
- 12 FOOD & BEVERAGE
- 14 ITINERARY IDEAS
- 16 NEAR GRCC

MEETING FACILITIES

- 18 FACILITIES
- 29 HOTEL FACILITIES
- 44 ACCOMMODATIONS
- 48 UNIQUE VENUES
- 58 ATTRACTIONS MAP

TOP: ASH DANIEL; BOTTOM: COURTESY MAYMONT

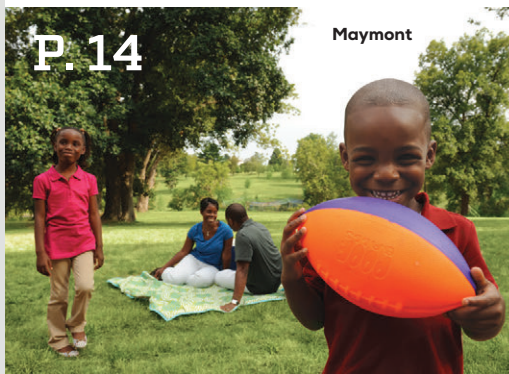

P. 14

Maymont

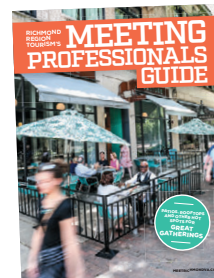

ON THE COVER: OUTDOOR DINING AT PASTURE. PHOTO BY JUSTIN CHESNEY.



WELCOME

COME FOR THE MEETING-FRIENDLY VENUES, BUT STAY FOR THE CULTURAL EXPERIENCES, EXHILARATING ENTERTAINMENT AND RENOWNED GOURMET DINING.

The Richmond region's blend of big-city excitement and small-town charm is guaranteed to make a lasting impression on your attendees. Our world-class museums, exquisite art, elegant and modern architecture, distinctive boutiques, lush gardens, and thriving nightlife are all set against a uniquely historic backdrop. And with more than 700 locally owned restaurants in the area, you're sure to find plenty to please your palate. But you've got an event to plan, so here are a few quick facts about Richmond or as the locals say, RVA.

We're ready to get to work for you and make your next meeting or convention an exceptional success.

LET'S GET STARTED!

- 18,000-plus hotel rooms
- The Greater Richmond Convention Center is Virginia's largest at 700,000 square feet.
- Just 8 miles from downtown, Richmond International Airport offers more than 200 daily nonstop flights on domestic, international and low-cost air carriers.
- The population is 1.3 million.
- There are five four-year universities and two two-year institutions within the region.
- Richmond is located in the Central East Coast, within one day's drive of half the U.S. population.
- The Atlantic Ocean, Blue Ridge Mountains, and Washington, D.C. are all within a two-hour drive.
- Charlottesville, Williamsburg and Fredericksburg are within a one-hour drive.
- The local government consists of Chesterfield County, City of Richmond, Hanover County, Henrico County and New Kent County.

A LASTING IMPRESSION

Acclaim and praise for Richmond

Richmond makes Southern Living's list of **"THE SOUTH'S BEST CITIES 2017,"** noting "an unconventional music scene, and restaurants that are redefining Appalachian cooking."

— southernliving.com, March 2017

“ Richmond sunsets are not so different from the city itself – they're packed with color and a richness of diversity that surprises visitors but is just everyday life to locals.”

— Brandon Schultz in the October 2016 metrosource.com article, "Out of the Cradle of the Confederacy, Richmond Shines Anew"

CNBC ranks Richmond **NO. 11** in its list of **"THE TOP 20 METRO AREAS TO START A BUSINESS IN AMERICA."**

— cnbc.com, August 2016

"With the James River as an anchor, Richmond reveals a stark natural beauty that, no matter the season, offers a distinctive URBAN CHARM AND VIBRANCY."

— John L. Dorman in the September 2016 New York Times article, "36 Hours in Richmond, Virginia"

Richmond ranks **NO. 7** on Travel + Leisure's list of **"AMERICA'S FAVORITE CITIES."**

— travelandleisure.com, May 2016

RVA makes Realtor.com's list of **"THE NEXT TOP TECH TOWNS."**

— realtor.com, April 2017

“ Arrive hungry. Virginia's capital has long been a destination for good grub, and in recent years, the dining scene has catapulted onto the national stage.”

— Mary Winston Nicklin in the September 2016 USA TODAY article, "Made in Virginia: Flavors only found in Richmond"

In 2017, two Richmond area chefs were named semifinalists for the prestigious **JAMES BEARD FOUNDATION AWARDS.**

Brittany Anderson, chef and co-owner of Metzger Bar & Butchery and Brenner Pass, was nominated for **"BEST CHEF: MID-ATLANTIC"** and Evrim and Evin Dogu, co-owners of Sub Rosa Bakery, were nominated for **"OUTSTANDING BAKER."**

— jamesbeard.org, March 2017

Richmond makes National Geographic Traveler's list of **"WHERE TO TRAVEL FOR FOOD IN 2016."**

— nationalgeographic.com, January 2016

SPECIALIZED SERVICES



AT RICHMOND REGION TOURISM, WE MAKE IT OUR JOB TO BE OF SERVICE. As an extension of your team, we partner with you at every stage of the planning process. At the outset, our team works closely with you to understand the needs and objectives of your meeting and those of your attendees. Then we get to work determining the local service providers and hotel properties that best meet those needs. Once meeting sites have been selected, we put our resources to work for you, strategically leveraging our local network, intellectual capital, and using promotional resources to maximize attendance. Finally, through our on-site and post-event interactions, we engage your group by providing experience-rich visitor services.

WE DON'T BELIEVE IN COOKIE-CUTTER SERVICES because we don't believe any two meetings are the same.

OUR GOAL IS SIMPLE: We want to help you plan, execute and market your meeting and ensure your group has an unforgettable stay. From providing custom marketing materials and housing solutions, to helping generate media coverage and building microsites, to assisting in the site selection process and post-convention feedback, we are here to be of service to you. After all, it takes more than just the right location to make your event a memorable success.

Call or visit our website today for additional convention and meeting information or to submit a request for proposal. A destination expert will be happy to help you plan your Richmond region event!

**804-782-2777 or 1-888-RICHMOND
MeetRichmondVA.com**

NO-COST SERVICES



Because we are funded by a portion of the lodging tax, Richmond Region Tourism provides free services to anyone planning a meeting in the Richmond region who has included us in the booking process — and you receive the best value if you utilize our services from the beginning. Costs are not passed on to meeting attendees, either. Here is a sampling of services that includes just some of the ways we can help you plan.

PLAN

- Off-site venues and service provider coordination
- Experiential activities and special events
- Assistance with ground transportation and tour guides
- Community service projects
- Customized hotel search for rates, proposals and availability
- Personalized assistance with site inspections

HOST

- Attendee welcome programs
- Access to local elected officials, industry leaders and associations
- Pre- and post-convention meeting assistance
- On-site staffing and volunteers
- Dining reservation services

PROMOTE

- Attendance-building marketing programs, resources and tools
- Local media relations
- Custom maps and driving directions
- Discount and promotional offers
- Local awareness and preparedness
- Volunteer acquisition
- Social media support

HOUSE

- Room block setup and monitoring

VOLUNTOURISM

As you plan and schedule your trip to Richmond, consider booking a VolunTourism event. A rapidly expanding trend in the meetings industry, it allows meeting-goers the opportunity to give back by participating in a community service project — an ideal team-building experience. Whether you have a few hours or a full day, here's a small sampling of local nonprofit organizations with volunteer opportunities suitable for groups.



RICHMOND METROPOLITAN HABITAT FOR HUMANITY

From working on a build site to working in the ReStore (a retail outlet offering donated building and home improvement supplies), your attendees will help facilitate home ownership and break the cycle of poverty. richmondhabitat.org



FEEDMORE CENTRAL VIRGINIA FOOD BANK

From meal preparation and packing to food sorting and shelf stocking, attendees can volunteer their time to bring hunger relief to the area's most vulnerable populations. feedmore.org



CARITAS

No availability for an in-person volunteer project? The largest provider of services to the homeless in the Region, CARITAS aims to break the cycle of addiction and homelessness. Donations of gently used household items such as pillows, linens, towels and dishes will be distributed to the formerly homeless community now actively rebuilding their lives. caritasva.org



UNITED FOR UNOS

Help spread the word about the importance of organ donation and transplantation by partnering with United for UNOS. unitedforunos.org

Volunteer programs and the needs of these organizations are subject to change.



RICHMOND'S NEWEST MUST-SEES

Some of RVA's most recent additions have contributed to the cultural scene, the architectural beauty of the city, and created new spaces to just have a good time.

T. TYLER POTTERFIELD MEMORIAL BRIDGE

Known by locals as the "T-Pot Bridge," the pedestrian river crossing connects Brown's Island, a hub for the city's festivals and concerts, to Manchester, a revitalized industrial neighborhood. The 1,600-foot-long pathway sits just 20 feet above the James River and includes three overlooks, making it an ideal location to take in river life and nature, as well as the sights and sounds of the city. The bridge is handicapped accessible, bike friendly and well-lit into the evening. Access the north entrance of the bridge from Brown's Island, S. Seventh St.

TOP, CLOCKWISE FROM LEFT: CHENLA OU; COURTESY CHESTERFIELD COUNTY PARKS AND RECREATION; JAY PAUL



RICHMOND VOLLEYBALL CLUB AT STONEBRIDGE

The Richmond Volleyball Club (RVC) is set to move into a brand new 50,000-square-foot facility in January 2018. Located in Chesterfield County's newest neighborhood, Stonebridge, the \$7 million mixed-use development is being funded by the Chesterfield County Economic Development Authority and will feature Chesterfield County Parks and Recreation programs in addition to RVC's events and offerings. **200 Karl Linn Drive, RVC: 804-358-3000 or rvc.net; Chesterfield County Parks and Recreation: 804-748-1623 or chesterfield.gov**

MAIN STREET STATION

More than a century old, this Amtrak station newly revamped its train shed creating 47,000 square feet of awe-inspiring event space, complete with graceful architectural touches like glass walls and a gabled ceiling. The state's tourist welcome center is scheduled to move into the site's renovated lower level in 2017. The station is located in Shockoe Bottom, home to a collection of Richmond's favorite restaurants, historical landmarks and the 17th Street Farmers' Market where food, music, and cultural events immerse festival-goers. **1500 E. Main St., 804-646-2041 or www.richmondgov.com/mainstreetstation**

BLACK HISTORY MUSEUM & CULTURAL CENTER OF VIRGINIA

Preserving and exploring Virginia's African-American history and culture, the Black History Museum is located inside the former Leigh Street Armory building in the historic Jackson Ward neighborhood. The family-friendly museum features interactive touch screen exhibits, educational events, and traveling exhibitions. Grab a coffee and sandwich in the café and take a seat in one of the Woolworth's Luncheonette booths or counter seats, where sit-in protesters fought segregation in the 1960s. **122 W. Leigh St., 804-780-9093 or blackhistorymuseum.org**

RIVER CITY SPORTSPLEX

This 115-acre, multi-sport, athletic complex hosts elite level regional and national soccer, lacrosse and field hockey events on 12 synthetic turf fields (one of the largest assemblages in the nation). Recently acquired by Chesterfield County's Department of Parks and Recreation, the programming is being expanded. **13030 Genito Road, 804-796-7045 or rivercitysportsplex.com**

INSTITUTE FOR CONTEMPORARY ART AT VIRGINIA COMMONWEALTH UNIVERSITY

Anchored by the number one public university art program in the country, the Institute for Contemporary Art (ICA) is scheduled to open in spring 2018. The ICA is an incubator for new art with constantly changing exhibits, performances, films and interactive community projects. **818 W. Broad St., 804-828-2823 or ica.vcu.edu**

GREENWOOD PARK

The first phase of this 200-acre site in Henrico County is scheduled for completion in early 2018. A tournament quality multi-sport complex, the campus includes sand volleyball courts, four lighted multi-purpose synthetic turf fields, two playgrounds, trail and more. **11217 Greenwood Road, 804-501-7275 or henrico.us**

HARDYWOOD PARK CRAFT BREWERY: WEST CREEK

Hardywood opened in 2014 and since has won international acclaim for its brews. Their latest expansion, the West Creek location in Goochland County, is scheduled for completion in 2018. The 60,000-square-foot production facility will be accompanied by a taproom, beer garden, orchard, and amphitheater. **hardywood.com**



GET HERE WITH EASE

Amplify your attendance by hosting your meeting or convention in one of the central-most destinations on the East Coast.

BY AUTOMOBILE

Did you know the Richmond region is located within a day's drive of half of the U.S. population? Utilize Interstates 95 and 64, the major corridors traveling through the region. For ease of navigation, vehicle rentals, taxi service, GRTC bus transportation, charter bus trips and airport service from James River Transportation, and Uber and Lyft service are also available.



BY TRAIN

Hop on an Amtrak train and trek to Richmond with ease and comfort. The national rail operator stops at three stations locally. Rail service is located just minutes from I-95 and I-64 at 7519 Staples Mill Road. Passengers also arrive at downtown's Main Street Station at 1500 E. Main St., and Amtrak has a station in the heart of downtown Ashland, at 112 N. Railroad Ave. Stations are handicapped-accessible, and baggage service is available. For more information about Amtrak service, visit amtrak.com/virginia.



FROM LEFT: ISAAC HARRELL; GRTC TRANSIT SYSTEM; CASEY TEMPLETON, COURTESY RICHMOND REGION TOURISM



BY PLANE

Richmond International Airport is minutes from downtown Richmond and 8 miles from the city's central business district. Six air carriers provide service to RIC: Allegiant, American, Delta, JetBlue, Southwest and United. Each offers nonstop flights to major national destinations and connecting flights to cities around the world. In 2017, OneJet began offering nonstop service between Richmond and Pittsburgh. Enjoy a modern, two-level terminal and the airport's Chamber RVA Business Center, which features meeting space, conference rooms and communications services. Taxi service at RIC is available. James River Transportation provides executive sedan and limousine service. Additional transportation options include nine rental agencies and transit service (visit ridegrtc.com for bus route and schedule). For more information, visit flyrichmond.com. ■

| AIRPORT | DESTINATION | AIRLINES |
|---------|---------------------------|------------------|
| ATL | Atlanta | Delta, Southwest |
| BOS | Boston | Delta, JetBlue |
| CLT | Charlotte | American |
| ORD | Chicago | American, United |
| DFW | Dallas/Ft. Worth | American |
| DEN | Denver | United |
| DTW | Detroit | Delta |
| FLL | Ft. Lauderdale | JetBlue |
| IAH | Houston | United |
| MIA | Miami | American |
| MSP | Minneapolis | Delta |
| JFK | New York JFK | Delta |
| LGA | New York LaGuardia | Delta, American |
| EWR | New York Newark | United |
| MCO | Orlando | JetBlue |
| SFB | Orlando-Sanford | Allegiant |
| PHL | Philadelphia | American |
| PIT | Pittsburgh | OneJet |
| PIE | Tampa-St. Pete-Clearwater | Allegiant |
| IAD | Washington DC - Dulles | United |

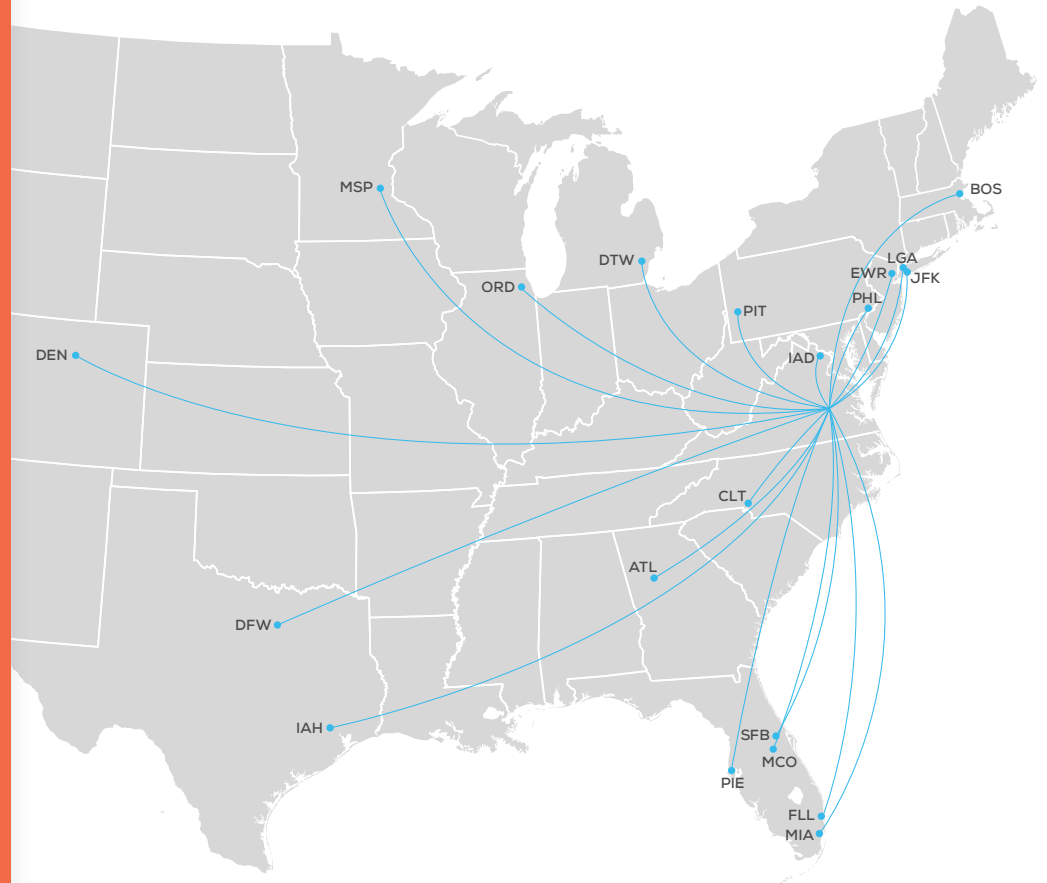

More routes continue to be added.

GRUBBING WITH THE GROUP

As one of the up-and-coming foodie capitals of the U.S., a trip to RVA isn't complete without sampling the delicious cuisine. Traveling with a large group? Not to worry — there's a plethora of restaurants ready to accommodate.



Hanover Tavern



Maggiano's Little Italy



The Boathouse at Sunday Park

THE BOATHOUSE

Each of The Boathouse's Richmond locations (Sunday Park, Rocketts Landing and Short Pump) feature spacious indoor and outdoor bar and dining areas, perfect for enjoying seafood delicacies with a view. boathouseva.com

BUZ AND NED'S REAL BARBECUE

For great barbecue in a casual, fun atmosphere, visit Buz and Ned's on North Boulevard or West Broad Street. buzandneds.com

CAPITAL ALE HOUSE

Head to Capital Ale House in downtown Richmond, Innsbrook or Midlothian for a diverse menu and large, open dining areas. capitalalehouse.com

FLORA

This eclectic, upscale Mexican restaurant and bar accommodates large groups in a lively, colorful setting. [804-355-0434](tel:804-355-0434) or florarva.com

HANOVER TAVERN

Catch dinner and a live stage performance from Virginia Repertory Theatre in a historic circa 18th-century tavern. [804-537-5050](tel:804-537-5050) or hanovertavern.org

JULEP'S NEW SOUTHERN CUISINE

This popular tavern offers prix-fixe dinner menus with multiple courses for private parties of up to 50 guests (the entire restaurant is available for parties larger than 100). [804-377-3968](tel:804-377-3968) or juleps.net

MAGGIANO'S LITTLE ITALY

In addition to its opulent bar and lounge area, this classic Italian restaurant has several private banquet halls to make your gathering truly special. [804-253-0900](tel:804-253-0900) or maggianos.com

NEW KENT WINERY

Enjoy award-winning wines in a beautiful setting. [804-932-8240](tel:804-932-8240) or newkentwinery.com

PASTURE

Known for its Southern small plates and craft beer selection, Pasture offers spacious indoor and outdoor seating in the heart of downtown Richmond. [804-780-0416](tel:804-780-0416) or pastureva.com

SAUDÉ CREEK VINEYARDS

Grab a glass of wine and enjoy a fantastic view of the vineyard from the 3,000 square feet of covered porches. [804-966-5896](tel:804-966-5896) or saudecreek.com

TARRANT'S CAFÉ

This former pharmacy building has plenty of space for upscale dining in an industrial setting. Catering services are also available. [804-225-0035](tel:804-225-0035) or tarrantscaferva.com

TARRANT'S WEST

The sister location of Tarrant's Café, Tarrant's West offers affordable neighborhood dining and catering services in Richmond's West End. [804-205-9009](tel:804-205-9009) or tarrantswestrvva.com ■

SKY DINING

Mesh the city's breathtaking sights and mouthwatering tastes by partaking in some rooftop dining.

THE HOFGARDEN

The Historic Hofheimer Building's unique rooftop biergarten serves 24 drafts of European and Virginia beer, prosecco, cider and lite German fare. [804-342-0012](tel:804-342-0012) or thehofgarden.com



Q ROOFTOP BAR

The popular Quirk Hotel's modern, open-air bar offers craft cocktails, beer and wine on tap and upscale street fare (in addition to spectacular views of downtown Richmond). [804-340-6040](tel:804-340-6040) or destinationhotels.com/quirk-hotel

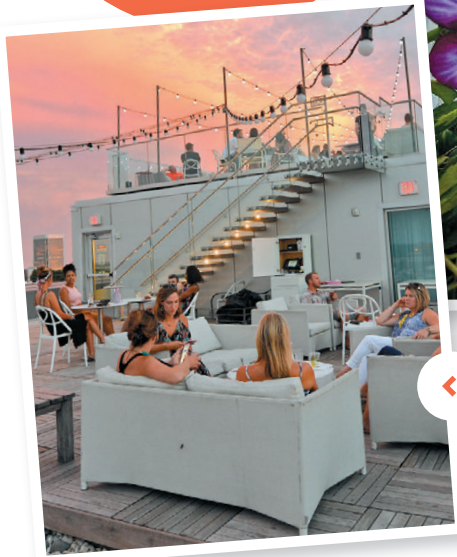

BYRD HOUSE

The new Graduate Richmond hotel's sophisticated pool house/rooftop bar, featuring a cocktail cabana, is expected to open by fall 2017. [804-644-9871](tel:804-644-9871) or graduaterichmond.com



KABANA

The crème de la crème of rooftop dining, this stylish Asian-inspired eatery launched Saturday brunch in 2017 in addition to its Tuesday jazz nights from 6 to 8 p.m. [804-545-3412](tel:804-545-3412) or kabanarooftop.com ■



TASTY TOURS

Take in local color and learn about Richmond's neighborhoods while enjoying fine cuisine on a food, brewery or winery tour.

REAL RICHMOND FOOD TOURS

Choose from about 10 tours that combine history and food in Church Hill, Scott's Addition and more. [804-840-5318](tel:804-840-5318) or realrichmondva.com

RICHMOND BEER TRAIL

Download the map for this self-guided tour; visit more than 25 craft breweries and earn fun prizes as you check multiple spots off your list. richmondbeertrail.com

RICHMOND BREWERY TOURS

Get a brief course on beer tasting before being chauffeured to three Richmond breweries for tours and samples. [804-404-2739](tel:804-404-2739) or richmondbrewerytours.com

RICHMOND RIDES BIKE TOURS

Embark on the "Foodie Tour" exploring the bakeries and award-winning restaurants of Church Hill via bike. [804-893-5065](tel:804-893-5065) or richmondrides.net

RICHMOND TROLLEY COMPANY

Schedule a private tour of local wineries and breweries aboard a classic trolley. [804-360-2122](tel:804-360-2122) or richmondrolley.com

RIVER CITY FOOD TOURS

Enjoy the ideal mix of food, history and fun – you can even take a cupcake baking tour. [804-479-8929](tel:804-479-8929) or rivercityfoodtours.com

RVA TROLLEY

Hop aboard a historic Chance trolley for a wine or beer tour visiting some of Richmond's most acclaimed spots. [804-971-2685](tel:804-971-2685) or rvatrolley.biz ■

CHOOSE YOUR ADVENTURE

Come for your business meeting, but stay for the fine dining, outdoor excursions, nightlife, performances and more. Whether you love a good nature walk or get a thrill from the hunt for unique merchandise, here are some sample itineraries to satisfy your recreational pursuits.



Riverside Outfitters

THE OUTDOORS LOVER

The pulse of RVA's outdoor culture can best be felt by visiting the James River. Visit one of the most popular swimming spots, **Belle Isle** (jamesriverpark.org) via a scenic suspended footbridge that can be accessed from Tredegar Street on the north shore or hike one of the park system's trails along the river. **Riverside Outfitters** (riversideoutfitters.net) can guide you on rafting, kayaking, and paddleboard tours and also offer rentals to use at your own pace. Search for bald eagles or

catch some fish on a **Discover the James** tour (discoverthejames.com). If you'd rather keep your feet on the ground, take in the kaleidoscope of colorful blooms at **Lewis Ginter Botanical Garden** (lewisginter.org) in the city's North Side or explore the sprawling 100-acre estate of **Maymont** (maymont.org) complete with ornate Italian and Japanese gardens.



Lewis Ginter Botanical Garden



Richmond Ballet

THE CULTURAL AFICIONADO

Richmond's Museum and Arts districts are home to several galleries and museums, anchored by the **Virginia Museum of Fine Arts** (vmfa.museum), one of the top art museums in the country. Nearby galleries include **1708 Gallery** (1708gallery.org), **Page Bond Gallery** (pagebondgallery.com), and the **Visual Arts Center of Richmond** (visarts.org). Head to Shockoe Bottom and acquire some literary inspiration at the **Edgar Allan Poe Museum** (poemuseum.org), which houses the largest museum collection of Poe artifacts and items in the world. There are multiple places across the region to catch a live show, including **Swift Creek Mill Theatre** (swiftcreekmill.com), **Hanover Tavern** (hanovertavern.org), **Virginia Repertory Theatre** (va-rep.org) and **Cultural Arts Center at Glen Allen** (artsglenallen.com). For a more classical performance, visit the **Richmond Ballet** (richmondballet.com) and **Richmond Symphony** (richmondsymphony.com).



THE STYLE SEEKER

Unique shopping corridors chock full of one-of-a-kind finds and local makers handcrafting décor and apparel, continually place Richmond on the nation's shopping and fashion radar. Along Libbie and Grove Avenues, stop by the **Shops at 5807** (shop5807.com), where you'll find several independent vendors under one roof, each with eclectic gifts and modern fashion. Carytown (known as the "Mile of Style") features formal dresses from **Lex's of Carytown** (lexsofcarytown.com), high-end consignment from **Clementine** (sweetclementine.com) and **Roan** (roanshop.com), and minimalist and fashion-forward apparel from **Need Supply Co.** (needsupply.com).

For designer men's clothing, a stop in **Ledbury** (ledbury.com) in the Arts District is a must. Three blocks away, **Rider Boot Co.** (riderboot.com) offers high-quality Italian-made footwear. For well-crafted jeans that are hand sewn in-house, stop by **Shockoe Atelier** (shockoeatelier.com) in Shockoe Bottom.



Rider Boot Co.



Shockoe Atelier



Richmond Raceway

FUN WITH (AND WITHOUT) THE FAM

When the family is in tow or even when seeking a thrill to bring out your inner kid, the region has you covered. More than 2,000 animals call **The Metro Richmond Zoo** (metrorichmondzoo.com) home and the **Treetop Zoofari Zip Line and Adventure Park** (treetopzoofari.com) features courses for all ages and skill levels, including 15 zip lines. **Uptown Alley** (uptownalleyrichmond.com) in Midlothian features 38 lanes of bowling. **Richmond Raceway** (richmondraceway.com) offers NASCAR action in April and September. Just a 30-minute drive from downtown Richmond, **Kings Dominion** (kingsdominion.com) offers roller coaster thrills. Four escape room experiences in the region include **Escape Room RVA** (ravenchase.com/escape-rooms) and **Room Escape USA** (roomescapeusa.com).



The Metro Richmond Zoo

THE HISTORY BUFF

Learn about early European settler life and the Arrohateck Indians at **Henricus Historical Park** (henricus.org). **Meadow Farm Museum** (henrico.us/rec/places/meadow-farm) is a living-history site based on an 1860 farm. The **Virginia Historical Society's** (vahistorical.org) "The Story of Virginia" exhibition interprets 16,000 years of Virginia's history. **Patrick Henry's Scotchtown** (preservationvirginia.org) is where he crafted the ideas of his "Liberty or Death" speech. **St. Peter's Parish Church**



Patrick Henry's Scotchtown

(stpetersnewkent.org) hosted the 1759 wedding of George and Martha Washington. For an overview of the area's Civil War sites and history, **The American Civil War Museum** (acwm.org) at Historic Tredegar is the place to start. **The Valentine** (thevalentine.org) has been preserving Richmond's past for more than a century and features permanent and changing exhibitions. ■



Henricus Historical Park

JUST AROUND THE CORNER

THIS IS JUST A SMALL SAMPLING OF NEARBY OPTIONS. CHECK OUT THE PAGE TO THE RIGHT FOR MORE.



Before, after or even in between meetings at the Greater Richmond Convention Center, there's a diverse array of cultural experiences, entertainment and more than 60 restaurants and lounges within walking distance. Here's a sampling of some neighborhood haunts, all within a six-block radius of the GRCC.

HISTORIC JACKSON WARD

This historic African-American neighborhood houses the Hippodrome Theater and don't miss the delicious trout and corn muffins at Mama J's Kitchen.
Hippodrome Theater: 528 N. Second St., 804-308-2913 or hippodromerichmond.com;
Mama J's Kitchen: 415 N. First St., 804-225-7449 or mamajskitchen.com

CANDELA BOOKS + GALLERY

Blending books and fine art, this publisher and art space focuses on fine art photography. Their popular annual invitational exhibition, "UnBound," raises funds to support fine art photographers. 214 W. Broad St., 804-225-5527 or candelabooks.com

THE NATIONAL

There's nothing quite like The National, a theater built nearly a century ago for cinema and vaudeville shows. Today, see local and international rock, soul, pop and reggae acts. 708 E. Broad St., 804-612-1900 or thenationalva.com

RAPPAHANNOCK AND RAPP SESSION

East Grace Street is the latest hot dining neighborhood, but to get a real taste of eastern Virginia, saddle up to the raw bar at Rappahannock restaurant or the more casual Rapp Session next door. 318 and 320 E. Grace St., 804-545-0565 or rroysters.com/restaurants

DOMINION ARTS CENTER

A significant (and lovely) part of Richmond's historic arts district is the Carpenter Theatre, with an 80-year heritage of stage and musical performances. Catch stand-up comedians, folk musicians and more. 600 E. Grace St., 804-592-3330 or dominionartscenter.com

THE VALENTINE

Known by Richmonders as the keeper of the city's history, The Valentine features permanent items including Gen. Robert E. Lee's boots and the morning suit worn by Gov. Douglas Wilder during his 1990 inauguration. 1015 E. Clay St., 804-649-0711 or thevalentine.org





J KOGI



Coalition Theater

MORE PLACES NEAR THE GRCC:

ARTS, MUSIC AND PERFORMANCE

1708 Gallery: 319 W. Broad St., 804-643-1708 or 1708gallery.org

ADA Gallery: 228 W. Broad St., 804-644-0100 or adagallery.com

Coalition Theater: 8 W. Broad St., 804-332-5857 or rvacomedy.com

Gallery5: 200 W. Marshall St., 804-678-8863 or gallery5arts.org

The Richmond Coliseum: 601 E. Leigh St., 804-780-4970 or richmondcoliseum.net

Virginia Repertory Theatre: 114 W. Broad St., 804-282-2620 or va-rep.org

DINING AND DRINKS

Big Herm's Kitchen: 315 N. Second St., 804-643-0202 or bighermskitchenrva.com

Bistro 27: 27 W. Broad St., 804-780-0086 or bistrotwentyseven.com

Chez Foushee: 203 N. Foushee St., 804-648-3225 or chezfoushee.com

Comfort: 200 W. Broad St., 804-780-0004 or comfortrestaurant.com

Godfrey's: 308 E. Grace St., 804-648-3957 or facebook.com/godfreysnightclub

Graffiato: 123 W. Broad St., 804-918-9454 or graffiatorva.com

Greenleaf's Pool Room: 100 N. Sixth St., 804-303-7102 or greenleafspoolroom.com

J KOGI: 325 N. Second St., 804-225-8734 or jkogi.com

Julep's: 420 E. Grace St., 804-377-3968 or juleps.net

La Grotta: 529 E. Broad St., 804-644-2466 or lagrottarva.com

Lift Coffee Shop & Café: 218 W. Broad St., 804-344-5438 or liftcoffeeshop.com

Lucy's Restaurant: 404 N. Second St., 804-562-1444 or lucys2st.com

Max's on Broad: 305 Brook Road, 804-225-0400 or maxsonbroad.com

Pasture: 416 E. Grace St., 804-780-0416 or pastureva.com

Perly's: 111 E. Grace St., 804-912-1560 or facebook.com/perlysrichmond

The Rogue Gentlemen: 618 N. First St., 804-477-3456 or theroguegentlemen.com

Saison: 23 W. Marshall St., 804-269-3689 or saisonrva.com

Secret Sandwich Society: 501 E. Grace St., 804-644-4777 or secretsandwichsociety.com

The Speakeasy Grill: 526 N. Second St., 804-308-2913 or hippodromerichmond.com

Tarrant's Café: 1 W. Broad St., 804-225-0035 or tarrantscaferva.com

Vagabond: 700 E. Broad St., 804-643-2632 or vagabondrva.com

Wong Gonzalez: 412 E. Grace St., 804-788-9000 or wonggonzalez.com

HISTORIC AND EDUCATIONAL POINTS OF INTEREST

The 1812 John Wickham House: 1015 E. Clay St., 804-649-0711 or thevalentine.org/exhibitions/permanent/wickham-house

Black History Museum and Cultural Center of Virginia: 122 W. Leigh St., 804-780-9093 or blackhistorymuseum.org

John Marshall House: 818 E. Marshall St., 804-648-7998 or preservationvirginia.org

Library of Virginia: 800 E. Broad St., 804-692-3500 or lva.virginia.gov

Maggie L. Walker National Historic Site: 600 N. Second St., 804-771-2017 or nps.gov/mawa

Virginia State Capitol: 1000 Bank St., 804-698-1788 or virginiacongress.gov ■



GREATER RICHMOND CONVENTION CENTER

403 N. Third St., Richmond, VA 23219
804-783-7334
richmondcenter.com

The sheer size and central location of the Greater Richmond Convention Center make it one of the most desirable meeting venues in the mid-Atlantic region. The Center is situated in the heart of downtown Richmond, just minutes from Richmond International Airport. The 700,000-square-foot facility spans 5.5 city blocks and is the ideal location for conventions, business meetings, trade shows, sporting events, banquets and galas.

Boasting 178,159 square feet of contiguous exhibit space, the exhibit hall can be divided into four sections and transformed from expo to elegant with lighting and décor. Exquisitely appointed, the Grand Ballroom features 30,550 square feet of space, divisible into three unique sections. Additional features include a Lecture Hall, green room and dressing rooms, a built-in sound system, and dimmable lighting capabilities. Enjoy an additional 50,000 square feet of flexible meeting and breakout rooms to suit your meeting's needs.

Also located in the building is the Richmond Region Tourism Visitor Center. Should your attendees need additional information about the Richmond region, travel counselors are happy to oblige with maps, directions and brochures on all that the area has to offer.



FAST FACTS

- 700,000 square feet
- 178,159-square-foot, dividable Exhibit Hall
- 80,000 square feet of additional meeting spaces and presentation rooms, including the Grand Ballroom
- 11,500-square-foot, glassed-in, showroom-style Registration Lobby
- 1,100 covered, attached parking spaces
- 258 fixed classroom-style seats in Lecture Hall
- 650 adjacent hotel rooms and thousands more nearby
- 35-foot ceiling in Exhibit Hall
- 20 truck bays with direct access to Exhibit Hall and Ballroom Pavilions
- 250-seat Food Court and Lounge
- Business Center, Cyber Café and Lactation Lounge
- State-of-the-art sound systems in all meeting rooms, exhibit halls and ballrooms
- Show offices, restrooms and concession stands located in each Exhibit Hall
- Free Wi-Fi in all public lobby spaces
- Northern-most non-union facility on the East Coast



GREATER RICHMOND CONVENTION CENTER

MEETING ROOM SPECIFICATIONS

BALLROOM BUILDING - LEVEL I, MEETING ROOMS B10-B19

| MEETING SPACE | SQ. FT. | DIMENSIONS | CEILING HEIGHT | THEATER SEATING | CLASSROOM SEATING | BANQUET SEATING |
|---------------|---------|------------|----------------|-----------------|-------------------|-----------------|
| B10 | 3,232 | 71' x 44' | 11' | 258 | --- | --- |
| B11 | 1,212 | 28' x 39' | 11' | 90 | 50 | 50 |
| B12 | 1,220 | 28' x 39' | 11' | 90 | 50 | 50 |
| B13 | 1,220 | 28' x 39' | 11' | 90 | 50 | 50 |
| B14 | 982 | 28' x 31' | 11' | 70 | 40 | 50 |
| B15ABC | 7,392 | 110' x 57' | 12' | 660 | 360 | 320 |
| B15AB | 4,802 | 73' x 57' | 12' | 435 | 240 | 200 |
| B15BC | 4,800 | 73' x 57' | 12' | 435 | 240 | 200 |
| B15A | 2,482 | 37' x 57' | 12' | 215 | 112 | 110 |
| B15B | 2,220 | 36' x 57' | 12' | 210 | 108 | 100 |
| B15C | 2,480 | 37' x 57' | 12' | 215 | 112 | 110 |
| B16 | 963 | 28' x 31' | 11' | 70 | 40 | 50 |
| B17 | 1,200 | 28' x 39' | 11' | 90 | 50 | 50 |
| B18 | 1,200 | 28' x 39' | 11' | 90 | 50 | 50 |
| B19 | 1,174 | 28' x 39' | 11' | 90 | 50 | 50 |

BALLROOM BUILDING - LEVEL II, GRAND BALLROOM B21

| MEETING SPACE | SQ. FT. | DIMENSIONS | CEILING HEIGHT | THEATER SEATING | CLASSROOM SEATING | BANQUET SEATING |
|---------------|---------|-------------|----------------|-----------------|-------------------|-----------------|
| B20-VIP Suite | 1,543 | 25' x 59' | 15' | 150 | 60 | 80 |
| B21ABC | 30,550 | 132' x 203' | 32' | 2,750 | 500 | 1,600 |
| B21AB | 20,167 | 132' x 135' | 32' | 1,800 | 1,000 | 1,000 |
| B21BC | 20,363 | 132' x 135' | 32' | 1,800 | 1,000 | 1,000 |
| B21A | 10,187 | 132' x 68' | 32' | 950 | 500 | 500 |
| B21B | 9,980 | 132' x 67' | 32' | 850 | 450 | 500 |
| B21C | 10,383 | 132' x 68' | 32' | 950 | 500 | 500 |

EXHIBIT HALL BUILDING - LEVEL I, EXHIBIT HALL ABCD

| MEETING SPACE | SQ. FT. | DIMENSIONS | CEILING HEIGHT | BOOTHS 10' X 10' | BOOTHS 12' X 12' | MAXIMUM OCCUPANCY |
|---------------|---------|-------------|----------------|------------------|------------------|-------------------|
| Exhibit Hall | 178,159 | 274' x 647' | 35' | 1,115 | 892 | 12,186 |
| EH-ABC | 136,435 | 274' x 501' | 35' | 851 | 681 | 9,320 |
| EH-BCD | 110,610 | 274' x 405' | 35' | 688 | 550 | 7,546 |
| EH-AB | 101,998 | 274' x 370' | 35' | 635 | 508 | 6,980 |
| EH-BC | 68,886 | 274' x 248' | 35' | 426 | 341 | 4,680 |
| EH-CD | 76,161 | 274' x 275' | 35' | 472 | 378 | 5,206 |
| EH-A | 67,549 | 274' x 246' | 35' | 420 | 335 | 4,640 |
| EH-B | 34,449 | 274' x 124' | 35' | 210 | 168 | 2,340 |
| EH-C | 34,437 | 274' x 124' | 35' | 210 | 168 | 2,340 |
| EH-D | 41,724 | 274' x 151' | 35' | 256 | 205 | 2,866 |

GREATER RICHMOND CONVENTION CENTER

MEETING ROOM SPECIFICATIONS

EXHIBIT HALL BUILDING - LEVEL I, MEETING ROOMS E10-E11

| MEETING SPACE | SQ. FT. | DIMENSIONS | CEILING HEIGHT | THEATER SEATING | CLASSROOM SEATING | BANQUET SEATING |
|---------------|---------|------------|----------------|-----------------|-------------------|-----------------|
| E10ABCD | 7,382 | 60' x 121' | 16' | 750 | 384 | 360 |
| E10ABC | 5,816 | 60' x 95' | 16' | 610 | 320 | 280 |
| E10BCD | 5,180 | 60' x 86' | 16' | 560 | 280 | 280 |
| E10AB | 4,009 | 60' x 65' | 16' | 410 | 210 | 200 |
| E10CD | 3,373 | 60' x 56' | 16' | 350 | 180 | 160 |
| E10A | 2,202 | 60' x 35' | 16' | 210 | 109 | 100 |
| E10B | 1,807 | 60' x 30' | 16' | 180 | 100 | 80 |
| E10C | 1,807 | 60' x 30' | 16' | 180 | 100 | 80 |
| E10D | 1,566 | 60' x 26' | 16' | 150 | 80 | 80 |
| E11ABC | 5,223 | 60' x 86' | 16' | 560 | 280 | 280 |
| E11AB | 3,657 | 60' x 60' | 16' | 400 | 200 | 200 |
| E11BC | 3,373 | 60' x 56' | 16' | 350 | 180 | 160 |
| E11A | 1,850 | 60' x 30' | 16' | 180 | 100 | 110 |
| E11B | 1,807 | 60' x 30' | 16' | 180 | 100 | 80 |
| E11C | 1,566 | 60' x 26' | 16' | 150 | 80 | 80 |

EXHIBIT HALL BUILDING - LEVEL II, MEETING ROOMS E20-E25

| MEETING SPACE | SQ. FT. | DIMENSIONS | CEILING HEIGHT | THEATER SEATING | CLASSROOM SEATING | BANQUET SEATING |
|---------------|---------|----------------------|----------------|-----------------|-------------------|-----------------|
| E20 | 811 | 18' x 33'; 25' x 25' | 28' 8" | 80 | 50 | 50 |
| E21ABC | 5,460 | 60' x 91' | 16' | 600 | 288 | 280 |
| E21BA | 3,900 | 60' x 60' | 16' | 400 | 200 | 200 |
| E21BC | 3,360 | 60' x 56' | 16' | 350 | 180 | 160 |
| E21A | 1,848 | 60' x 30' | 16' | 180 | 100 | 115 |
| E21B | 1,807 | 60' x 30' | 16' | 180 | 100 | 80 |
| E21C | 1,566 | 60' x 26' | 16' | 150 | 80 | 80 |
| E22AB | 1,837 | 23' x 71' | 16' | 150 | 100 | 100 |
| E22A | 1,228 | 23' x 47' | 16' | 100 | 65 | 60 |
| E22B | 609 | 23' x 24' | 16' | 50 | 34 | 30 |
| E23AB | 2,173 | 23' x 84' | 12' 8" | 190 | 110 | 100 |
| E23A | 1,228 | 23' x 47' | 12' 8" | 110 | 70 | 60 |
| E23B | 945 | 23' x 37' | 12' 8" | 80 | 40 | 40 |
| E24AB | 2,173 | 23' x 84' | 12' 8" | 190 | 110 | 100 |
| E24A | 1,228 | 23' x 47' | 12' 8" | 100 | 70 | 60 |
| E24B | 945 | 23' x 37' | 12' 8" | 80 | 40 | 40 |
| E25AB | 2,173 | 23' x 84' | 12' 8" | 190 | 110 | 100 |
| E25A | 1,228 | 23' x 47' | 12' 8" | 100 | 70 | 60 |
| E25B | 945 | 23' x 37' | 12' 8" | 80 | 40 | 40 |

GREATER RICHMOND CONVENTION CENTER FLOOR PLANS

LEVEL 1

- SHOW/REGISTRATION OFFICES & GREEN ROOMS
- FOOD & BEVERAGE
- MEETING SPACE
- COMMON AREA
- FLEXIBLE WALL
- RESTROOMS
- ESCALATORS
- BOX OFFICE
- ELEVATORS
- VENDING
- PARKING
- STAIRS
- ATMS
- INFORMATION
- RAMP

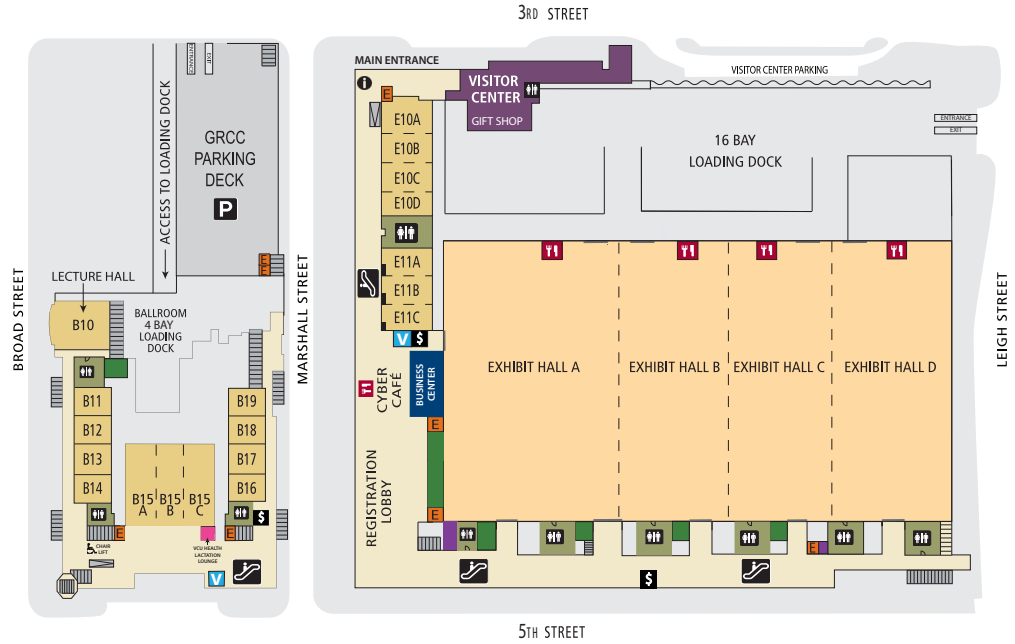

LEVEL 2

- SHOW/REGISTRATION OFFICES & GREEN ROOMS
- FOOD & BEVERAGE
- MEETING SPACE
- COMMON AREA
- FLEXIBLE WALL
- RESTROOMS
- ESCALATORS
- BOX OFFICE
- ELEVATORS
- VENDING
- PARKING
- STAIRS
- ATMS
- INFORMATION
- RAMP

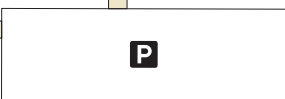
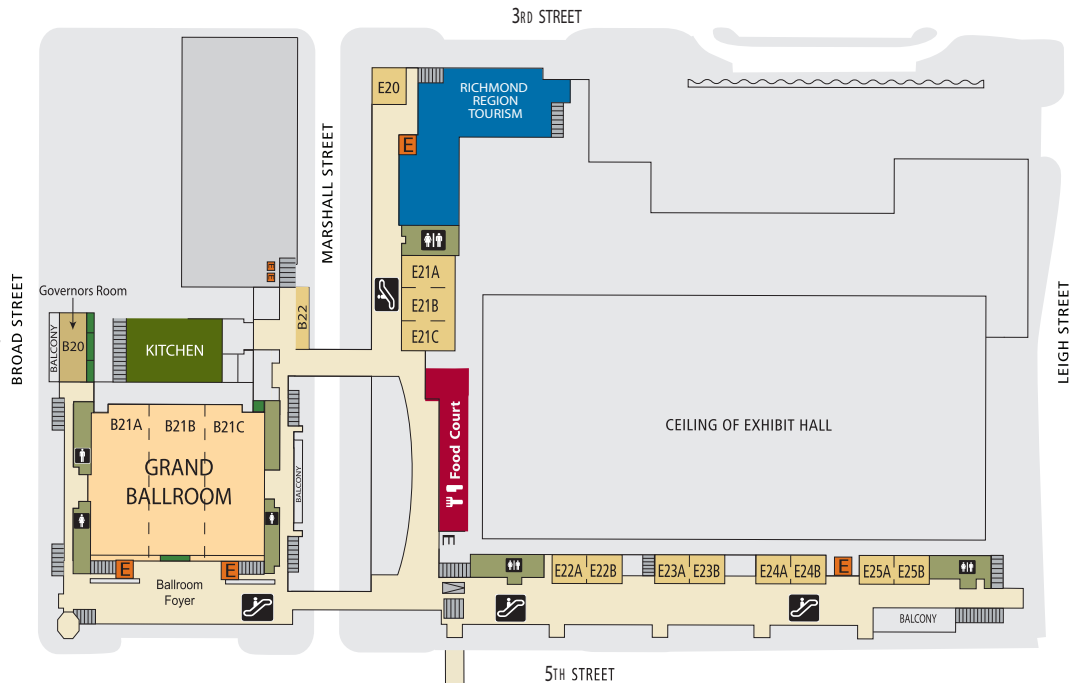

RICHMOND COLISEUM

601 E. Leigh St., Richmond, VA 23219
804-780-4970
richmondcoliseum.net

The Richmond Coliseum features concerts, sporting events and family shows. It is home to the APF Richmond Roughriders Arena Football team.

For larger events, the Richmond Coliseum is located adjacent to the Greater Richmond Convention Center. The Coliseum offers more than 70,000 square feet of space, as outlined in the chart to the right, and a 12,217-seat sports and entertainment arena.

Capacity: 12,217

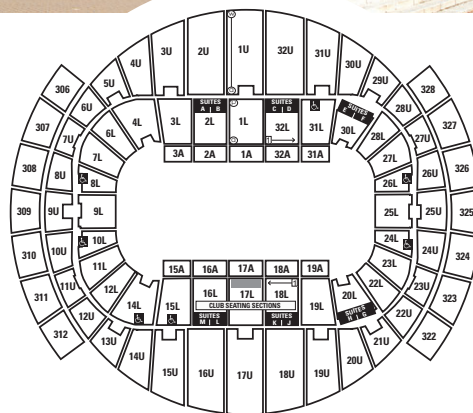

MAIN STREET STATION

1500 E. Main St., Richmond, VA 23219
804-523-3328
rmtaonline.org

National Historic Landmark. Includes newly renovated 47,000-square-foot train shed and event space. Other improvements include a new catering kitchen, larger capacity, and a new bridal green room. Open and booking events now. For Main Street Station events call: 804-523-3329 or 804-646-1768.

Capacity: 738

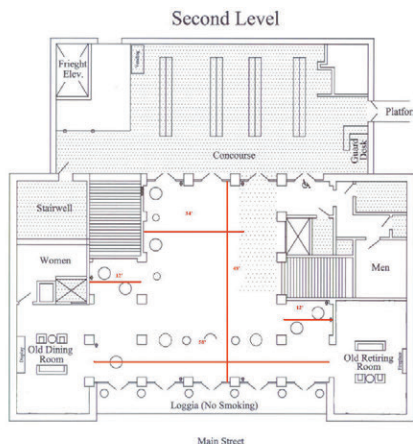
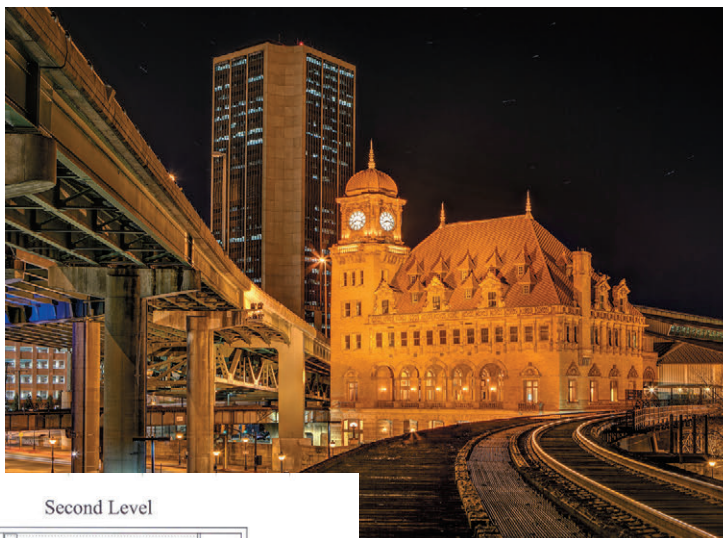

(Diagram depicts headhouse and does not include train shed space)

VIRGINIA MUSEUM OF FINE ARTS

200 N. Boulevard, Richmond, VA 23220
 804-340-1590
specialevents@vmfa.museum

The Virginia Museum of Fine Arts is an extraordinary venue for meetings and events, offering security, full-service catering and onsite parking. The historic buildings and striking architecture on campus, in combination with the remarkable permanent collection of more than 33,000 works of art, make the museum one of Richmond's greatest cultural assets.

VMFA offers theater-style seating in the Leslie Cheek Theater (472 max.) and in the Reynolds Lecture Hall (150 max.). The multipurpose Claiborne Robertson Room seats 75 for a meal or 60 classroom style. The Conference Center has two conference rooms. Conference Center 1 accommodates 40 and the Founder's Conference Room accommodates up to 30. Additionally, the museum offers spectacular settings for seated dinners up to 300 and receptions up to 1,000.

Capacity: 1,000

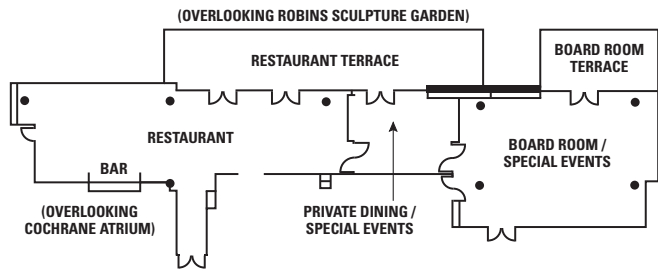

VIRGINIA WAR MEMORIAL

621 S. Belvidere St., Richmond, VA 23220
 804-786-2060
vawarmemorial.org

The Virginia War Memorial's 18,000-square-foot Paul and Phyllis Galanti Education Center provides state-of-the-art meeting space in a spectacular setting overlooking the James River and downtown business district. From board meetings to a reception for several hundred indoors or out, the Memorial can accommodate a variety of events.

Indoor venues include the VMI Alumni Hall of Honor, Freedom Hall, McMurtrie Grand Lobby, Reynolds Theater and Schumann Conference Room. Outdoor spaces include the Ukrop Terrace, Grand Terrace and the Heilman Amphitheater. Onsite parking and catering kitchen.

Capacity: 800

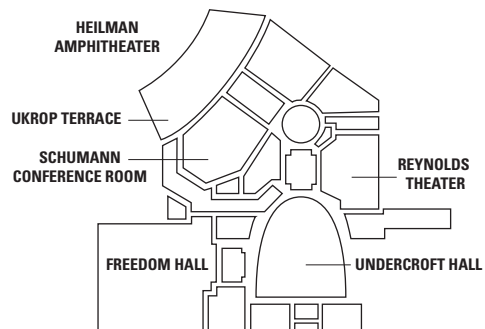

ALTRIA THEATER

A Dominion Arts Center Venue
6 N. Laurel St., Richmond, VA 23220
804-592-3368, altriatheater.com

Not only is the 3,600-seat Altria Theater the largest performance venue between New York and Atlanta, but the 180,000-square-foot complex also houses six lounges and a ballroom for private events.

Capacity: 3,600

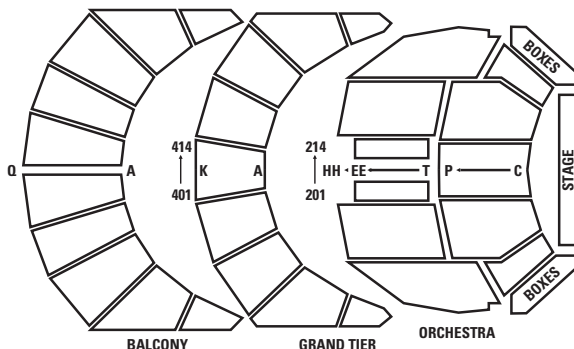

THE HIPPODROME THEATER AND MANSION

528 and 526 N. Second St., Richmond, VA 23219
804-266-2021, hippodromerichmond.com

The Hippodrome first opened in 1914 as a vaudeville and movie theater in Jackson Ward, while the Taylor Mansion next door, circa 1895, was home to a founder of an African-American-owned bank. In 2010, the two buildings were converted into a new, live music and entertainment venue with a restaurant and retail and residential space.

Capacity: 552



THE CULTURAL ARTS CENTER AT GLEN ALLEN

2880 Mountain Road, Glen Allen, VA 23060
804-261-6211, artsglenallen.com

The Center offers a unique arts-oriented setting with both indoor and outdoor spaces available for meetings, trade shows, special events and dinners. With 12 different spaces, The Center can accommodate groups from 20 to 250 people. Special features include a three-room art gallery and a 350-seat theater.

Capacity: 350

STUART C. SIEGEL CENTER

Virginia Commonwealth University
1200 W. Broad St., Richmond, VA 23284
804-827-1000, siegelcenter.com

The Stuart C. Siegel Center, located on the Monroe Park Campus of Virginia Commonwealth University, is a multipurpose facility that offers flexibility and style for events, athletics and community programs.

The Siegel Center is a perfect venue to hold a convention, trade show or concert. It can seat up to 7,500 people or offer 38,000 square feet of open floor space. The Siegel Center also offers meeting space, full-service in-house catering and concessions for its customers. Hospitality suites, which include the Tommy J. West Club and University and Athletic Suites, are available for rental.

Capacity: 7,500

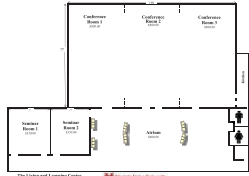
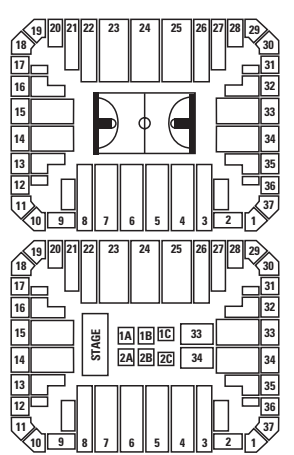

VIRGINIA UNION UNIVERSITY CLAUDE G. PERKINS LIVING AND LEARNING CENTER

1500 N. Lombardy St., Richmond, VA 23220
804-257-5600, vuu.edu

The Claude G. Perkins Living and Learning Center at Virginia Union University has been in operation for just over a year and is available for hosting events. Our facility includes a large banquet/ballroom that can accommodate different events. With the two air walls opened, the center is just under 6,000 square feet and also features two smaller meeting rooms with just more than 600 square feet of space each.

Capacity: 600

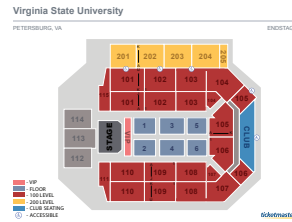

VIRGINIA STATE UNIVERSITY MULTI-PURPOSE CENTER

20809 Second Ave., Petersburg, VA 23803
804-524-3300, vsumpc.com

The VSU Multi-Purpose Center (MPC) is a state-of-the-art multipurpose venue located on the campus of Virginia State University. The arena is able to seat more than 6,000 guests, making it the largest events venue located south of Richmond in the state. The amenities-packed arena serves as a full entertainment facility hosting athletic events, commencements, live concerts, family shows, trade shows and more. The center officially opened in March 2016 and is home to the VSU Trojans basketball and volleyball teams. The MPC is managed by Spectra by Comcast Spectacor.

Capacity: 6,000



RICHMOND RACEWAY COMPLEX

600 E. Laburnum Ave., Richmond, VA 23222
 804-228-7506
richmondracewaycomplex.com

Richmond Raceway Complex is a sprawling, 1,000-acre, multipurpose facility that is home to Richmond Raceway and one of the most versatile special event sites in the country.

The complex has five buildings with more than 150,000 square feet of exhibition and meeting space as well as one of Richmond's most unique venues, the Torque Club. The Torque Club at Richmond Raceway overlooks the racetrack and makes the perfect setting for corporate, social and nonprofit events. With more than 50 plasma TVs, two built-in bars, a lounge and a view of the racetrack, it is the ideal space to host 20 to 500 people for your next meeting, luncheon or reception. You can make any Torque Club event unforgettable by offering pace car rides around Richmond Raceway.

The Old Dominion Building is a 36,000-square-foot facility with a 30-foot atrium and beautifully landscaped entrance ideal for large catered affairs, holiday parties and trade shows. In addition to exhibition halls and meeting facilities, the property also has the newly rejuvenated Classic Amphitheater, which offers covered seating for 6,000. Other outdoor venues on the property include the Horticulture Garden and Pavilion.

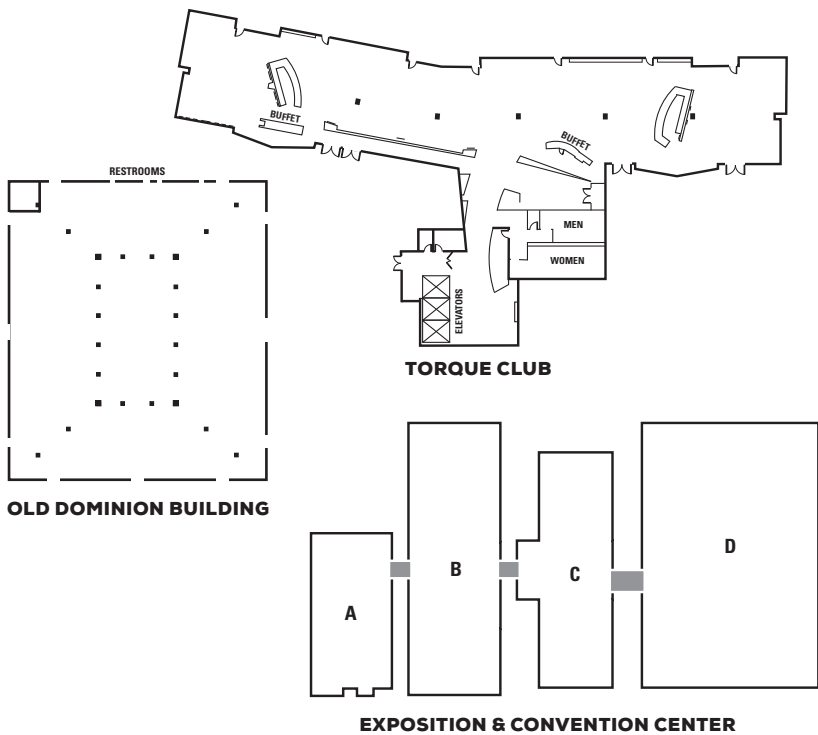

| MEETING SPACE | SQ. FT. | DIMENSIONS | RECEPTION | BANQUET | THEATER | CLASSROOM |
|---------------------------|---------|-------------------|-----------|---------|---------|-----------|
| A - Colonial Building | 10,000 | 140' x 50' x 10' | * | * | * | -- |
| B - Henrico Hall | 30,000 | 300' x 100' x 10' | * | * | * | -- |
| C - Commonwealth Building | 20,000 | 260' x 80' x 10' | * | * | * | -- |
| D - Exhibition Hall | 60,000 | 300' x 190' x 32' | * | * | * | -- |
| Classic Amphitheater | -- | -- | -- | -- | 6,000 | -- |
| Old Dominion Building | 36,000 | 225' x 174' x 30' | * | * | * | -- |
| Torque Club | 15,000 | -- | 500 | 200 | 150 | -- |

HOST YOUR EVENT AT RICHMOND RACEWAY COMPLEX

FLEXIBLE RENTAL SPACE

Special group ticket offers for NASCAR events

TORQUE Club 15,000 square feet

Executive club level with picturesque views featuring full catering & a/v needs

Exhibition Hall 50,000 square feet

Additional 60,000 square feet of space connected via breezeways

Open meeting space, customizable to your event needs

Old Dominion Building 36,000 square feet

Historic red-brick victorian space for an event with flair

The Classic Amphitheater 6,000 seat venue

Covered outdoor venue with stage and dressing rooms

NEW SPACE

OPENING SEPTEMBER 2018

- Infield Club
- Garage Suites
- Infield Hospitality Center
- Interactive Fan Experience Area
- Roof Top Lounge

**RICHMOND
RACEWAY
COMPLEX**

804-228-7506
RichmondRacewayComplex.com
600 East Laburnum Avenue, Richmond, VA 23222

Department of Parks, Recreation and Community Facilities

A little of something for everyone!



For more information on our programs, visit www.richmondgov.com/parks, check out our social media pages, or call 804-646-5733.



@rvaparksandrec



Levar M. Stoney, Mayor

DELTA HOTELS BY MARRIOTT RICHMOND DOWNTOWN

555 E. Canal St., Richmond, VA 23219
804-344-2967
marriott.com/ricde

The Delta Richmond Downtown overlooks the banks of the James River in the heart of the city's business district.

AMENITIES

- High-speed internet access in all space including guest rooms and meeting space
- Bar serving cocktails and a light menu
- Indoor swimming pool and onsite fitness center, including whirlpool
- Dedicated catering and banquet staff
- Onsite Rapids Rapids Fast Fare serving fresh grab and go items daily
- Onsite Quench Food + Spirits restaurant and bar serving breakfast, lunch and dinner daily
- Room service available daily
- Filtered water stations throughout the hotel
- Pet friendly hotel (allowing up to 50-pound pets – fees apply)
- Wheelchair-accessible facilities available

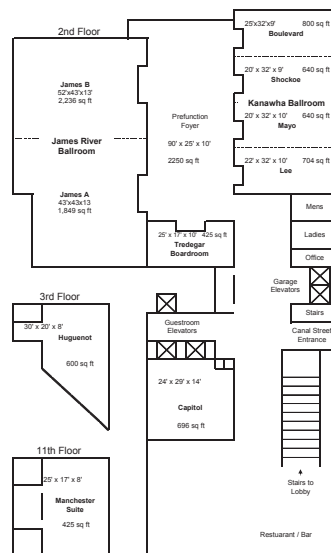

QUICK STATS

Miles from GRCC

◀1

Miles from RIC airport

9

Minutes to closest shops, restaurants

5

Total meeting space (sq. ft.)

13,000

Total rooms/suites

283/15

| MEETING SPACE | SQ. FT. | DIMENSIONS | RECEPTION | BANQUET | THEATER | CLASSROOM | CONFERENCE |
|----------------------|---------|------------|-----------|---------|---------|-----------|------------|
| Pre-Function | 2,250 | 90' x 25' | 200 | — | — | — | — |
| James River Ballroom | 4,085 | 95' x 43' | 450 | 300 | 400 | 200 | 85 |
| James A | 1,849 | 43' x 43' | 200 | 100 | 150 | 65 | 33 |
| James B | 2,236 | 52' x 43' | 200 | 100 | 170 | 75 | 48 |
| Kanawha Ballroom | 2,784 | 87' x 32' | 292 | 216 | 240 | 140 | 50 |
| Mayo | 640 | 20' x 32' | 49 | 32 | 49 | 25 | 20 |
| Lee | 704 | 22' x 32' | 49 | 40 | 49 | 25 | 24 |
| Shockoe | 640 | 20' x 32' | 49 | 32 | 49 | 25 | 20 |
| Boulevard | 800 | 25' x 32' | 49 | 40 | 49 | 25 | 24 |
| Capitol | 696 | 24' x 29' | 60 | 36 | 60 | 24 | 20 |
| Tredegar Boardroom | 463 | 26' x 18' | — | — | — | — | 20 |
| Huguenot | 600 | 30' x 20' | — | — | — | — | 18 |
| Manchester Suite | 425 | 25' x 17' | 36 | — | 36 | 18 | 18 |
| Rocketts Landing | 1,983 | 60' x 38' | 100 | 120 | 80 | 50 | 15 |



DOUBLETREE BY HILTON RICHMOND-MIDLOTHIAN

1021 Koger Center Blvd., Richmond, VA 23235
 804-379-3800
richmondmidlothian.doubletree.com

This suburban conference center is located in Northern Chesterfield County.

QUICK STATS

Miles from GRCC

11

Miles from RIC airport

20

Minutes to closest shops, restaurants

<1

Total meeting space (sq. ft.)

26,000

Total rooms/suites

228/9



AMENITIES

- Two ballrooms and 10 breakout rooms
- Banquets for 520 in the James River Ballroom, 460 in the Shenandoah Ballroom
- In-room amenities include coffee and tea by The Coffee Bean and Leaf Company, microwave/refrigerator, Sweet Dreams Sleep Experience and complimentary Wi-Fi
- Midlo-Bistro, a full-service restaurant
- Indoor pool and exercise room
- Adjacent to sports and fitness center with indoor/outdoor tennis, jogging trails and a seasonal water park
- Adjacent to Huguenot Park for picnics and outdoor gatherings
- Golf packages available
- Free parking

| MEETING SPACE | SQ. FT. | RECEPTION | BANQUET | THEATER | CLASSROOM | CONFERENCE | U-SHAPE |
|-------------------------|---------|-----------|---------|---------|-----------|------------|---------|
| Shenandoah Ballroom | 6,300 | 750 | 460 | 700 | 280 | – | – |
| Foyer (pre-function) | 1,680 | 250 | – | – | – | – | – |
| Parlor A & B (each) | 1,050 | 125 | 50 | 90 | 42 | 40 | 35 |
| Parlor C & D (each) | 2,100 | 375 | 150 | 240 | 96 | 80 | 60 |
| Parlor A & B (combined) | 2,100 | 375 | 140 | 180 | 90 | 80 | 60 |
| Parlor C & D (combined) | 4,200 | 600 | 290 | 480 | 192 | – | – |
| York Room | 648 | 49 | 40 | 49 | 24 | 25 | 21 |
| James River Ballroom | 7,080 | 900 | 520 | 760 | 360 | – | – |
| Foyer (pre-function) | 1,925 | 150 | – | – | – | – | – |
| Corridor (pre-function) | 1,440 | 100 | – | – | – | – | – |
| Parlor E & F (each) | 870 | 100 | 50 | 85 | 39 | 25 | 27 |
| Parlor E & F (combined) | 1,740 | 250 | 120 | 180 | 84 | 40 | 45 |
| Parlor G | 1,770 | 250 | 140 | 200 | 90 | 40 | 45 |
| Parlor H | 3,540 | 400 | 260 | 380 | 174 | 40 | 50 |
| Parlor G & H (combined) | 5,310 | 650 | 400 | 580 | 270 | – | – |
| Midlothian Room | 350 | 20 | 20 | 20 | 12 | 20 | – |
| New River Room | 648 | 50 | 40 | 45 | 24 | 25 | 21 |
| Board Room | 324 | – | – | – | – | 10 | – |
| Atrium | 750 | 50 | – | – | – | – | – |
| Chesterfield Room | 1,032 | 100 | 50 | 60 | 36 | 35 | 20 |
| Suites 802 & 806 (each) | – | 35 | – | – | – | 12 | – |
| Pond & Cove (each) | 264 | – | 20 | 20 | 12 | 12 | – |
| Anna Room | 648 | 50 | 40 | 45 | 24 | 25 | 21 |
| Bon Air Suite | 648 | 49 | 40 | 49 | 24 | 25 | 21 |

THE EXECUTIVE MEETING CENTER AT EMBASSY SUITES BY HILTON RICHMOND

**2925 Emerywood Parkway,
Richmond, VA 23294
804-672-8585
richmond.embassysuites.com**

The IACC-approved Executive Meeting Center (EMC) is complemented by spacious two-room suite accommodations. The EMC is designed to provide the optimum environment for high productivity, including the IACC standard equipment, technology and meeting room amenities that provide maximum comfort to attendees. The comprehensive conference package with all-inclusive pricing allows planners to customize each event and have time to focus on the content of the meeting.



AMENITIES

- Seven individual meeting rooms
- Dedicated conference planning manager
- Non-glare oversized tables and 18-hour ergonomic chairs
- Surround-room whiteboards and tackable surfaces
- Task lighting with in-room controls
- Sound-proof walls and finishes
- High-speed internet access and full-service AV support
- Full made-to-order breakfast and two-hour complimentary evening reception daily
- In-room amenities include Internet, two phones, two 37-inch flat-panel TVs, refrigerator, microwave, coffee-maker, iron, ironing board and hair dryer
- Ample free parking

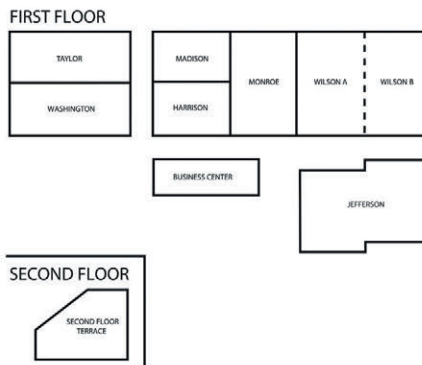

QUICK STATS

- Miles from GRCC
8
- Miles from RIC airport
18
- Minutes to closest shops, restaurants
<1
- Total meeting space (sq. ft.)
9,900
- Total rooms/suites
225

| MEETING SPACE | SQ. FT. | DIMENSIONS | CEILING | PODS OF 6 | CLASSROOM | CONFERENCE | U-SHAPE | HOLLOW |
|---------------------|---------|------------|---------|-----------|-----------|------------|---------|--------|
| Washington | 792 | 33' x 24' | 10' | 24 | 28 | 22 | 22 | 24 |
| Taylor | 792 | 33' x 24' | 10' | 24 | 28 | 22 | 22 | 24 |
| Madison | 660 | 30' x 22' | 10' | 18 | 18 | 16 | 16 | 16 |
| Harrison | 660 | 30' x 22' | 10' | 18 | 18 | 16 | 16 | 18 |
| Monroe | 1,218 | 42' x 29' | 10' | 48 | 50 | 28 | 28 | 36 |
| Wilson A | 1,218 | 42' x 29' | 10' | 48 | 50 | 28 | 28 | 36 |
| Wilson B | 1,218 | 42' x 29' | 10' | 48 | 50 | 28 | 28 | 36 |
| Wilson A & B | 2,436 | 42' x 58' | 10' | 96 | 110 | - | - | - |
| Exec. Boardroom (2) | 304 | 13' x 18' | 8' | - | - | 10 | - | - |
| Jefferson | 1,560 | varied | 8' | - | 40 | - | - | 40 |
| Second Fl. Terrace | 1,105 | 48' x 37' | - | - | - | - | - | - |



FOUR POINTS BY SHERATON RICHMOND

9901 Midlothian Turnpike, Richmond, VA 23235
804-323-1144
fourpointsrichmond.com

The Four Points by Sheraton Richmond offers all the modern conveniences and amenities to make you feel comfortable and connected.

QUICK STATS

Miles from GRCC

15

Miles from RIC airport

20

Minutes to closest
shops, restaurants

<1

Total meeting space
(sq. ft.)

7,628

Total rooms/suites

183/11

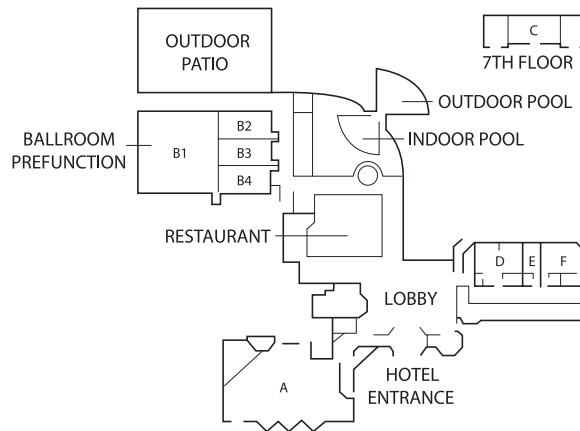

AMENITIES

- Fork & Vine Restaurant
- Indoor/outdoor swimming pool and Jacuzzi
- Business center
- Adjacent to Moorefield Park lakes and walking trails
- Flexible meeting rooms
- Enterprise car rental service available
- Complimentary high-speed internet access in all guest rooms
- Five minutes from Chesterfield Town Center

| MEETING SPACE | SQ. FT. | DIMENSIONS | HEIGHT | BANQUET | THEATER | RECEPTION | CLASSROOM | CONFERENCE |
|---------------------------------|---------|------------|--------|---------|---------|-----------|-----------|------------|
| Chesapeake | 2,400 | 60' x 40' | 10' | 200 | 275 | 300 | 75 | - |
| Ballroom Prefunction | 720 | 50' x 9' | - | - | - | 150 | - | - |
| Ballroom | 4,000 | 80' x 50' | - | 350 | 450 | 550 | 200 | - |
| Eppington | 2,250 | 50' x 45' | - | 200 | 250 | 275 | 110 | - |
| Ampt Hill | 595 | 35' x 17' | 12' | 32 | 65 | 50 | 25 | 20 |
| Castlewood | 595 | 35' x 17' | 12' | 32 | 65 | 50 | 25 | 20 |
| Alandale | 595 | 35' x 17' | 12' | 32 | 65 | 50 | 25 | 20 |
| Castlewood & Alandale | 1,190 | 35' x 17' | - | 75 | 120 | 100 | 30 | 35 |
| Alandale, Castlewood, Ampt Hill | 1,785 | 51' x 35' | - | 125 | 170 | 150 | 30 | 50 |
| Bon Air | 400 | 25' x 17' | 12' | - | - | 25 | - | 16 |
| Salisbury | 360 | 24' x 15' | 12' | - | - | 15 | - | 10 |
| Moorefield | 450 | 25' x 18' | 12' | - | - | 25 | - | 16 |
| Bellgrade | 180 | 15' x 12' | - | - | - | - | - | 6 |

FOUR POINTS BY SHERATON AIRPORT

4700 S. Laburnum Avenue, Richmond, VA 23231
804-226-4300

fourpointsrichmondairport.com

The Richmond airport hotel has flexible pre-function and event space and can host groups of up to 325 guests. Let the friendly staff help you plan your next Richmond meeting or special event.



AMENITIES

- 24-hour shuttle service to and from RIC airport or within a five mile radius of the hotel
- 24-hour fitness center
- Indoor pool open daily
- Terra Nova Grille and Lounge, a full-service restaurant featuring Southern cuisine
- Free coffee in the lobby
- Free high speed internet access

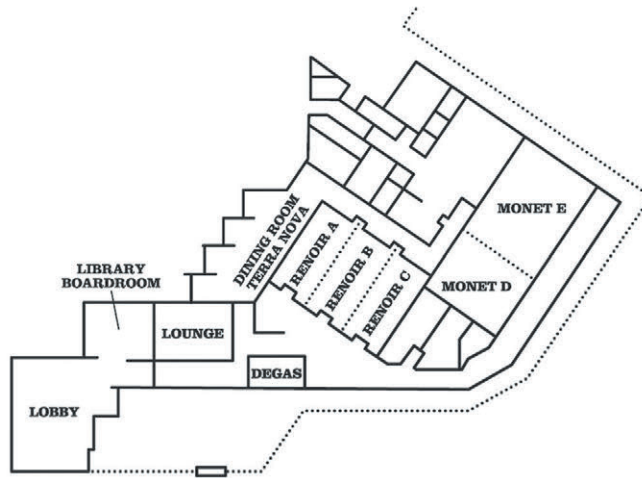

QUICK STATS

Miles from GRCC

6

Miles from RIC airport

3

Minutes to closest shops, restaurants

<1

Total meeting space (sq. ft.)

11,000

Total rooms/suites

152/3

| MEETING SPACE | SQ. FT. | DIMENSIONS | CEILING | RECEPTION | BANQUET | THEATER | CONFERENCE | CLASSROOM | U-SHAPE | HOLLOW SQ. |
|-----------------------|---------|------------|---------|-----------|---------|---------|------------|-----------|---------|------------|
| Monet E | 1,862 | 49' x 38' | 10' | 200 | 64 | 200 | 40 | 75 | 40 | 47 |
| Renoir Ballroom | 2,400 | 60' x 40' | 12' | 250 | 200 | 250 | - | 100 | 50 | 57 |
| Monet D | 1,102 | 29' x 38' | 10' | 120 | 48 | 120 | 30 | 60 | 25 | 32 |
| Monet Ballroom | 2,964 | 78' x 38' | 10' | 325 | 240 | 325 | - | 140 | 60 | 67 |
| Atrium | 2,250 | 50' x 45' | 40' | 175 | 150 | 150 | - | - | - | - |
| Renoir Prefunction | 2,100 | 70' x 30' | 10' | 50 | - | - | - | - | - | - |
| Renoir A & B or B & C | 1,600 | 40' x 40' | 12' | 150 | 128 | 150 | 60 | 60 | 40 | 47 |
| Monet Prefunction | 1,001 | 100' x 10' | 10' | 50 | - | - | - | - | - | - |
| The Degas Boardroom | 200 | 10' x 20' | 12' | 10 | 8 | 15 | 10 | - | - | - |
| The Library Boardroom | 529 | 23' x 23' | 10' | 30 | 30 | - | 15 | - | - | - |
| Renoir A, B or C | 800 | 20' x 40' | 12' | 75 | 64 | 75 | 30 | 30 | 30 | 37 |



HILTON RICHMOND DOWNTOWN

501 E. Broad St., Richmond, VA 23219
804-344-4300

richmonddowntown.hilton.com

The Hilton Richmond Downtown, built in the historic Miller & Rhoads Department Store building, is located in a vibrant section of the city and within walking distance of many cultural and entertainment venues.

AMENITIES

- Complimentary wired and wireless high-speed internet in all guest rooms
- Full-service catering with dedicated catering and event specialists
- Refrigerator in each room
- Complimentary 24-hour business center
- Herb N' Kitchen, serving breakfast, lunch and dinner
- Full-service lounge, Thirst & Fifth
- Indoor swimming pool, Jacuzzi and fitness center
- Complimentary shuttle available (from 6 a.m. to 10 p.m. daily) for destinations within a two-mile radius of the hotel
- Executive floor and lounge

QUICK STATS

Miles from GRCC
ACROSS THE STREET

Miles from RIC airport
9

Minutes to closest shops, restaurants

<1

Total meeting space (sq. ft.)

15,000

Total rooms/suites

250/15

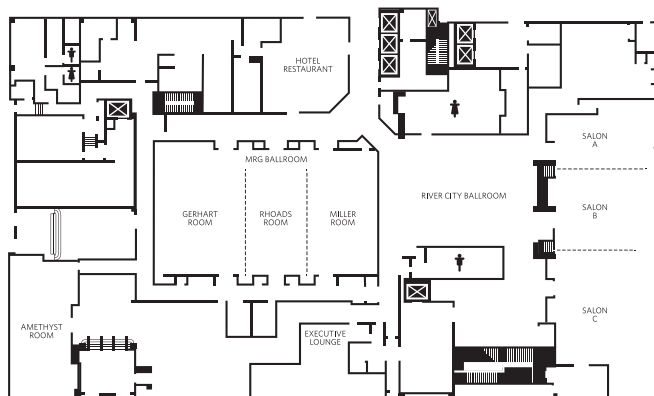

| MEETING SPACE | SQ. FT. | DIMENSIONS | CEILING | RECEPTION | THEATER | CLASSROOM | BANQUET | CRESENT ROUND OF 5 | CONFERENCE | U-SHAPE | HOLLOW SQ. |
|-----------------------------|---------|------------|---------|-----------|---------|-----------|---------|--------------------|------------|---------|------------|
| River City Ballroom | 4,720 | 118' x 40' | 11' | 400 | 380 | 154 | 270 | - | - | - | - |
| Salon A | 1,000 | 40' x 27' | 11' | 70 | 80 | 30 | 70 | - | 18 | 18 | 15 |
| Salon B | 1,300 | 40' x 32' | 11' | 120 | 120 | 52 | 70 | - | 15 | 18 | - |
| Salon C | 2,100 | 40' x 58' | 11' | 150 | 180 | 72 | 130 | - | 21 | 25 | 21 |
| MRG Ballroom | 3,080 | 88' x 35' | 12' | 350 | 400 | 220 | 256 | 160 | - | - | - |
| Miller | 1,000 | 35' x 28' | 12' | 100 | 135 | 60 | 80 | 50 | 36 | 24 | 30 |
| Rhoads | 850 | 35' x 24' | 12' | 90 | 130 | 63 | 64 | 40 | 36 | 15 | 20 |
| Gerhart | 1,275 | 36' x 35' | 12' | 135 | 170 | 82 | 105 | 60 | 40 | 30 | 30 |
| Amethyst | 1,365 | 22' x 53' | 11' | 120 | 130 | 50 | 100 | - | 35 | 35 | 29 |
| Old Dominion | 400 | 14' x 29' | 10' | - | - | - | - | - | 12 | - | - |
| River City Prefunction Area | 3,500 | 64' x 41' | 10' | - | - | - | - | - | - | - | - |
| MRG Prefunction Area | 1,362 | n/a | n/a | - | - | - | - | - | - | - | - |

HILTON RICHMOND HOTEL & SPA SHORT PUMP

12042 W. Broad St., Richmond, VA 23233
804-364-3600
hiltonrichmond.com

Located adjacent to the acclaimed Short Pump Town Center, the Hilton Richmond Hotel & Spa offers beautiful function space, fine dining and plentiful attractions, activities and upscale shopping next door.

AMENITIES

- Flat-panel televisions, iPod alarm clocks and the Hilton Signature Bed
- Abundant pre-function space and 20-foot ceilings in the Capital Ballroom
- Shula's America's Steak House and Lounge
- Aroma Café proudly serves Starbucks coffee
- Complimentary high-speed wireless internet service
- Indoor swimming pool, whirlpool, fitness center and sundeck
- Aura Spa and Salon is open seven days a week
- Executive floor and executive lounge with junior and executive suites
- Complimentary surface and underground parking
- Customized group webpages for ease of online reservations

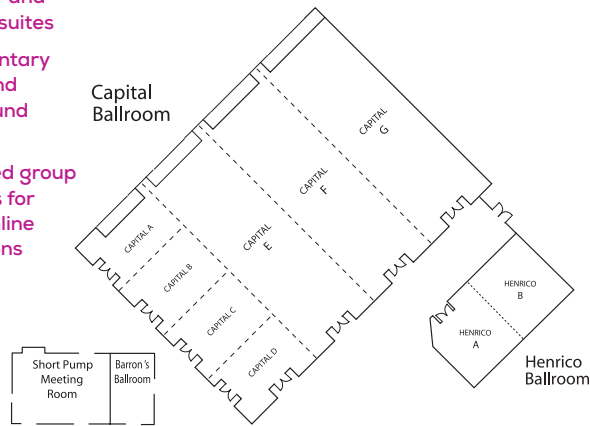

QUICK STATS

Miles from GRCC

15

Miles from RIC airport

25

Minutes to closest shops, restaurants
ADJACENT TO A MALL

Total meeting space (sq. ft.)

24,653

Total rooms/suites

250/4

| MEETING SPACE | SQ. FT. | DIMENSIONS | ROUNDS OF 10 | CLASSROOM | THEATER | CONFERENCE |
|-----------------------------|---------|------------|--------------|-----------|---------|------------|
| Capital Boardroom | 10,332 | 84' x 124' | 795 | 680 | 1,000 | - |
| Capital A | 651 | 21' x 31' | 50 | 40 | 65 | - |
| Capital B | 651 | 21' x 31' | 50 | 40 | 65 | - |
| Capital C | 651 | 21' x 31' | 50 | 40 | 65 | - |
| Capital D | 651 | 21' x 31' | 50 | 40 | 65 | - |
| Capital E | 2,604 | 31' x 84' | 200 | 170 | 270 | - |
| Capital F | 2,604 | 31' x 84' | 200 | 170 | 270 | - |
| Capital G | 2,520 | 31' x 84' | 190 | 160 | 265 | - |
| Capital Pre-function | 6,200 | - | - | - | - | - |
| Henrico Ballroom | 1,274 | 26' x 49' | 90 | 85 | 130 | - |
| Henrico A | 520 | 26' x 20' | 40 | 35 | 55 | - |
| Henrico B | 754 | 26' x 29' | 50 | 50 | 75 | - |
| Towne Center (pre-function) | 925 | - | - | - | - | - |
| Barron's Ballroom | 400 | 25' x 16' | - | - | - | 16 |
| Short Pump Meeting Room | 910 | 35' x 26' | 70 | 60 | 90 | - |



HOMEWOOD SUITES AND HAMPTON INN & SUITES RICHMOND DOWNTOWN

700 E. Main St., Richmond, VA 23219

Homewood Suites: 804-643-2900

richmonddowntown.homewoodsuites.com

Hampton Inn & Suites: 804-643-2500

richmonddowntownsuites.hamptoninn.com

Our convenient location in the heart of the Richmond financial district is just steps from the Virginia State Capitol, Federal Courthouse, Greater Richmond Convention Center, and a multitude of entertainment and shopping.

QUICK STATS

Miles from GRCC

<1

Miles from RIC airport

8

Minutes to closest shops, restaurants

<1

Total meeting space (sq. ft.)

6,800

Total rooms/suites

96/148

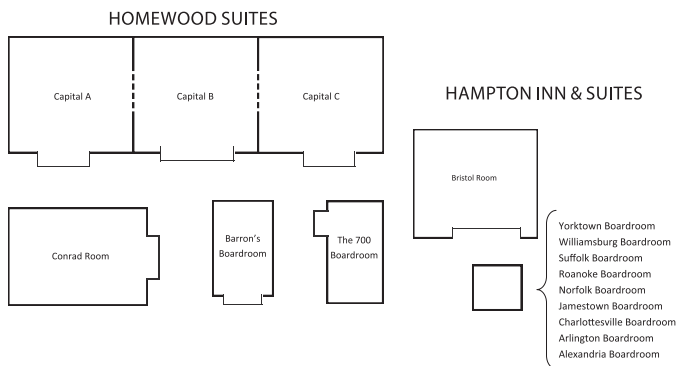

AMENITIES

- Complimentary Wi-Fi in all guest rooms
- Complimentary hot breakfast
- Complimentary 24-hour rooftop fitness center
- Belle and James French-American Restaurant
- Kabana rooftop restaurant, lounge, and event space
- Sip Cafe featuring cold pressed smoothies and quinoa bowls
- Outdoor rooftop pool

| MEETING SPACE | SQ. FT. | BANQUET | CONFERENCE | CLASSROOM | HOLLOW SQ. | THEATER | RECEPTION |
|---------------------------|---------|---------|------------|-----------|------------|---------|-----------|
| Capital Ballroom | 2,820 | 180 | 60 | 150 | – | 300 | 275 |
| Capital A | 960 | 60 | 20 | 50 | 20 | 100 | 90 |
| Capital B | 960 | 60 | 20 | 50 | 20 | 100 | 90 |
| Capital C | 960 | 60 | 20 | 50 | 20 | 100 | 90 |
| Conrad Room | 936 | 60 | 20 | 40 | 20 | 70 | 60 |
| Barron's Boardroom | 384 | – | 10 | – | – | – | – |
| The 700 Boardroom | 364 | – | 10 | – | – | – | – |
| Bristol Room | 1,050 | 80 | 20 | 65 | 20 | 80 | 75 |
| Yorktown Boardroom | 121 | 8 | 8 | – | – | – | – |
| Williamsburg Boardroom | 121 | 8 | 8 | – | – | – | – |
| Suffolk Boardroom | 121 | 8 | 8 | – | – | – | – |
| Roanoke Boardroom | 121 | 8 | 8 | – | – | – | – |
| Norfolk Boardroom | 121 | 8 | 8 | – | – | – | – |
| Jamestown Boardroom | 121 | 8 | 8 | – | – | – | – |
| Charlottesville Boardroom | 121 | 8 | 8 | – | – | – | – |
| Arlington Boardroom | 121 | 8 | 8 | – | – | – | – |
| Alexandria Boardroom | 121 | 8 | 8 | – | – | – | – |

THE JEFFERSON HOTEL

101 W. Franklin St., Richmond, VA 23220
804-788-8000 or 800-424-8014

jeffersonhotel.com

The Jefferson Hotel is a national historic landmark and a member of Preferred Hotels and Resorts. In 2017, The Jefferson was again recognized as both a AAA Five Diamond and Forbes Five Star award winner.



AMENITIES

- Two business centers
- 24-hour room service and concierge service
- TJ's Restaurant and Lounge for a casual meal next to Rotunda
- Nationally recognized Lemaire restaurant
- State-of-the-art health club with indoor pool
- Complimentary high-speed WiFi in overnights and meeting rooms
- Complimentary downtown transportation

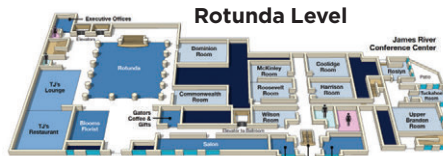

QUICK STATS

Miles from GRCC

<1

Miles from RIC airport

10

Minutes to closest shops, restaurants

<1

Total meeting space (sq. ft.)

26,000

Total rooms/suites

166/15

| | MEETING SPACE | SQ. FT. | DIMENSIONS | THEATER | BANQUET | CLASSROOM | RECEPTION | U-SHAPE | |
|-------------------------------|---------------------------------------|---------|--------------------------------------|--|---------|-----------|-----------|---------|--|
| ROTUNDA LEVEL | Rotunda | 2,944 | n/a | 180* | n/a | n/a | 450 | n/a | |
| | Dominion Room | 806 | 31x26 | 60 | 60* | 45** | 70 | 30** | |
| | Commonwealth Room | 660 | 30x22 | 50 | 50* | 30** | 55 | 24** | |
| | Wilson Room | 456 | 24x 19 | 30 | 30* | 18** | 25 | 15** | |
| | Roosevelt Room | 552 | 24x23 | 40 | 50* | 27** | 40 | 18** | |
| | Harrison Room | 528 | 24x22 | 40 | 40* | 36** | 40 | 18** | |
| | McKinley Room | 456 | 24x19 | 40 | 40* | 27** | 25 | 18** | |
| | Coolidge Room | 696 | 29x24 | 40 | 50* | 36** | 55 | 18** | |
| PALM COURT LEVEL | Mezzanine | 1,310 | n/a | n/a | 120* | n/a | 80/50/40 | | |
| | Washington Boardroom | 336 | 21x16 | Permanent conference for 10 guests plus anteroom | | | | | |
| | Monticello Boardroom | 384 | 24x16 | Permanent conference for 12 guests plus anteroom | | | | | |
| | Flemish Room | 1,320 | 30x44 | 90 | 80* | 54** | 100 | 36** | |
| | Empire Room | 4,050 | 90x45 | 290 | 270* | 150** | 400 | 45** | |
| | Grand Ballroom | 4,556 | 67x68 | 480 | 420* | 240** | 450 | 69** | |
| | Grand Ballroom Stage | 325 | 25x13 | | | | | | |
| Ginter Gallery | 1,388 | | Pre-function area for Grand Ballroom | | | | | | |
| JAMES RIVER CONFERENCE CENTER | 1ST LEVEL OF CONFERENCE CENTER | | | | | | | | |
| | Upper Brandon | 696 | 29x24 | n/a | n/a | 24** | n/a | 22** | |
| | Tuckahoe Room | 192 | 12x16 | Permanent conference for 6 | | | | | |
| | Roslyn Room | 300 | 20x15 | Break room | | | | | |
| | 2ND LEVEL OF CONFERENCE CENTER | | | | | | | | |
| | Shirley Room | 288 | 16x18 | Permanent conference for 10 | | | | | |
| | Tredegar Rooms (1, 2 & 3) | 416 | 26x16 | Permanent conference for 2/2/4 | | | | | |
| | Berkley Room | 260 | 20x13 | Permanent conference for 8 | | | | | |
| | Westover Room | 320 | 20x16 | Permanent conference for 10 | | | | | |

*10 per 5' Round Table | **3 per 6'x18 Table - limited to no Audio Visual

*10 per 5' Round Table | **3 per 6'x18 Table - limited to no Audio Visual

*no elevator access, stairs required | **two executive chairs per linen less 5'x24" table



OMNI RICHMOND HOTEL

100 S. 12th St., Richmond, VA 23219
804-344-7000

OmniHotels.com/Richmond

The Omni Richmond Hotel is located at Richmond's premier business and leisure address. Overlooking the scenic James River in the heart of the city's financial and historic districts, the hotel offers both superb business amenities and rich American history. Fine dining, shopping and entertainment options are available right outside the front door in historic Shockoe Slip.

QUICK STATS

Miles from GRCC

1

Miles from RIC airport

9

Minutes to closest
shops, restaurants

<1

Total meeting space
(sq. ft.)

15,000

Total rooms/suites

361/6

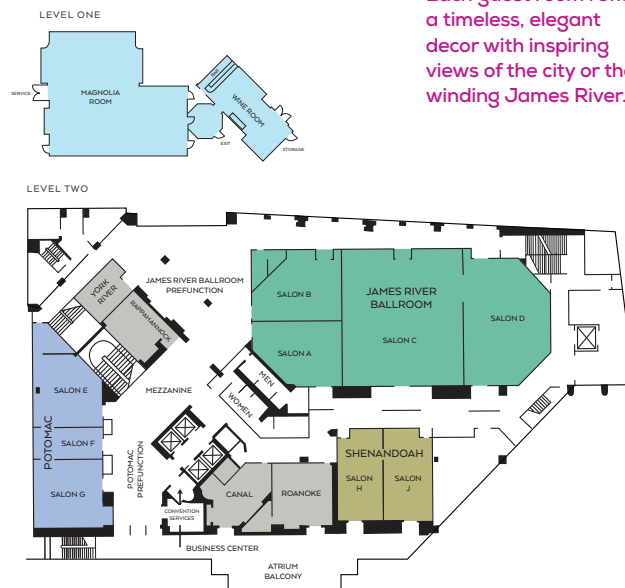

AMENITIES

- Each guest room reflects a timeless, elegant decor with inspiring views of the city or the winding James River.
- Trevi's Grille is an Italian trattoria restaurant in an open atrium setting. The menu reflects an offering of classic Italian dishes from the many regions of Italy. Trevi's Grille also offers full service breakfast and the Art of Breakfast buffet. Open daily for breakfast, lunch and dinner.
- Trevi's Market offers quick and convenient breakfast and lunch to go menu options. Open Monday to Friday.
- Guest-room dining available from 6 a.m. to 11 p.m.
- A full-service Starbucks coffee shop is offered in the hotel's main lobby.

| MEETING SPACE | SQ. FT. | RECEPTION | BANQUET | THEATER | CLASSROOM |
|------------------------------|---------|-----------|---------|---------|-----------|
| James River Ballroom (total) | 7,027 | 720 | 550 | 800 | 435 |
| Salon A | 1,174 | 140 | 65 | 140 | 50 |
| Salon B | 1,000 | 130 | 60 | 120 | 45 |
| Salon C | 2,679 | 250 | 220 | 260 | 180 |
| Salon D | 2,174 | 200 | 170 | 210 | 100 |
| York River | 340 | 30 | 24 | 30 | 22 |
| Rappahannock | 462 | 50 | 40 | 45 | 32 |
| Potomac (total) | 2,396 | 310 | 150 | 238 | 145 |
| Salon E | 986 | 125 | 60 | 94 | 56 |
| Salon F | 526 | 60 | 32 | 50 | 34 |
| Salon G | 884 | 125 | 60 | 94 | 56 |
| Boardroom | 256 | — | 16 | — | — |
| Roanoke | 676 | 60 | 50 | 45 | 32 |
| Shenandoah (total) | 1,426 | 150 | 120 | 130 | 112 |
| Salon H | 620 | 60 | 50 | 63 | 56 |
| Salon J | 806 | 60 | 50 | 63 | 56 |
| Magnolia Room and Wine Bar | 2,460 | 225 | 170 | 250 | 100 |

QUIRK HOTEL

201 W. Broad St., Richmond, VA 23220
844-757-8475
quirkhotel.com

This boutique hotel was named one of the top 60 “Best New Hotels in the World” in *Condé Nast Traveler’s* 2016 Hot List. A hub for authentic Richmond experiences, Quirk’s adjoining gallery showcases local and international artists and offers unique gifts, the acclaimed restaurant Maple & Pine serves creative dishes with local ingredients, and the Q Rooftop Bar offers a fantastic view of the city skyline along with artisan cocktails.



AMENITIES

- Quirk Art Gallery
- Boutique shop
- Maple & Pine signature restaurant
- Courtyard and patio outdoor spaces
- Q Rooftop Bar
- Lobby Coffee Bar
- Fitness Center
- Valet parking
- Bike rentals
- Daily newspaper
- Original artwork, custom designed furniture and large windows in each room
- Tesla Destination Charging stations
- Charismatic meeting spaces accommodating business meetings and social events, plus the Creative Meetings at Quirk service offering extras including catering and out-of-the box onsite sessions
- Located in Richmond’s Arts District surrounded by small art galleries, unique shopping, thrilling entertainment, and renowned restaurants

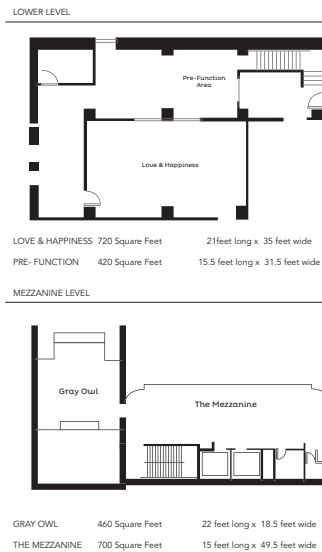

QUICK STATS

Miles from GRCC
<1

Miles from RIC airport
10

Minutes to closest shops, restaurants
<1

Total meeting space (sq. ft.)
3,000

Total rooms/suites
69/5

| MEETING SPACE | DIMENSIONS | THEATER | BANQUET | CLASSROOM | RECEPTION | U-SHAPE |
|-----------------------------------|---------------|---------|---------|-----------|-----------|---------|
| Art Gallery | 15' x 49.5' | – | 24 | – | 45 | – |
| Art Gallery & Courtyard | 36' x 87.5' | – | 80 | – | 105 | – |
| Courtyard | 21' x 38' | – | 56 | 24 | 60 | 20 |
| Gray Owl | 22' x 18.5' | 40 | 24 | – | 25 | 10 |
| Gray Owl & Mezzanine | 37' x 68' | – | 64 | – | 70 | – |
| Mezzanine | 15' x 49.5' | 65 | 40 | – | 45 | – |
| The Rooftop & Terrace | 117' x 26.5' | 140 | – | – | 126 | – |
| Terrace | 35' x 26.5' | 70 | 48 | 18 | 65 | 20 |
| The Rooftop | 82' x 26.5' | 70 | – | – | – | – |
| Love & Happiness | 21' x 35' | 70 | 56 | 24 | 60 | 20 |
| Love & Happiness/ Pre-Function | 36.5' x 66.5' | – | 80 | – | 100 | – |



RICHMOND MARRIOTT

500 E. Broad St., Richmond, VA 23219
 804-643-3400
marriott.com/ricdt

Located in the heart of downtown Richmond, the renovated Marriott is adjacent to the Greater Richmond Convention Center and located steps away from the Richmond Coliseum. It is Richmond's largest convention hotel.

QUICK STATS

Miles from GRCC
ADJACENT

Miles from RIC airport

8

Minutes to closest shops, restaurants

<1

Total meeting space (sq. ft.)

27,000

Total rooms/suites

405/5

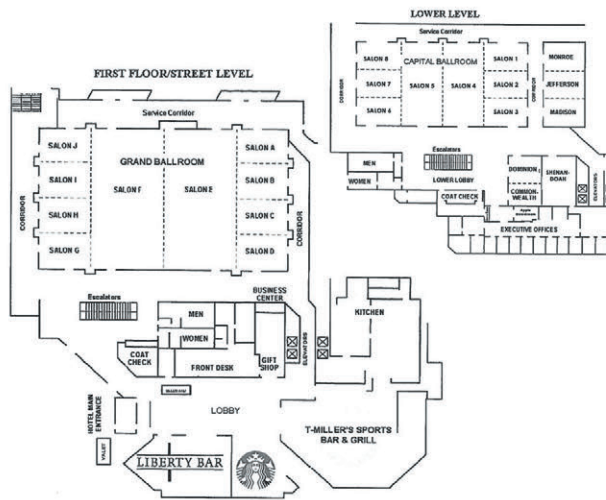

AMENITIES

- Walking distance to a wide array of historic and cultural attractions
- Expansive health club with indoor pool
- Professional convention-services department
- Starbucks coffee shop and boarding-pass terminal
- Complete teleconference capabilities
- Full-service executive business center
- Conierge

| MEETING SPACE | SQ. FT. | RECEPTION | BANQUET | THEATER | CLASSROOM | CONFERENCE | U-SHAPE |
|--|---------|-----------|---------|---------|-----------|------------|---------|
| Grand Ballroom | 15,092 | 2,000 | 1,120 | 1,700 | 840 | – | – |
| Salons A-D, G-J | 762 | 65 | 40 | 70 | 32 | 20 | 14 |
| Salons AB, BC, CD, GH, HI or IJ | 1,535 | 140 | 80 | 140 | 70 | 28 | 30 |
| ABC, BCD, GHI, HIJ | 2,308 | 220 | 110 | 210 | 100 | – | 36 |
| ABCD or GHIJ | 3,071 | 300 | 140 | 320 | 130 | – | 50 |
| Salons E & F (each) | 4,475 | 600 | 280 | 390 | 200 | – | – |
| ABCDE or EFGHIJ | 7,546 | 900 | 470 | 760 | 400 | – | – |
| Capital Ballroom | 7,919 | 1,000 | 580 | 700 | 360 | – | – |
| Salons 1-3 & 6-8 (each) | 683 | 62 | 40 | 55 | 26 | 16 | 14 |
| Salons 4 & 5 (each) | 1,906 | 200 | 100 | 190 | 80 | 36 | 40 |
| Salons 1-2, 2-3, 6-7 or 7-8 (combined) | 1,365 | 120 | 70 | 110 | 55 | 30 | 24 |
| Salons 1-2-3 or 6-7-8 (combined) | 2,047 | 220 | 100 | 180 | 85 | – | 44 |
| Salons 1-2-3-4 or 5-6-7-8 (combined) | 3,954 | 450 | 230 | 300 | 160 | – | – |
| Salons 1-2-3-4-5 or 4-5-6-7-8 | 5,860 | 700 | 340 | 600 | 250 | – | – |
| Madison, Jefferson & Monroe (each) | 618 | 60 | 30 | 50 | 24 | 14 | 16 |
| Dominion | 495 | 45 | 30 | 45 | 20 | 14 | 14 |
| Commonwealth | 440 | 45 | 30 | 45 | 20 | 14 | 14 |
| Dominion & Commonwealth | 939 | 60 | 50 | 90 | 34 | 24 | 20 |
| Capital | 988 | 60 | 50 | 70 | 40 | 24 | 22 |
| Apple Boardroom | 624 | – | – | – | – | 12 | – |

RICHMOND MARRIOTT SHORT PUMP

4240 Dominion Blvd., Glen Allen, VA 23060
804-965-9500

marriott.com/ricmw

Richmond Marriott Short Pump hotel is conveniently located in the heart of Innsbrook, close to office parks, world-class shopping and restaurants. Use the jogging trail that winds through Innsbrook's beautiful office park and lakes, relax in the Great Room and Bourbon Bar, indulge in New American cuisine or enjoy a cocktail in a warm, relaxed setting.



AMENITIES

- High-speed wired and wireless Internet
- Complimentary onsite parking
- Coffee/tea in room
- Local restaurant dinner delivery
- Toll-free phone calls
- Room service, 6:30 a.m. to 11:00 p.m.
- In-room safes
- In-room refrigerators
- Onsite fitness center
- Indoor swimming pool
- Close to 1-95, 1-295, VA-288
- Five miles to Amtrak Train Station
- Car rentals nearby

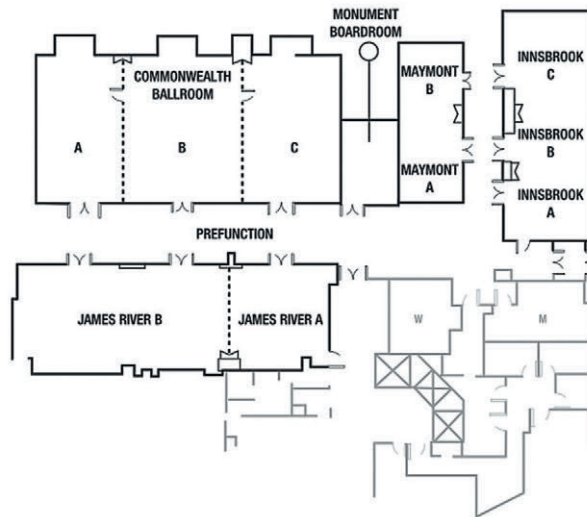

QUICK STATS

Miles from GRCC

13

Miles from RIC airport

18

Minutes to closest shops, restaurants

<5

Total meeting space (sq. ft.)

7,200

Total rooms/suites

234/9

| MEETING SPACE | SQ. FT. | DIMENSIONS | HEIGHT | THEATER | RECEPTION | CLASSROOM | U-SHAPE | CONFERENCE | ROUNDS |
|-----------------------|---------|------------|--------|---------|-----------|-----------|---------|------------|--------|
| Commonwealth Ballroom | 3,116 | 38' x 82' | 18' | 375 | 330 | 240 | - | - | 220 |
| Salon A | 874 | 38' x 23' | 18' | 100 | 90 | 63 | 30 | 36 | 60 |
| Salon B | 1,216 | 38' x 32' | 18' | 150 | 145 | 84 | 33 | 42 | 90 |
| Salon C | 1,026 | 38' x 27' | 18' | 120 | 105 | 84 | 33 | 42 | 70 |
| Ballroom Foyer | 1,066 | 13' x 82' | 12' | - | 145 | - | - | - | - |
| Monument Boardroom | 322 | 14' x 23' | 12' | - | - | - | - | 12 | 12 |
| Maymont | 792 | 18' x 44' | 11' | 80 | 75 | 42 | 36 | 42 | 50 |
| Maymont A | 450 | 18' x 25' | 11' | 44 | 45 | 24 | 21 | 24 | 30 |
| Maymont B | 342 | 18' x 19' | 11' | 32 | 30 | 18 | 15 | 18 | 20 |
| Innsbrook | 1,116 | 18' x 62' | 12' | 132 | 145 | 63 | 54 | 60 | 90 |
| Innsbrook A | 360 | 18' x 20' | 12' | 36 | 45 | 18 | 15 | 18 | 30 |
| Innsbrook B | 270 | 18' x 15' | 12' | 30 | 30 | 18 | 9 | 12 | 20 |
| Innsbrook C | 468 | 18' x 26' | 12' | 52 | 60 | 24 | 21 | 24 | 40 |
| James River | 1,848 | 84' x 22' | 10' | 200 | 195 | 126 | 42 | 48 | 150 |
| James River A | 552 | 24' x 23' | 10' | 61 | 58 | 36 | 10 | 14 | 40 |
| James River B | 1,288 | 56' x 23' | 10' | 150 | 142 | 93 | 30 | 36 | 110 |



WESTIN RICHMOND

6631 W. Broad St., Richmond, VA 23230
 804-282-8444
 westinrichmond.com

The Westin Richmond is ideally situated in the vibrant Near West End of Richmond, with short distances to the West End and downtown.

QUICK STATS

Miles from GRCC
7
 Miles from RIC airport
15
 Minutes to closest shops, restaurants
<1
 Total meeting space (sq. ft.)
17,000
 Total rooms/suites
250/11

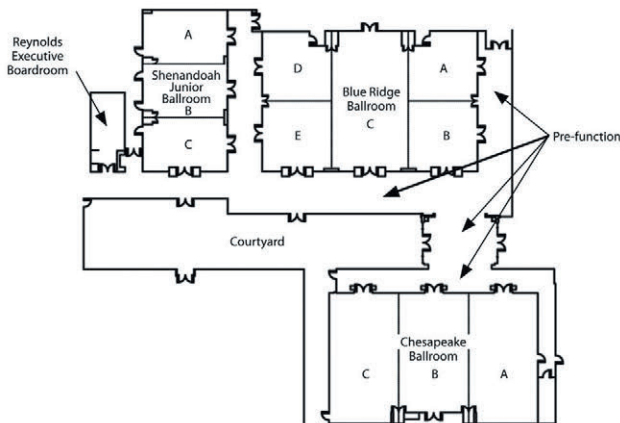

AMENITIES

- Heavenly® Bed and the Heavenly® Bath/Shower in all rooms
- High-speed wireless and wired internet access
- Flat-panel televisions, telephone with speaker phone, voicemail
- Crossings, a casually sophisticated restaurant; a warm, inviting lobby bar and lounge; and 24-hour in-room dining
- Space includes elegant ballrooms, meeting rooms, an executive boardroom and a conference hospitality suite
- A 24-hour fitness facility with cardiovascular equipment, weight machines, a heated indoor pool and hot tub

| MEETING SPACE | SQ. FT. | DIMENSIONS | CEILING | BANQUET | THEATER | CONFERENCE | RECEPTION | CLASSROOM | U-SHAPE |
|---------------------------------|---------|------------------------------------|---------|---------|---------|------------|-----------|-----------|---------|
| Blue Ridge Ballroom - Total | 4,387 | 56' x 84' | 15' 10" | 300 | 550 | 78 | 500 | 280 | 70 |
| Salon A | 683 | 27' x 27' | 15' 10" | 50 | 80 | 15 | 65 | 35 | 20 |
| Salon B | 712 | 27' x 27' | 15' 10" | 50 | 80 | 15 | 65 | 35 | 20 |
| Salon AB | 1,395 | 54' x 27' | 15' 10" | 100 | 165 | 40 | 120 | 80 | 45 |
| Salon C | 1,595 | 56' x 30' | 15' 10" | 120 | 200 | 40 | 180 | 110 | 50 |
| Salon ABC | 2,990 | 54' x 57' | 15' 10" | 250 | 320 | 50 | 300 | 200 | 60 |
| Salon D | 684 | 27' x 27' | 15' 10" | 50 | 80 | 15 | 65 | 35 | 20 |
| Salon E | 713 | 27' x 27' | 15' 10" | 50 | 80 | 15 | 65 | 35 | 20 |
| Salon DE | 1,397 | 54' x 27' | 15' 10" | 100 | 150 | 40 | 120 | 80 | 45 |
| Salon CDE | 2,992 | 54' x 57' | 15' 10" | 250 | 420 | 50 | 300 | 200 | 60 |
| Shenandoah Jr. Ballroom - Total | 1,989 | 62' x 33' | 17' | 150 | 230 | 55 | 160 | 130 | 60 |
| Salon A | 664 | 21' x 32' | 17' | 50 | 70 | 20 | 50 | 30 | 18 |
| Salon B | 668 | 20' x 33' | 17' | 50 | 70 | 20 | 50 | 30 | 18 |
| Salon C | 656 | 21' x 32' | 17' | 50 | 70 | 20 | 50 | 30 | 18 |
| Salon AB | 1,332 | 41' x 33' | 17' | 100 | 120 | 30 | 100 | 60 | 35 |
| Salon BC | 1,324 | 41' x 33' | 17' | 100 | 120 | 30 | 100 | 60 | 35 |
| Reynolds Executive Boardroom | 390 | 30' x 13' | 10' | - | - | 12 | - | - | - |
| Pre-function | 3,420 | 104' x 16' x 49' & 10' x 44' x 10' | 17' | - | - | - | 250 | - | - |
| Chesapeake Ballroom - Total | 4,769 | 56' x 90' | 13' 8" | 350 | 625 | 100 | 550 | 325 | 100 |
| Salon A | 1,625 | 56' x 30' | 13' 8" | 130 | 200 | 50 | 200 | 125 | 45 |
| Salon B | 1,519 | 51' x 30' | 13' 8" | 100 | 150 | 35 | 150 | 90 | 35 |
| Salon C | 1,625 | 56' x 30' | 13' 8" | 130 | 200 | 50 | 200 | 125 | 45 |
| Salon AB | 3,143 | 56' x 60' | 13' 8" | 270 | 350 | 85 | 350 | 215 | 70 |
| Salon BC | 3,143 | 56' x 60' | 13' 8" | 270 | 350 | 85 | 350 | 215 | 70 |
| Chesapeake Pre-function | 1,956 | 93' x 9' & 40' x 27' | 13' 8" | - | - | - | 200 | - | - |
| Courtyard | 5,850 | 130' x 45' | - | - | - | - | 300 | - | - |
| Conference Suite (2nd floor) | 468 | 26' x 18' | 8' 8" | - | - | 8 | 25 | - | - |

VIRGINIA CROSSINGS HOTEL AND CONFERENCE CENTER

1000 Virginia Center Parkway, Glen Allen, VA 23059
804-727-1400

vacrossings.com



The Four-Diamond Virginia Crossings Hotel & Conference Center offers 183 deluxe rooms, two restaurants, fitness center, outdoor pool and privileges at the adjacent Crossings Golf Course. Set on a 20-acre estate, it is a favorite destination for gatherings.

AMENITIES

- Deluxe guest rooms, including suites equipped with 47-inch flat panel television and complimentary high-speed internet access
- 24/7 fitness center
- Outdoor pool, hot tub, volleyball and basketball courts, and horseshoe pit
- Access to The Crossings Golf Club, an 18-hole Joe Lee designed golf course
- 15 minutes from downtown Richmond and 15 minutes to Kings Dominion

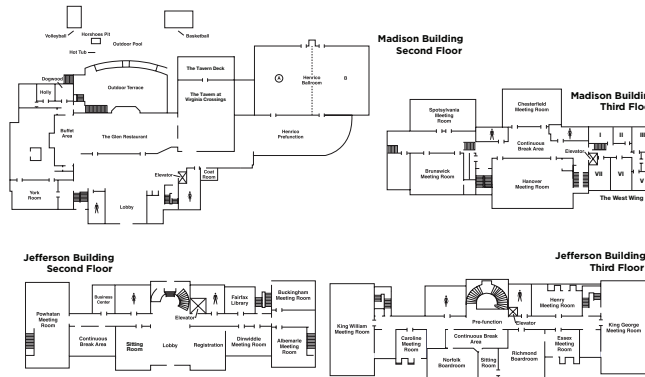

QUICK STATS

Miles from GRCC

11

Miles from RIC airport

20

Minutes to closest shops, restaurants

1

Total meeting space (sq. ft.)

28,000

Total rooms/suites

183/2

| | MEETING SPACE | SIZE | SQ. FT. | CEILING | CONF. | CRESCENT | CLASS | U-SHAPE | THEATER | BANQUET | RECEPTION |
|----------------------------------|---------------------|---------|---------|---------|-------|----------|-------|---------|---------|---------|-----------|
| MADISON BUILDING, SECOND FLOOR | Henrico Ballroom | 84 x 56 | 4,700 | 17' | 46 | 180 | 190 | 50 | 400 | 300 | 400 |
| | Henrico Ballroom A | 42 x 56 | 2,350 | 17' | 30 | 80 | 100 | 30 | 200 | 140 | 200 |
| | Henrico Ballroom B | 42 x 56 | 2,350 | 17' | 30 | 80 | 100 | 30 | 200 | 140 | 200 |
| | Henrico Prefunction | 80 x 30 | 2,400 | - | - | - | - | - | - | - | 280 |
| | York | 24 x 22 | 528 | 11' | 18 | 32 | 24 | 24 | 60 | 50 | 60 |
| | Holly | 13 x 13 | 169 | 8' | - | - | - | - | - | 10 | - |
| | Dogwood | 13 x 13 | 169 | 8' | - | - | - | - | - | 10 | - |
| | Outdoor Terrace | 70 x 25 | 1,750 | - | - | - | - | - | - | 60 | 90 |
| MADISON BUILDING, THIRD FLOOR | Hanover | 56 x 38 | 2,128 | 12' | 40 | 70 | 80 | 36 | 140 | 120 | 170 |
| | Brunswick | 36 x 30 | 1,080 | 9' | 22 | 40 | 48 | 24 | 100 | 60 | 80 |
| | Spotsylvania | 23 x 45 | 1,035 | 9' | 22 | 35 | 40 | 24 | 84 | 60 | 80 |
| | Chesterfield | 28 x 42 | 1,176 | 10' | 22 | 35 | 40 | 24 | 80 | 60 | 80 |
| JEFFERSON BUILDING, SECOND FLOOR | Powhatan | 27 x 60 | 1,620 | 9.5' | 30 | 48 | 54 | 30 | 140 | 80 | 120 |
| | Fairfax Library | 18 x 18 | 324 | 10' | 8 | - | - | - | - | - | - |
| | Buckingham | 27 x 20 | 540 | 9.5' | 20 | 24 | 24 | 16 | 60 | 32 | 40 |
| | Albemarle | 22 x 28 | 616 | 9.5' | 24 | 24 | 20 | 16 | 60 | 40 | 40 |
| | Dinwiddie | 28 x 21 | 588 | 9.5' | 16 | 24 | 24 | 16 | 40 | 30 | 30 |
| JEFFERSON BUILDING, THIRD FLOOR | King William | 27 x 62 | 1,674 | 9.5' | 34 | 56 | 64 | 36 | 150 | 100 | 130 |
| | King George | 27 x 62 | 1,674 | 9.5' | 34 | 56 | 64 | 36 | 150 | 100 | 130 |
| | Henry | 30 x 16 | 480 | 9.5' | 12 | 16 | 12 | 20 | 40 | 20 | - |
| | Caroline | 19 x 18 | 342 | 9.5' | 12 | 16 | 10 | 9 | 30 | 16 | - |
| | Essex | 19 x 18 | 342 | 9.5' | 12 | 16 | 16 | 10 | 30 | 16 | - |
| | Richmond Boardroom | 21 x 32 | 672 | 11' | 18 | - | - | - | - | - | - |
| | Norfolk Boardroom | 23 x 18 | 414 | 11' | 10 | - | - | - | - | - | - |

ACCOMMODATIONS

NAME ADDRESS PHONE

ROOMS/SUITES

PRICE RANGE

DETAILS

DOWNTOWN

| | | | |
|---|--------|----------|--------------|
| The Berkeley Hotel , 1200 E. Cary St., 804-780-1300 | 55/8 | Moderate | 🍽️ 🐾 🚫 🦿 |
| Commonwealth Park Suites Hotel , 901 Bank St., 804-343-7300 | 59/59 | Moderate | 🍽️ 🐾 🚪 🚫 🦿 |
| Courtyard Richmond Downtown , 1320 E. Cary St., 804-754-0007 | 135/0 | Moderate | 🍽️ 🚪 🚫 🦿 |
| Delta Hotels by Marriott Richmond Downtown , 555 E. Canal St., 804-788-0900 | 283/15 | Moderate | 🍽️ 🐾 🏊 🚪 🚫 🦿 |
| Graduate Richmond , 301 W. Franklin St., 804-644-9871 | 178/27 | Moderate | 🍽️ 🐾 🏊 🚪 🚫 🦿 |
| Hampton Inn & Suites Richmond-Downtown , 700 E. Main St. Suite A, 804-643-5400 | 96/48 | Mod/Lux | 🍽️ 🏊 🚪 🚫 🦿 |
| Hilton Richmond-Downtown , 501 E. Broad St., 804-344-4300 | 250/15 | Mod/Lux | 🍽️ 🏊 🚪 🚫 🦿 |
| HI Richmond Hostel , 7 N. Second St., 804-729-5410 | 6/7* | Budget | 🚫 🦿 |
| Holiday Inn Express Downtown Richmond , 201 E. Cary St., 804-788-1600 | 80/20 | Moderate | 🚪 🚫 🦿 |
| Homewood Suites by Hilton Richmond-Downtown , 700 E. Main St. Suite B, 804-643-2900 | 0/100 | Mod/Lux | 🍽️ 🏊 🚪 🚫 🦿 |
| The Jefferson Hotel , 101 W. Franklin St., 804-788-8000 | 166/15 | Luxury | 🍽️ 🐾 🏊 🚫 🦿 |
| Linden Row Inn , 100 E. Franklin St., 804-783-7000 | 63/7 | Moderate | 🍽️ 🚫 🦿 |
| Omni Richmond Hotel , 100 S. 12th St., 804-344-7000 | 361/6 | Mod/Lux | 🍽️ 🐾 🏊 🚪 🚫 🦿 |
| Quirk Hotel , 201 W. Broad St., 804-340-6040 | 69/5 | Luxury | 🍽️ 🐾 🚪 🚫 🦿 |
| Residence Inn by Marriott , 14 S. 14th St., 804-225-5550 | 0/75 | Moderate | 🍽️ 🐾 🚪 🚫 🦿 |
| Richmond Marriott Hotel , 500 E. Broad St., 804-643-3400 | 405/5 | Moderate | 🍽️ 🏊 🚪 🚫 🦿 |

EASTERN HENRICO | AIRPORT | MECHANICSVILLE

| | | | |
|---|--------|----------|--------------|
| All Day Inn , 5500 Williamsburg Road, 804-222-2041 | 90/0 | Budget | 🍽️ 🏊 🦿 |
| America's Best Value Inn Richmond Airport , 5700 Williamsburg Road, 804-222-2780 | 100/0 | Budget | 🐾 🏊 🚪 🦿 |
| Best Western Richmond Airport , 5300 Airport Square Lane, 804-222-8200 | 119/0 | Budget | 🏊 🚪 🦿 |
| Candlewood Suites Richmond Airport , 5400 Audubon Drive, 804-652-1888 | 0/103 | Moderate | 🐾 🚪 🚫 🦿 |
| Courtyard by Marriott Richmond Airport , 5400 Williamsburg Road, 804-652-0500 | 142/15 | Moderate | 🍽️ 🏊 🚪 🚫 🦿 |
| Econo Lodge , 5203 Williamsburg Road, 804-222-6450 | 86/2 | Budget | 🏊 🚫 🦿 |
| Four Points by Sheraton Richmond Airport , 4700 S. Laburnum Ave., 804-226-4300 | 152/3 | Moderate | 🍽️ 🐾 🏊 🚪 🚫 🦿 |
| Hampton Inn Mechanicsville , 7433 Bell Creek Road, 804-559-0559 | 80/5 | Moderate | 🐾 🏊 🚪 🚫 🦿 |
| Hampton Inn Richmond Airport , 421 International Center Drive, 804-226-1888 | 104/0 | Moderate | 🏊 🚪 🦿 |
| Hilton Garden Inn Richmond Airport , 441 International Center Drive, 804-222-3338 | 130/16 | Moderate | 🍽️ 🏊 🚪 🚫 🦿 |
| Holiday Inn Express Mechanicsville , 7441 Bell Creek Road, 804-559-0022 | 101/4 | Moderate | 🏊 🚪 🚫 🦿 |
| Holiday Inn Express Richmond Airport , 491 International Center Drive, 804-222-1499 | 101/6 | Moderate | 🐾 🏊 🚪 🚫 🦿 |
| Holiday Inn Richmond Airport , 445 International Center Drive, 804-236-1111 | 143/0 | Moderate | 🍽️ 🏊 🚪 🚫 🦿 |
| Homewood Suites by Hilton Airport , 5996 Audubon Drive, 804-737-1600 | 0/125 | Moderate | 🏊 🚪 🚫 🦿 |
| Hyatt Place Richmond Airport , 4401 S. Laburnum Ave., 804-549-4865 | 151/0 | Moderate | 🍽️ 🐾 🏊 🚪 🚫 🦿 |
| Knights Inn , 5408 Williamsburg Road, 804-222-1020 | 50/0 | Budget | 🦿 |
| Motel 6 Richmond Airport , 5704 Williamsburg Road, 804-222-7600 | 120/0 | Budget | 🐾 🏊 🦿 |
| Quality Inn Richmond Airport , 5240 Airport Square Lane, 804-226-1800 | 61/0 | Moderate | 🚪 🦿 |

ICON KEY: 🍽️ = Restaurant on site 🐾 = Pets allowed 🏊 = Pool 🚪 = On-site gym 🚫 = 100% smoke-free 🦿 = Handicapped-accessible rooms

| NAME ADDRESS PHONE | ROOMS/SUITES | PRICE RANGE | DETAILS |
|--|--------------|-------------|---------|
| Richmond Airport Hotel , 5501 Eubank Road, 804-226-6400 | 160/20 | Moderate | |
| Super 8 Richmond Airport , 5110 Williamsburg Road, 804-222-8008 | 50/1 | Budget | |
| NORTH SIDE ASHLAND | | | |
| America's Best Value Inn , 8901 Brook Road, 804-553-8395 | 38/7 | Budget | |
| Best Western Glen Allen , 8507 Brook Road, 804-266-3500 | 62/0 | Moderate | |
| Candlewood Suites Glen Allen , 10609 Telegraph Road, 804-262-2240 | 0/84 | Moderate | |
| Centerstone Inn Doswell , 16102 Theme Park Way, 804-876-3321 | 125/1 | Moderate | |
| Clarion Hotel Richmond Central , 3207 N. Boulevard, 804-359-9441 | 176/3 | Moderate | |
| Comfort Suites , 10601 Telegraph Road, 804-262-2000 | 8/92 | Moderate | |
| Country Inn & Suites , 16250 International St., 804-612-8450 | 62/25 | Moderate | |
| Country Inn & Suites by Carlson , 11600 Lakeridge Pkwy, 804-798-7378 | 63/18 | Moderate | |
| Courtyard by Marriott , 10077 Brook Road, 804-266-6900 | 150/4 | Moderate | |
| Days Inn , 8613 Brook Road, 804-261-0188 | 36/3 | Moderate | |
| Days Inn Ashland , 806 England St., 804-798-4262 | 90/0 | Moderate | |
| Days Inn Doswell , 16220 International St., 804-612-8680 | 47/0 | Bud/Mod | |
| Econo Lodge North , 8350 Brook Road, 804-262-7070 | 31/0 | Budget | |
| Hampton Inn & Suites Virginia Center , 1101 Technology Park Drive, 804-261-2266 | 99/30 | Moderate | |
| Hampton Inn Ashland , 705 England St., 804-752-8444 | 72/2 | Moderate | |
| Holiday Inn Express & Suites Ashland , 107 S. Carter Road, 804-752-7889 | 53/62 | Moderate | |
| Knights Inn Glen Allen , 9002 Brook Road, 804-266-2444 | 60/0 | Budget | |
| La Quinta Inn & Suites , 16280 International St., 804-876-6900 | 0/72 | Moderate | |
| Motel 6 Doswell , 16116 Theme Park Way, 804-876-4546 | 105/0 | Budget | |
| Quality Inn , 801 E. Parham Road, 804-266-8753 | 80/0 | Moderate | |
| Quality Inn & Suites , 107 N. Carter Road, 804-521-2377 | 48/12 | Moderate | |
| Red Inn , 103 N. Carter Road, 804-798-9221 | 83/0 | Budget | |
| Sleep Inn & Suites Ashland , 80 Cottage Green Drive, 804-752-2355 | 31/38 | Bud/Mod | |
| Sleep Inn North , 950 E. Parham Road, 804-515-7800 | 72/0 | Moderate | |
| Springhill Suites by Marriott at Virginia Center Commons , 9701 Brook Road, 804-266-9403 | 0/136 | Moderate | |
| Super 8 Motel Ashland , 806-B England St., 804-752-7000 | 73/0 | Bud/Mod | |
| Super 8 Motel Chamberlayne , 5615 Chamberlayne Road, 804-262-8880 | 55/2 | Budget | |
| Virginia Crossings Hotel & Conference Center , 1000 Virginia Center Parkway, 804-727-1400 | 183/2 | Moderate | |
| SOUTH SIDE CHESTER | | | |
| America's Best Value Inn , 2126 Willis Road, 804-271-1281 | 100/0 | Budget | |
| Best Western Plus Governor's Inn , 9826 Midlothian Turnpike, 804-323-0007 | 80/3 | Moderate | |
| Candlewood Suites , 15820 Woods Edge Road, 804-526-0111 | 0/81 | Moderate | |
| Candlewood Suites Richmond South , 4301 Commerce Road, 804-271-0016 | 0/103 | Moderate | |

ICON KEY: = Restaurant on site = Pets allowed = Pool = On-site gym = 100% smoke-free = Handicapped-accessible rooms

ACCOMMODATIONS

| NAME ADDRESS PHONE | ROOMS/SUITES | PRICE RANGE | DETAILS |
|---|--------------|-------------|-------------|
| Comfort Inn Chester , 2100 W. Hundred Road, 804-751-0000 | 122/10 | Moderate | 🍴 🏊 🏠 🚫 🦿 |
| Comfort Inn South Chesterfield , 15720 Woods Edge Road, Colonial Heights, 480-725-1635 | 45/0 | Moderate | 🏠 🚫 🦿 |
| Country Inn & Suites by Carlson , 2401 Willis Road, 804-275-5900 | 35/15 | Budget | 🏠 🚫 🦿 |
| Country Inn & Suites by Carlson , 2406 W. Hundred Road, 804-751-0080 | 65/15 | Moderate | 🏊 🏠 🚫 🦿 |
| Courtyard by Marriott Richmond/Chester , 2001 W. Hundred Road, 804-414-1010 | 135/19 | Moderate | 🍴 🏊 🏠 🚫 🦿 |
| Days Inn Chester , 2410 W. Hundred Road, 804-748-5871 | 118/0 | Moderate | 🏠 🦿 |
| Days Inn Richmond , 6910 Midlothian Turnpike, 804-745-7100 | 114/1 | Budget | 🏠 🏊 🦿 |
| Doubletree by Hilton Richmond Midlothian , 1021 Koger Center Blvd., 804-379-3800 | 228/9 | Mod/Lux | 🍴 🏊 🏠 🚫 🦿 |
| Econo Lodge , 2310 Indian Hill Road, 804-520-1010 | 90/4 | Budget | 🏠 🏊 🦿 |
| Extended Stay America Arboretum , 241 Arboretum Place, 804-272-1800 | 0/125 | Moderate | 🏠 🚫 🦿 |
| Fairfield Inn & Suites Richmond Midlothian , 150 N. Pinetta Drive, 804-447-8326 | 68/23 | Moderate | 🏊 🏠 🚫 🦿 |
| Fairfield Inn by Marriott Chester , 12400 Redwater Creek Road, 804-778-7500 | 115/8 | Moderate | 🏠 🏊 🏠 🚫 🦿 |
| Four Points by Sheraton Richmond-Midlothian , 9901 Midlothian Turnpike, 804-323-1144 | 183/11 | Moderate | 🍴 🏠 🏊 🏠 🚫 🦿 |
| Hampton Inn Chester , 12610 Chestnut Hill Road, 804-768-8888 | 65/2 | Moderate | 🏠 🚫 🦿 |
| Hampton Inn Hull Street , 3620 Price Club Blvd., 804-675-0000 | 68/2 | Moderate | 🏊 🏠 🚫 🦿 |
| Hampton Inn Midlothian Turnpike , 800 Research Road, 804-897-2800 | 80/0 | Moderate | 🏊 🏠 🚫 🦿 |
| Hampton Inn Richmond South Bells Road , 4300 Commerce Road, 804-743-3550 | 104/0 | Moderate | 🏊 🏠 🚫 🦿 |
| Holiday Inn Express Brandermill , 5030 W. Village Green Drive, 804-744-7303 | 62/34 | Moderate | 🏠 🚫 🦿 |
| Holiday Inn Express Chester , 1911 W. Hundred Road, 804-751-0123 | 92/3 | Moderate | 🏠 🚫 🦿 |
| Holiday Inn Express Midlothian , 8710 Midlothian Turnpike, 804-320-8900 | 144/4 | Moderate | 🏠 🏊 🏠 🚫 🦿 |
| Holiday Inn Richmond South Bells Road , 4303 Commerce Road, 804-592-2900 | 165/2 | Moderate | 🍴 🏊 🏠 🚫 🦿 |
| Homewood Suites by Hilton Richmond South , 12810 Old Stage Road, 804-751-0010 | 83/35 | Moderate | 🏊 🏠 🚫 🦿 |
| Hyatt Place Richmond Arboretum , 201 Arboretum Place, 804-560-1566 | 127/0 | Moderate | 🍴 🏠 🏊 🏠 🚫 🦿 |
| Hyatt Place Richmond Chester , 13148 Kingston Ave., 804-530-4600 | 120/0 | Moderate | 🍴 🏠 🏊 🏠 🚫 🦿 |
| Interstate Inn , 2201 Indian Hill Road, 804-526-4772 | 44/0 | Budget | 🏠 🦿 |
| InTown Suites Richmond South , 2601 Perdue Springs Drive, 804-706-1999 | 0/120 | Budget | 🚫 🦿 |
| InTown Suites Richmond West , 11551 Green Spring Road, 804-897-7180 | 0/137 | Budget | 🚫 🦿 |
| Knights Inn , 2125 Willis Road, 804-271-6031 | 48/0 | Budget | 🏠 |
| La Quinta Inn & Suites , 1301 Huguenot Road, 804-794-4999 | 112/4 | Moderate | 🏠 🏠 🚫 🦿 |
| La Quinta Inn Richmond , 9040 Pams Ave., 804-743-0770 | 39/16 | Moderate | 🏠 🏠 🚫 🦿 |
| Motel 6 , 100 Greshamwood Place, 804-745-0600 | 70/0 | Budget | 🏠 🦿 |
| Quality Inn Chester , 12711 Old Stage Road, 804-796-5200 | 61/10 | Moderate | 🏊 🏠 🚫 🦿 |
| Regency Inn & Suites , 10020 Hull Street Road, 804-745-1900 | 25/1 | Budget | 🦿 |
| Residence Inn by Marriott Richmond Chester , 800 Bermuda Hundred Road, 804-530-5501 | 0/136 | Moderate | 🏠 🏊 🏠 🚫 🦿 |
| Royal Inn , 9801 Hull Street Road, 804-276-4500 | 15/0 | Budget | 🦿 |
| Sleep Inn , 2321 Willis Road, 804-275-8800 | 51/0 | Budget | 🏠 |
| Sleep Inn & Suites Harbour Pointe , 6451 Bayside Lane, 804-639-3500 | 38/16 | Moderate | 🏠 🚫 🦿 |

ICON KEY: 🍴 = Restaurant on site 🏠 = Pets allowed 🏊 = Pool 🏠 = On-site gym 🚫 = 100% smoke-free 🦿 = Handicapped-accessible rooms

UNIQUE VENUES

Whether you need creative brainstorming sessions, client dinners or collaborative team-building events, finding the right venue is essential to fostering the desired outcome. The Richmond region offers a wide variety of options, from enchanting historic homes to breathtaking sites along the James River, from airy, hip galleries to lush vineyards.



THE AMERICAN CIVIL WAR MUSEUM AT HISTORIC TREDEGAR

500 Tredegar St., Richmond, VA 23219
804-649-1861, ext. 148
acwm.org

This 8.3-acre riverfront venue is created from the remnants of Richmond's historic Tredegar Iron Works.

| MEETING SPACE | REC | TH | CR | BAN |
|---------------------|-------|-----|----|-----|
| BlueStone Courtyard | 1,000 | 500 | – | 500 |
| Brick Courtyard | – | – | – | 250 |
| Bluestone Patio | 250 | 150 | – | 150 |
| Brick Patio | 350 | 225 | – | 225 |



ART WORKS

320 Hull Street Road, Richmond, VA 23224
804-291-1400
artworksrichmond.com

An artful place to hold small or large business meetings, as well as seminars, lectures and banquets, Art Works is located a half-mile from downtown Richmond. It includes facilities for team-building group workshops, as well as projectors, tables and chairs, and a kitchen.

| MEETING SPACE | REC | TH | CR | BAN |
|-----------------------|-----|-----|-----|-----|
| Jane Sandelin Gallery | 250 | 300 | 200 | 200 |
| All Media Gallery | 75 | 100 | 75 | 75 |
| Centre Gallery | 30 | 50 | 30 | 30 |



ASHTON CREEK VINEYARD & EVENTS

14501 Jefferson Davis Highway, Chester, VA 23831
804-896-1586
ashtoncreekvineyard.com

Ashton Creek Vineyard is a working farm, winery and event venue. Post and beam construction and stone accents highlight the interior of The Barn, as french doors lead to the veranda where views of the vineyard and surrounding forest can be enjoyed. The rustic charm of the facility creates a warm and inviting atmosphere for any occasion big or small.

| MEETING SPACE | REC | TH | CR | BAN |
|---------------|-----|----|----|-----|
| Barn | 300 | – | – | – |
| Banquet Room | – | – | – | 55 |



ATLAS 42

4032 Cox Road, Suite A, Glen Allen, VA 23060
804-965-0420
atlas42.com

Atlas 42 is a full-service event venue for corporate events, team building, nonprofit functions, music events, private celebrations and more. This dynamic gathering space is 11,740 square feet with two adjoining open spaces that can be configured in a variety of ways. Outdoor patios open onto a landscaped courtyard. The focus of Atlas 42 is on active fun, offering pingpong, shuffleboard, cornhole, bocce ball and more.

| MEETING SPACE | REC | TH | CR | BAN |
|---------------------|-----|-----|-----|-----|
| Northern Hemisphere | 220 | 150 | 150 | 200 |
| Southern Hemisphere | 250 | – | 150 | 220 |
| Courtyard Patio | 250 | – | – | – |
| Gathering Room | 50 | 50 | 30 | – |
| Gathering Room | 32 | – | – | – |
| Private Patio | – | – | – | – |

BLACK HISTORY MUSEUM & CULTURAL CENTER OF VIRGINIA

122 W. Leigh St., Richmond, VA 23220
804-780-9093

blackhistorymuseum.org

Immersed in past and present, the Black History Museum offers a contemporary interior in the former Leigh Street Armory built in 1895. Rehearsal dinners, team gatherings, family celebrations, movie premieres, and corporate training sessions are hosted; tables, chairs, projector, and kitchen onsite. Exhibition tours available.

| MEETING SPACE | REC | TH | CR | BAN |
|-------------------------|-----|----|----|-----|
| Dominion Community Room | 100 | 80 | 75 | 70 |
| Atrium | 30 | — | — | 15 |



BOLLING HAXALL HOUSE

211 E. Franklin St., Richmond, VA 23219
804-643-2847

twcrichmond.org

The Bolling Haxall House, an Italianate villa in downtown Richmond, offers flexible meeting spaces equipped with modern business necessities. Request a list of preferred caterers; kitchen facilities available.

| MEETING SPACE | REC | TH | CR | BAN |
|---------------|-----|-----|----|-----|
| Boardroom | — | — | 48 | — |
| Ballroom | 250 | 300 | — | 250 |



PHOTO BY ISAAC HARRELL

THE BRANCH MUSEUM OF ARCHITECTURE AND DESIGN

2501 Monument Ave., Richmond, VA 23220
804-644-3041

architectureva.org

Host your next special event, meeting, retreat or party at an architectural treasure located on Richmond's historic Monument Avenue. The interior spaces and elegant garden can be arranged to accommodate a variety of events, from sophisticated cocktail parties to daylong corporate retreats.

| MEETING SPACE | REC | TH | CR | BAN |
|-------------------------|-------------------|----|----|-----|
| Adam Board Room | 30 | — | 30 | 30 |
| Georgian Parlor | 15 | — | — | — |
| Social Gallery | 62 | 35 | 30 | 50 |
| Long Gallery/Great Hall | 100 | 80 | 60 | 100 |
| Garden | Call for details. | | | |



CELEBRATIONS AT THE RESERVOIR

4801 Woolridge Road, Moseley, VA 23120
804-739-9015

celebrationsva.com

Located on 125 acres near the wooded, upscale subdivisions of Woodlake and Brandermill, Celebrations includes three distinct venues, each with its own staffing and parking, which together can accommodate events of many sizes.

| MEETING SPACE | REC | TH | CR | BAN |
|-------------------|-----|----|----|-----|
| Manor House | 300 | — | — | 220 |
| The Azalea Garden | 200 | — | — | 200 |
| Pool Pavilion | 250 | — | — | 175 |



CHILDREN'S MUSEUM OF RICHMOND

2626 W. Broad St., Richmond, VA 23220
804-474-7000

childrensmuseumofrichmond.org

The Children's Museum of Richmond offers a unique, creative setting for your meetings, galas, holiday banquets, and special occasions. Up to 1,000 guests can enjoy the entire museum, and there are numerous options for smaller groups. All or part of the museum can be rented seven days a week.

| MEETING SPACE | REC | TH | CR | BAN |
|--------------------|-------|-----|-----|-----|
| Entire Museum | 1,000 | — | — | — |
| Lobby | 250 | 100 | 100 | 100 |
| Pavilion | 150 | 120 | 75 | 75 |
| Grandis Gallery | 60 | 45 | 50 | 50 |
| Celebration Center | 45 | 30 | 35 | 35 |
| Clock Room | 45 | 30 | 35 | 35 |





PHOTO BY DAVID PROETT

CROSSROADS ART CENTER

2016 Staples Mill Road, Richmond, VA 23230
804-278-8950

crossroadsartcenter.com/banquet.html

No need to decorate this unique party space; the artwork is already on the walls. Crossroads has hundreds of free parking spaces and is wheelchair accessible.

| MEETING SPACE | REC | TH | CR | BAN |
|-------------------------|-----|-----|----|-----|
| Classroom One | 85 | 100 | 25 | 60 |
| Classroom Two | 45 | 50 | 18 | 30 |
| Rhoda MacCallum Gallery | 125 | - | - | 85 |
| Gallery One | 75 | 40 | - | 40 |

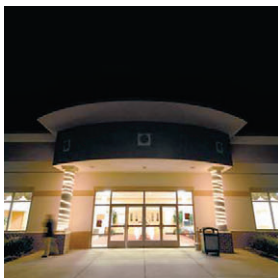

CULTURAL CENTER OF INDIA

6641 Ironbridge Parkway, Chester, VA 23831
804-536-2524

ccihall.com Email: nitapansuria@yahoo.com

The Cultural Center of India is a 20,000-square-foot facility with a banquet hall, foyer, dining room and kitchen. The facility also has a professional sound system and a main hall with a 2,000-square-foot stage where groups can host performances. Facilities available for wedding receptions, graduation parties, prom nights, festivals, and private events.

| MEETING SPACE | REC | TH | CR | BAN |
|---------------|-----|-----|----|-----|
| Banquet Hall | 700 | 300 | - | - |

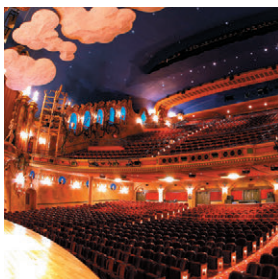

DOMINION ARTS CENTER

600 E. Grace St., Richmond, VA 23219
804-592-3330

dominionartscenter.com

Located in the heart of the Arts District, the Carpenter Theatre has a capacity of nearly 1,800 and is listed on the National Register of Historic Places. The 200-seat Libby S. Gottwald Playhouse is an intimate setting for performances, lectures, conferences and presentations. Rhythm Hall is a multi-purpose venue that regularly features intimate cabaret performances, stand-up comedy, wedding receptions, corporate luncheons and community gatherings.

| MEETING SPACE | REC | TH | CR | BAN |
|-----------------------------|-----|-------|----|-----|
| Carpenter Theatre | - | 1,800 | - | - |
| Libby S. Gottwald Playhouse | - | 200 | - | - |
| Rhythm Hall | 200 | - | - | - |



DOVER HALL ESTATE

1500 Manakin Road, Manakin Sabot, VA 23103
804-396-8366

doverhallestate.com

Dover Hall combines the grandeur of days past with modern conveniences, providing unforgettable experiences. The estate's 33,000 square feet command a majestic view of 55 acres of rolling hills and woodlands. Inside, over 30 rooms invite guests to live luxuriously, creating the perfect setting for events of all kinds.

| MEETING SPACE | REC | TH | CR | BAN |
|---------------|-----|----|----|-----|
| Ballroom | 400 | - | - | 400 |



KATIE BROWN PHOTO

GALLERY 5

200 W. Marshall St., Richmond, VA 23220
804-678-8863

gallery5arts.org

Gallery 5, originally a fire and police station, is a Richmond historic landmark. An eclectic space, the venue includes an upstairs ballroom, gallery space, a commercial kitchen, banquet space, a full bar and stage.

| MEETING SPACE | REC | TH | CR | BAN |
|---------------|-----|-----|-----|-----|
| Entire Venue | 300 | 151 | 151 | 151 |



GINTER PARK WOMEN'S CLUB

3016 Seminary Ave., Richmond, VA 23227
804-358-7314

This facility includes an auditorium with stage, two dressing rooms, a sound system and a grand piano, as well as a large foyer, a well-equipped kitchen and a commercial-size stove.

| MEETING SPACE | REC | TH | CR | BAN |
|---------------|-----|----|-----|-----|
| Auditorium | 200 | - | 200 | 200 |

THE HANOVER ARTS & ACTIVITIES CENTER

500 S. Center St., Ashland, VA 23005
804-798-2728
hanoverarts.org

The historic building with soaring windows and ceilings, hardwood floors and a minimalist décor provides a blank canvas to decorate. And you're not limited to the Ballroom. The Neoclassic exterior, expansive front lawn and towering oak trees are a perfect backdrop for an outdoor wedding or event.

| MEETING SPACE | REC | TH | CR | BAN |
|-----------------|-----|----|----|-----|
| Center | 250 | – | – | 150 |
| Conference Room | – | – | 20 | – |
| Classrooms | – | – | 20 | – |



HANOVER TAVERN

13181 Hanover Courthouse Road, Hanover, VA 23069
804-537-5050
hanovertavern.org

Located 15 miles north of Richmond, this 200-year-old building provides an excellent space for corporate meetings and special events. Catering provided by the onsite full-service restaurant. Free Wi-Fi also available.

| MEETING SPACE | REC | TH | CR | BAN |
|---------------------|-----|-----|----|-----|
| Washington Room | 12 | – | 12 | 12 |
| Arch Room | 40 | – | 40 | 40 |
| The Veranda | – | – | 45 | 45 |
| Taylor Room | – | – | 50 | 50 |
| The Bradley Theater | – | 150 | – | – |
| Brick Terrace | 150 | – | – | 150 |
| Coach House | 200 | – | – | 160 |



HENRICUS HISTORICAL PARK

251 Henricus Park Road, Chester, VA 23836
804-748-1611
henricus.org

The site of the New World's second successful English settlement, Henricus offers a natural woodland setting for meetings. Located about 20 minutes from downtown Richmond, Henricus Historical Park has outdoor and indoor facilities that accommodate up to 250 people.

| MEETING SPACE | REC | TH | CR | BAN |
|---------------------------|-----|----|-----|-----|
| Henricus Education Center | – | – | 100 | 80 |
| Mount Malady | 80 | – | – | 50 |
| Tavern | – | – | 40 | – |
| James River Bluff | 400 | – | – | – |
| Board Room 1 | – | – | 20 | – |
| Board Room 2 | – | – | 20 | – |



HISTORIC MANKIN MANSION

4300 Oakleys Lane, Richmond, VA 23223
804-737-7773
historicmankinmansion.com

A historic marvel, this resort is nestled minutes from downtown Richmond. Professional event planners are on staff to make your event worry-free.

| MEETING SPACE | REC | TH | CR | BAN |
|------------------|-----|----|-----|-----|
| European Gallery | 75 | 75 | 75 | 75 |
| Tented Pavilion | 200 | – | 100 | 200 |



INSTITUTE FOR CONTEMPORARY ART AT VIRGINIA COMMONWEALTH UNIVERSITY

601 W. Broad St., Richmond, VA 23284
804-828-2823
ica.vcu.edu

With 41,000 square feet of flexible space, the Institute for Contemporary Art (ICA) is a premier facility offering astonishing venues for events. By providing a one-of-a-kind atmosphere, access to world-class exhibits and several venues for meetings and events, the ICA promises to deliver exceptional experiences for both clients and guests. (Opening spring 2018)

| MEETING SPACE | REC | TH | CR | BAN |
|------------------------------|-----|-----|----|-----|
| Auditorium | – | 240 | – | – |
| Forum | 430 | – | – | 130 |
| New Market Sculpture Terrace | 48 | – | – | – |
| Thinking Field | 320 | – | – | – |



JAMES RIVER CELLARS WINERY

11008 Washington Highway, Glen Allen, VA 23059
804-550-7516
jamesrivercellars.com

Only 15 minutes from downtown Richmond, James River Cellars Winery hosts corporate events, private parties and fundraisers. The winery offers an event room, outdoor grounds and areas for breakout sessions. Adjacent parking is available, along with flat-screen TVs, wireless internet, and wine tastings and winery tours.

| MEETING SPACE | REC | TH | CR | BAN |
|----------------|-----|----|----|-----|
| Event Room | 40 | – | – | – |
| Patio | – | – | – | – |
| Lawn | 500 | – | – | – |
| Reception Tent | 200 | – | – | – |



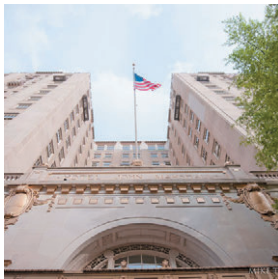

THE JOHN MARSHALL BALLROOMS

101 N. Fifth St., Richmond, VA 23219
804-775-2323

thejohnmarshallballrooms.com

The historic John Marshall Ballrooms offer an elegant venue for corporate events, private functions and wedding receptions in the heart of downtown Richmond, Virginia. Two stunning ballrooms restored to their original 1920s grandeur house vintage crystal chandeliers, soaring ceilings and handcrafted moldings. The ballrooms are ready for you to transform to complement your event vision.

| MEETING SPACE | REC | TH | CR | BAN |
|---------------|-----|-----|-----|-----|
| Virginia Room | 500 | 600 | 400 | 350 |
| Marshall Room | 200 | 200 | 150 | 175 |



LEWIS GINTER BOTANICAL GARDEN

1800 Lakeside Ave., Richmond, VA 23228
804-262-9887, ext. 224 or 345

lewisginter.org

The garden offers beautiful facilities for corporate and private events. A fully equipped auditorium is ideal for conferences, seminars and meetings, with space for board meetings or breakout sessions. Other spaces on site offer unique rental options for corporate outings, receptions, dinners and parties. The garden offers an exclusive onsite caterer.

| MEETING SPACE | REC | TH | CR | BAN |
|--------------------------|-----|-----|-----|-----|
| Auditorium | 325 | 250 | 110 | 176 |
| Partial #3 | - | 176 | 60 | 96 |
| Azalea Room | 40 | 50 | 30 | 48 |
| Robins Visitors Center | 250 | - | - | - |
| Robins Room | 125 | 140 | 50 | 136 |
| Café | 100 | - | - | 60 |
| Bloemendaal House | 125 | - | - | 48 |
| Entire Downstairs & Tent | 250 | - | - | 144 |
| Robins Tea House | 60 | - | - | 66 |

ALLEN JONES VCU CREATIVE SERVICES



MAYMONT

1700 Hampton St., Richmond, VA 23220
804-358-7166

maymont.org Email: crosenberg@maymont.org

Maymont is a 100-acre American estate, an extraordinary gift given to the community by James and Sallie Dooley. They completed their mansion in 1893 and spent the next three decades creating gardens, landscapes and outbuildings.

| MEETING SPACE | REC | TH | CR | BAN |
|----------------------------------|------|----|----|-----|
| Garden Hall | 150 | - | - | 80 |
| Carriage House Lawn | 250+ | - | - | - |
| The Farm Lawn | 250+ | - | - | - |
| Nature Center (full building) | 500 | - | - | - |
| Nature Center EEC & West Terrace | 250 | - | - | 150 |
| Nature Center | - | - | 20 | - |
| Conference Room | - | - | - | - |
| Nature Center Robins Room | - | - | 40 | - |
| Stone Barn | - | 50 | - | - |

STEVE HEDBERG



THE NATIONAL

708 E. Broad St., Richmond, VA 23219
804-219-8785

thenationalva.com

Events are not attended, they are experienced. By providing world-class service, state-of-the-art lighting and sound, and top-level event planning and coordination services, The National offers turnkey solutions to transform any event into an unforgettable experience. For specific capacity limits, venue features, pricing options, or to schedule a site tour, please contact D.J. Bognar at dbognar@aegpresents.com.

| MEETING SPACE | REC | TH | CR | BAN |
|-----------------|-------|----|----|-----|
| Entire Facility | 1,500 | - | - | - |



THE PLACE AT INNSBROOK

4036-C Cox Road, Glen Allen, VA 23060
804-346-2100

theplaceatinnsbrook.com

The Place at Innsbrook features a variety of beautiful rooms with an outdoor patio. The ballroom, the salons or patio and garden are a perfect setting for your next wedding, banquet or business meeting. Let the expert staff show you how pleasant and stress-free it can be to plan the most important events of your life.

| MEETING SPACE | REC | TH | CR | BAN |
|----------------|-----|-----|----|-----|
| Ballroom | 300 | 400 | 77 | 200 |
| Salons | 150 | 200 | 57 | 100 |
| Innsbrook Room | 45 | 40 | 16 | 24 |
| Garden Room | 80 | 70 | 36 | 60 |
| Pavilion Room | 50 | 50 | 24 | 40 |



PLANT ZERO

0 E. Fourth St., Richmond, VA 23224
804-322-9575

rvaeventspace.com

Plant Zero is a 7,000-square-foot former warehouse turned event site. It has a very urban, artsy atmosphere that can be transformed with each event. Plant Zero has proven to be an exceptional site for wedding receptions, bar mitzvahs, fashion shows, parties, art openings and fundraisers of all sorts.

| MEETING SPACE | REC | TH | CR | BAN |
|-----------------|-----|-----|-----|-----|
| Entire Facility | 400 | 400 | 400 | 350 |

THE RENAISSANCE CONFERENCE CENTER

107 W. Broad St., Suite 300, Richmond, VA 23220
804-649-3373
renaissanceva.com

Previously the Old Masonic Temple, The Renaissance has been magnificently restored to its original Victorian splendor, with grand rooms and extensive amenities including catering and beverage service, onsite parking, and state-of-the-art audiovisual and internet capabilities.

| MEETING SPACE | REC | TH | CR | BAN |
|-------------------------|-----|-----|----|-----|
| Roosevelt Room/Ballroom | 450 | 450 | - | 300 |
| Grand Foyer | 150 | - | - | - |
| Adams Room | 115 | 156 | - | 100 |



RICHMOND BALLET

407 E. Canal St., Richmond, VA 23219
804-344-0906
richmondballet.com

The state ballet of Virginia, the Ballet's repertoire includes more than 60 original works. Richmond Ballet has limited studio rental.

| MEETING SPACE | REC | TH | CR | BAN |
|--------------------|-----|-----|----|-----|
| Third-Floor Studio | - | 250 | - | - |



PHOTO BY JESSICA DODDS

ROSLYN CONFERENCE AND RETREAT CENTER

8727 River Road, Richmond, VA 23229
804-288-6045 or 800-477-6296
roslyncenter.org

Roslyn welcomes groups for residential conferences, retreats, meetings and picnics. There is more than 7,900 square feet of quiet, peaceful meeting space overlooking the James River valley. Overnight lodging is available, as well as a dining facility that can accommodate up to 150 guests.

| MEETING SPACE | REC | TH | CR | BAN |
|-----------------------|-----|-----|----|-----|
| Gibson Hall | - | 80 | 50 | - |
| Walker Assembly | - | 110 | 55 | - |
| Walker Lounge | - | 25 | - | - |
| Tucker Hall | - | 80 | 50 | - |
| Bishop's Dining Room | - | - | 20 | - |
| West Room | - | - | 16 | - |
| The Chancellor's Room | - | - | 10 | - |
| Dining Hall | - | - | - | 150 |



PHOTO BY MICHAEL WAINE

SCIENCE MUSEUM OF VIRGINIA

2500 W. Broad St., Richmond, VA 23220
804-864-1400
smv.org

Set in a restored train station listed on the National Register of Historic Places, this venue has a stimulating environment including indoor and outdoor space and a five-story, domed theater. The museum offers free parking. Request a list of recommended caterers; limited kitchen facilities available.

| MEETING SPACE | REC | TH | CR | BAN |
|-------------------------------|-------|-----|-----|-------|
| RF&P Forum | 100 | - | 100 | 100 |
| Rotunda Forum | 350 | - | 350 | 350 |
| Thalhimer Pavilion | 500 | - | - | 500 |
| Garner Pavilion | 1,000 | - | - | 1,000 |
| Discovery Room | 125 | 150 | 80 | 80 |
| Mezzanine | 200 | - | - | - |
| Dome Theater | - | 230 | - | - |
| Ms. Barbara Thalhimer Theater | - | 119 | - | - |
| Dewey Gottwald Center | 500 | - | 500 | 500 |



SUNTRUST CENTER

919 E. Main St., Richmond, VA 23213
804-344-3600
suntrustcenter.com

Centrally located in downtown, SunTrust Center offers meeting and special event space. The fourth-floor conference center features several meeting spaces that can accommodate up to 220 guests.

| MEETING SPACE | REC | TH | CR | BAN |
|-----------------|-----|-----|----|-----|
| Auditorium | - | 221 | - | - |
| Piedmont Room | - | - | 30 | - |
| Shenandoah Room | - | - | 25 | - |
| Tidewater Room | - | - | 50 | - |
| Tilghman Room | - | - | 20 | - |
| Main Dining | 300 | - | - | 150 |

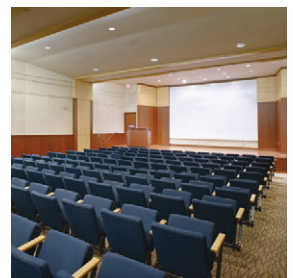

SWIFT CREEK MILL THEATRE

17401 Jefferson Davis Highway,
Colonial Heights, VA 23834
804-748-5203
swiftcreekmill.com

Ambiance and charm greet you at this registered historic landmark that dates to 1663. The ADA-accessible venue has two dining rooms and wheelchair seating in the theatre. The Mill is perfect for intimate to mid-sized gatherings, meetings, and receptions, and it boasts ample onsite parking. Delicious catering is also available.

| MEETING SPACE | REC | TH | CR | BAN |
|--------------------------|-----|-----|-----|-----|
| Mill Room | 100 | - | 130 | 130 |
| Swift Creek Mill Theatre | 220 | 220 | 220 | - |
| Granite Room | 100 | 100 | 140 | 140 |





TUCKAHOE PLANTATION

12601 River Road, Richmond VA 23238
804-971-8329
tuckahoeplantation.com

Tuckahoe Plantation, the boyhood home of Thomas Jefferson, is a privately owned and operated National Historic Landmark. Featuring beautiful gardens and overlooking the James River west of Richmond, Tuckahoe is the perfect place for your event.

| MEETING SPACE | REC | TH | CR | BAN |
|-------------------------|-----|----|----|-----|
| The Old Stable Building | 60 | – | – | 45 |
| Outdoor Sites | – | – | – | 500 |



THE VALENTINE

1015 E. Clay St., Richmond, VA 23219
804-649-0711
thevalentine.org

Providing a “very Richmond” alternative for your private event, The Valentine is conveniently located in downtown Richmond and offers both indoor and outdoor accommodations.

| MEETING SPACE | REC | TH | CR | BAN |
|-----------------------------------|-----|----|----|-----|
| Garden | 150 | – | – | 75 |
| Multi-Purpose Room | 150 | 90 | 60 | 75 |
| Stern Gallery/ Conference Room | – | 35 | 30 | 30 |
| Gray Family Terrace | 120 | – | – | 60 |



VIRGINIA CAPITOL

10th and Bank streets, Richmond, VA 23219
804-698-7400 (Senate), 804-698-1619 (House)
virginiacapitol.gov

The restored Virginia State Capitol carries on themes originally presented by Thomas Jefferson and also caters to a 21st-century visitor’s expectation of what the Commonwealth’s capitol should be. New working space features many meeting amenities, including public restrooms, meeting rooms, an exhibit gallery, gift shop and café.

| MEETING SPACE | REC | TH | CR | BAN |
|--------------------|-----|-----|-----|-----|
| Senate Room 3 | 150 | 125 | 100 | 130 |
| House Room 3 | 150 | 125 | 100 | 130 |
| Rotunda | 100 | – | – | – |
| Old Senate Chamber | 75 | – | – | 40 |
| Jefferson Room | 75 | – | – | 40 |



VIRGINIA HISTORICAL SOCIETY

428 N. Boulevard, Richmond, VA 23220
804-342-9676
vahistorical.org

From small and intimate to large and spacious, the meeting and reception spaces at the VHS offer flexible set-up times, A/V equipment, kitchen access for caterers, and can be used for both daytime and evening events.

| MEETING SPACE | REC | TH | CR | BAN |
|------------------------|-----|-----|-----|-----|
| Halsey Lecture Hall | 300 | 250 | 150 | 150 |
| Robins Conference Room | 21 | – | – | 24 |
| Robins Forum | – | 488 | – | – |
| Weinstein Classroom | – | 68 | 40 | – |



VIRGINIA HOLOCAUST MUSEUM

2000 E. Cary St., Richmond, VA 23223
804-257-5400
vaholocaust.org

The Virginia Holocaust Museum is suitable for events of all sizes and types. Facilities include a large auditorium with balcony, a 5,300-square-foot classroom and a flexible meeting room, as well as two art galleries. Audiovisual equipment is available.

| MEETING SPACE | REC | TH | CR | BAN |
|----------------------------|-----|-----|-----|-----|
| Auditorium | 300 | 300 | 300 | 300 |
| TEI Classroom | 150 | 150 | 75 | 100 |
| Meeting Room (Old Library) | 75 | – | 75 | 60 |



VIRGINIA HOUSE

4301 Sulgrave Road, Richmond, VA 23221
804-353-4251
vahistorical.org

Virginia House and its gardens provide a bucolic setting for daytime retreats and corporate receptions. Request a list of preferred caterers; kitchen facilities available.

| MEETING SPACE | REC | TH | CR | BAN |
|-----------------|-----|----|----|-----|
| Gallery | – | 40 | 25 | 40 |
| Great Hall | – | 40 | 25 | 40 |
| Terrace | 80 | – | – | 50 |
| House & Grounds | 80 | – | – | – |

VISUAL ARTS CENTER OF RICHMOND

1812 W. Main St., Richmond, VA 23220
804-353-0094
visarts.org

The Visual Arts Center of Richmond offers 30,000 square feet of interior space in the heart of Richmond's historic Fan District. Your event can be enhanced by offering attendees access to a gallery exhibition, and there are also venues for outdoor events.

| MEETING SPACE | REC | TH | CR | BAN |
|--------------------------------|-----|-----|----|-----|
| Schaberg Commons | 300 | - | - | - |
| Dominion Energy Community Room | 220 | 150 | - | 100 |
| Weinstein Room | - | - | 20 | - |
| Cabell Courtyard | 200 | - | - | 130 |



WALKERTON TAVERN

2892 Mountain Road, Glen Allen, VA 23060
804-261-6898
henricorecandparks.com

Walkerton was built by John Walker between 1824 and 1825. In the course of its history, the structure has served as a tavern, hotel, store, post office and voting precinct. Walkerton Tavern and its gardens host a variety of programs and special events and are available to rent for weddings, conferences and group meetings.

| MEETING SPACE | REC | TH | CR | BAN |
|----------------|-----|----|----|-----|
| First Floor | 30 | - | - | 23 |
| Second Floor | 60 | - | 44 | 30 |
| Gardens/Gazebo | 200 | - | - | - |



PHOTO BY JUSTIN VAUGHAN

THE WINE LOFT

4035 Whittall Way, Glen Allen, VA 23060
804-368-1768
wineloftrichmond.com

Located at West Broad Village in the heart of Short Pump, the Wine Loft can accommodate a wide range of social gatherings from fundraisers to company parties. Event planners will find The Wine Loft ideal for corporate socials, cocktail parties, receptions, presentations and general after-hours functions.

| MEETING SPACE | REC | TH | CR | BAN |
|-----------------|-----|----|----|-----|
| Entire Building | 200 | - | - | - |
| Loft | 50 | - | - | - |
| Downstairs | 120 | - | - | - |



Four Points by Sheraton Richmond

Four Points by Sheraton Richmond Airport

MEETINGS DONE RIGHT

Two great hotels, each with more than 11,000 square feet of flexible event space. Four Points by Sheraton Richmond and Four Points by Sheraton Richmond Airport can accommodate your group with ease, providing the perfect space for your wedding, banquet, social event or meeting.

Four Points by Sheraton Richmond Enjoy a beautiful backdrop for your next event. The largest of our nine flexible meeting spaces is 4,000 square feet and can accommodate up to 550 guests.

Four Points by Sheraton Richmond Airport Stay minutes from the airport. The largest of our eight flexible meeting spaces is nearly 3,000 square feet and can accommodate up to 325 guests.

Four Points by Sheraton Richmond

LEARN MORE AT FOURPOINTS.RICHMOND.COM
OR CALL 804 323 1144

Four Points by Sheraton Richmond Airport

LEARN MORE AT FOURPOINTS.RICHMONDAIRPORT.COM
OR CALL 804 226 4300



©2015 Starwood Hotels & Resorts Worldwide, Inc. All Rights Reserved. Preferred Guest, SPG, Four Points and their logos are the trademarks of Starwood Hotels & Resorts Worldwide, Inc., or its affiliates. For full terms and conditions, visit fourpointsrichmond.com and fourpointsrichmondaairport.com

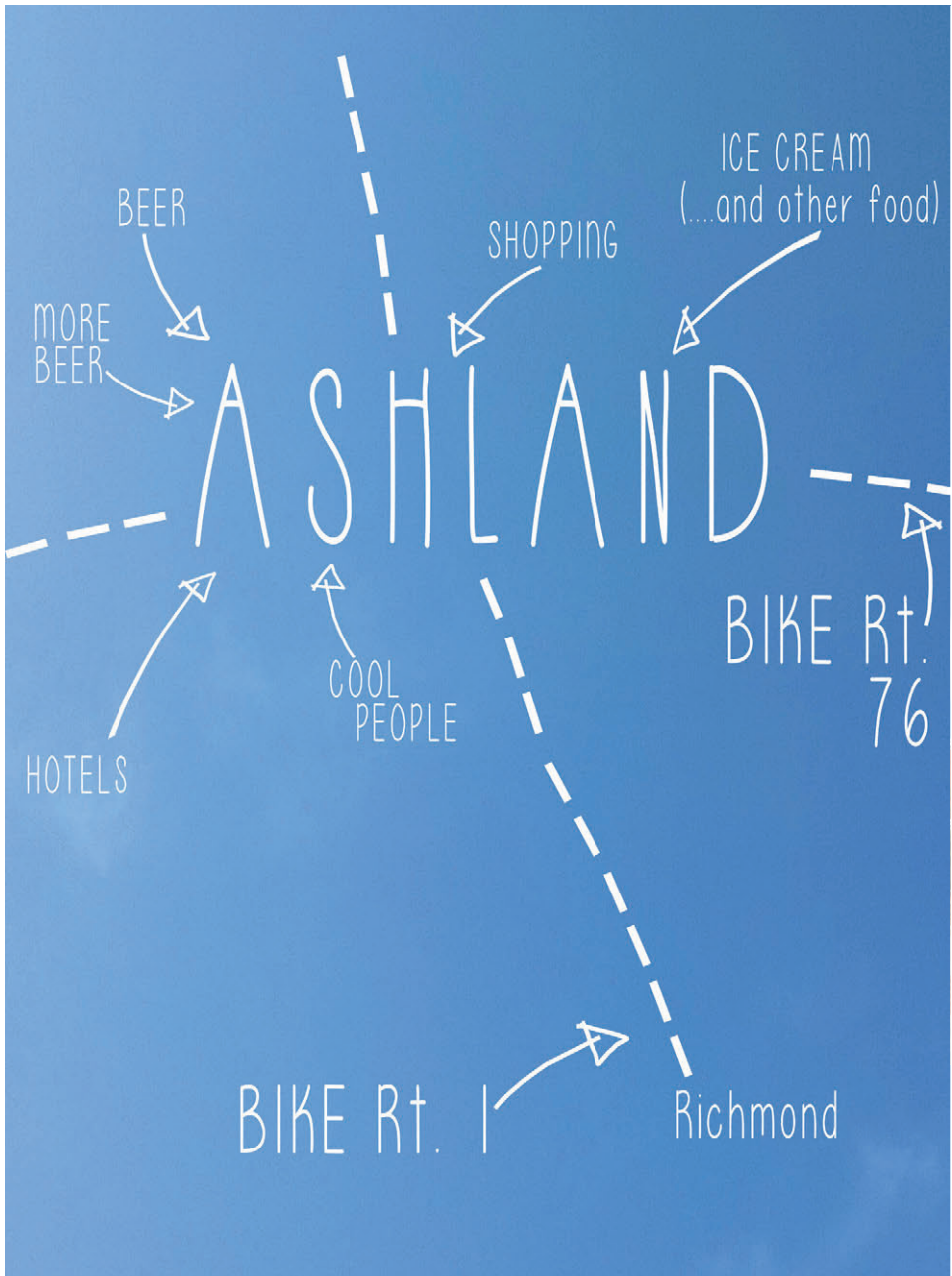

We're closer than you think, just 15 minutes away!

Ashland. At the intersection of Bike Route 1 and 76... which also happens to be at the Center of the Universe.

Visitor Info: 804.752.6766 or www.DiscoverAshlandVA.com





An Extraordinary Location.

Your place to innovate, communicate and celebrate. Leave the "bored" room for some inspired brainstorming. Entertain clients amidst giant aquariums. Or host an elegant celebration steps away from historic gardens. Experience the endless possibilities at Maymont.

804-358-7167 | maymont.org

MAYMONT®



Cultural
ARTS
CENTER
- GLEN ALLEN -

SAVE 10% OFF THIS INSPIRING VENUE FOR YOUR NEXT:
Staff Retreat • Business Meeting • Conference
Board Meeting • Holiday Party • And More!

Enjoy 10% off your next rental space with code: **ARTS-RM**

FOR MORE INFORMATION OR TO ARRANGE A TOUR:
Nancy Allen - Events Manager
(804) 261-6211 rentals@artsglenallen.com
artsglenallen.com 2880 Mountain Rd., Glen Allen, VA

Must present coupon or mention at time of request. Must book by 7/31/18.
May not be combined with any other discount or offer.



BE A PART OF HISTORY when you book your next meeting in Richmond.

Formerly the historic Miller & Rhoads department store building, the new Hilton Richmond Downtown combines the glorious past with every conceivable modern amenity. Just across the street from the Convention Center, this hotel property has everything you need for a successful and productive meeting, including complimentary Wi-Fi and a 24-hour business center, and over 15,000 sq. ft. of flexible meeting space to accommodate up to 750 guests. The new Hilton Richmond Downtown. Your place in history. **Everything. Right where you need it.®**



Reservations: richmonddowntown.hilton.com • 1-800-774-1500

501 East Broad St.
Richmond, VA 23219
804-344-4300

©2019 Hilton Hotels Corporation



LINDEN ROW
A GREAT AMERICAN INN

boutique historic hotel
downtown rva

100 E. Franklin Street
Richmond, VA 23219

www.lindenrowinn.com



To book a meeting, event or guest accommodations with us,
please contact our
Group Sales and Events Office
1.804.225.5841
sales@lindenrowinn.com

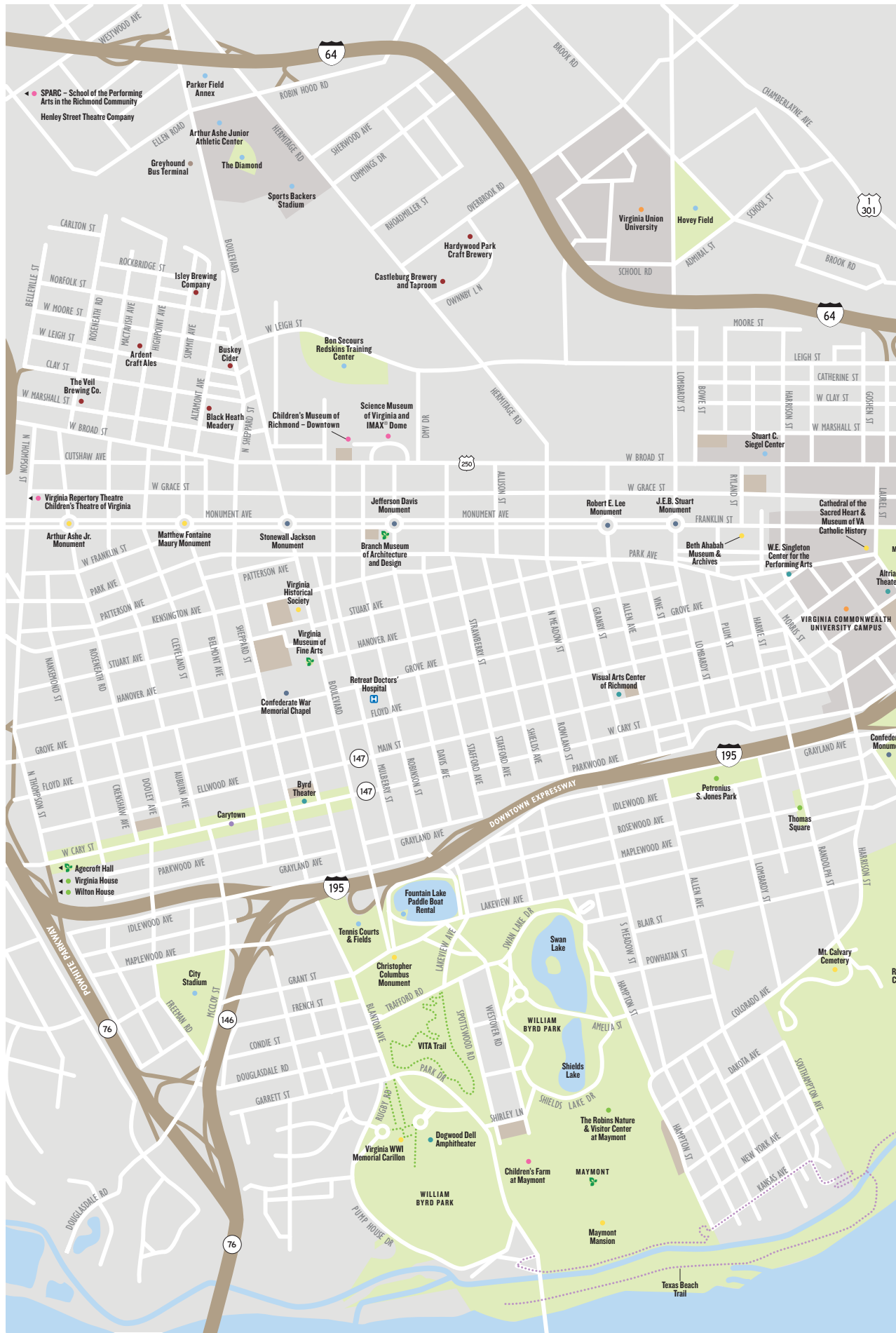



Richmond Attractions Map

- | | | | | | | |
|------------------|---------------------|---------------------|----------------------|-------------------|---------------|---------|
| ★ Visitor Center | Transportation | Universities | Family Fun | Garden Trail | Slave Trail | Parking |
| H Hospital | Historic & Cultural | Sports & Recreation | Shopping | Interpretive Walk | Liberty Trail | Park |
| Wine & Brew | American Civil War | Homes & Gardens | Arts & Entertainment | Multiuse Trail | Flood Wall | |





VIRGINIA'S
BEER
AUTHORITY
and more...



CAPITAL
ALE · HOUSE

CAPITALALEHOUSE.COM

The Hilton Richmond Hotel & Spa

- ♦ 254 beautifully appointed guest rooms
- ♦ Executive & Junior suites available
- ♦ Multipurpose Capital pre-function area
- ♦ Capital ballroom allowing 800 seated guests and 1,000 for reception
- ♦ Visit Aroma Café which proudly serves Starbucks coffee
- ♦ Newly redesigned fitness room
- ♦ Indoor pool & whirlpool with access to patio with outdoor seating & fire pit
- ♦ Relax & rejuvenate at Aura Spa, the only Four Diamond Spa in Central Virginia
- ♦ Complimentary parking & shuttle service
- ♦ Electric car charging stations
- ♦ Take advantage of our on-site concierge & bellmen staff
- ♦ Shula's Steak House features a separate lounge area to unwind in as well as private dining rooms for special events & occasions, meetings and intimate dinners



1 2 0 4 2 West Broad Street | Richmond VA 2 3 2 3 3 | 8 0 4 . 3 6 4 . 3 6 0 0



MEETINGS SIMPLIFIED.

Homewood Suites and Hampton Inn & Suites Richmond Downtown is located in the heart of downtown Richmond, steps from the Virginia State Capitol, Federal Courthouse, Richmond Coliseum, Richmond Convention Center, and a multitude of restaurants, entertainment, and shopping options. Come experience our oversized guestrooms and suites, which are 80% larger than traditional hotels; we give you the space you need to work, live, and play.

Our hotels have 244 rooms and 7,000 square feet of flexible meeting space perfect for your conferences, meetings, weddings, and other social events. Our space features a 2,840 square foot ballroom with windows for natural light. It can be split into three sections. Our hotels also offer an additional two 1,000 square foot meeting rooms, 2 executive boardrooms, and 8 additional small meeting rooms perfect for interviews, depositions, or a small dinner party.



700 East Main Street | Richmond, VA 23219



Hampton Inn & Suites Richmond Downtown
richmonddowntownsuites.hamptoninn.com
804-643-2500 | Fax: 804-643-5400



Homewood Suites Richmond Downtown
richmonddowntown.homewoodsuites.com
804-643-2900 | Fax: 804-643-5200



MEET FOR A
PURPOSE,
STAY FOR THE
EXPERIENCE.

Every destination has a soul worth discovering. So at Omni Richmond Hotel we strive at every opportunity to bring you the true essence of historic Shockoe Slip. It's in the gracious Southern hospitality and local knowledge offered with a smile. Stay with Omni, and let us make the most of your next chance to gather.

OMNI  HOTELS
& RESORTS
richmond

OMNIHOTELS.COM/RICHMOND
804-344-7000