

ACCESSORIES

STRAIGHT TUBING

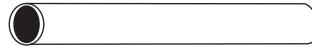

Bendable Aluminum Killed Draw Quality (AKDQ) Steel Tubing																		
OD	Low Carbon								Aluminized									
Length	7'		7' 6"		10'				7'	7' 6"				10'			13'	
Gauge	16	14	16	14	17	16	14	13	16	17	16	14	13	17	16	14	13	14
Thick.	0.060"	0.069"	0.060"	0.069"	0.050"	0.060"	0.075"	0.082"	0.060"	0.050"	0.060"	0.069"	0.082"	0.050"	0.060"	0.069"	0.082"	0.069"
1½	—	—	47980	—	—	49021	—	—	—	47968	—	—	—	49045	49243	—	—	—
1¾	—	—	47982	—	—	49022	—	—	—	47971	—	—	—	49046	49241	—	—	—
1⅞	—	—	47983	—	—	49023	—	—	—	47969	—	—	—	49057	49242	—	—	—
2	47993	—	47984	47989	49016	49024	49043	—	—	—	47972	—	47960	—	49047	—	49069	—
2¼	—	—	—	47986	49007	—	49025	—	—	—	—	47973	47961	—	—	49048	49068	—
2½	—	47996	—	47987	49008	—	49026	—	—	—	—	47974	47962	—	—	49049	49067	—
2¾	—	—	—	—	49009	—	49040	—	—	—	—	—	—	—	—	49195	—	49050
3	—	—	—	—	—	49010	49041	49066	—	—	—	47963	47967	—	—	49159	49065	49051
3½	—	—	—	—	—	49011	—	—	—	—	—	—	—	—	49098	49160	—	—
4	—	—	—	—	—	49012	—	—	47863	—	—	—	—	—	49099	49161	—	49052
5	—	—	—	—	—	—	—	—	—	—	—	—	—	—	49064	49162	—	—
6	—	—	—	—	—	—	—	—	—	—	—	—	—	—	—	49062	—	—

BENDABLE TUBING CHART

Tubing Part #	Emboss	OAL (In.)
47960	AK200HA	90
47961	AK214HA	90
47962	AK212HA	90
47963	AK300A	90
47967	AK300HA	90
47968	AK112A	90
47969	AK178A	90
47971	AK134A	90
47972	AK200A	90
47973	AK214A	90
47974	AK212A	90
47980	AK112	90
47982	AK134	90
47983	AK178	90
47984	AK200	90
47986	AK214	90
47987	AK212	90
47989	AK200H	90

Tubing Part #	Emboss	OAL (In.)
47993	AK200	84
47996	AK212	84
49007	AK214	120
49008	AK212	120
49009	AK234	120
49010	AK300	120
49011	AK312	120
49012	AK400	120
49016	AK200	120
49021	AK112	120
49022	AK134	120
49023	AK178	120
49024	AK200	120
49025	AK214	120
49026	AK212	120
49040	AK234	120
49041	AK300	120
49043	AK200H	120

Tubing Part #	Emboss	OAL (In.)
49045	AK112A	120
49046	AK134A	120
49047	AK200A	120
49048	AK214A	120
49049	AK212A	120
49050	AK234A	156
49051	AK300A	156
49052	AK400A	156
49057	AK178A	120
49062	AK600A	120
49064	AK500	120
49065	AK300HA	120
49066	AK300H	120
49067	AK212HA	120
49068	AK214HA	120
49069	AK200HA	120
49098	AK312A	120
49099	AK400A	120

Tubing Part #	Emboss	OAL (In.)
49159	AK300A	120
49160	AK312A	120
49161	AK400A	120
49162	AK500HA	120
49195	AK234A	120
49241	AK134HA	120
49242	AK178HA	120
49243	AK112HA	120

Emboss	Tubing Part #	OAL (In.)
AK112	47980	90
AK112	49021	120
AK112A	47968	90
AK112A	49045	120
AK112HA	49243	120
AK134	47982	90
AK134	49022	120
AK134A	47971	90
AK134A	49046	120
AK134HA	49241	120
AK178	47983	90
AK178	49023	120
AK178A	47969	90
AK178A	49057	120
AK178HA	49242	120
AK200	47993	84
AK200	47984	90

Emboss	Tubing Part #	OAL (In.)
AK200	49016	120
AK200	49024	120
AK200A	47972	90
AK200A	49047	120
AK200H	47989	90
AK200H	49043	120
AK200HA	47960	90
AK200HA	49069	120
AK212	47996	84
AK212	47987	90
AK212	49008	120
AK212	49026	120
AK212A	47974	90
AK212A	49049	120
AK212HA	47962	90
AK212HA	49067	120
AK214	47986	90

Emboss	Tubing Part #	OAL (In.)
AK214	49007	120
AK214	49025	120
AK214A	47973	90
AK214A	49048	120
AK214HA	47961	90
AK214HA	49068	120
AK234	49009	120
AK234	49040	120
AK234A	49050	156
AK234A	49195	120
AK300	49010	120
AK300	49041	120
AK300A	47963	90
AK300A	49159	120
AK300A	49051	156
AK300H	49066	120
AK300HA	47967	90

Emboss	Tubing Part #	OAL (In.)
AK300HA	49065	120
AK312	49011	120
AK312A	49098	120
AK312A	49160	120
AK400	49012	120
AK400A	49099	120
AK400A	49161	120
AK400A	49052	156
AK500A	49064	120
AK500HA	49162	120
AK600A	49062	120

ACCESSORIES

STANDARD STRAIGHT TUBING Non-Bendable

Length	Low Carbon Steel		
	10'		
Gauge	18	17	15
Thickness	0.042"	0.054"	0.065"
OD			
1½	49002	—	—
1⅝	49003	—	—
1¾	49004	—	—
1⅞	49005	—	—
2	49006	—	—
2⅛	49013	—	—
3¼	—	49058	—
4½	—	49056	—
5	—	—	49015
6	—	49027	—

Comparison of Gauge to Decimal	
Gauge	Decimal
13	0.082
14	0.069/0.075
15	0.065
16	0.055/0.060
17	0.050/0.054
18	0.042

STAINLESS STEEL STRAIGHT TUBING

OD	Bendable 409 Stainless Steel Tubing		Aluminized Stainless Steel Tubing			
	10'		4'	10'		
Gauge	14	15	17	14	15	17
Thickness	0.071"	0.065"	0.054"	0.071"	0.065"	0.054"
2	—	—	—	—	—	49184
2¼	—	—	—	—	—	49185
2½	—	—	54762	—	—	49186
3	49095	—	54763	—	—	—
3½	49096	—	—	—	—	—
4	49097	—	—	—	—	—
5	—	49263	—	—	—	—

Note: Bending characteristics of stainless steel tubing are substantially different than low carbon steel tubing. Listed below are important factors in successfully bending stainless steel tubing.

1. Wing die (back) pressure may need to be increased to prevent backwall collapse.
2. The tube weld seam should be located 90° from the inside and outside of any severe bends.
3. Wing dies must be in good condition and in alignment throughout the entire bending arc.
4. Bends should be made in one continuous operation at a slow rate of speed.
5. Bends should not be made tighter than two times pipe diameter.
6. Equipment must be in proper operating condition.

OXYGEN SENSOR GASKET

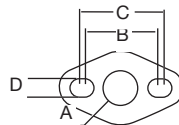

Gasket No.	A	B	C	D
31564	¾	1½	1¾	⅜
31676	1	2⅞	—	⅜

Must be used with 31958 Flange Adapter