

NovoPen® 6))

Your NovoPen® 6 at a glance

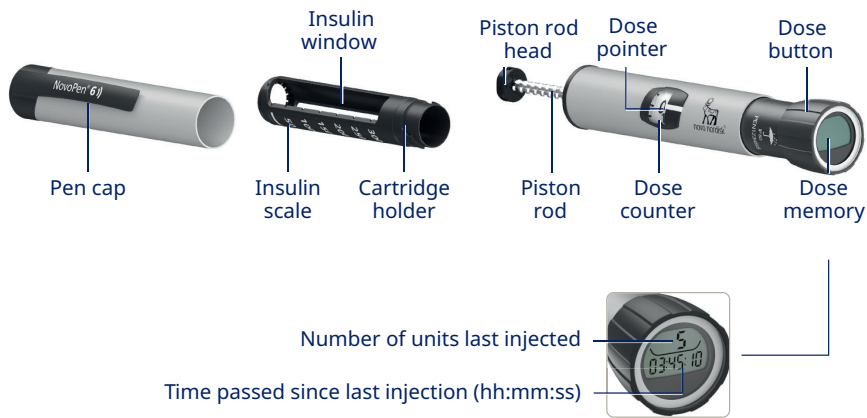

NovoPen® 6



Single use needle

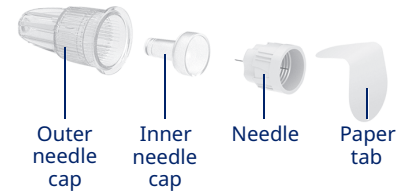

Penfill® cartridge

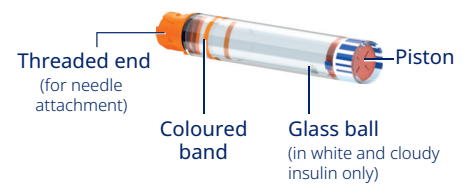

Quick **step-by-step** guide to use

INSERT PENFILL® CARTRIDGE AND ATTACH NEEDLE

STEP 1 Remove pen cap

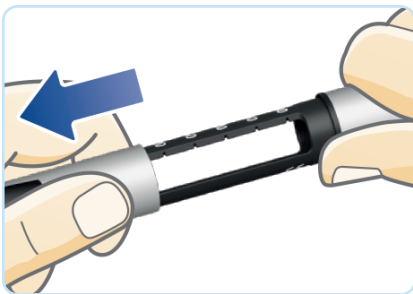

STEP 2 Twist off cartridge holder

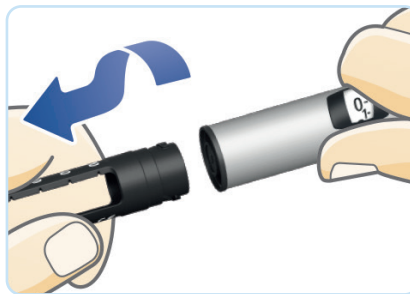

STEP 3 Insert cartridge, threaded end first



STEP 4 Twist cartridge holder back on until you hear or feel a click

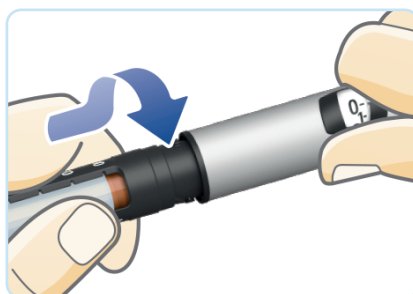

STEP 5 Remove the paper tab from a new needle and push needle straight onto pen

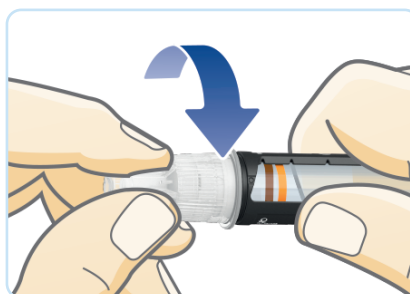

STEP 6 Remove outer and inner needle caps. Keep the outer cap for safe needle disposal

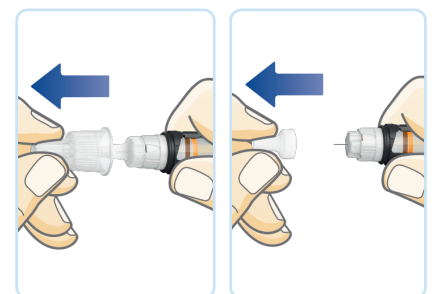

For a full explanation of how to use your NovoPen® 6, please read the Instructions for use that accompany your pen. Please turn over for important safety information.

ALWAYS TEST INSULIN FLOW AFTER INSERTING A PENFILL® CARTRIDGE

STEP 1 Pull out dose button and turn to select **2 units**.

STEP 2 Press the dose button until the dose counter shows **0** and lines up with the dose pointer.

Insulin should squirt from the needle

STEP 3 Then check in the insulin window to ensure there is no gap between the piston rod head and the piston.

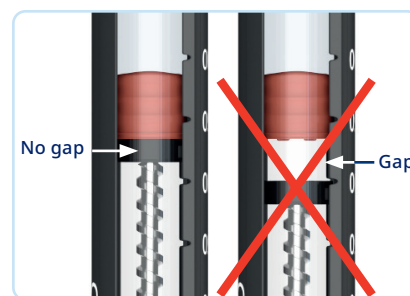
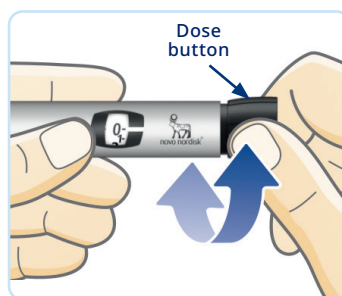

If no insulin appears OR there is a gap, repeat steps 1–3 until the pen is ready for use.



If you do not check the insulin flow you may not receive your full insulin dose.

INJECT YOUR INSULIN

STEP 1 With the dose counter at **0**, pull out the dose button and turn to select the number of units you wish to inject.



STEP 2 Insert the needle and press the dose button until the dose counter shows **0**. Count slowly to **6** before you remove the needle.

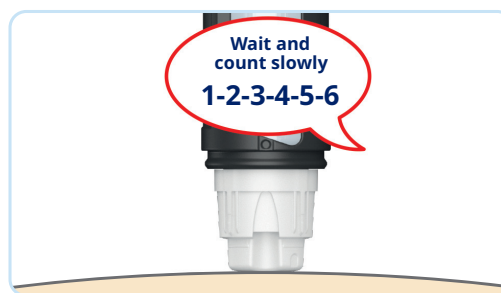

Safely remove and dispose of the needle and put the pen cap back on.

FREQUENTLY ASKED QUESTIONS

How do I know if there is enough insulin left for my next dose?

Turn the dose button until it stops. The dose counter will show either:
– **60** meaning there are **at least 60 units** in the cartridge, or
– a number less than 60 indicating **exactly** how many units are left.

If the cartridge does not contain enough insulin for your next dose, replace with a new Penfill®.

Can I remove and replace a partially used Penfill® cartridge?

YES. If you remove a Penfill® cartridge and then return it to NovoPen® 6 you **MUST** retest the insulin flow as shown above.

Why is the piston rod loose?

If there is no Penfill® in the pen the piston rod may move back and forth. **This is normal.**

IF YOU NEED FURTHER INFORMATION OR SUPPORT



Visit the NovoCare® Patient Support Program to access information about insulin and NovoPen® 6 resources including how-to-use videos – www.novocare.com.au



Questions about how to use your pen, or technical issues? Call Novo Nordisk Medical Information – **1800 668 626**

NovoPen® 6

Novo Nordisk Pharmaceuticals Pty Ltd. Level 10, 118 Mount Street, North Sydney NSW 2060.
ABN 40 002 879 996. Novo Nordisk Medical Information (Australia) 1800 668 626. www.novonordisk.com.au.
© Registered trademark of Novo Nordisk A/S. NON00Y0133. AU24NP600011. July 2024.

