

How to use NovoPen Echo®



NovoPen Echo®



Pen cap



Colour-coded cap Cartridge holder



Piston rod Dose indicator Dose memory

NovoFine® Plus 4mm 32G 0.23x0.25 x 4mm

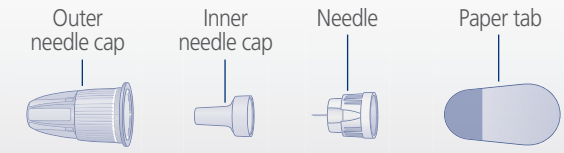

NovoPen Echo® is designed to be used with NovoFine® needles

Preparing NovoPen Echo®

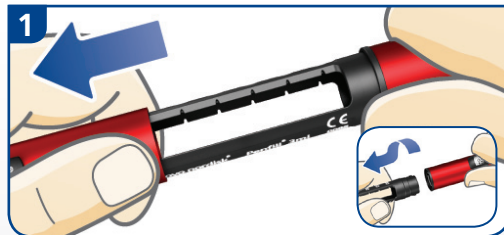

1 Pull off the pen cap.
Twist off the cartridge holder.
The piston rod may stick out of your pen. If so, push it in until it stops.



2 Take a new insulin cartridge and check that:

- It contains the correct type of insulin, which looks as it should.
- It has no cracks or damage.

Slide the cartridge into the cartridge holder with the colour coded cap end first.

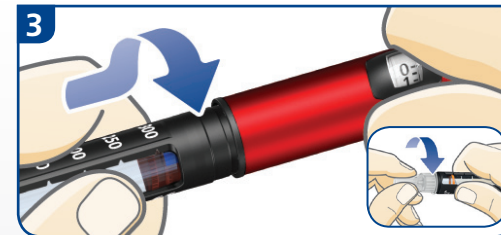

3 Twist the cartridge holder back on, until you hear or feel a click. If you use an insulin cartridge with white and cloudy insulin, always resuspend the insulin right before injection. Before injection, always attach a new NovoFine® needle. Remove both the outer and inner needle caps, and dispose of the inner needle cap. Keep the outer needle cap to remove the needle from the pen after injection.

Checking the insulin flow

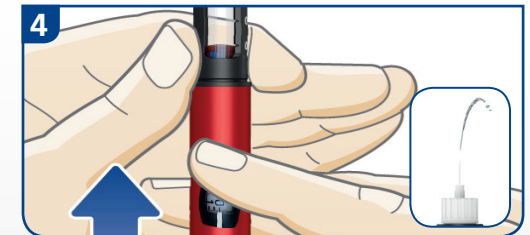

4 ALWAYS test the insulin flow before you inject. Keep testing until insulin squirts from the needle tip. This ensures that any gaps and air bubbles are removed and that insulin is getting through the needle.

- Turn the dose button to select 2 units and press the dose button until the dose counter shows "0".
- If no insulin appears or there is a gap in the insulin window, repeat the insulin flow test. The insulin flow test is complete when you see insulin squirt and there is no longer a gap between the piston rod head and the piston in the cartridge.

Selecting your dose

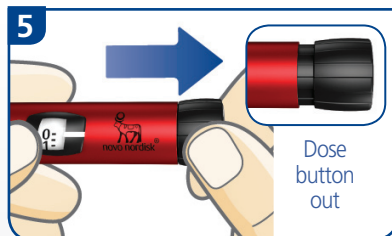

5 Pull out the dose button.
Make sure the dose counter shows "0" before you start.

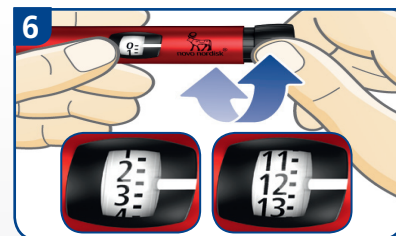

6 Turn the dose button to select the dose you need. Dial until the dose indicator line is level with the required number of units you need to inject. Half-units are indicated by lines between the numbers. You can turn the dose button forward or backward. You can select up to a maximum of 30 units per dose. If you need more than 30 units, you can divide your dose into two injections. Refer to the user manual for instructions.

Injecting your dose

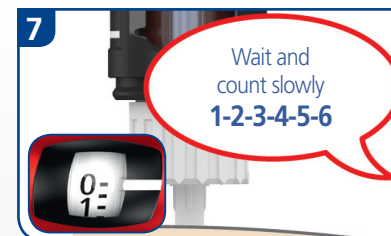

7 Insert the needle into your skin and press the dose button until the dose counter shows "0". Then wait and count slowly 1-2-3-4-5-6 before you remove the needle from your skin. Safely remove the needle from the pen and throw it away.
Put the pen cap back on. Do not store your pen with a needle attached.

Checking the dose memory

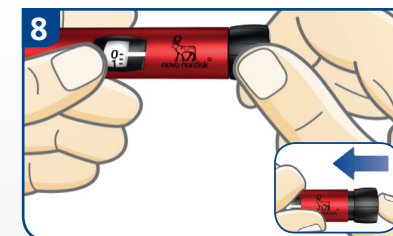

8 To activate the dose memory at the end of the dose button, pull out the dose button and push it back in. The display shows the details of your last dose. After 10 seconds, it turns off.

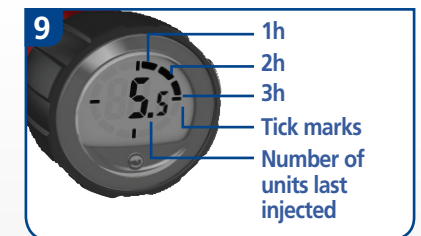

9 The number in the dose memory display is the number of units last injected. The segments around the edge show how many full hours have passed since your last injection. When a full hour has passed, one segment will be shown.
Note: the dose memory only saves information about the last injection or insulin flow test. Example above shows 5.5 units injected more than 3 hours ago, but less than 4.

How to use NovoPen Echo®

NovoPen Echo®
developed with the
needs of kids in mind



Fine-tuned dosing
in half-unit
increments.



Simple memory
function, which
records dose and time
since last injection.



Available in two
colours and a
choice of fun skins.

Function Check

If you think that your NovoPen Echo® is not working properly, follow this procedure:

- 1 Check that the mechanical part and the Penfill® cartridge holder are screwed securely together.
- 2 Screw on a new NovoFine® needle.
- 3 Prime NovoPen Echo®.
- 4 Carefully replace the NovoFine® outer needle cap.
- 5 Dispense 20 units into the cap holding the pen with the needle pointing downwards.



20 Units

The insulin should fill the lower part of the NovoFine® outer needle cap. If the pen has delivered too much or too little insulin, repeat the test.

If it happens again, do not use the pen. Contact your supplier. Do not try to repair a faulty NovoPen Echo®.

Use a new NovoFine® needle every time you inject.

Always remove the NovoFine® needle after each injection and store NovoPen Echo® without the needle attached.

Patients registered with the National Diabetes Services Scheme (NDSS) are entitled to 1,200 needles every 180 day period free of charge with or without scripts, from NDSS pharmacies and Diabetes Australia.

You have been prescribed: (to be completed by Healthcare Professional)



NovoFine® Plus 4mm 32G
0.23/0.25 x 4mm



novofine® 6mm 32G Tip
0.23/0.25 x 6mm



novofine® 8mm 30G
0.3 x 8mm



Levemir® Penfill®
insulin detemir (rys)



NovoRapid® Penfill®
insulin aspart (rys)

Remember
Always
use a new
NovoFine®
needle every time you inject

Use the injection technique shown to you by your Healthcare Professional.

Please see your Healthcare Professional for any further information about your diabetes treatment.

This sheet is intended as a quick guide only and does not replace NovoPen Echo® user manual or the CMI enclosed in your prescribed insulin pack. NovoPen Echo® user manual can be found inside every new pack of NovoPen Echo®. The CMI and user manual should be read carefully before use. For distribution by Healthcare Professionals.

Novo Nordisk Pharmaceuticals Pty Ltd. ABN 40 002 879 996. Level 10, 118 Mount Street, North Sydney, NSW 2060. NovoCare® Customer Care Centre (Australia) 1800 668 626
www.novonordisk.com.au © Registered trademark of Novo Nordisk A/S. AU21NC00005. 709990. Date of preparation: September 2021



NovoCare® Customer Care Centre

1800 668 626

www.novonordisk.com.au

